



# MINIS

**WARNING:**  
CHOKING HAZARD - Small parts.  
Not for children under 3 years.



## MOTORIZED RESCUE STUNT SET

Simpan instruksi ini untuk referensi di masa depan karena mengandung informasi penting.

### What's Included

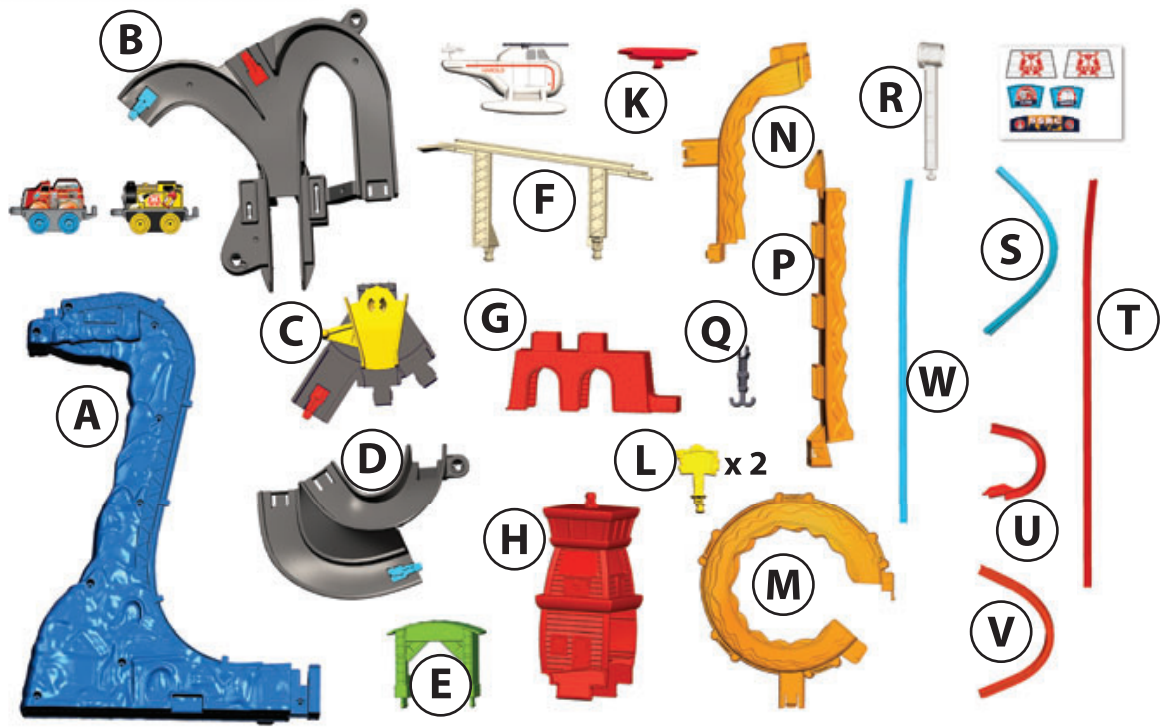

### Helpful Hints

- For assembly steps marked with a red star (\*), please note that the width of the flexible track is T-shaped and wider at the top than it is at the bottom. Be sure to align and insert correctly.
- **ONE-TIME SNAPS:** Assembly steps that are marked with a star (\*) are "one-time snaps". Once these parts are put together, they cannot be taken apart.

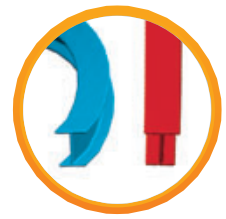

## Battery Installation

Unscrew and lift away cover from product.

Install batteries as indicated inside the battery compartment.

For longer life use only alkaline batteries.

If the product begins to malfunction, check the battery installation.

You may need to reset the electronics by removing the batteries and reinstalling them.

If the product continues to malfunction or no longer operates,

remove the batteries from the toy and replace them with fresh batteries.

Requires 3 "AA" (LR6) batteries.

**REQUIRED TOOL: PHILLIPS SCREWDRIVER  
(NOT INCLUDED).**

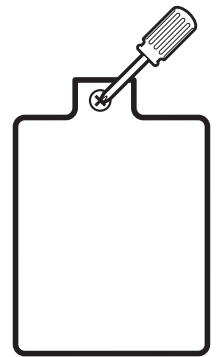
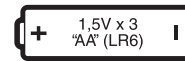

## Battery Safety Information

In exceptional circumstances batteries may leak fluids that can cause a chemical burn injury or ruin your product. To avoid battery leakage:

- Non-rechargeable batteries are not to be recharged.
- Rechargeable batteries are to be removed from the product before being charged.
- Rechargeable batteries are only to be charged under adult supervision.
- Do not mix alkaline, standard (carbon-zinc), or rechargeable (nickel-cadmium) batteries.
- Do not mix old and new batteries.
- Only batteries of the same or equivalent type as recommended are to be used.
- Batteries are to be inserted with the correct polarity.
- Exhausted batteries are to be removed from the product.
- The supply terminals are not to be short-circuited.
- Dispose of battery(ies) safely.
- Do not dispose of this product in a fire. The batteries inside may explode or leak.



Protect the environment by not disposing of this product or any batteries with household waste. This symbol indicates that this product shall not be treated as household waste. Check your local authority for recycling advice and facilities.

## Label Placement

1

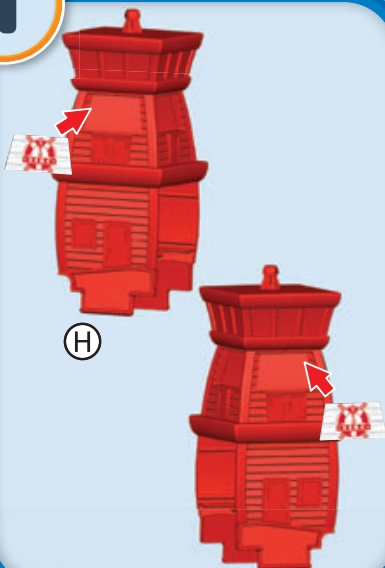

2



3

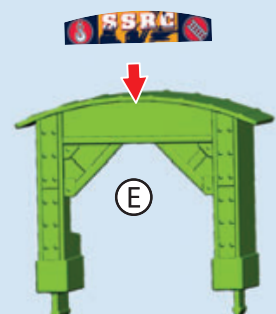

# Assembly

Assembly steps that are marked with a star (★), are “one-time snaps”. Press firmly until they snap into place. Once these parts are put together, they cannot be taken apart.

1

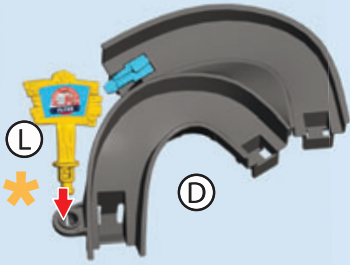

2

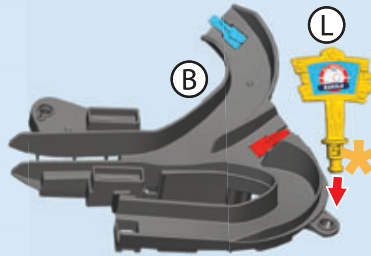

3

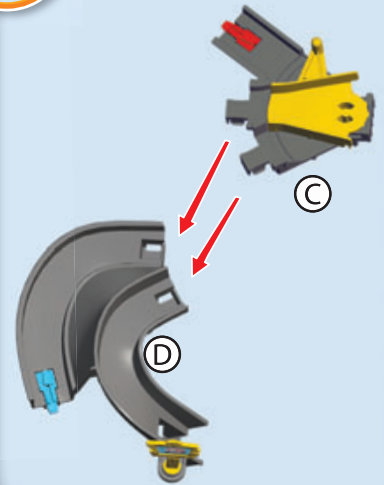

4

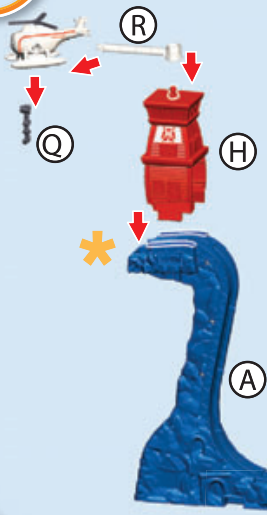

5

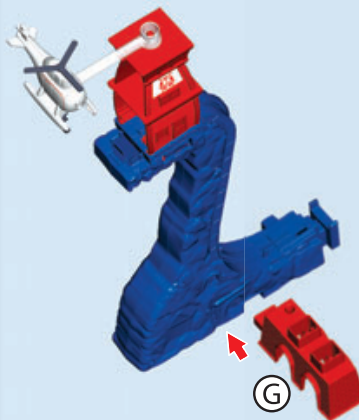

6

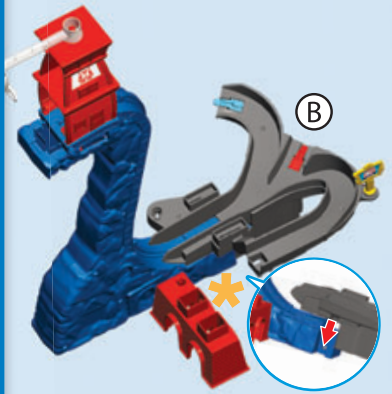

7

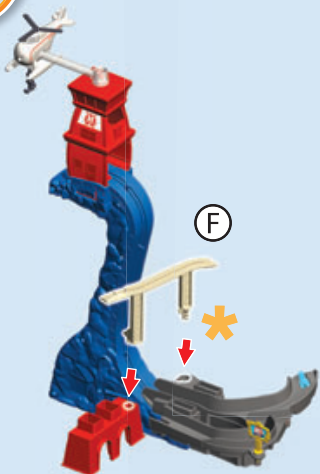

8

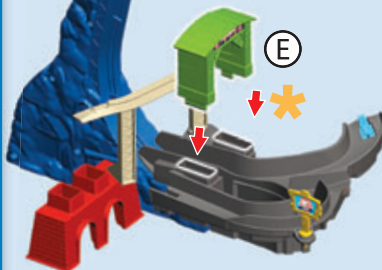

9

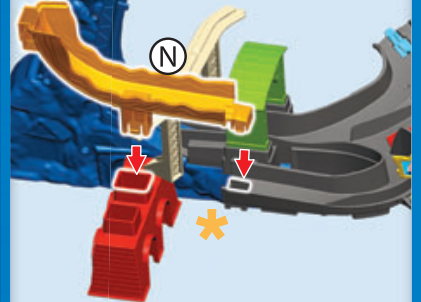

For assembly steps marked with a red star (\*), please note that the width of the flexible track is T-shaped and wider at the top than it is at the bottom. Be sure to align and insert correctly.

10

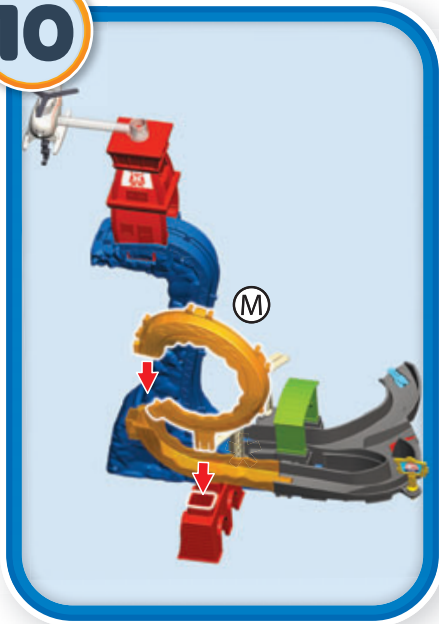

11



12



13



14

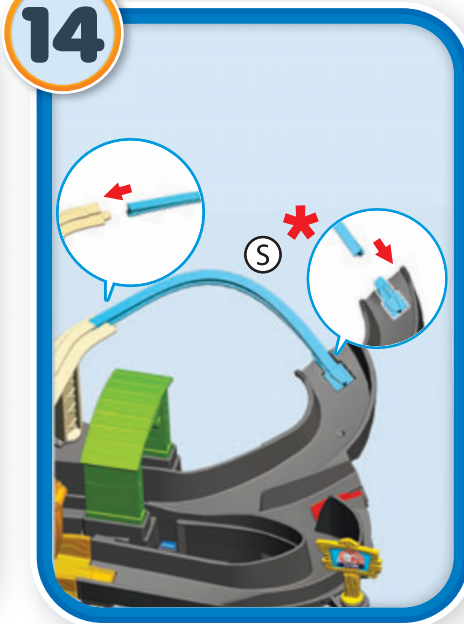

15

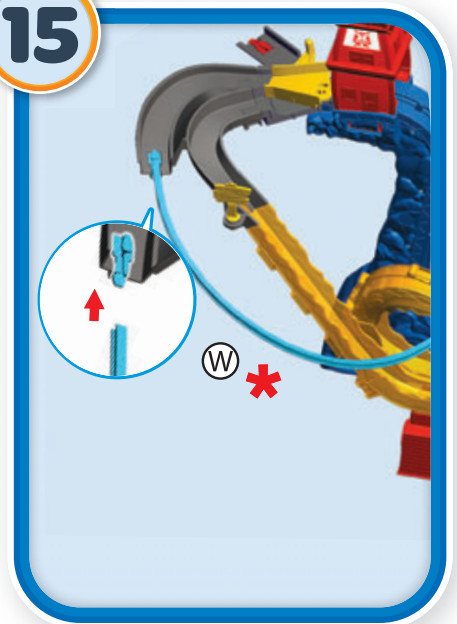

16



17

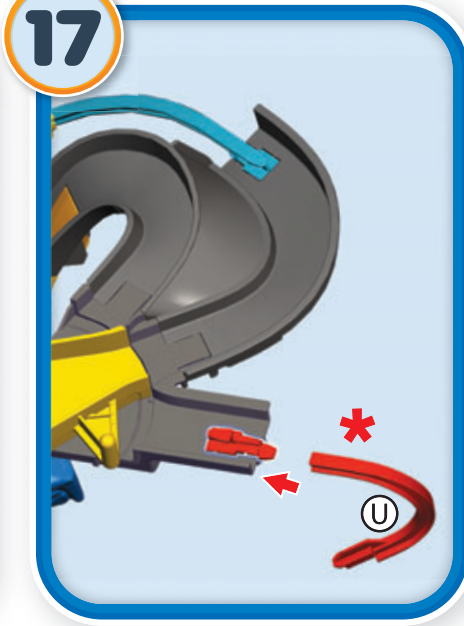

18

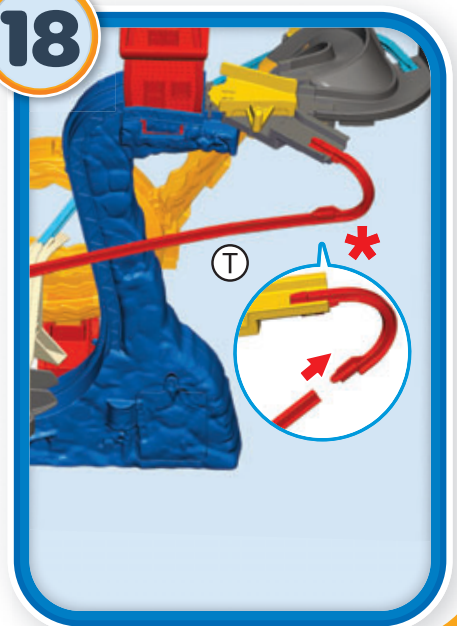

# Assembly

For assembly steps marked with a red star (\*), please note that the width of the flexible track is T-shaped and wider at the top than it is at the bottom. Be sure to align and insert correctly.

19



20

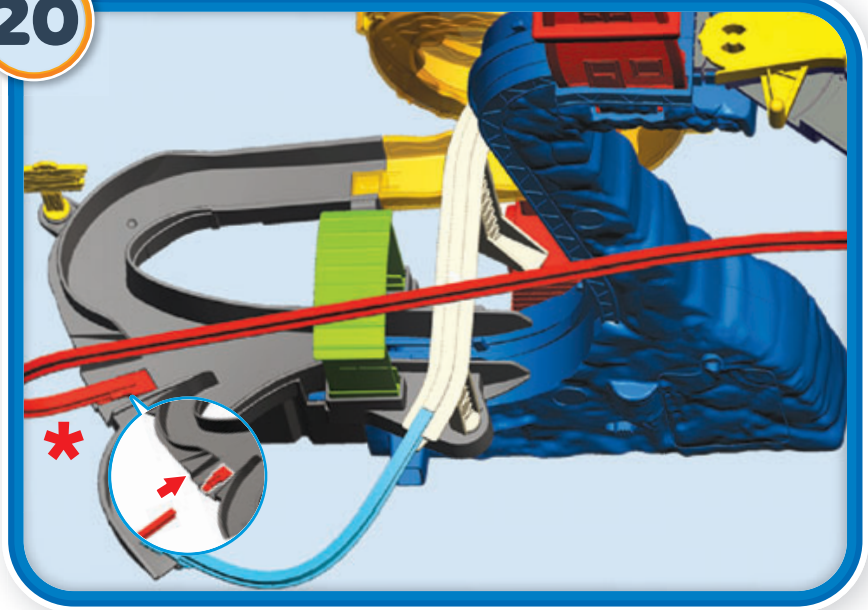

# How To Play

Move the track switch, and send the engines down 1 of 3 routes.

1

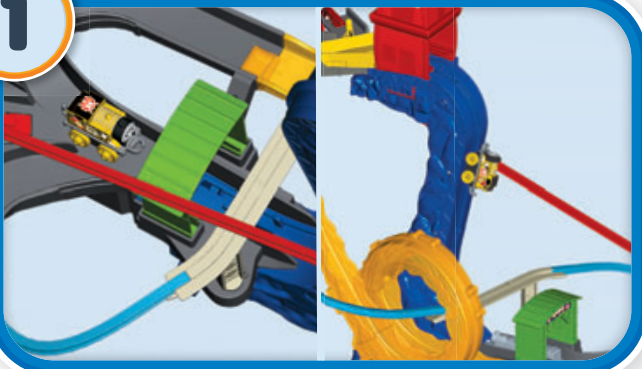

2

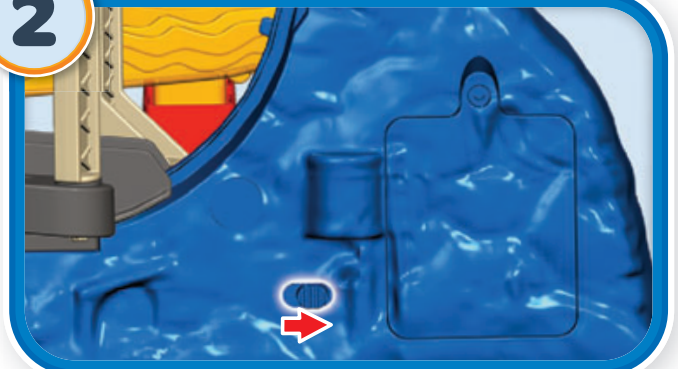

3

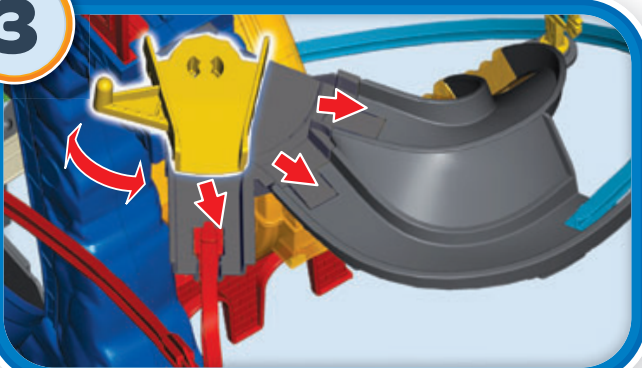

4

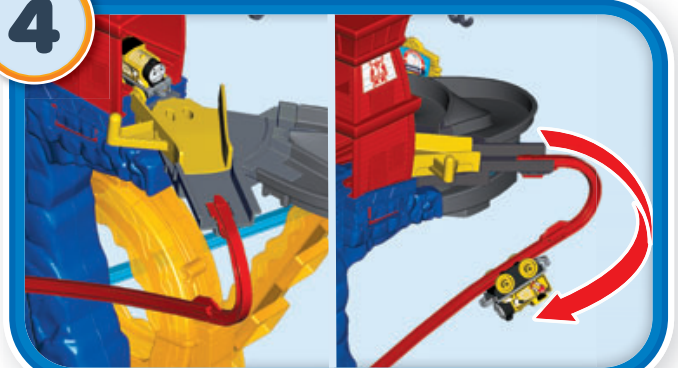

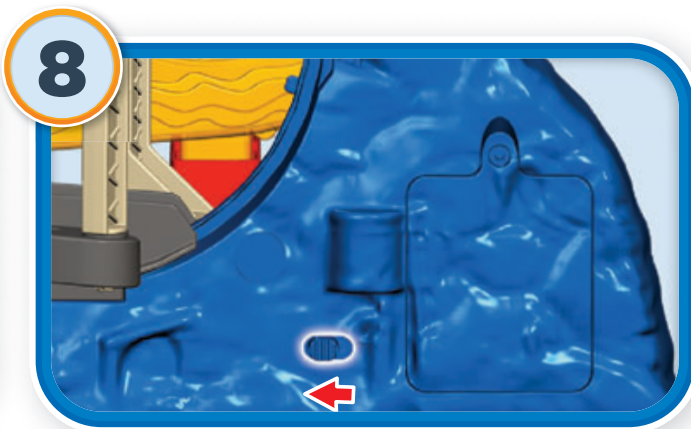
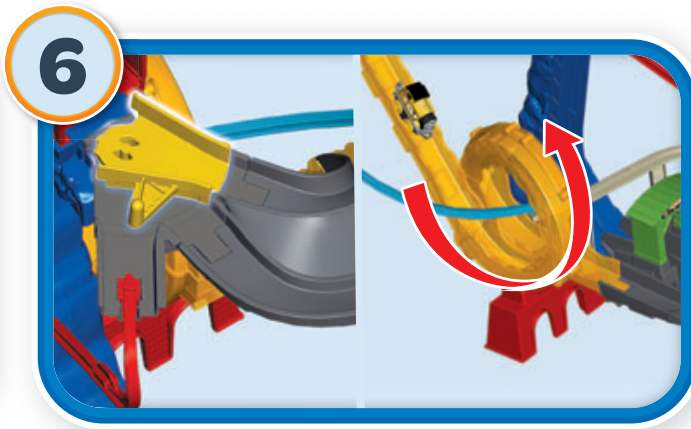
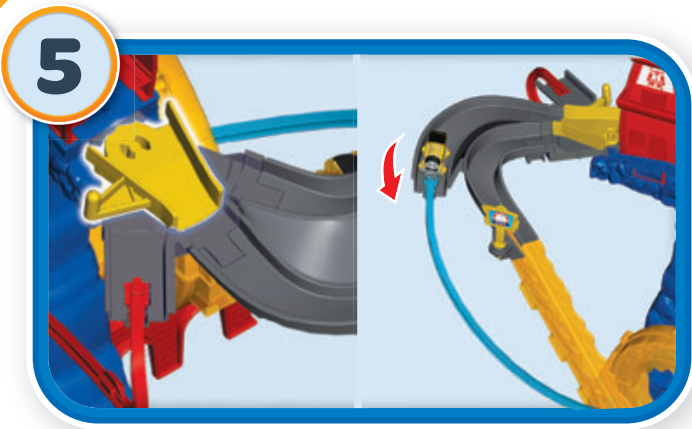

**NOTE: May not work with all engines.**

**Adult assembly required.** No tool needed.

Thomas the Tank Engine & Friends™



CREATED BY BRITT ALLCROFT

Based on the Railway Series by The Reverend W Awdry.

©2018 Gullane (Thomas) Limited. Thomas the Tank Engine & Friends and Thomas & Friends are trademarks of Gullane (Thomas) Limited.

©2018 HIT Entertainment Limited. HIT and the HIT logo are trademarks of HIT Entertainment Limited.

©2018 Mattel. ® and ™ designate U.S. trademarks of Mattel, except as noted. **PRINTED IN CHINA.**

Mattel East Asia Ltd., Room 503-09, North Tower, World Finance Centre, Harbour City, Tsimshatsui, HK, China. Tel.: (852) 3185-6500.

**?** **CONSUMER ASSISTANCE**  
 1-800-432-5437 (US & Canada)  
 1300 135 312 (Australia)

**service.fisher-price.com**

Fisher-Price, Inc., 636 Girard Avenue, East Aurora, NY 14052.  
 Hearing-impaired consumers: 1-800-382-7470.

**Outside the United States:**

Canada: Mattel Canada Inc., 6155 Freemont Blvd., Mississauga, Ontario L5R 3W2; www.service.mattel.com.

Great Britain: Mattel UK Ltd, Vanwall Business Park, Maidenhead SL6 4UB. Helpline: 01628 500303. www.service.mattel.com/uk

Mattel Europa B.V., Gondel 1, 1186 MJ Amstelveen, Nederland.

Australia: Mattel Australia Pty. Ltd., 658 Church Street, Locked Bag #870, Richmond, Victoria 3121 Australia.

New Zealand: 16-18 William Pickering Drive, Albany 1331, Auckland.

South Africa: Mattel South Africa (PTY) LTD, Office 102 I3, 30 Melrose Boulevard, Johannesburg 2196.

**FXT29**

