

CRASH CHALLENGE

INSTRUCTIONS

4+



Please keep these instructions for future reference as they contain important information.

CONTENTS

C

E

B

A

D

C

F

E

A

B

D

F

X2

X2

X3

X2

X2

X2

X2

1

APPLY LABELS

BACK VIEW

BOTTOM VIEW

X2

©2018 Mattel. ® and ™ designate U.S. trademarks of Mattel, except as noted. Mattel, Inc., 636 Girard Avenue, East Aurora, NY 14052, U.S.A. Consumer Services 1-800-524-8697 or 1-877-219-8335 (for products that can be controlled by smart devices). Mattel U.K. Ltd., Vanwall Business Park, Maidenhead SL6 4UB. Helpline 01628 500303. Mattel Australia Pty., Ltd., Richmond, Victoria. 3121.Consumer Advisory Service - 1300 135 312. Mattel South Africa (PTY) LTD, Office 102 I3, 30 Melrose Boulevard, Johannesburg 2196. Mattel East Asia Ltd., Room 503-09, North Tower, World Finance Centre, Harbour City, Tsimshatsui, HK, China. Tel.: (852) 3185-6500. Diimport & Diedarkan Oleh: Mattel Southeast Asia Pte. Ltd. , No 19-1, Tower 3 Avenue 7, Bangsar South City, No 8, Jalan Kerinchi, 59200 Kuala Lumpur, Malaysia. Tel: 03-33419052.



①

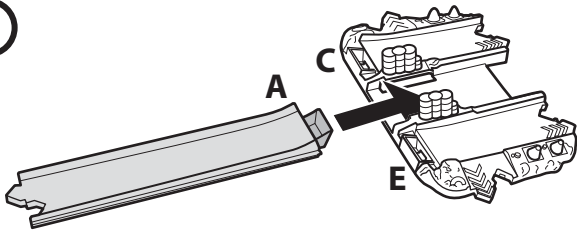

②

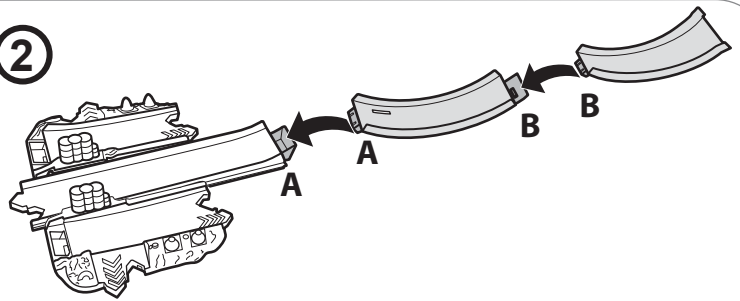

③

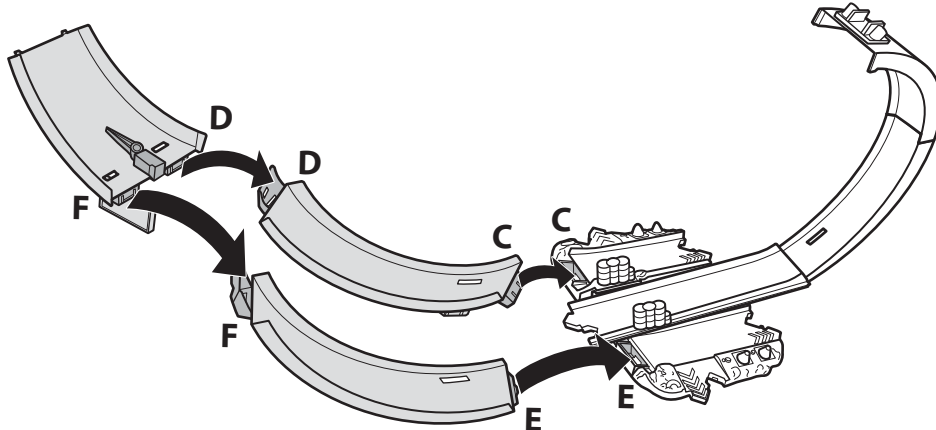

④

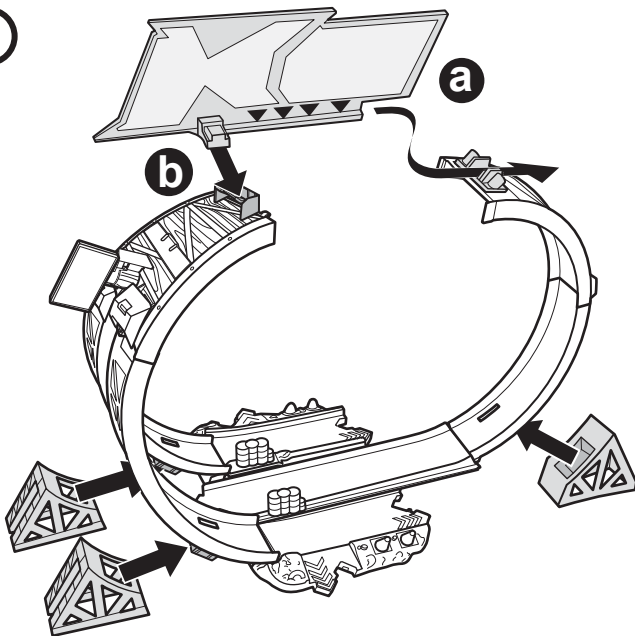

⑤

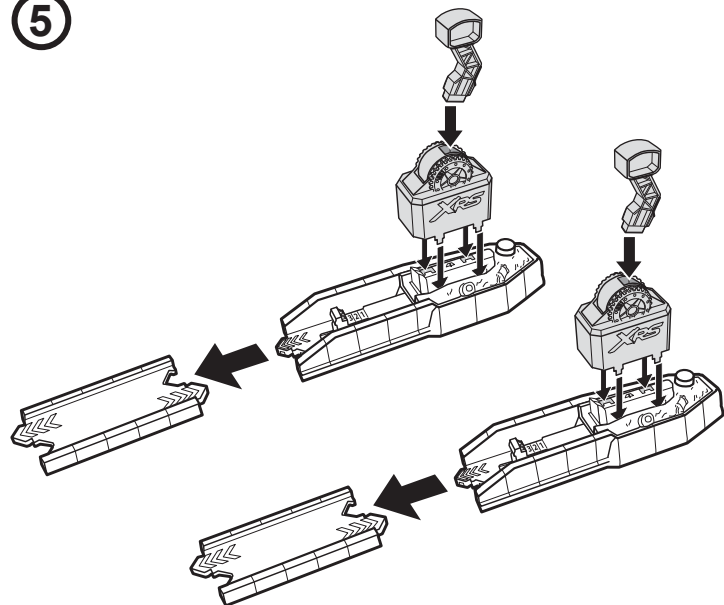

⑥

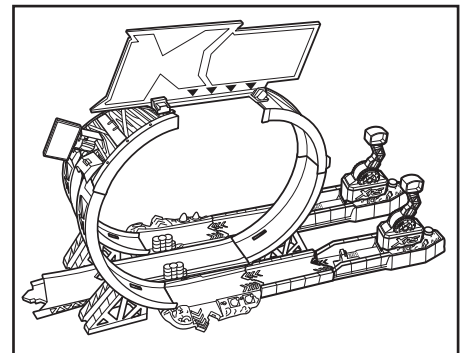
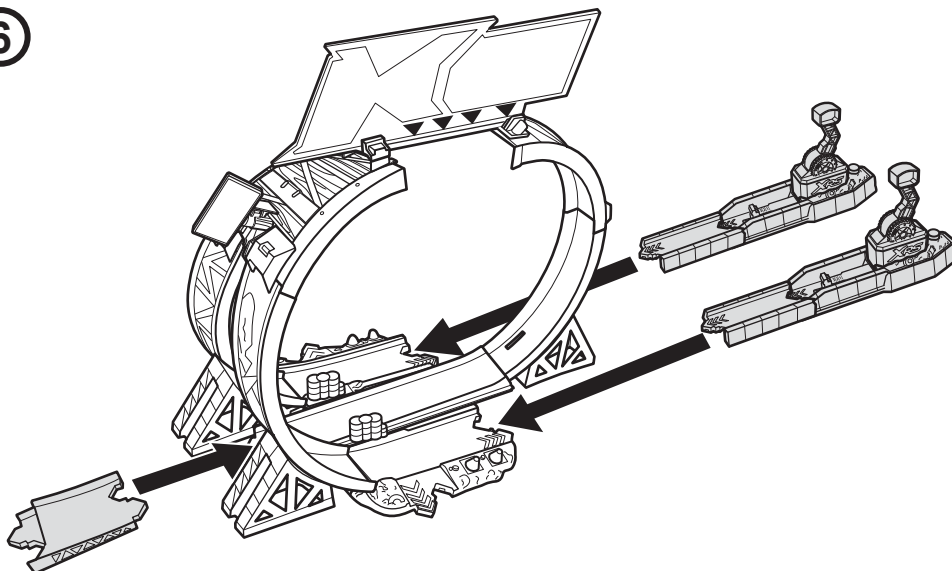

① Adjust jumping distance.

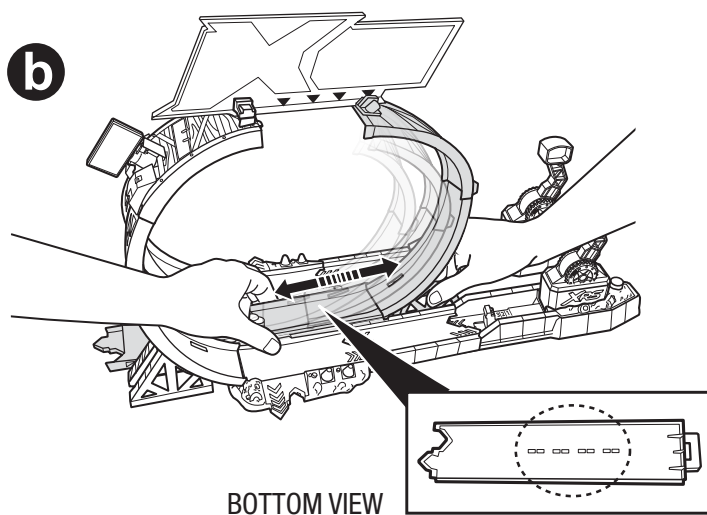
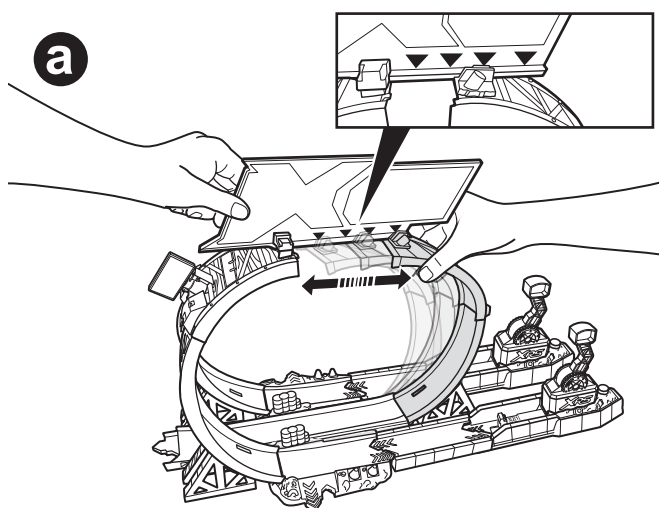

② Lock launchers and load vehicles.

- a 3-SPEED LAUNCHER**
Push forward to select different speed settings for best performance.

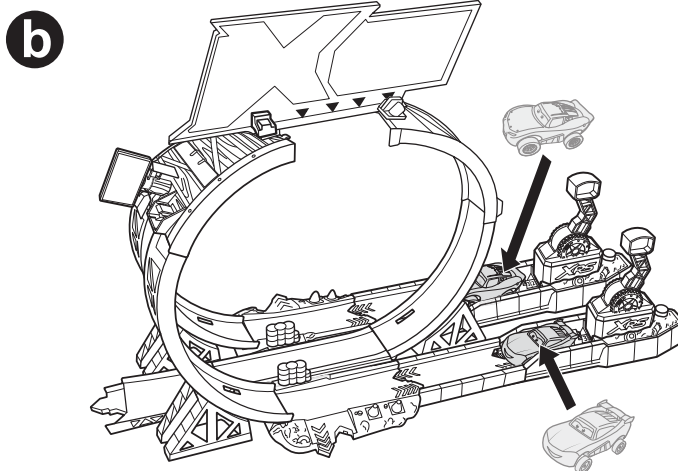
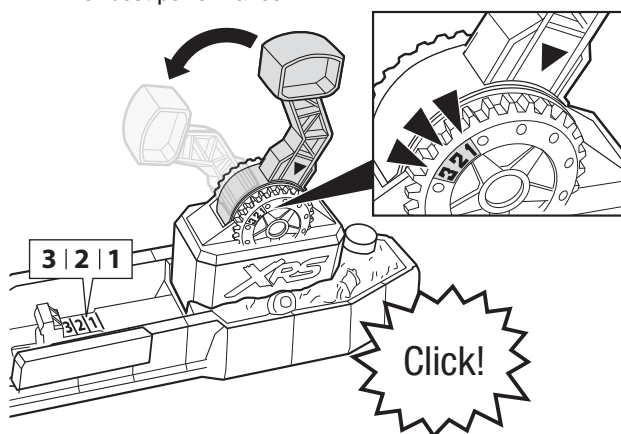

Works best with vehicle included. One vehicle included. Additional vehicle sold separately, subject to availability. Not for use with some Cars vehicles.

③ Press buttons to launch and race!

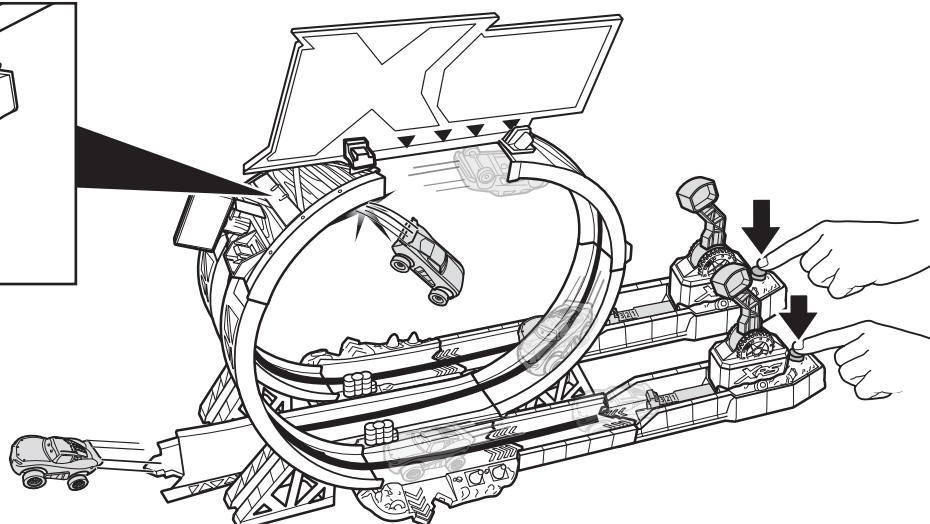
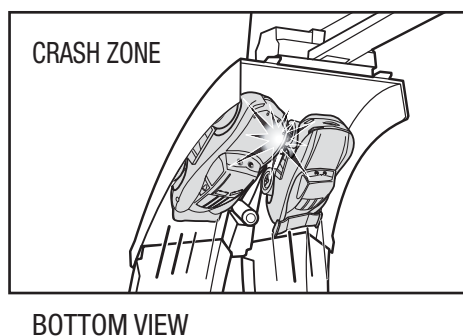

4 TO PLAY: HEAD-TO-HEAD RACE

- ① Rearrange track pieces to set up another race.

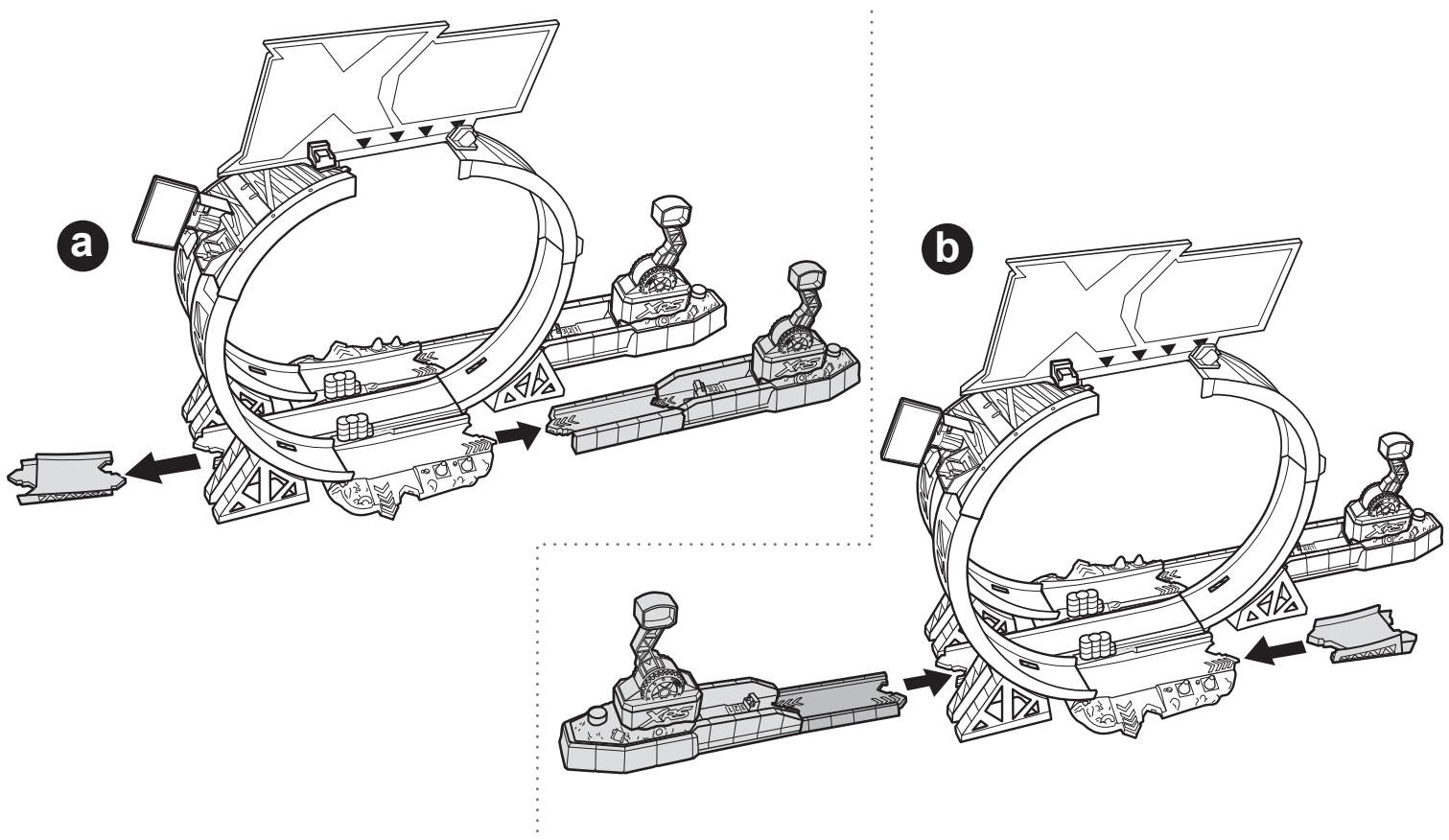

- ② Launch vehicles to hit and crash!

