

Fisher-Price®

G5776
Instructions

Jungle Development Mobile™

Please keep this instruction sheet for future reference, as it contains important information.

Requires three "C" (LR14) **alkaline** batteries (not included).

Adult assembly is required.

Tool required for assembly: Phillips screwdriver (not included).



Link-a-doo

www.fisher-price.com

Parts

WARNING

- Possible entanglement injury, keep out of baby's reach.
- Remove mobile from crib or playpen when baby begins to push up on hands and knees.

CAUTION

This toy contains small parts in its unassembled state.
Adult assembly is required.

IMPORTANT!

- A crib mobile is intended for visual stimulation and is not to be grasped by a child.
- Always attach by all provided fasteners (clamp) tightly to a crib or playpen according to the instructions. Check frequently.
- Do not add additional strings or straps to attach to a crib or playpen.

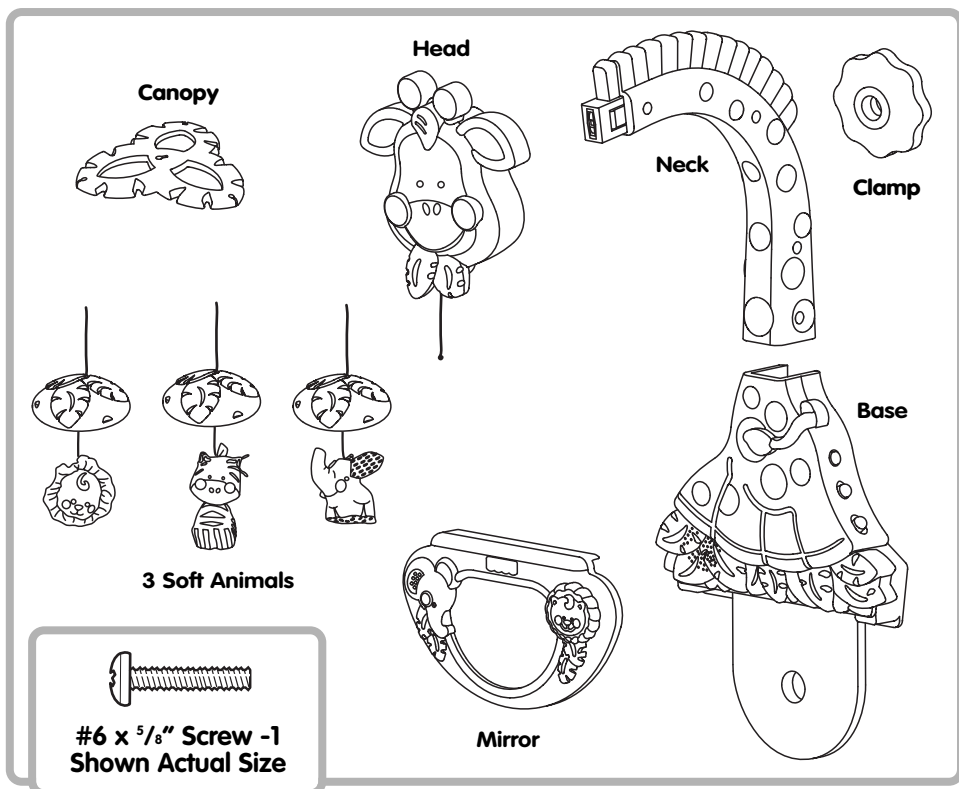

Battery Installation

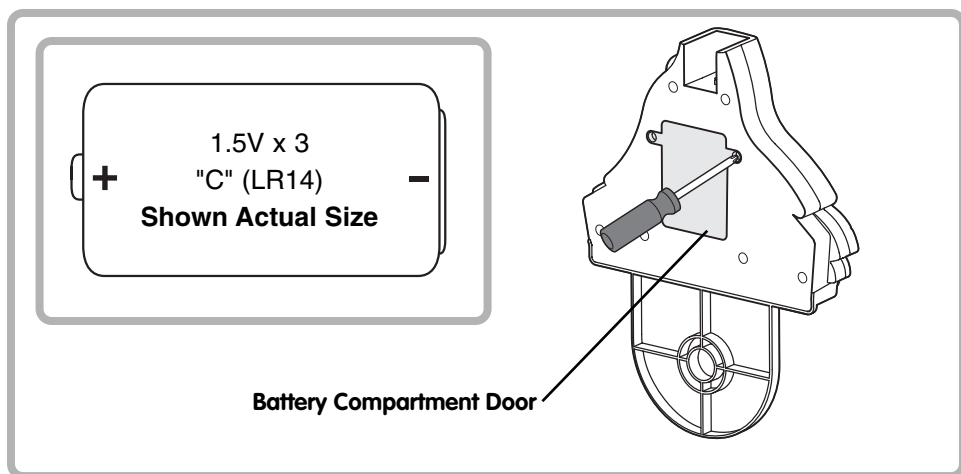

- Locate the battery compartment on the back of the base.
- Loosen the screws in the battery compartment door with a Phillips screwdriver. Remove the battery compartment door.
- Insert three "C" (LR14) **alkaline** batteries.

Hint: We recommend using **alkaline** batteries for longer life.

- Replace the battery compartment door and tighten the screws with a Phillips screwdriver. Do not over-tighten.
- When sounds or motions from this toy become faint or stop, it's time for an adult to change the batteries!

Battery Safety Information

Batteries may leak fluids that can cause a chemical burn injury or ruin your toy. To avoid battery leakage:

- Do not mix old and new batteries or batteries of different types: alkaline, standard (carbon-zinc) or rechargeable (nickel-cadmium).
- Insert batteries as indicated inside the battery compartment.
- Remove batteries during long periods of non-use. Always remove exhausted batteries from the toy. Dispose of batteries safely. Do not dispose of batteries in a fire. The batteries may explode or leak.
- Never short-circuit the battery terminals.
- Use only batteries of the same or equivalent type, as recommended.
- Do not charge non-rechargeable batteries.
- Remove rechargeable batteries from the toy before charging.
- If removable, rechargeable batteries are used, they are only to be charged under adult supervision.

Care

- Surface wash only. Wipe with a clean cloth dampened with a mild soap and water solution.
- Do not immerse the toy.

FCC Note (United States Only)

Note: This equipment has been tested and found to comply with the limits for a Class B digital device, pursuant to Part 15 of the FCC Rules. These limits are designed to provide reasonable protection against harmful interference in a residential installation. This equipment generates, uses and can radiate radio frequency energy and, if not installed and used in accordance with the instructions, may cause harmful interference to radio communications. However, there is no guarantee that interference will not occur in a particular installation. If this equipment does cause harmful interference to radio or television reception, which can be determined by turning the equipment off and on, the user is encouraged to try to correct the interference by one or more of the following measures:

- Reorient or relocate the receiving antenna.
- Increase the separation between the equipment and receiver.
- Consult the dealer or an experienced radio/TV technician for help.

Note: Changes or modifications not expressly approved by the manufacturer responsible for compliance could void the user's authority to operate the equipment.

Consumer Information

Questions? We'd like to hear from you!

Call Fisher-Price® Consumer Relations, toll-free at **1-800-432-5437**, 8 AM - 6 PM EST Monday through Friday. Hearing-impaired consumers using TTY/TDD equipment, please call 1-800-382-7470. Or, visit us on line at www.service.mattel.com.

Write to us at:

Fisher-Price® Consumer Relations
636 Girard Avenue
East Aurora, New York 14052.

For countries outside the United States:

CANADA: Questions? **1-800-432-5437**. Mattel Canada Inc., 6155 Freemont Blvd., Mississauga, Ontario L5R 3W2.

GREAT BRITAIN: [Mattel UK Ltd, Vanwall Business Park, Maidenhead SL6 4UB](http://www.mattel.co.uk). Helpline: 01628 500302.

AUSTRALIA: Mattel Australia Pty. Ltd., 658 Church Street, Locked Bag #870, Richmond, Victoria 3121 Australia. Consumer Advisory Service 1300 135 312.

NEW ZEALAND: 16-18 William Pickering Drive, Albany 1331, Auckland.

ASIA: Mattel East Asia Ltd, Room 1106, South Tower, World Finance Centre, Harbour City, Tsimshatsui, HK, China.

Assembly

1

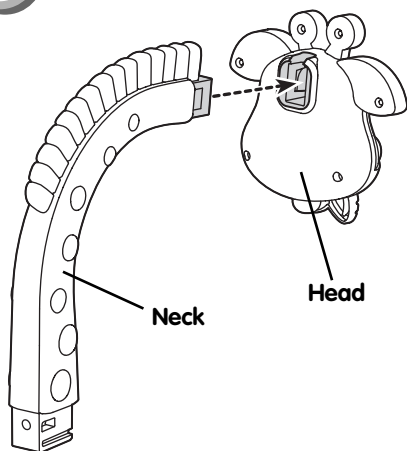

- **"Snap"** the head onto the neck.
- Gently pull on the head to be sure it is secure.

2

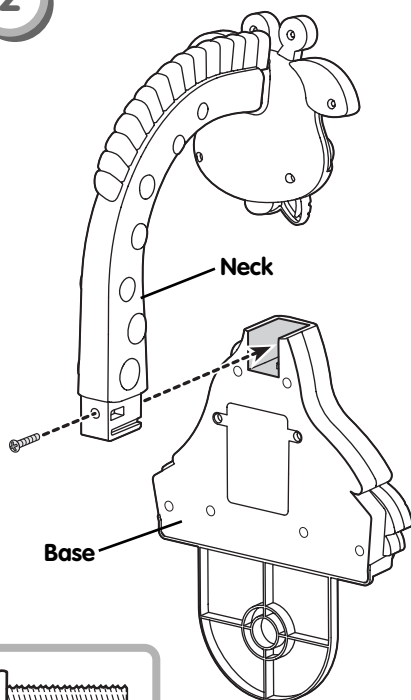

- Slide the neck into the slot in the base, as shown.
- Insert the #6 x $\frac{5}{8}$ " screw into the hole in the neck. Tighten the screw with a Phillips screwdriver. Do not over-tighten.

Assembly

3

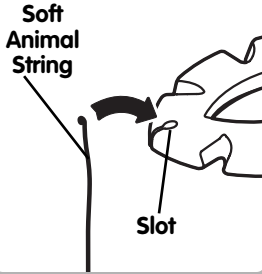
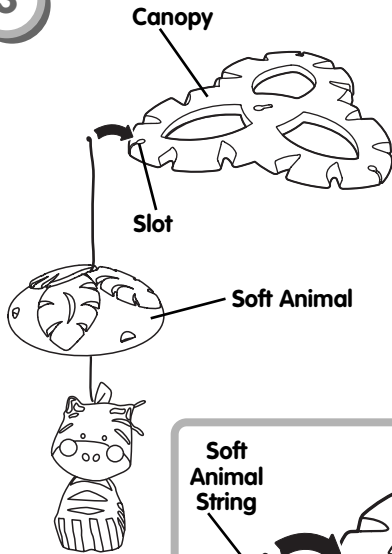

- Position the canopy with the open side facing down.
- Fit a soft animal string through one of the slots on the canopy.
- Pull down gently on the soft animal to secure the string in the canopy.
- Repeat this procedure to attach the remaining soft animals to the other two slots in the canopy.

4

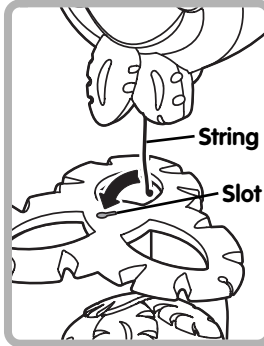
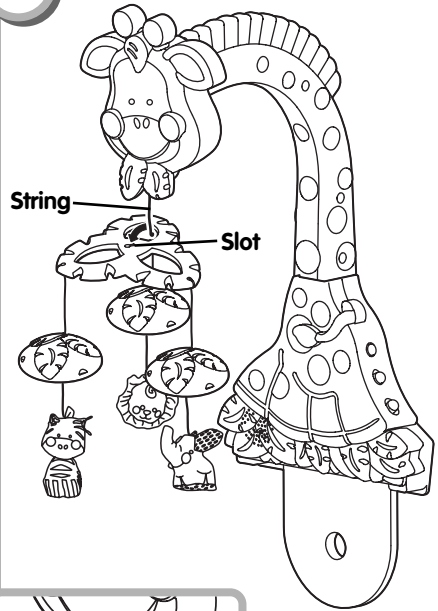

- Fit the string from the head into the slot in the center of the canopy.
- Slide the knot to the narrow end of the slot and pull down gently on the canopy to secure it on the string.

Attaching the Mobile to a Crib

1

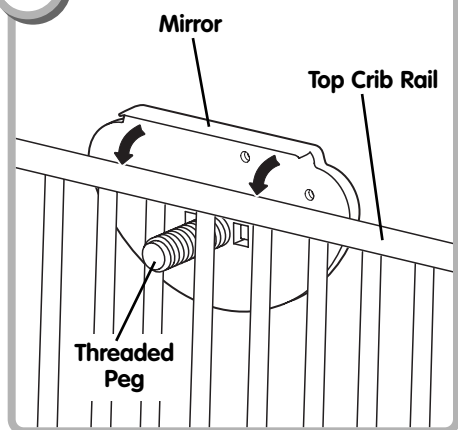

Fit the mirror onto the top crib rail so that the threaded peg extends out of the crib. Hold the mirror in place.

2

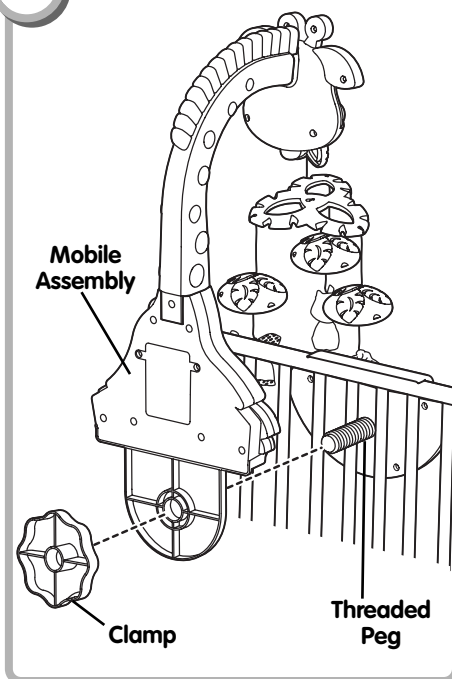

- Slide the mobile assembly onto the threaded peg from the mirror so that it also rests on the top crib rail.
- Fit the clamp onto the threaded peg and turn it clockwise to secure the mobile to the crib rail. Do not over-tighten the clamp.

Use

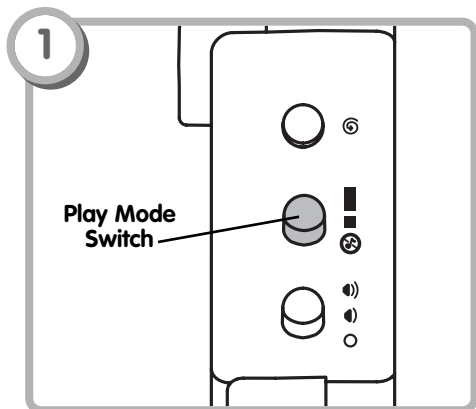

- Locate the play mode switch on the base.
- Slide to short play ■ for about 3 minutes of music and motion.
- Slide to long play ▮ for about 7 minutes of music and motion.
- Slide to this position 🎵 for about 3 minutes of motion only (no music).

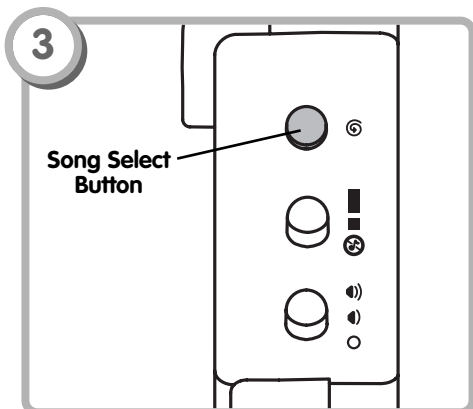

- Press this button ⑥ to choose from four different songs.

Hint: To restart the mobile, press the song select button again.

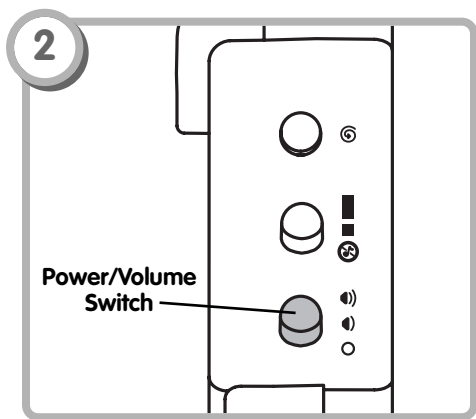

- Locate the power/volume switch on the base.
- Slide the switch to either: on with low volume 🗣️ or on with high volume 🗣️).
- Music begins as the animal friends "dance" over baby's head.
- Slide the power/volume switch to the off position ○ when not in use.