

Fisher-Price®

**Scan it. Watch it.
Build it.**

fisher-price.com/assembly/GDD39



**EASY
ASSEMBLY
VIDEO**



GDD39

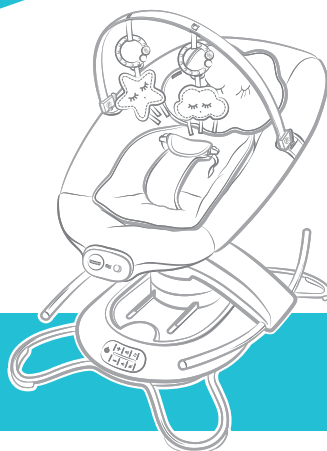

ASSEMBLY AND USE

WARNING:

Prevent serious injury or death:

- Never leave child unattended.
- This product is not intended for unsupervised or prolonged periods of sleep.
- Always use the restraint system.
- Never use for a child able to sit up unassisted.
- **Fall Hazard** – Never use on any elevated surface, since child's movement may cause the product to slide or tip over. Use only on a floor.
- **Suffocation Hazard** – Never use on a soft surface (bed, crib, sofa, cushion) since the product can tip over and cause suffocation.
- The toy bar is not a carry handle. Never use toy bar to lift or carry product.
- Never use as a carrier or lift while child is seated.

BEFORE YOU BEGIN



IMPORTANT!

Keep this instruction sheet for future reference, as it contains important information.

Before assembly and each use, inspect this product for damaged hardware, loose joints, missing parts or sharp edges. Do not use the product if any parts are missing, damaged or broken. Do not use accessories or replacement parts other than those approved by the manufacturer. Never substitute parts.



Adult assembly is required. Tool needed for assembly: Phillips screwdriver (not included).

Please read these instructions before assembly and use of this product.

Product features and decorations may vary from images.



20

Set aside at least 20 minutes for assembly.



x1

One D (LR20) **alkaline** battery is required for the soother (not included). For longer life, use **alkaline** batteries.



Requires an AC adapter (input 100 - 240 VAC, 50 - 60 Hz, with an output of 6V, 1A) for operation (included).

The AC adapter is not a toy.



Use from birth until child is able to sit up unassisted.



This product may come with replacement warning labels which you can apply over the factory applied warning label if English is not your primary language. Select the warning label with the appropriate language for you.



Some features of this product only work with the Fisher-Price® Smart Connect™ app.

Download the Fisher-Price® Smart Connect™ app to control the glider from your smart device (not included). The app is available on the App Store® and Google Play™. The app does not control seat vibration.

The Smart Connect™ app is compatible with most iOS and Android™ devices. Visit fisher-price.com/SmartConnect/ for a list of compatible devices.

PARTS

IMPORTANT! Please remove all parts from the package and identify them before assembly. Some parts may be packed in the pad.

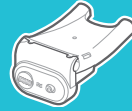
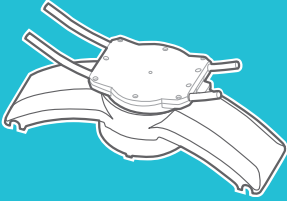

We recommend installing batteries in the soothing unit before beginning assembly.

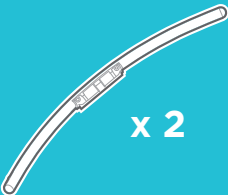
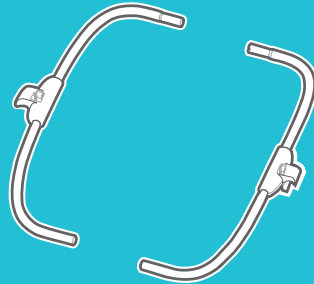

x 2



x 2

PARTS

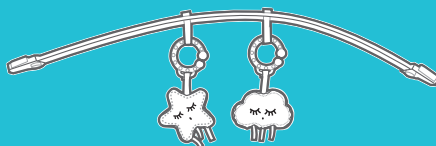
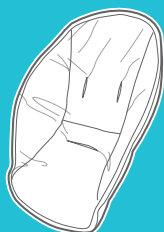
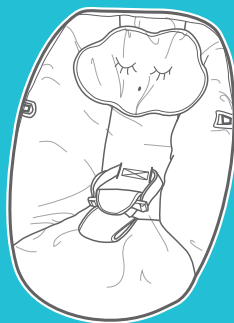
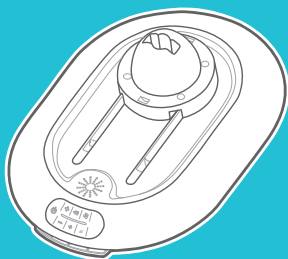

x 8

M3,5 x 15 mm Screw

Note: Tighten or loosen all screws with a Phillips screwdriver. Do not over-tighten the screws.

ASSEMBLY

Push the base tube until it “snaps” into place. Pull on it to be sure it’s assembled to the base.

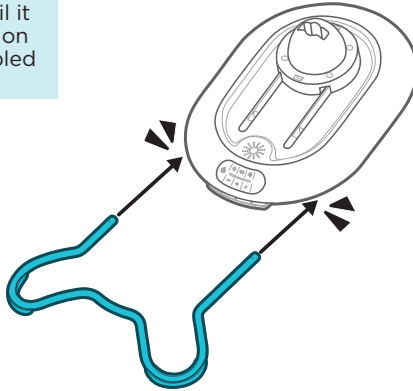

1

Oh, no! If you snapped one end of the base tube into the base and can’t assemble the other end, you can remove the base tube. See the next step for instructions to remove the base tube.

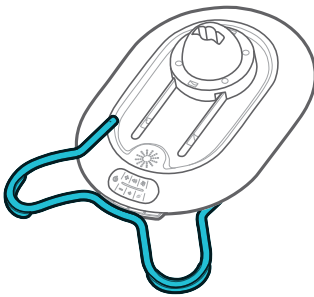

2

Rotate the tube up and then pull it out. Go back to assembly step 1.

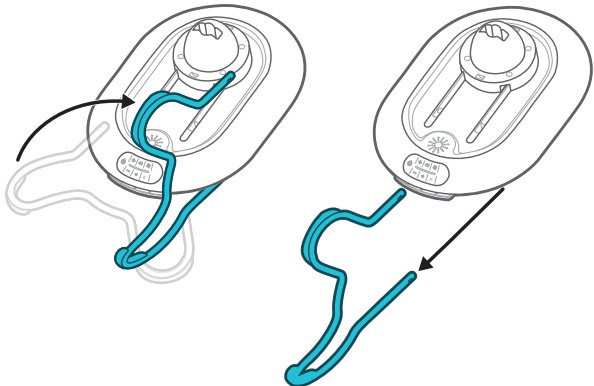

3

ASSEMBLY

Push the other base tube until it “snaps” into place. Pull on it to be sure it’s assembled to the base.

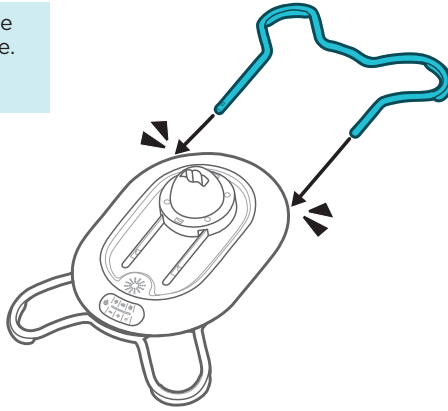

4

During shipping, the seat base tubes may have moved. Press the latch and make sure the ends of the tubes align on both sides.

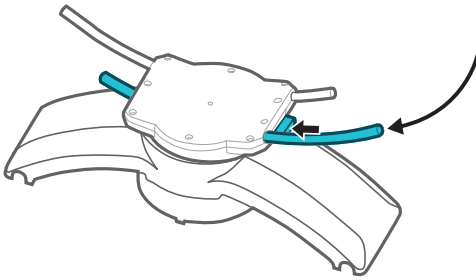

5

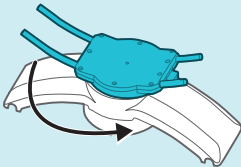

It's easier to complete assembly if the seat base tubes are turned.

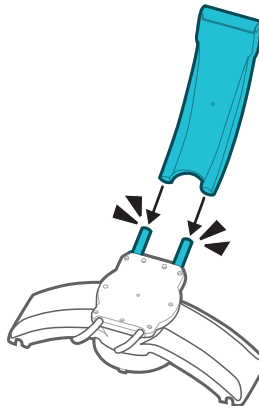

If the seat back does not snap to the tubes, try assembling it to the tubes on the opposite side of the seat base.

6

ASSEMBLY

7

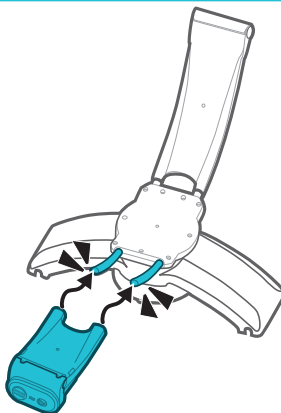

Make sure the socket is upright.

8

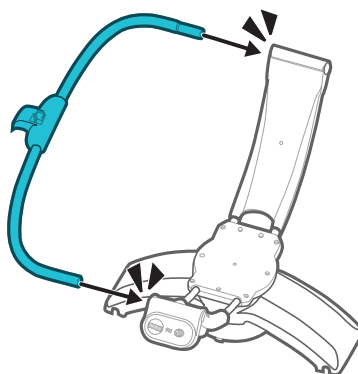

9

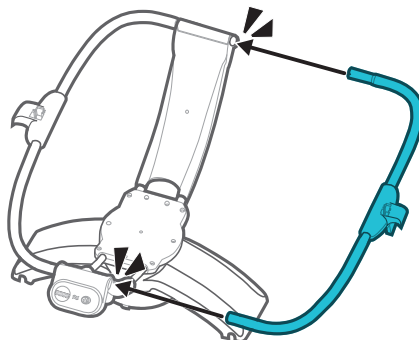

Make sure the socket is upright.

ASSEMBLY

Turn the assembly over and fit a seat rail to the frame.

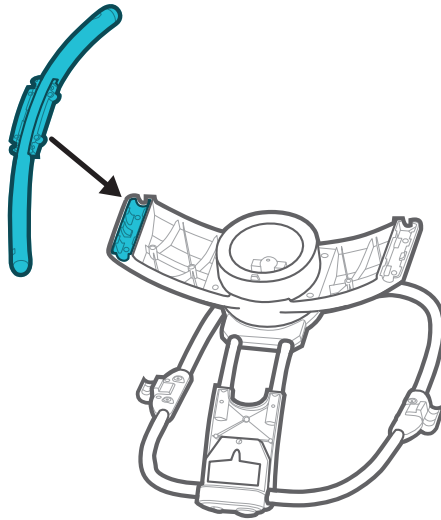

10

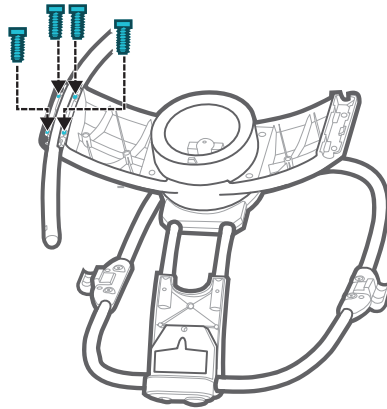

x 4

11

ASSEMBLY

12

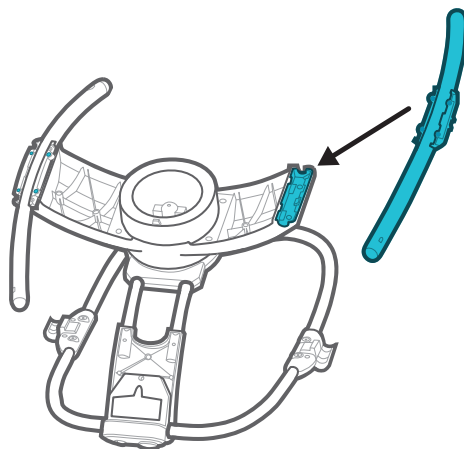

13

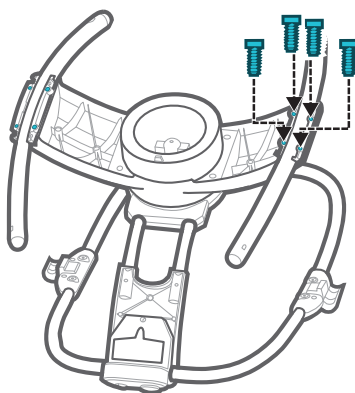

ASSEMBLY

Hint: Before attaching the seat pad in the next step, you may want to install the soother battery. Go to page 13 for battery installation instructions.

Turn the assembly upright to attach the seat pad.

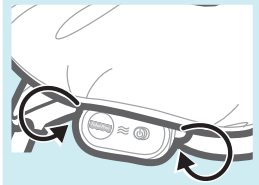
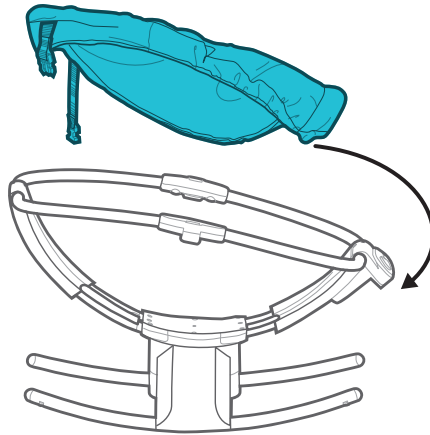

Attach the pad around the soother.

14

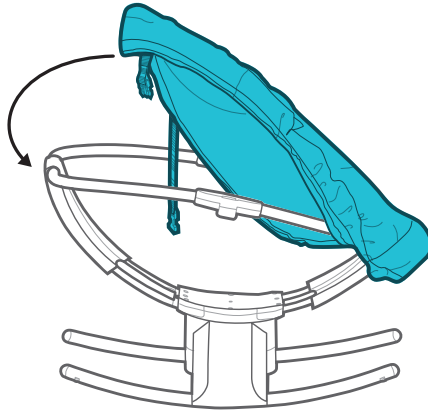

15

ASSEMBLY

16

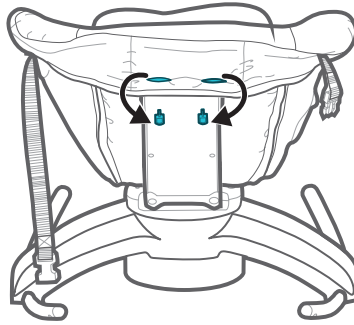

Fasten the pad button holes to the pegs.

17

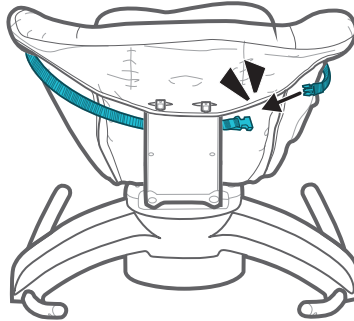

Buckle the straps on the pad. Make sure you hear a “**click**”.

18

Tuck the pad around the toy bar retainers.

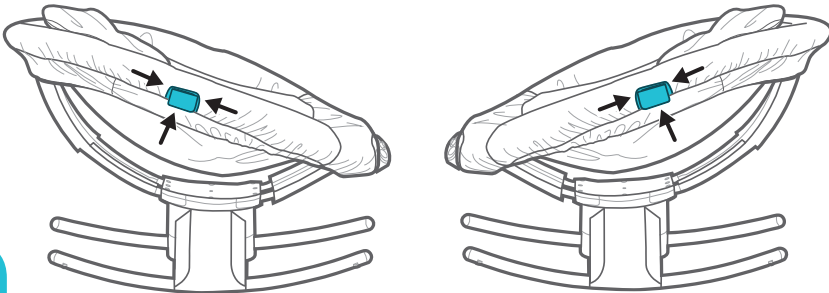

ASSEMBLY

Fit the restraint belts through the slots in the body support.

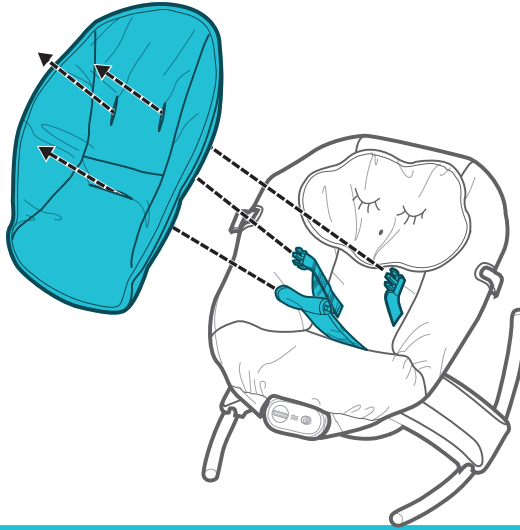

19

SOOTHER BATTERY INSTALLATION

The battery compartment is located on the underside of the soother. Remove the seat pad from around the soother.

Loosen the screw in the battery compartment door and lift to remove the door.

Insert one D (LR20) **alkaline** battery.

Replace the battery compartment door and tighten the screw.

Replace the seat pad around the soother.

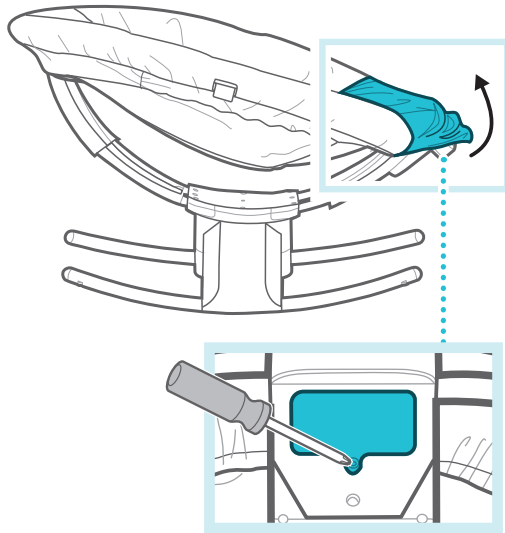

ADJUST SEAT BACK

The seat back can be raised or lowered for **upright or recline** seating when used as a rocker or glider.

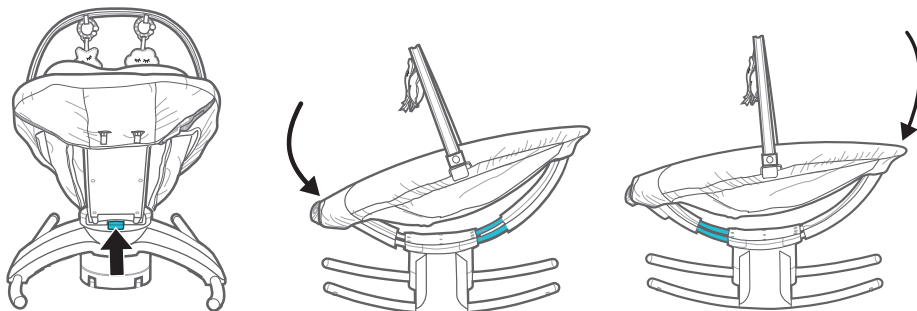

Press the latch on the seat frame and then push the seat back or the seat bottom into upright or recline positions.

TOY BAR

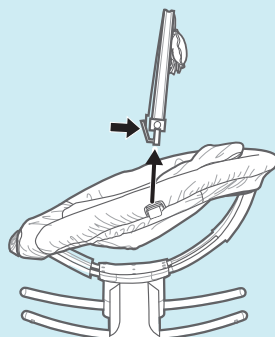
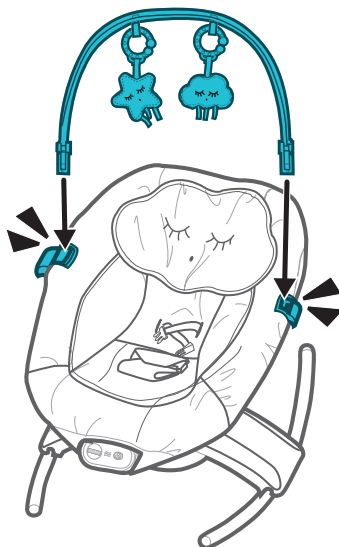

The toy bar is removable. Simply press the the ends of the latches and lift the toy bar.

GLIDER

"Snap" the seat to the base to use as a glider.

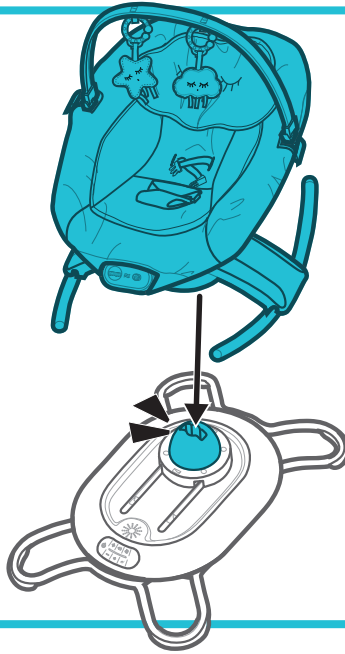

1

Place the glider near a standard wall outlet. First plug the AC adapter into the glider base and then the wall outlet. Use the AC adapter only in a wall outlet. Do not plug the adapter into a ceiling outlet.

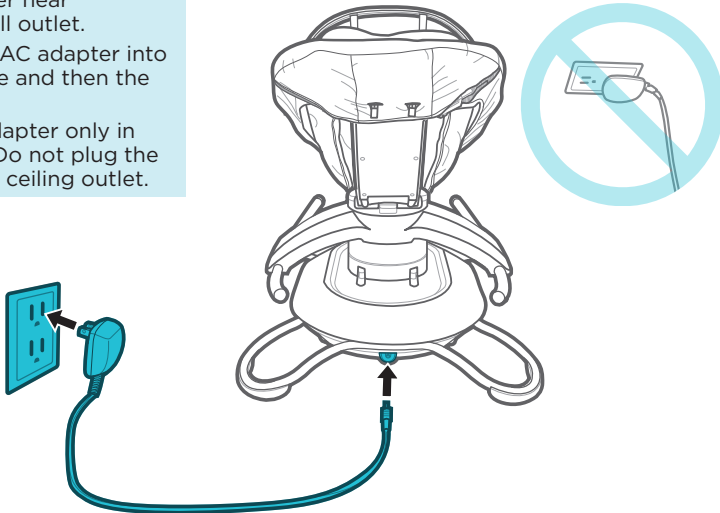

2

PAIRING YOUR DEVICE

Before using the Smart Connect™ app for the first time, you will need to pair your device with the glider.

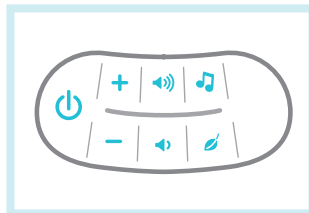
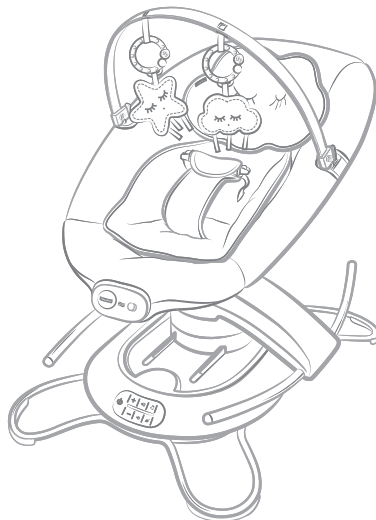

Open the Smart Connect™ app on your device. Be sure your device is within approximately 1,8 m (6 ft) of the glider to pair.

Press and hold the pairing button (power button) on the glider control panel for about 5 seconds. The glider stays in pairing mode for approximately 30 seconds.

Hint: If you cannot pair your device with the glider, try moving the device closer to the glider.

The glider icon will be highlighted in green in the app when the glider is connected to your device. This indicates that you can use your device to control the glider.

SMART CONNECT™ APP

App features and decorations shown in photographs and illustrations may vary.

Touch to customize the glider name.

Touch to start selections (gliding, sounds or music). Touch again to pause.

Touch to decrease gliding speed.

Choose the amount of gliding time.

Touch and drag the button to increase or decrease volume.

Choose how long you'd like music or sound effects to entertain baby.

Touch to connect or disconnect your device from the glider.

Touch to increase gliding speed.

Touch to start settling music that transitions to calming music. Make sure you choose the amount of time for each stage.

Touch a button to choose music or sound effects.

You can save up to two custom settings.

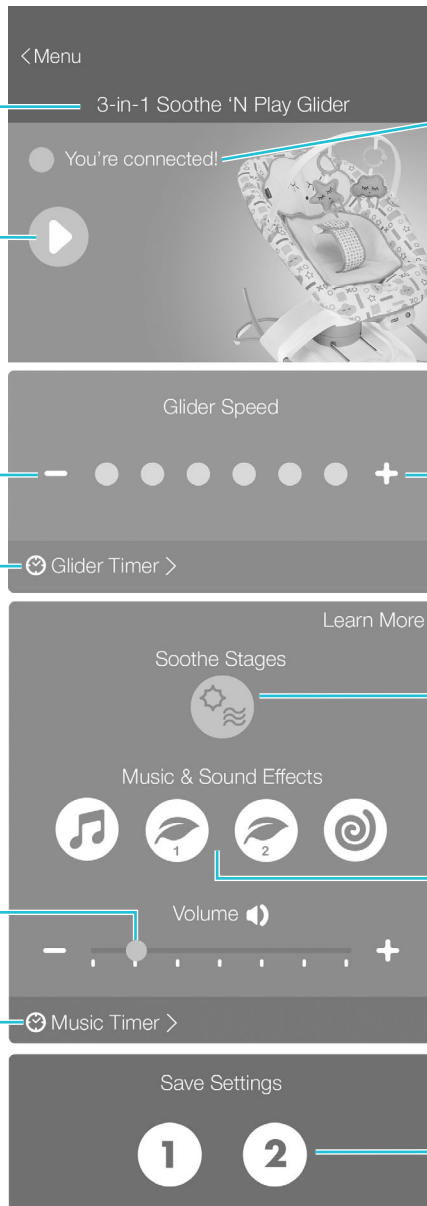

RESTRAINT SYSTEM

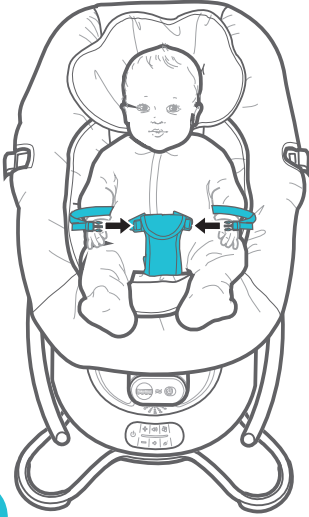

Position the restraint pad between your child's legs and fasten the restraint belts to each side of the restraint pad. **Make sure you hear a "click" on both sides.**

Check to be sure the restraint system is securely attached by pulling it away from your child. The restraint system should remain attached.

Tighten each waist belt so that the restraint system is snug against your child.

1

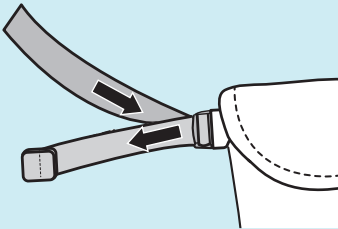

To tighten: Feed the attached end of the restraint belt into the buckle to form a loop. Then, pull the free end of the restraint belt.

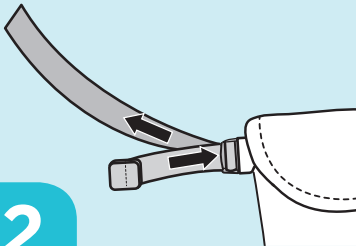

To loosen: Feed the free end of the restraint belt into the buckle to form a loop. Then, pull the anchored end of the restraint belt.

2

GLIDER

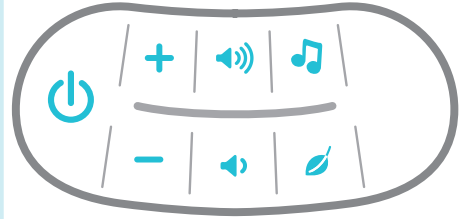
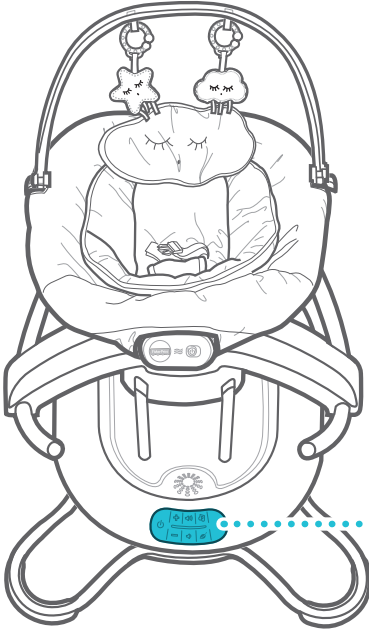

Touch the power button  on the glider base to turn power ON or OFF.

Touch the speed buttons **+** or **-** to select the desired gliding speed or to turn gliding motion off.

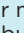
Touch  or  for music or nature sounds. Touch the same button again and again to cycle through music or sounds or to turn music or sounds off.

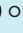
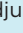
Touch  or  to adjust volume up or down.

If the glider begins to operate erratically, you may need to reset the electronics. Unplug the AC adapter from the glider base and then plug back in again.

3

ROCKER SEAT

Lift to remove the seat from the base to use as a rocker.

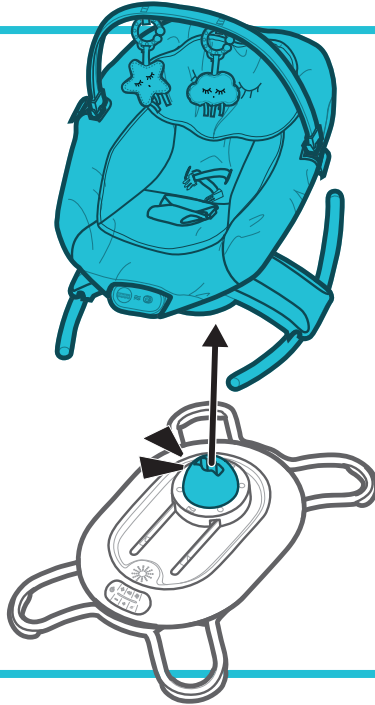

SOOTHING VIBRATIONS



Slide the soother power switch to turn vibrations ON or OFF.

Low battery power or a static charge may cause the soother to operate erratically. If vibration does not turn on or will not turn off, remove and reinstall the battery. If you still experience a problem, replace the battery.

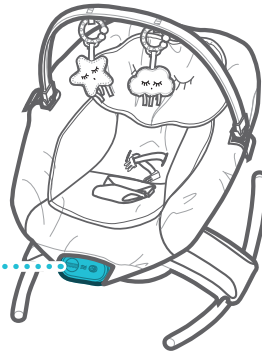

WANT TO SWITCH THE MOTION?

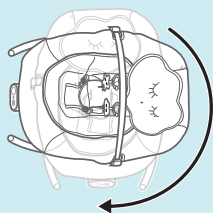

Turn the seat for head-to-toe motion.

1

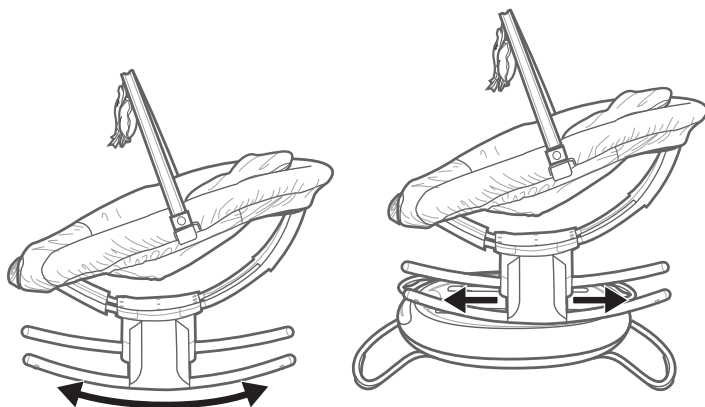

HEAD-TO-TOE

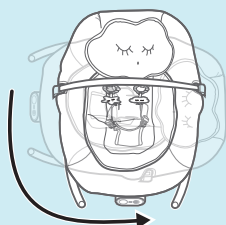

Turn the seat for side-to-side motion.

2

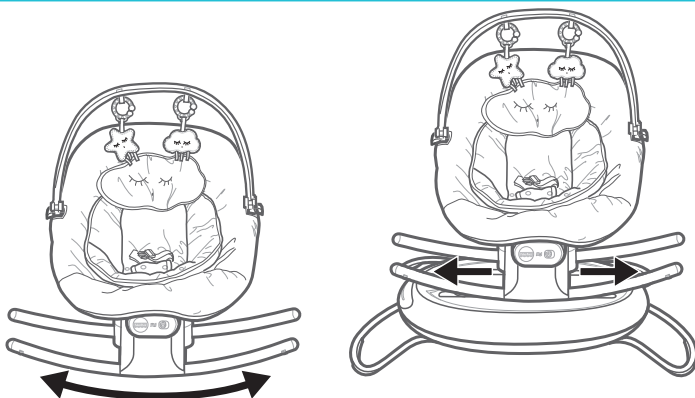

SIDE-TO-SIDE

CARE

The seat pad and body support are machine washable. Wash them separately, with a mild detergent, in cold water and on the gentle cycle. Do not use bleach. Tumble dry separately on low heat and remove promptly.

To remove the pad, unfasten the rear strap buckle on the pad. Pull to remove the pad from around the seat back, soothing unit and the toy bar retainers. Remove the back of the pad from the pegs on the seat back. Lift to remove. Follow the assembly instructions to re-attach the pad.

The frame and toy bar may be wiped clean using a mild cleaning solution and a damp cloth. Do not use bleach. Do not use harsh or abrasive cleaners. Rinse clean with water to remove residue. Do not immerse the frame or toy bar.



Protect the environment by not disposing of this product or any batteries with household waste. This symbol indicates that this product shall not be treated as household waste. Check your local authority for recycling advice and facilities.

AC POWER USE

Adults Note: If you use this product with the AC adapter, periodically examine the AC adapter for damage to the cord, housing or other parts that may result in the risk of fire, electric shock or injury. If the AC adapter is damaged, do not use the product with the AC adapter.

Always use the product where there is adequate ventilation. To prevent overheating, keep the product away from heat sources such as radiators, heat registers, direct sunlight, stoves, amplifiers, or other appliances which produce heat.

Never use extension cords with the AC adapter.

Never use the product near water (ie.: bathtub, sink, laundry tub or wet basement, etc.).

Do not connect to more than the recommended number of power supplies.

The product must only be used with the recommended AC adapter.

Disconnect the AC adapter from the product before cleaning.

GENERAL INFORMATION

FCC STATEMENT (UNITED STATES ONLY)

This equipment has been tested and found to comply with the limits for a Class B digital device, pursuant to Part 15 of the FCC rules. These limits are designed to provide reasonable protection against harmful interference in a residential installation. This equipment generates uses and can radiate radio frequency energy and, if not installed and used in accordance with the instructions, may cause harmful interference to radio communications. However, there is no guarantee that interference will not occur in a particular installation. If this equipment does cause harmful interference to radio or television reception, which can be determined by turning the equipment off and on, the user is encouraged to try to correct the interference by one or more of the following measures:

- Reorient or relocate the receiving antenna.
- Increase the separation between the equipment and receiver.
- Connect the equipment into an outlet on a circuit different from that to which the receiver is connected.
- Consult the dealer or an experienced radio/TV technician for help.

NOTE: Changes or modifications not expressly approved by the manufacturer responsible for compliance could void the user's authority to operate the equipment.

This device complies with Part 15 of the FCC Rules. Operation is subject to the following two conditions: (1) This device may not cause harmful interference, and (2) this device must accept any interference received, including interference that may cause undesired operation.

CAN ICES-3 (B)/NMB-3 (B)

Operation is subject to the following two conditions: (1) this device may not cause interference, and (2) this device must accept any interference, including interference that may cause undesired operation of the device.

L'utilisation de ce dispositif est autorisée seulement aux conditions suivantes : (1) il ne doit pas produire de brouillage et (2) il doit pouvoir tolérer tout brouillage radioélectrique reçu, même si ce brouillage est susceptible de compromettre son fonctionnement.

Battery Safety Information

In exceptional circumstances, batteries may leak fluids that can cause a chemical burn injury or ruin your product. To avoid battery leakage:

Do not mix old and new batteries or batteries of different types: alkaline, standard (carbon-zinc) or rechargeable.

Insert batteries as indicated inside the battery compartment (+ and -).

Remove batteries during long periods of non-use. Always remove exhausted batteries from the product. Dispose of batteries safely. Do not dispose of this product in a fire. The batteries inside may explode or leak.

Never short-circuit the battery terminals.

Use only batteries of the same or equivalent type, as recommended.

Do not charge non-rechargeable batteries.

Remove rechargeable batteries from the product before charging.

If removable, rechargeable batteries are used, they are only to be charged under adult supervision.

**UNITED STATES**

1-800-432-5437. Fisher-Price, Inc.,
636 Girard Avenue, East Aurora, NY 14052.
Hearing-impaired consumers: 1-800-382-7470.

CHILE

Mattel Chile, S.A., Avenida Américo Vespucio
501-B, Quilicura, Santiago. Tel.: 1230-020-6213.

VENEZUELA

Servicio al consumidor Venezuela:
Tel.: 0-800-100-9123.

ARGENTINA

Mattel Argentina, S.A., Av. Libertador 1000,
Piso 11 - Oficinas 109 y 111, Vicente López -
Prov. Buenos Aires. Tel.: 0800-666-3373.

COLOMBIA

Mattel Colombia, S.A., Calle 123#7-07 P.5,
Bogotá. Tel.: 01800-710-2069.

PERÚ

Mattel Perú, S.A., Av. Juan de Arona # 151,
Centro Empresarial Juan de Arona, Torre
C, Piso 7, Oficina 704, San Isidro, Lima 27,
Perú. RUC: 20425853865. Reg. Importador:
02350-12-JUE-DIGESA. Tel.: 0800-54744.

E-mail Latinoamérica:
servicio.clientes@mattel.com.

SOUTH AFRICA

Mattel South Africa (PTY) LTD, Office 102 I3,
30 Melrose Boulevard, Johannesburg 2196.

Apple & the Apple logo are trademarks of Apple Inc.,
registered in the U.S. and other countries. App Store is a service mark of Apple Inc.
Google Play, and the Google Play logo are trademarks of Google LLC.

©2018 Mattel.
GDD39-0970

PRINTED IN CHINA
1102089178-DOM