

# IMAGINE WHAT YOU COULD DO WITH THE TRACK BUILDER SYSTEM!

ADVERTISEMENT



EACH SOLD SEPARATELY. SUBJECT TO AVAILABILITY. COLORS AND DECORATIONS MAY VARY.

FOR MORE EPIC TRACK IDEAS VISIT  
[WWW.HOTWHEELS.COM/TRACKBUILDER](http://WWW.HOTWHEELS.COM/TRACKBUILDER)

©2018 Mattel. Mattel, Inc., 636 Girard Avenue, East Aurora, NY 14052, U.S.A. Consumer Services 1-800-524-8697. Mattel U.K. Ltd., Vanwall Business Park, Maidenhead SL6 4UB. Helpline 01628 500303. Mattel Australia Pty., Ltd., Richmond, Victoria. 3121. Consumer Advisory Service - 1300 135 312. Mattel South Africa (PTY) LTD, Office 102 13, 30 Melrose Boulevard, Johannesburg 2196. Mattel East Asia Ltd., Room 503-09, North Tower, World Finance Centre, Harbour City, Tsimshatsui, HK, China. Tel.: (852) 3185-6500. Diimport & Diedarkan Oleh: Mattel Southeast Asia Pte. Ltd., No 19-1, Tower 3 Avenue 7, Bangsar South City, No 8, Jalan Kerinchi, 59200 Kuala Lumpur, Malaysia. Tel: 03-33419052.

## Hot Wheels TRACK BUILDER SYSTEM

### BUILDER'S GUIDE

FOR EXPERT BUILDERS



WARNING: CHOKING HAZARD - Small parts. Not for children under 3 years.



AGES 6-12

## RACE CRATE

GFV68-0970  
 1102049865-DOM  
[service.mattel.com](http://service.mattel.com)

[HOTWHEELS.COM](http://HOTWHEELS.COM)

PLEASE KEEP THESE INSTRUCTIONS FOR FUTURE REFERENCE AS THEY CONTAIN IMPORTANT INFORMATION.



**FOR EXPERT BUILDERS**

Hey parents check this out! The Track Builder Race Crate is intended for the expert builder. This set is fun for all ages, but younger kids might need support when building this epic toy. You can curb potential frustration AND it's a great way to get started on enriching your child's cognitive and motor skills!

### HOW TO OPEN YOUR BOX:

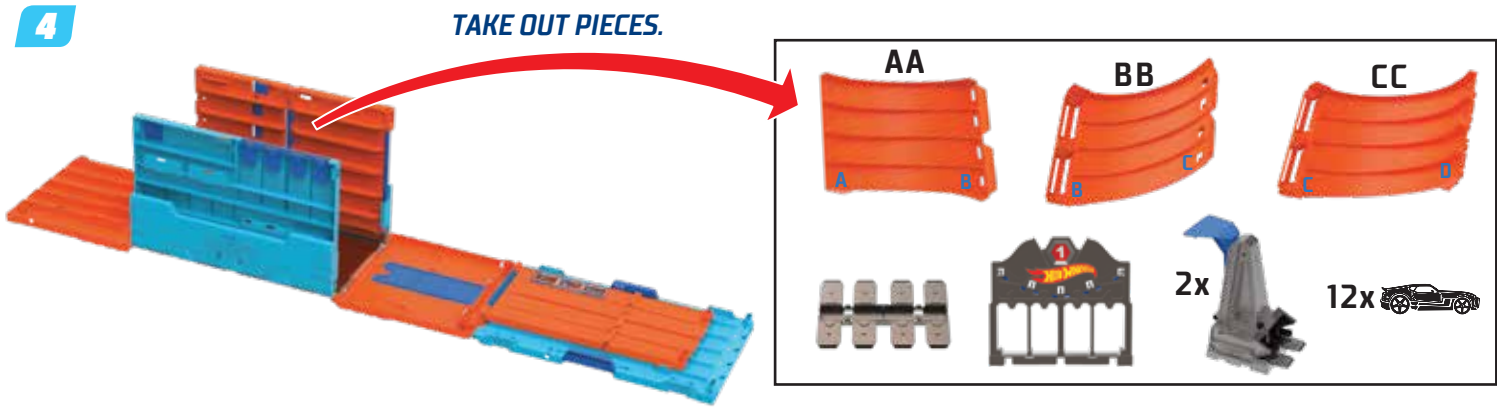
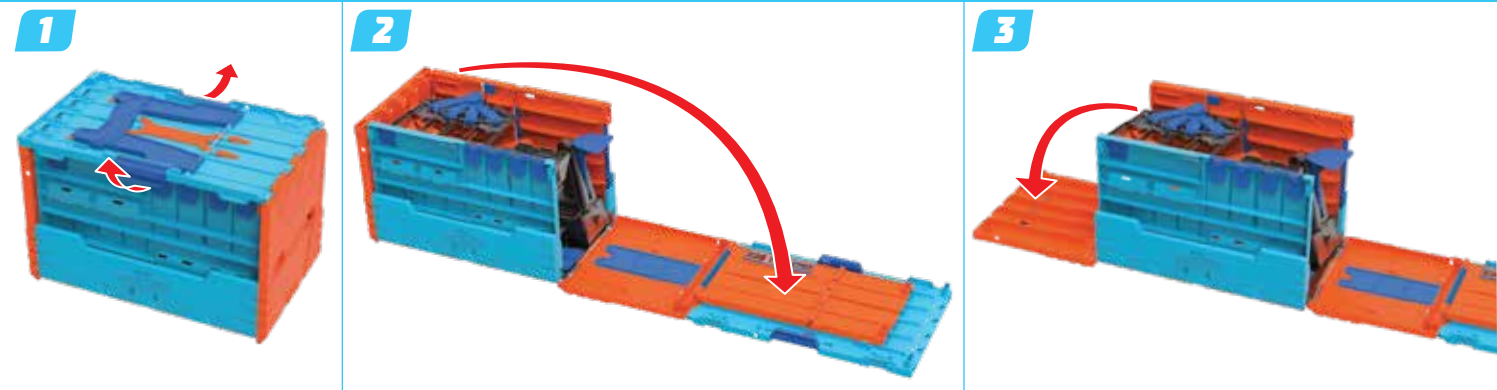

**FOR VIDEO INSTRUCTIONS GO TO:** [www.HotWheels.com/RaceCrate](http://www.HotWheels.com/RaceCrate)

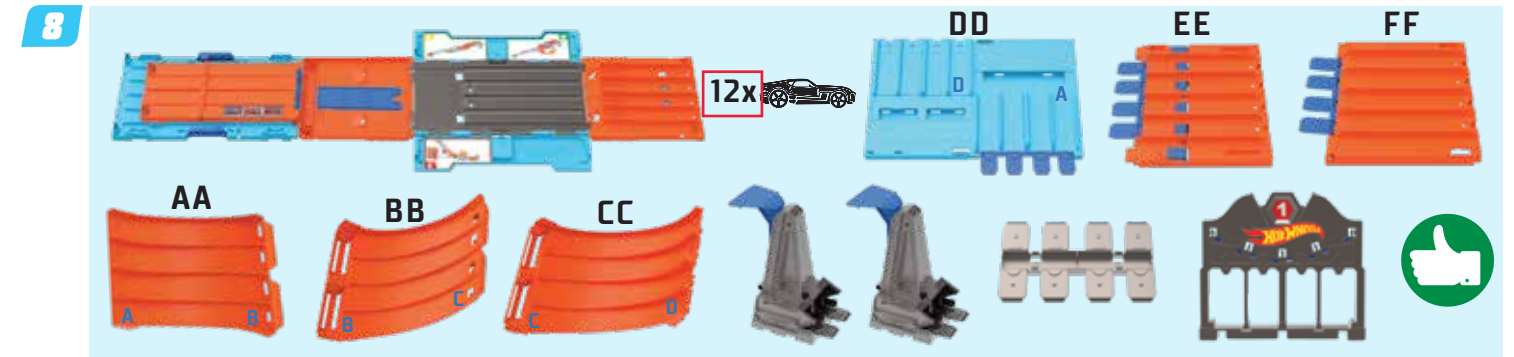
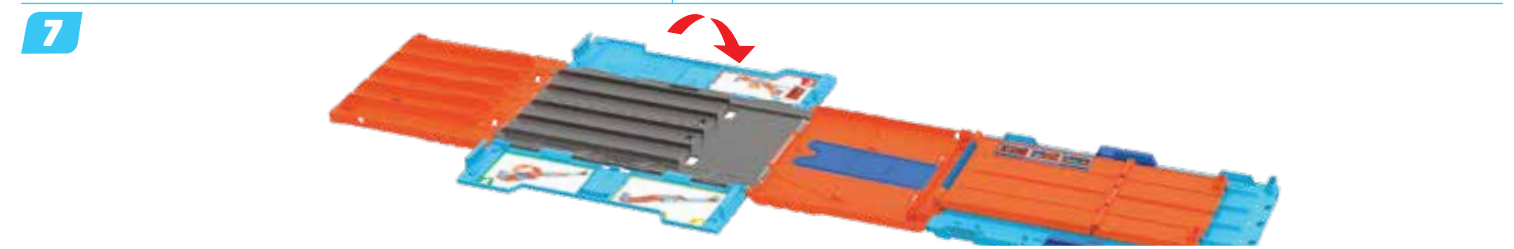
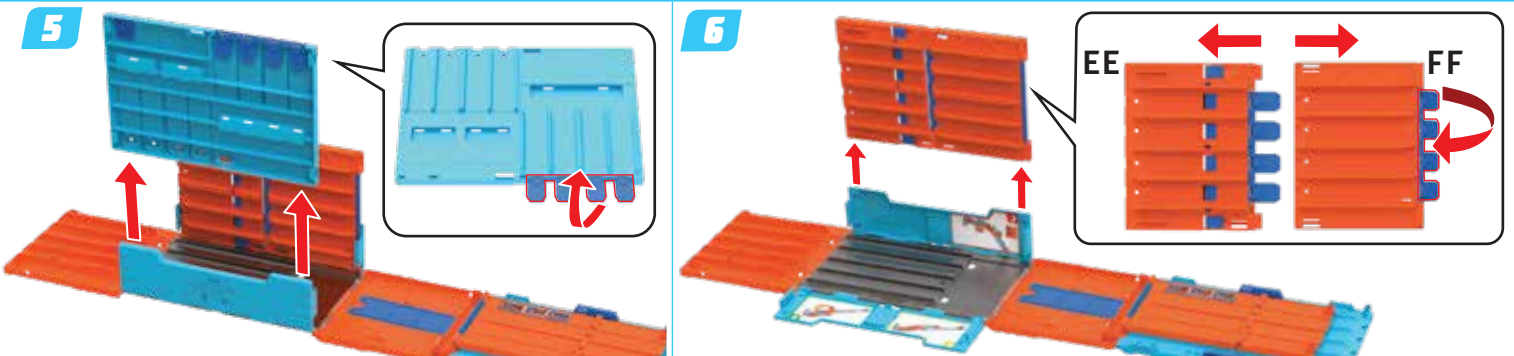

Get your wheels turning with the unlimited world of Track Builder where YOU are in the driving seat. Create your own outrageous stunts, experiment with speed and keep challenging yourself. The world of Track Builder offers endless possibilities and hours of fun where the formula is: CREATE +EXPERIMENT+ REPEAT. Are you ready to test your limits? Challenge Accepted™!

### BUILD THESE FIRST:

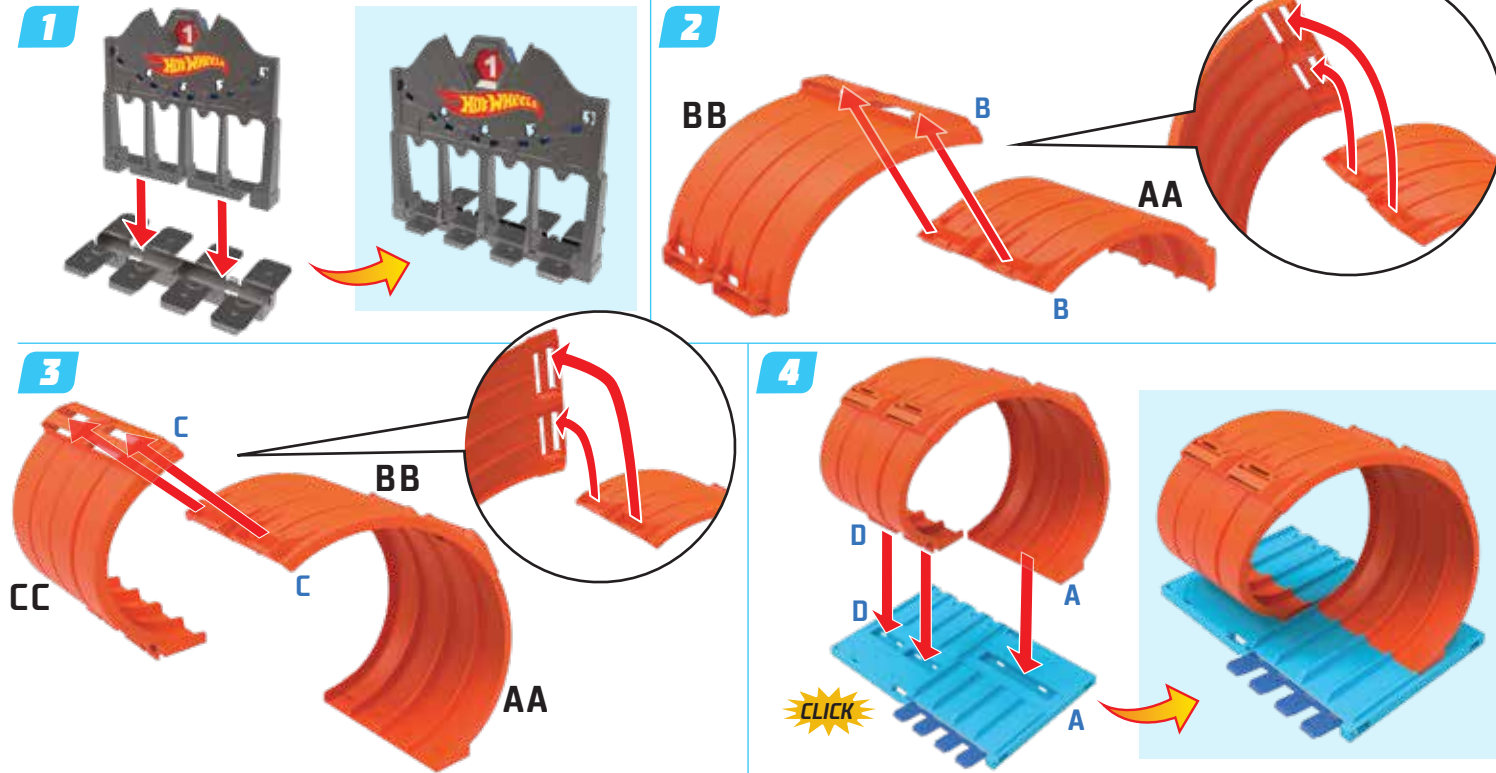

### WHICH 4-LANE RACEWAY WILL YOU CHALLENGE FIRST?

#### BUILD A DRAG RACE

INSTRUCTIONS ON PAGE 6

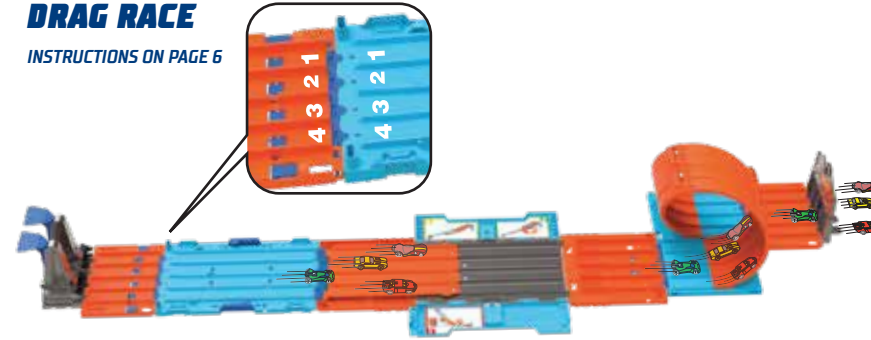

#### BUILD C GRAVITY DROP

INSTRUCTIONS ON PAGE 12

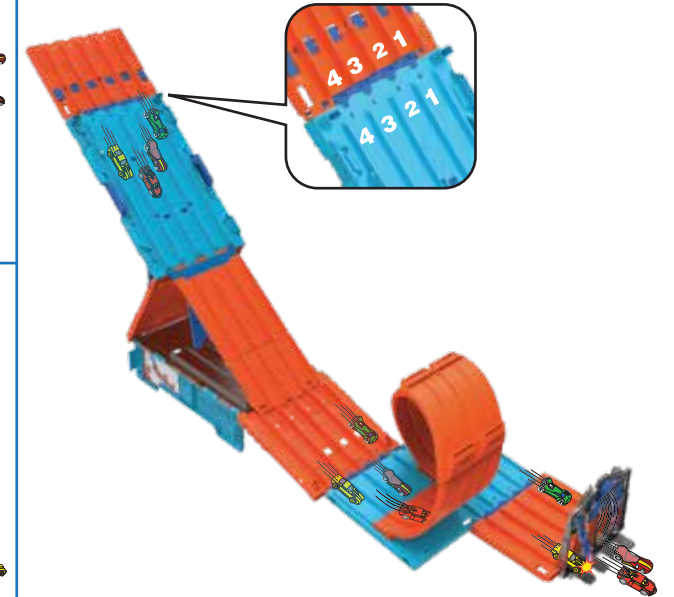

#### BUILD B HILL CLIMB

INSTRUCTIONS ON PAGE 9

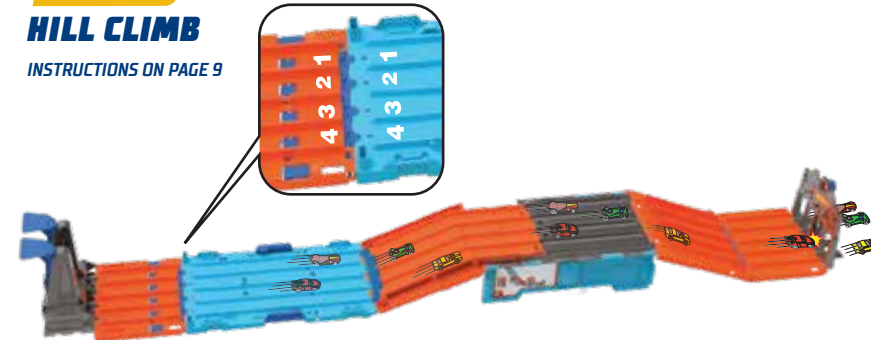

COLORS AND DECORATIONS MAY VARY.  
NOT FOR USE WITH SOME HOT WHEELS® VEHICLES.  
12 VEHICLES INCLUDED. ADDITIONAL VEHICLES SOLD SEPARATELY.

NOTE: FOR BEST PERFORMANCE, PLAY ON LOW PILE CARPET OR HARD SURFACES.



# BUILD A: DRAG RACE

HERE'S WHAT YOU NEED:



## STEP 1

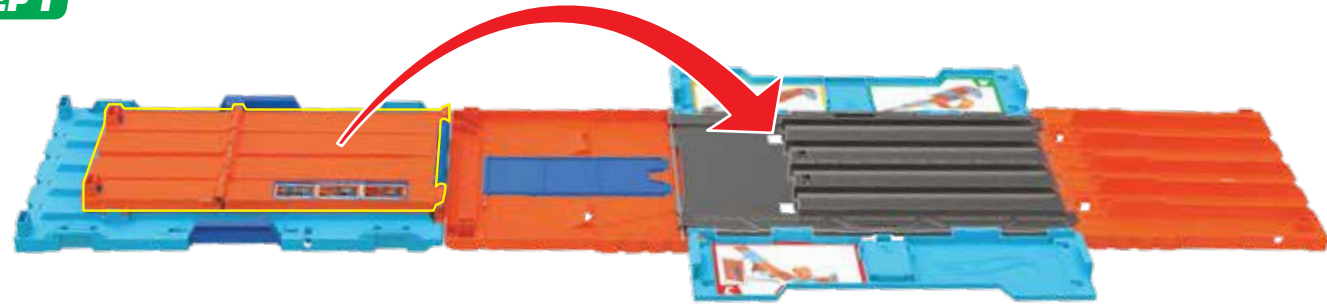

## 2

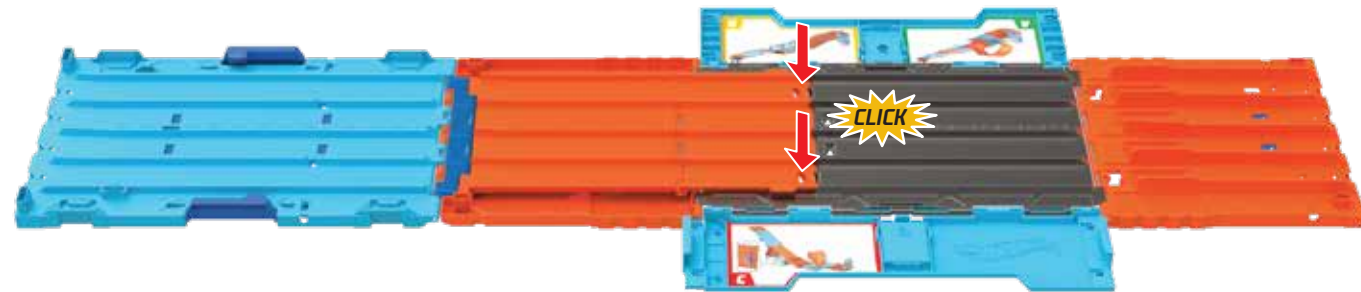

## 3

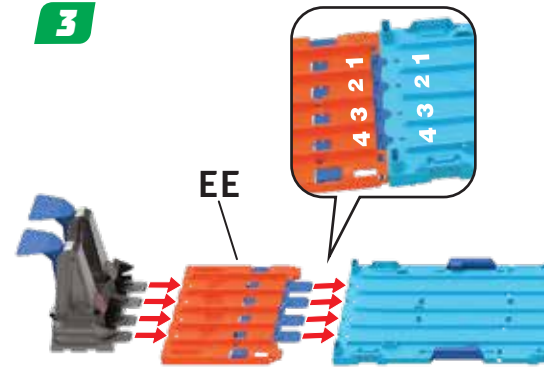

## 4

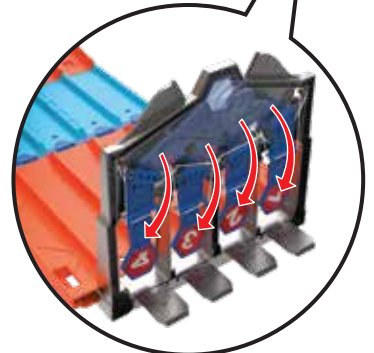
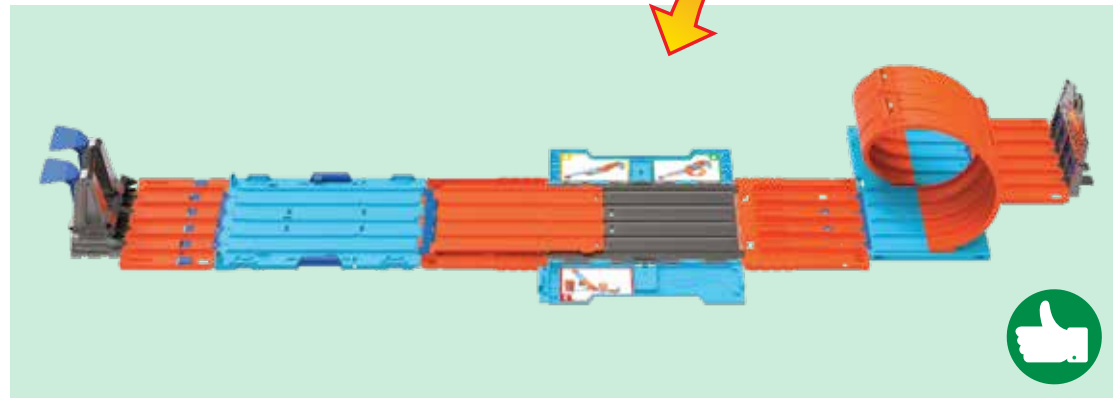
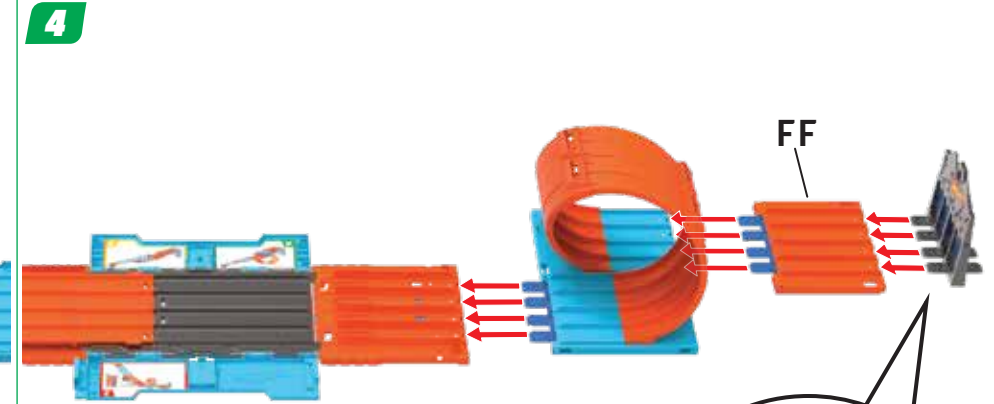

FLIP DOWN FOR EACH RACE.



## NOW GRAB YOUR CAR AND GO!



LOAD YOUR CARS & POUND TO LAUNCH!

**TIP:** INSERT CAR ENTIRELY INTO THE LAUNCHER FOR BEST PERFORMANCE.

 SPEED THROUGH THE LOOPS & CHECK OUT WHO'S THE FIRST TO CROSS THE FINISH LINE!

## BUILD B: HILL CLIMB

HERE'S WHAT YOU NEED:

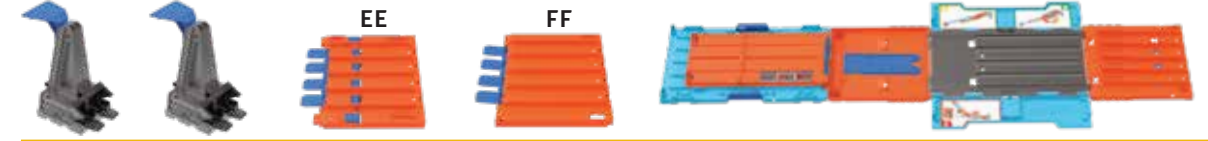

### STEP 1



### 2

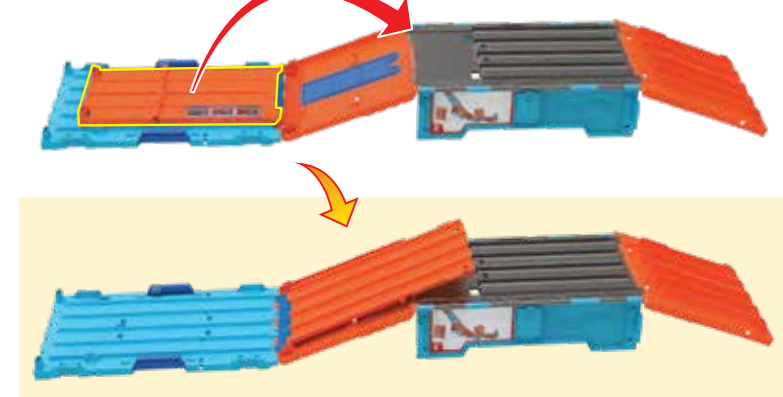

### 3

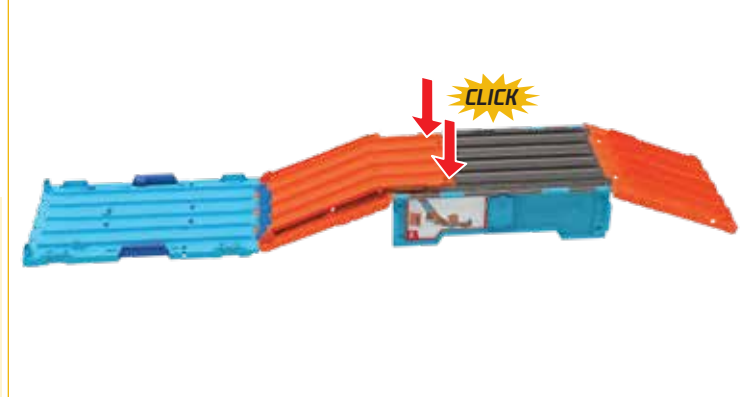

4

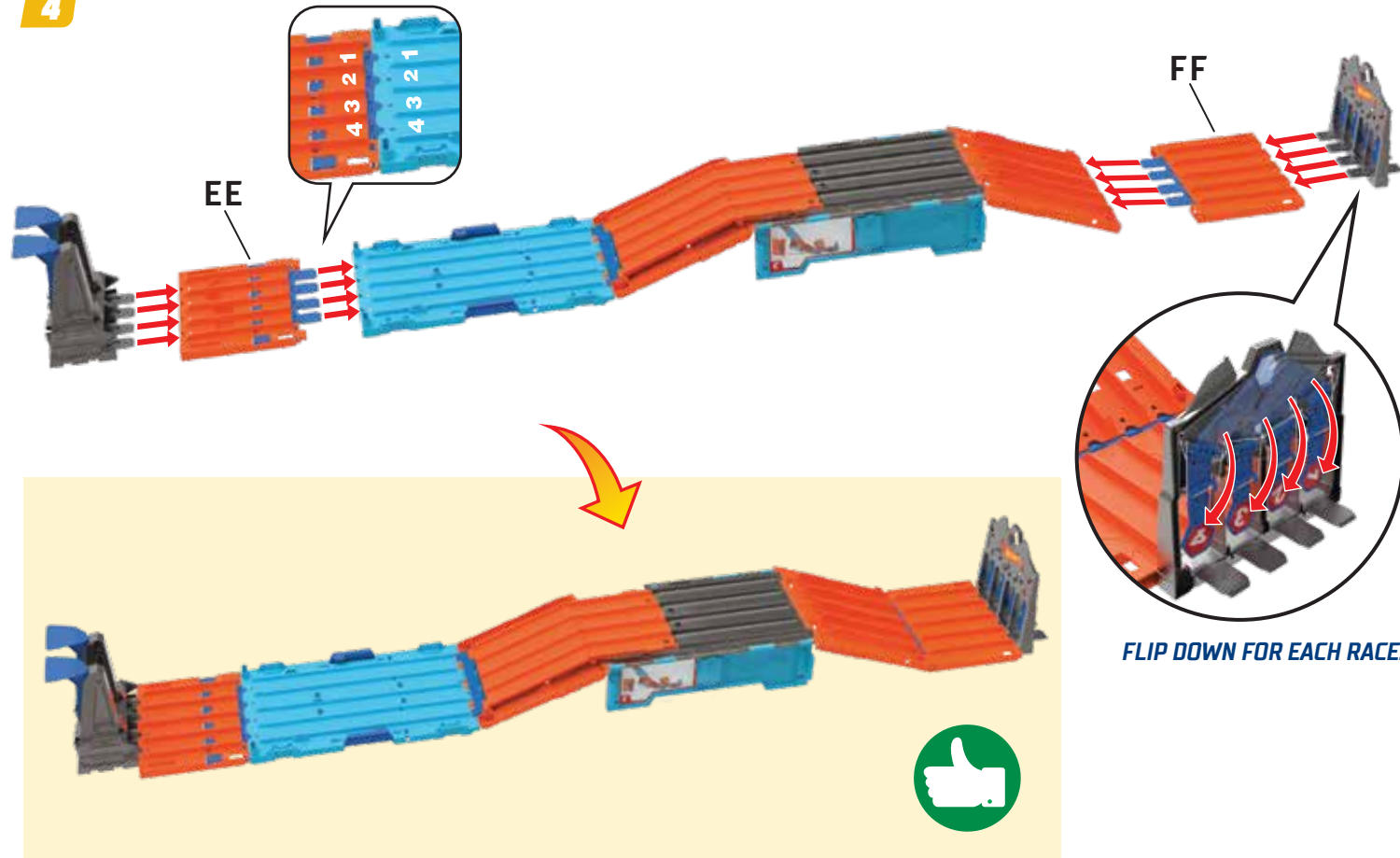

FLIP DOWN FOR EACH RACE.

## NOW GRAB YOUR CAR AND GO!



LOAD YOUR CARS & POUND TO LAUNCH!

**TIP:** INSERT CAR ENTIRELY INTO THE LAUNCHER FOR BEST PERFORMANCE.



RACE UP THE RAMP TO JUMP & NAIL THE LANDING!  
CAN YOU ALL STAY ON TRACK TO THE FINISH LINE?



## BUILD C: GRAVITY DROP

HERE'S WHAT YOU NEED:



REFER TO  
PAGE 4

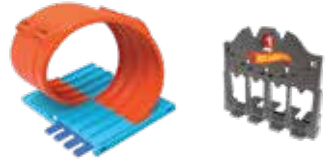

### STEP 1

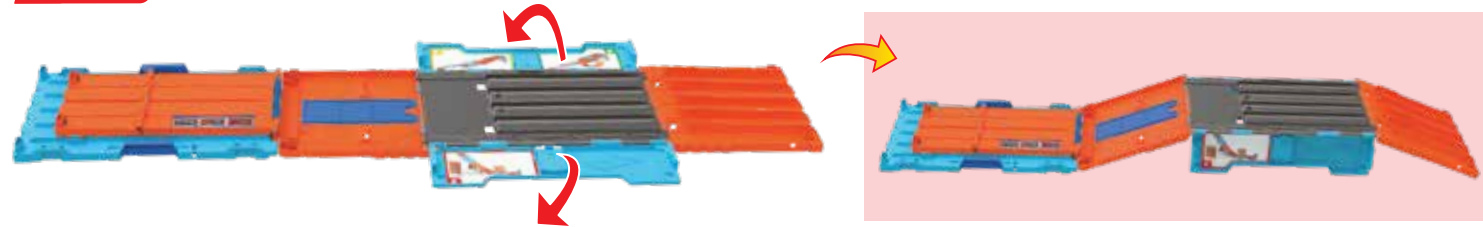

### 2

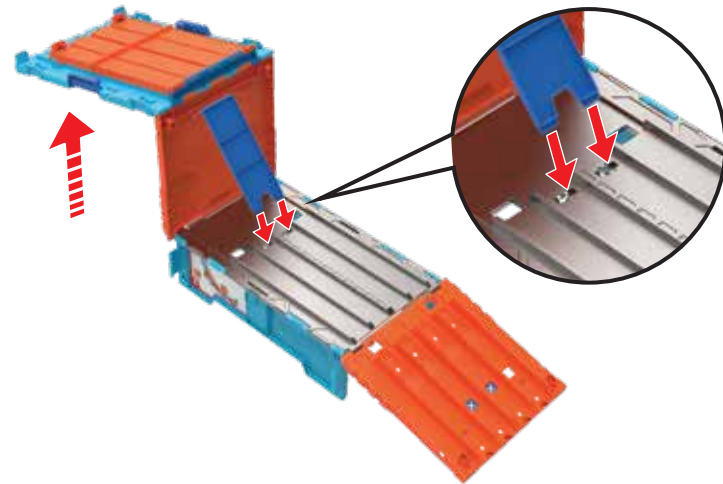

### 3

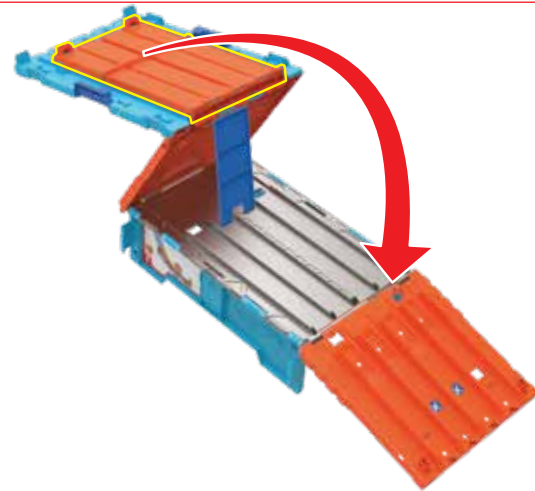

12

### 4



### 5

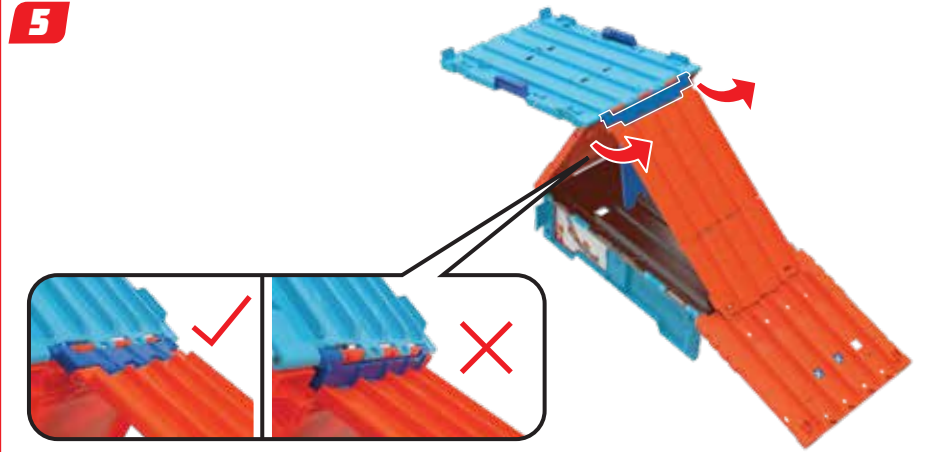

### 6

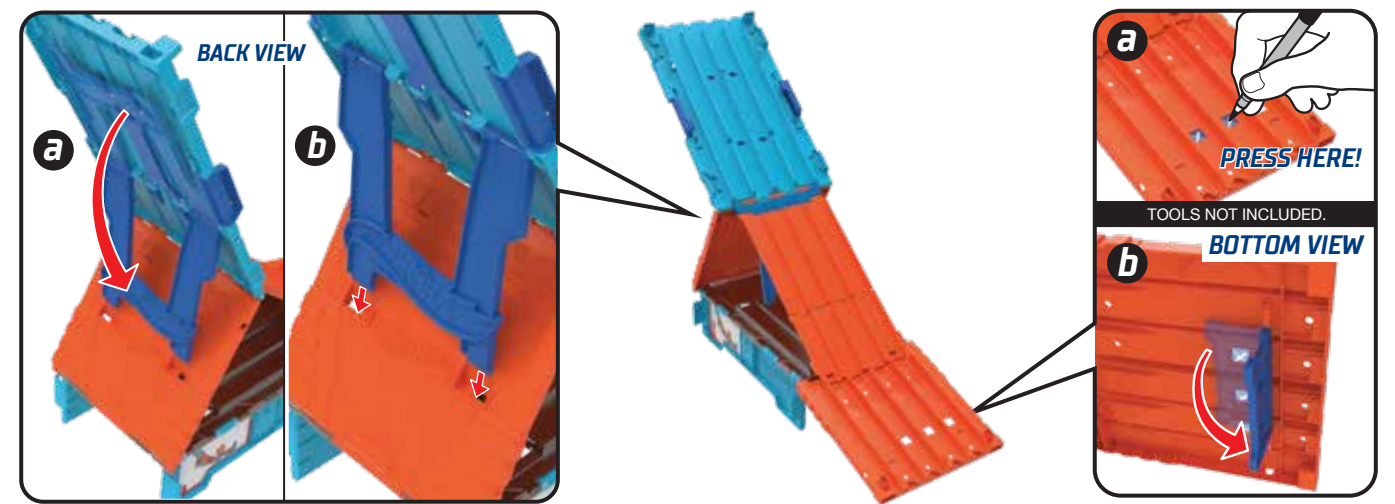

13

7

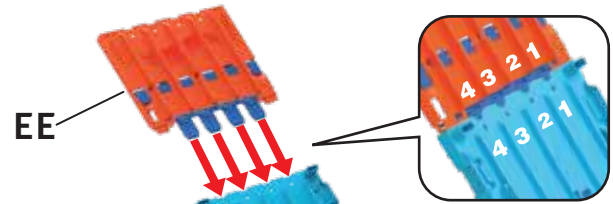

EE

FLIP DOWN FOR EACH RACE.

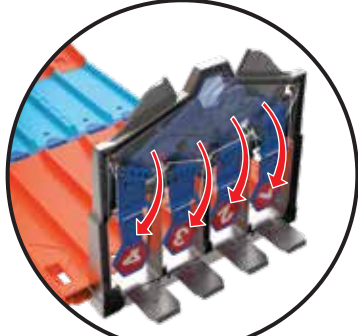

FF

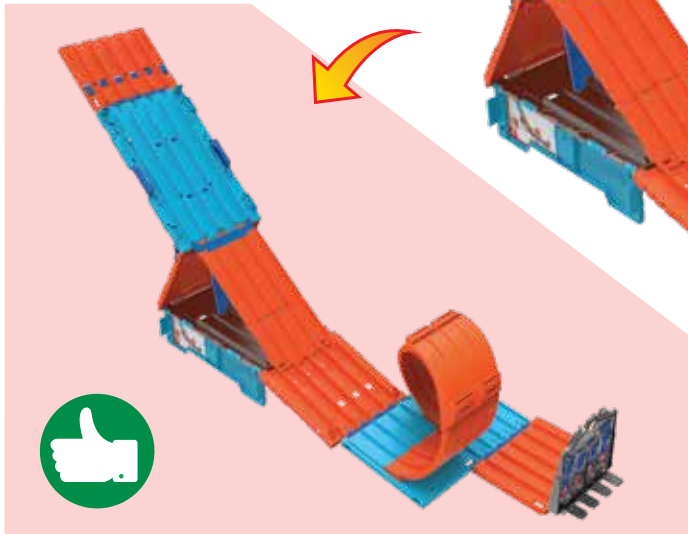

# NOW GRAB YOUR CAR AND GO!

LOAD YOUR CARS & LOWER THE GATE FOR A FAIR START!

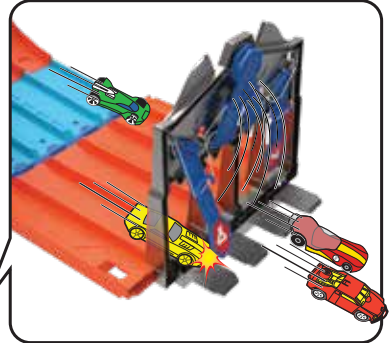

EXPERIENCE THE PULL OF GRAVITY!  
WHO CAN MAKE IT THROUGH THE LOOPS & FINISH THE RACE?



## HOW TO STORE YOUR PIECES:

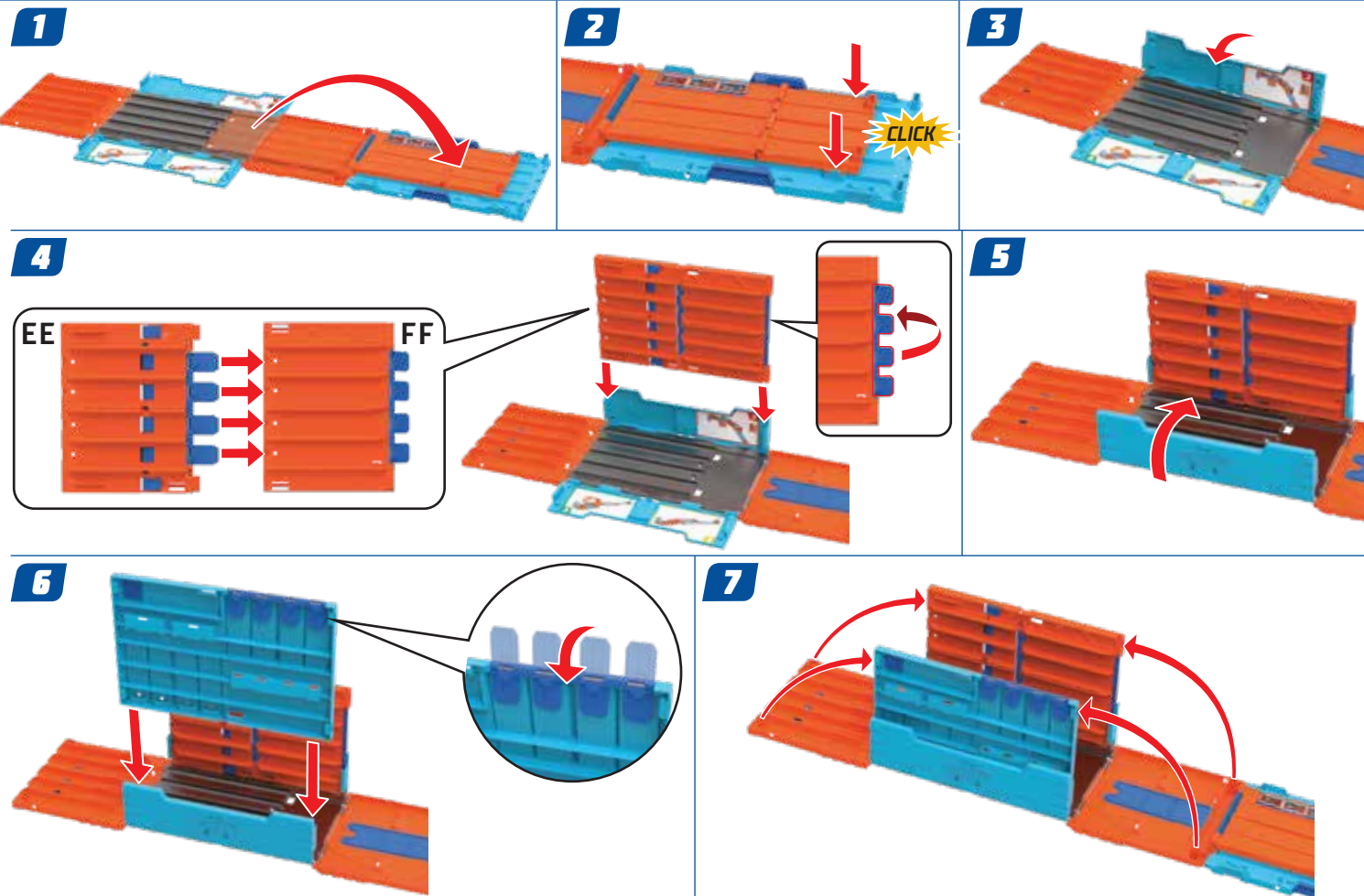

16

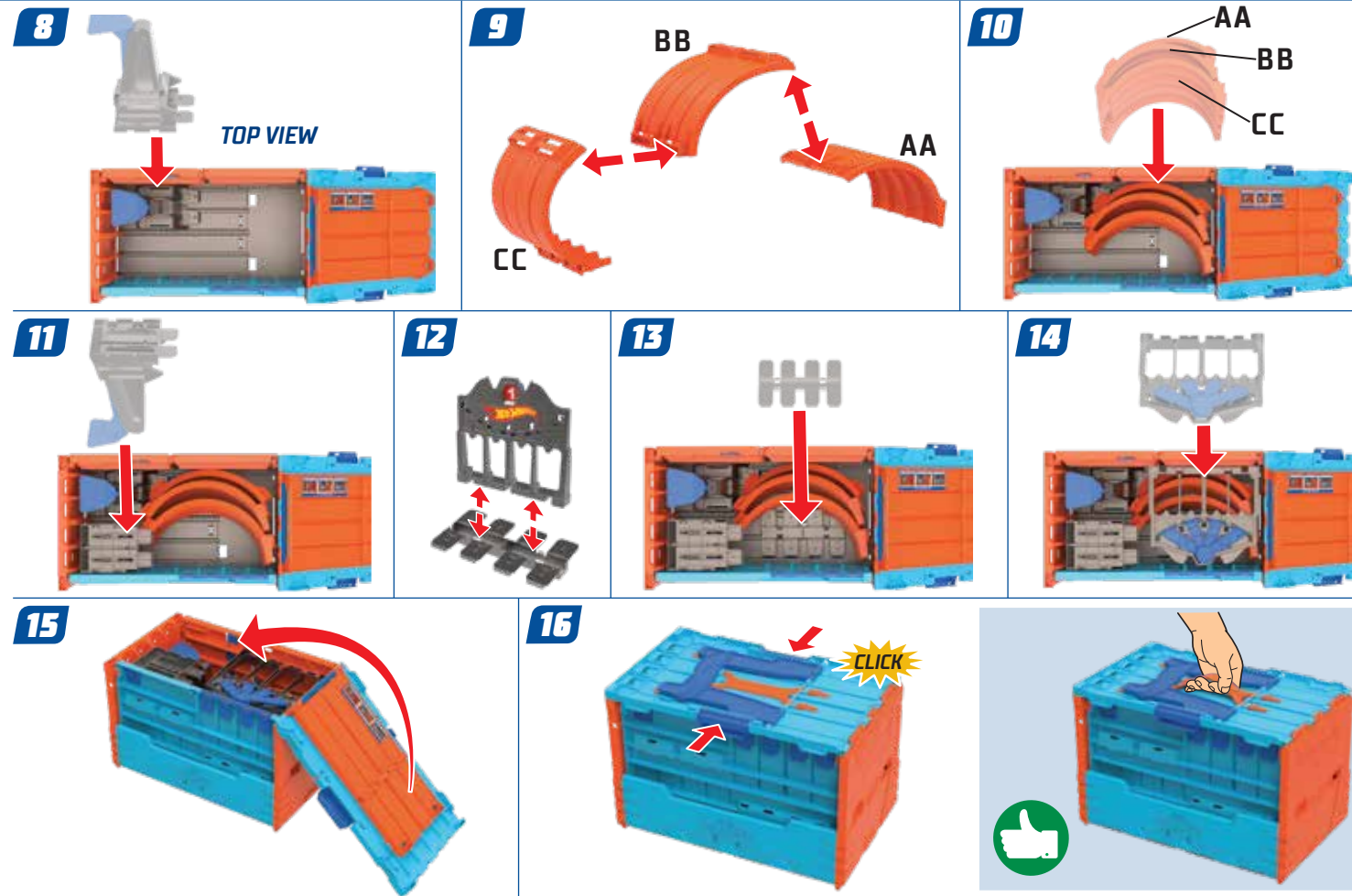

17

## REPLACE RUBBER BAND

FOLLOW THE STEPS IF RUBBER BANDS DETACH.

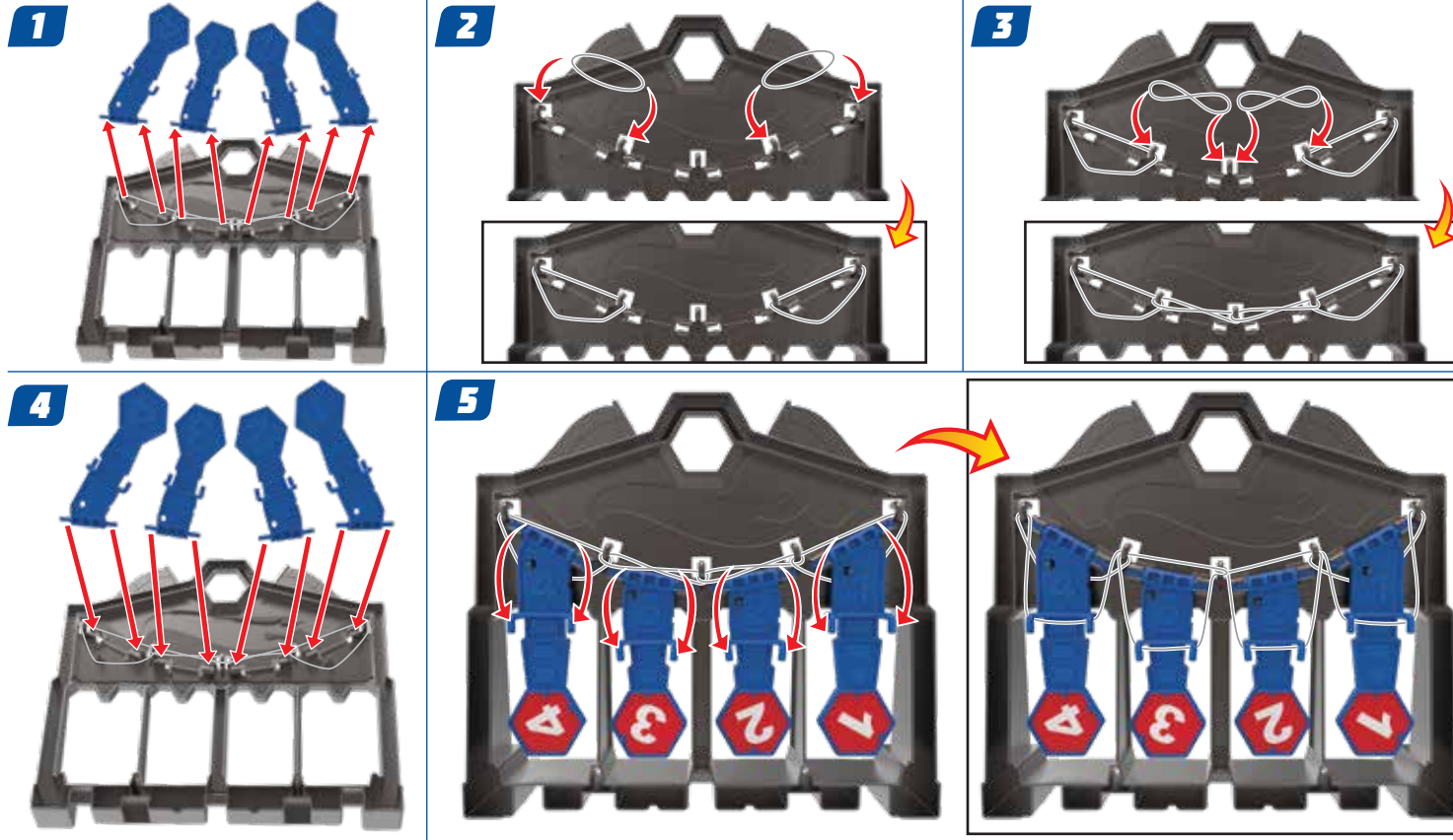



**PARENTS: FOR EPIC TRACK IDEAS, HOW-TO VIDEOS AND AWESOME ENTERTAINMENT, CHECK OUT THE HOT WHEELS® YOUTUBE CHANNEL!**

  
[WWW.YOUTUBE.COM/HOTWHEELS](http://WWW.YOUTUBE.COM/HOTWHEELS)

## HERE'S WHAT ELSE YOU CAN GET:

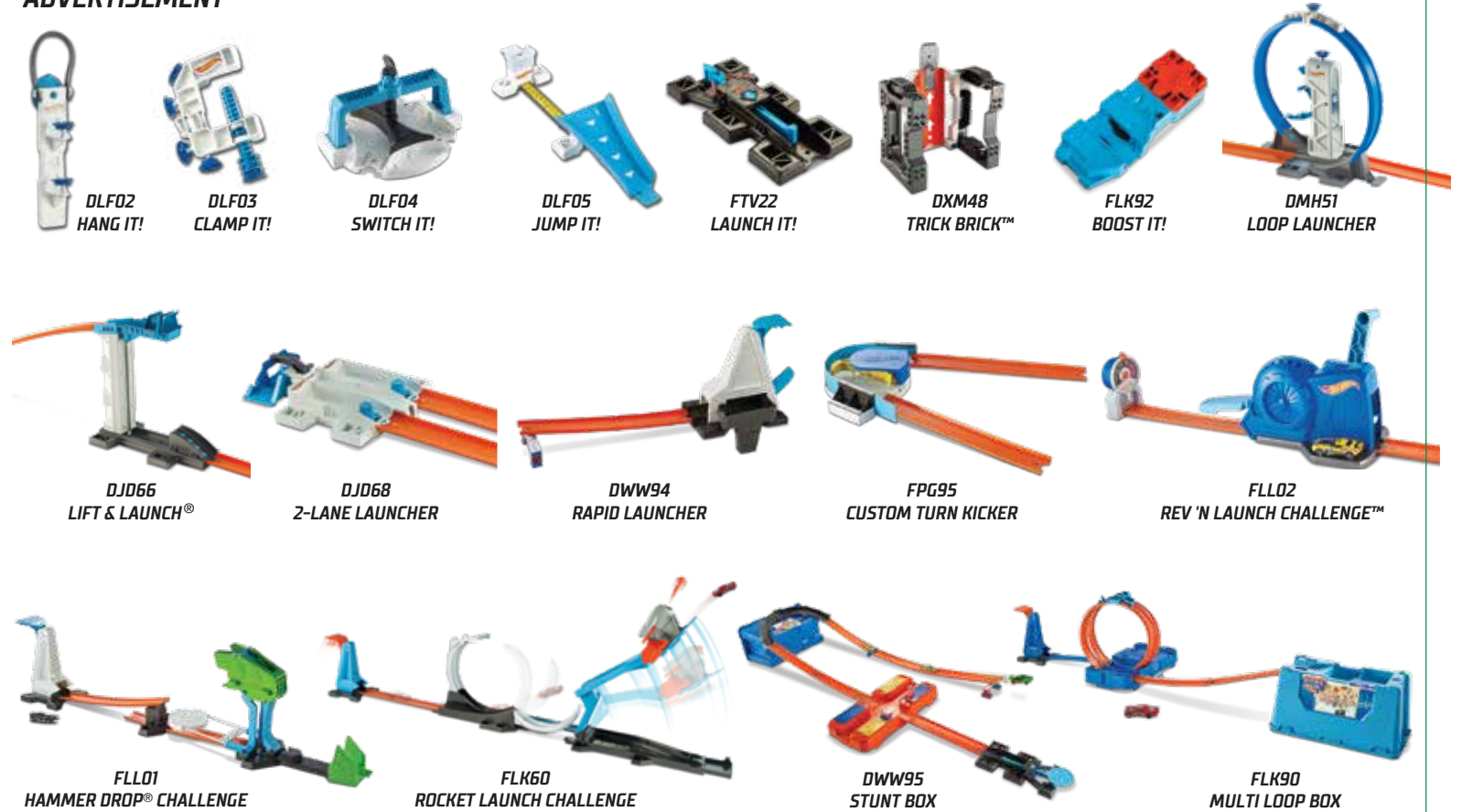
### ADVERTISEMENT



EACH SOLD SEPARATELY, SUBJECT TO AVAILABILITY. COLORS AND DECORATIONS MAY VARY.