

WALL TEMPLATE & ASSEMBLY VERTICAL LAUNCH KIT



Please read all instructions before beginning assembly and set-up.

- Notes:
- Failure to follow instructions carefully may result in damage.
 - DO NOT use on wallpaper, bare wood or porous, unpainted surfaces.
 - DO NOT adhere to dirty, dusty or oily surfaces.
 - DO NOT hang objects over beds.
 - Use indoors 50°F to 105°F (10°C to 40°C).
 - Wait at least 1 day to apply to freshly painted surfaces.
 - Holding capacity increased if the unit is applied less than one hour after the adhesive has been applied.

Read and follow all instructions and warnings carefully before using this product. The manufacturer and distributor shall have no liability for any loss or damage associated with the mis-handling of the product and the adhesive.

AGES 6-12

COMPLETE COMMAND® STRIP APPLICATION GUIDE FIRST!

READ ME FIRST!
COMMAND STRIP APPLICATION GUIDE

To Attach Command® strips on the wall, follow instructions on the Command® Strip Application Guide.

IF YOU COMPLETE ABOVE PORTION, YOU CAN MOVE ON TO PRE-ASSEMBLY STEPS BELOW!

CONTENTS

REFER TO THE MOLDED LETTERS ON PRODUCT PARTS FOR EASY ASSEMBLY.

WALL FRAME BRACKET

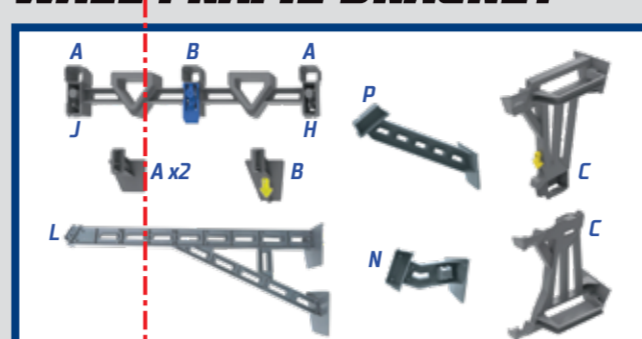

DARING DOUBLE LOOP

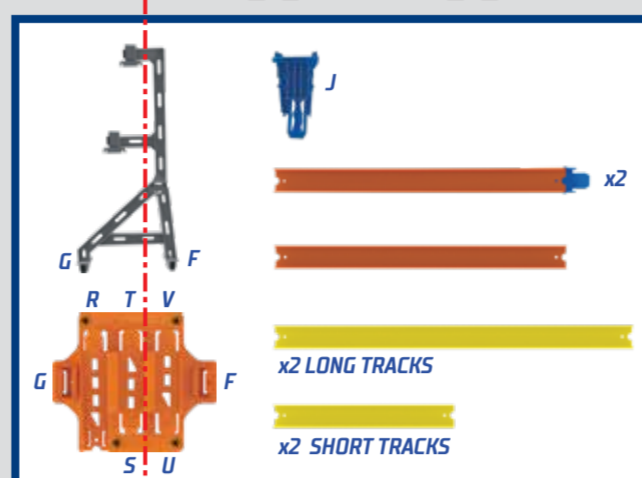

VERTICAL U-TURN



LAUNCH RAMP



SPIRAL DROP



PRE-ASSEMBLY

REFER TO THE MOLDED LETTERS ON PRODUCT PARTS FOR EASY ASSEMBLY.

1 DARING DOUBLE LOOP [x10 parts]

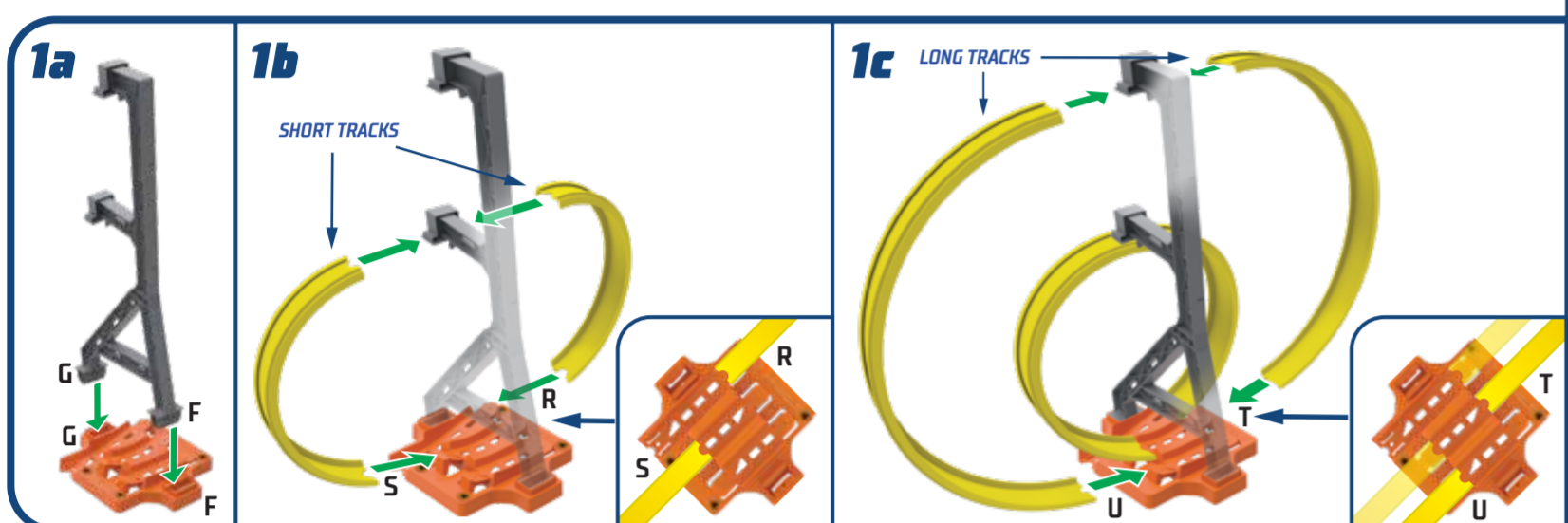

2 LAUNCH RAMP [x10 parts]

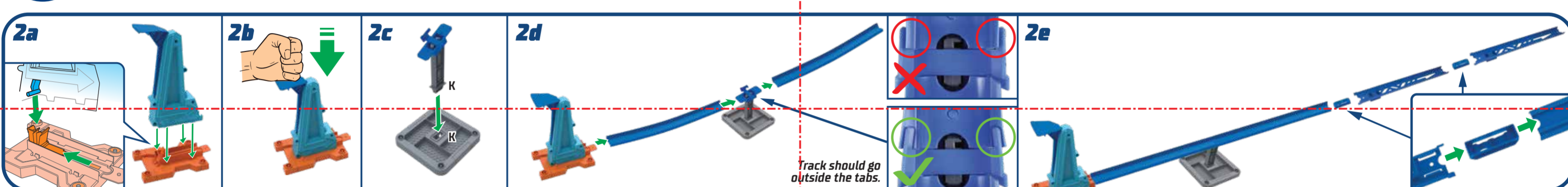

3 SPIRAL DROP [x13 parts]

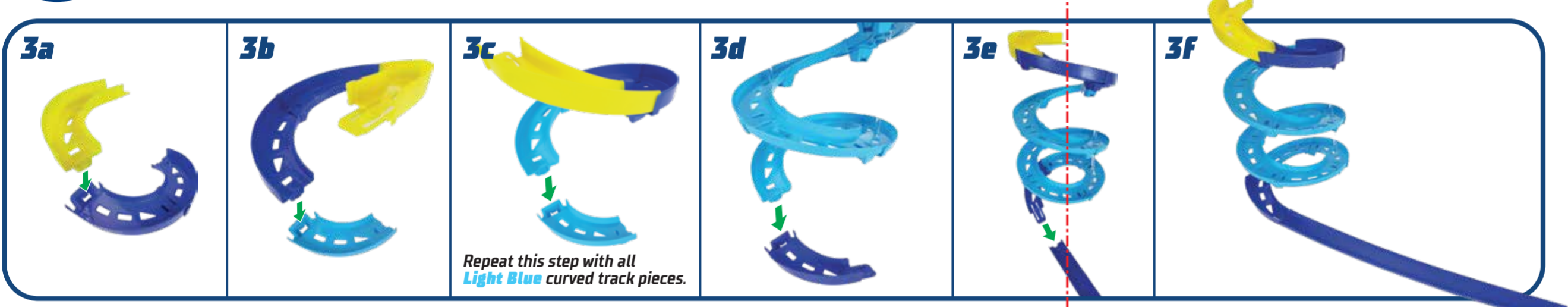

4 WALL FRAME ASSEMBLY

HOW TO USE COMMAND STRIPS.

Mounted with Command STRIPS 3M

Wait for 1 HOUR before attaching wall frames. Line up frames with strips on wall and press until each pair of strips click.

1 HOUR

Have you waited for 1 hour after applying Command® strips? Please do so before proceeding.

FIRST, GATHER THE FOLLOWING 9 PARTS FOR THE WALL FRAME ASSEMBLY.

4A, 4B, 4C, 4D, 4E, 4F, 4G, 4H

NEXT, START ATTACHING THE WALL FRAME PARTS TO THE WALL.

You will need the following 4 parts. Assemble this structure before attaching onto the wall.

4B, 4C, 4D, 4E

TIP: Align 2 ARROWS to ensure parts are properly fixed.

CORRECT vs WRONG

TIP: To Remove Command® Strips

Slowly pull the strip towards you. Never pull the strip towards you! (Never pull towards you!)

FINAL ASSEMBLY

Now let's put it all together.

5 VERTICAL U-TURN

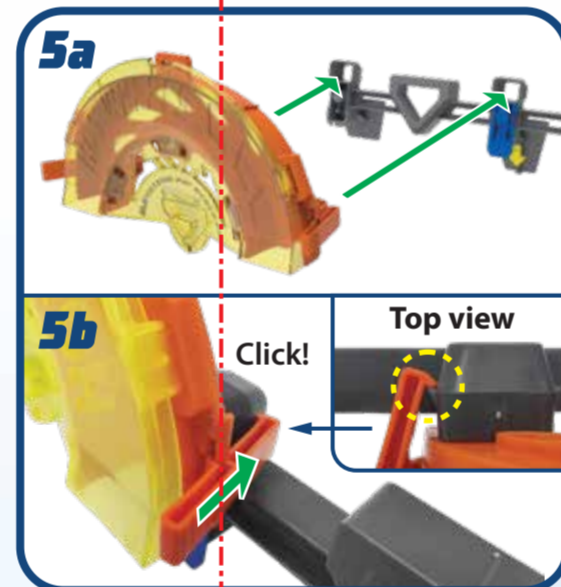

6 DARING DOUBLE LOOP [Pre-assembled]

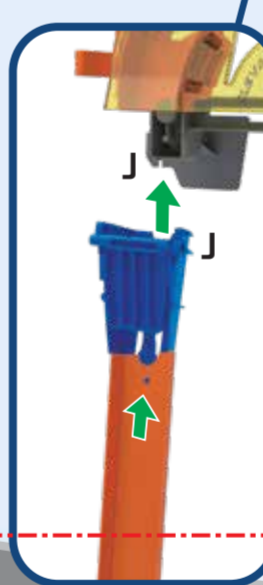

7 SPIRAL DROP

Pre-assembled +



8 LAUNCH RAMP [Pre-assembled]

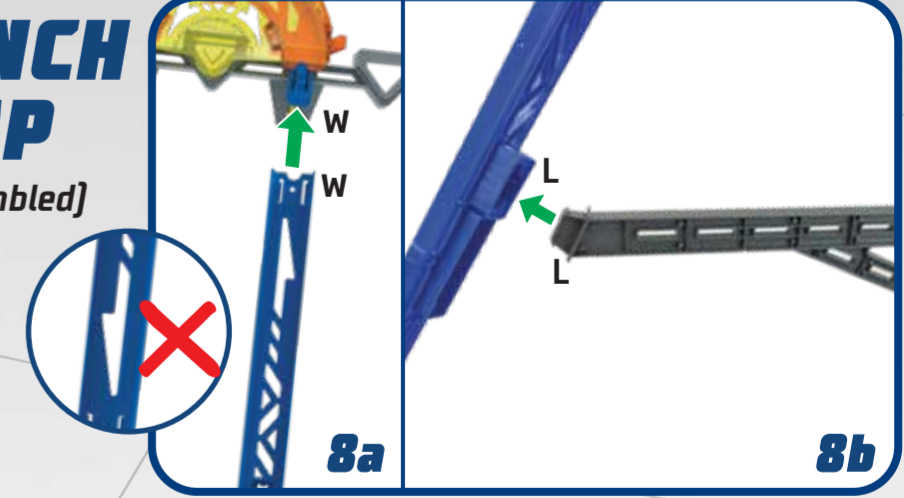

2 WAYS TO PLAY

DETACHING U-TURN

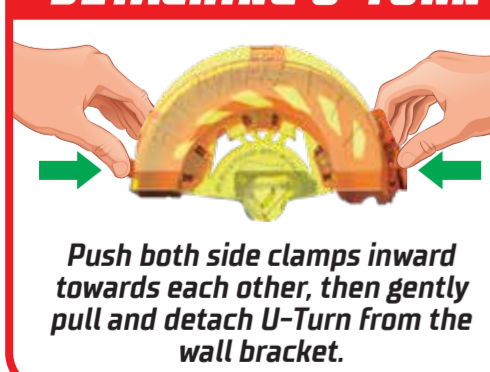

SWITCHING PLAY MODES

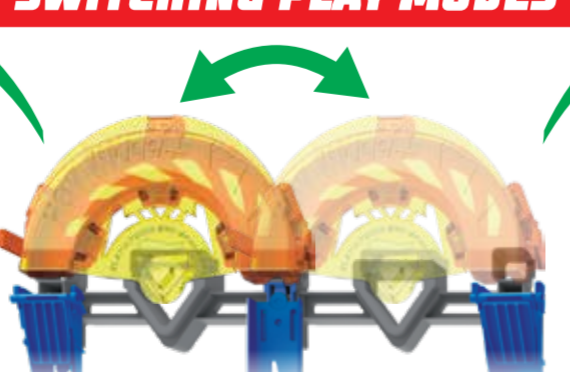

DARING DOUBLE LOOP

SPIRAL DROP

STORAGE

Save space and store away your Vertical Launch Kit when it's not in use.

