

fisher-price®



Keep this instruction sheet for future reference,
as it contains important information.

Adult set up and battery installation are required.
Requires two AA (LR6) **alkaline** batteries (not included).

Tool required for battery installation:
Phillips screwdriver (not included).

GJD41

**UNITED STATES**

Fisher-Price, Inc., 636 Girard Avenue, East Aurora, NY 14052.
Consumer Services: 1-800-432-5437.

CANADA

Mattel Canada Inc., 6155 Freemont Blvd., Mississauga, Ontario L5R 3W2
Consumer Services/Service à la clientèle : 1-800-432-5437.
www.service.mattel.com.

GREAT BRITAIN

Mattel U.K. Limited, The Porter Building, 1 Brunel Way, Slough SL1 1FQ, UK.
www.service.mattel.com/uk.

NEDERLAND

Mattel Europa B.V., Gondel 1, 1186 MJ Amstelveen, Nederland.

AUSTRALIA

Mattel Australia Pty. Ltd., 658 Church Street, Locked Bag #870, Richmond, Victoria 3121 Australia.
Consumer Advisory Service 1300 135 312.

NEW ZEALAND

16-18 William Pickering Drive, Albany 1331, Auckland.

SOUTH AFRICA

Mattel South Africa (PTY) LTD, Office 102 I3, 30 Melrose Boulevard, Johannesburg 2196.

FCC STATEMENT (UNITED STATES ONLY)

This equipment has been tested and found to comply with the limits for a Class B digital device, pursuant to Part 15 of the FCC rules. These limits are designed to provide reasonable protection against harmful interference in a residential installation. This equipment generates uses and can radiate radio frequency energy and, if not installed and used in accordance with the instructions, may cause harmful interference to radio communications. However, there is no guarantee that interference will not occur in a particular installation. If this equipment does cause harmful interference to radio or television reception, which can be determined by turning the equipment off and on, the user is encouraged to try to correct the interference by one or more of the following measures:

- Reorient or relocate the receiving antenna.
- Increase the separation between the equipment and receiver.
- Consult the dealer or an experienced radio/TV technician for help.

NOTE: Changes or modifications not expressly approved by the manufacturer responsible for compliance could void the user's authority to operate the equipment.

This device complies with Part 15 of the FCC Rules. Operation is subject to the following two conditions: (1) This device may not cause harmful interference, and (2) this device must accept any interference received, including interference that may cause undesired operation.

CAN ICES-3 (B)/NMB-3 (B)

Operation is subject to the following two conditions:

(1) this device may not cause interference, and (2) this device must accept any interference, including interference that may cause undesired operation of the device.

L'utilisation de ce dispositif est autorisée seulement aux conditions suivantes : (1) il ne doit pas produire de brouillage et (2) il doit pouvoir tolérer tout brouillage radioélectrique reçu, même si ce brouillage est susceptible de compromettre son fonctionnement.

©2020 Mattel.
PRINTED IN CHINA
GJD41-0970-1102329020-DOM



Install Batteries



For longer life, use **alkaline** batteries.



Loosen the screw in the battery compartment door and remove the door.

Insert two, new AA (LR6) **alkaline** batteries.

Replace the battery compartment door and tighten the screw. Do not over-tighten.

If the truck begins to operate erratically, you may need to reset the electronics. Slide the power-mode switch off and back on.

When sounds or lights become faint or stop, it's time for an adult to change the batteries.

A Cone for the Road!

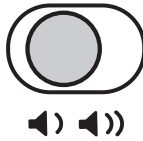
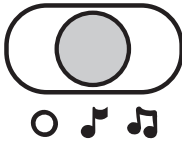

Slide the power-mode switch to ON in **short play mode** 🎵, ON in **long play mode** 🎵 or OFF ○.

In **short play mode** 🎵, shake or push along the truck for fun sound effects, musical ditties, and colorful lights.

In **long play mode** 🎵, shake or push the truck to start approximately 25 minutes of music and lights. Shake the truck again to activate sound effects.

To control the volume, slide the volume switch to **low volume** 🔊 or **high volume** 🔊).

Activity City Gym Setup

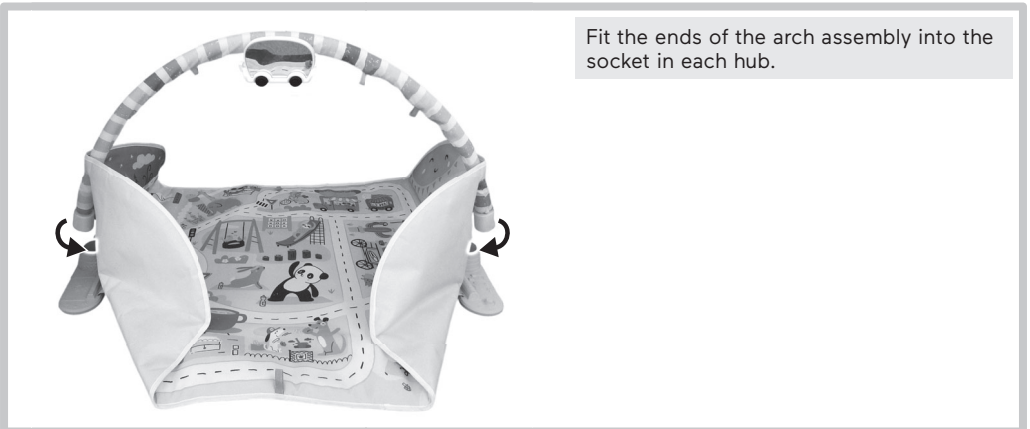
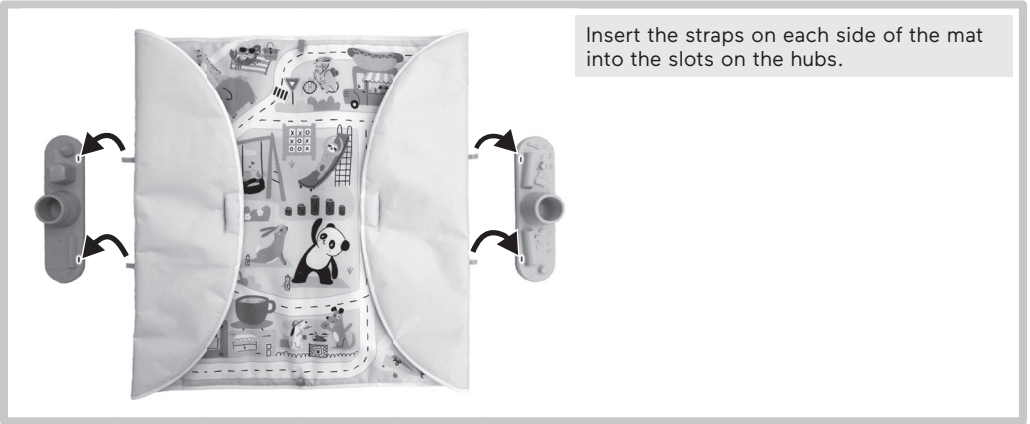

Lay & Play Cityscape

Remove the toys from the arch and place on the mat for tummy-time fun!

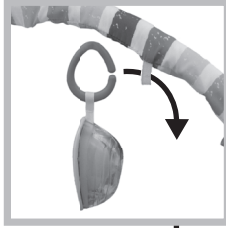
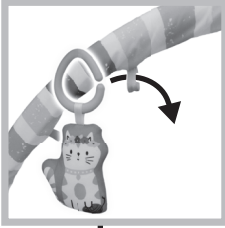

⚠ WARNING

To prevent entanglement injury, never place the gym in a crib or playpen. Never add strings, ties or other products to the gym.

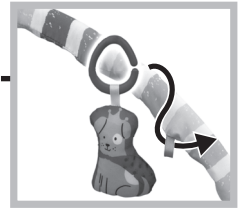
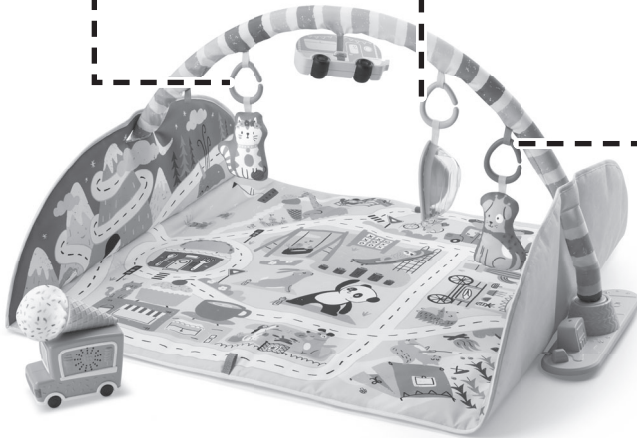

Room-to-Vroom Play Mat

Remove the toys from the arch, the arch from the hubs and the hubs from the mat.

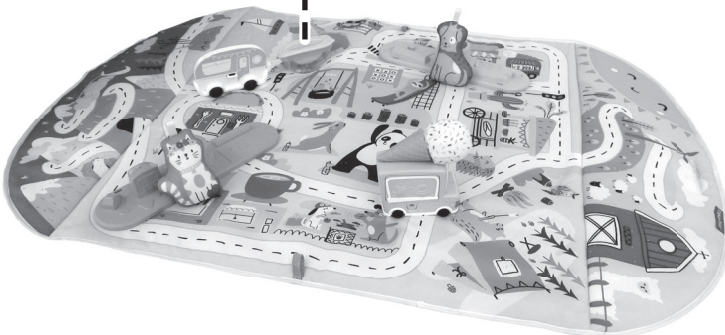
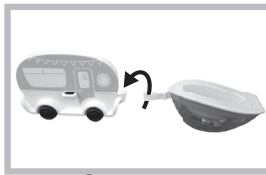

Care

The mat is machine washable without the arch assembly.

Follow the setup instructions to remove the mat from the arch assembly and hubs.

Place the cat and dog toys into a pillowcase before placing them into the washing machine with the mat. Use a mild detergent and cold water on the gentle cycle. Do not use bleach. Tumble dry on low heat.

The arch assembly and the ice cream truck are surface washable only. Wipe with a clean cloth dampened with a mild soap and water solution. Do not immerse.

Battery Safety Information

In exceptional circumstances, batteries may leak fluids that can cause a chemical burn injury or ruin your product. To avoid battery leakage:

- Do not mix old and new batteries or batteries of different types: alkaline, standard (carbon-zinc) or rechargeable.
- Insert batteries as indicated inside the battery compartment (+ and -).
- Remove batteries during long periods of non-use. Always remove exhausted batteries from the product. Dispose of batteries safely. Do not dispose of this product in a fire. The batteries inside may explode or leak.
- Never short-circuit the battery terminals.
- Use only batteries of the same or equivalent type, as recommended.
- Do not charge non-rechargeable batteries.
- Remove rechargeable batteries from the product before charging.
- If removable, rechargeable batteries are used, they are only to be charged under adult supervision.



Protect the environment by not disposing of this product or any batteries with household waste. This symbol indicates that this product shall not be treated as household waste. Check your local authority for recycling advice and facilities.