

4 TO PLAY

1. LOAD BOTH VEHICLES ONTO THE TRACK.



2. PUSH LEVER FORWARD TO LOCK LAUNCHER.



3. PLACE INSTRUCTION SHEET NEXT TO TROPHY CUP FOR A MEASUREMENT REFERENCE GUIDE.

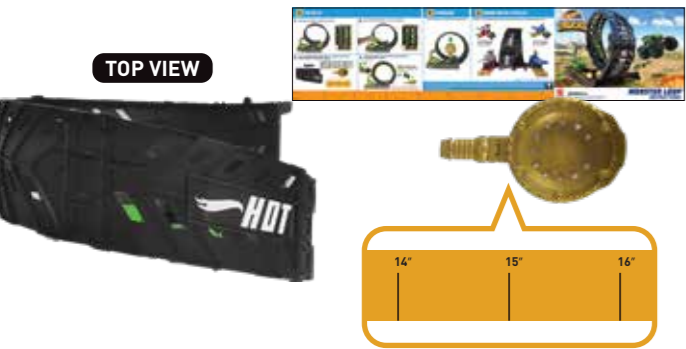

4. PRESS BUTTON TO LAUNCH AND RACE THROUGH THE MONSTER LOOP™!

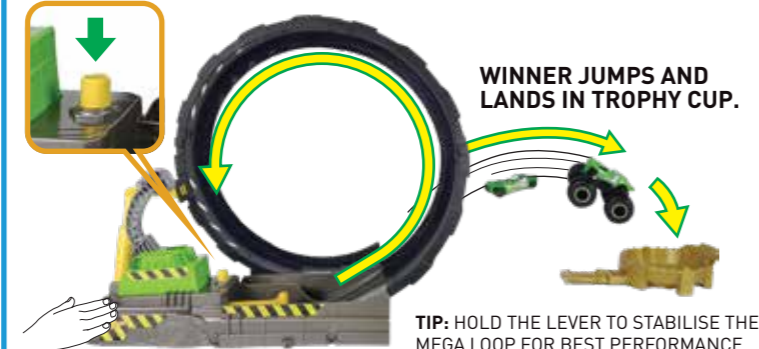

5 STORAGE

ATTACH TROPHY CUP INSIDE THE MONSTER LOOP™.

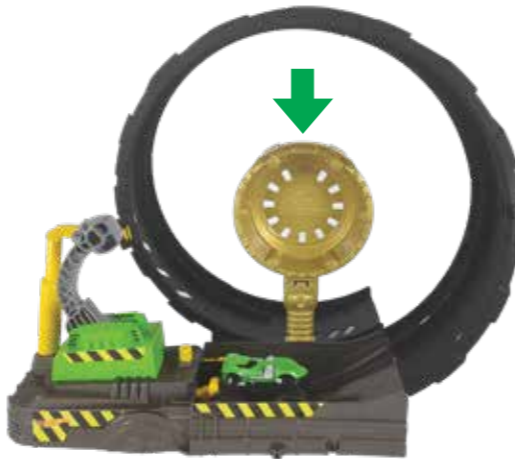

6 MORE WAYS TO PLAY

CONNECT TO OTHER MONSTER TRUCKS LAUNCHERS AND RACE IN DIFFERENT DIRECTIONS!



ADDITIONAL SETS SOLD SEPARATELY SUBJECT TO AVAILABILITY.



AGES 4-8

©2019 Mattel. Mattel, Inc., 636 Girard Avenue, East Aurora, NY 14052, U.S.A. Consumer Services 1-800-524-8697. Mattel U.K. Ltd., Vanwall Business Park, Maidenhead SL6 4UB. Helpline 01628 500303. Mattel Australia Pty., Ltd., Richmond, Victoria. 3121. Consumer Advisory Service - 1300 135 312. Mattel South Africa (PTY) LTD, Office 102 I3, 30 Melrose Boulevard, Johannesburg 2196. Mattel East Asia Ltd., Room 503-09, North Tower, World Finance Centre, Harbour City, Tsimshatsui, HK, China. Tel.: (852) 3185-6500. Diimport & Diedarkan Oleh: Mattel Southeast Asia Pte. Ltd., No 19-1, Tower 3 Avenue 7, Bangsar South City, No 8, Jalan Kerinchi, 59200 Kuala Lumpur, Malaysia. Tel: 03-33419052.



HOTWHEELS.COM

GKY00-0970
1102195253-DOM

Colors and decorations may vary. Not for use with some Hot Wheels® vehicles. Two vehicles included. Additional vehicles sold separately. Please keep these instructions for future reference as they contain important information.

MONSTER LOOP™ INSTRUCTIONS

WELCOME!

Thank you for purchasing **Monster Trucks - Monster Loop**. This amazing track set lets you race your favourite Hot Wheels® cars against the powerful Hot Wheels® Monster Trucks. **Who will win?**

1 HERE'S WHAT YOU GET!

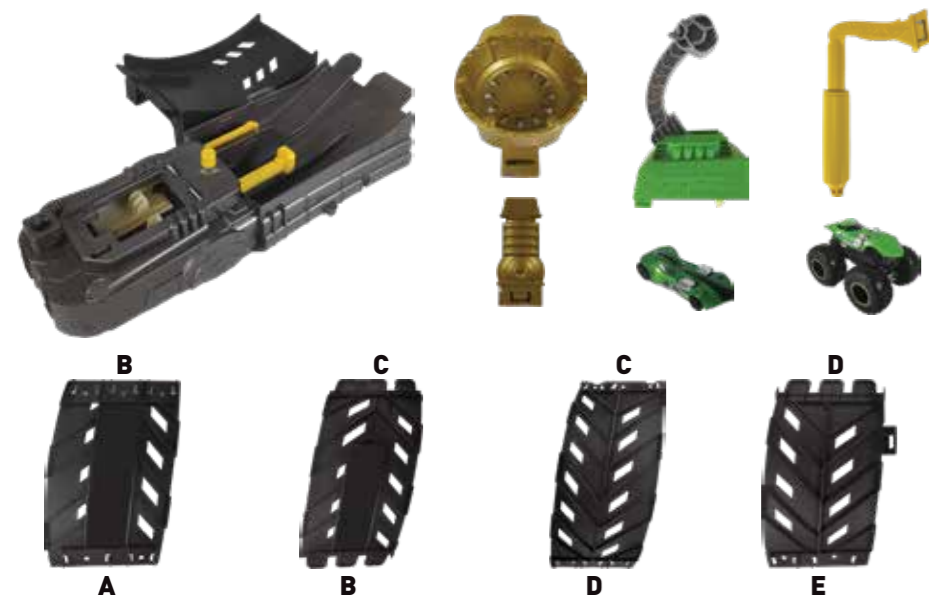

2 APPLY LABELS



Label sheet



3 ASSEMBLY

Let's get started!

You will now begin to assemble the Hot Wheels® Monster Loop and trophy cup.

The Monster Loop has 4 loop sections that look similar. Please pay attention to the molded letters on track pieces for correct assembly.



1.

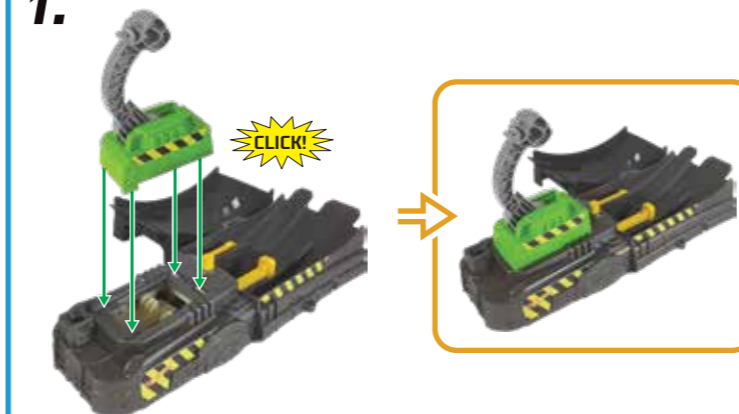

2.

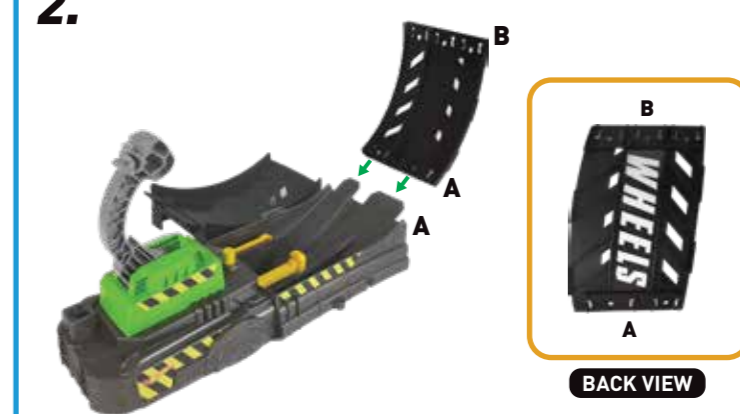

3.

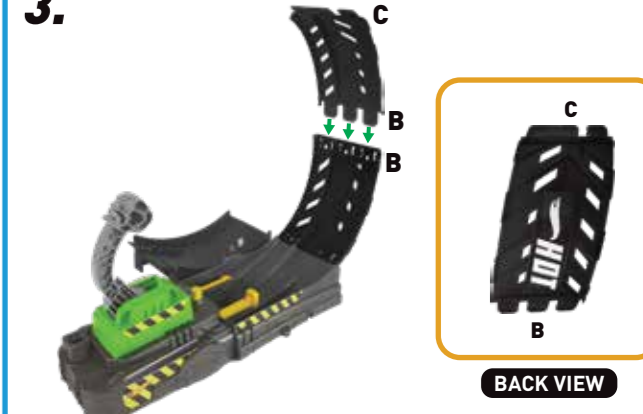

4.

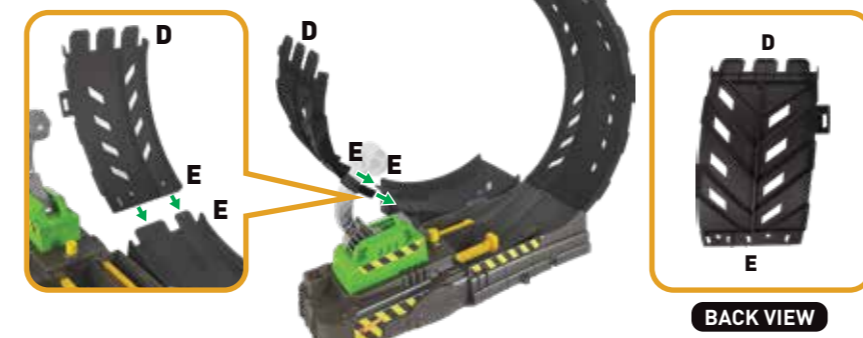

5.



6.



7.

