

BUSY ISLAND SET INSTRUCTIONS

Keep these instructions for future reference as they contain important information.

What's Included

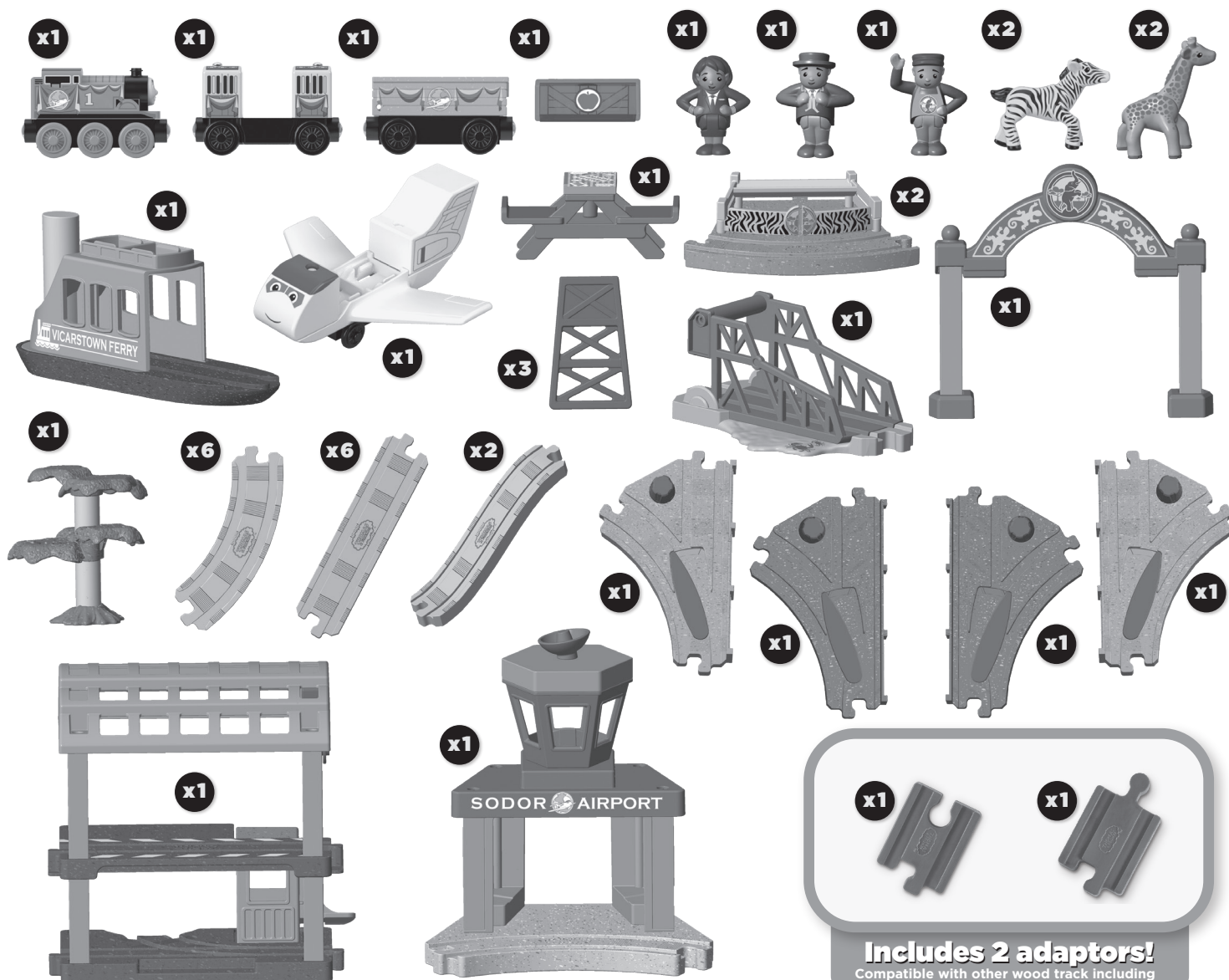

Includes 2 adaptors!
Compatible with other wood track including
Thomas & Friends™ Wooden Railway.

Helpful Hint

1

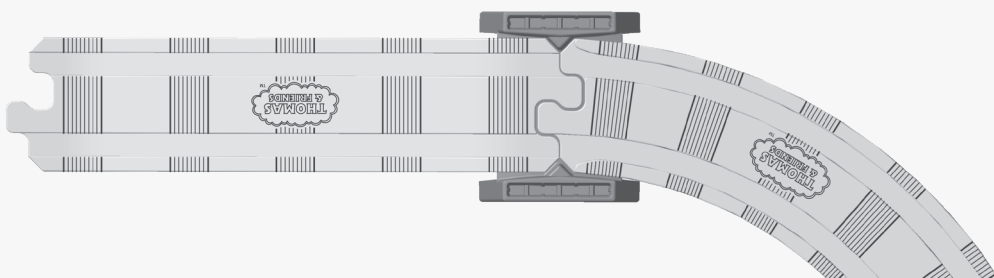
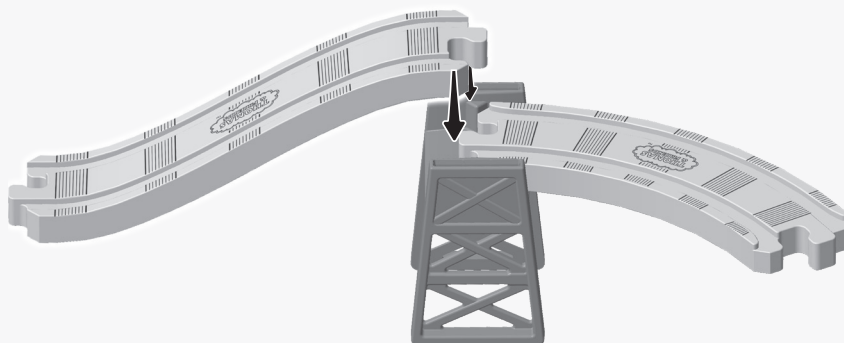
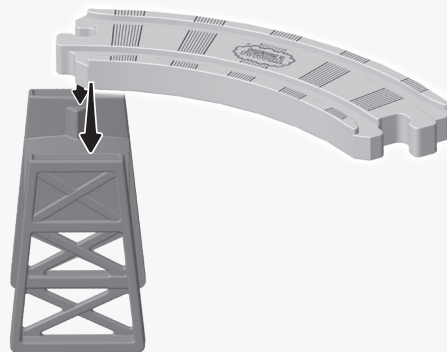

Place the end of one track piece on one side of the riser first and then place the second track piece on the riser as shown. Notches on the riser will fit between the two track pieces.

How to Play

1



2

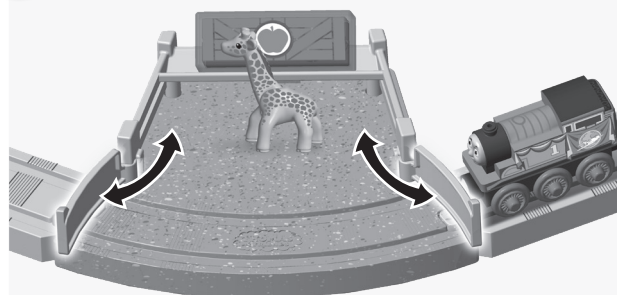

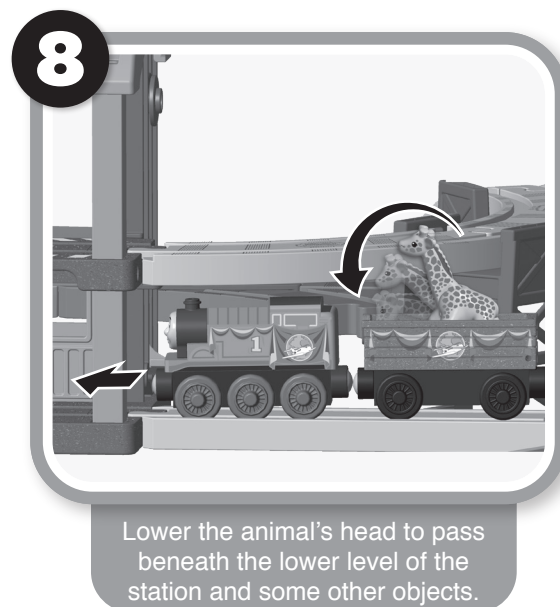
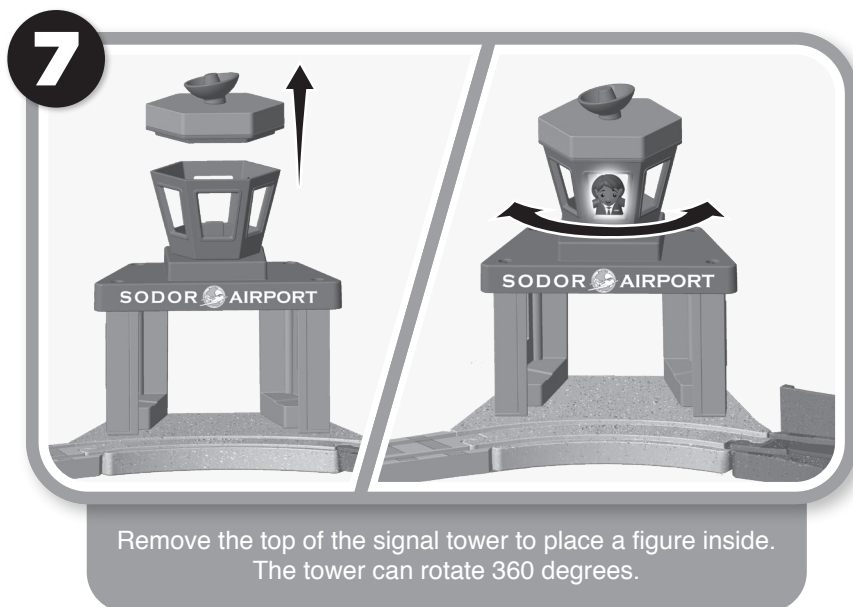
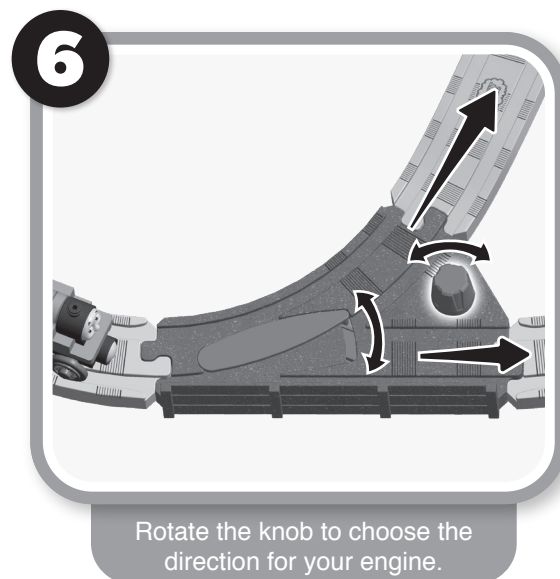
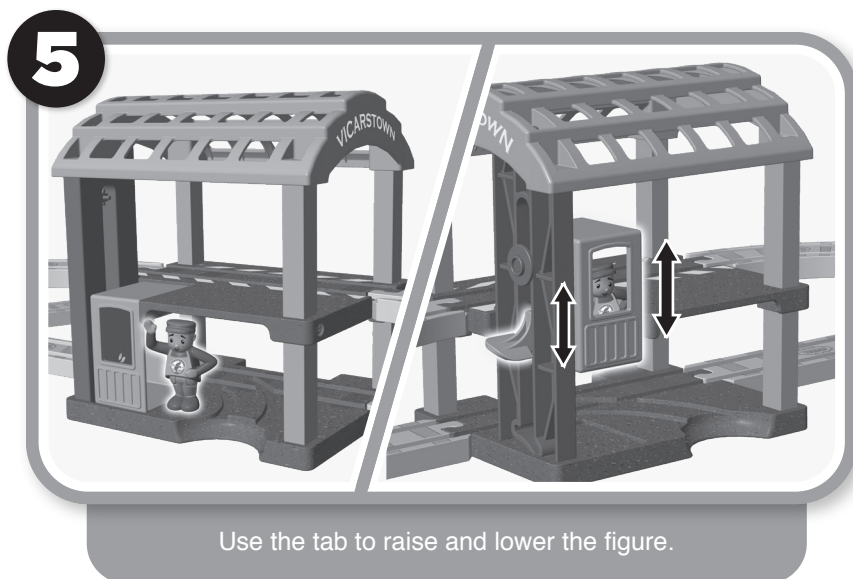
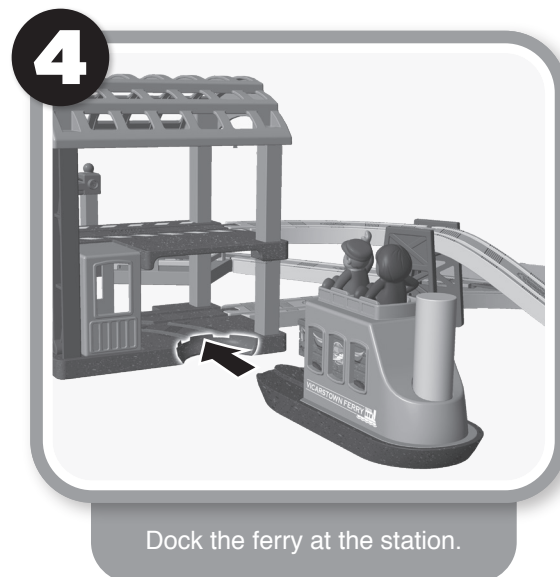
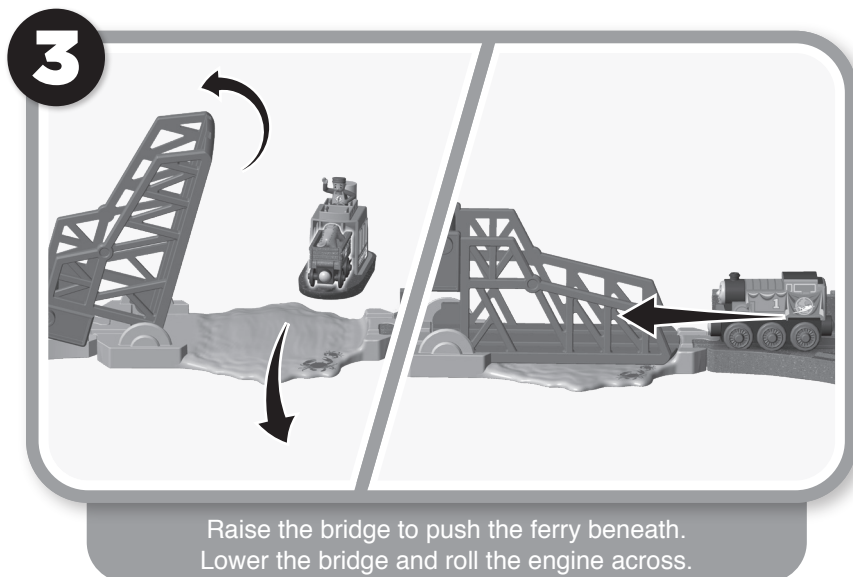

Track Layout

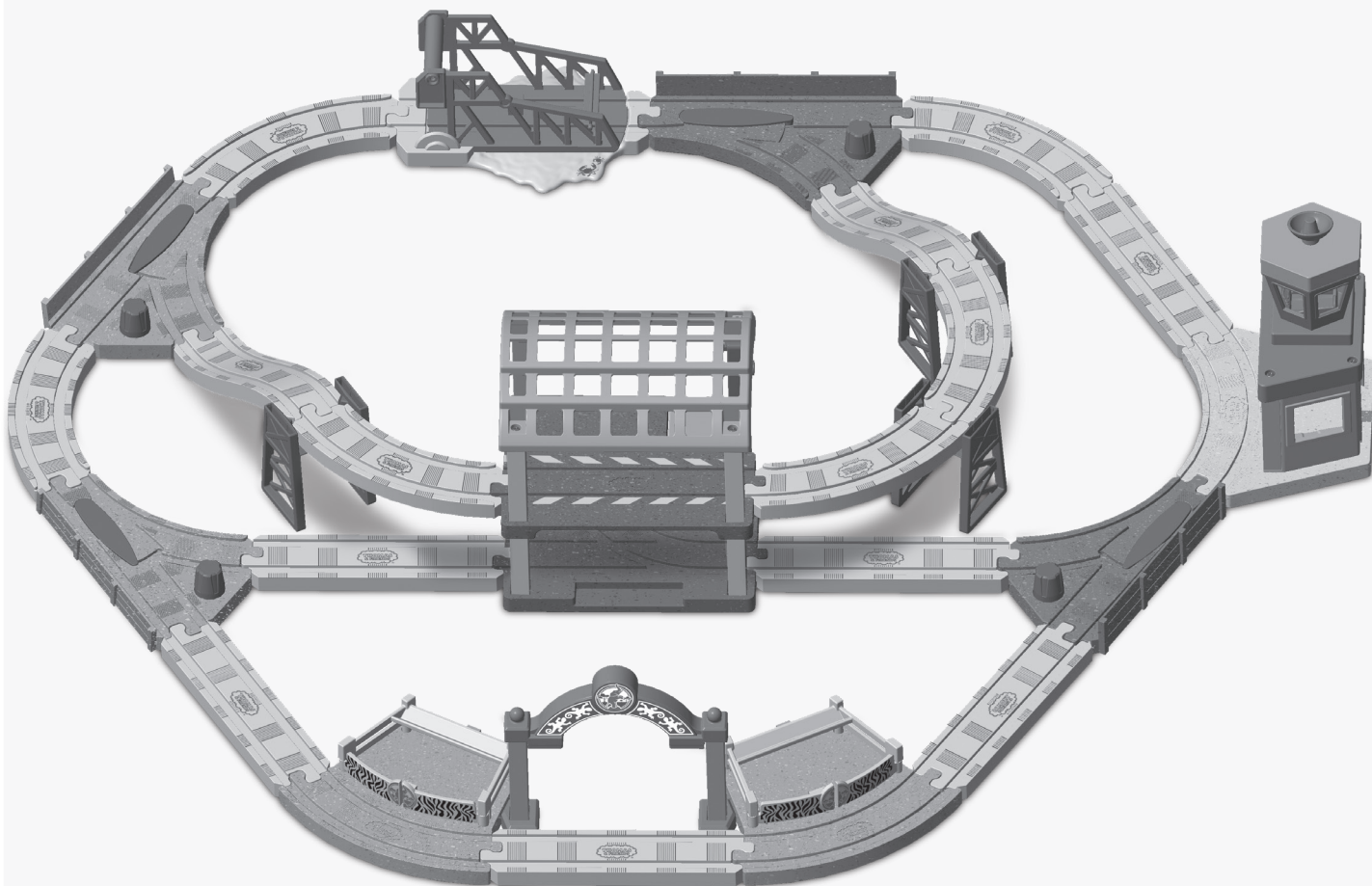

Thomas the Tank Engine & Friends™
 CREATED BY BRIT ALLCROFT

Based on the Railway Series by The Reverend W Awdry.
 ©2018 Gullane (Thomas) Limited. Thomas the Tank Engine & Friends and
 Thomas & Friends are trademarks of Gullane (Thomas) Limited.
 ©2018 HIT Entertainment Limited. HIT and the HIT logo are trademarks of
 HIT Entertainment Limited.

©2018 Mattel. ® and ™ designate U.S. trademarks of Mattel,
 except as noted. **PRINTED IN CHINA.**
 Mattel East Asia Ltd., Room 503-09, North Tower,
 World Finance Centre, Harbour City,
 Tsimshatsui, HK, China. Tel.: (852) 3185-6500.



GGG74 GGG74-0970
 1101917551-DOM
FisherPrice®

CONSUMER ASSISTANCE

1-800-432-5437 (US & Canada)
 1300 135 312 (Australia)

service.fisher-price.com

Fisher-Price, Inc., 636 Girard Avenue, East Aurora, NY 14052.
 Hearing-impaired consumers: 1-800-382-7470.

Outside the United States:
 Canada: Mattel Canada Inc., 6155 Freemont Blvd.,
 Mississauga, Ontario L5R 3W2; www.service.mattel.com.
 Great Britain: Mattel UK Ltd, Vanwall Business Park,
 Maidenhead SL6 4UB, Helpline: 01628 500303,
 www.service.mattel.com/uk
 Mattel Europa B.V., Gondel 1, 1186 MJ Amstelveen, Nederland.
 Australia: Mattel Australia Pty. Ltd., 658 Church Street,
 Locked Bag #870, Richmond, Victoria 3121 Australia.
 New Zealand: 16-18 William Pickering Drive,
 Albany 1331, Auckland.
 South Africa: Mattel South Africa (PTY) LTD, Office 102 I3,
 30 Melrose Boulevard, Johannesburg 2196.