

5+

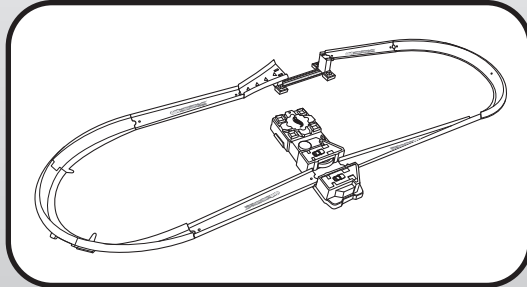
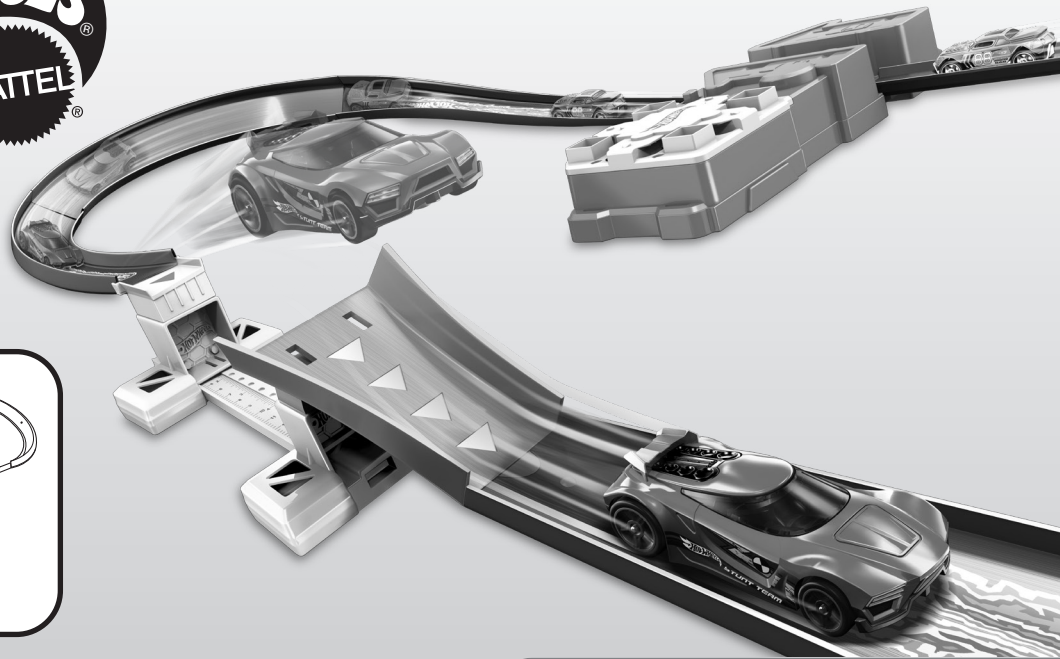

FLYING CUSTOMS™

HOT CURVES SUPER JUMP™

GND90-0970
1102240286-DOM

HOTWHEELS.COM

Requires 2-D (LR20) alkaline batteries (not included). Dispose of batteries safely. Please keep these instructions for future reference as they contain important information.



INSTRUCTIONS

2 BATTERY INSTALLATION

- Unscrew battery cover with a Phillips head screwdriver (not included).
- Install 2 new D-size (LR20) alkaline batteries (not included) in the battery box.
- Replace battery cover and tighten screws.
- For longer life, use alkaline batteries.
- Replace batteries if booster can no longer propel cars through the track set.
- Remove batteries and dispose of them safely.
- If product malfunctions, turn power OFF for a few seconds, then ON again. This should reset your product and let you resume normal operation.

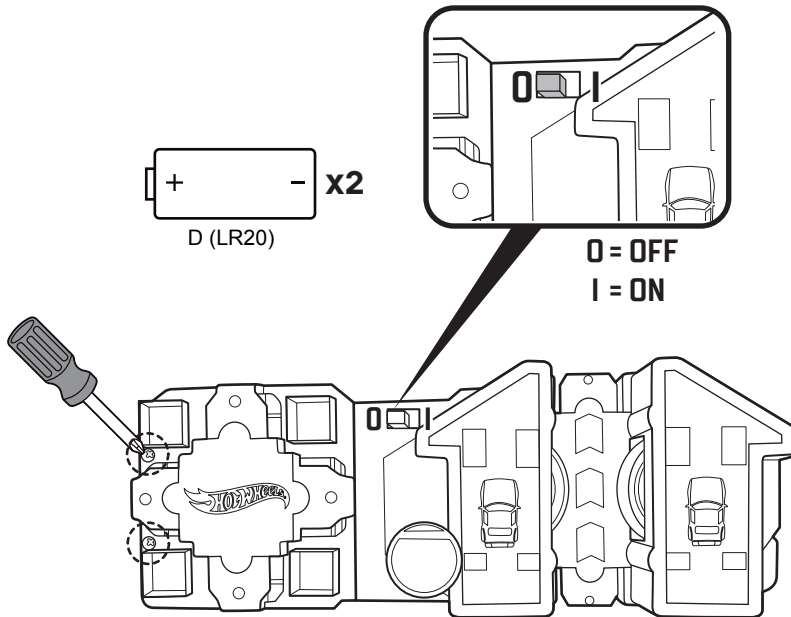

3 APPLY LABELS

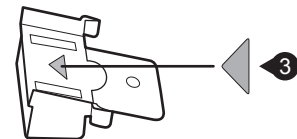
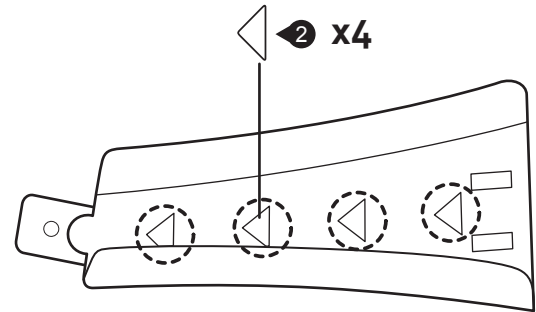
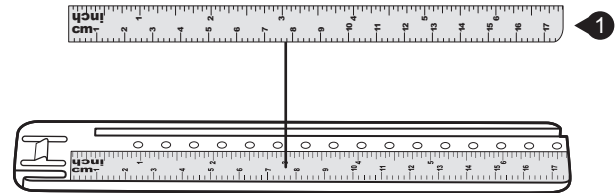

4 ASSEMBLY

1

a

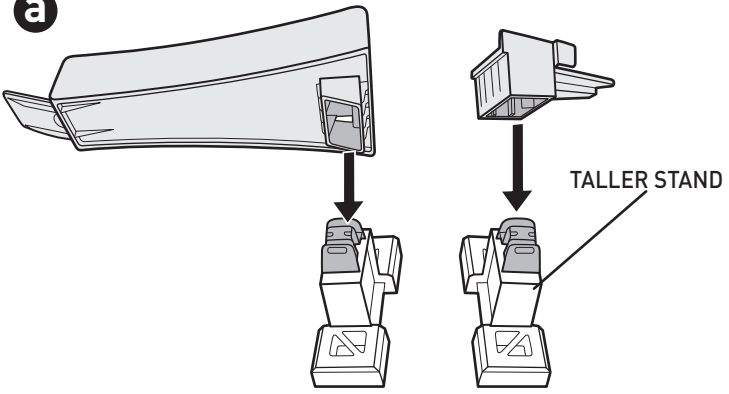

b

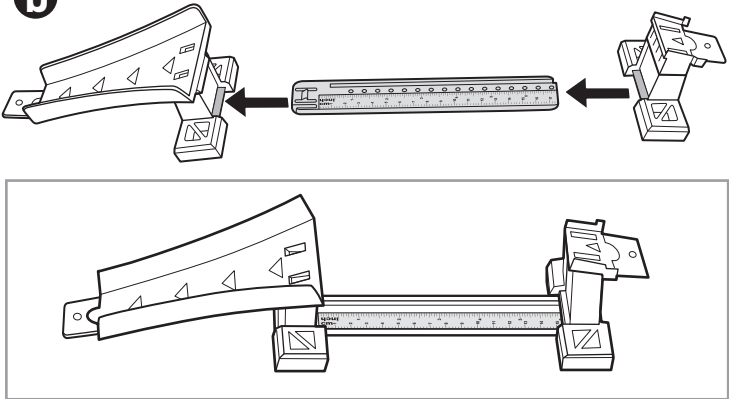

2

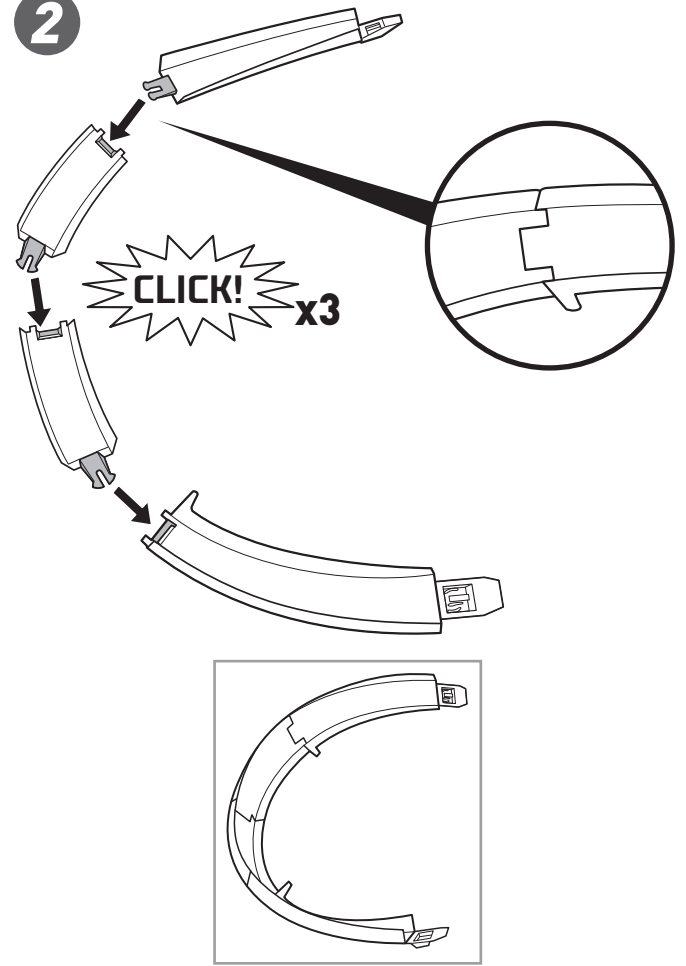

3

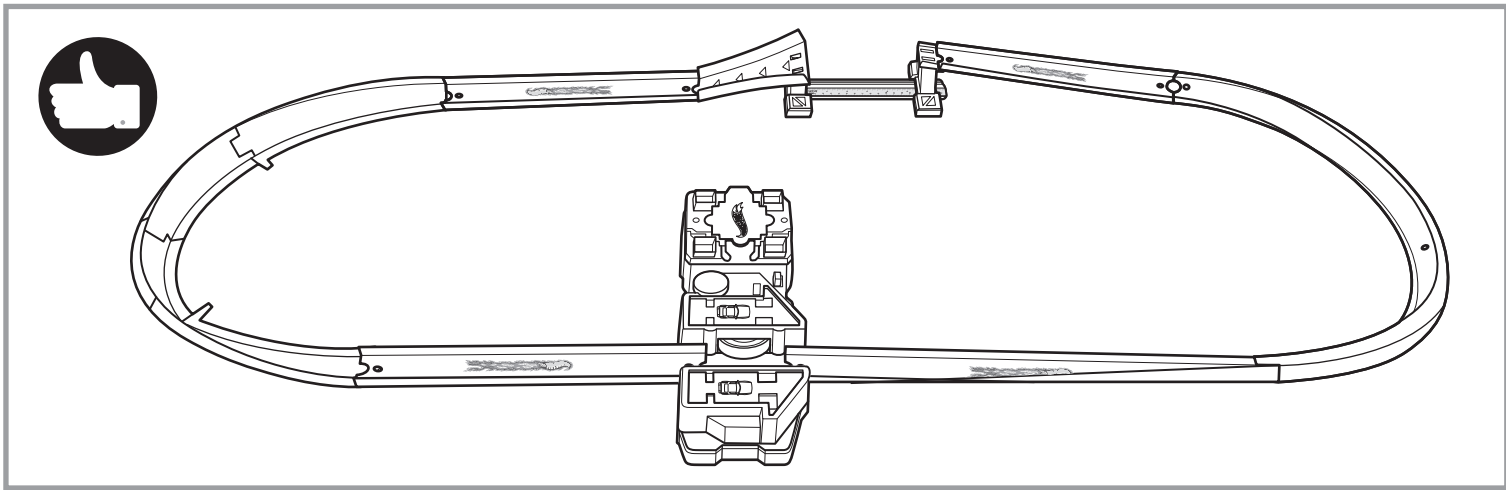
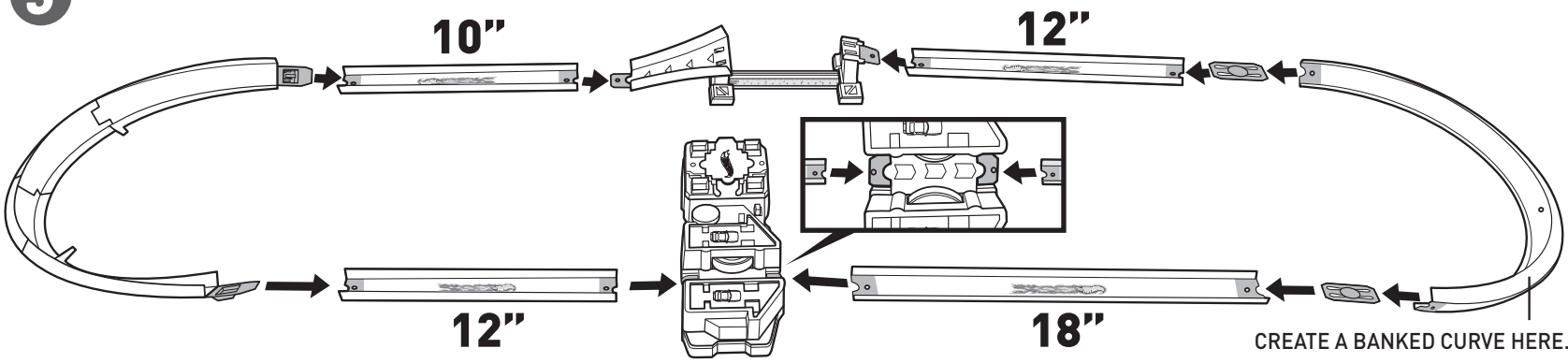

5 To Play

1 TEST YOUR LIMITS BY ADJUSTING THE JUMP DISTANCE!

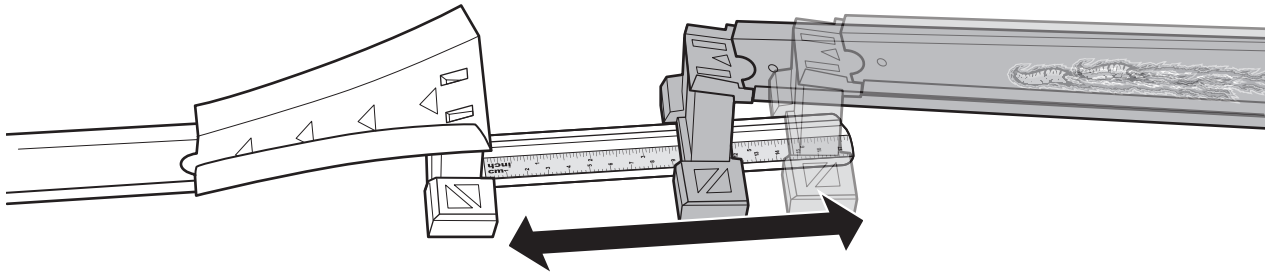

2 LOAD CARS IN SPECTATOR ZONES TO CHEER ON THE RACERS!

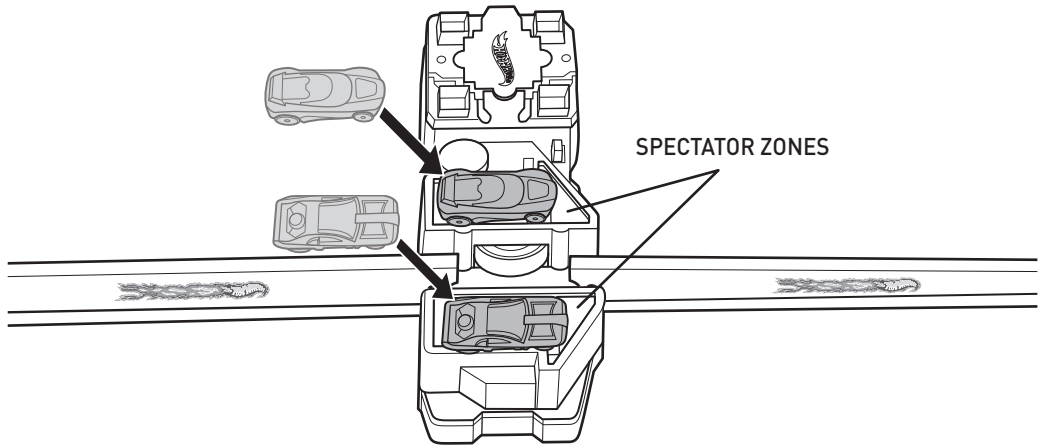

3

SWITCH ON THE BOOSTER AND PUSH YOUR CAR THROUGH. SPEED AROUND THE HOT CURVES AND LAND THE SUPER JUMP!

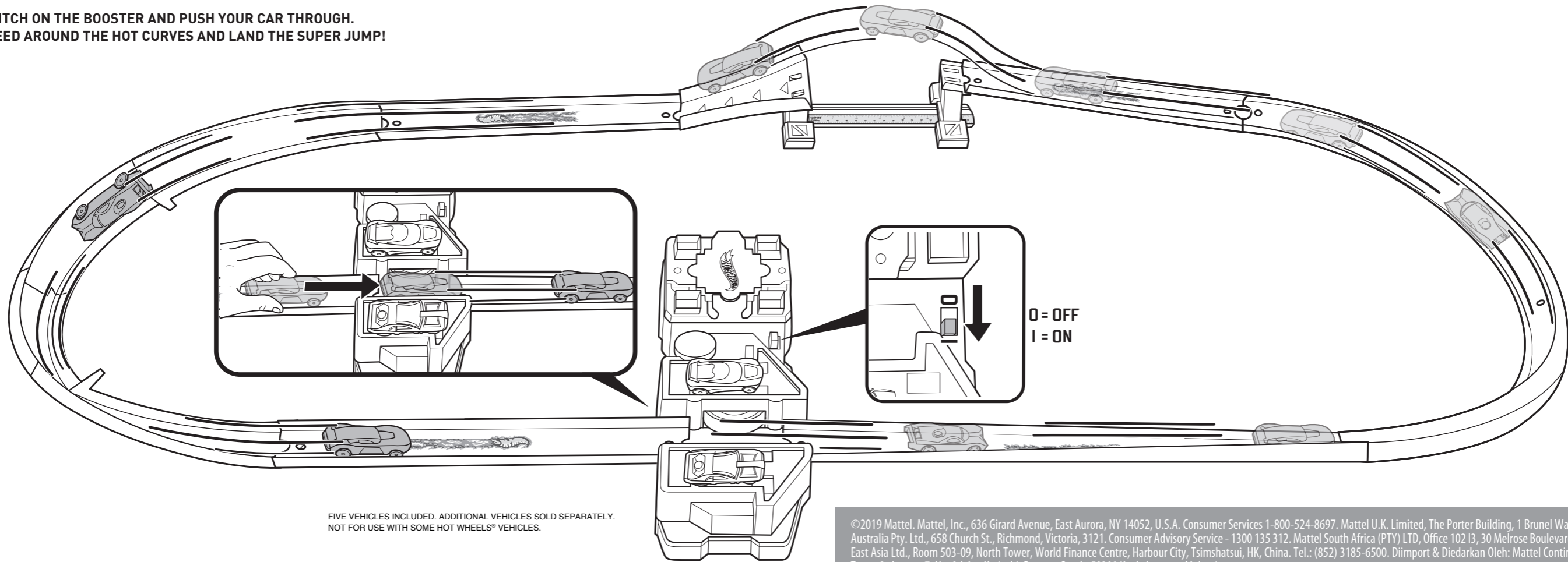

FIVE VEHICLES INCLUDED. ADDITIONAL VEHICLES SOLD SEPARATELY. NOT FOR USE WITH SOME HOT WHEELS® VEHICLES.

©2019 Mattel. Mattel, Inc., 636 Girard Avenue, East Aurora, NY 14052, U.S.A. Consumer Services 1-800-524-8697. Mattel U.K. Limited, The Porter Building, 1 Brunel Way, Slough SL1 1FQ, UK. Mattel Australia Pty. Ltd., 658 Church St., Richmond, Victoria, 3121. Consumer Advisory Service - 1300 135 312. Mattel South Africa (PTY) LTD, Office 10213, 30 Melrose Boulevard, Johannesburg 2196. Mattel East Asia Ltd., Room 503-09, North Tower, World Finance Centre, Harbour City, Tsimshatsui, HK, China. Tel.: (852) 3185-6500. Diimport & Diedarkan Oleh: Mattel Continental Asia Sdn Bhd. Level 19, Tower 3, Avenue 7, No. 8 Jalan Kerinchi, Bangsar South, 59200 Kuala Lumpur, Malaysia.

