

UNITED STATES
Fisher-Price, Inc., 636 Girard Avenue, East Aurora, NY 14052.
Consumer Services: 1-800-432-5437.
CANADA
Mattel Canada Inc., 6155 Rivermont Blvd., Mississauga, Ontario L5R 3W2, Consumer Service/Service à la clientèle: 1-800-432-5437, www.service.mattel.com.
GREAT BRITAIN
Mattel U.K. Limited, The Porter Building, 1 Brunel Way, Slough SL1 1PQ, UK.
www.service.mattel.com/uk.
NETHERLAND
Mattel Europe B.V., Gondel 1, 1186 MA Amstelveen, Nederland.
AUSTRALIA
Mattel Australia Pty. Ltd., 656 Church Street, Locked Bag 4970, Richmond, Victoria 3121 Australia.
Consumer Advisory Service: 1300 133 332.
NEW ZEALAND
15-18 William Pickering Drive, Albany 1331, Auckland.
SOUTH AFRICA
Mattel South Africa (PTY) LTD, Office 102 13, 30 Melrose Boulevard, Johannesburg 2196.

CREATED BY WILLY LUKOWITZ
Based on the Railway Series by The Reverend W. Awdry.
©2022 Cullane (Thomas) Limited. Thomas the Tank Engine & Friends™ and Thomas & Friends™ are trademarks of Cullane (Thomas) Limited.
©2022 HPI Entertainment Limited. HPI and the HPI logo are trademarks of HPI Entertainment Limited.
©2022 Mattel. "and" designate U.S. trademarks of Mattel, except as noted. **PRINTED IN CHINA.**
Mattel East Asia Ltd., Room 503-09, North Tower, World Finance Centre, Harbour City, Tsimshatsui, HK, China. Tel: (852) 3185-6500.



INSTRUCTIONS
Keep these instructions for future reference as they contain important information.

HHN25

What's Included

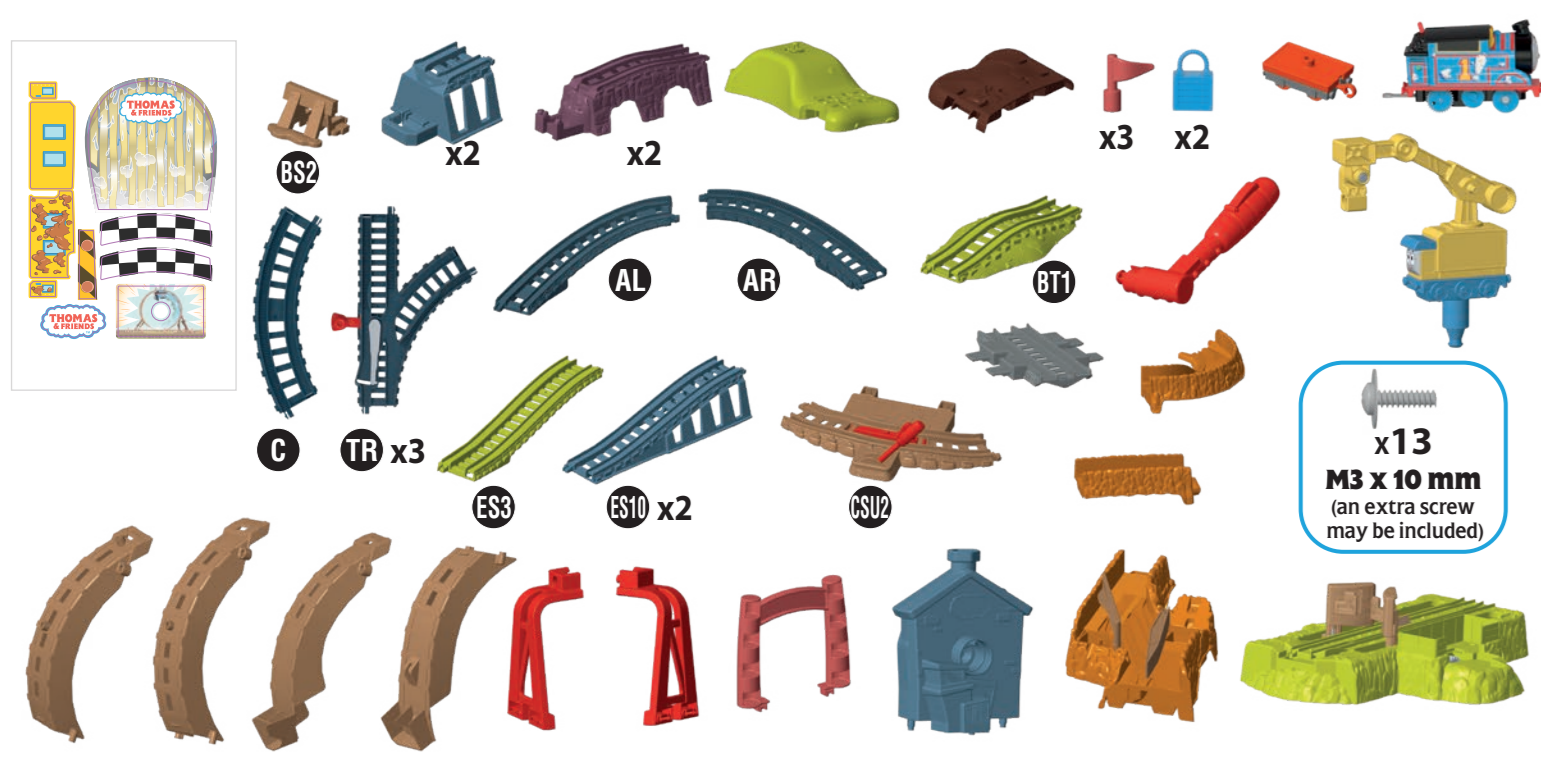

Helpful Hints

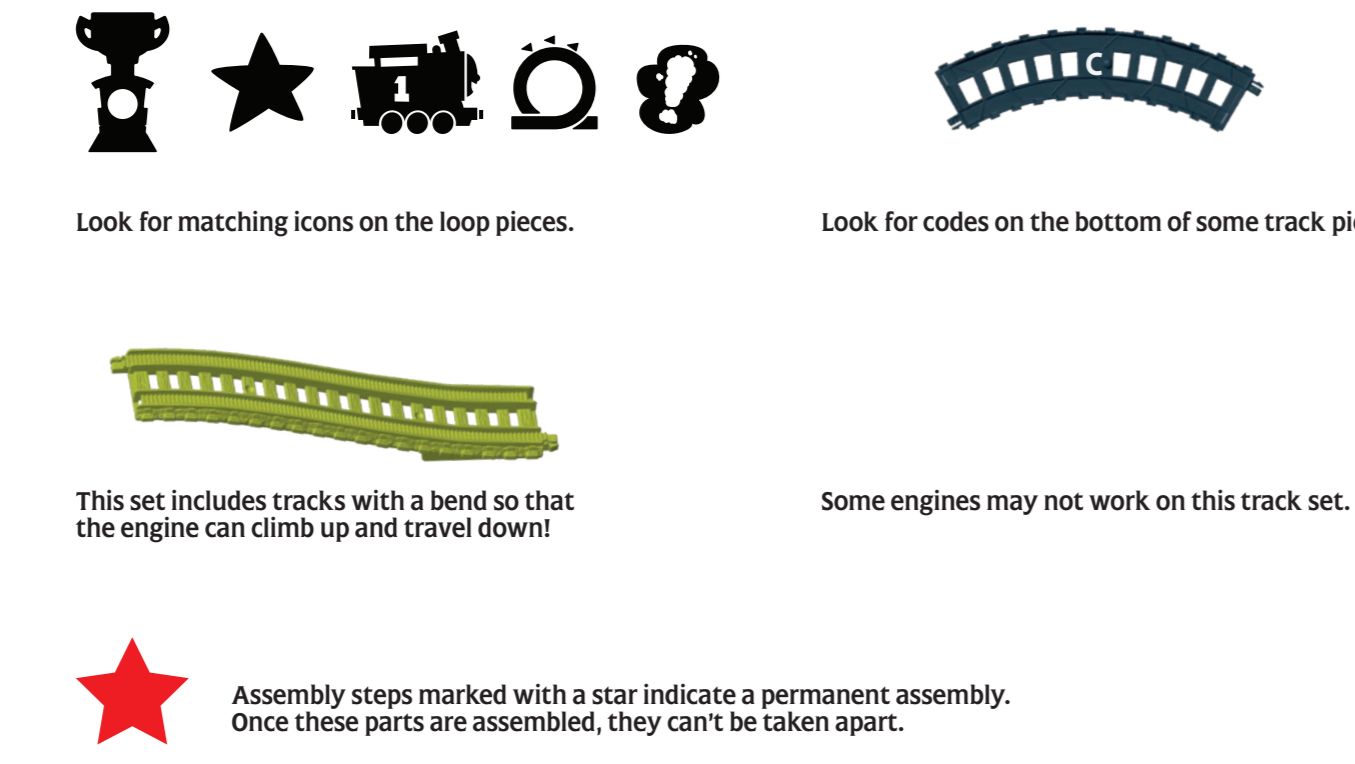

Assembly

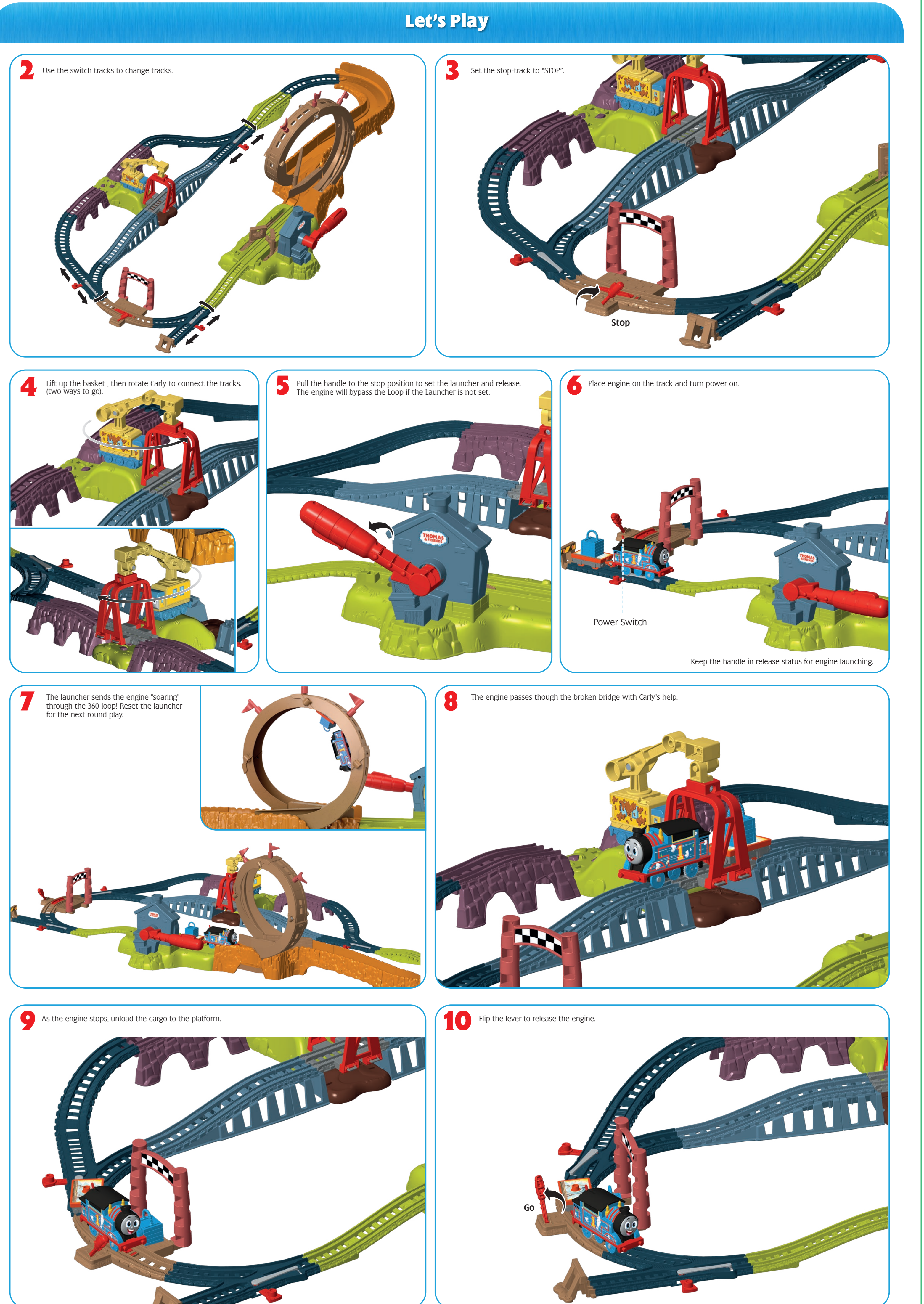
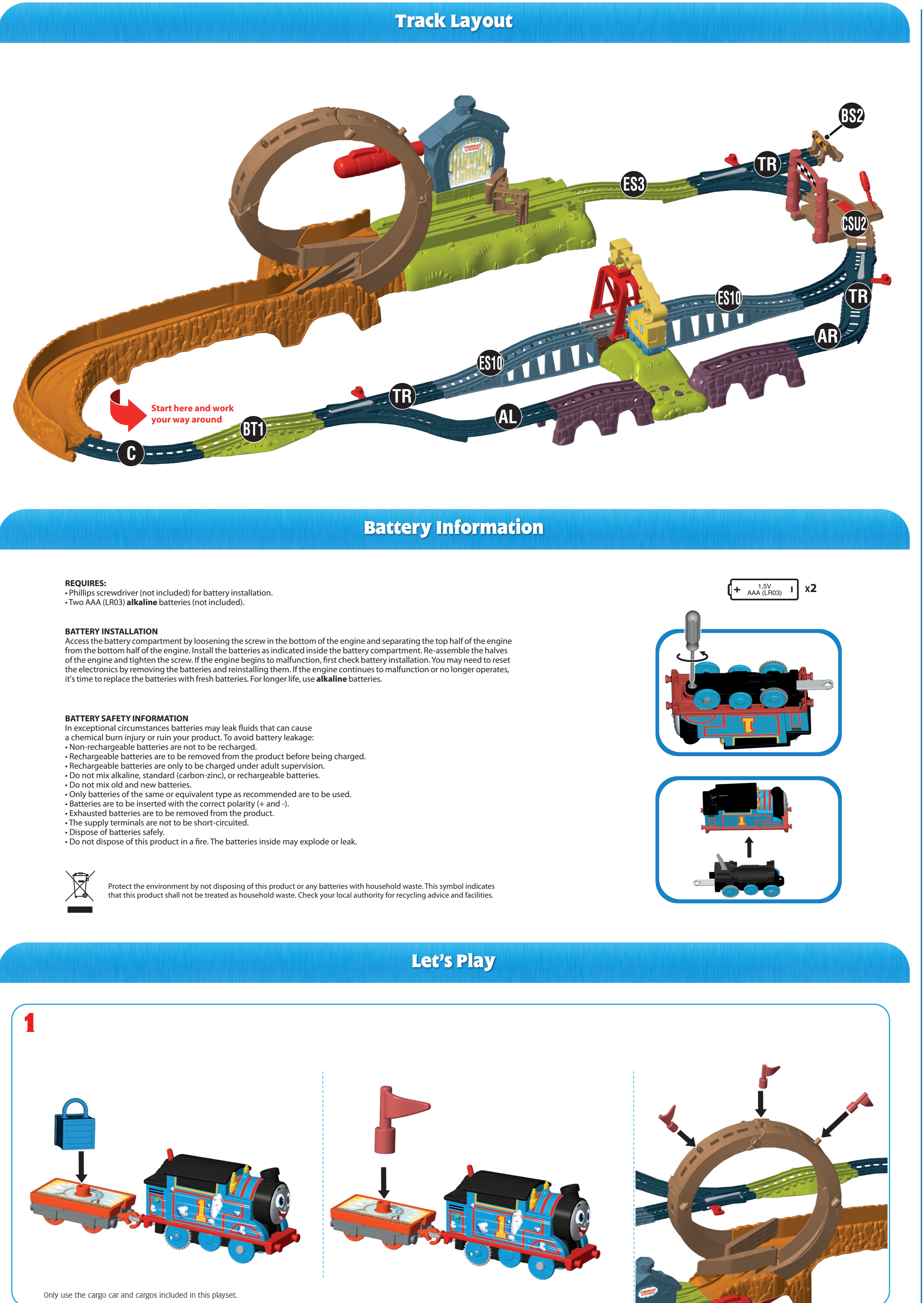
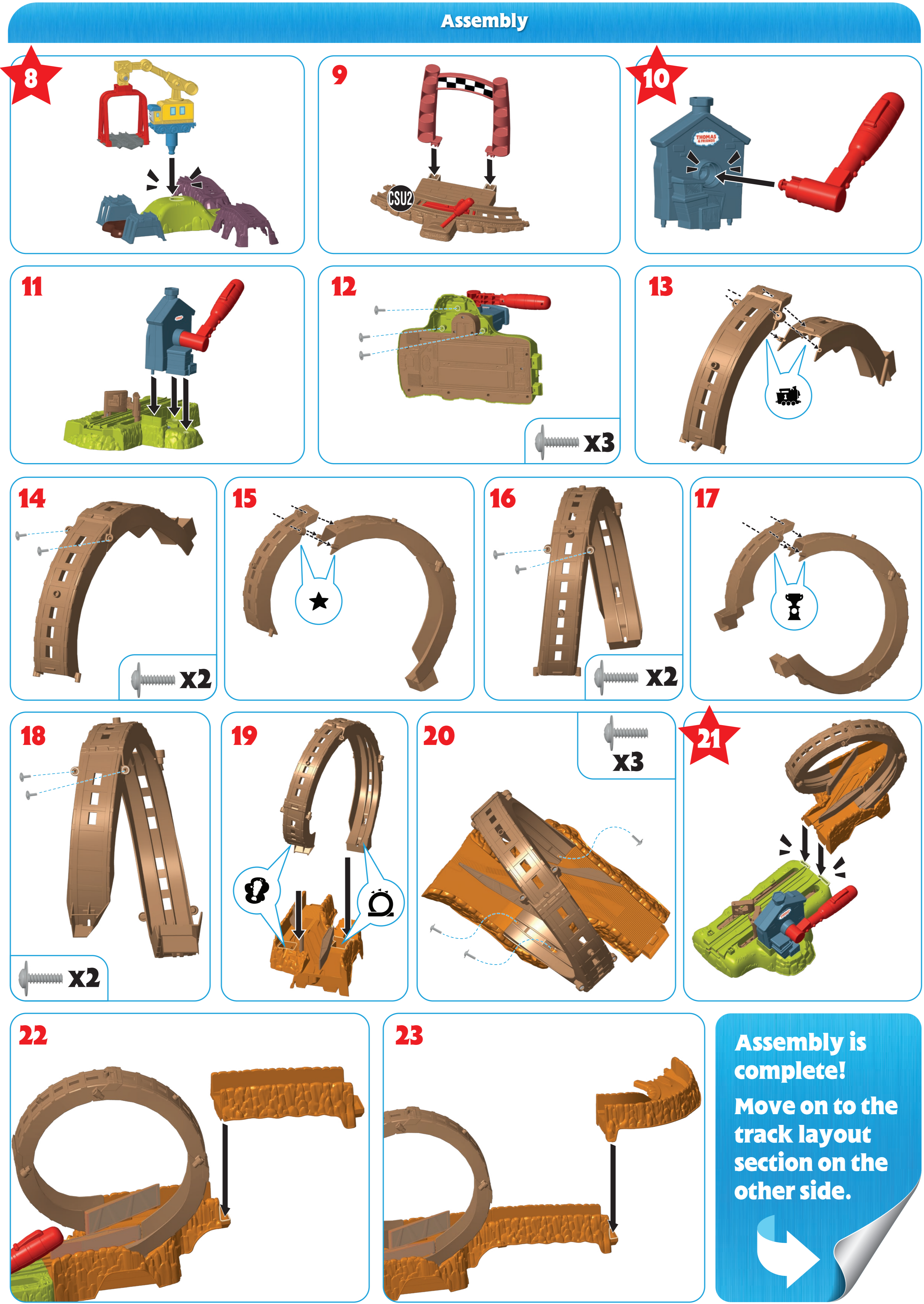

Front				Back			
COVER	BACK	3	4	17	18	19	20
5	6	7	8	21	22	23	24
9	10	11	12	25	26	27	28
13	14	15	16	29	30	31	32

Fold

COVER BACK COVER

Color: Cyan Magenta Yellow Black Orange

Size: 15.1" x 12.1" (38.1 x 30.7 cm)
Paper: 100% Recycled paper
Color: 4C
Date: 4/18/2022 (China Main)

4/18/2022 remark for G1
- Added a sheet for step 21.