

THOMAS & FRIENDS™

TALKING CRANKY DELIVERY™ TRAIN SET



Adult assembly required.

Tool needed: Phillips screwdriver (not included).



HMB97

INSTRUCTIONS

Keep these instructions for future reference as they contain important information.



UNITED STATES
Fisher-Price, Inc., 636 Girard Avenue, East Aurora, NY 14052.
Consumer Services: 1-800-432-5437.

CANADA
Mattel Canada Inc., 6155 Freemont Blvd., Mississauga, Ontario L5R 3W2. Consumer Services/Service à la clientèle : 1-800-432-5437. www.service.mattel.com.

GREAT BRITAIN
Mattel U.K. Limited, The Porter Building, 1 Brunel Way, Slough SL1 1FQ, UK.
www.service.mattel.com/uk.

NETHERLAND
Mattel Europa B.V., Gondel 1, 1186 MJ Amstelveen, Nederland.

AUSTRALIA
Mattel Australia Pty. Ltd., 658 Church Street, Locked Bag #870, Richmond, Victoria 3121 Australia.
Consumer Advisory Service 1300 135 312.

NEW ZEALAND
16-18 William Pickering Drive, Albany 1331, Auckland.

SOUTH AFRICA
Mattel South Africa (PTY) LTD, Office 102 I3, 30 Melrose Boulevard, Johannesburg 2196.



CREATED BY BRITT ALLCROFT

Based on the Railway Series by The Reverend W Awdry.

©2023 Gullane (Thomas) Limited. Thomas the Tank Engine & Friends™ and Thomas & Friends™ are trademarks of Gullane (Thomas) Limited.

©2023 HIT Entertainment Limited. HIT and the HIT logo are trademarks of HIT Entertainment Limited.

©2022, 2023 Mattel. ® and ™ designate U.S. trademarks of Mattel, except as noted. **PRINTED IN CHINA.**



HMB97-0970G2-1102964177-DOM



What's Included

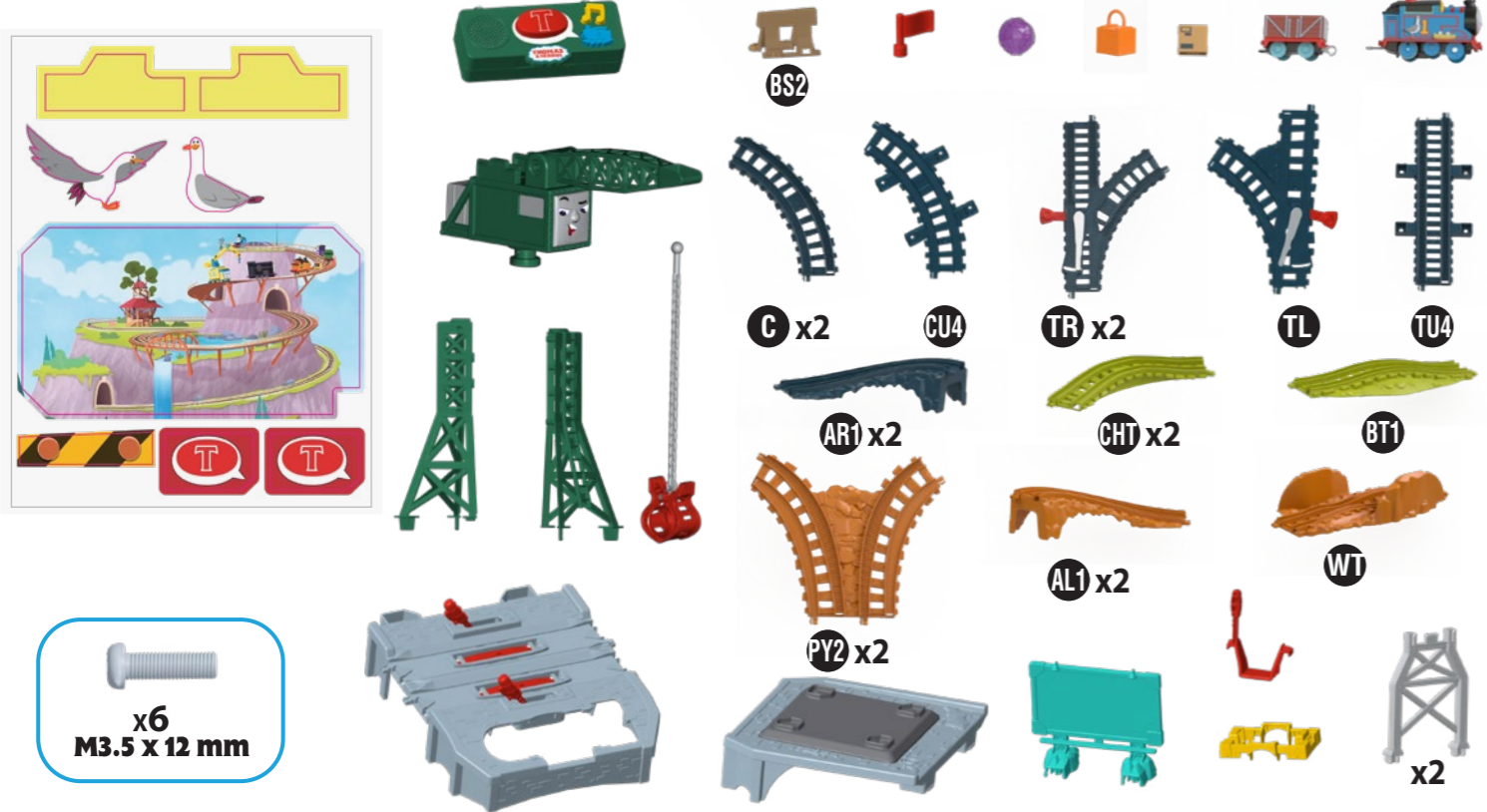

x6
M3.5 x 12 mm

Helpful Hints



Look for codes on the bottom of some track pieces.



This set includes tracks with a bend so that the engine can climb up and travel down!

Some engines may not work on this track set.



Assembly steps marked with a star indicate a permanent assembly. Once these parts are assembled, they can't be taken apart.



Protect the environment by not disposing of this product or any batteries with household waste. This symbol indicates that this product shall not be treated as household waste. Check your local authority for recycling advice and facilities.

Assembly

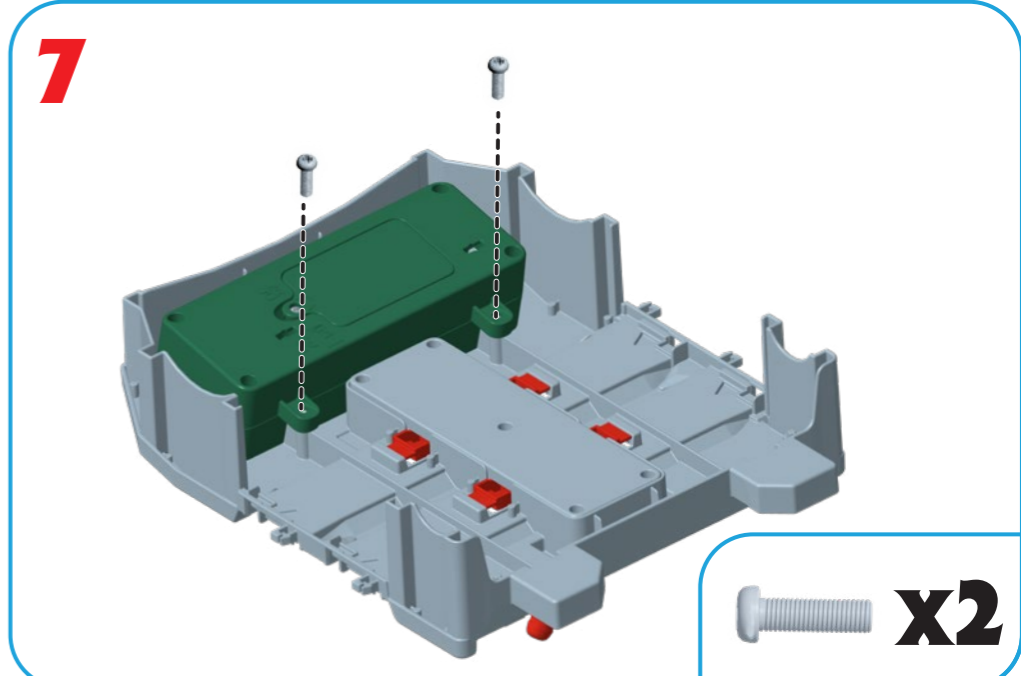
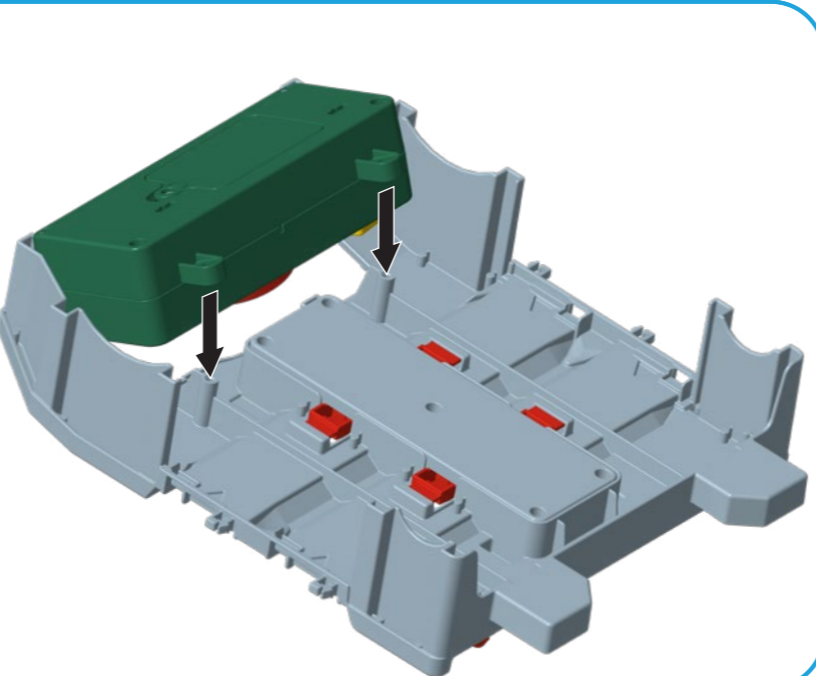
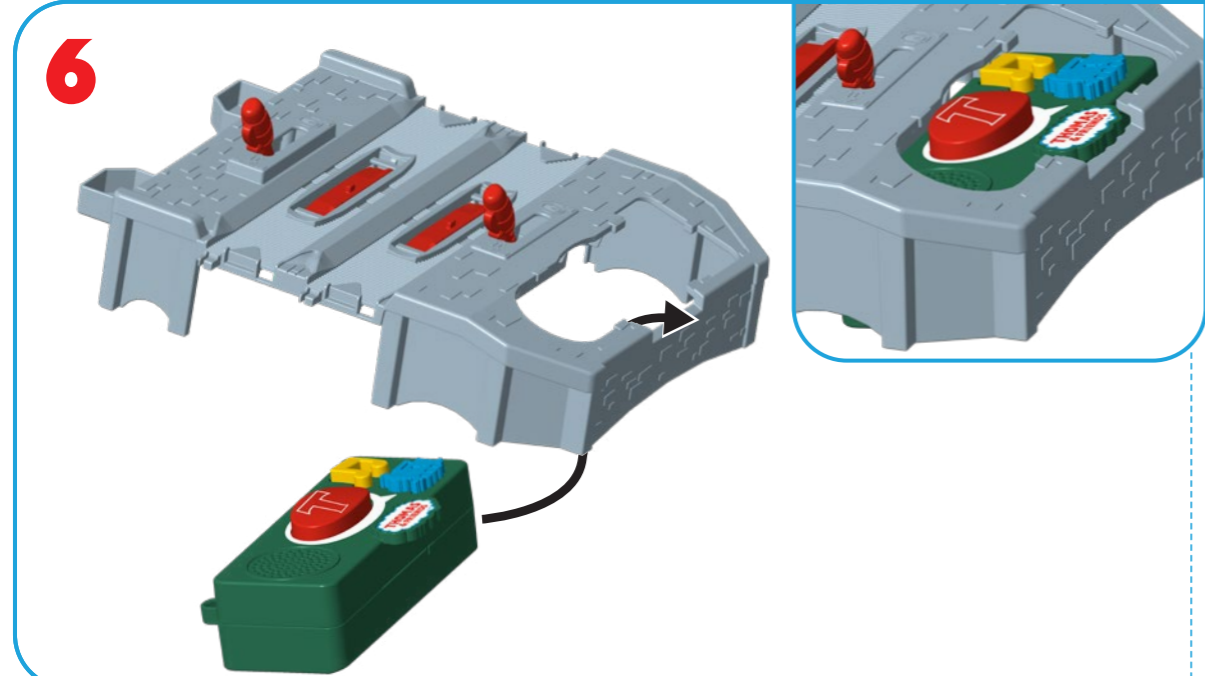
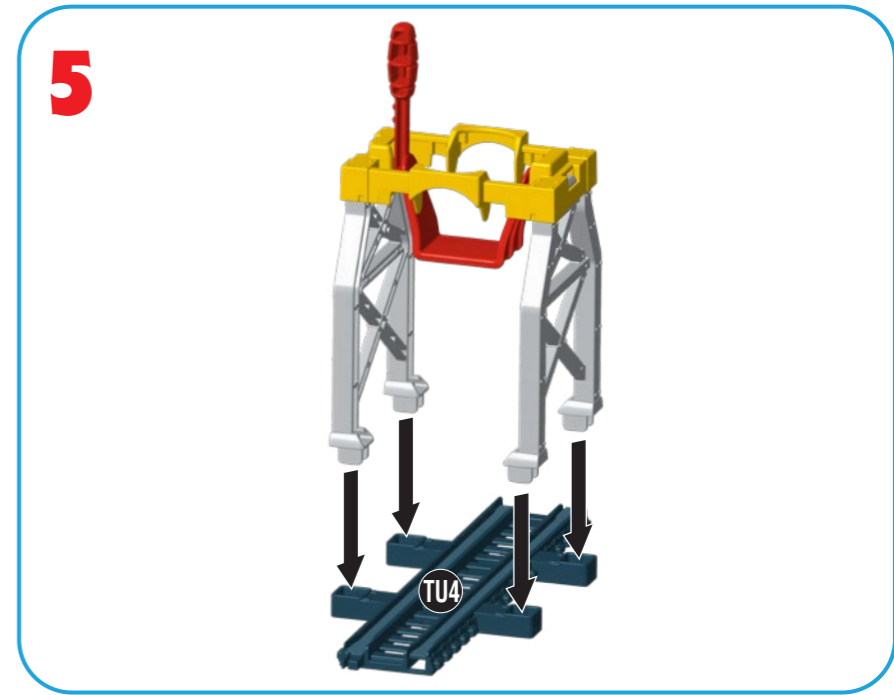
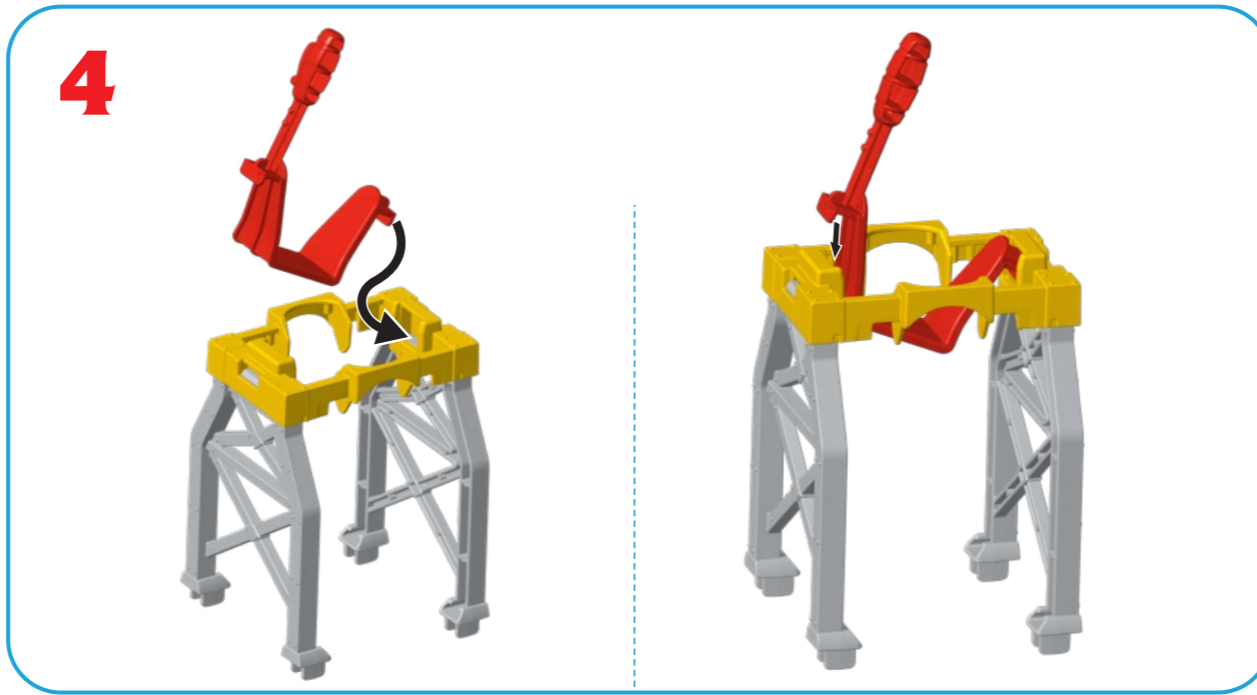
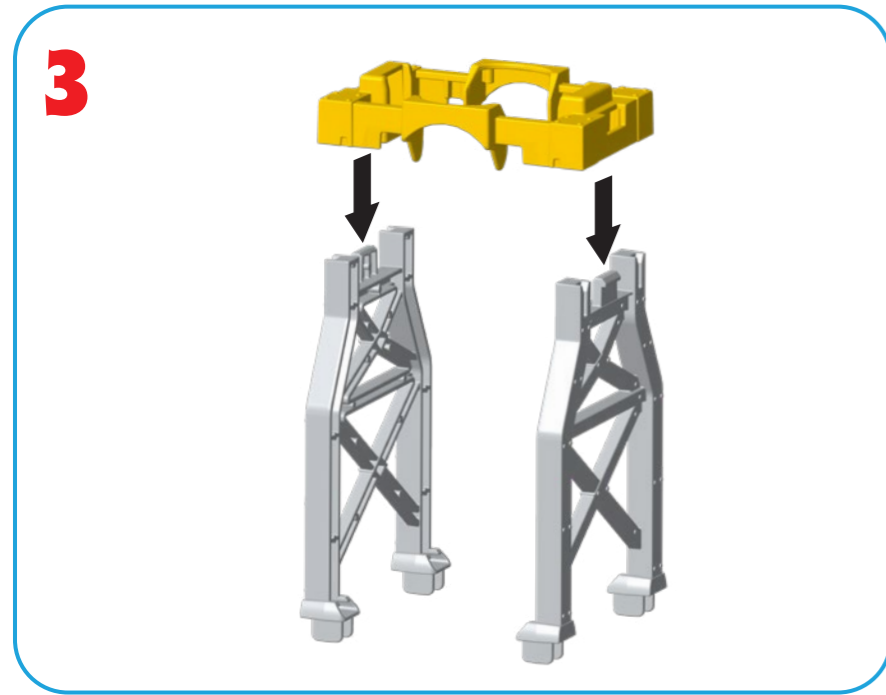
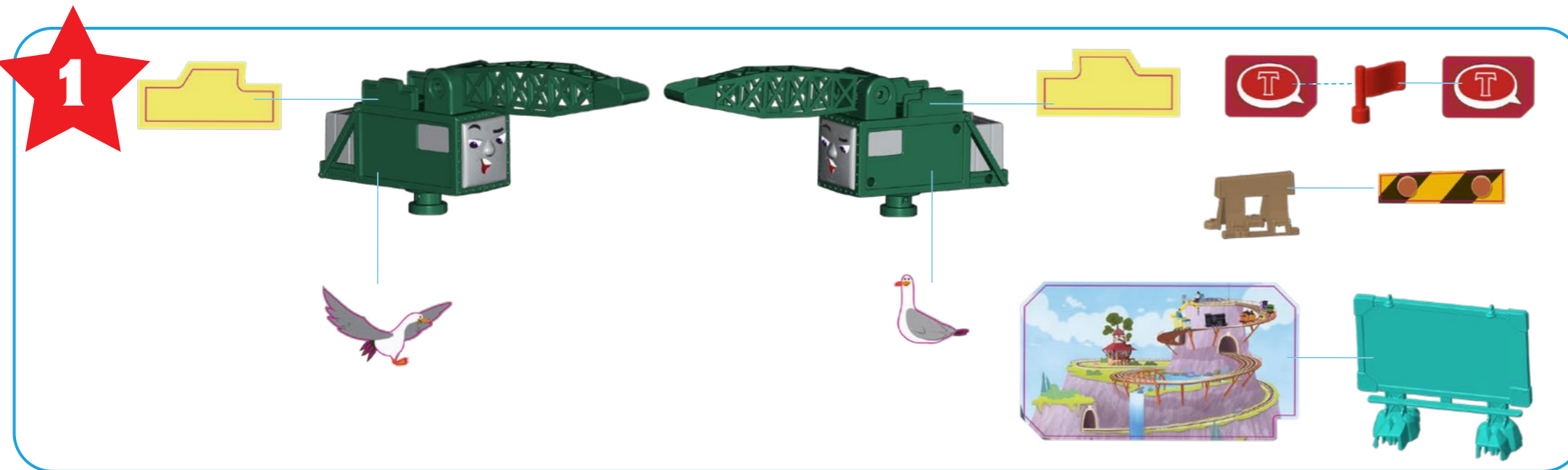

x2

Assembly

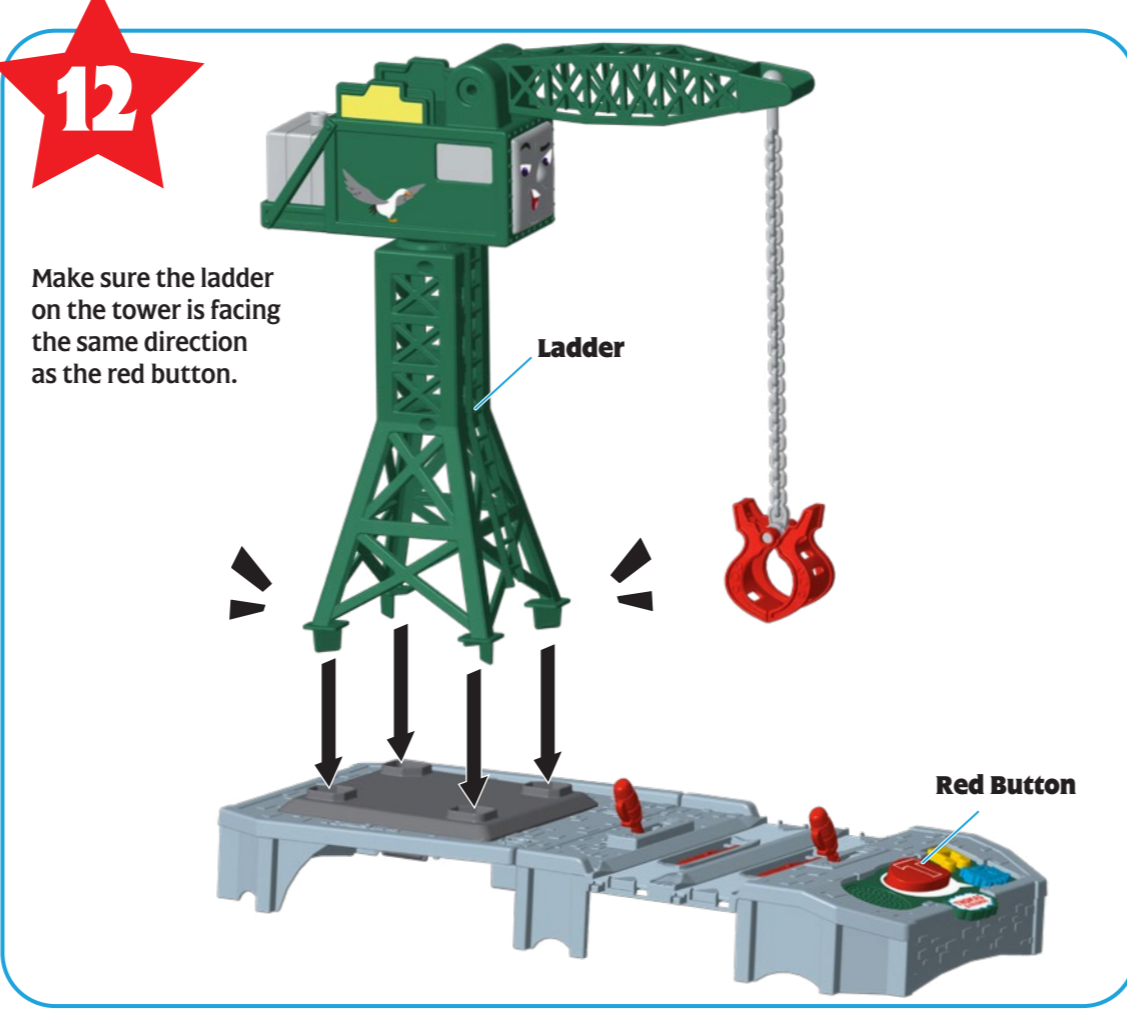
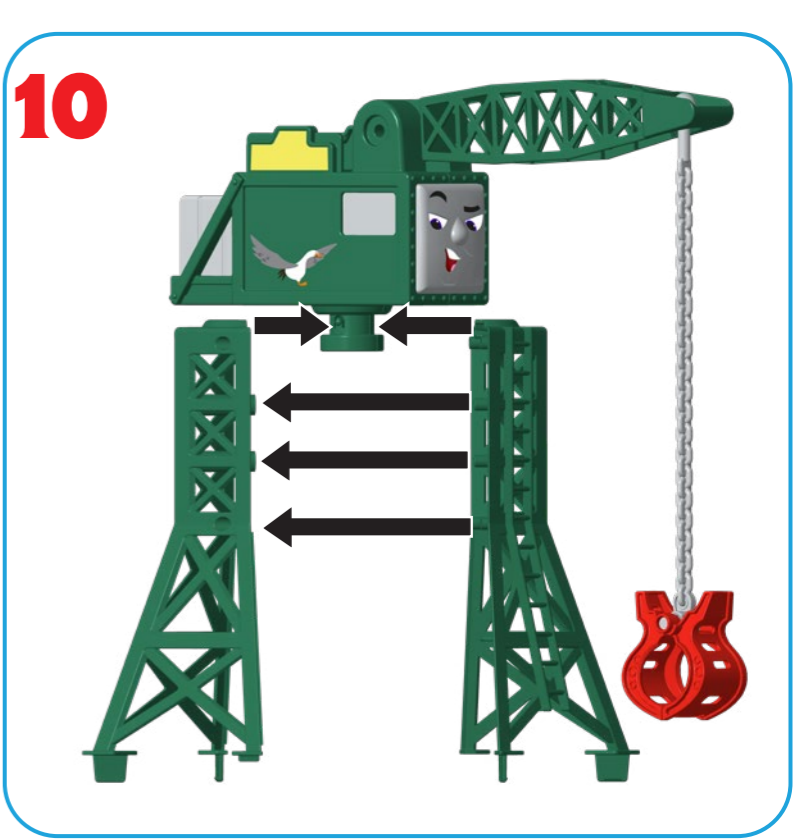
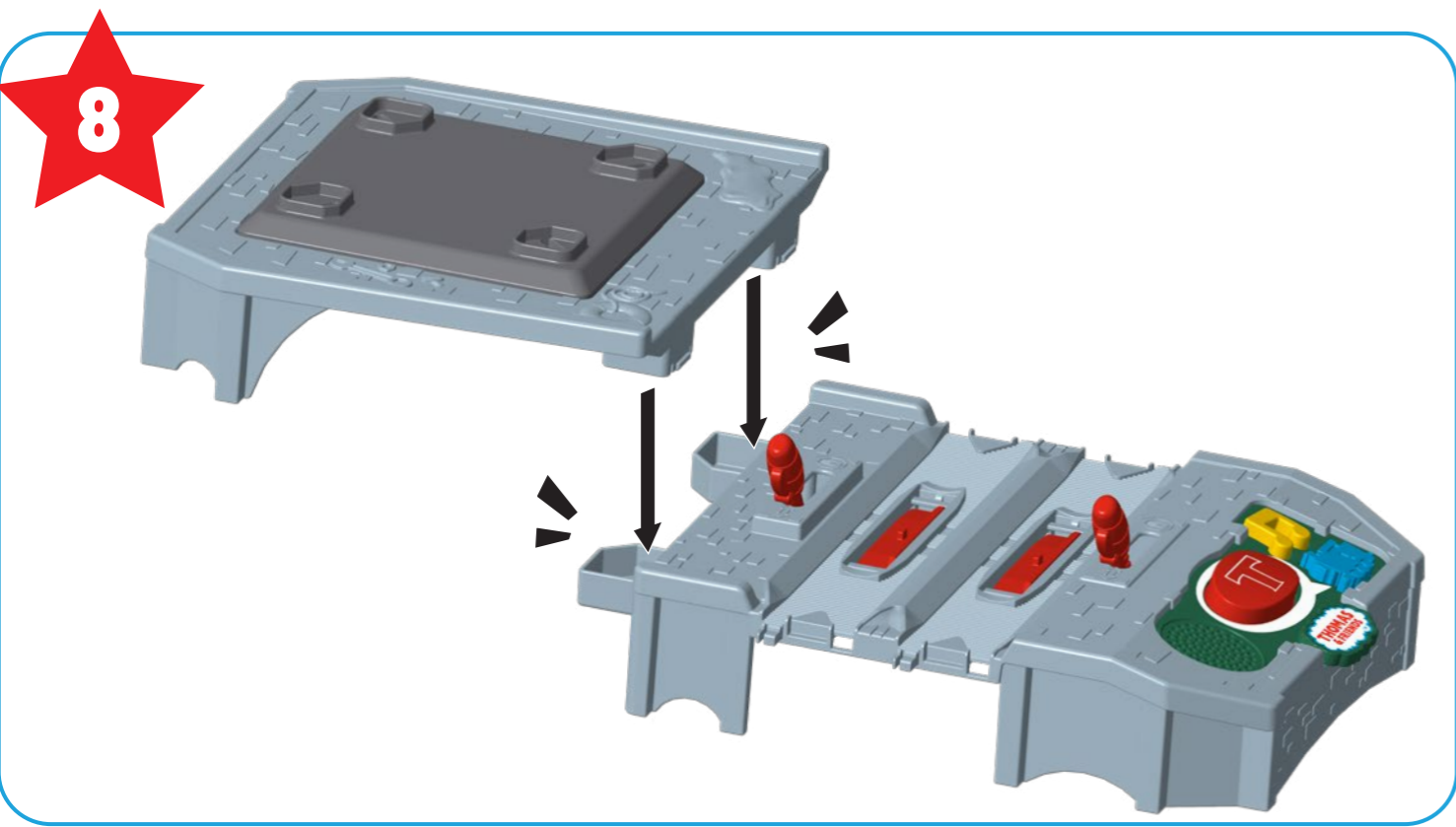

Battery Information

- REQUIRES:**
- Phillips screwdriver (not included) for battery installation.
 - Two AAA (LR03) and two AA (LR6) **alkaline** batteries (included).

- BATTERY SAFETY INFORMATION**
- In exceptional circumstances batteries may leak fluids that can cause a chemical burn injury or ruin your product. To avoid battery leakage:
- Non-rechargeable batteries are not to be recharged.
 - Rechargeable batteries are to be removed from the product before being charged.
 - Rechargeable batteries are only to be charged under adult supervision.
 - Do not mix alkaline, standard (carbon-zinc), or rechargeable batteries.
 - Do not mix old and new batteries.
 - Only batteries of the same or equivalent type as recommended are to be used.
 - Batteries are to be inserted with the correct polarity (+ and -).
 - Exhausted batteries are to be removed from the product.
 - The supply terminals are not to be short-circuited.
 - Dispose of batteries safely.
 - Do not dispose of this product in a fire. The batteries inside may explode or leak.

FCC STATEMENT (UNITED STATES ONLY)

This equipment has been tested and found to comply with the limits for a Class B digital device, pursuant to Part 15 of the FCC rules. These limits are designed to provide reasonable protection against harmful interference in a residential installation. This equipment generates uses and can radiate radio frequency energy and, if not installed and used in accordance with the instructions, may cause harmful interference to radio communications. However, there is no guarantee that interference will not occur in a particular installation. If this equipment does cause harmful interference to radio or television reception, which can be determined by turning the equipment off and on, the user is encouraged to try to correct the interference by one or more of the following measures:

- Reorient or relocate the receiving antenna.
- Increase the separation between the equipment and receiver.
- Consult the dealer or an experienced radio/TV technician for help.

NOTE: Changes or modifications not expressly approved by the manufacturer responsible for compliance could void the user's authority to operate the equipment. This device complies with Part 15 of the FCC Rules. Operation is subject to the following two conditions:

(1) This device may not cause harmful interference, and (2) this device must accept any interference received, including interference that may cause undesired operation.

CAN ICES-3 (B)/NMB-3 (B)

Operation is subject to the following two conditions: (1) this device may not cause interference, and (2) this device must accept any interference, including interference that may cause undesired operation of the device. L'utilisation de ce dispositif est autorisée seulement aux conditions suivantes : (1) il ne doit pas produire de brouillage et (2) il doit pouvoir tolérer tout brouillage radioélectrique reçu, même si ce brouillage est susceptible de compromettre son fonctionnement.

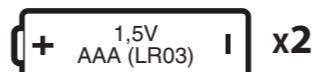

BATTERY INSTALLATION

Access the battery compartment by loosening the screw in the bottom of engine and separating the top halves of the engine from the bottom halves of the engine. Remove the worn batteries and properly dispose. Insert new batteries as indicated inside battery compartment. Re-assemble the halves of engine and tighten each screw. If the engine begins to malfunction, first check battery installation. You may need to reset the electronics by removing the batteries and reinstalling them. If the engine continues to malfunction or no longer operates, it's time to replace the batteries with fresh batteries. For longer life, use **alkaline** batteries.

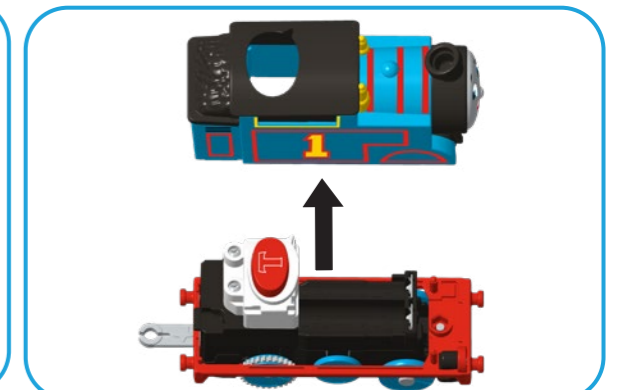
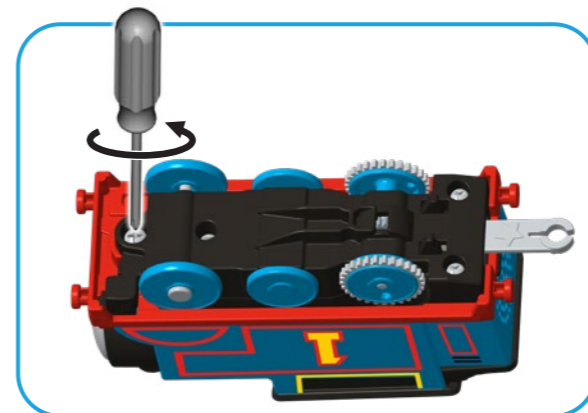

Loosen the screw in the bottom of console box battery compartment door and remove the door. Install batteries as indicated inside the battery compartment. Replace the battery compartment door and tighten the screw.

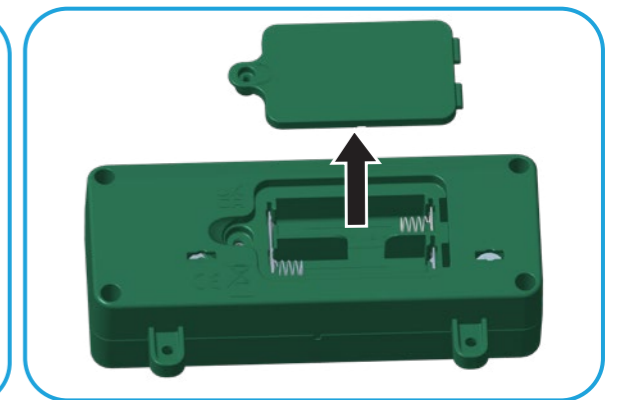
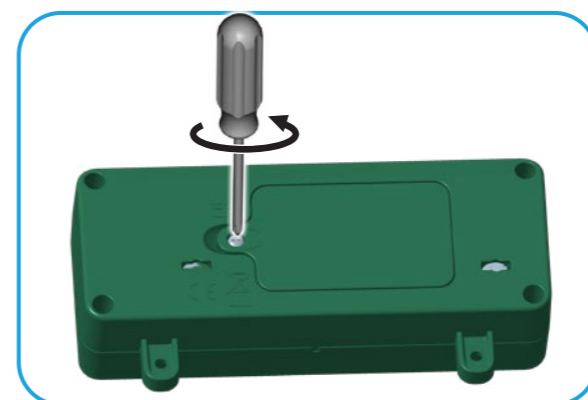

Troubleshooting

Two or more interactive engines can interact with each other (other interactive engines sold separately and subject to availability.)

| PROBLEM | SOLUTION |
|--|---|
| An engine does not move but still talks and its front light blinks three times | When battery power is low, the engine front light blinks three times. Be sure to replace batteries with two, new AAA (LR03) alkaline batteries. |
| The engine stops and talks. | If the button on the engine is pressed to pause movement or it is stopped on a stop track, it stops to chat and then starts moving again. Press the red button on electronic console, the engine will also stop to chat and then start moving again. |
| An engine doesn't move or talk | The engine is in sleep mode (after about five minutes of inactivity) or is paused. Press the button on the engine to wake it up. Batteries are dead. Replace the batteries with two, new AAA (LR03) alkaline batteries |
| The engine and electronic console do not react to each other | Battery power may be low. Replace batteries with two, new AAA (LR03) alkaline batteries for the engine or two, new AA (LR6) batteries for electronic console or both of them. The distance between the engine and electronic console is too great. Make sure the engine and electronic console are no further apart than six feet (1,8 meters). The light in the room may be too bright. Try dimming light by closing curtains or turning a light off. The engine enters sleep mode after about five minutes of inactivity. Press the button on the engine to wake it up. |
| The engine does not seem to totally turn off | Press and hold the engine button for about three seconds to completely turn off power. |
| The electronic console does not seem to totally turn off | Press and hold the red button on the electronic console for about three seconds to completely turn off power. |
| An engine from another set does not work on track in this set. | Some engines from other sets will not fit on this track set. Only interactive engines will interact with engine and electronic console included with this set. |

Track Layout

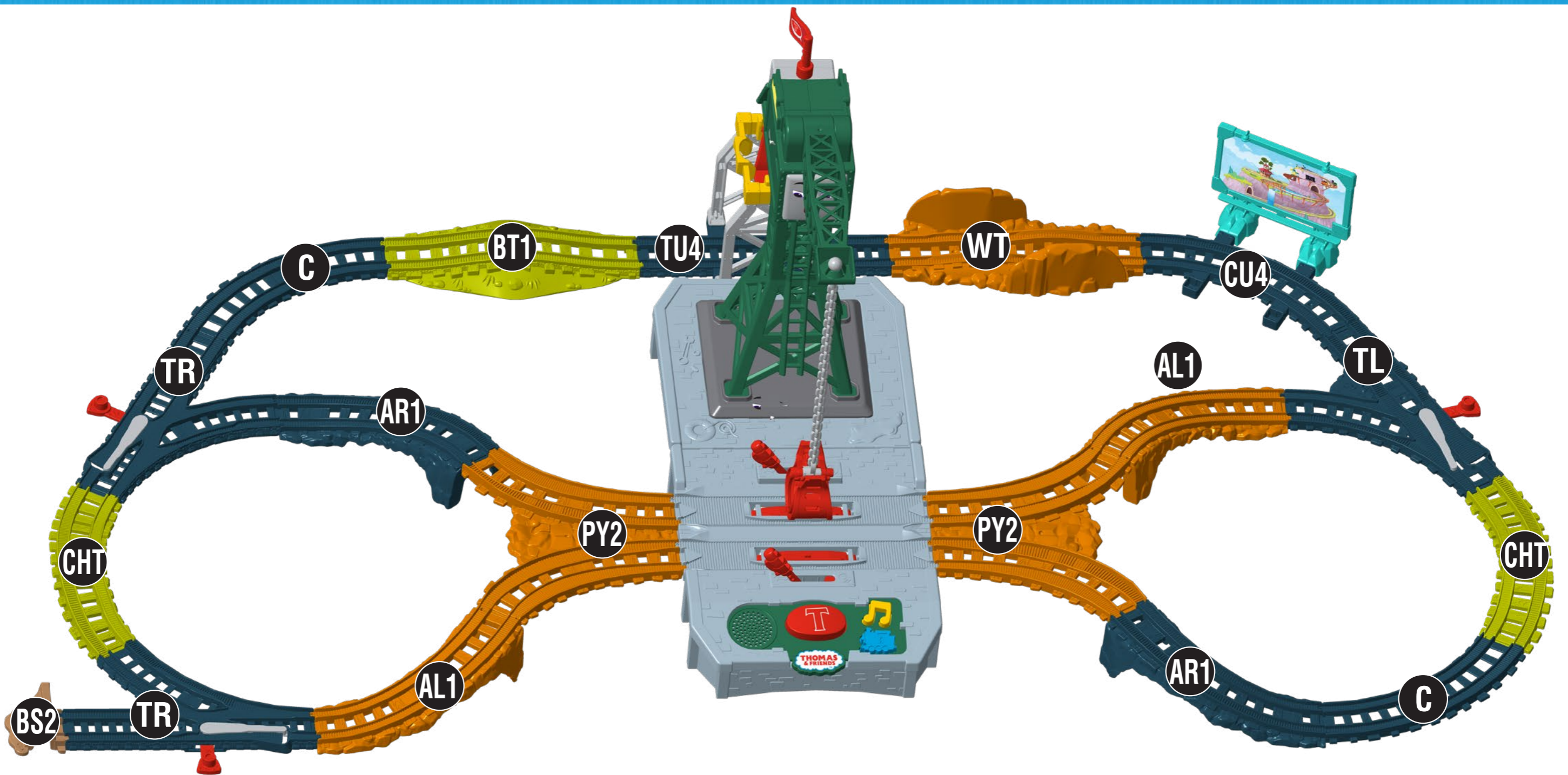

Let's Play

1 Use the switch tracks to change tracks.

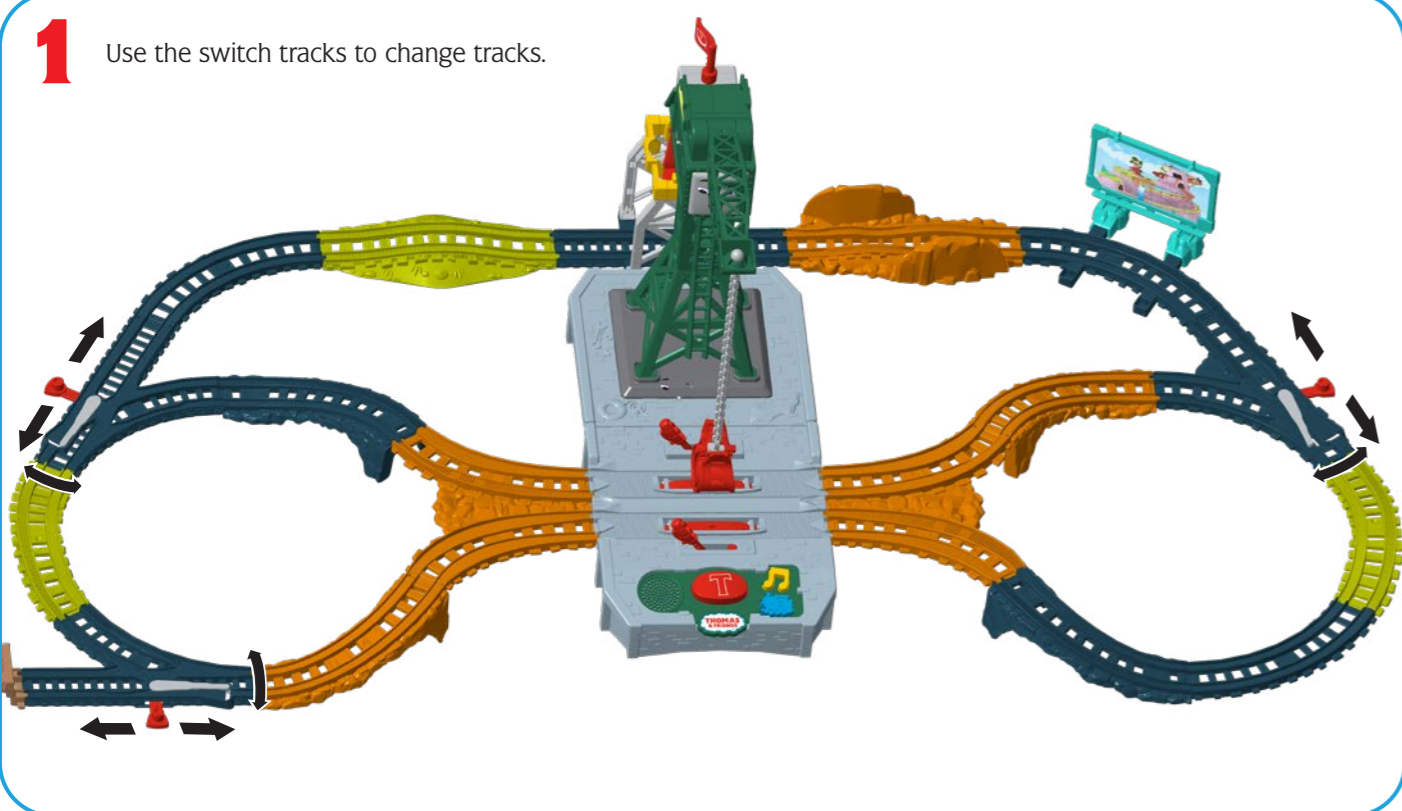

2 Set the stop-track to "STOP".

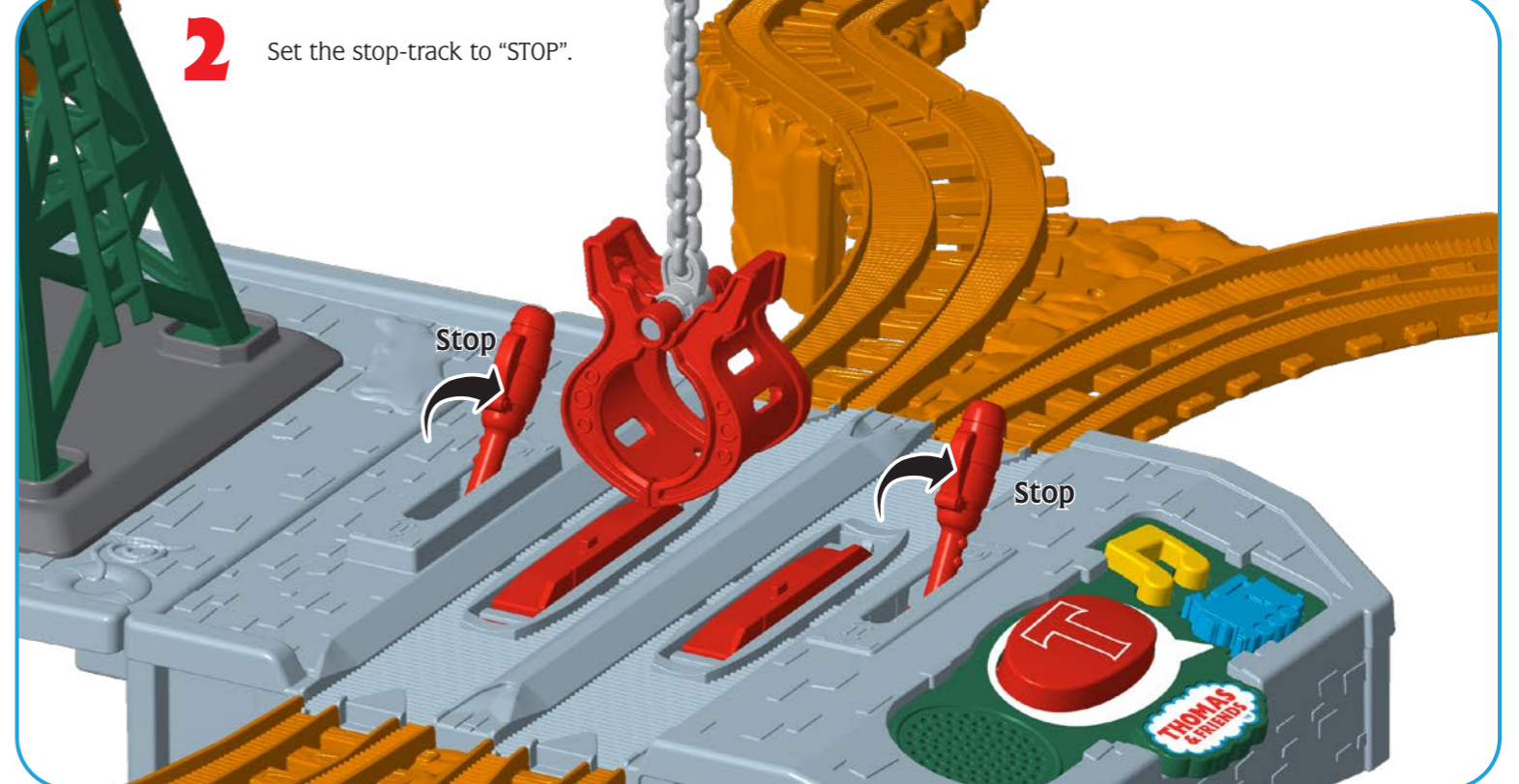

3 Place engine with cargo car on the track and load a cargo crate into the cargo car.

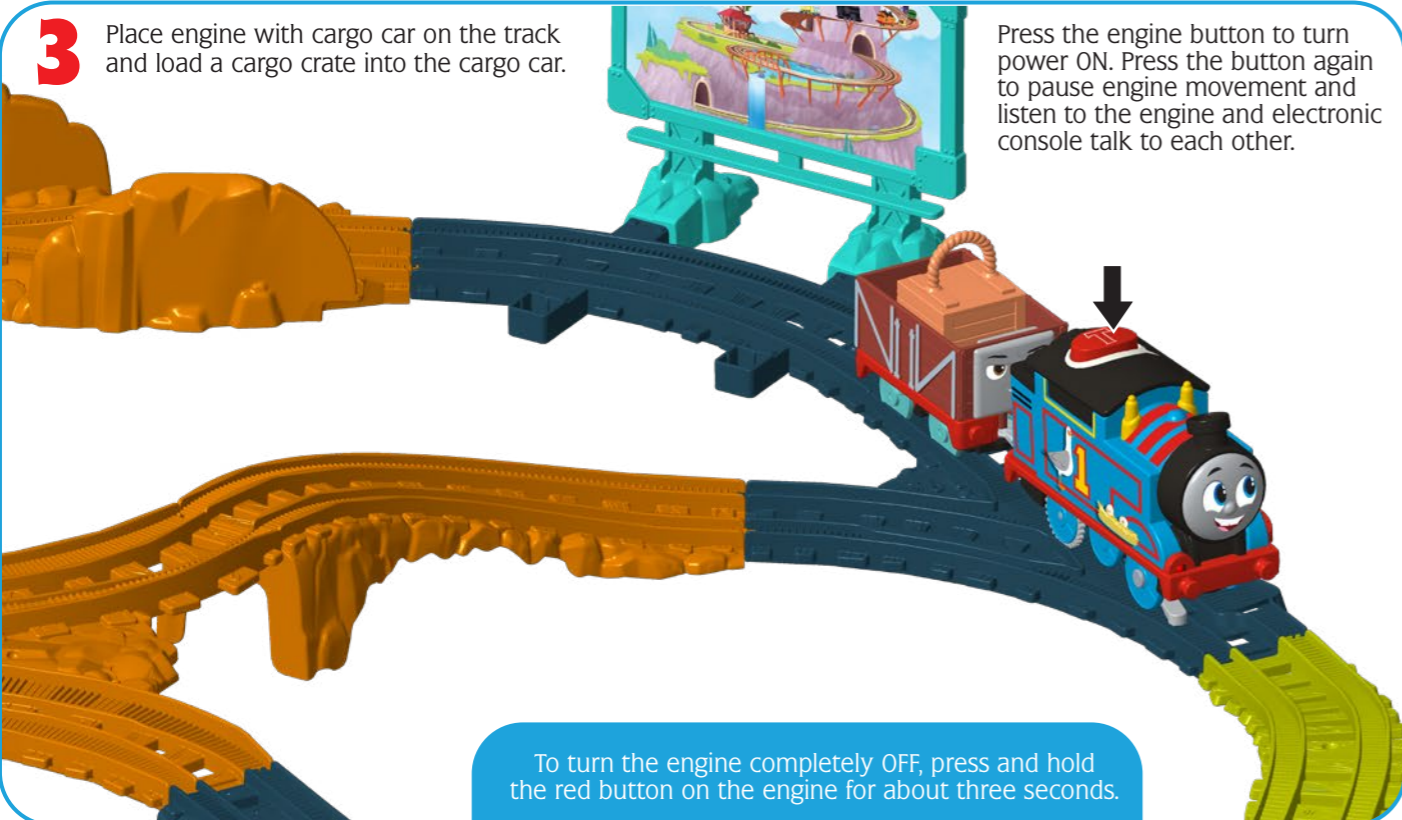

Press the engine button to turn power ON. Press the button again to pause engine movement and listen to the engine and electronic console talk to each other.

To turn the engine completely OFF, press and hold the red button on the engine for about three seconds.

4 When the engine stops at the stop track, listen to the engine and electronic console talk to each other, then press one of the red buttons to continue the conversation...

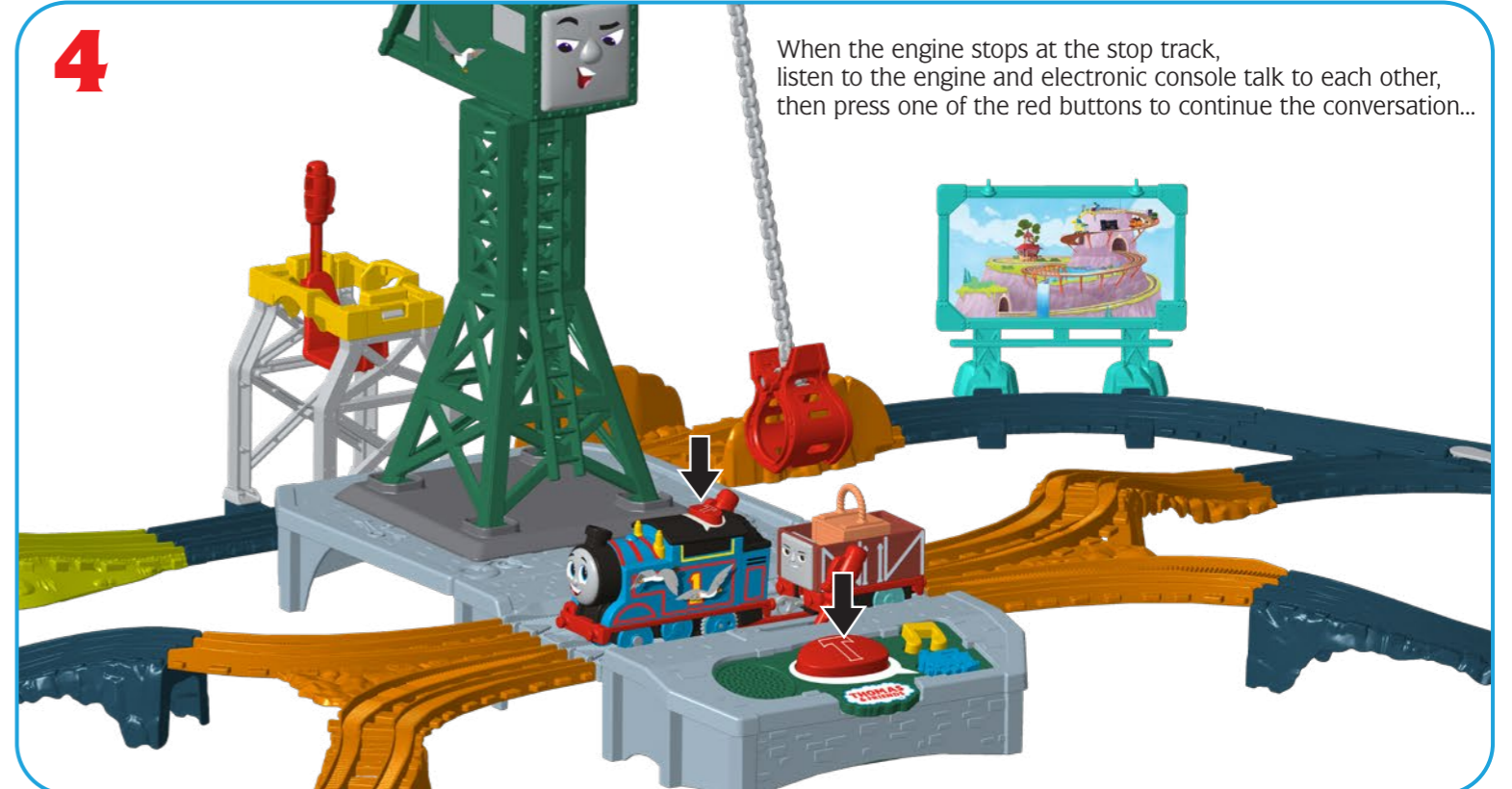

5 Manually spin the Crane, grab the cargo crate and drop it down the cradle.

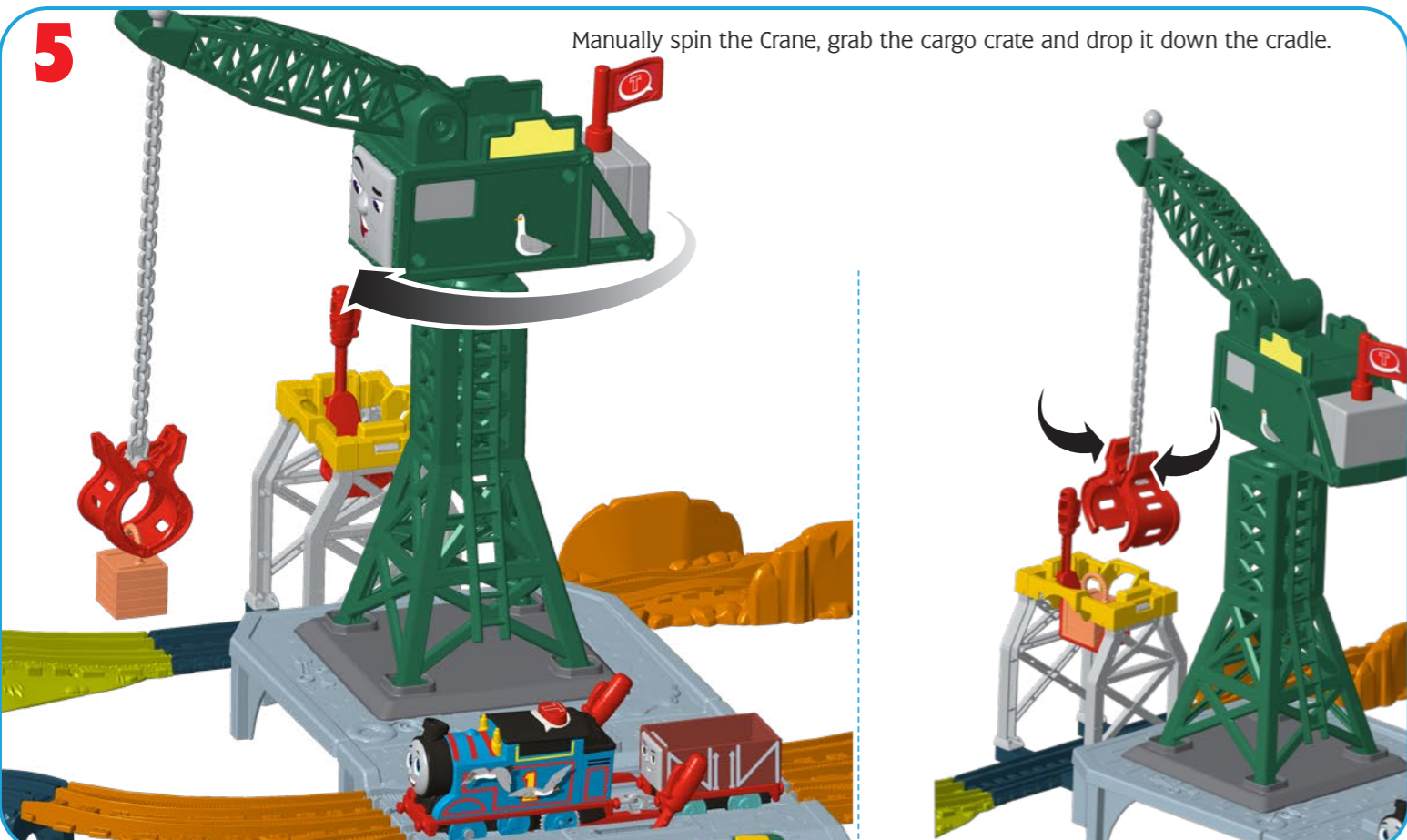

6 Flip the lever and watch the engine GO! Push the lever back into the stop position for the next time the engine comes around the track.

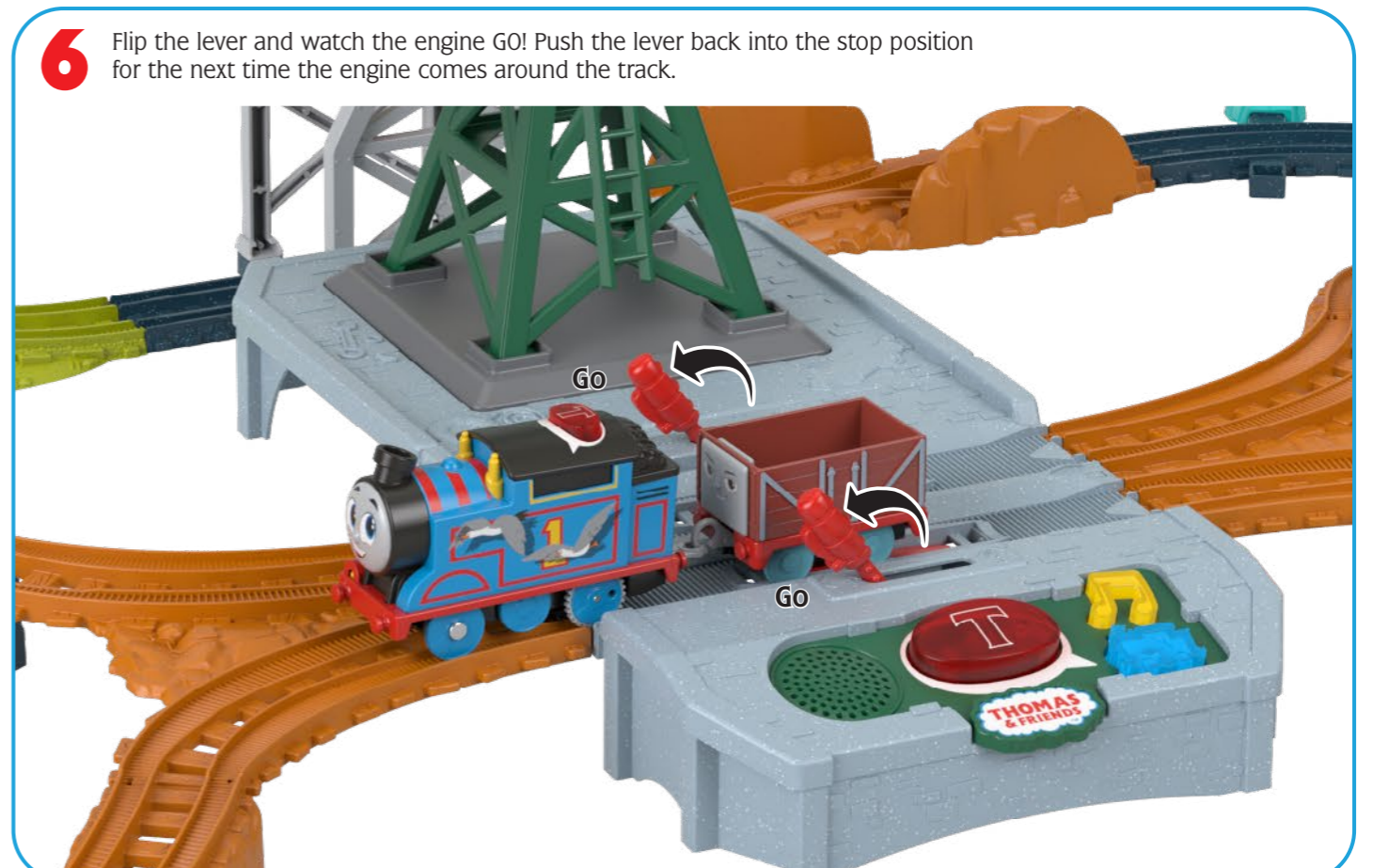

Let's Play

7 Press the lever to tip the cradle so that the cargo crate can fall into the cargo car when it passes by.



8 Press red button for lights, sounds & phrases, press one of the other two buttons for lights, fun songs & sounds!



To turn electronic console completely OFF, press and hold the red button on the console for about three seconds.

Try These Track Layouts

