

# INSTRUCTIONS

# CONTENTS

Please keep these instructions for future reference as they contain important information.

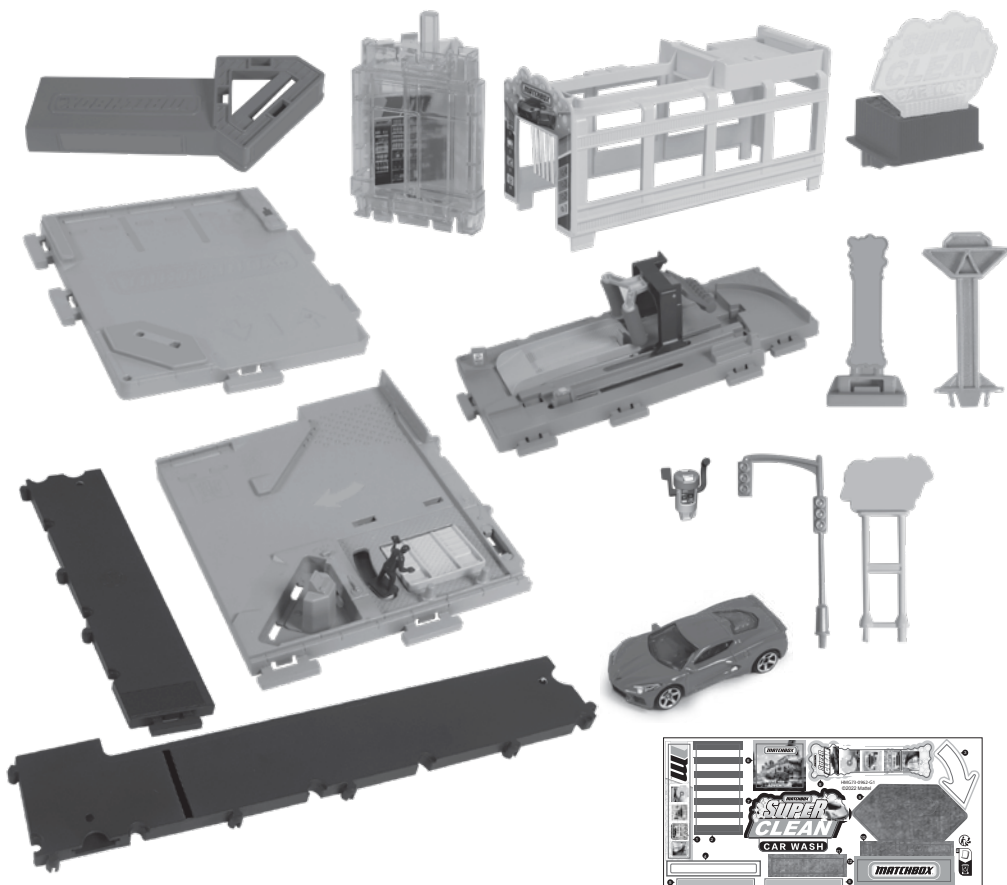

OFFICIAL  
LICENSED PRODUCT

General Motors Trademarks used  
under license to Mattel, Inc.



 **WARNING:**  
CHOKING HAZARD – Small parts.  
Not for children under 3 years.

HMG73-0970-G1  
1102562495-DOM



# 1 APPLY LABELS

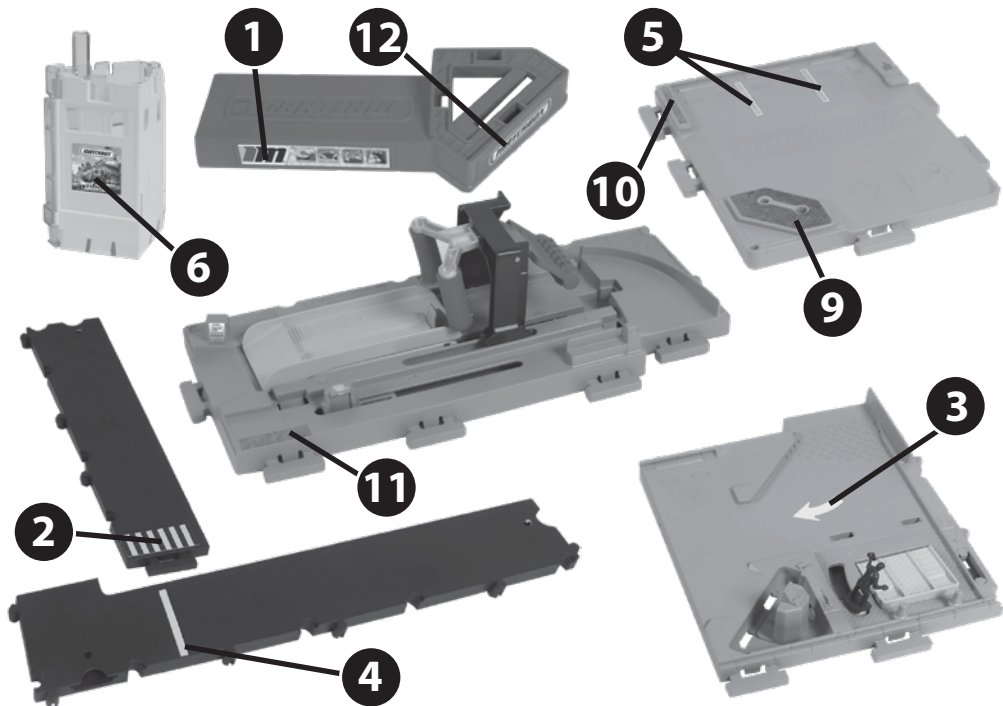

# 2 BATTERY REPLACEMENT

- Batteries included are for demonstration purposes only.
- Replace the batteries if lights dim or sounds distort.
- Unscrew the battery cover with a Phillips head screwdriver (not included).
- Remove batteries and dispose of them safely.
- Install 3 new AG13/LR44 1.5V button cell batteries in the battery box.
- Replace battery cover and tighten screw.
- For best performance, use only alkaline batteries.
- When exposed to an electrostatic source, the product may malfunction. To resume normal operation, remove and reinstall the batteries.

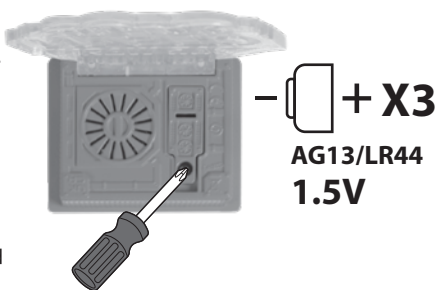

### 3 ASSEMBLY

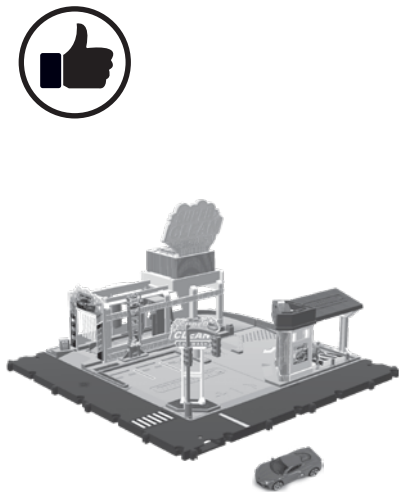
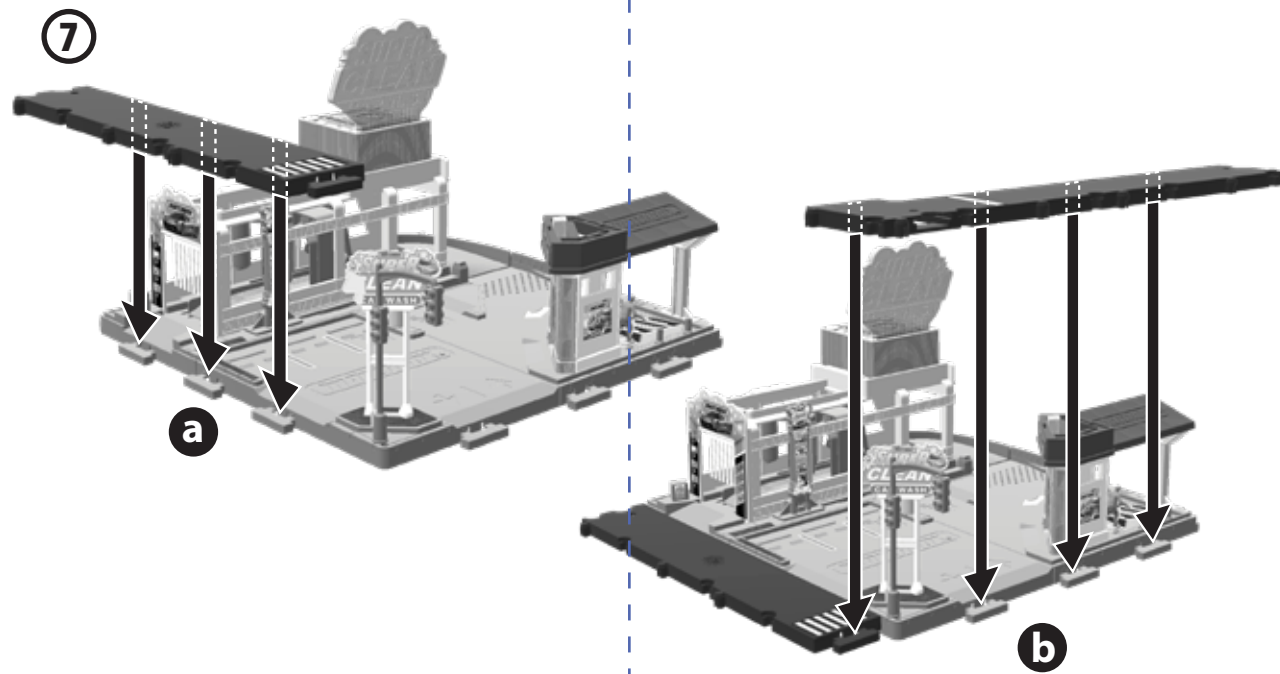
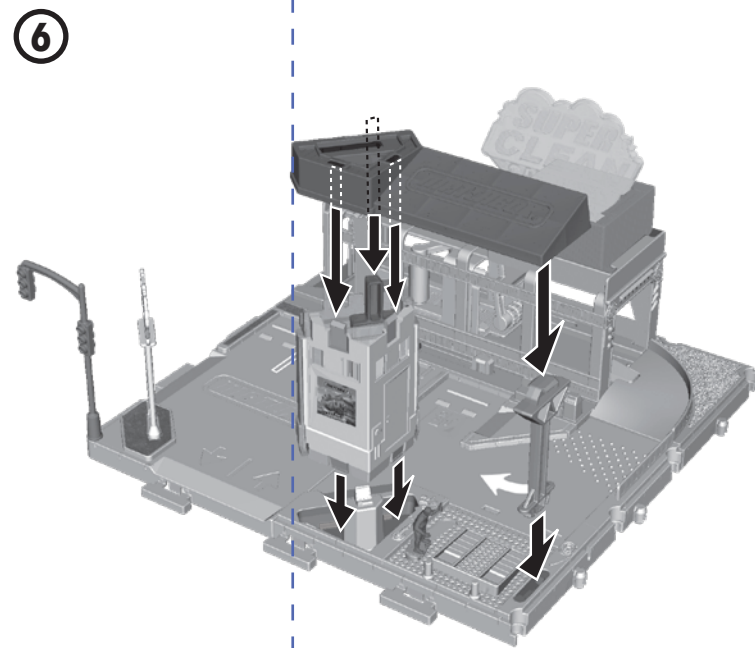
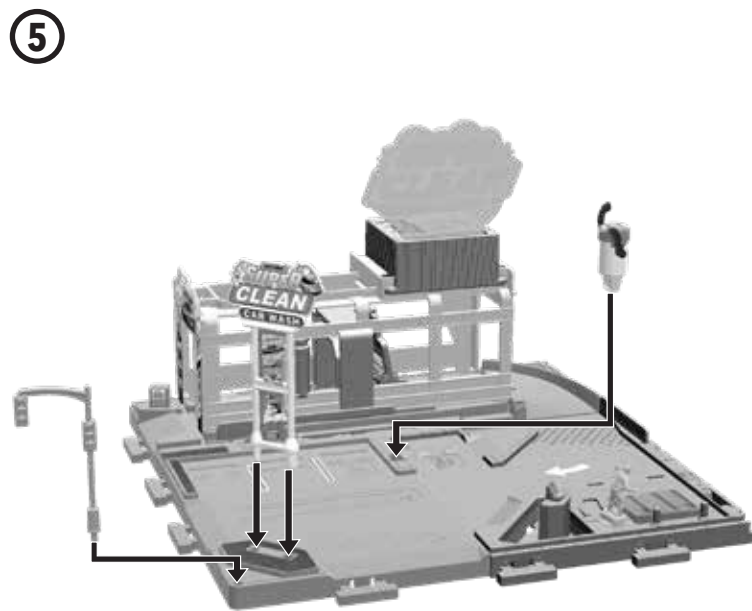
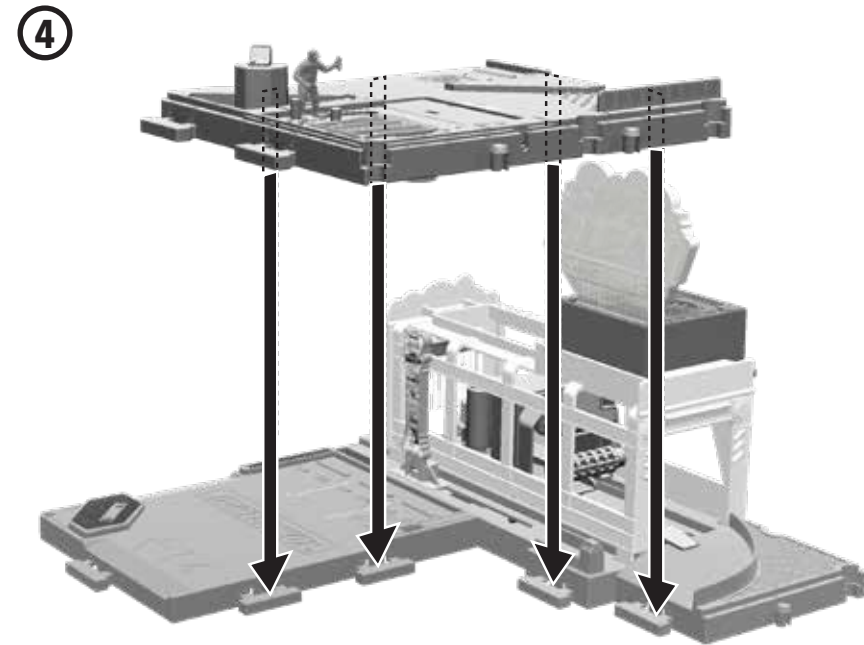
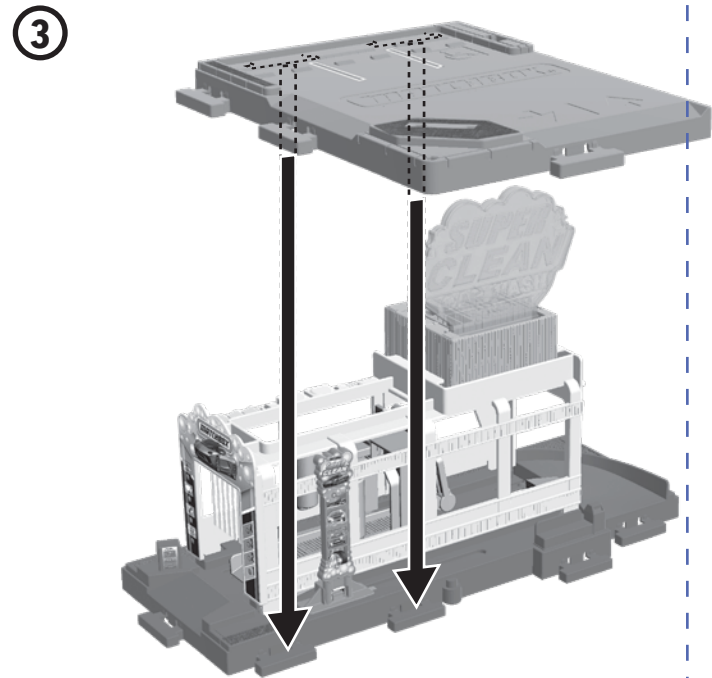
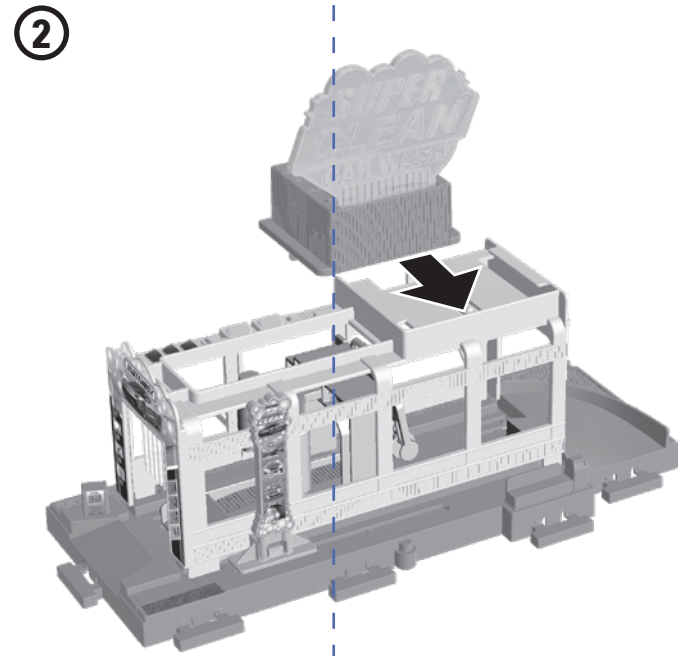
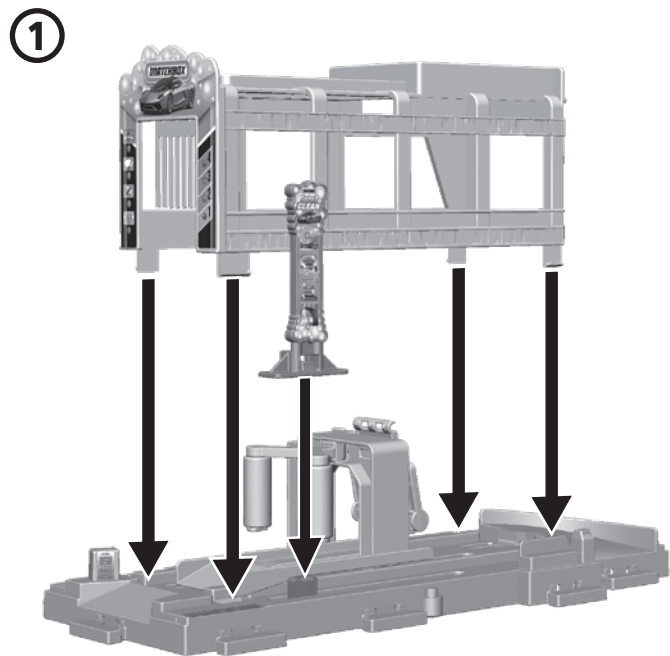



# 4 TO PLAY

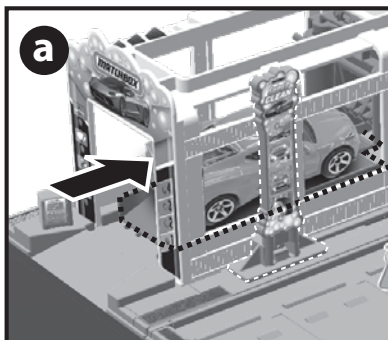

Drive onto platform and slide to activate car wash.

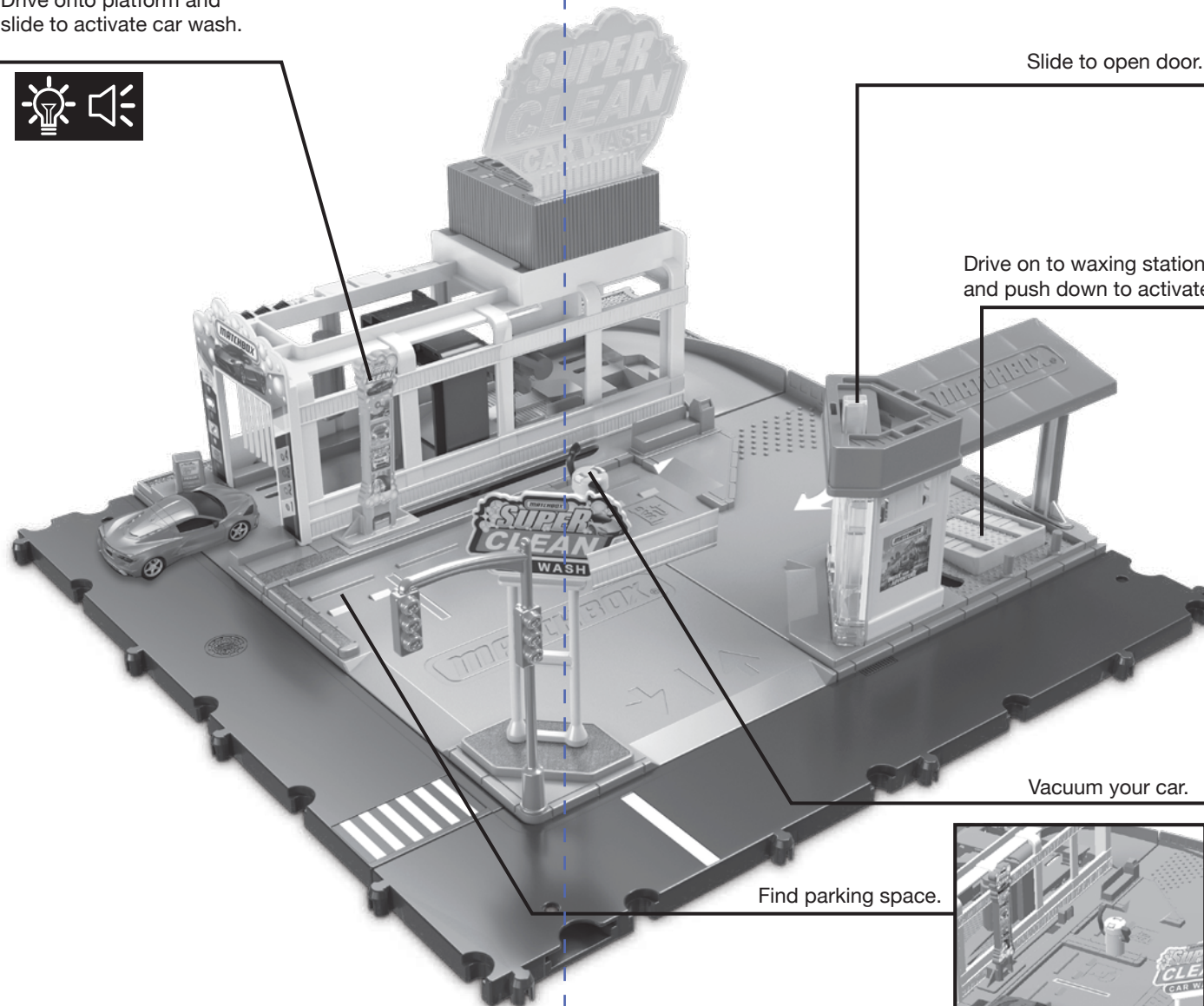
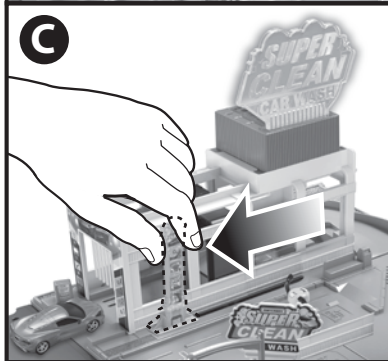
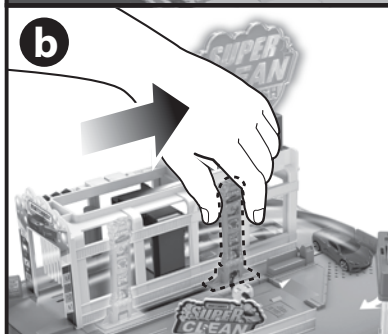

Slide to open door.



Drive on to waxing station and push down to activate.

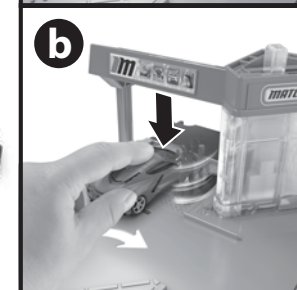
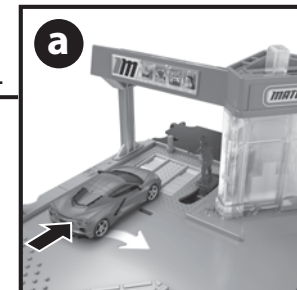

Vacuum your car.

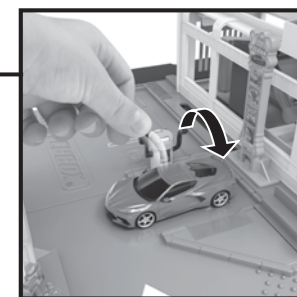

Find parking space.

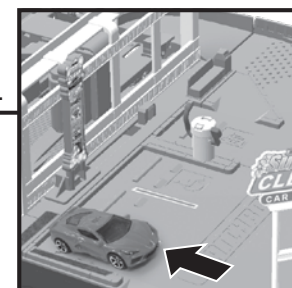

One vehicle included. Additional vehicles sold separately. Not for use with some Matchbox® vehicles.

# 5 MORE WAYS TO PLAY

## ADVERTISEMENT

Connect to other Matchbox® or Hot Wheels® sets to expand your city!



HMG73

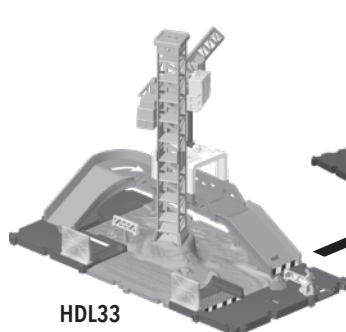

HDL33

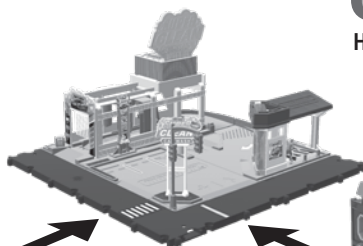

GVN72

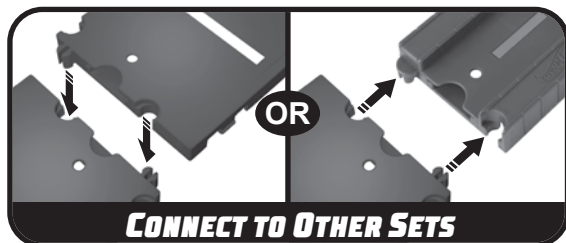
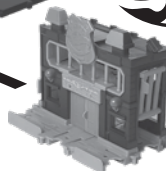

**CONNECT TO OTHER SETS**



**CONNECT TO TRACK**

Additional tracks or sets sold separately, subject to availability.

# 6 DISASSEMBLE & RECYCLE

Do this **ONLY BEFORE RECYCLING** the product. Follow the steps below to remove the electronic components.

①

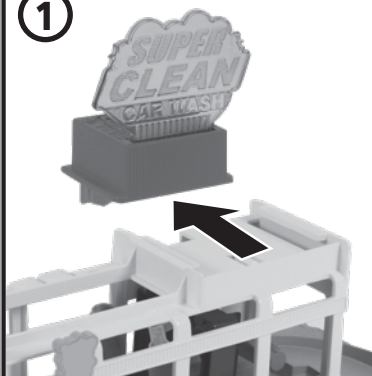

②

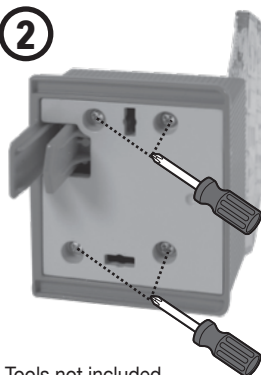

Tools not included.

③

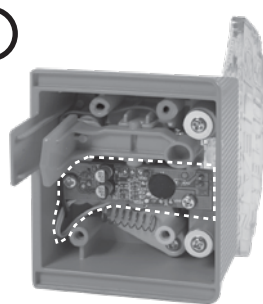

Dispose of electronic waste and plastic separately according to local recycling guidelines.

©2022 Mattel. ® and ™ designate U.S. trademarks of Mattel, except as noted. Mattel, Inc., 636 Girard Avenue, East Aurora, NY 14052, U.S.A. Consumer Services 1-800-524-8697. Mattel U.K. Limited, The Porter Building, 1 Brunel Way, Slough SL1 1FQ, UK. Mattel Australia Pty. Ltd., 658 Church St., Richmond, Victoria, 3121. Consumer Advisory Service - 1300 135 312. Mattel South Africa (PTY) LTD, Office 102 I3, 30 Melrose Boulevard, Johannesburg 2196. Mattel East Asia Ltd., Room 503-09, North Tower, World Finance Centre, Harbour City, Tsimshatsui, HK, China. Tel.: (852) 3185-6500. Diimport & Diedarkan Oleh: Mattel Continental Asia Sdn Bhd. Level 19, Tower 3, Avenue 7, No. 8 Jalan Kerinchi, Bangsar South, 59200 Kuala Lumpur, Malaysia.

? [service.mattel.com](http://service.mattel.com)