

fisher-price®



HMJ55

2-Sided Steady Speed™ Tiger Walker

# Before You Begin



Keep these instructions for future reference as they contain important information.

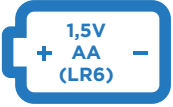

**x3**

Three AA batteries are required (not included).

**Alkaline** batteries make this toy work longer before you need to change them.



Clean with a damp cloth. Do not immerse.



Adult assembly is required (because we needed to fit this toy in the box).



**10**

Plan on about 10 minutes for assembly.



You'll need a Phillips screwdriver (not included) for assembly and battery installation. Do not over-tighten assembled screws or the screw in the battery door.

# Assembled Parts

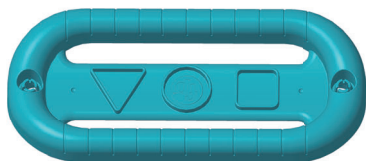
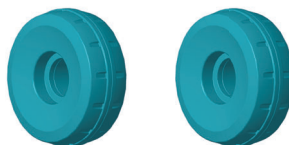
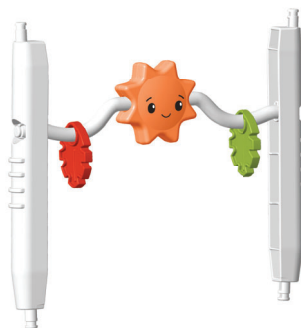

M4,5 x 16 mm

**⚠ CAUTION**

This package contains small parts.  
For adult assembly only.

# Assembled Parts



# Assembly

1

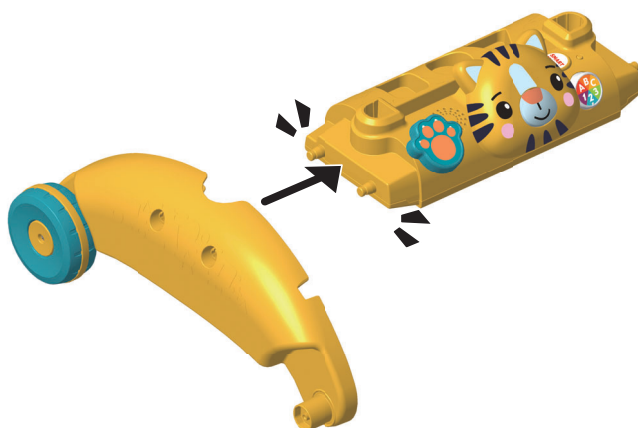

# Assembly

2

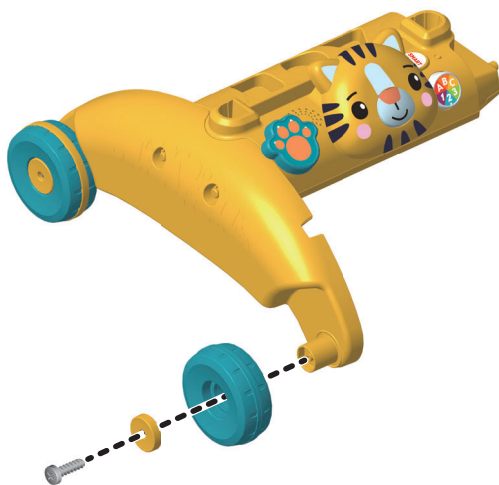

3

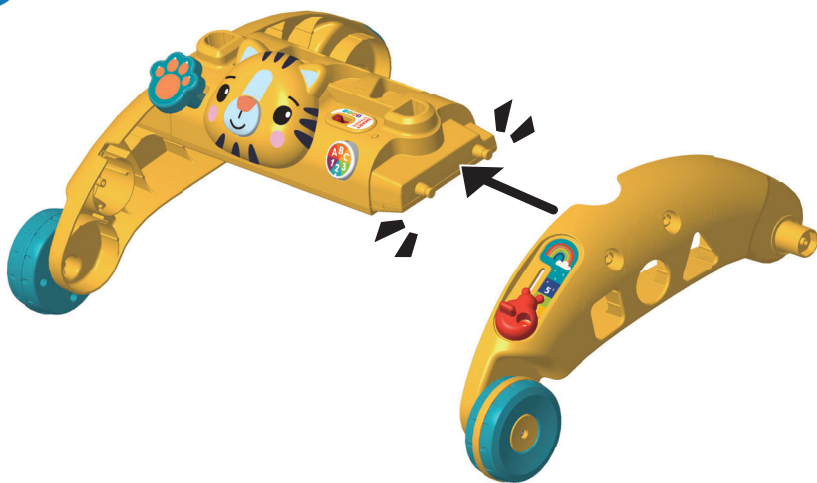

# Assembly

4



5



# Assembly

6



7

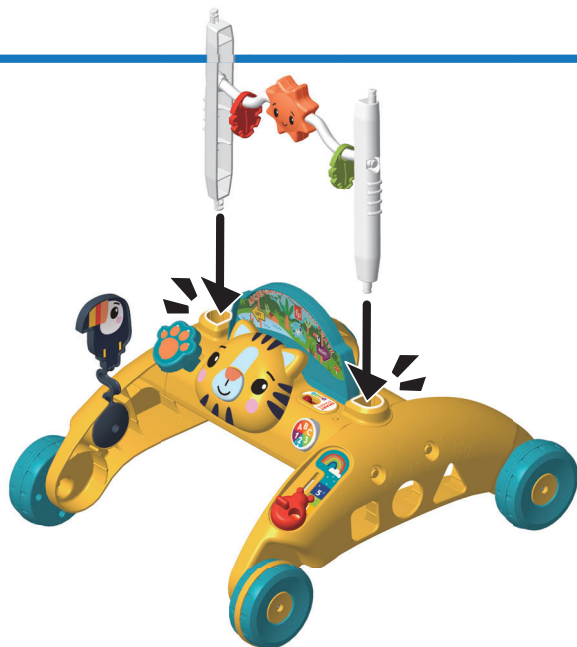

# Assembly

8



9



Pull up on the handle to be sure it's secure.



# Install Batteries

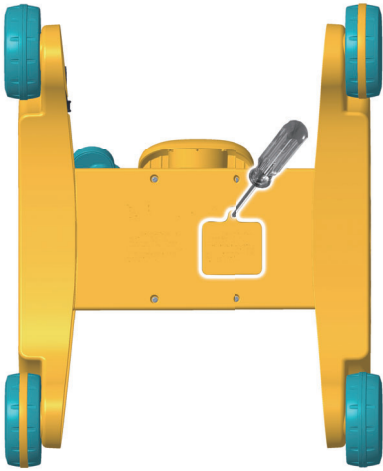

Loosen the screw in the battery door and remove the door. Insert three, new AA (LR6) **alkaline** batteries. Make sure you insert the batteries correctly!

Replace the battery door and tighten the screw.

You may need to reset the electronics if this toy begins to operate erratically. Slide the power-mode switch off and back on.

When sound or lights become faint or stop, it's time for an adult to change the batteries.

# Power & Modes



Press the  
horn

Press the button



- 1 **Explore** – Enjoy fun sounds, music, first words and phrases that introduce opposite and colours!
  - 2 **Encourage** – Along with sounds, phrases and songs about the alphabet and counting, listen for a fun prompt followed by a reward!
  - 3 **Pretend** – Listen to engaging music and phrases that inspire imaginative play!
- **Off**

## Battery Safety Information

In exceptional circumstances, batteries may leak fluids that can cause a chemical burn injury or ruin your product. To avoid battery leakage:

- Do not mix old and new batteries or batteries of different types: alkaline, standard (carbon-zinc) or rechargeable.
  - Insert batteries as indicated inside the battery compartment (+ and -).
  - Remove batteries during long periods of non-use. Always remove exhausted batteries from the product. Dispose of batteries safely. Do not dispose of this product in a fire. The batteries inside may explode or leak.
  - Never short-circuit the battery terminals.
  - Use only batteries of the same or equivalent type, as recommended.
  - Do not charge non-rechargeable batteries.
  - Remove rechargeable batteries from the product before charging.
  - If removable, rechargeable batteries are used, they are only to be charged under adult supervision.
- 



Protect the environment by not disposing of this product or any batteries with household waste. This symbol indicates that this product shall not be treated as household waste. Check your local authority for recycling advice and facilities.



**Great Britain:** Mattel U.K. Limited, The Porter Building, 1 Brunel Way, Slough SL1 1FQ, UK. [www.service.mattel.com/uk](http://www.service.mattel.com/uk).

Mattel Europa B.V., Gondel 1, 1186 MJ Amstelveen, Nederland.

**Australia:** Mattel Australia Pty. Ltd., 658 Church Street, Locked Bag #870, Richmond, Victoria 3121 Australia.  
Consumer Advisory Service 1300 135 312.

**New Zealand:** 16-18 William Pickering Drive, Albany 1331, Auckland.

**Asia:** Mattel East Asia Ltd., Room 503-09, North Tower, World Finance Centre, Harbour City, Tsimshatsui, HK, China. Tel.: (852) 3185-6500.

**Malaysia:** Diimport & Diedarkan Oleh: Mattel Continental Asia Sdn Bhd. Level 19, Tower 3, Avenue 7, No. 8 Jalan Kerinchi, Bangsar South, 59200 Kuala Lumpur, Malaysia.

**South Africa:** Mattel South Africa (PTY) LTD, Office 102 I3, 30 Melrose Boulevard, Johannesburg 2196.

# Let's be kids

HMJ55-KM70  
1102758735-UU1

©2022 Mattel.  
PRINTED IN CHINA