

fisher-price

**THOMAS
& FRIENDS™**

PAINT DELIVERY SET



Adult assembly required.

INSTRUCTIONS

HTN34

Keep these instructions for future reference as they contain important information.

What's Included

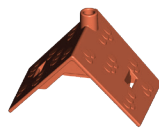

BS2



CBT

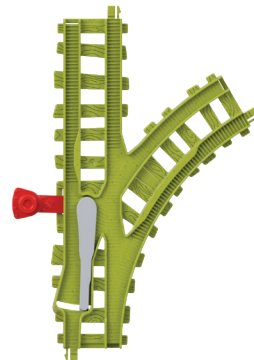

TR

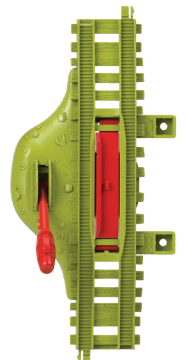

SS1

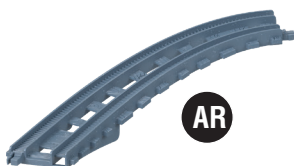
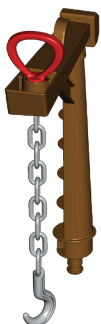

AR

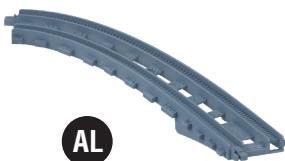

AL



C x2

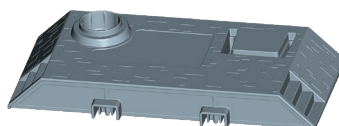
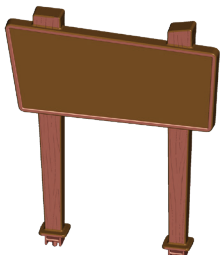

BT2

Helpful Hints

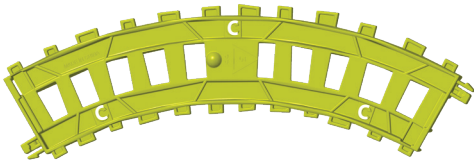

Look for codes on the bottom of each track.



This set includes tracks with a bend so that the engine can climb up and travel down!

Some engines may not work on this track set.



Assembly steps marked with a star indicate a permanent assembly. Once these parts are assembled, they can't be taken apart.



Protect the environment by not disposing of this product or any batteries with household waste. This symbol indicates that this product shall not be treated as household waste. Check your local authority for recycling advice and facilities.

Assembly

1



2

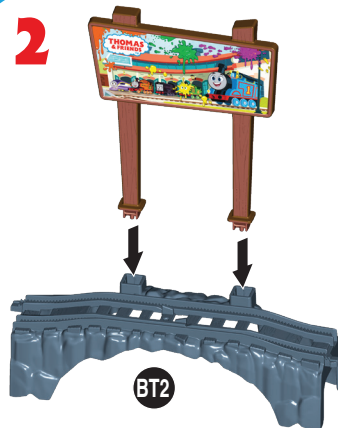

3



4



5



6



Battery Information

REQUIRES:

- Phillips screwdriver (not included) for battery installation.
- Two AAA (LR03) **alkaline** batteries (not included).

BATTERY INSTALLATION

Access the battery compartment by loosening the screw in the bottom of the engine and separating the top half of the engine from the bottom half of the engine. Install the batteries as indicated inside the battery compartment. Re-assemble the halves of the engine and tighten the screw. If the engine begins to malfunction, first check battery installation. You may need to reset the electronics by removing the batteries and reinstalling them. If the engine continues to malfunction or no longer operates, it's time to replace the batteries with fresh batteries. For longer life, use **alkaline** batteries.

BATTERY SAFETY INFORMATION

In exceptional circumstances batteries may leak fluids that can cause a chemical burn injury or ruin your product. To avoid battery leakage:

- Non-rechargeable batteries are not to be recharged.
- Rechargeable batteries are to be removed from the product before being charged.
- Rechargeable batteries are only to be charged under adult supervision.
- Do not mix alkaline, standard (carbon-zinc), or rechargeable batteries.
- Do not mix old and new batteries.
- Only batteries of the same or equivalent type as recommended are to be used.
- Batteries are to be inserted with the correct polarity (+ and -).
- Exhausted batteries are to be removed from the product.
- The supply terminals are not to be short-circuited.
- Dispose of batteries safely.
- Do not dispose of this product in a fire. The batteries inside may explode or leak.

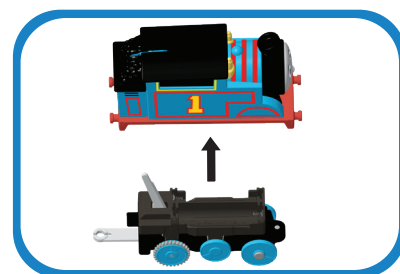
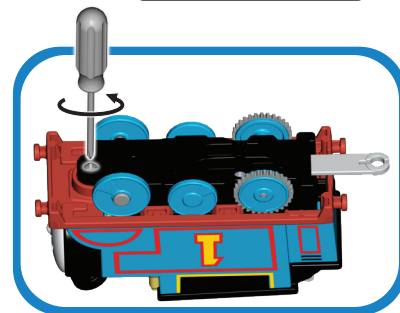
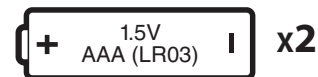

Track Layout

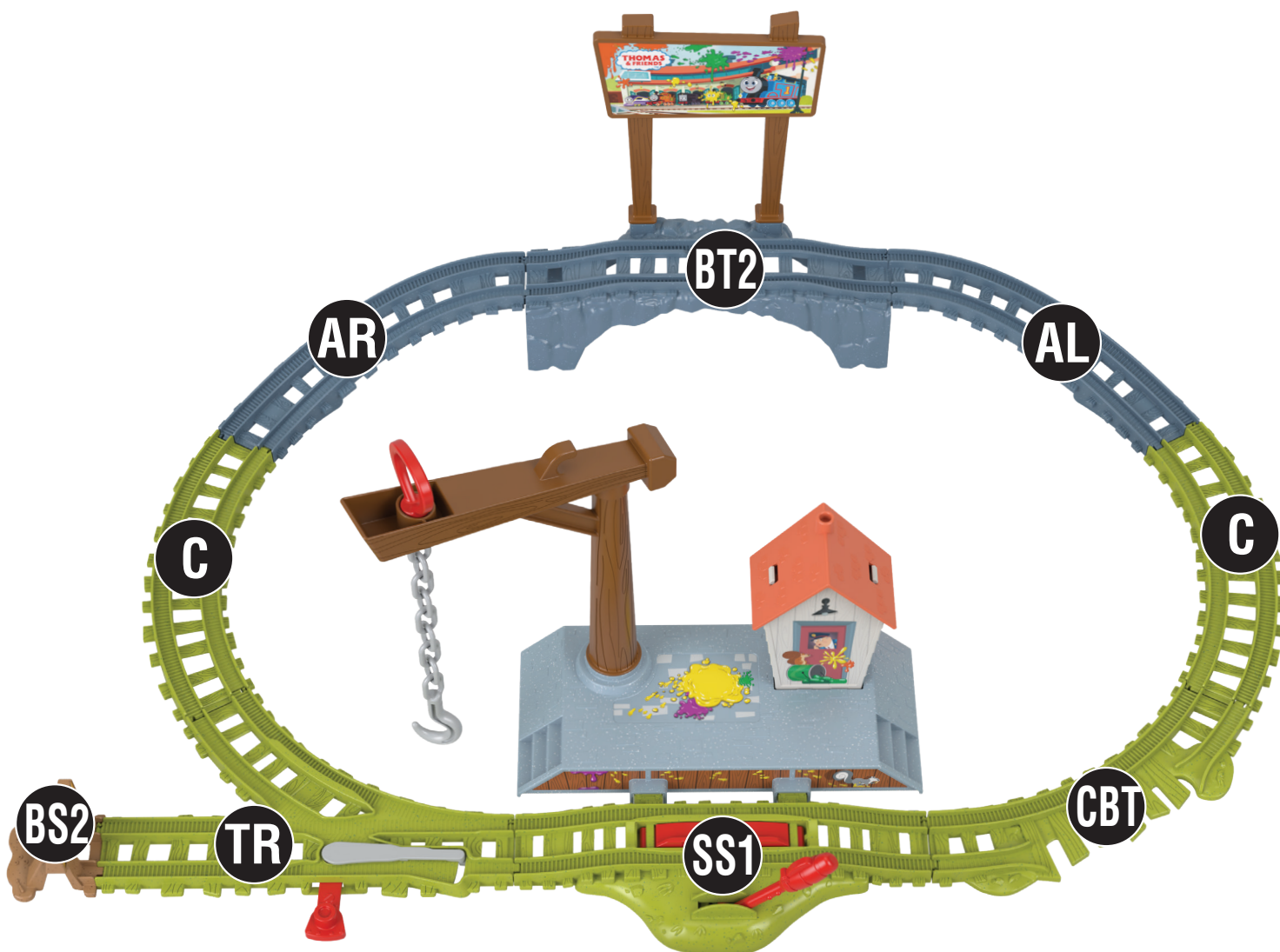

Let's Play!

Use the switch track to change tracks.

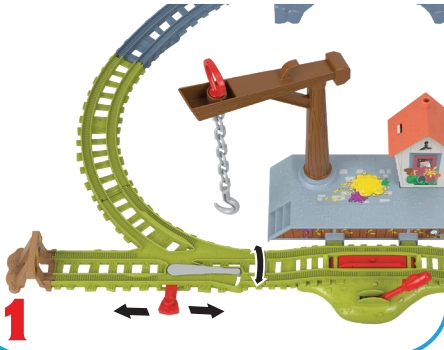

Set the stop track to "STOP" and place paint cans on the platform.



Place the engine with Troublesome Truck™ on the track. Flip the switch on the back of the engine to turn power on.

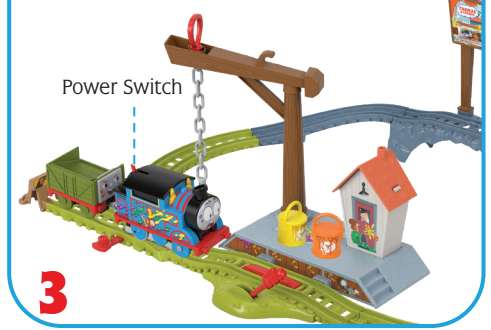

Manually raise & lower the hook to deliver the paint cans.



Hook the paint cans, then rotate the crane to load it into Troublesome Truck™.

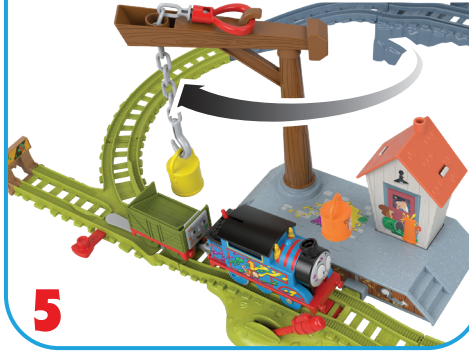

Press the lever to release the engine. Set the stop track to "STOP" for the next time the engine comes around.



The paint can drops down as Troublesome Truck™ passes the bridge.



CREATED BY BRIT ALLCROFT

Based on the Railway Series by The Reverend W Awdry.

©2025 Gullane (Thomas) Limited. Thomas the Tank Engine & Friends™ and Thomas & Friends™ are trademarks of Gullane (Thomas) Limited.

©2025 HIT Entertainment Limited. HIT and the HIT logo are trademarks of HIT Entertainment Limited.

©2025 Mattel. ® and ™ designate U.S. trademarks of Mattel, except as noted.

Mattel Europa B.V., Godel 1, 1186 MJ Amstelveen, Nederland.

Mattel, Inc., 636 Girard Avenue, East Aurora, NY 14052, U.S.A.

Consumer Services 1-800-524-8697 and 1-800-432-5437 for Fisher Price products.

Mattel U.K. Limited, The Porter Building, 1 Brunel Way, Slough SL1 1FQ, UK.

Mattel Australia Pty. Ltd., 658 Church St., Richmond, Victoria, 3121. Consumer Advisory Service - 1300 135 312.

16-18 William Pickering Drive, Albany 1331, Auckland.

Mattel Barbie (Shanghai). Trading Co., Ltd. Room 2005, 20th Floor, 899 Ruining Road, Xuhui District, Shanghai, 200232, PRC.

Customer Care Line: 400-819-8658.

Kids Kingdom Limited, Room 1908-9, Gala Place, 56 Dundas Street, Mongkok, Kowloon, Hong Kong, P.R.C. Customer Care Line: (852)2782-0766.

CHICKABIDDY CO., LTD, F5, No. 186, Sec. 4, Nanjing E. Rd., Taipei 10595, Taiwan region. Customer Care Line: 0800 001 256.

Diimport & Diedarkan Oleh: Mattel Continental Asia Sdn Bhd. Level 19, Tower 3, Avenue 7, No. 8 Jalan Kerinchi, Bangsar South, 59200 Kuala Lumpur, Malaysia. Mattel South Africa (PTY) LTD, Office 102 I3, 30 Melrose Boulevard, Johannesburg 2196.

