

CONNECTS TO OTHER PLAYSETS!

Playset not for use with some Matchbox® vehicles.

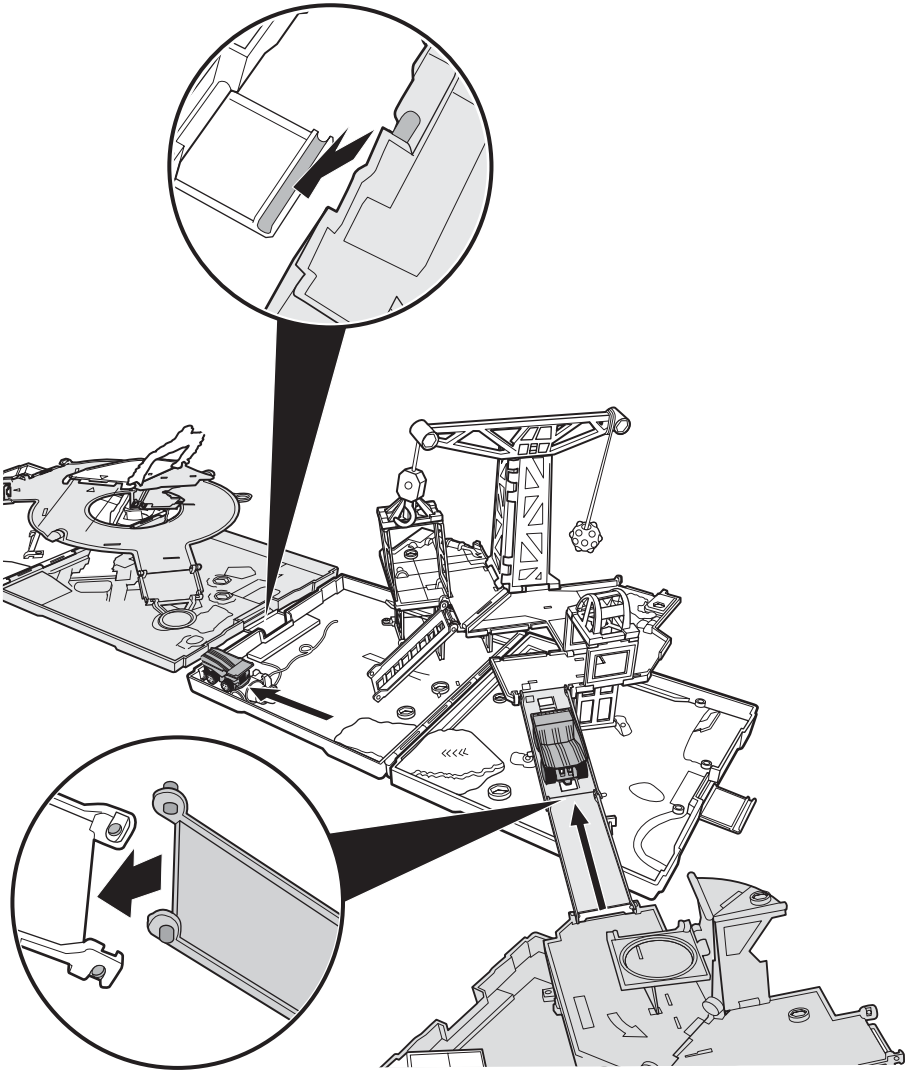

© 2005 Mattel, Inc. All Rights Reserved. **PRINTED IN CHINA.** Mattel, Inc. 333 Continental Blvd., El Segundo, CA 90245 U.S.A. Consumer Relations 1-800-524-8697. service.mattel.com  
Mattel U.K. Ltd., Vanwall Business Park, Maidenhead SL6 4UB. Helpline 01628500303.  
Mattel Australia Pty., Ltd., Richmond, Victoria. 3121.Consumer Advisory Service - 1300 135 312. Mattel East Asia Ltd., Room 1106, South Tower, World Finance Centre, Harbour City, Tsimshatsui, HK, China. Diimport & Diedarkan Oleh: Mattel SEA Ptd Ltd.(993532-P) Lot 13.5, 13th Floor, Menara Lien Hoe, Persiaran Tropicana Golf Country Resort, 47410 PJ. Tel:03-78803817, Fax:03-78803867.

MATCHBOX

INSTRUCTIONS

Please keep these instructions for future reference as they contain important information.

3+



ASST. J1809  
J3922-0920

**WARNING:**  
CHOKING HAZARD - Small parts.  
Not for children under 3 years.

CONTENTS

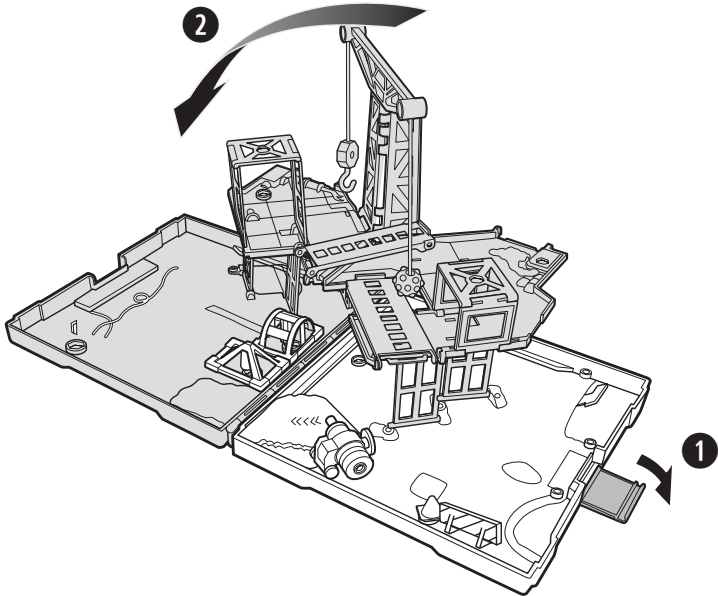
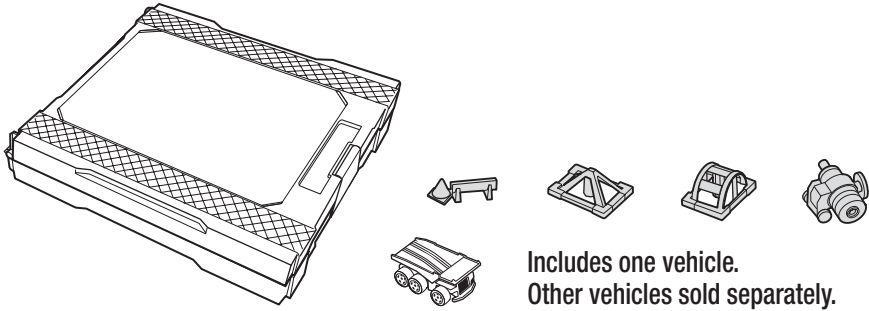

STORAGE

Ramps must be folded up as shown for case to close properly.

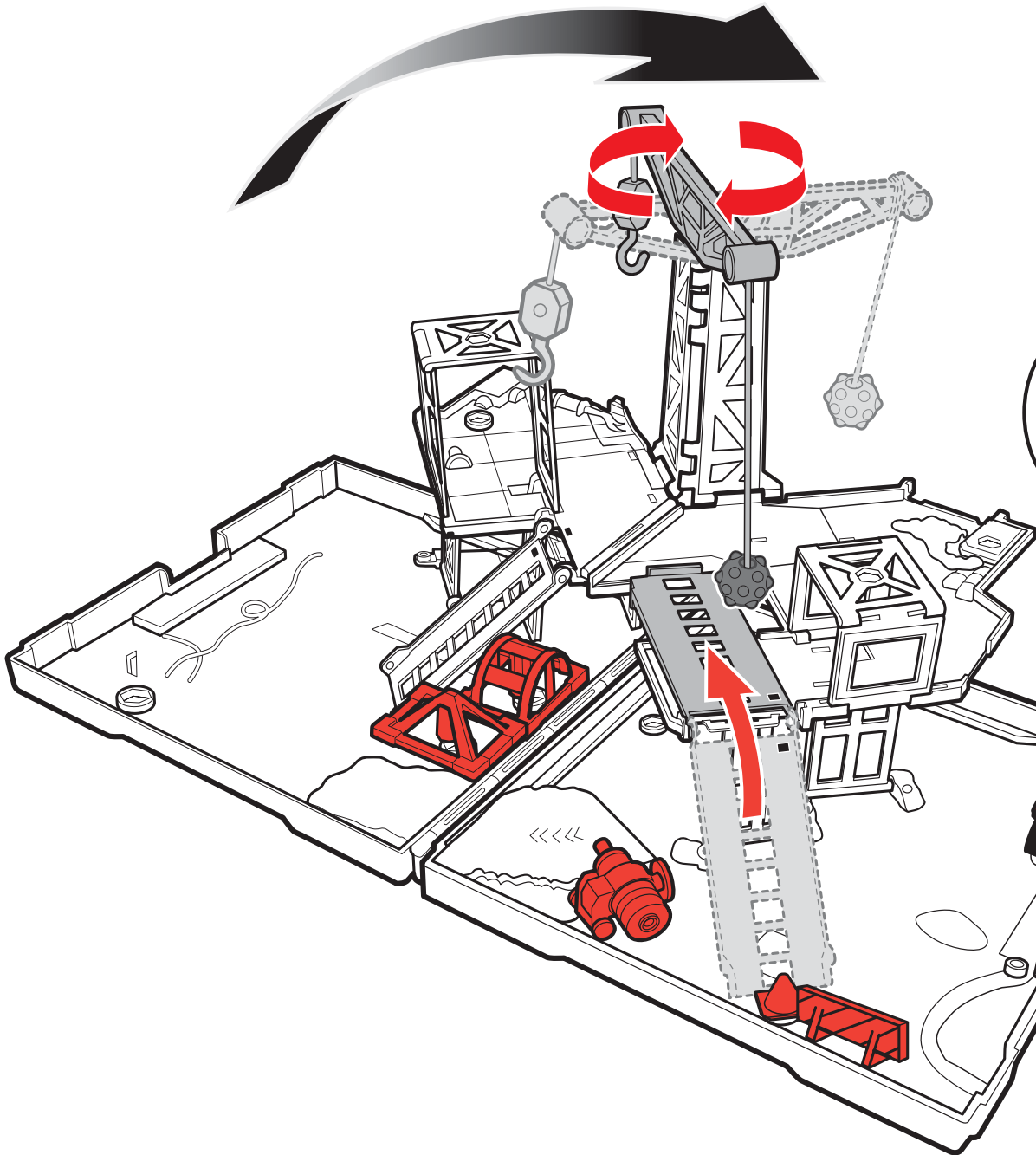

TO PLAY

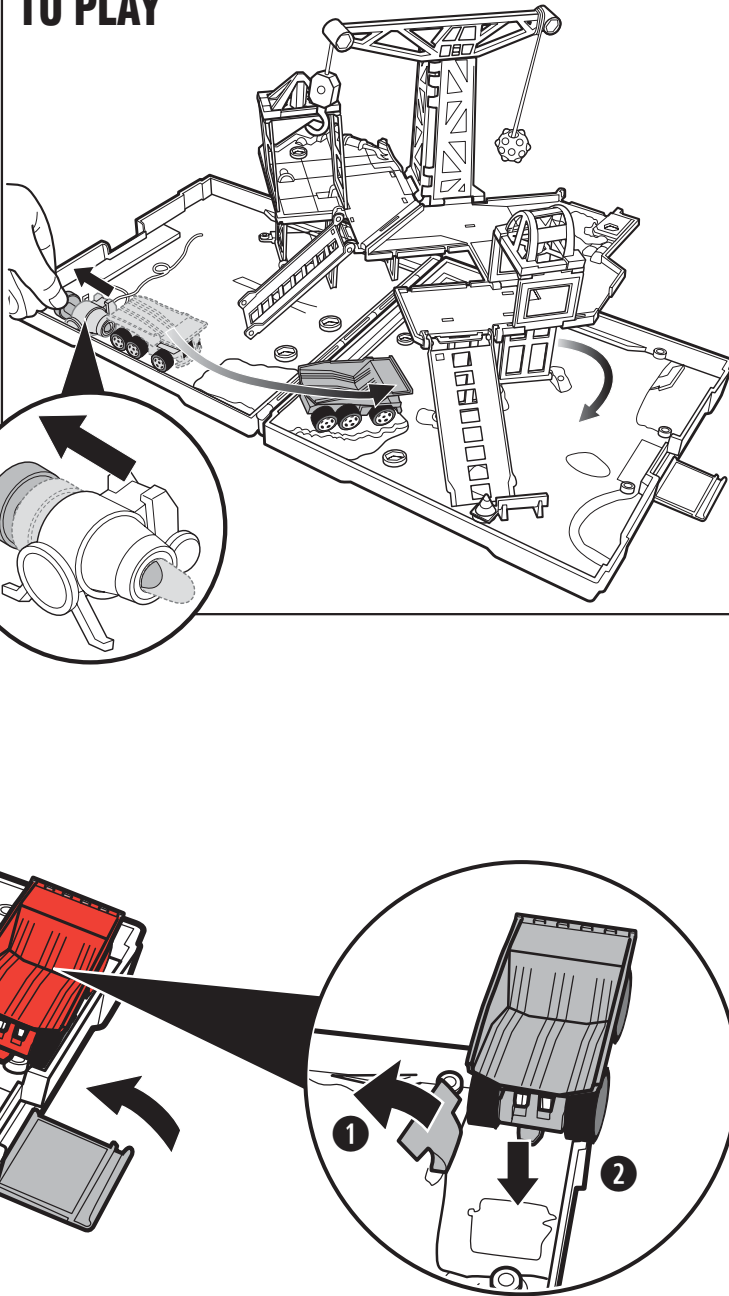

CONNECTS TO OTHER PLAYSETS!

Playset not for use with some Matchbox® vehicles.

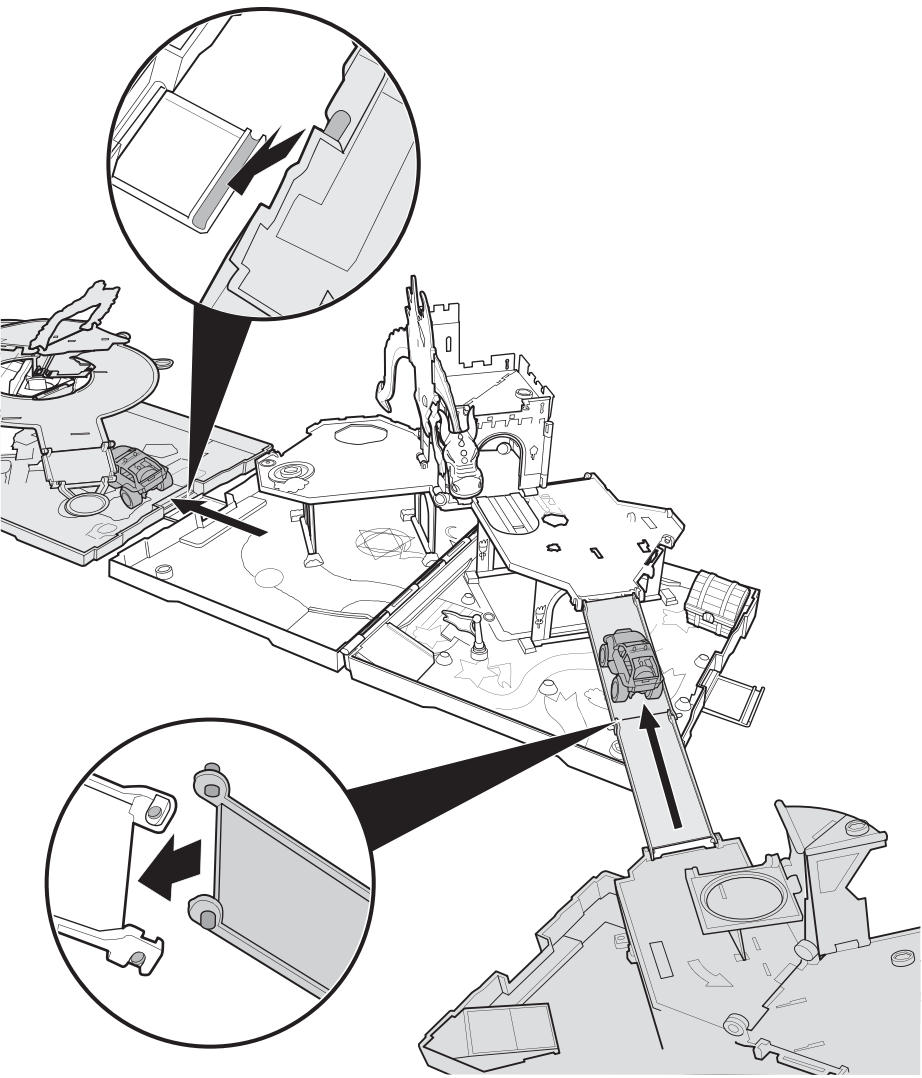

© 2005 Mattel, Inc. All Rights Reserved. **PRINTED IN CHINA.** Mattel, Inc. 333 Continental Blvd., El Segundo, CA 90245 U.S.A. Consumer Relations 1-800-524-8697. service.mattel.com  
Mattel U.K. Ltd., Vanwall Business Park, Maidenhead SL6 4UB. Helpline 01628500303.  
Mattel Australia Pty., Ltd., Richmond, Victoria. 3121.Consumer Advisory Service - 1300 135 312. Mattel East Asia Ltd., Room 1106, South Tower, World Finance Centre, Harbour City, Tsimshatsui, HK, China. Diimport & Diedarkan Oleh: Mattel SEA Ptd Ltd.(993532-P) Lot 13.5, 13th Floor, Menara Lien Hoe, Persiaran Tropicana Golf Country Resort, 47410 PJ. Tel:03-78803817, Fax:03-78803867.

MATCHBOX

INSTRUCTIONS

Please keep these instructions for future reference as they contain important information.

3+



ASST. J1809  
J3923-0920

CONTENTS

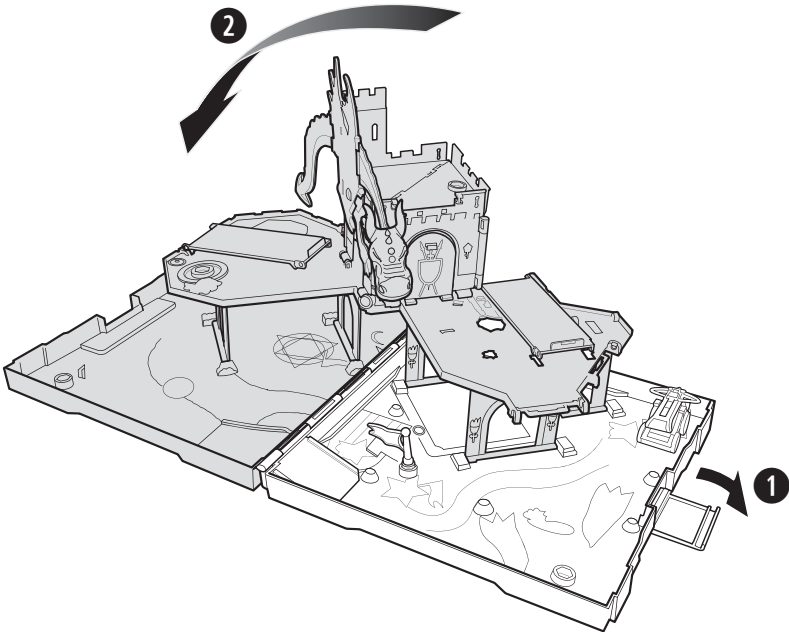
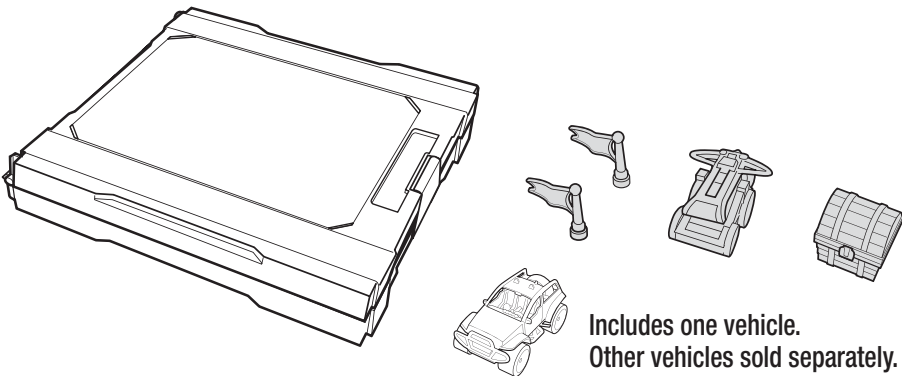

STORAGE

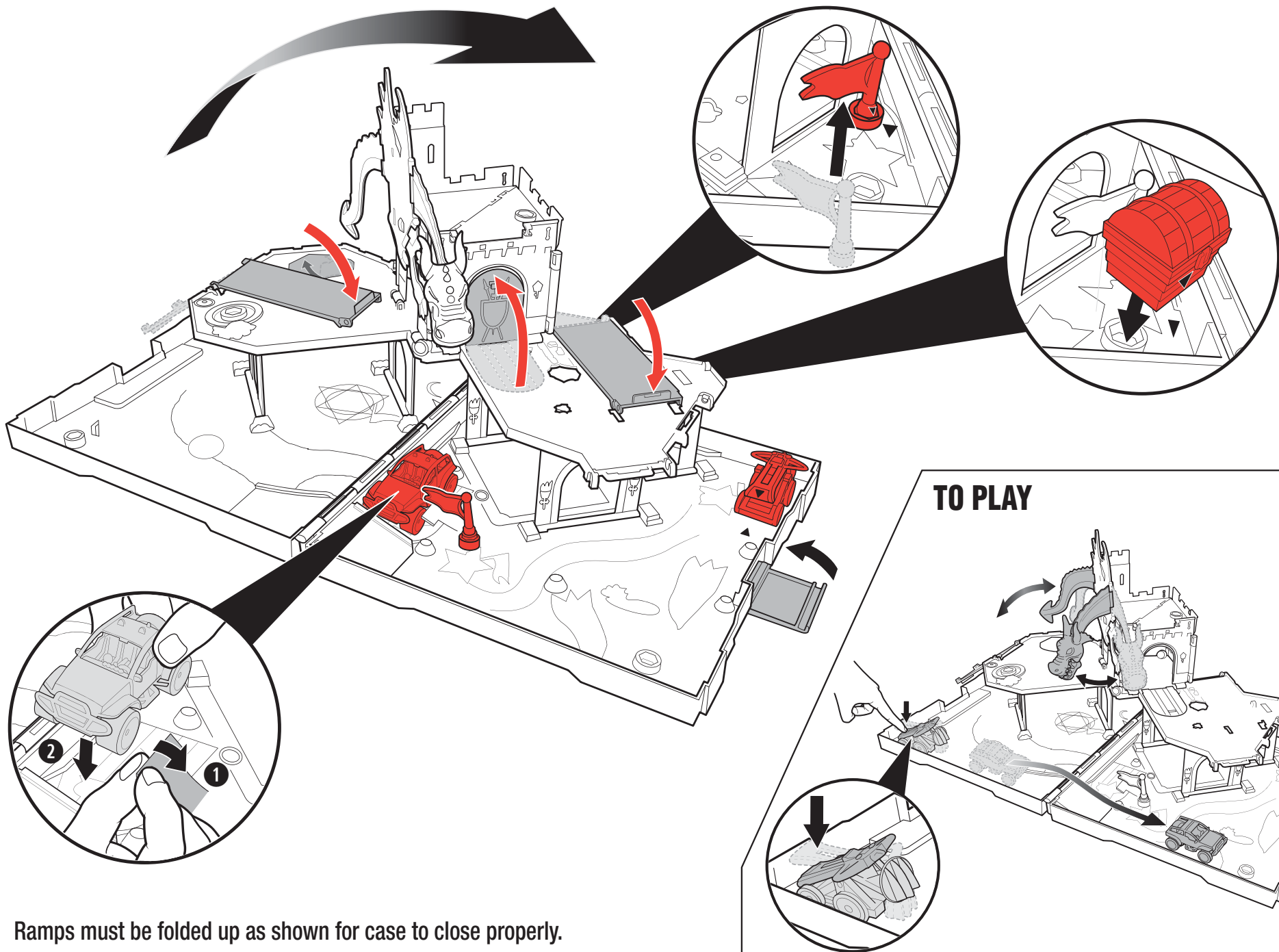

Ramps must be folded up as shown for case to close properly.