

G

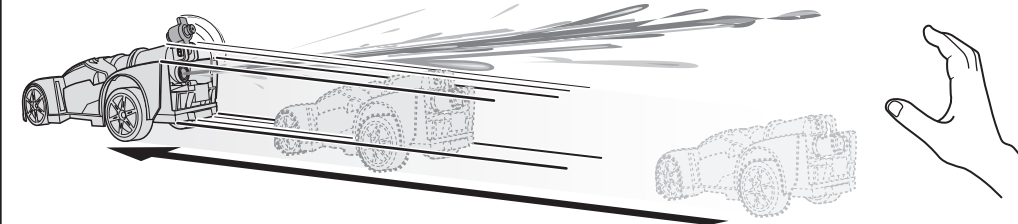

- Do not direct at people or animals.
- This product is not dishwasher safe. Do not wash in the dishwasher.
- Not recommended for use on loose dirt or rugged surfaces.
- Drain, rinse, clean, and dry all items thoroughly before storing.
- Store with nozzle off.



8+

INSTRUCTIONS

Please keep these instructions for future reference as they contain important information.

CONTENTS

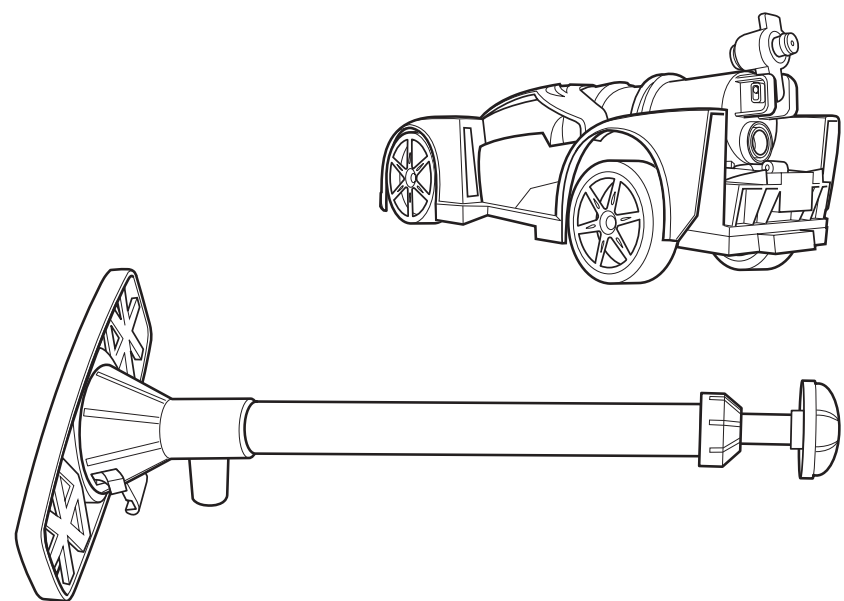

© 2006 Mattel, Inc. All Rights Reserved.
 Mattel, Inc., 333 Continental Blvd., El Segundo, CA 90245 U.S.A. Consumer Relations 1-800-524-8697.
 service.mattel.com Mattel U.K. Ltd., Vanwall Business Park, Maidenhead SL6 4UB, Helpline 01628500303
 Mattel Australia Pty Ltd., Richmond, Victoria, 3121. Consumer Advisory Service - 1300 135 312.
 Mattel East Asia Ltd., Room 1106, South Tower, World Finance Centre, Harbour City, Tsimshatsui, HK, China. Diimport
 & Diedarkan Oleh: Mattel SEA Ptd Ltd.(993532-P) Lot 13.5, Menara Lien Hoe, Persiaran Tropicana Golf Country
 Resort, 47410 PJ. Tel:03-78803817, Fax:03-78803867.



TO OPEN

IF NOZZLE IS LOCKED IN CLOSED POSITION:
Do not force open. Pressurize vehicle (steps D & E), then roll it forward and nozzle should pop open.

TO PLAY

A

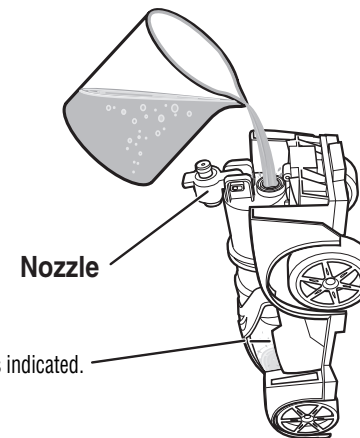

- For best performance, add water to the fill line as indicated.
- Only use water with toy.

B

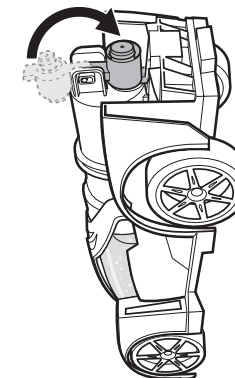

C

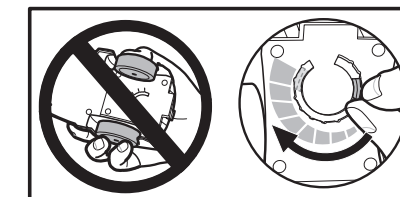

- For shorter delay between launch and turbo boost, push tab to the right.
- For longer delay, push tab to the left.
- You can also choose to set the second shot anywhere in between as well by moving the tab to any notch in between.

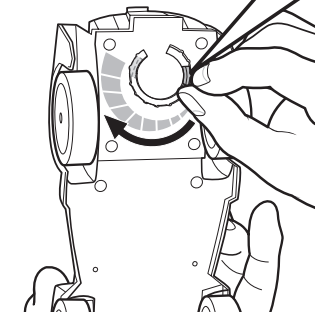

D

Attach pump to vehicle then use pump to pressurize vehicle.

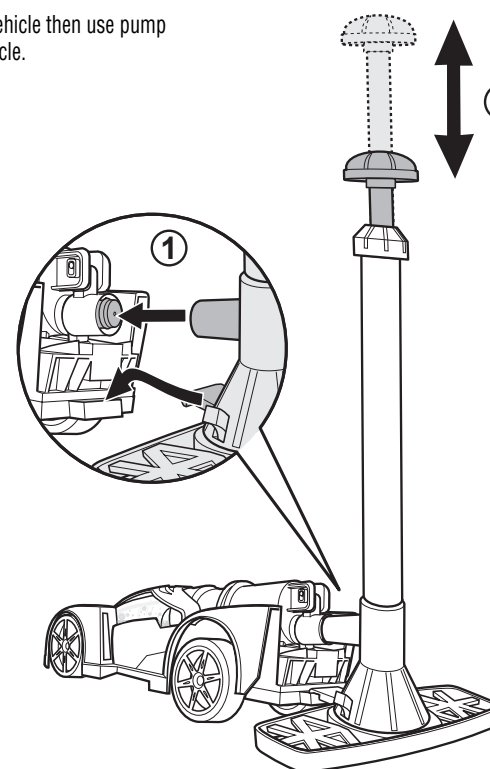

E

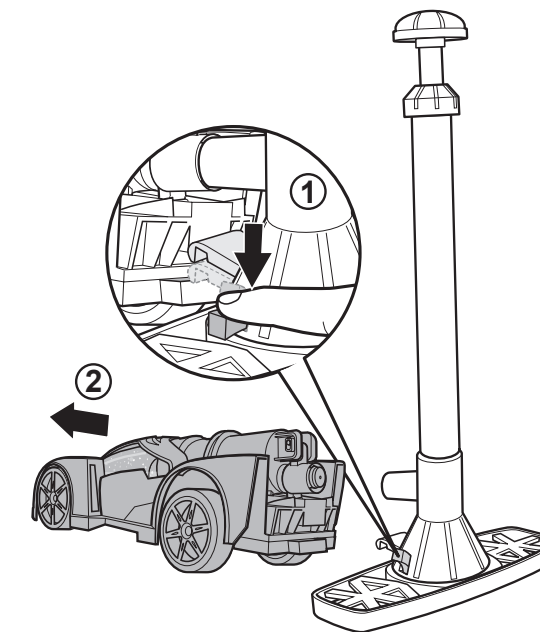

F

For best performance, gently shake vehicle before launching to ensure the water is at the back of the vehicle.

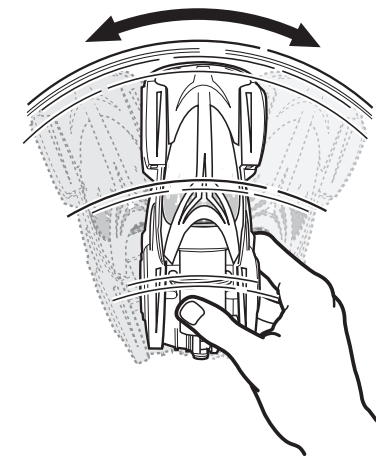

G

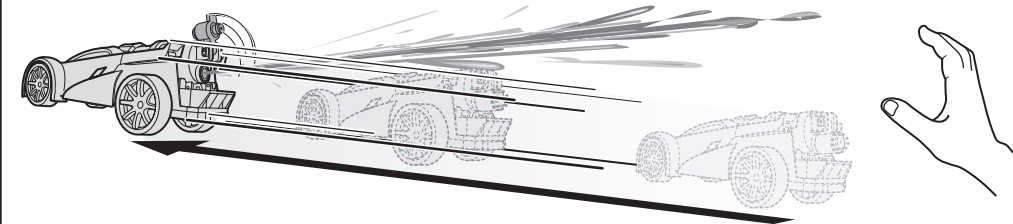

- Do not direct at people or animals.
- This product is not dishwasher safe. Do not wash in the dishwasher.
- Not recommended for use on loose dirt or rugged surfaces.
- Drain, rinse, clean, and dry all items thoroughly before storing.
- Store with nozzle off.



8+

INSTRUCTIONS

Please keep these instructions for future reference as they contain important information.

CONTENTS

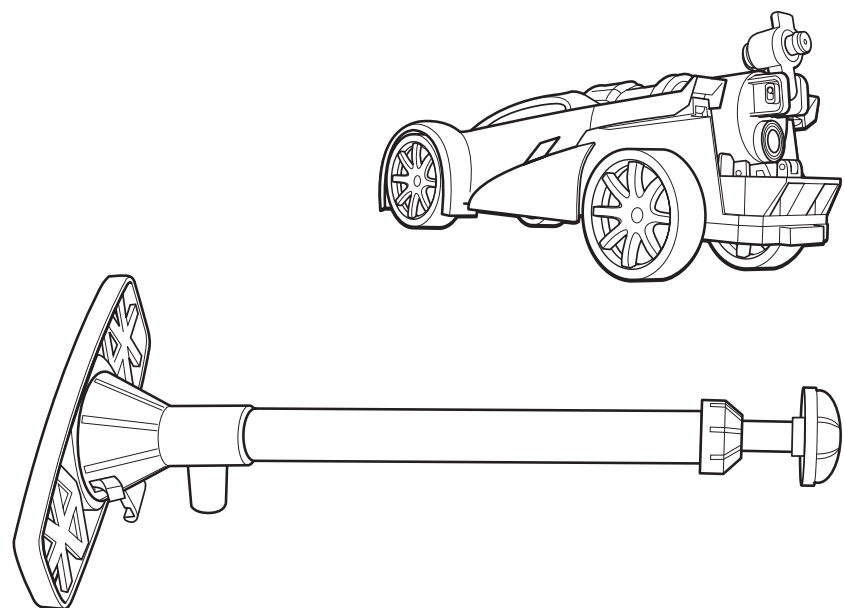

© 2006 Mattel, Inc. All Rights Reserved.
 Mattel, Inc., 333 Continental Blvd., El Segundo, CA 90245 U.S.A. Consumer Relations 1-800-524-8697.
 service.mattel.com Mattel U.K. Ltd., Vanwall Business Park, Maidenhead SL6 4UB, Helpline 01628500303
 Mattel Australia Pty Ltd., Richmond, Victoria, 3121. Consumer Advisory Service - 1300 135 312.
 Mattel East Asia Ltd., Room 1106, South Tower, World Finance Centre, Harbour City, Tsimshatsui, HK, China. Diimport
 & Diedarkan Oleh: Mattel SEA Ptd Ltd.(993532-P) Lot 13.5, Menara Lien Hoe, Persiaran Tropicana Golf Country
 Resort, 47410 PJ. Tel:03-78803817, Fax:03-78803867.



TO OPEN

IF NOZZLE IS LOCKED IN CLOSED POSITION:
Do not force open. Pressurize vehicle (steps D & E), then roll it forward and nozzle should pop open.

TO PLAY

A

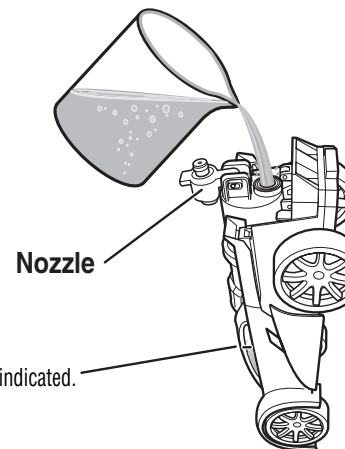

- For best performance, add water to the fill line as indicated.
- Only use water with toy.

B

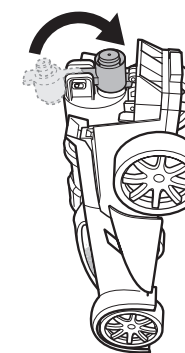

C

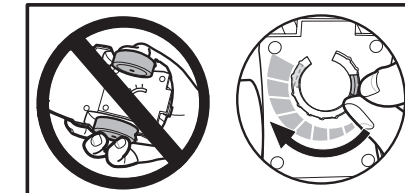

- For shorter delay between launch and turbo boost, push tab to the right.
- For longer delay, push tab to the left.
- You can also choose to set the second shot anywhere in between as well by moving the tab to any notch in between.

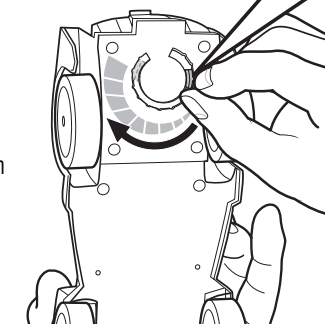

D

Attach pump to vehicle then use pump to pressurize vehicle.

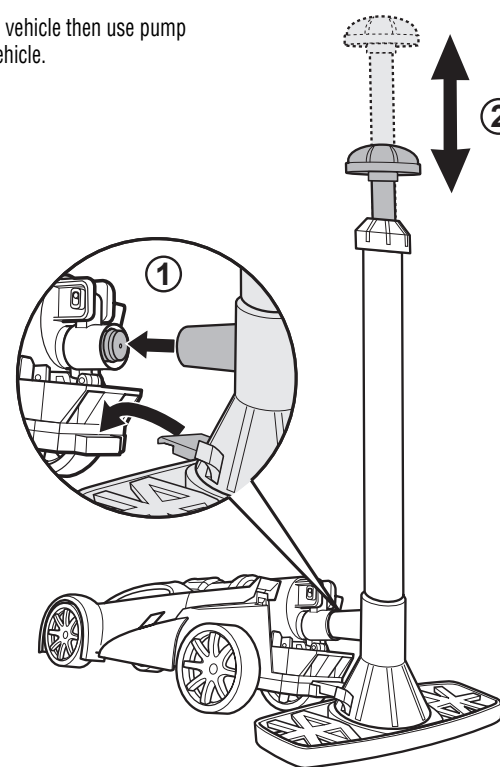

E

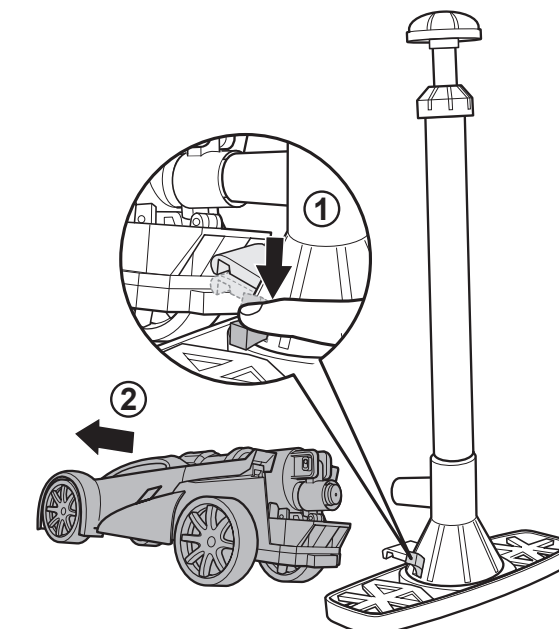

F

For best performance, gently shake vehicle before launching to ensure the water is at the back of the vehicle.

