



www.fisher-price.com

Child Tray Replacement Kit



- An adult must remove and replace the child tray.
- Tools needed for child tray replacement: Flat end screwdriver and Phillips screwdriver.
- Please read these instructions before assembly and use of this product.

Child Tray



- Using a flat end screwdriver, pry the child tray caps from each tray.

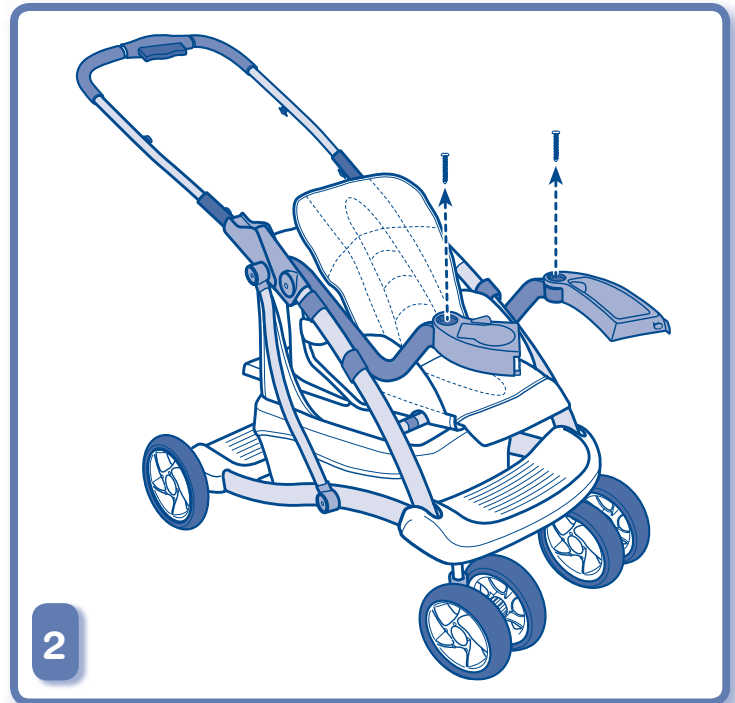

- Using a Phillips screwdriver, loosen and remove the bolts inside the child trays.

Child Tray

Parts

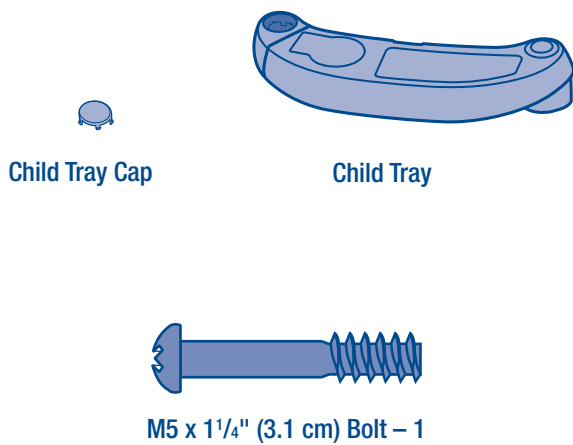

- Fit the child tray peg into the opening in the armrest.

Removal



- Remove the child trays from the armrests.
- Properly dispose of the child trays, bolts and child tray caps.

Assembly

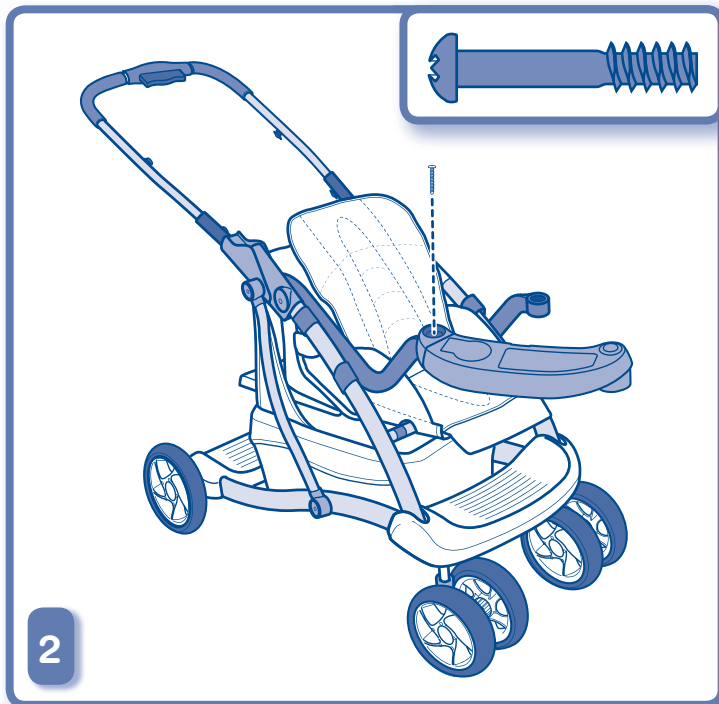

- Insert an M5 x 1 $\frac{1}{4}$ " bolt down into the hole in the child tray.
- Completely tighten the bolt with a Phillips screwdriver.



- Fit and **“snap”** the child tray cap to the child tray as shown.

Child Tray Use



- Rotate the child tray closed. Make sure you hear a **"click"**.



- Press the button on the tray and rotate open.

Questions?



Visit us on line at www.service.fisher-price.com.

Call our Consumer Relations Department, toll-free at **1-800-432-5437**,
9 AM - 7 PM EST Monday through Friday and 11 AM - 5 PM EST Saturday.

Hearing-impaired consumers using TTY/TD equipment, please call
1-800-382-7470.

Write to us at: Fisher-Price® Consumer Relations, 636 Girard Avenue,
East Aurora, New York 14052.