

Please keep this instruction sheet for future reference, as it contains important information.

Requires three "C" (LR14) **alkaline** batteries (not included).

Adult assembly is required.

Tool needed for assembly:
Phillips screwdriver (not included).



Toddler



Preschooler

Grow With Me
Kitchen™

Parts

⚠ CAUTION

This product contains small parts in its unassembled state. Adult assembly is required. Take extra care during unpacking and assembly.



Counter

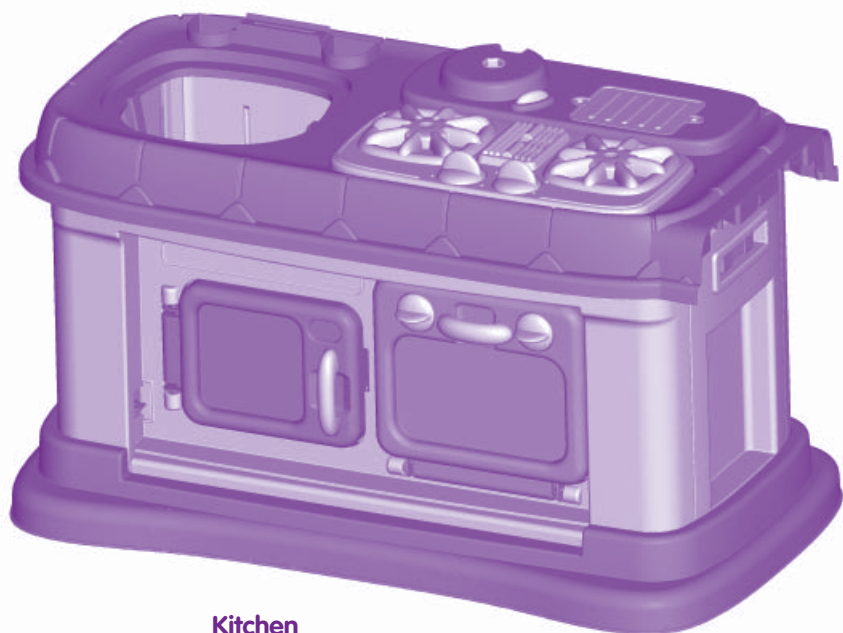

Kitchen



Shelf



Faucet



Sink

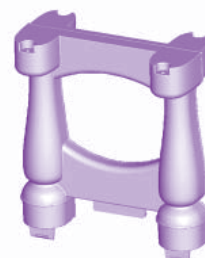

Shelf Support

Parts Not Shown

Dish	Drinking Cup
Pot	Phone
Pot Lid	3 Stacking Cups
Mixing Spoon	Milk Carton
Spatula	Cheese
Fork	Cupcake
Spoon	Blender



#6 x 5/8" (1,6 cm) Screw – 9

Shown Actual Size

Note: Tighten and loosen all screws with a Phillips screwdriver. Do not over-tighten.

Assembly

Lift

Lift

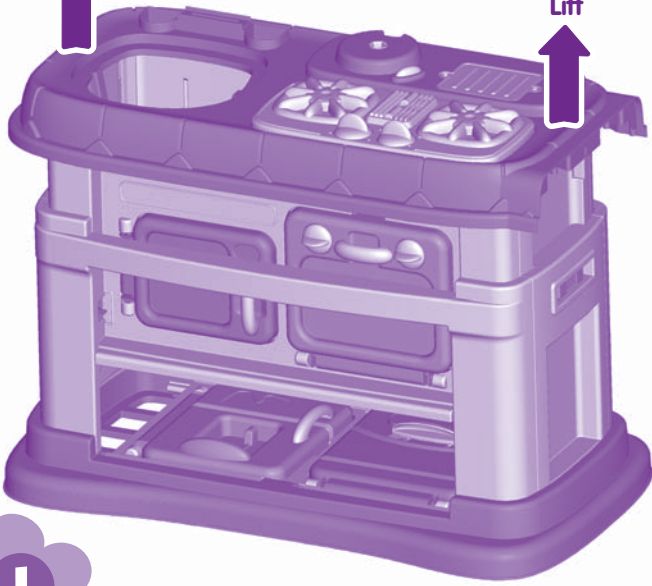

1

- Place your feet on the base of the kitchen and lift the counter top until it **"snaps"** in place.

Counter

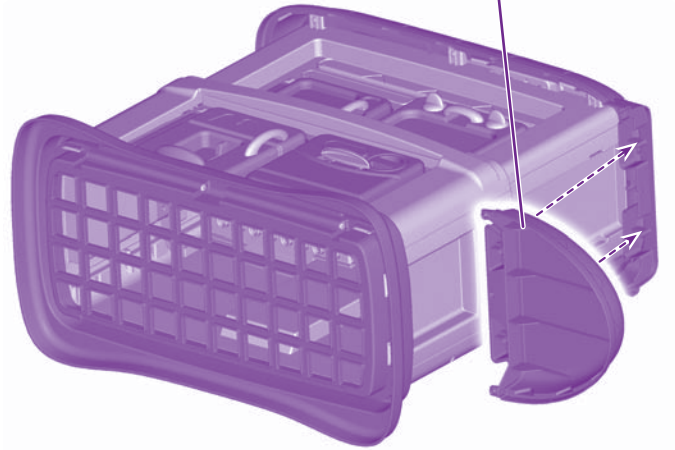

3

- Set the kitchen on its side. Fit the counter to the underside of counter top.
- Insert five screws into the counter and tighten.
- Turn the kitchen upright.

Lift

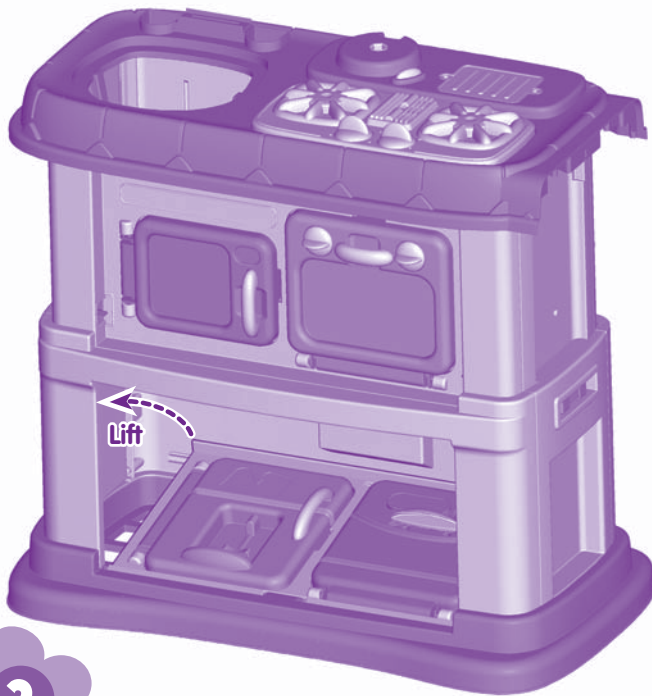

2

- Lift the refrigerator panel inside the lower part of the kitchen.
- Pull the refrigerator panel forward until it **"snaps"** in place.



4

- **"Snap"** the shelf support into the counter top, as shown.
- Hint:** This may require some force.

Assembly

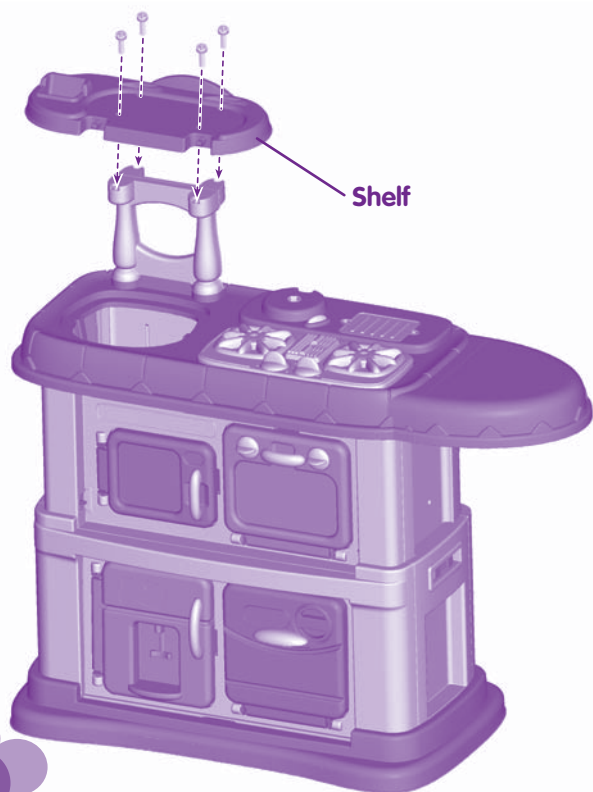

5

- Fit the shelf onto the shelf support.
- Insert four screws into the shelf and tighten.

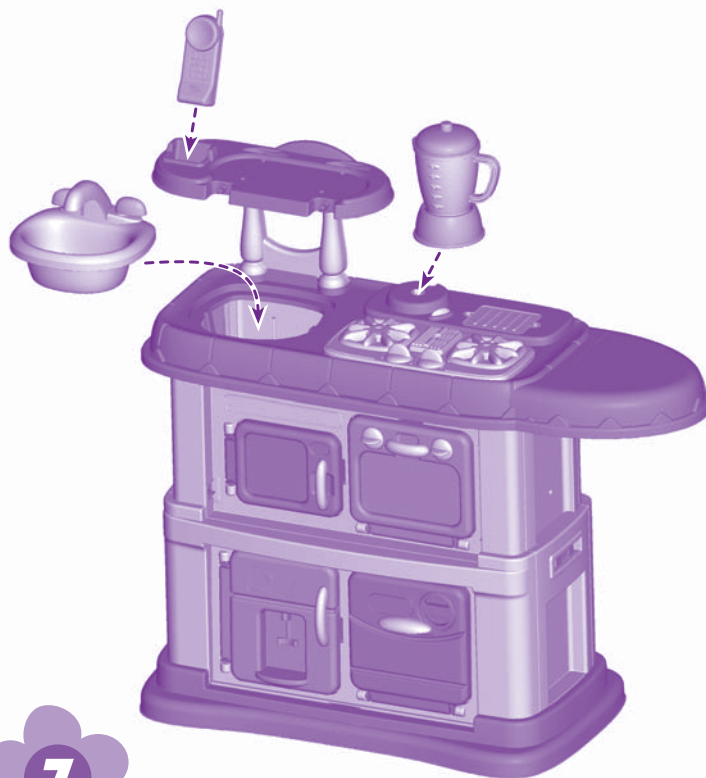

7

- Place the sink, phone and blender into the kitchen, as shown.

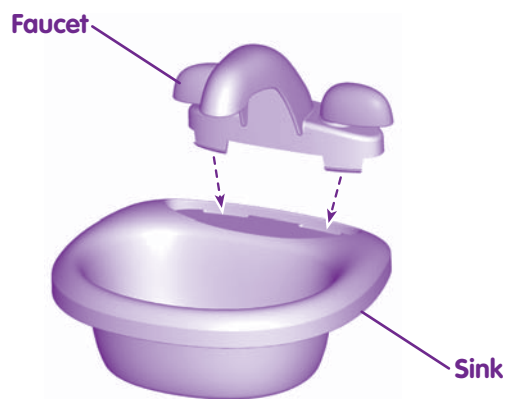

6

- "Snap" the faucet into the sink.

Battery Installation

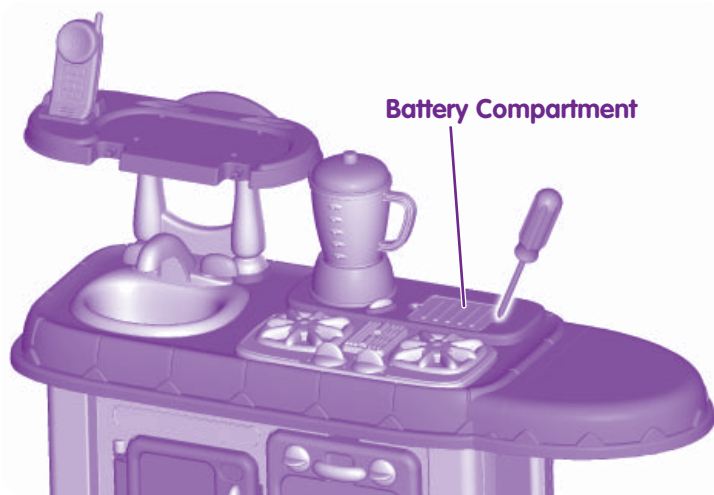

- Locate the battery compartment on the counter top.
- Loosen the screws in the battery compartment door with a Phillips screwdriver. Remove the battery compartment door.
- Insert three "C" (LR14) **alkaline** batteries.

Hint: We recommend using **alkaline** batteries for longer battery life.

- Replace the battery compartment door and tighten the screws.
- When sounds become faint or stop, it's time for an adult to change the batteries!



- Protect the environment by not disposing of this product with household waste (2002/96/EC). Check your local authority for recycling advice and facilities (Europe only).

Battery Safety Information

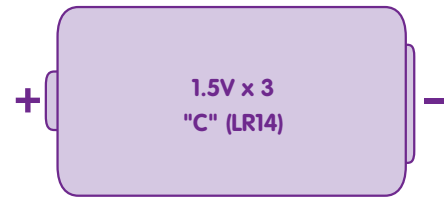

Shown Actual Size

In exceptional circumstances, batteries may leak fluids that can cause a chemical burn injury or ruin your product. To avoid battery leakage:

- Do not mix old and new batteries or batteries of different types: alkaline, standard (carbon-zinc) or rechargeable (nickel-cadmium).
- Insert batteries as indicated inside the battery compartment.
- Remove batteries during long periods of non-use. Always remove exhausted batteries from the toy. Dispose of batteries safely. Do not dispose of the product in a fire. The batteries inside may explode or leak.
- Never short-circuit the battery terminals.
- Use only batteries of the same or equivalent type, as recommended.
- Do not charge non-rechargeable batteries.
- Remove rechargeable batteries from the product before charging.
- If removable, rechargeable batteries are used, they are only to be charged under adult supervision.

Convert from Toddler Height to Preschooler Height

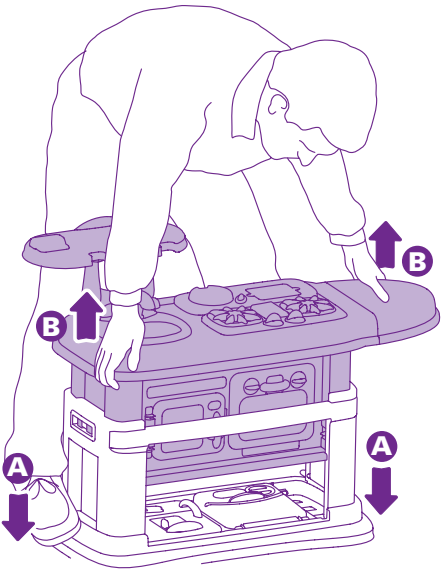

- 1
- Place your feet on the base of the kitchen **A** and lift the counter top until it “snaps” in place **B**.

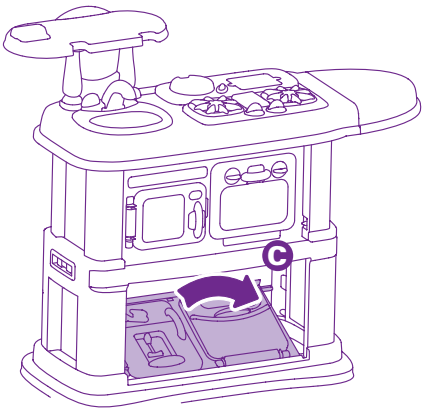

- 2
- Lift the refrigerator panel inside the lower part of the kitchen. Pull the refrigerator panel forward until it “snaps” in place **C**.

Convert from Preschool Height to Toddler Height

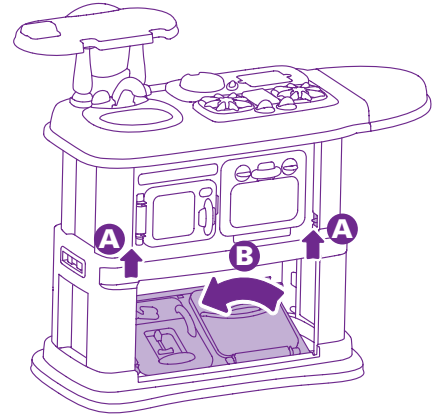

- 1
- Lift the two levers near the microwave and oven **A**.
- Push to lower the refrigerator panel **B**.

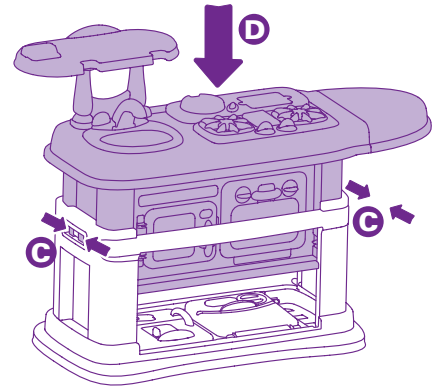

- 2
- Squeeze the levers on each side of the kitchen **C**.
- Push the counter top down **D**.

Lots of Fun Kitchen Activities



Press the button for realistic blender sounds (in preschool mode) or fun music (in toddler mode).



Turn the stove knobs for realistic cooking sounds (in preschool mode) or fun music (in toddler mode).



Before use, thoroughly wash all parts that may contact food.

Consumer Information

Visit us on-line at
www.service.fisher-price.com.

Call our Consumer Relations Department, toll-free at
1-800-432-5437, 9 AM - 7 PM EST Monday through Friday
and 11 AM - 5 PM EST Saturday. Hearing-impaired consumers
using TTY/TD equipment, please call 1-800-382-7470.

Write to us at: Fisher-Price® Consumer Relations,
636 Girard Avenue, East Aurora, New York 14052

For countries outside the United States:

CANADA: Questions? 1-800-432-5437. Mattel Canada Inc., 6155 Freemont
Blvd., Mississauga, Ontario L5R 3W2; www.service.mattel.com.

GREAT BRITAIN: Mattel UK Ltd, Vanwall Business Park, Maidenhead SL6 4UB.
Helpline: 01628 500303; www.service.mattel.com/uk

AUSTRALIA: Mattel Australia Pty. Ltd., 658 Church Street, Locked Bag #870,
Richmond, Victoria 3121 Australia. Consumer Advisory Service 1300 135 312.

NEW ZEALAND: 16-18 William Pickering Drive, Albany 1331, Auckland.

ASIA: Mattel East Asia Ltd, Room 1106, South Tower, World Finance Centre,
Harbour City, Tsimshatsui, HK, China.

FCC Statement

United States Only

This equipment has been tested and found to comply with the limits for a Class B digital device, pursuant to Part 15 of the FCC Rules. These limits are designed to provide reasonable protection against harmful interference in a residential installation. This equipment generates, uses and can radiate radio frequency energy and, if not installed and used in accordance with the instructions, may cause harmful interference to radio communications. However, there is no guarantee that interference will not occur in a particular installation. If this equipment does cause harmful interference to radio or television reception, which can be determined by turning the equipment off and on, the user is encouraged to try to correct the interference by one or more of the following measures:

- Reorient or relocate the receiving antenna.
- Increase the separation between the equipment and receiver.
- Consult the dealer or an experienced radio/TV technician for help.

Note: Changes or modifications not expressly approved by the manufacturer responsible for compliance could void the user's authority to operate the equipment.

Care

- Wipe this toy with a clean cloth dampened with a mild soap and water solution. Do not immerse this toy.
- This toy has no consumer serviceable parts. Do not take this toy apart.