



# Dora's Magic Castle

## INSTRUCTION SHEET

Please keep these instructions for future reference as they contain important information.

### HOW TO ASSEMBLE

#### ASSEMBLY PIECES

- A. MAIN CASTLE UNIT (4 ROOMS)
- B. BASE FLOOR
- C. SECOND FLOOR
- D. KITCHEN UNIT (CABINETS & COUNTERTOP)
- E. MAIN ROOF
- F. EXTENSION ROOF
- G. TWO-ROOM EXTENSION
- H. 3RD STORY EXTENSION
- I. MAGIC MIRROR

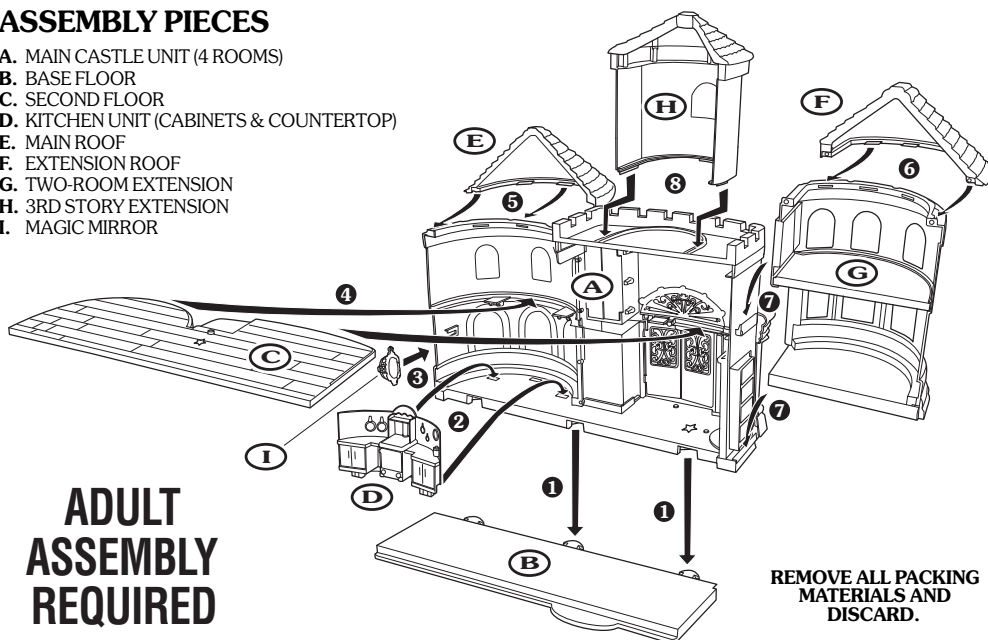

**ADULT  
ASSEMBLY  
REQUIRED**

1. Lift the MAIN CASTLE UNIT onto the notches in the BASE FLOOR, so that the tabs of the BASE FLOOR fit into the floor of the MAIN CASTLE UNIT, as shown.
2. Snap the KITCHEN UNIT into the floor of the MAIN CASTLE UNIT as shown.
3. Slide the MAGIC MIRROR onto the kitchen wall, as shown.
4. Slide the SECOND FLOOR into the MAIN CASTLE UNIT, as shown.
5. Slide the MAIN ROOF into the MAIN CASTLE UNIT as shown.
6. Slide the EXTENSION ROOF into the TWO-ROOM EXTENSION as shown.
7. Attach the TWO-ROOM EXTENSION to the MAIN CASTLE UNIT as shown.
8. Attach the 3RD STORY EXTENSION to the MAIN CASTLE UNIT, as shown.

**NOTE:** All of these assemblies are one-time snap assemblies. Make sure all pieces snap firmly into place. Once the pieces are assembled and snapped into place, they cannot be taken apart.

K3005-0920

### HOW TO PLAY

Activate the 5 magical features by waving the magic wand directly over the stars found in the following locations.

#### CASTLE DOORS

- Wave the wand directly over the star, found on the front left column, as shown.
- You can also activate the magical feature manually by pressing the button found on the floor inside the entranceway of the castle, as shown.

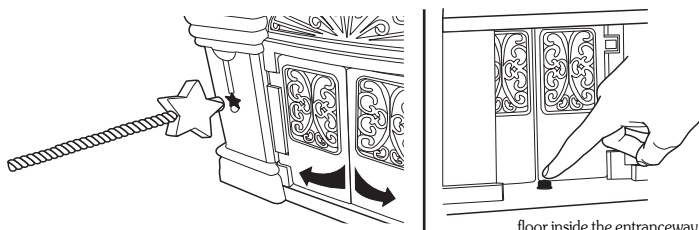

#### TRAP DOOR

- Put Dora or any other figure inside the armoire, located on the second floor.
- Wave the wand directly over the star, found on the floor directly in front of the armoire, as shown.
- The figure will drop down a passageway and 're-appear' behind the secret door found to the right of the castle doors.
- You can also activate the magical feature manually by pressing the button found next to the star, as shown.

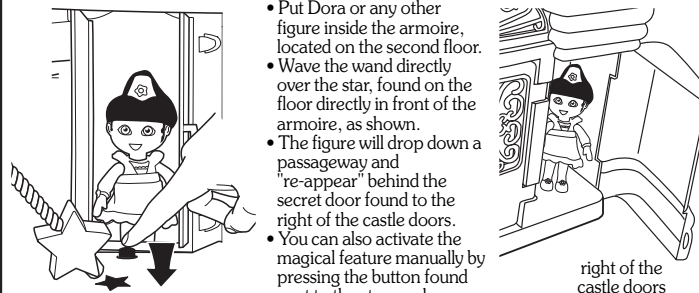

#### REVOLVING BOOKCASE

- Wave the wand directly over the star, found on the floor directly in front of the bookcase on the first floor, as shown.
- You can also activate the magical feature manually by pressing the button found next to the star, as shown.



#### TREASURE CHEST

- Wave the wand directly over the star, found on the front of the treasure chest, as shown.
- You can also activate the magical feature manually by pressing the button, as shown.

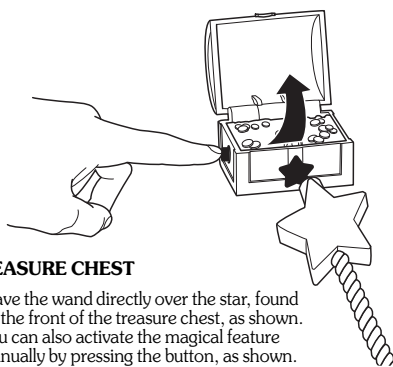

#### MAGIC MIRROR

- Wave the wand directly over the star, found on the side of the mirror, as shown.
- You can also activate the magical feature manually by pressing the button found next to the star, as shown.

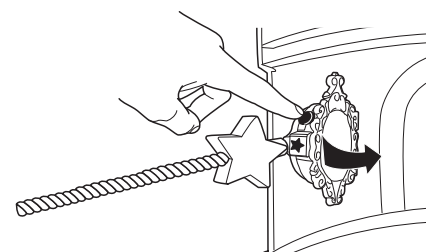

©2006 Viacom International Inc.  
All Rights Reserved. Nickelodeon, Nick Jr., Dora the Explorer and all related titles, logos and characters are trademarks of Viacom International Inc.  
Fisher-Price, Inc., a subsidiary of Mattel, Inc., East Aurora, NY 14052 U.S.A.  
**PRINTED IN CHINA.**  
Manufactured for Fisher-Price. ©2006 Mattel, Inc. All Rights Reserved.  
Fisher-Price and the Fisher-Price logo are U.S. trademarks of Mattel, Inc.  
Packaging and address should be retained for future reference.

Mattel Canada Inc., Mississauga, Ontario L5R 3W2. You may call us free at 1-800-432-5437.  
Mattel U.K. Ltd., Vanwall Business Park, Maidenhead SL6 4UB. Helpline 01628500303.  
Mattel Australia Pty., Ltd., Richmond, Victoria 3121. Consumer Advisory Service - 1300 135 312.  
Mattel East Asia Ltd., Room 1106, South Tower, World Finance Centre, Harbour City, Tsimshatsui, HK, China.  
Ditimpot & Diedarkan Oleh: Mattel SEA Ptd Ltd. (993532-P) Lot 13.5, 13th Floor, Menara Lien Hoe, Persiaran Tropicana Golf Country Resort, 47410 PJ. Tel:03-78803817, Fax:03-78803867.  
Mattel, Inc., 333 Continental Blvd., El Segundo, CA 90245 U.S.A. Consumer Affairs 1 (800) 524-Toys.

Questions?  
**service.fisher-price.com**  
In US and Canada  
**1-800-432-5437**

**Fisher-Price®**  
**ITEM NO. K3005**

Item No : K3005  
Version : English  
Size : 8.5 x 11"  
Paper : Woodfree paper 80 gsm  
Color : Black  
Date : March 31, 2006 (EN)