

Please keep this instruction sheet for future reference, as it contains important information.

Adult assembly is required.

Requires three "C" (LR14) **alkaline** batteries (not included).

Tool required for assembly:
Phillips screwdriver (not included).



Parts

⚠ WARNING

To prevent entanglement injury, never place the gym in a crib or playpen.
Never add strings, ties or other products to the gym.

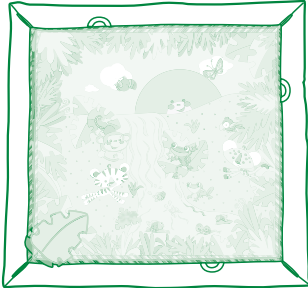

Mat

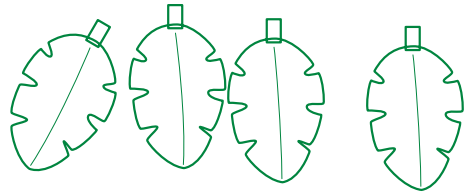

4 Leaves



Butterfly Arch

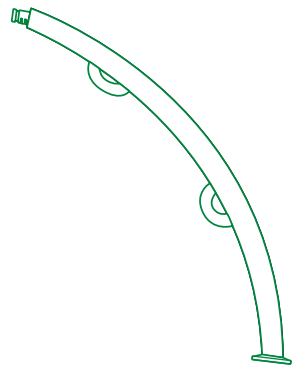

Plain Tube

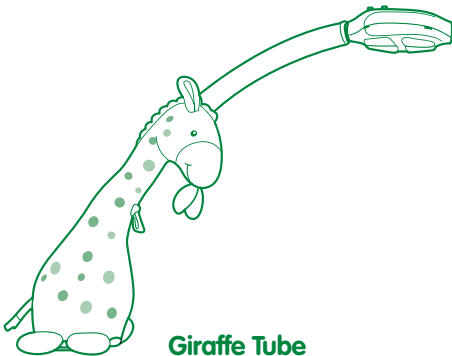

Giraffe Tube

Not Shown: 5 Activity Toys

Battery Installation

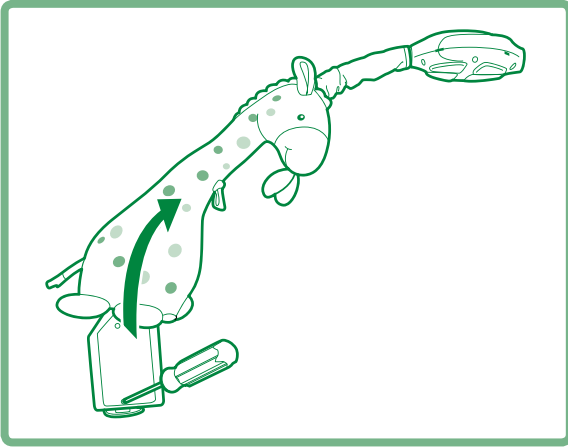

- Slide the soft giraffe up to access the battery compartment.
- Loosen the screws in the battery compartment door with a Phillips screwdriver. Remove the battery compartment door.
- Insert three "C" (LR14) alkaline batteries, as indicated inside the battery compartment.

Hint: We recommend using alkaline batteries for longer battery life.

- Replace the battery compartment door and tighten the screws with a Phillips screwdriver. Do not over-tighten.
- Slide the soft giraffe back down to cover the battery compartment.
- When sounds or lights become faint or stop, it's time for an adult to change the batteries!



- Protect the environment by not disposing of this product with household waste (2002/96/EC). Check your local authority for recycling advice and facilities (Europe only).

Battery Safety Information

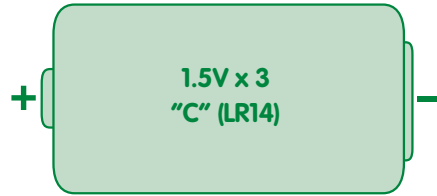

SHOWN ACTUAL SIZE

In exceptional circumstances, batteries may leak fluids that can cause a chemical burn injury or ruin your toy. To avoid battery leakage:

- Do not mix old and new batteries or batteries of different types: alkaline, standard (carbon-zinc) or rechargeable (nickel-cadmium).
- Insert batteries as indicated inside the battery compartment.
- Remove batteries during long periods of non-use. Always remove exhausted batteries from the toy. Dispose of batteries safely. Do not dispose of the product in a fire. The batteries inside may explode or leak.
- Never short-circuit the battery terminals.
- Use only batteries of the same or equivalent type, as recommended.
- Do not charge non-rechargeable batteries.
- Remove rechargeable batteries from the toy before charging.
- If removable, rechargeable batteries are used, they are only to be charged under adult supervision.

Assembly

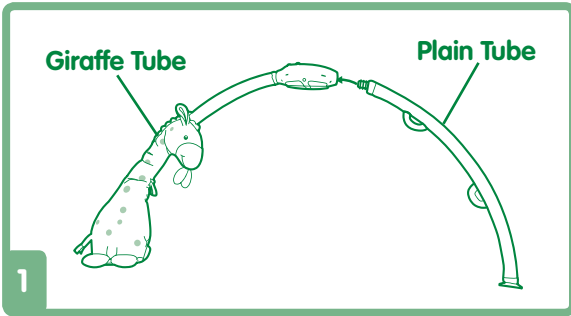

- **"Snap"** the plain tube into the giraffe tube, as shown.

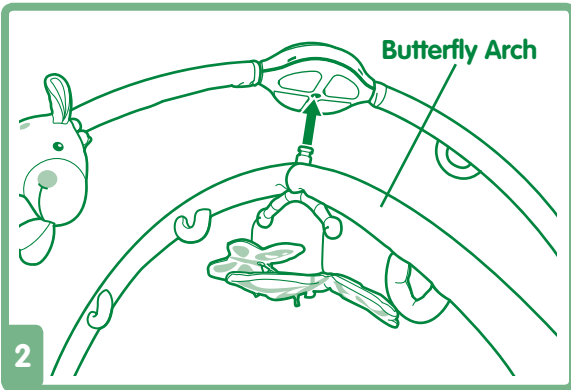

- **"Snap"** the butterfly arch into the underside of the tube assembly, as shown.

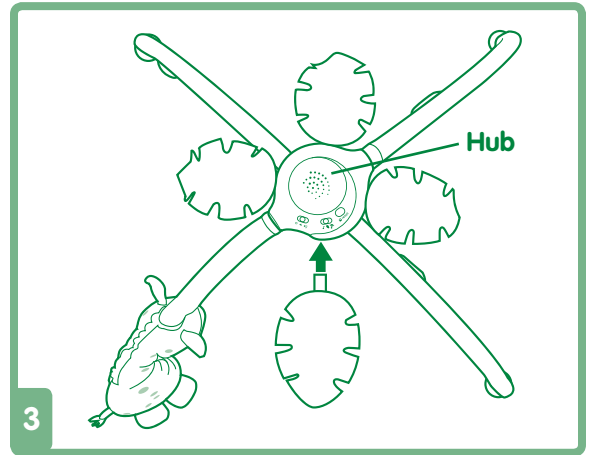

- **"Snap"** the four leaves into the hub.

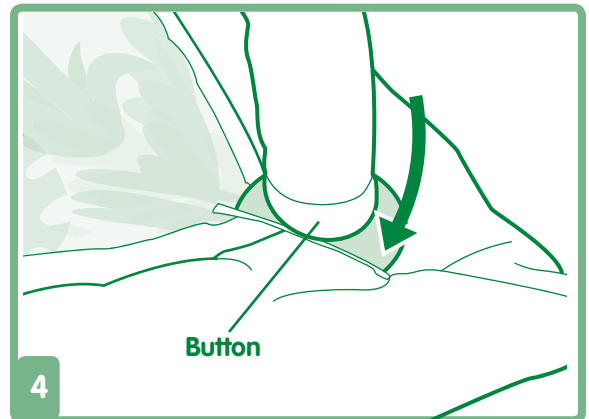

- Insert the button at the bottom of each tube into the slot in each corner of the mat.

Music, Lights and Nature Sounds!





- Hang the five activity toys from loops or links around the gym.

Power/Volume Switch

Slide the switch to either  off,  low volume, or  high volume.

Mode Select Switch

-  Select music, lights and nature sounds.
-  Select for nature sounds and lights.
-  Select for baby-activated music. Lights and music respond to baby's movement.

Activation Button

-  Press to start or stop the music and lights.

Care

Mat

- Remove the arch and activity toys from the mat.
- Machine wash the mat inside a pillow case in cold water on the gentle cycle. Do not use bleach. Line dry the mat.

Arch and Activity Toys

- Wipe with a clean cloth dampened with a mild soap and water solution. Do not immerse.

Consumer Information

Visit us on line at
www.service.fisher-price.com

Call Fisher-Price® Consumer Relations, toll-free at **1-800-432-5437**, 9 AM - 7 PM Monday through Friday and 11 AM - 5 PM Saturday. Hearing-impaired consumers using TTY/TDD equipment, please call **1-800-382-7470**. Write to us at: Fisher-Price® Consumer Relations, 636 Girard Avenue, East Aurora, New York 14052.

FCC Statement

United States Only

This equipment has been tested and found to comply with the limits for a Class B digital device, pursuant to Part 15 of the FCC Rules. These limits are designed to provide reasonable protection against harmful interference in a residential installation. This equipment generates, uses and can radiate radio frequency energy and, if not installed and used in accordance with the instructions, may cause harmful interference to radio communications. However, there is no guarantee that interference will not occur in a particular installation. If this equipment does cause harmful interference to radio or television reception, which can be determined by turning the equipment off and on, the user is encouraged to try to correct the interference by one or more of the following measures:

- Reorient or relocate the receiving antenna.
- Increase the separation between the equipment and receiver.
- Consult the dealer or an experienced radio/TV technician for help.

Note: Changes or modifications not expressly approved by the manufacturer responsible for compliance could void the user's authority to operate the equipment.

For countries outside the United States:

CANADA Questions? 1-800-432-5437. Mattel Canada Inc., 6155 Freemont Blvd., Mississauga, Ontario L5R 3W2; www.service.mattel.com.

GREAT BRITAIN: Mattel UK Ltd, Vanwall Business Park, Maidenhead SL6 4UB. Helpline: 01628 500303; www.service.mattel.com/uk.

AUSTRALIA: Mattel Australia Pty. Ltd., 658 Church Street, Locked Bag #870, Richmond, Victoria 3121 Australia. Consumer Advisory Service 1300 135 312.

NEW ZEALAND: 16-18 William Pickering Drive, Albany 1331, Auckland.

ASIA: Mattel East Asia Ltd, Room 1106, South Tower, World Finance Centre, Harbour City, Tsimshatsui, HK, China.

Fisher-Price, Inc., a subsidiary of Mattel, Inc., East Aurora, NY 14052 U.S.A.

© 2006 Mattel, Inc. All Rights Reserved. ® and ™ designate U.S. trademarks of Mattel, Inc.

K4562pr-0920
PRINTED IN CHINA