

## Play Time

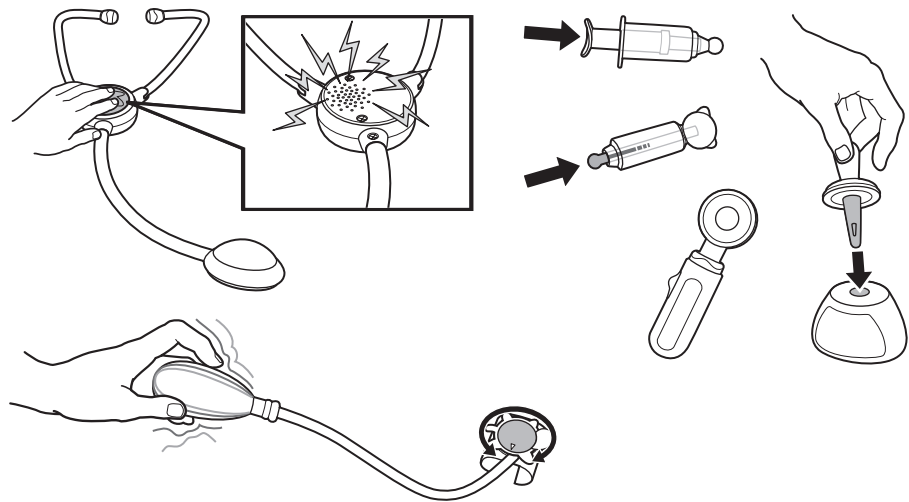

## Battery Replacement

For longer life use only alkaline batteries. Toy requires 3 replaceable AG13/LR44 alkaline button cell batteries. Replace batteries when sound becomes distorted. To replace batteries, use a Phillips head screwdriver (not included) to open battery door. Remove and set aside. Insert 3 AG13/LR44 alkaline button cell batteries as shown. Use either AG13/LR44 alkaline button cell batteries or equivalent. Replace battery cover and screw closed.

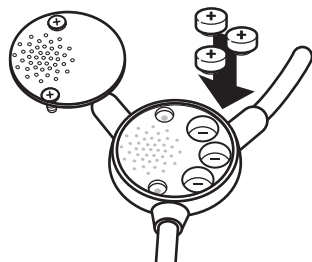

## Battery Safety Information

In exceptional circumstances batteries may leak fluids that can cause a chemical burn injury or ruin your product. To avoid battery leakage:

- Non-rechargeable batteries are not to be recharged.
- Rechargeable batteries are to be removed from the product before being charged (if designed to be removable).
- Rechargeable batteries are only to be charged under adult supervision (if designed to be removable).
- Do not mix alkaline, standard (carbon-zinc), or rechargeable (nickel-cadmium) batteries.
- Do not mix old and new batteries.
- Only batteries of the same or equivalent type as recommended are to be used.
- Batteries are to be inserted with the correct polarity.
- Exhausted batteries are to be removed from the product.
- The supply terminals are not to be short-circuited.
- Dispose of batteries safely.
- Do not dispose of this product in a fire. The batteries inside may explode or leak.



## RECYCLE INFORMATION

Please recycle button cell batteries contained in this product by:

- Visiting your nearest recycling center. For location of the nearest recycling center, visit us online at [www.service.mattel.com](http://www.service.mattel.com).
- If a recycling center is not available in your area, contact us for a pre-paid mailing label. Visit us online at [www.service.mattel.com](http://www.service.mattel.com) or call toll-free at 1 (800) 524-8697.

*Valid in the US only.*



2+  
K5485-0920-G1

Fisher-Price

## INSTRUCTIONS

## Contents

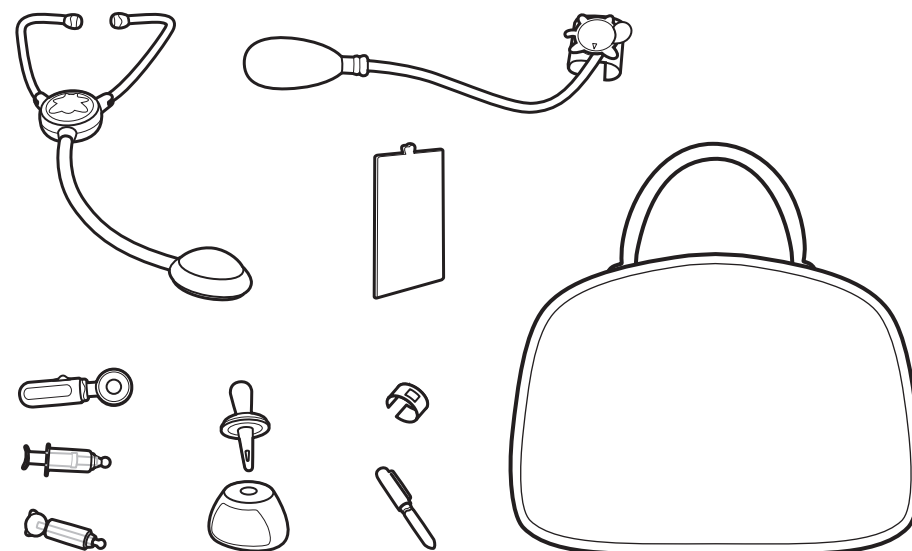

This toy is for doll only. Not intended for child use. Fits approx. 14" (35 cm) Little Mommy™ Doll.

Includes 3 replaceable AG13/LR44 button cell batteries. Dispose of batteries safely.  
Colours and decorations may vary from those shown.

Please remove everything from the package and compare to the contents shown here.  
If any items are missing, please contact your local Mattel office.  
Keep these instructions for future reference as they contain important information.



Protect the environment by not disposing of this product with household waste (2002/96/EC). Check your local authority for recycling advice and facilities.

## CONSUMER INFORMATION

**Need Assistance?** Visit [service.mattel.com](http://service.mattel.com) or call 1-800-524-8697 (US and Canada only), M-F 9AM - 7PM & SAT 11AM - 5PM, Eastern.

**SERVICE.MATTEL.COM**

Mattel Canada Inc., Mississauga, Ontario L5R 3W2. You may call us at 1-800-524-3697. Mattel Inc., Attn: Mattel Australia Pty. Ltd., Menarhead St. 4UB, Hildesheim, 31269-0001, Germany. Mattel Australia Pty. Ltd., Richmond, Victoria 3121, Australia. Consumer Advisory Service, 1300 135 311. Mattel East Asia Ltd., Room 1106, South Tower, World Finance Centre, Harbour City, Tsimshatsui, HK, China. Diompt & Dieddarak Olleh: Mattel SEA PD Ltd.(993532-P) Lot 13.5, 13th Floor, Menara Lien Hoe, Persiaran Tropicana Golf Country Resort, 47410 PJ. Tel: 03-78803817, Fax: 03-78803867. Mattel, Inc., 3303 Continental Blvd., El Segundo, CA 90245 USA. Consumer Affairs 1 (800) 524-8697.