

TO PLAY (CONTINUED)

REVEAL

1.

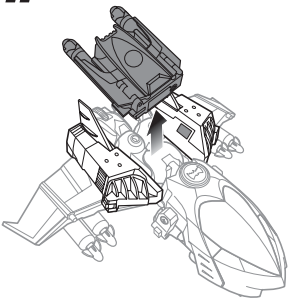

2.

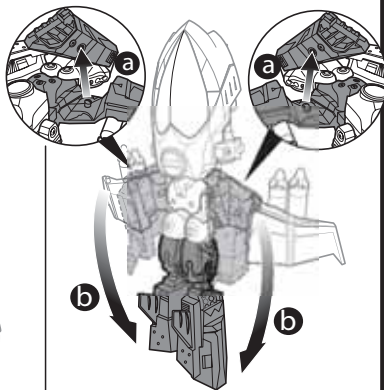

3.

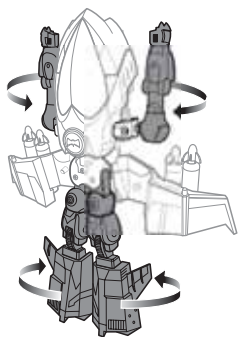

4.

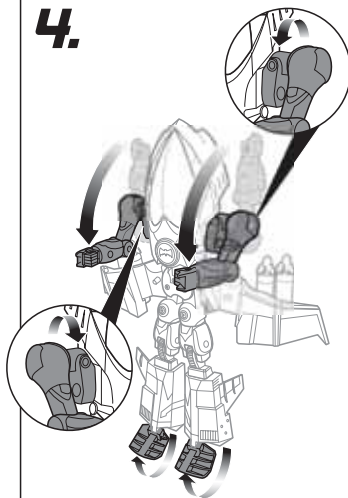

5.

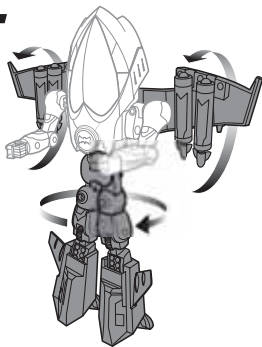

6.

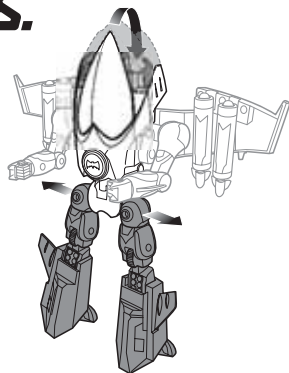

7.

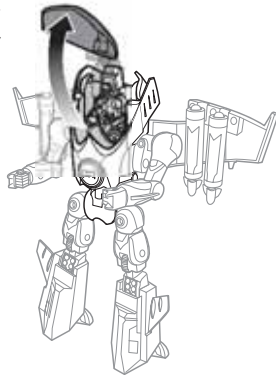

8.

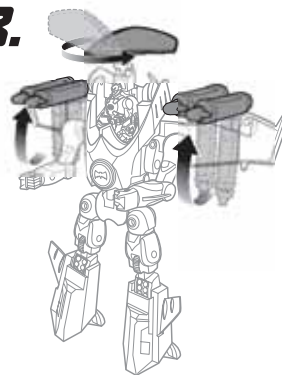

9.

This barrel is for spare projectile storage only.

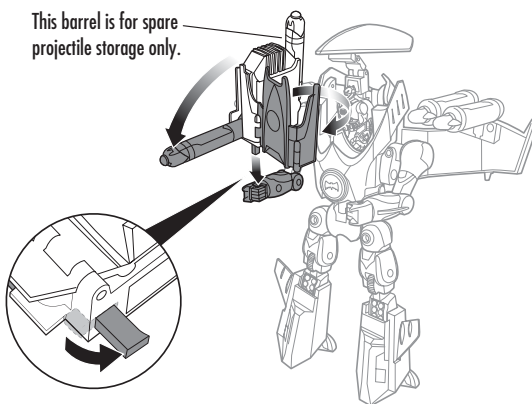

ATTACK

A. Press buttons shown to launch projectiles.

BACK VIEW

BACK VIEW

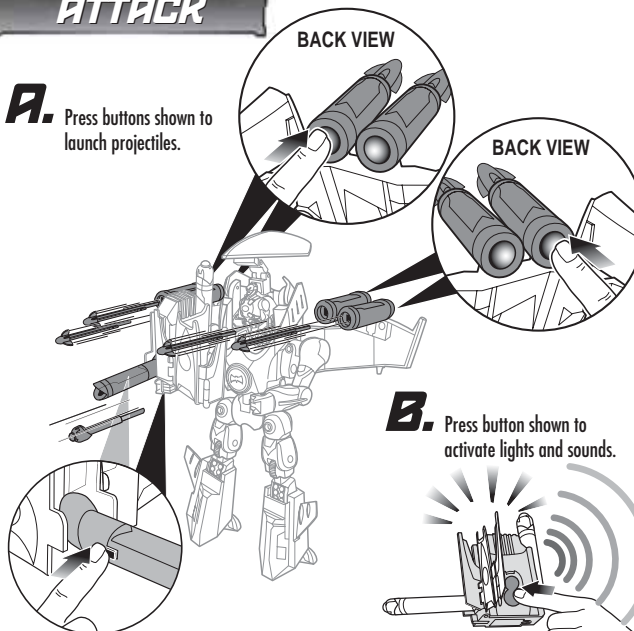

B. Press button shown to activate lights and sounds.

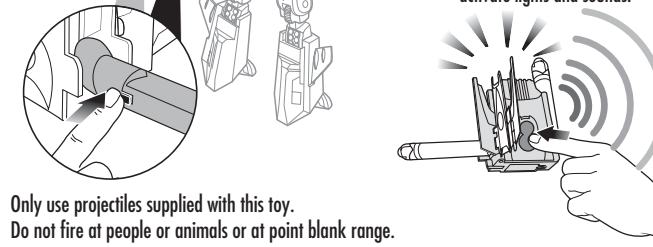

Only use projectiles supplied with this toy.
Do not fire at people or animals or at point blank range.

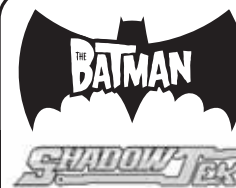

**BATJET™
SHADOWBOT™**
VEHICLE

INSTRUCTIONS **5+**



CONTENTS

Keep these instructions for future reference as they contain important information.

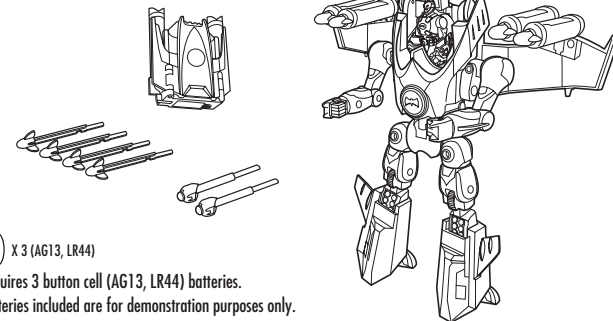

X 3 (AG13, LR44)

Requires 3 button cell (AG13, LR44) batteries.
Batteries included are for demonstration purposes only.

DC **WB** BATMAN and all related characters and elements are trademarks of and © DC Comics
WB SHIELD: TM & © Warner Bros. Entertainment Inc.
(s07)

2007 Mattel, Inc. All Rights Reserved.

BATTERY INSTALLATION/ REPLACEMENT

Open battery cover with Phillips head screwdriver (not included) remove batteries included for demonstration purposes only and dispose of them safely. Insert 3 new button cell AG13 (LR44) alkaline batteries in the orientation shown. Replace cover and tighten screw.

For best performance use only alkaline batteries. Replace batteries when sound distorts or product does not function properly.

RECYCLE INFORMATION (USA ONLY)
Please recycle button cell batteries contained in this product by:

- Visiting your nearest recycling center. For location of the nearest recycling center visit us online at www.service.mattel.com.
- If a recycling center is not available in your area, contact us for a pre-paid mailing label. Visit us online at www.service.mattel.com or call toll-free at 1-800-524-8697. Valid in the US only.

BATTERY SAFETY INFORMATION

In exceptional circumstances batteries may leak fluids that can cause a chemical burn injury or ruin your product. To avoid battery leakage:

- Non-rechargeable batteries are not to be recharged.
- Rechargeable batteries are to be removed from the product before being charged (if designed to be removable).
- Rechargeable batteries are only to be charged under adult supervision (if designed to be removable).
- Do not mix alkaline, standard (carbon-zinc), or rechargeable (nickel-cadmium) batteries.
- Do not mix old and new batteries.
- Only batteries of the same or equivalent type as recommended are to be used.
- Batteries are to be inserted with the correct polarity.
- Exhausted batteries are to be removed from the product.
- The supply terminals are not to be short-circuited.
- Dispose of battery(ies) safely.
- Do not dispose of this product in a fire. The batteries inside may explode or leak.

TO PLAY

STEALTH

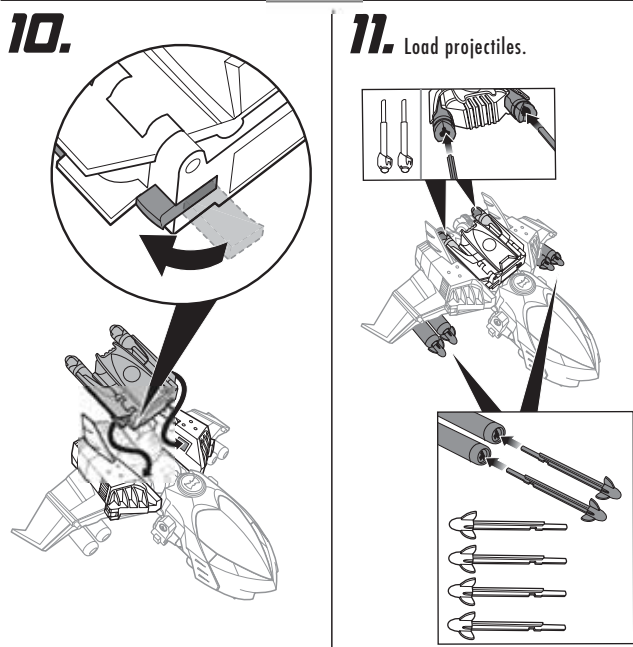
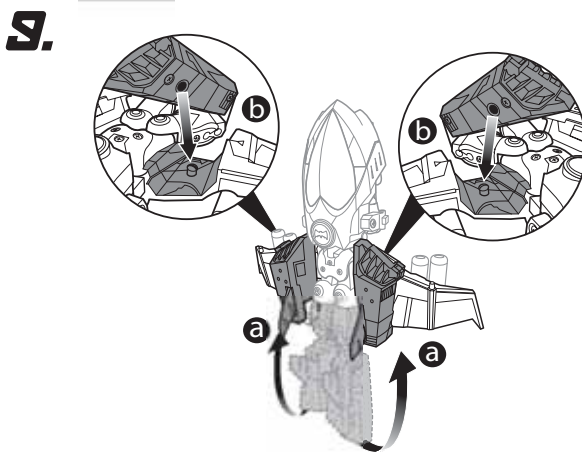
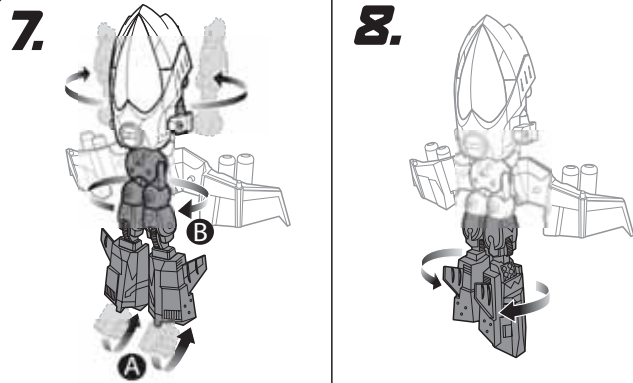
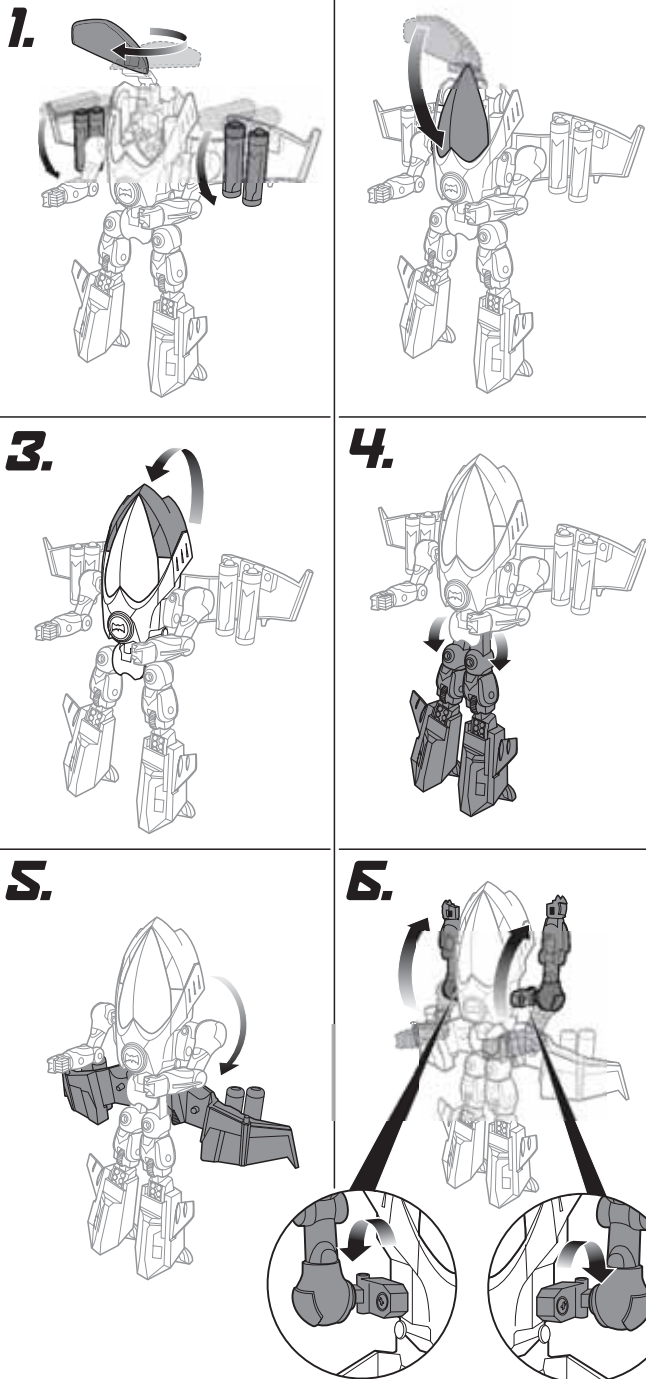

ATTACK

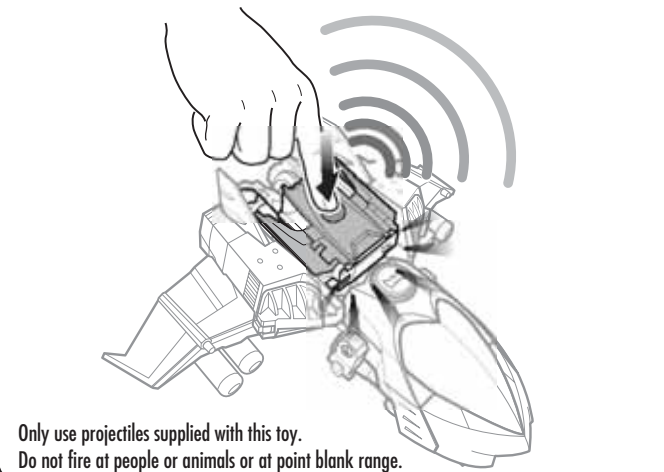
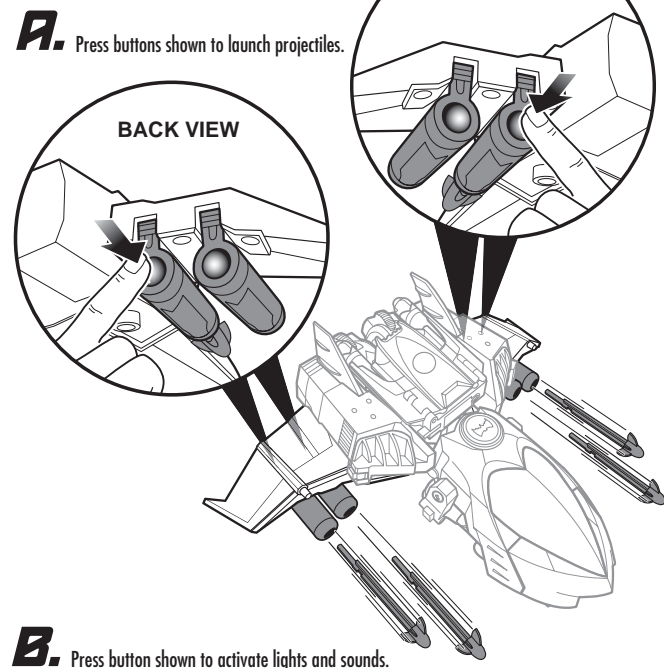

Only use projectiles supplied with this toy.
Do not fire at people or animals or at point blank range.

Protect the environment by not disposing of this product with household waste (2002/96/EC). Check your local authority for recycling advice and facilities.

Mattel, Inc., 333 Continental Blvd., El Segundo, CA 90245 U.S.A. Consumer Relations 1-800-524-8697. service.mattel.com • Mattel U.K. Ltd., Vanwall Business Park, Maidenhead SL6 4UB. Helpline 01628500303 • Mattel Australia Pty Ltd., Richmond, Victoria. 3121. Consumer Advisory Service - 1300 135 312. • Mattel East Asia Ltd., Room 1106, South Tower, World Finance Centre, Harbour City, Tsimshatsui, HK, China. • Diimport & Diedarkan Oleh: Mattel SEA Ptd Ltd. (993532-P) Lot 13.5, Menara Lien Hoe, Persiaran Tropicana Golf Country Resort, 47410 PJ. Tel:03-78803817, Fax:03-78803867.