

# Fisher-Price®

L1343



Please keep this instruction sheet for future reference,  
as it contains important information.

Requires two "AA" batteries (included).

Adult assembly is required.

Tool required for assembly: Phillips screwdriver (not included).



[www.fisher-price.com](http://www.fisher-price.com)

# Parts

## ⚠ CAUTION

This product contains small parts in its unassembled state. Adult assembly is required. Take extra care during unpacking and assembly.



#6 x 3/4" (1,9 cm) Screw - 12

**Note:** Tighten and loosen all screws with a Phillips screwdriver. Do not over-tighten the screws.

**Shown Actual Size**

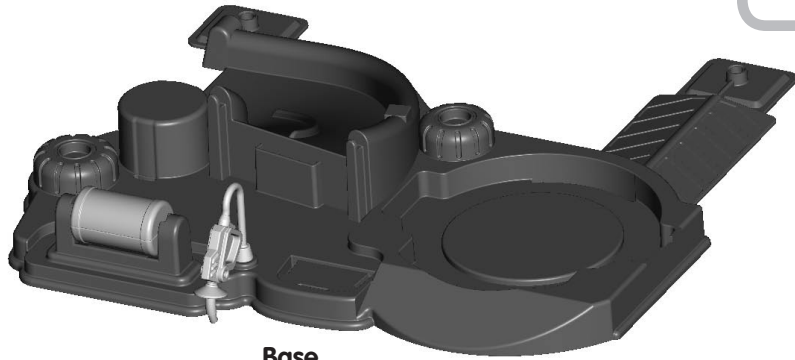

Base

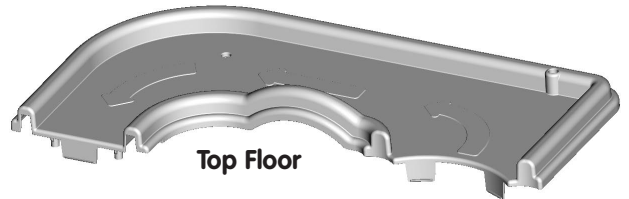

Top Floor

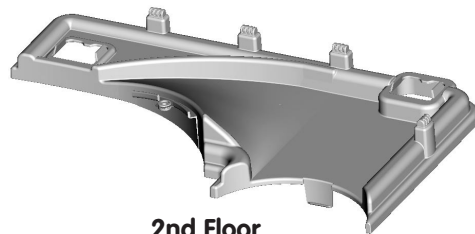

2nd Floor

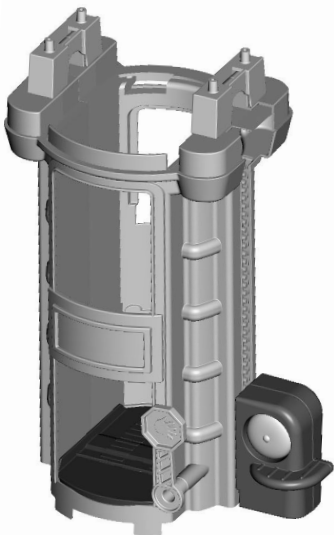

Elevator



2 Columns



4 Ramps



Handle

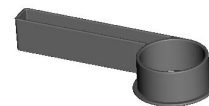

Floor Support



Post



Tow Truck



Pump



Car

**Parts Not Shown:**  
2 Figures

# Assembly

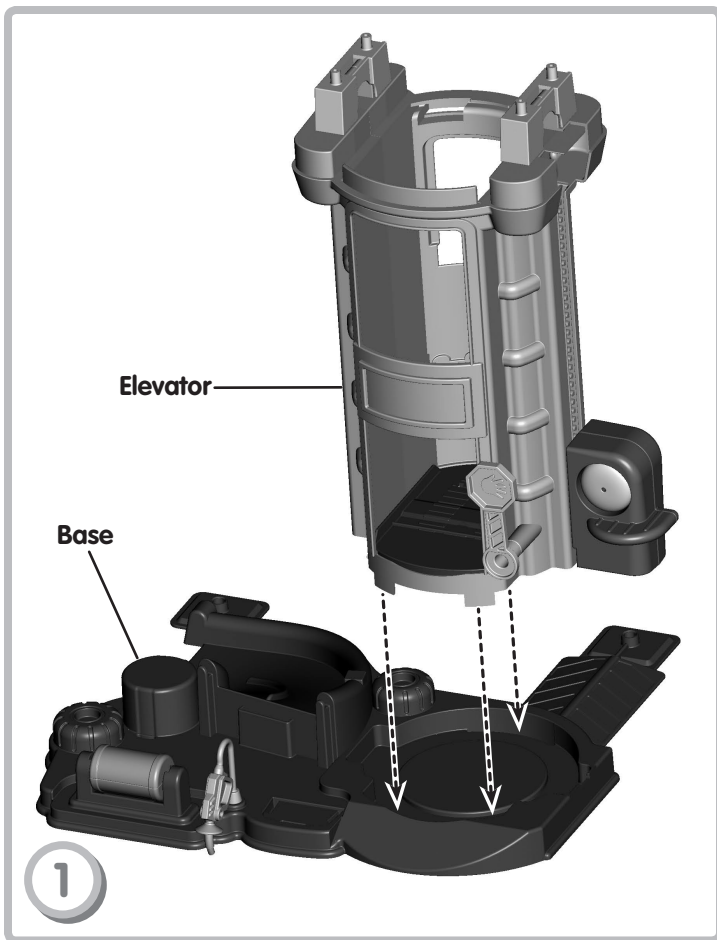

- “Snap” the elevator into the base.

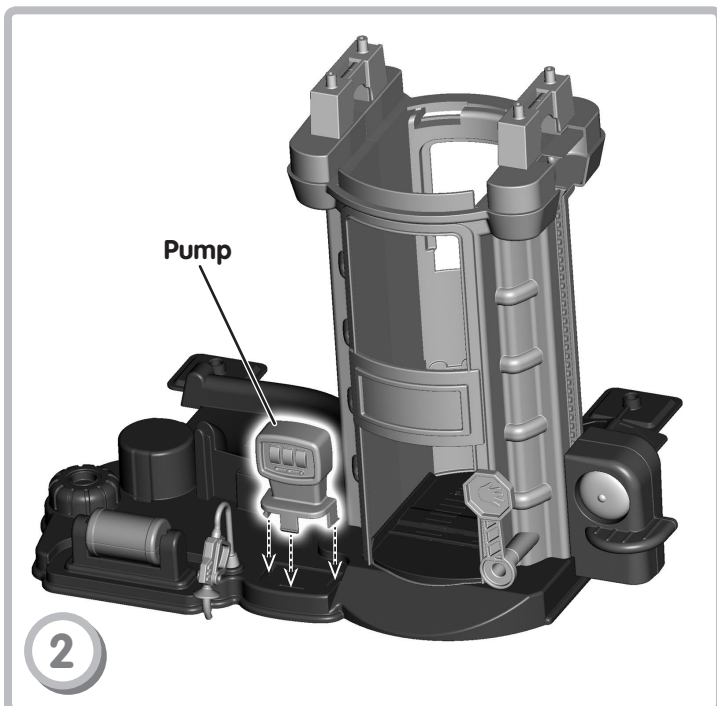

- “Snap” the pump into the base.

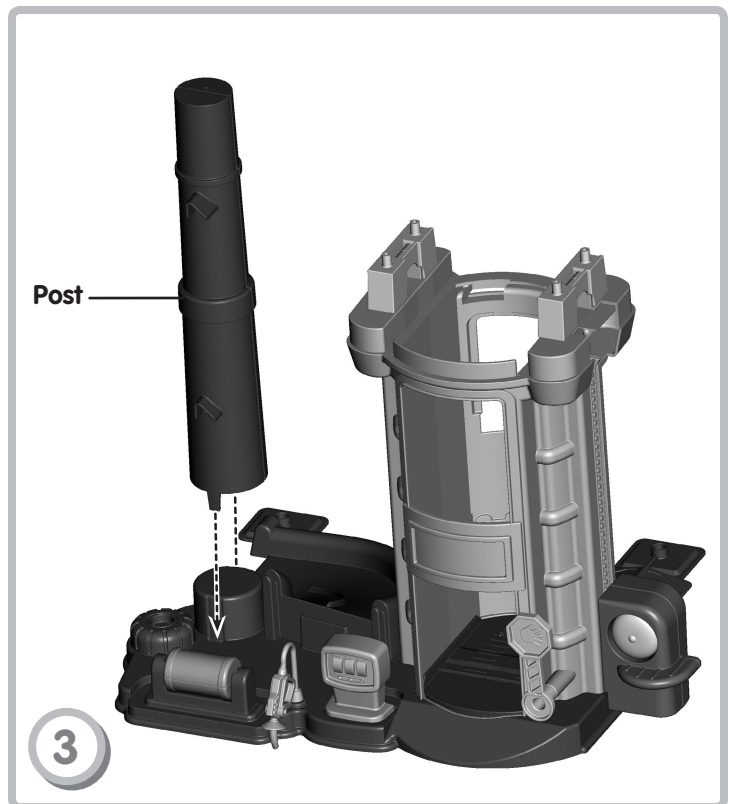

- “Snap” the post onto the base.

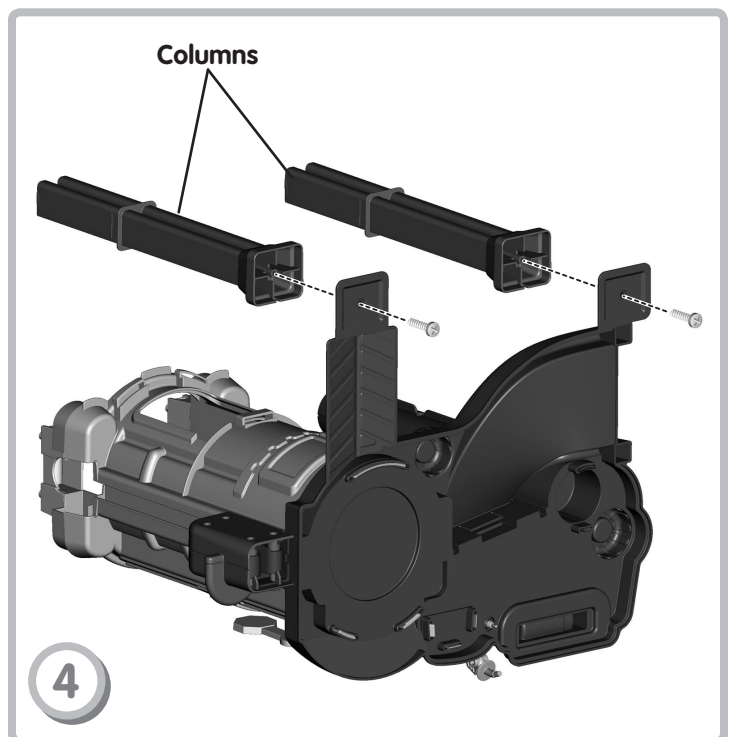

- Set the assembly on its side.
- Fit a column to a tab extending from the base. While holding the column in place, insert a screw through the base and into the column. Tighten the screw.
- Repeat this procedure to attach the other column.
- Set the assembly upright again.



# Assembly

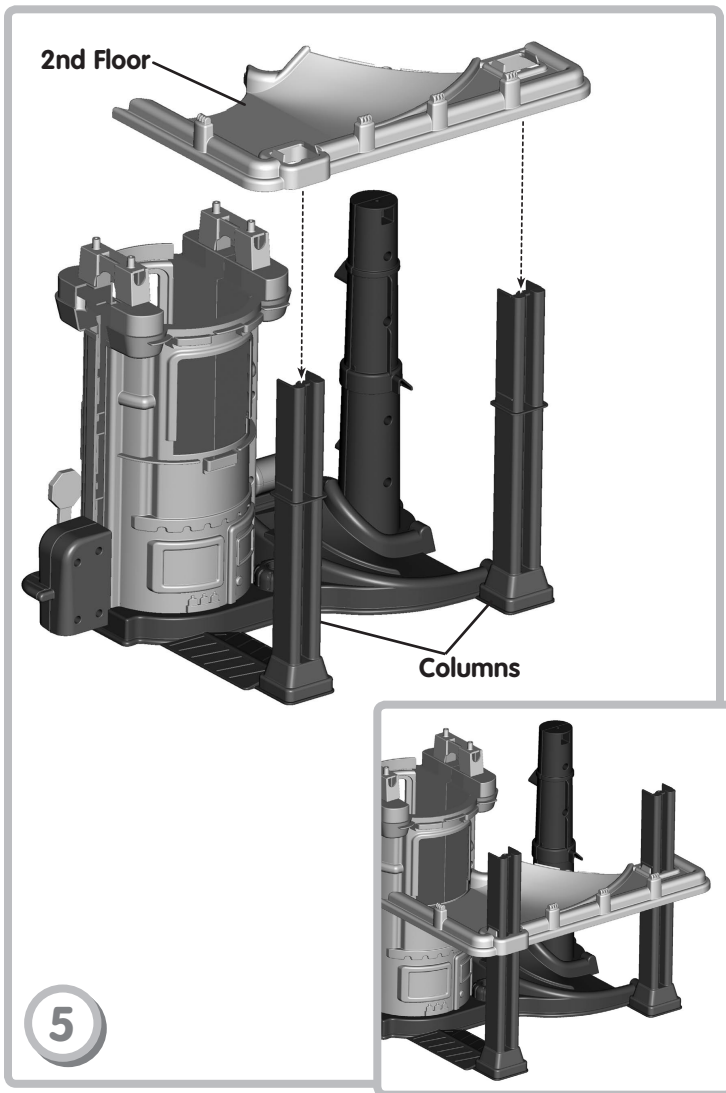

- Slide the 2nd floor onto the columns.
- Press down on the 2nd floor near the elevator and each column to **"snap"** the floor in place.

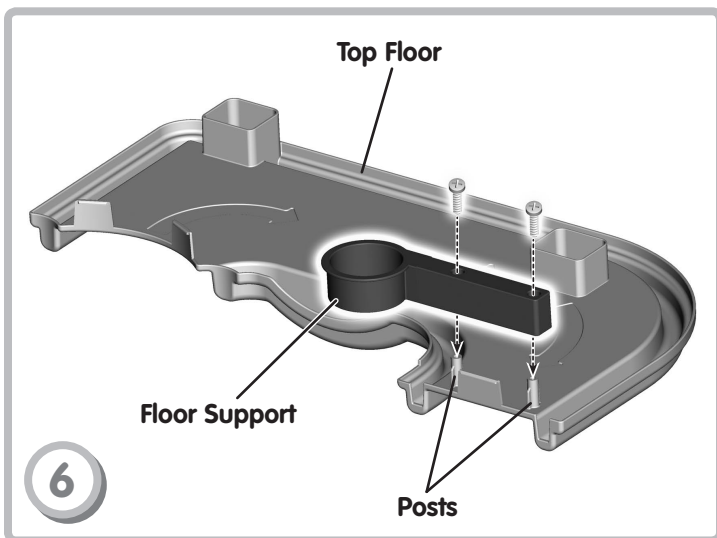

- Fit the floor support to the posts on the top floor.
- Insert two screws into the floor support and tighten.

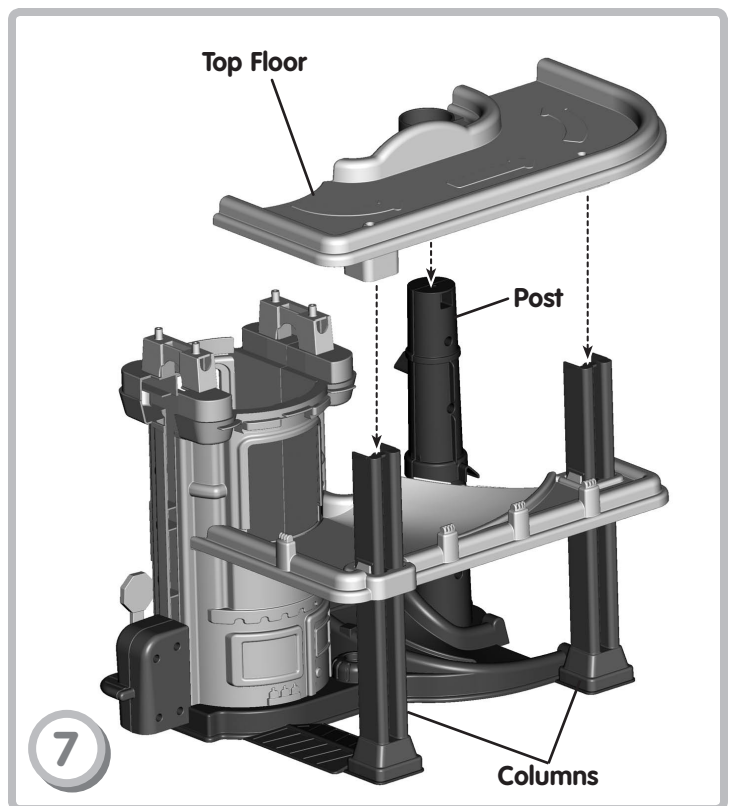

- Fit the top floor onto the post and columns.
- Press down on the top floor near the post to **"snap"** the floor in place.

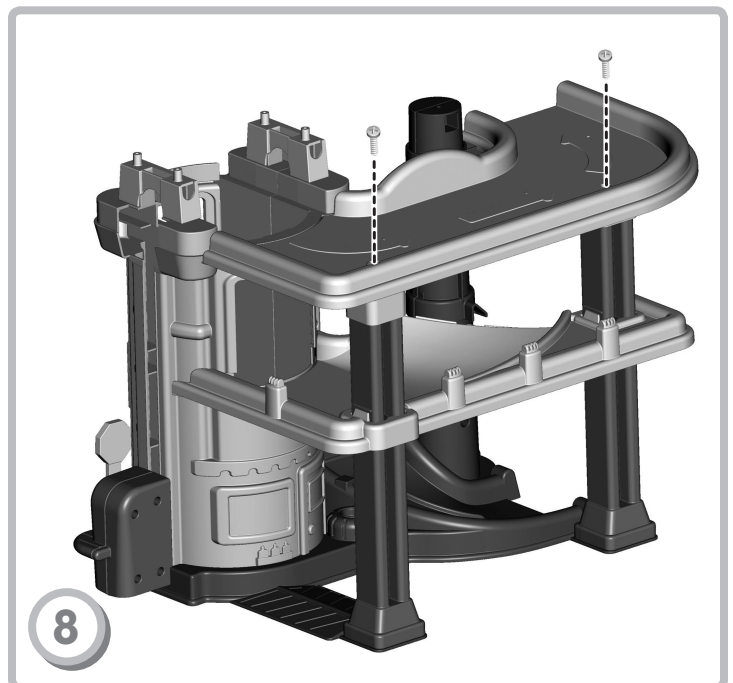

- Insert two screws into the top floor and tighten.

## Assembly

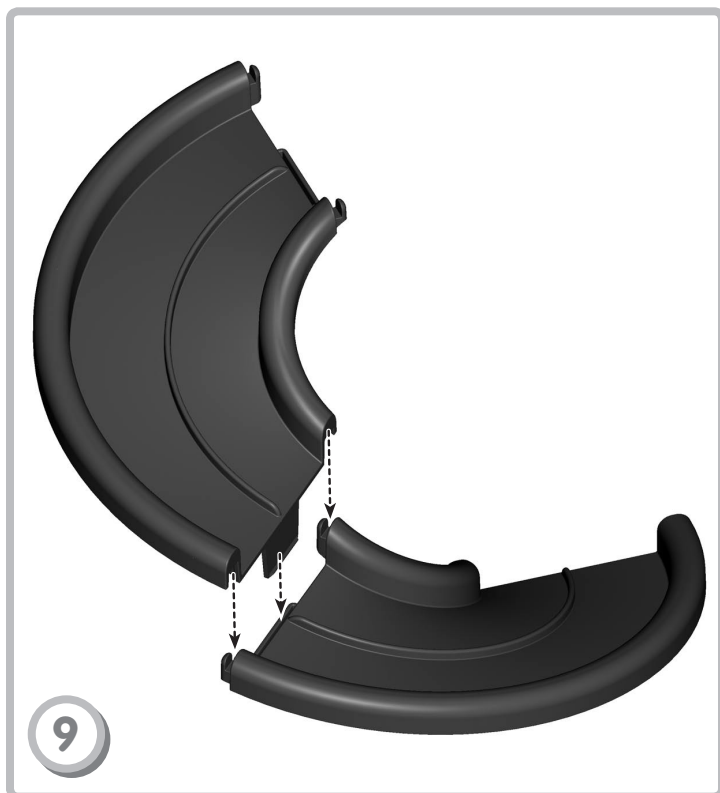

- Insert the the tabs on a ramp into the slots in another ramp.
- Repeat this procedure to assemble the remaining two ramps.



- Insert and "**snap**" the tabs on a ramp assembly into the slots in the base.

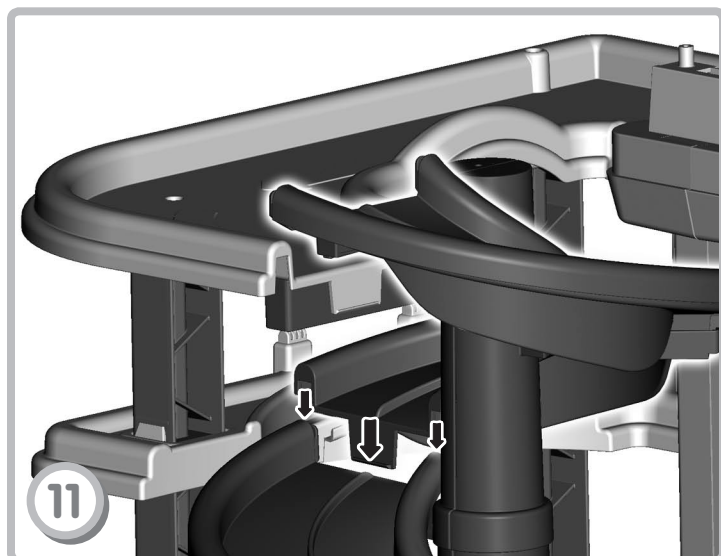

- Slide the other ramp assembly over the post.
- First, insert and "**snap**" the tabs on the ramp assembly into the slots in the other ramp assembly.

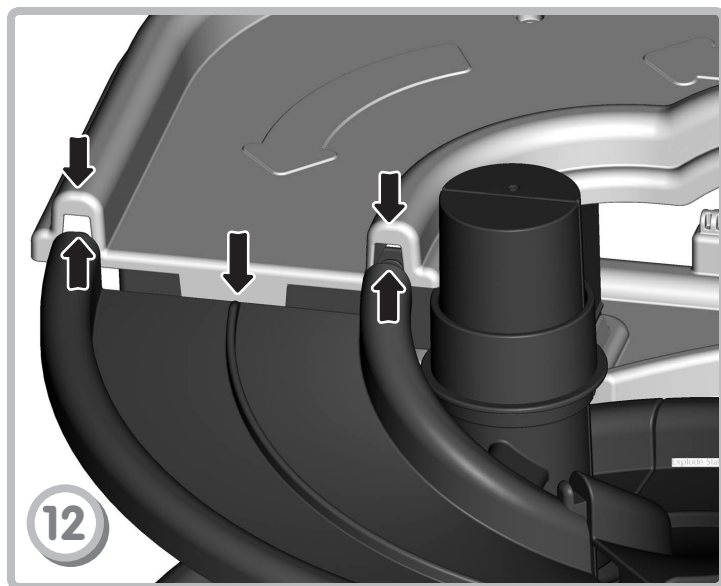

- Then, insert and "**snap**" the tab on the top floor into the slot in the ramp assembly.

## Assembly

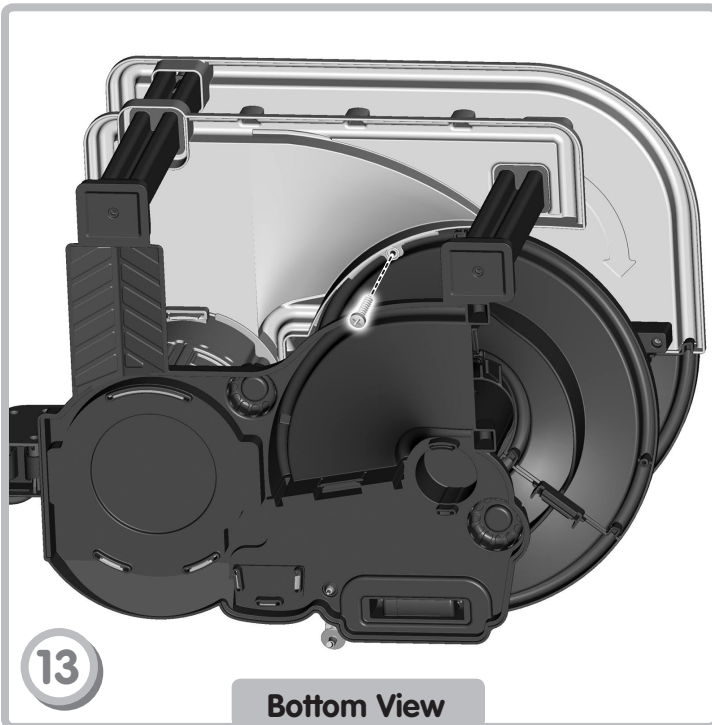

13

Bottom View

- Set the assembly upside down.
- Insert a screw through the 2nd floor and into the ramp assembly. Tighten the screw.
- Set the assembly upright.

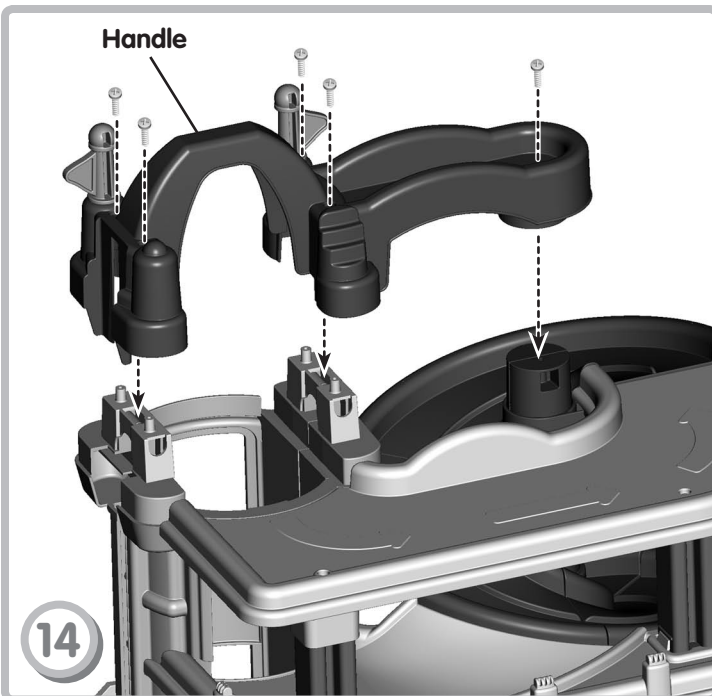

14

- Fit the handle to the top of the elevator and post.
- Insert five screws into the handle and tighten.

**Assembly is now complete**

## Battery Replacement

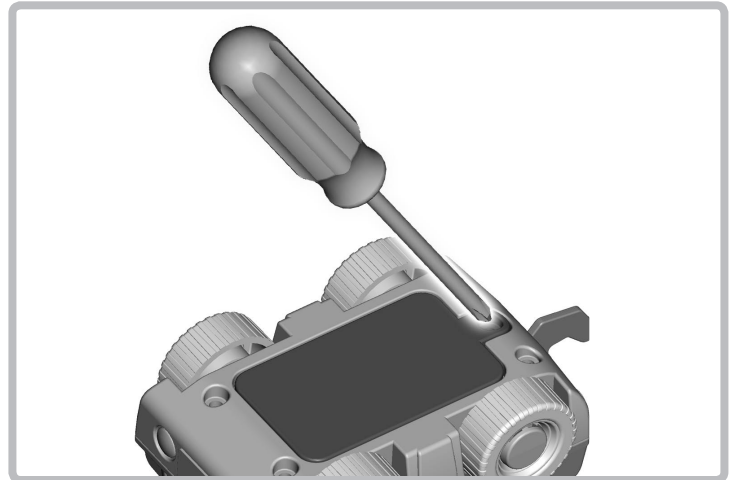
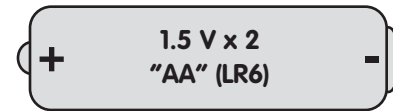

**For best performance, we recommend that you replace batteries that came with the tow truck, with two, new "AA" (LR6) alkaline batteries.**

- Locate the battery compartment on the bottom of the tow truck.
- Loosen the screw in the battery compartment door. Remove the battery compartment door.
- Insert two "AA" (LR6) **alkaline** batteries, as indicated inside the battery compartment.

**Hint:** We recommend using **alkaline** batteries for longer battery life.

- Replace the battery compartment door and tighten the screw.
- When sounds become faint or stop, it's time for an adult to change the batteries!



- Protect the environment by not disposing of this product with household waste (2002/96/EC). Check your local authority for recycling advice and facilities.

### Battery Safety Information

In exceptional circumstances, batteries may leak fluids that can cause a chemical burn injury or ruin your toy. To avoid battery leakage:

- Do not mix old and new batteries or batteries of different types: alkaline, standard (carbon-zinc) or rechargeable (nickel-cadmium).
- Insert batteries as indicated inside the battery compartment.
- Remove batteries during long periods of non-use. Always remove exhausted batteries from the toy. Dispose of batteries safely. Do not dispose of the product in a fire. The batteries inside may explode or leak.
- Never short-circuit the battery terminals.
- Use only batteries of the same or equivalent type, as recommended.
- Do not charge non-rechargeable batteries.
- Remove rechargeable batteries from the toy before charging.
- If removable, rechargeable batteries are used, they are only to be charged under adult supervision.

# Three Stories of Fun!

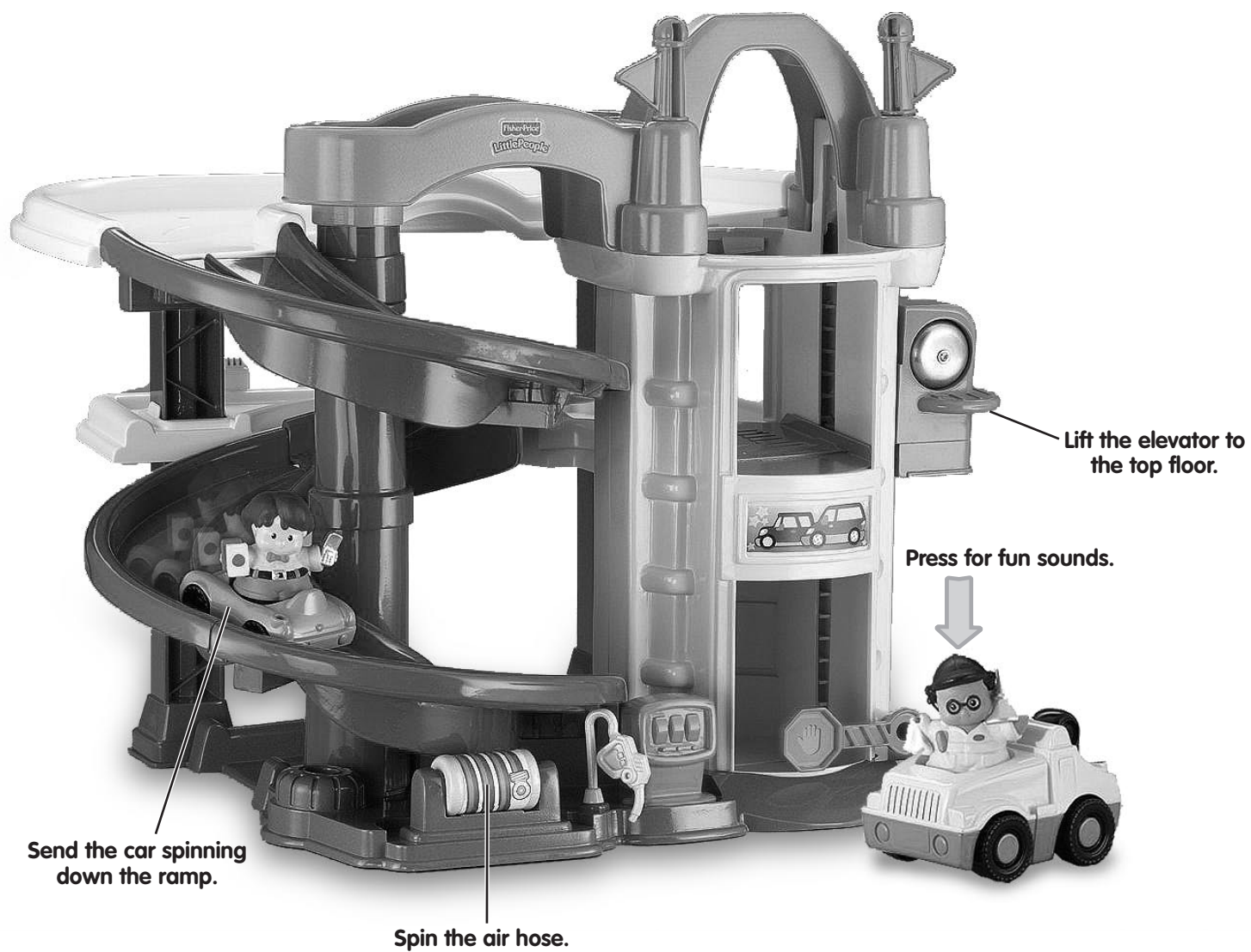



## Care

- Wipe the toy with a clean cloth dampened with a mild soap and water solution. Do not immerse the toy.
- This toy has no consumer serviceable parts. Do not take this toy apart.

## FCC Statement

### United States Only

Note: This equipment has been tested and found to comply with the limits for a Class B digital device, pursuant to Part 15 of the FCC Rules. These limits are designed to provide reasonable protection against harmful interference in a residential installation. This equipment generates, uses and can radiate radio frequency energy and, if not installed and used in accordance with the instructions, may cause harmful interference to radio communications. However, there is no guarantee that interference will not occur in a particular installation. If this equipment does cause harmful interference to radio or television reception, which can be determined by turning the equipment off and on, the user is encouraged to try to correct the interference by one or more of the following measures:

- Reorient or relocate the receiving antenna.
- Increase the separation between the equipment and receiver.
- Consult the dealer or an experienced radio/TV technician for help.

Note: Changes or modifications not expressly approved by the manufacturer responsible for compliance could void the user's authority to operate the equipment.

## Consumer Information

**Visit us on line at [www.service.fisher-price.com](http://www.service.fisher-price.com)**

Call our Consumer Relations Department, toll-free at **1-800-432-5437**, 9 AM - 7 PM EST Monday through Friday and 11 AM - 5 PM EST Saturday. Hearing-impaired consumers using TTY/TDD equipment, please call **1-800-382-7470**.

Write to us at: Fisher-Price® Consumer Relations, 636 Girard Avenue, East Aurora, New York 14052.

### For countries outside the United States:

#### CANADA

**Questions? 1-800-432-5437.** Mattel Canada Inc., 6155 Freemont Blvd., Mississauga, Ontario L5R 3W2; [www.service.mattel.com](http://www.service.mattel.com).

#### GREAT BRITAIN

Mattel UK Ltd, Vanwall Business Park, Maidenhead SL6 4UB.  
Helpline: 01628 500303; [www.service.mattel.com/uk](http://www.service.mattel.com/uk).

#### AUSTRALIA

Mattel Australia Pty. Ltd., 658 Church Street, Locked Bag #870, Richmond, Victoria 3121 Australia. Consumer Advisory Service 1300 135 312.

#### NEW ZEALAND

16-18 William Pickering Drive, Albany 1331, Auckland.

#### ASIA

Mattel East Asia Ltd, Room 1106, South Tower, World Finance Centre, Harbour City, Tsimshatsui, HK, China.