



INSTRUCTIONS

Keep these instructions for future reference as they contain important information.

CONTENTS:



6"

(15.2 cm)

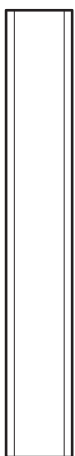

8"

(20.3 cm)



8"

(20.3 cm)

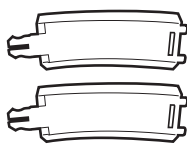
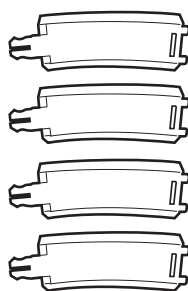
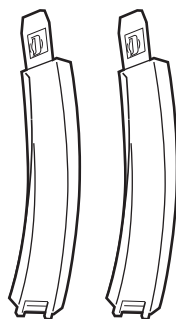
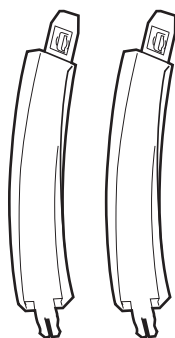

6 - 45°

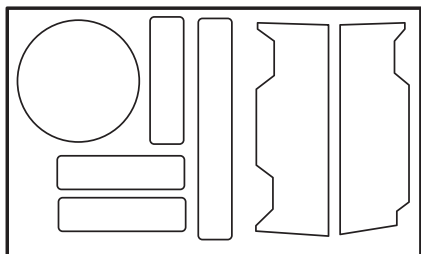

BRIDGE

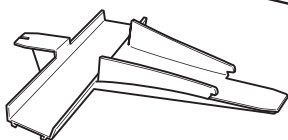
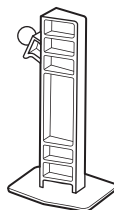
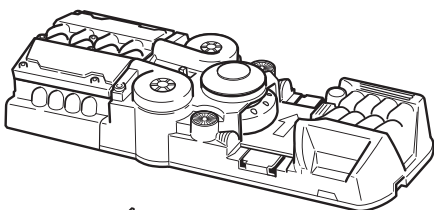
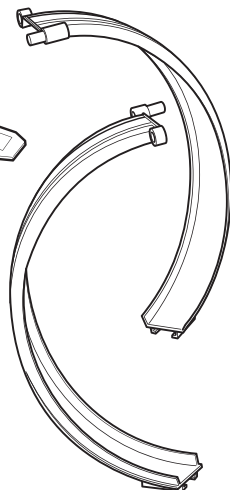

5 +



Requires 2 "D" alkaline batteries (not included).

13784-0920
Asst. K9414

Mattel, Inc. 333 Continental Blvd., El Segundo, CA 90245 U.S.A. All Rights Reserved. Consumer Relations 1-800-524-8697. service.mattel.com [Mattel U.K. Ltd.](http://Mattel.U.K.Ltd.), Vanwall Business Park, Maidenhead SL6 4UB. Helpline 01628500303 [Mattel Australia Pty Ltd.](http://Mattel.Australia.Pty.Ltd.), Richmond, Victoria. 3121. Consumer Advisory Service - 1300 135 312. [Mattel East Asia Ltd.](http://Mattel.East.Asia.Ltd.), Room 1106, South Tower, World Finance Centre, Harbour City, Tsimshatsui, HK, China. Diimport & Diedarkan Oleh: [Mattel SEA Ptd Ltd.](http://Mattel.SEA.Ptd.Ltd.)(993532-P) Lot 13.5, Menara Lien Hoe, Persiaran Tropicana Golf Country Resort, 47410 PJ. Tel:03-78803817, Fax:03-78803867.

© 2006 Mattel, Inc. All Rights Reserved.

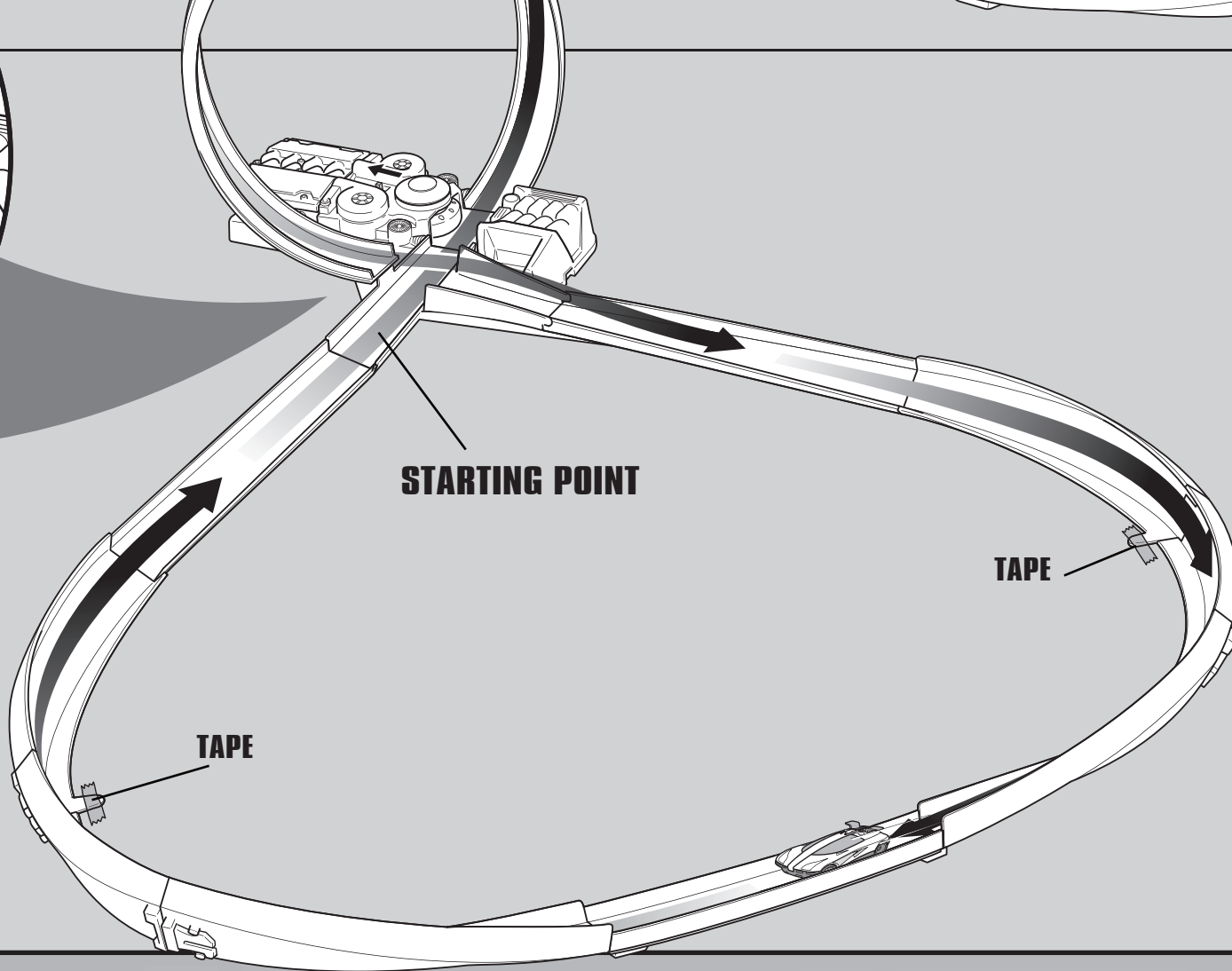
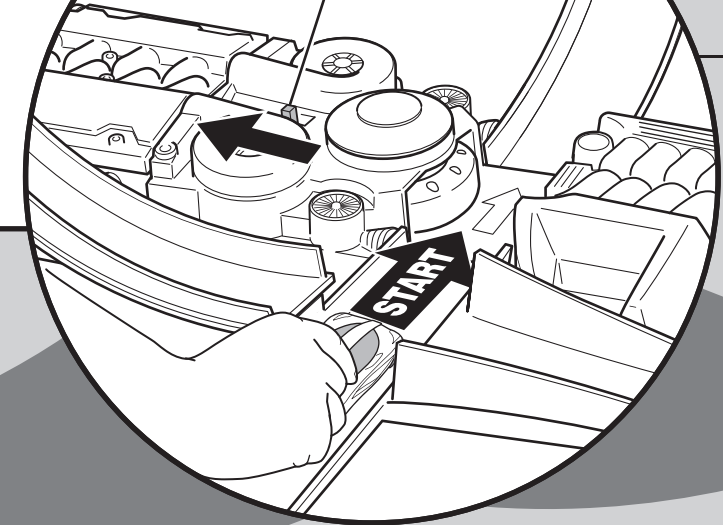

INSTALL BATTERIES

Open battery cover and insert 2 "D" size alkaline batteries (not included) as shown. For best performance, use alkaline batteries. Replace the batteries when the booster no longer propels the car through the set.

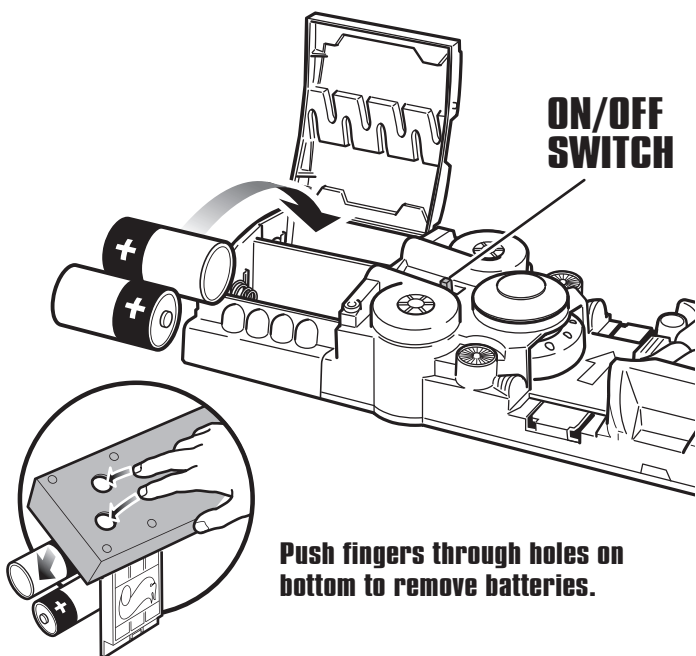

OPERATING TIPS

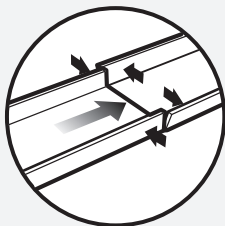

Adjust track side walls at each connection point as shown.

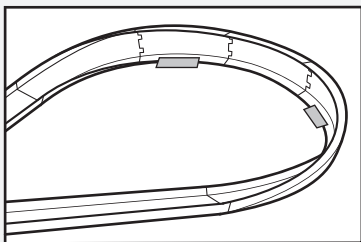

TO STABILIZE SET: On carpet, use books. On smooth floor, tape base to surface.

ASSEMBLY

3

1.

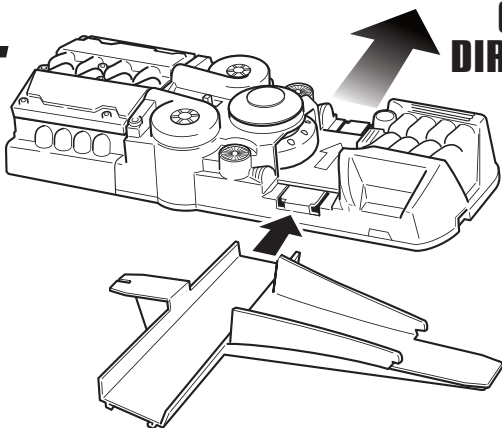

CAR
DIRECTION

2.

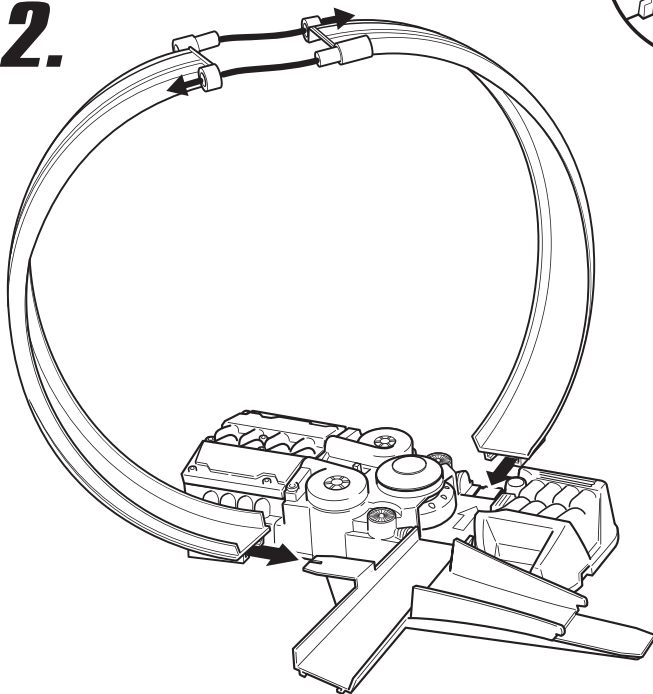

3a.

ION

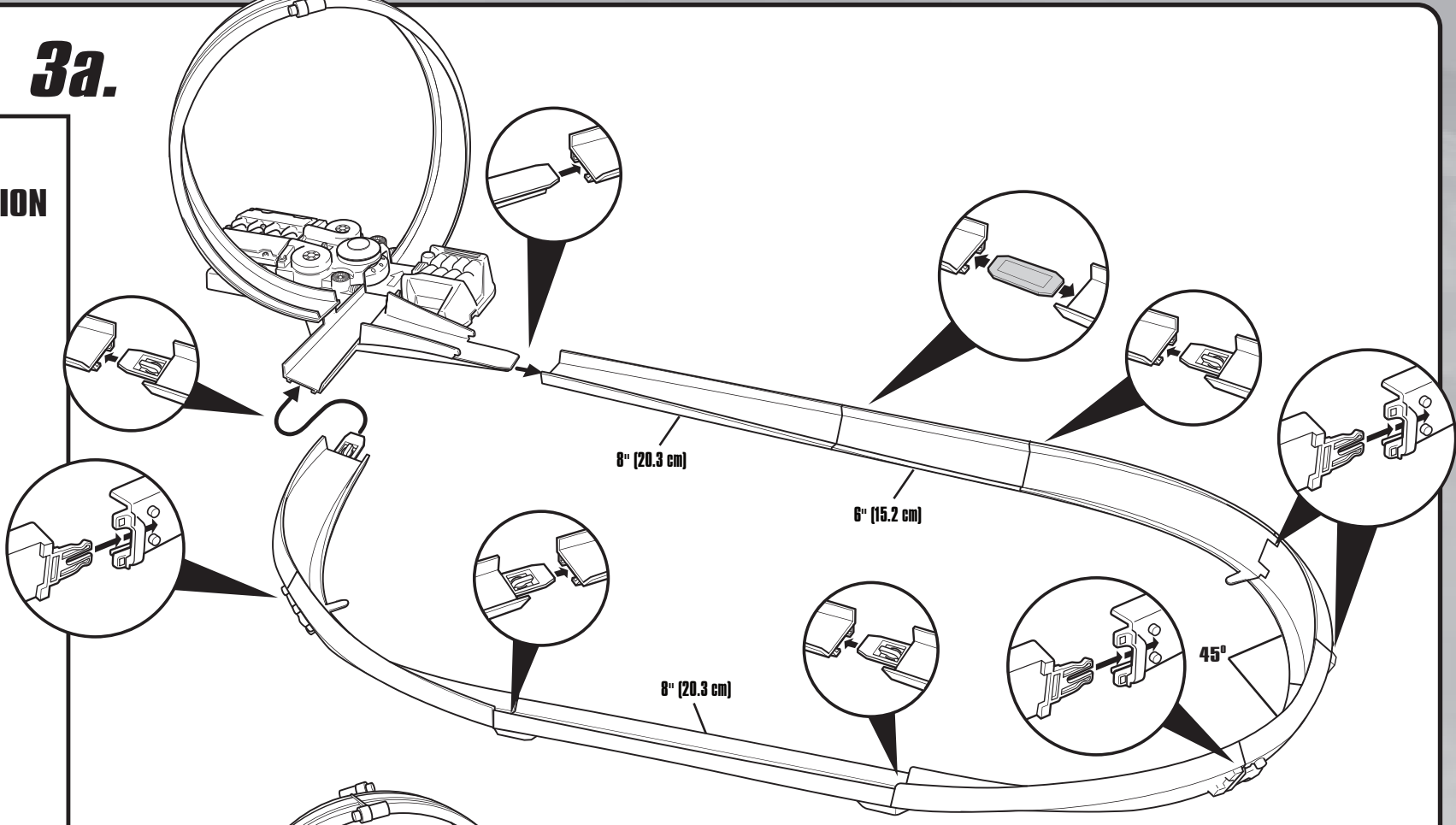

3b.

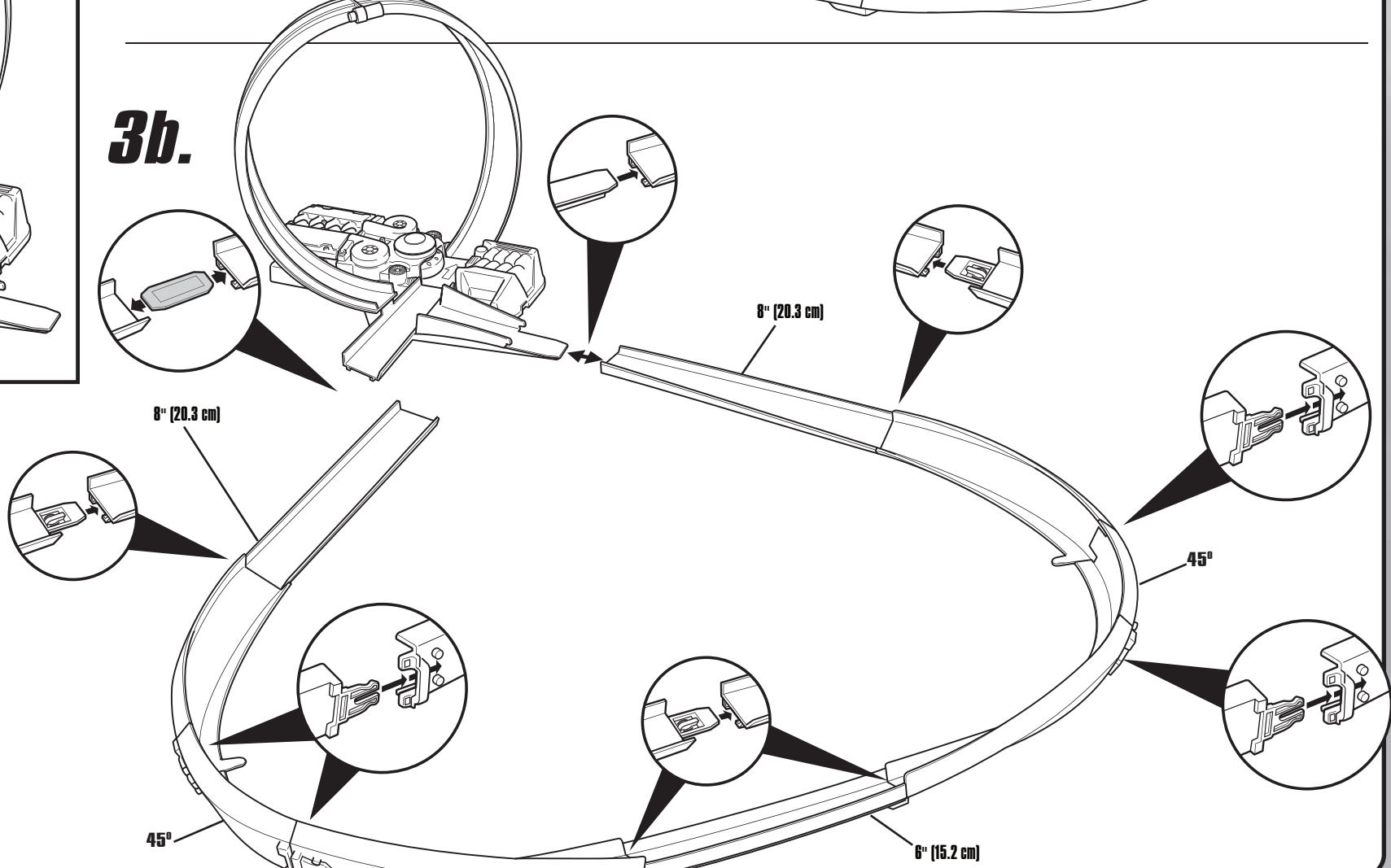

APPLY LABELS

Apply labels by number as shown.

LABEL SHEET

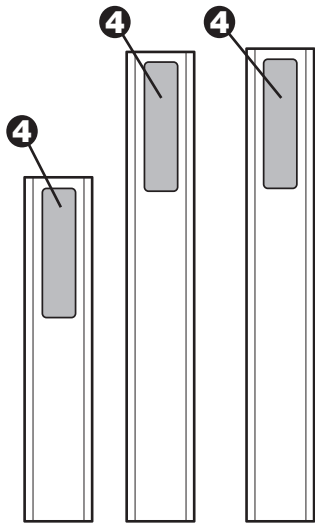
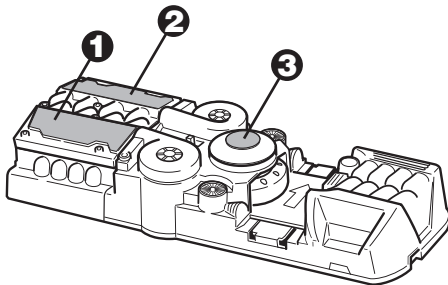
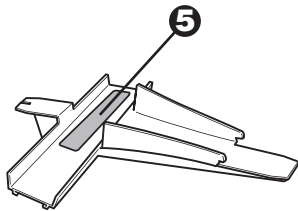
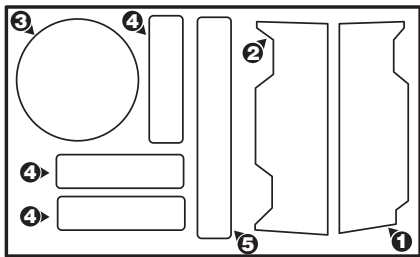

3c.

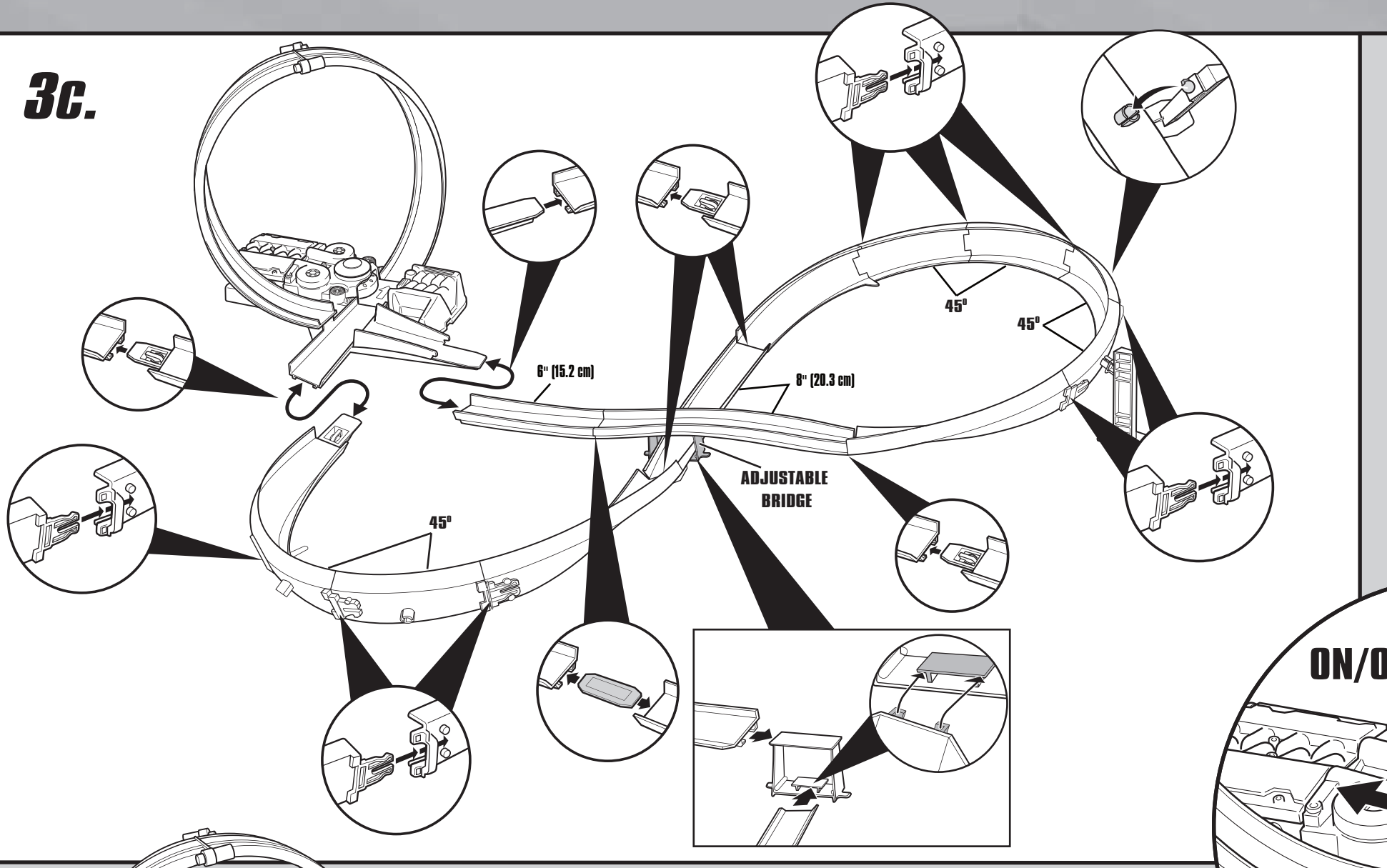

TO PLAY

Turn power switch on.
Place car at starting point as shown.

Replace batteries when the booster can
no longer propel cars through the set.

/OFF SWITCH

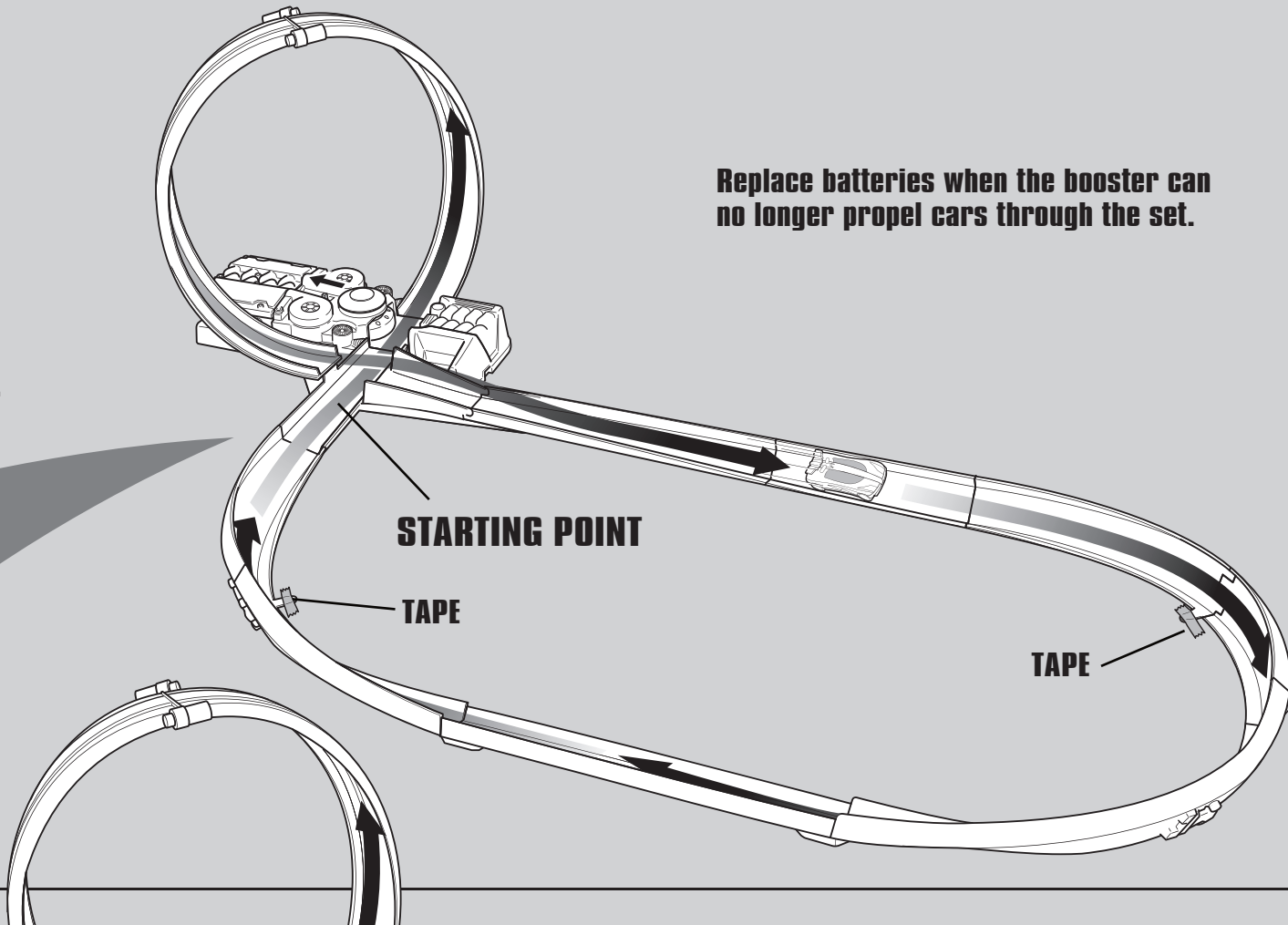

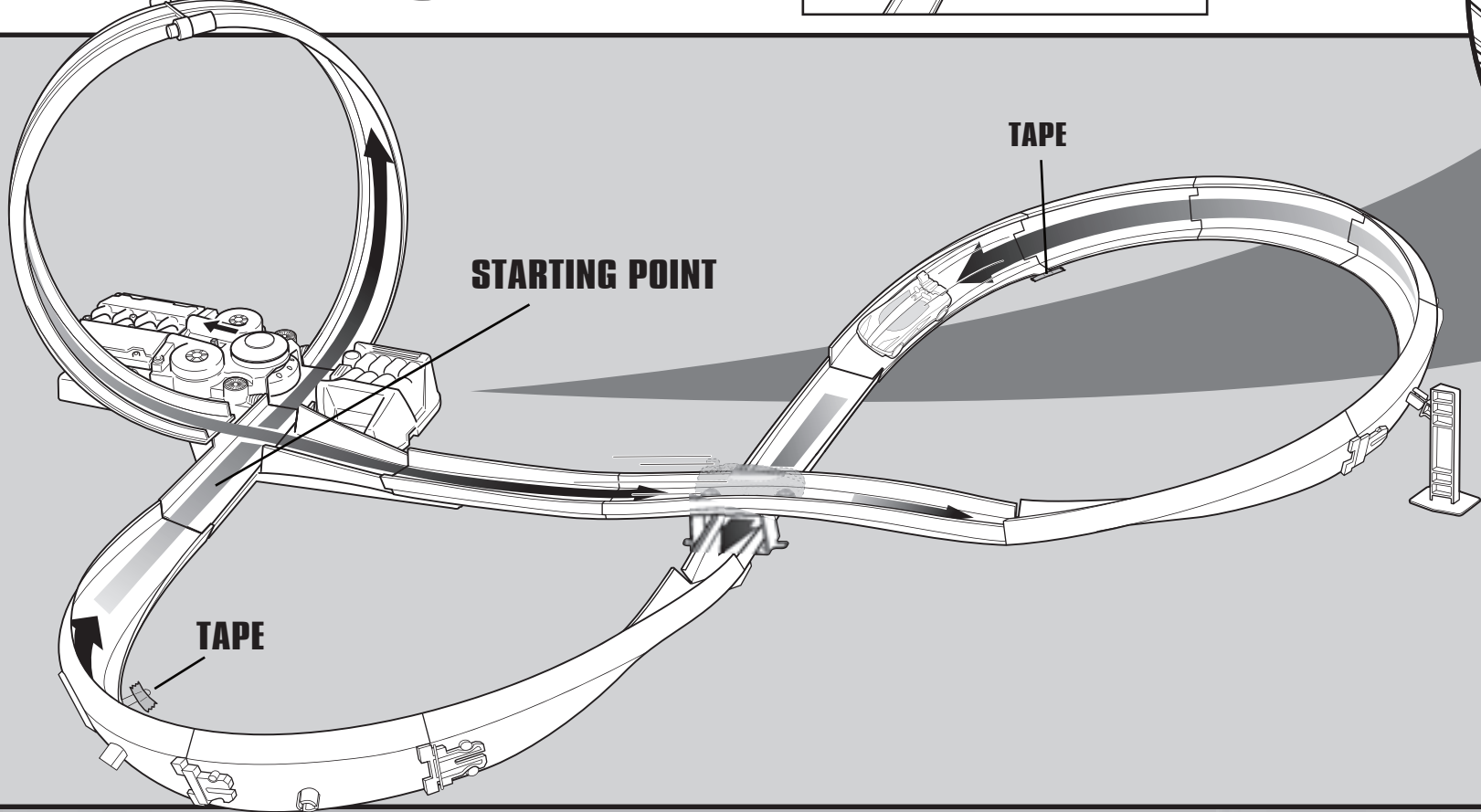

STARTING POINT

TAPE

TAPE

