

2-in-1 Learning Kitchen™

Please keep this instruction sheet for future reference, as it contains important information.

Requires three "C" (LR14) **alkaline** batteries (not included).

Adult assembly is required.

Tool required for assembly: Phillips screwdriver (not included).



Laugh & Learn™

Parts



Kitchen Light

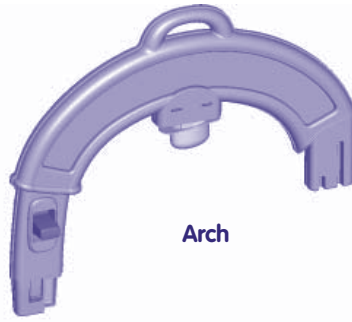

Arch



Refrigerator

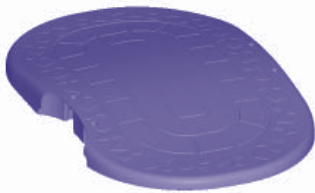

Rug



Oven Door



Countertop



Oven Base



Sink Base

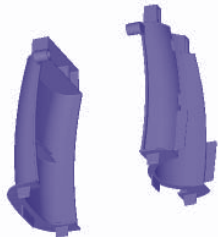

2 Oven Walls



Oven Rack



Shape Sorter



Pipe



Toaster



Stove Knob



Faucet



Handle



Flower



Spoon



Pan

#6 x 1" (2.5 cm) Screw – 12
Shown Actual Size



Note: Tighten or loosen all screws with a Phillips screwdriver. Do not over-tighten the screws.

Parts not shown: 2 Balls, 3 Shape Blocks

Assembly

⚠ CAUTION

This product contains small parts for assembly by an adult. Take extra care during unpacking and assembly.

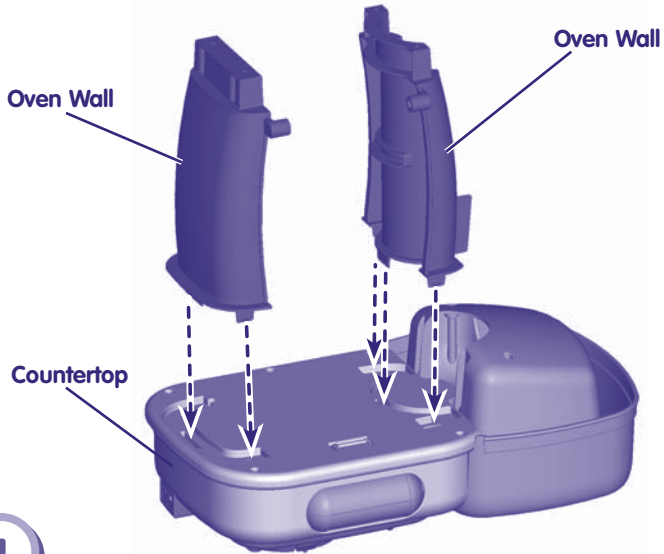

1

- Fit the tabs on the oven walls into the slots in the countertop.

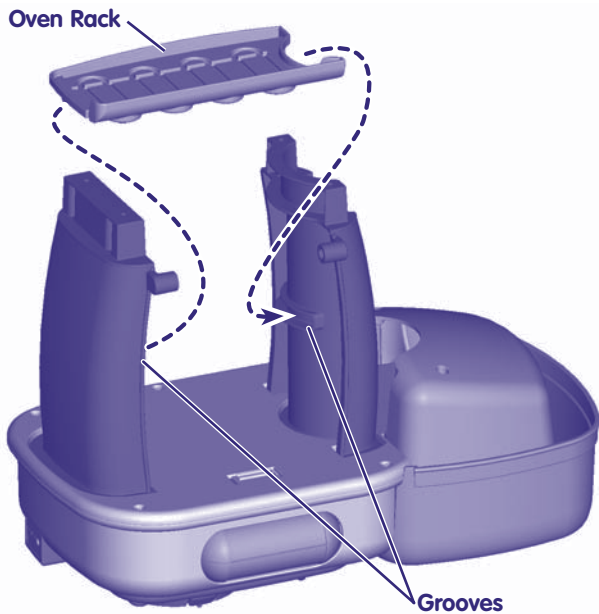

2

- Turn the oven rack upside-down (detail side down) and fit it into the groove in each oven wall.
- Hint:** The oven rack is designed to fit one way. If it does not fit, turn the oven rack over and try again.

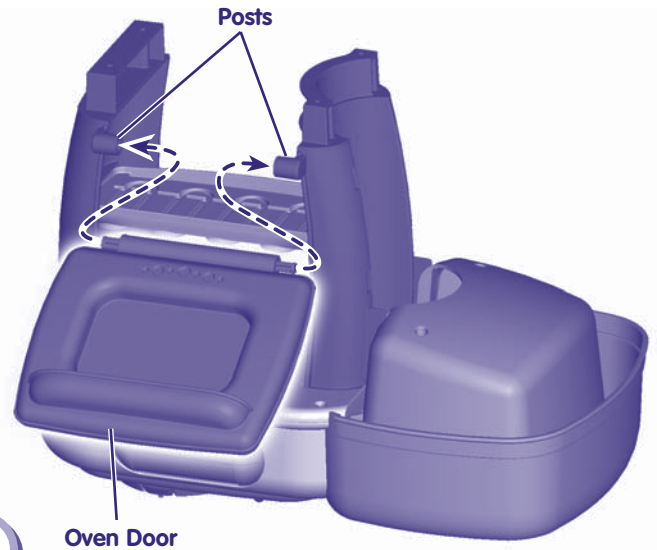

3

- Turn the oven door upright (detail side up) and fit the pegs into the posts on each side of the oven.
- Hint:** The oven door is designed to fit one way. If it does not fit, turn the oven door over and try again.

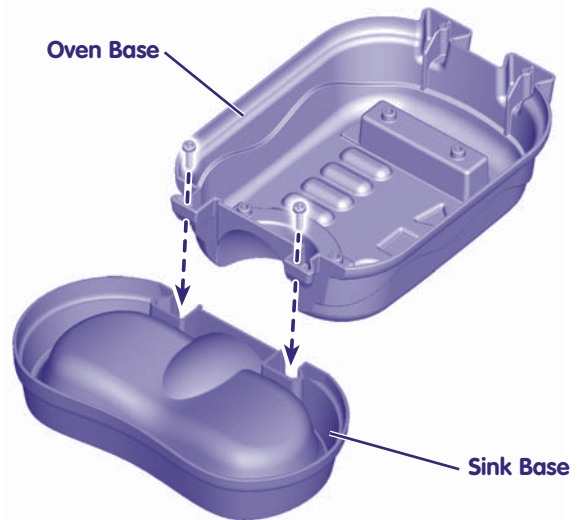

4

- Fit the tabs on the oven base into the slots in the sink base.
- Insert two screws into the oven base and tighten.

Assembly

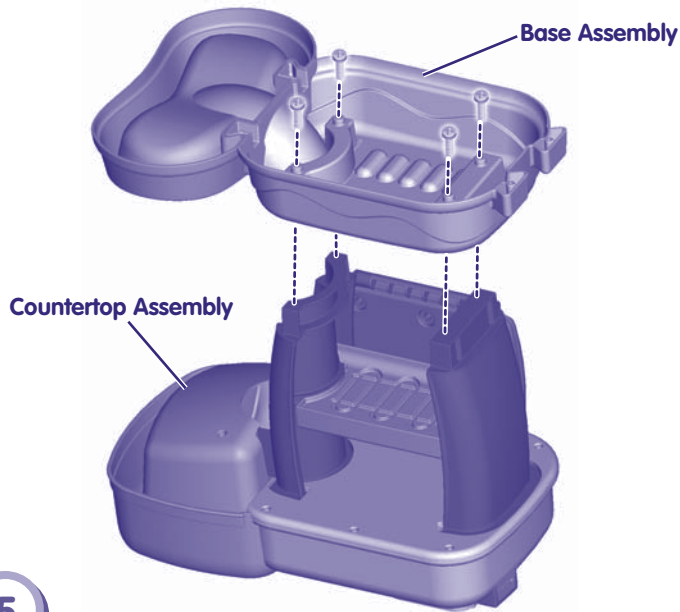

5

- Fit the base assembly onto the countertop assembly.
- Insert four screws into the base assembly and tighten.

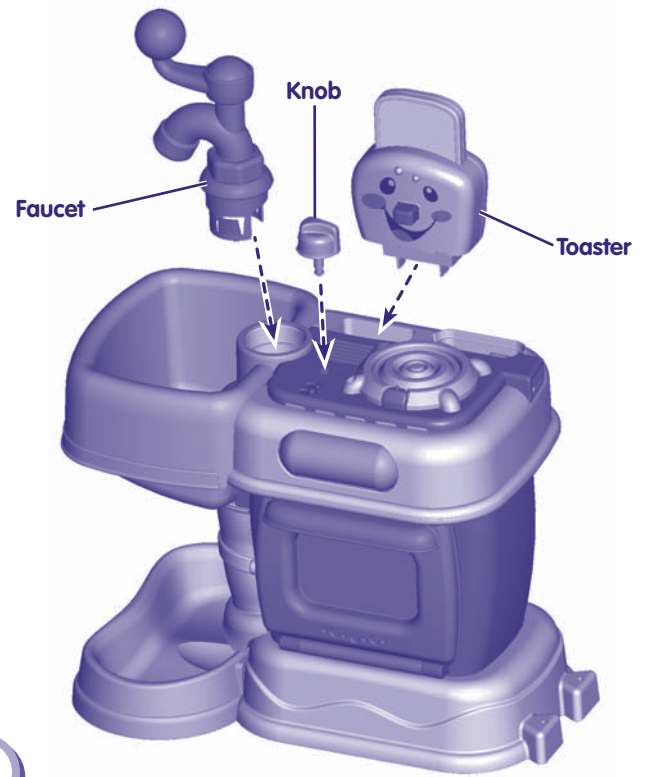

7

- Insert and **"snap"** the faucet, knob and toaster into the countertop, as shown.

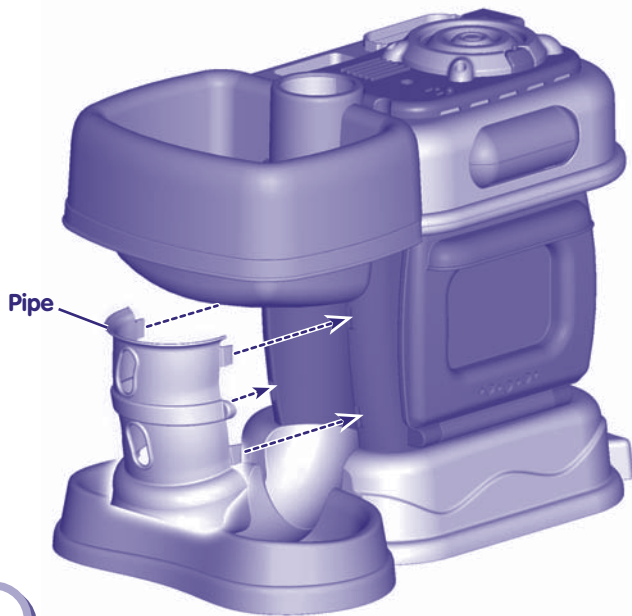

6

- Turn the assembly upright.
- Insert and **"snap"** the tabs on the pipe into the slots in the assembly, under the sink.

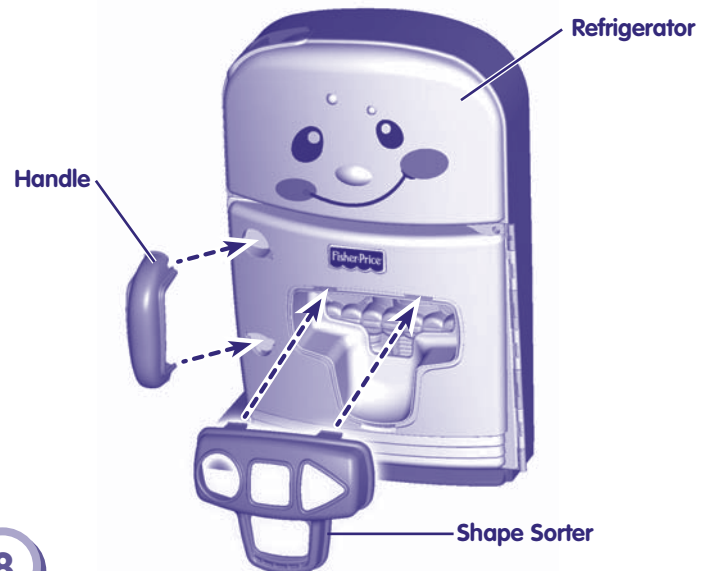

8

- Insert and **"snap"** the shape sorter and handle into the front of the refrigerator.

Hint: This may require extra force.

Assembly

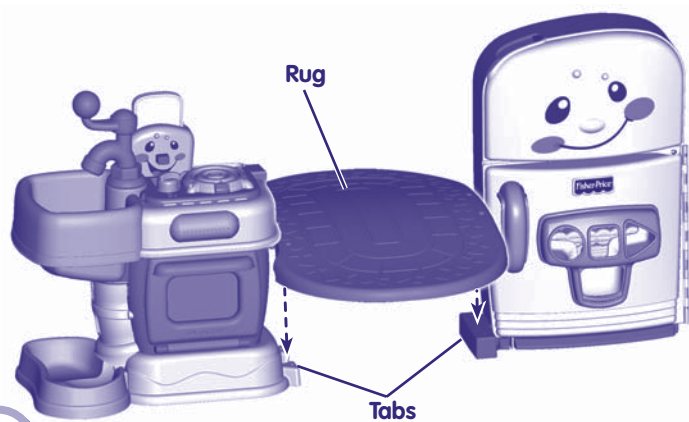

9

- Position the main assembly and the refrigerator as shown.
- Fit the rug grooves to the tabs on the base of the main assembly and the tab on the base of the refrigerator.

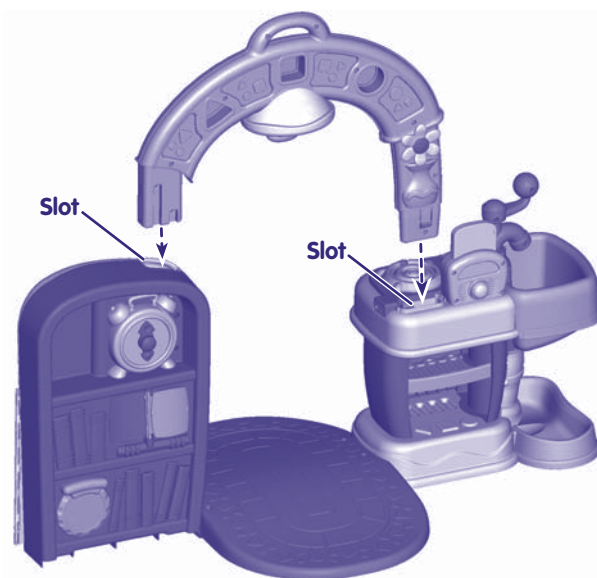

12

- Insert and **"snap"** the arch into the slot in the top of the refrigerator and the countertop.



10

- Insert four screws into the rug and tighten.

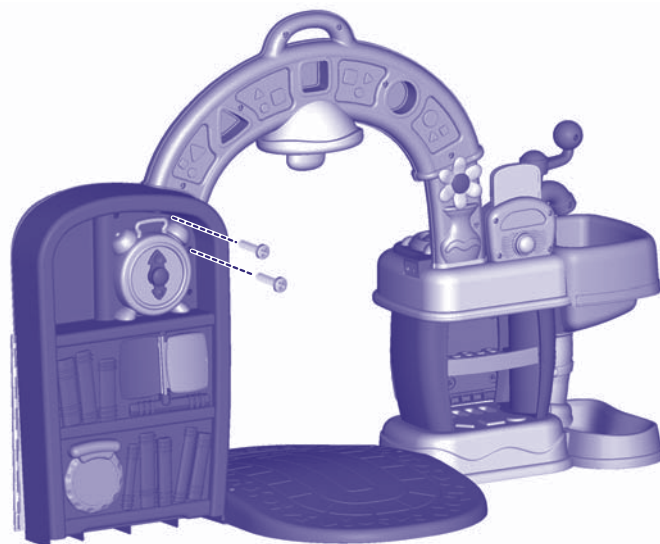

13

- Insert two screws into the back of the refrigerator, near the clock. Tighten the screws.
- Assembly is now complete.**

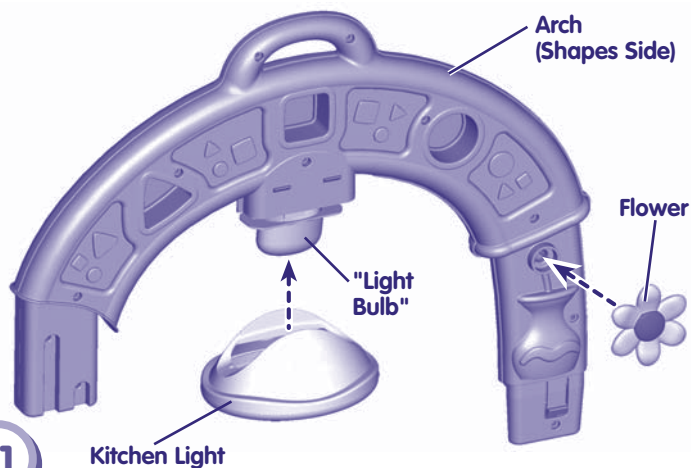

11

- Position the arch with the shapes facing you. Slide and **"snap"** the kitchen light to the arch over the "light bulb".

Hint: The kitchen light is designed to be assembled to the arch one way. If it doesn't "snap" onto the arch, turn it around and try again.

- Check to be sure the kitchen light is assembled properly by pulling it down. If you can remove it, please repeat this assembly step.
- Insert and **"snap"** the flower into the hole in the arch.

Battery Installation

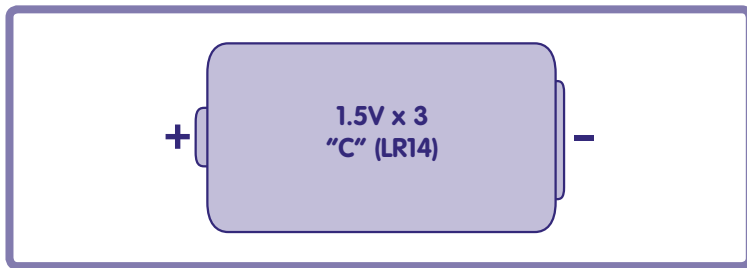
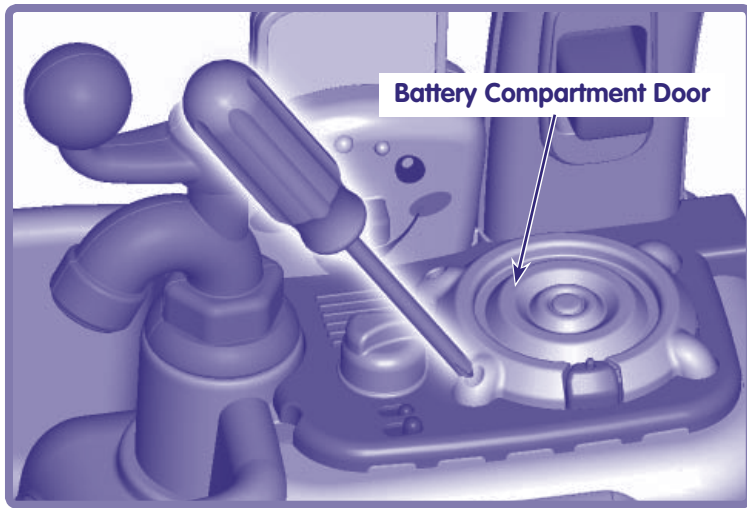

- Locate the battery compartment door (burner) on the countertop.
- Loosen the screws in the battery compartment door. Remove the battery compartment door.
- Insert three "C" (LR14) **alkaline** batteries, as indicated inside the battery compartment.

Hint: We recommend using **alkaline** batteries for longer battery life.

- Replace the battery compartment door and tighten the screws.
- When lights or sounds from this toy become faint or stop, it's time for an adult to change the batteries!



- Protect the environment by not disposing of this product with household waste (2002/96/EC). Check your local authority for recycling advice and facilities (Europe only).

Battery Safety Information

In exceptional circumstances, batteries may leak fluids that can cause a chemical burn injury or ruin your product. To avoid battery leakage:

- Do not mix old and new batteries or batteries of different types: alkaline, standard (carbon-zinc) or rechargeable (nickel-cadmium).
- Insert batteries as indicated inside the battery compartment.
- Remove batteries during long periods of non-use. Always remove exhausted batteries from the product. Dispose of batteries safely. Do not dispose of this product in a fire. The batteries inside may explode or leak.
- Never short-circuit the battery terminals.
- Use only batteries of the same or equivalent type, as recommended.
- Do not charge non-rechargeable batteries.
- Remove rechargeable batteries from the product before charging.
- If removable, rechargeable batteries are used, they are only to be charged under adult supervision.

FCC Statement

United States Only

This equipment has been tested and found to comply with the limits for a Class B digital device, pursuant to Part 15 of the FCC Rules. These limits are designed to provide reasonable protection against harmful interference in a residential installation. This equipment generates, uses and can radiate radio frequency energy and, if not installed and used in accordance with the instructions, may cause harmful interference to radio communications. However, there is no guarantee that interference will not occur in a particular installation. If this equipment does cause harmful interference to radio or television reception, which can be determined by turning the equipment off and on, the user is encouraged to try to correct the interference by one or more of the following measures:

- Reorient or relocate the receiving antenna.
- Increase the separation between the equipment and receiver.
- Consult the dealer or an experienced radio/TV technician for help.

Note: Changes or modifications not expressly approved by the manufacturer responsible for compliance could void the user's authority to operate the equipment.

Care

- Wipe this toy with a clean cloth dampened with a mild soap and water solution. Do not immerse this toy.
- This toy has no consumer serviceable parts. Do not take this toy apart.
- Before use, thoroughly wash all parts that may contact food. The pan and spoon are not dishwasher safe.

Two Sides of Learning Fun!

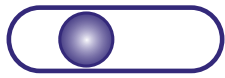

○ **ABC** 🎵 🌀

Slide the mode switch to either **ABC** Learning Time, 🎵 Musical fun, 🌀 Imagination or ○ Off.

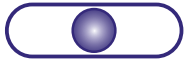

Adjust the volume to 🔊 low, 🔊 medium or 🔊 high for your child's comfort.



ABC Learning Time

Learn A-B-C's, 1-2-3's, colors, shapes and more!

🎵 Musical Fun

Listen to favorite tunes, fun phrases and silly sounds.

🌀 Imagination

Enjoy role play fun along with realistic sounds in the kitchen.

Consumer Information

Visit us on line at www.service.fisher-price.com

Call our Consumer Relations Department, toll-free at **1-800-432-5437**, 9 AM - 7 PM EST Monday through Friday and 11 AM - 5 PM EST Saturday. Hearing-impaired consumers using TTY/TDD equipment, please call 1-800-382-7470. Write to us at: Fisher-Price® Consumer Relations, 636 Girard Avenue, East Aurora, New York 14052.

Learn every day - through fun, familiar play!

Make learning more fun with the whole collection of **Laugh & Learn™** toys. With rich music, lyrics and lots of activities, they combine early academics and everyday experiences, for the way kids really learn.

Each sold separately and subject to availability.



J9163



K7164



K7165



G6167



C6325



L3479



K6423



L5847



K6422



L3480



J2462



L5846

For countries outside the United States:

CANADA: Questions? 1-800-432-5437. Mattel Canada Inc., 6155 Freemont Blvd., Mississauga, Ontario L5R 3W2; www.service.mattel.com.

GREAT BRITAIN: Mattel UK Ltd, Vanwall Business Park, Maidenhead SL6 4UB. Helpline: 01628 500303. www.service.mattel.com/uk

AUSTRALIA: Mattel Australia Pty. Ltd., 658 Church Street, Locked Bag #870, Richmond, Victoria 3121 Australia. Consumer Advisory Service 1300 135 312.

NEW ZEALAND: 16-18 William Pickering Drive, Albany 1331, Auckland.

ASIA: Mattel East Asia Ltd, Room 1106, South Tower, World Finance Centre, Harbour City, Tsimshatsui, HK, China.