



Instructions
Faucet and Clock Removal and Installation

2-in-1 Learning Kitchen Model Number L5067

WARNING

CHOKING HAZARD

- The faucet may break into small pieces and the clock hands may be removed from the clock if pushed or pulled with a lot of force. These parts may accidentally be swallowed. **DO NOT** use this toy until you remove and replace the faucet and clock.
- **DO NOT** allow children to remove or install these parts.

Kit Parts

Tools needed for removal: Tool (included) and
Flat Blade Screwdriver (not included).



Clock



Faucet



Tool

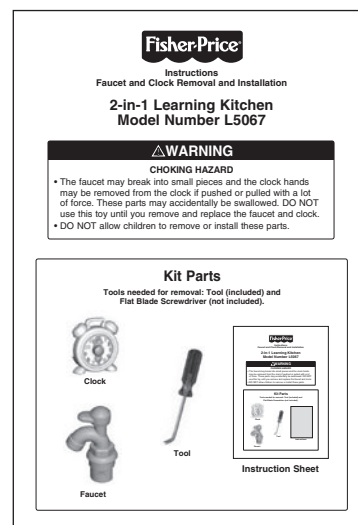

Instruction Sheet

Removal Instructions

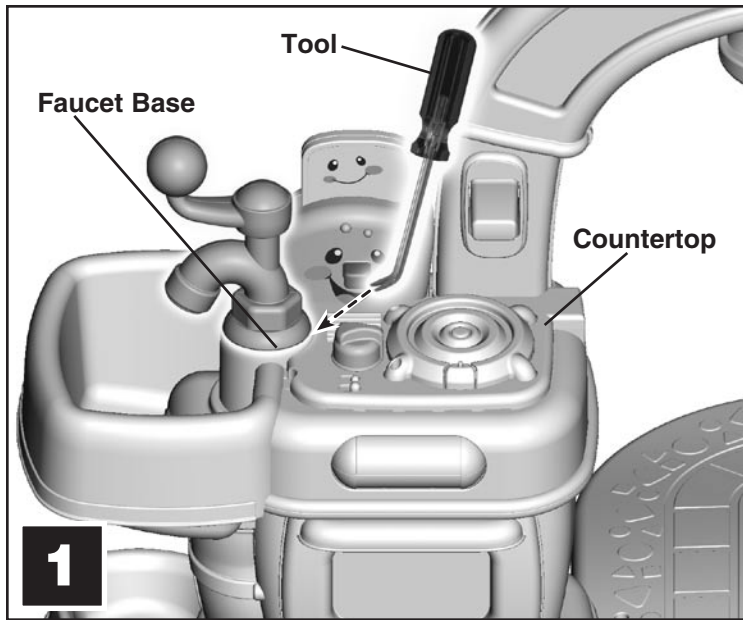

- Fit the end of the tool between the base of the faucet and the countertop.

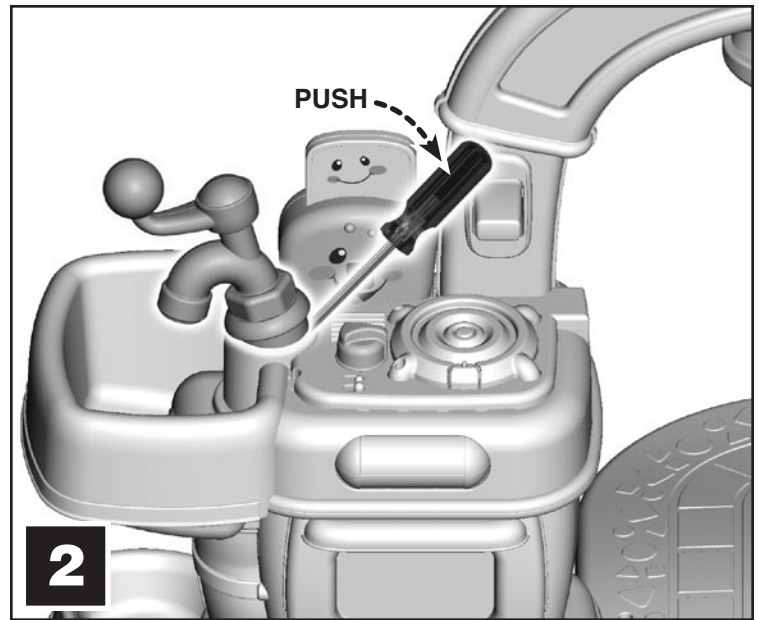

- Push the tool down slowly to pry the faucet from the countertop.
- When you hear a “snap”, remove the tool.

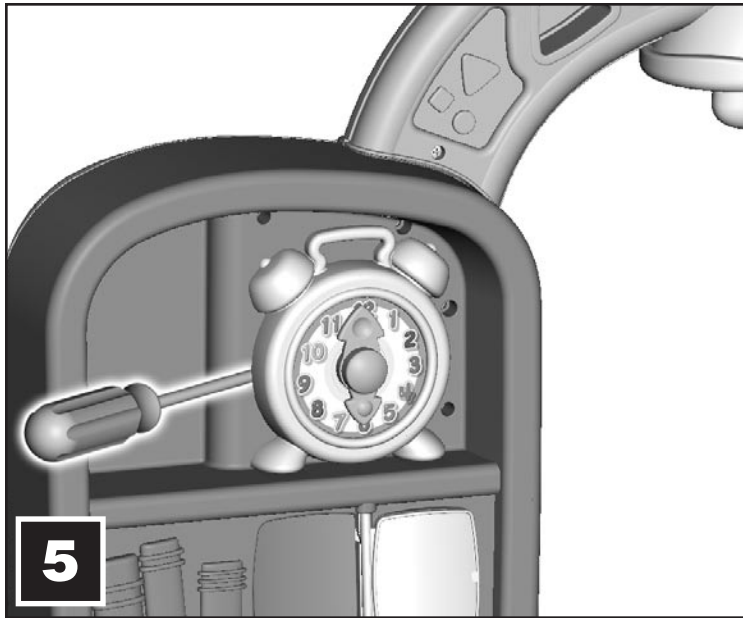

- First, fit the end of a flat blade screwdriver into a slot on one side of the clock. Gently pry the edge of the clock.

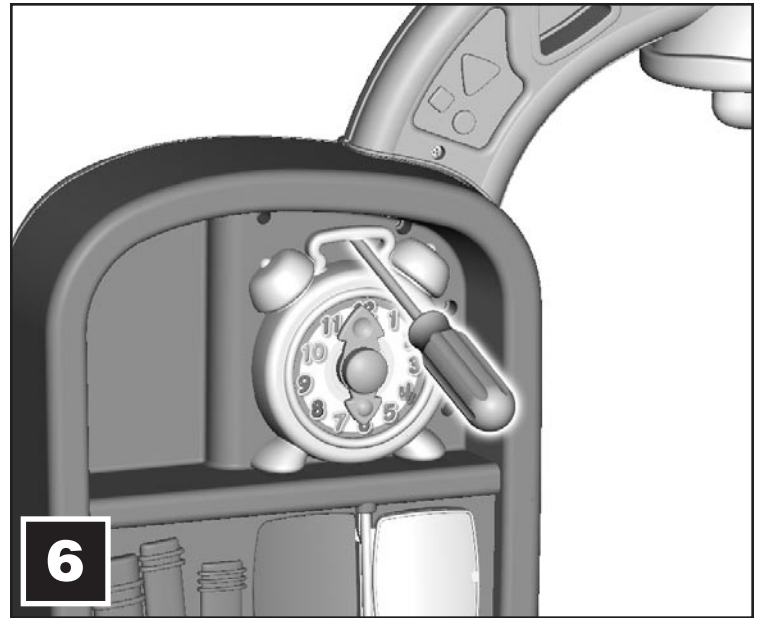

- Next, fit the end of a flat blade screwdriver into the slot on the top of the clock. Gently pry the edge of the clock.

Instructions

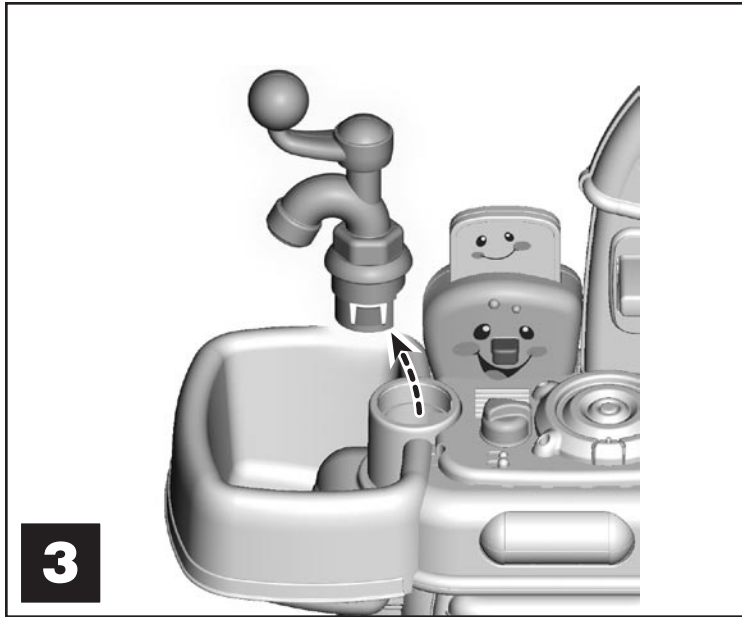

- Carefully rock the faucet back and forth to remove it from the hole in the countertop. You may need to use the tool again to pry the faucet if it is sticking.

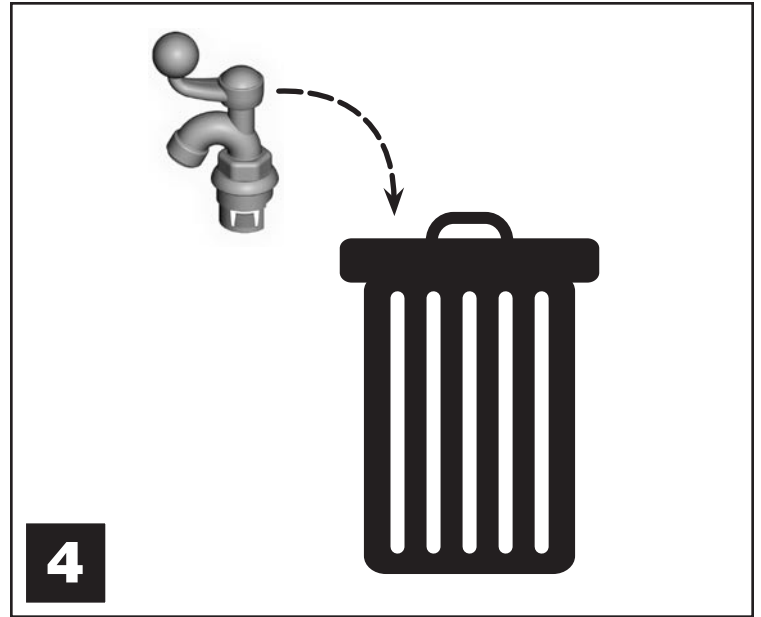

IMPORTANT! While doing this, you may crack the bottom of the faucet. Be sure to dispose of all pieces of the faucet.

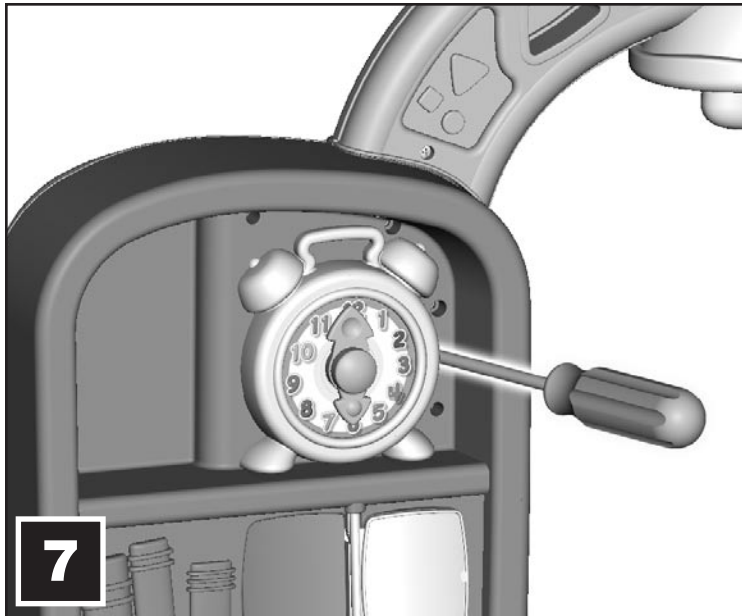

- Then, fit the end of the flat blade screwdriver into the slot on the other side of the clock. Gently pry the edge of the clock.

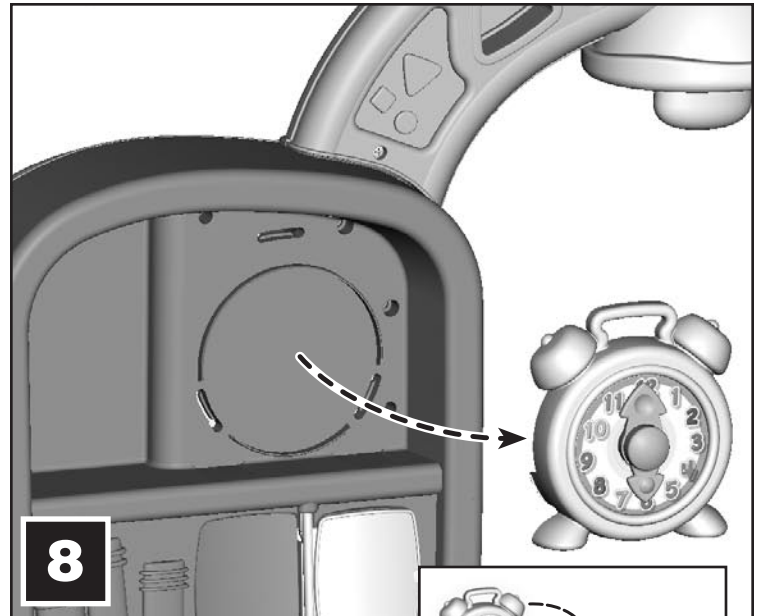

- Remove the clock and dispose of it.

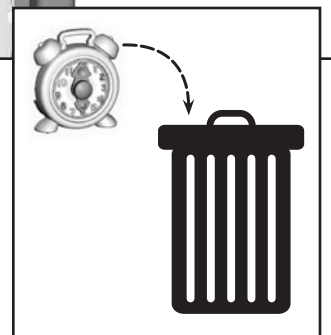

Installation Instructions

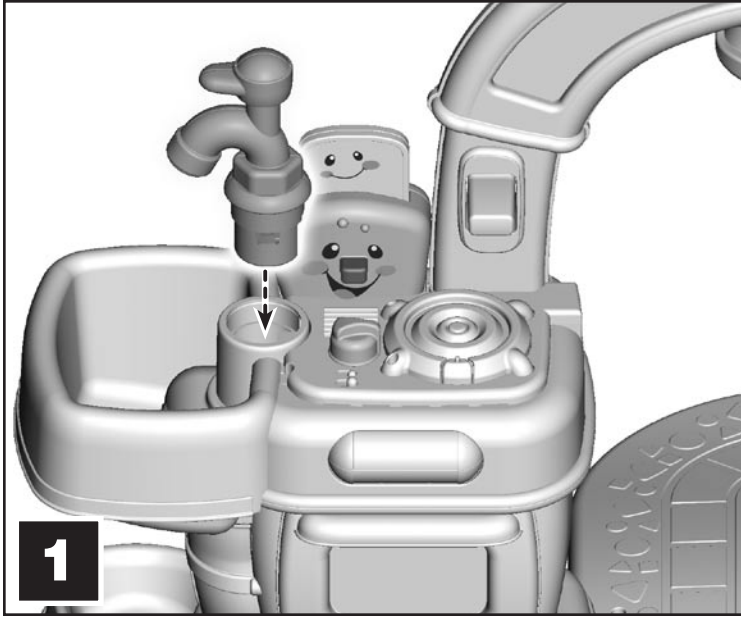

- Insert and “**snap**” the end of the new faucet into the hole in the countertop.

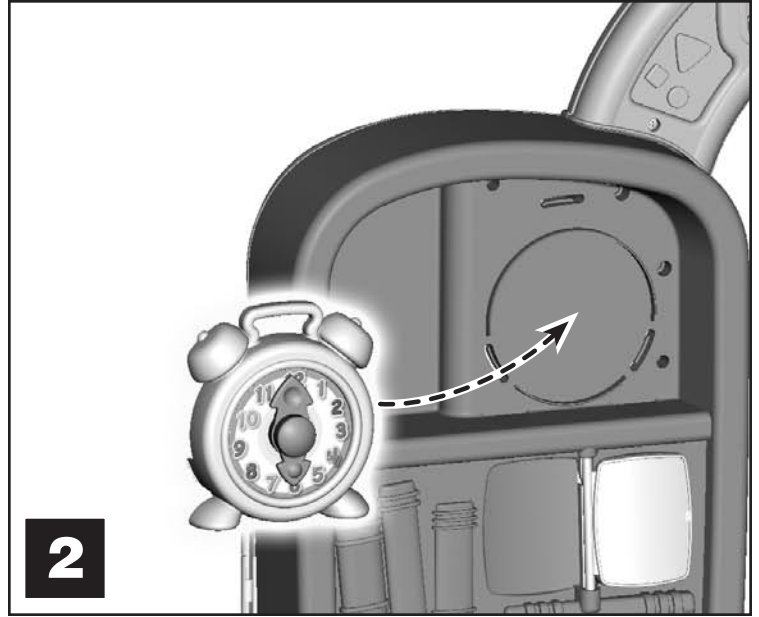

- Fit the tabs on the new clock into the slots in the refrigerator door. Push to “**snap**” the clock in place.

If you have further questions regarding the removal and installation of the faucet and/or clock, please call Fisher-Price® Consumer Relations at 1-888-812-7187, 9 AM – 7 PM Monday through Friday and 11 AM – 5 PM Saturday. Hearing-impaired consumers using TTY/TDD equipment, please call 1-800-382-7470. Or, write to Fisher-Price® Consumer Relations, 636 Girard Avenue, East Aurora, New York 14052.