



Please keep this instruction sheet for future reference,  
as it contains important information.

Requires four "C" batteries for  
aquarium (included) and two "AAA" (LR03)  
**alkaline** batteries for remote (not included) operation.

Adult assembly is required.

Tool required for battery installation:  
Phillips screwdriver (not included).



## Before Use

### CAUTION

Please keep small parts such as the plastic tab out of children's reach. Throw the plastic tab away.

**Note:** A plastic tab was attached to the toy for in-store demonstration purposes. While the tab may have already been removed, check the back of the toy to be sure. If the plastic tab is still attached, pull and remove the tab. Throw the plastic tab away.

## Aquarium Battery Replacement

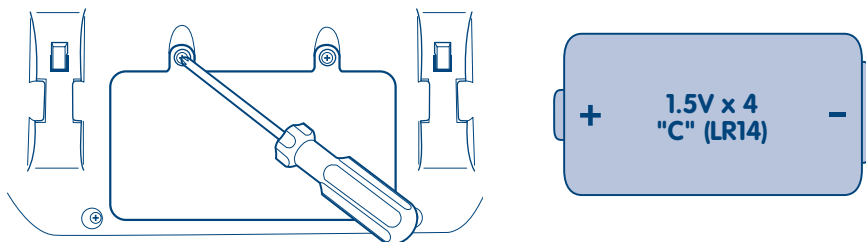

**For best performance, we recommend that you replace the batteries that came with the aquarium with four, new “C” (LR14) alkaline batteries.**

- Locate the battery compartment on the back of the aquarium.
- Loosen the screws in the battery compartment door with a Phillips screwdriver. Remove the battery compartment door. Remove and throw away the batteries.
- Insert four “C” (LR14) **alkaline** batteries.

**Hint:** We recommend using **alkaline** batteries for longer battery life.

- Replace the battery compartment door and tighten the screws.

**IMPORTANT!** Under normal use conditions, the batteries in the aquarium will require replacement more often than the batteries in the remote. When sounds, lights or motions from the aquarium become faint or stop, it's time for an adult to replace the batteries in the aquarium.

# Remote Battery Installation

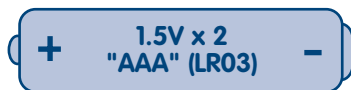
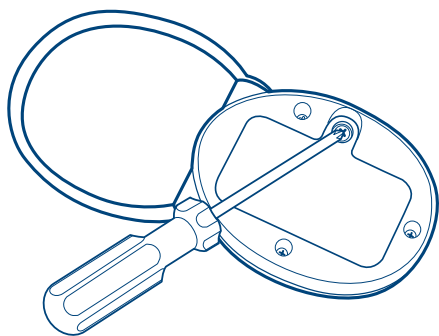

- Locate the battery compartment on the back of the remote.
- Loosen the screw in the battery compartment door with a Phillips screwdriver. Remove the battery compartment door.
- Insert two "AAA" (LR03) **alkaline** batteries.

*Hint: We recommend using **alkaline** batteries for longer battery life.*

- Replace the battery compartment door and tighten the screw.



- Protect the environment by not disposing of this product with household waste (2002/96/EC). Check your local authority for recycling advice and facilities (Europe only).

## Battery Safety Information

**In exceptional circumstances, batteries may leak fluids that can cause a chemical burn injury or ruin your product. To avoid battery leakage:**

- Do not mix old and new batteries or batteries of different types: alkaline, standard (carbon-zinc) or rechargeable (nickel-cadmium).
- Insert batteries as indicated inside the battery compartment.
- Remove batteries during long periods of non-use. Always remove exhausted batteries from the product. Dispose of batteries safely. Do not dispose of product in a fire. The batteries inside may explode or leak.
- Never short-circuit the battery terminals.
- Use only batteries of the same or equivalent type, as recommended.
- Do not charge non-rechargeable batteries.
- Remove rechargeable batteries from the product before charging.
- If removable, rechargeable batteries are used, they are only to be charged under adult supervision.

# Attach

## WARNING

### Prevent falls and entanglement:

This product will not attach to all crib designs. Do not add additional strings or straps to attach to a crib or playpen.

**IMPORTANT!** Always attach all provided fasteners (strings, straps, clamps, etc.) tightly to a crib or playpen according to the instructions. Do not add additional strings or straps to attach to crib. Check frequently.

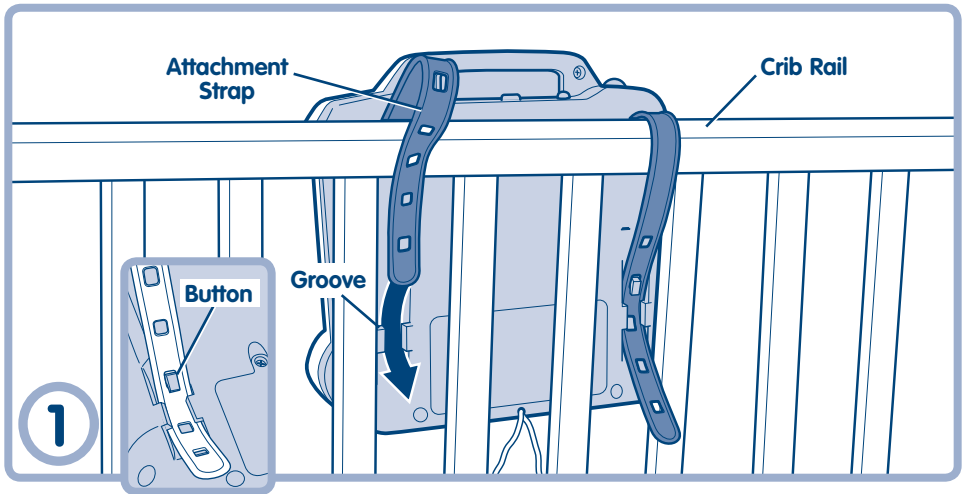

**Note:** If you are attaching this toy to a crib side rail that can be lowered and raised, make sure the crib side rail is in the raised (locked) position whenever a child is in the crib.

- Position the toy inside the crib.
- Wrap one of the toy's attachment straps around the crib rail.
- Slide the strap through the groove on the back of the toy. Pull the attachment strap up slightly to fasten it to the button on the back of the toy.
- Repeat this procedure to secure the other attachment strap.

**Note:** This toy should be snug against the crib rail and spindles. Use the strap slot that provides the tightest fit.

## Attach

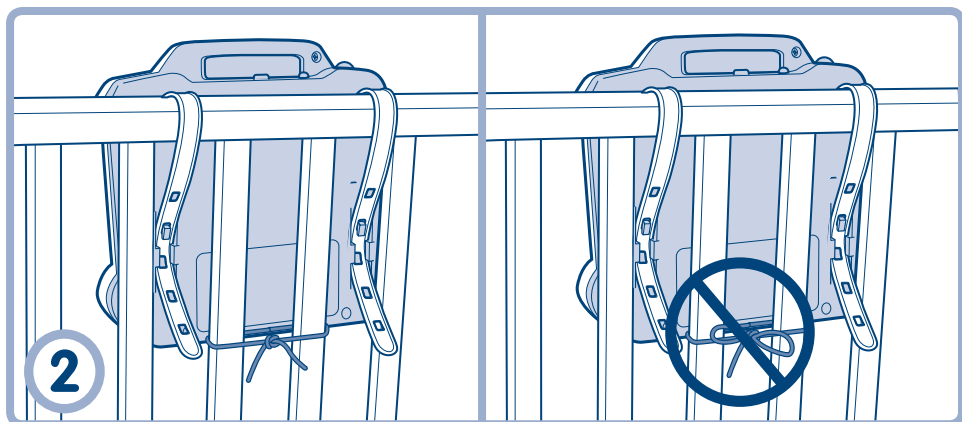

- Tie the toy's strings to the crib spindles.

**Note:** It is better to tie the strings in a knot than a bow, since a bow may be easily untied.

## Remove

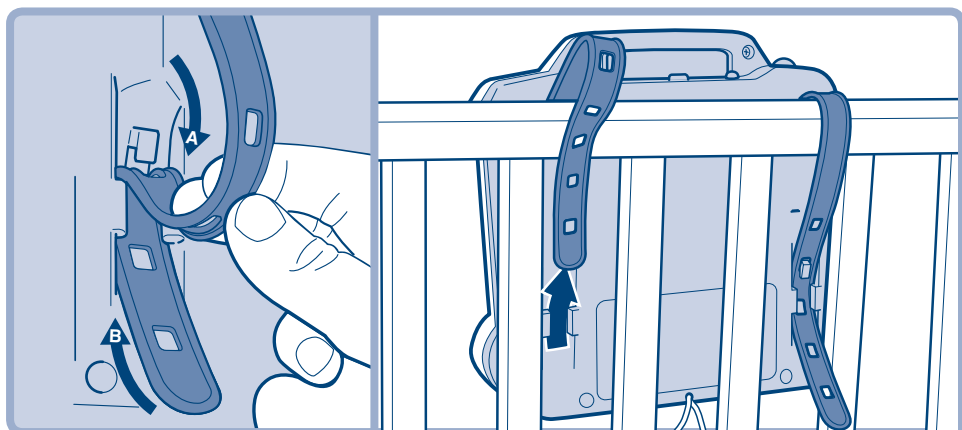

- Untie the aquarium strings.
- Pull the attachment strap out and down to remove it from the button **A**.
- Then, push the strap up and pull from the groove **B**.

## Use

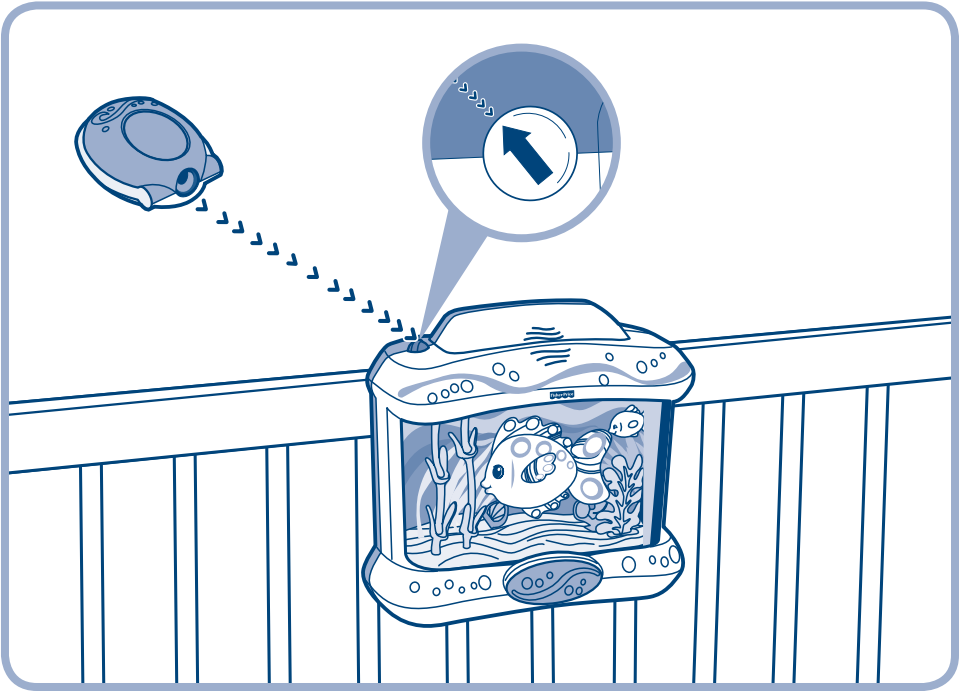

- When using the remote, make sure that the arrow on the aquarium dome is pointing towards the transmitter window on the remote. **For best results, make sure the path between the transmitter window on the remote and the dome on the aquarium are in a direct line and free of obstacles. Rotate the aquarium dome so that the arrow points to the area from which you're most likely to use the remote.** For example, if you'll most often be using the remote from the doorway of the nursery, make sure the arrow on the aquarium dome is pointing towards the doorway and that the path between the aquarium dome and the doorway is free from obstructions.

### IMPORTANT!

- In the unlikely event that use of the remote interferes with normal use of other remote controlled equipment, such as televisions and stereos, or use of other electric or battery powered appliances interfere with operation of the aquarium, do not use both appliances at the same time.
- For best performance avoid using the remote in areas of bright light. In bright natural or artificial light, you may notice a loss of range. Move the aquarium or reduce the amount of light to improve performance.

# Soothing Music and Soft Lights

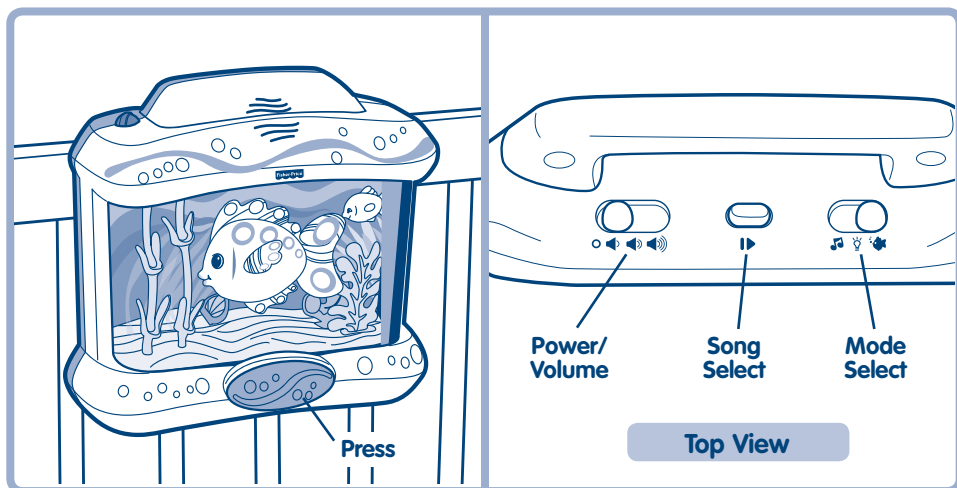

## Power/Volume Switch



Choose from four settings: off ; on with low volume , on with medium volume  or on with high volume .

## Song Select Button

Press the button  to change song selections.

## Mode Select Switch

Slide the switch to select one of three modes:

-  Music, sounds, lights and swimming motion
-  Music, sounds and lights
-  Music and sounds only



- Press the button on the remote to activate the aquarium. Press again to stop.

**Note:** The remote will remain active for about one hour. After an hour, you will need to slide the power/volume switch on the aquarium off, then on again to reactivate.

# Consumer Information

**CONSUMER ASSISTANCE**  
Call toll free: 1-800-432-5437 (US & Canada only)  
M-F 9AM to 7PM / SAT 11AM to 5PM (EST)

 **service.fisher-price.com**

---

Write to us at: Fisher-Price® Consumer Relations,  
636 Girard Avenue, East Aurora, New York 14052.

Hearing-impaired consumers using TTY/TDD equipment,  
please call 1-800-382-7470.

---

For countries outside the United States:

Canada: Mattel Canada Inc., 6155 Freemont Blvd.,  
Mississauga, Ontario L5R 3W2; [www.service.mattel.com](http://www.service.mattel.com).

Great Britain: Mattel UK Ltd, Vanwall Business Park,  
Maidenhead SL6 4UB, Helpline: 01628 500303,  
[www.service.mattel.com/uk](http://www.service.mattel.com/uk)

Australia: Mattel Australia Pty. Ltd., 658 Church Street,  
Locked Bag #870, Richmond, Victoria 3121 Australia.  
Consumer Advisory Service 1300 135 312.

New Zealand: 16-18 William Pickering Drive,  
Albany 1331, Auckland.

Asia: Mattel East Asia Ltd, Room 1106, South Tower,  
World Finance Centre, Harbour City, Tsimshatsui, HK, China.

## Care

- Wipe with a clean cloth dampened with a mild soap and water solution. Do not immerse.
- This toy has no consumer serviceable parts. Do not take this toy apart.

## FCC Statement

### United States Only

This equipment has been tested and found to comply with the limits for a Class B digital device, pursuant to Part 15 of the FCC Rules. These limits are designed to provide reasonable protection against harmful interference in a residential installation. This equipment generates, uses and can radiate radio frequency energy and, if not installed and used in accordance with the instructions, may cause harmful interference to radio communications. However, there is no guarantee that interference will not occur in a particular installation. If this equipment does cause harmful interference to radio or television reception, which can be determined by turning the equipment off and on, the user is encouraged to try to correct the interference by one or more of the following measures:

- Reorient or relocate the receiving antenna.
- Increase the separation between the equipment and receiver.
- Consult the dealer or an experienced radio/TV technician for help.

Note: Changes or modifications not expressly approved by the manufacturer responsible for compliance could void the user's authority to operate the equipment.