

Please keep this instruction sheet for future reference, as it contains important information.

Requires four "AA" batteries (included).

Adult assembly is required.

Tool required for battery replacement: Phillips screwdriver (not included).



# Consumer Information



## CONSUMER ASSISTANCE

Call toll free: 1-800-432-5437 (US & Canada only)  
M-F 9AM to 7PM / SAT 11AM to 5PM (EST)

 [service.fisher-price.com](http://service.fisher-price.com)

Write to us at: Fisher-Price® Consumer Relations,  
636 Girard Avenue, East Aurora, New York 14052.

Hearing-impaired consumers using TTY/TDD equipment,  
please call 1-800-382-7470.

For countries outside the United States:

Canada: Mattel Canada Inc., 6155 Freemont Blvd.,  
Mississauga, Ontario L5R 3W2; [www.service.mattel.com](http://www.service.mattel.com).

Great Britain: [Mattel UK Ltd. Vanwall Business Park,  
Maidenhead SL6 4UB. Helpline: 01628 500303.](http://MattelUKLtd.VanwallBusinessPark.MaidenheadSL64UB)  
[www.service.mattel.com/uk](http://www.service.mattel.com/uk)

Australia: Mattel Australia Pty. Ltd., 658 Church Street,  
Locked Bag #870, Richmond, Victoria 3121 Australia.  
Consumer Advisory Service 1300 135 312.

New Zealand: 16-18 William Pickering Drive,  
Aubany 1331, Auckland.

Asia: Mattel East Asia Ltd, Room 1106, South Tower,  
World Finance Centre, Harbour City, Tsimshatsui, HK, China.

# Parts

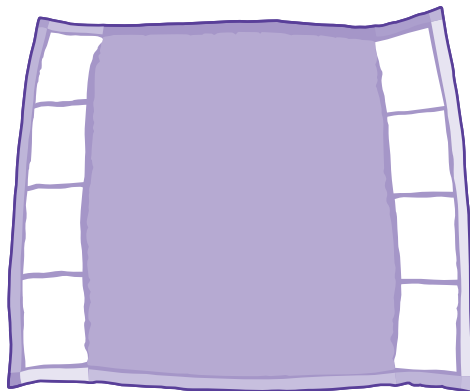

Quilt



2 Supports

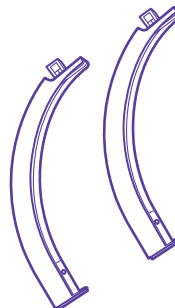

2 Arches



Puppy House

**Not Shown:**  
3 Hanging Toys  
4 Links

## Battery Replacement

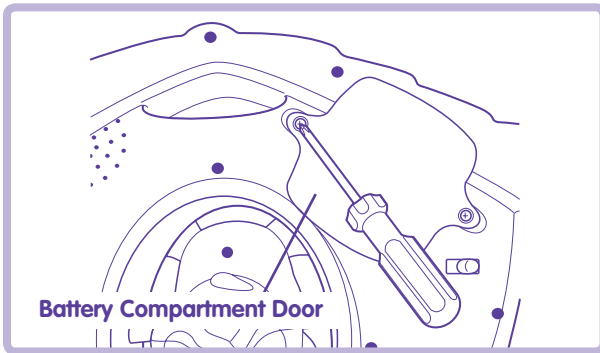

***For best performance, we recommend that you replace batteries that came with this toy with four, new "AA" (LR6) alkaline batteries.***

- Locate the battery compartment on the back of the puppy house.
- Loosen the screws in the battery compartment door with a Phillips screwdriver. Remove the battery compartment door.

***Hint:*** You may need to use the tip of the screwdriver to lift the battery compartment door.

- Insert four "AA" (LR6) **alkaline** batteries.

***Hint:*** We recommend using **alkaline** batteries for longer life.

- Replace the battery compartment door and tighten the screws with a Phillips screwdriver. Do not over-tighten.
- When sounds or motions from this toy become faint or stop, it's time for an adult to change the batteries!



- Protect the environment by not disposing of this product with household waste (2002/96/EC). Check your local authority for recycling advice and facilities (Europe only).

## Battery Safety Information

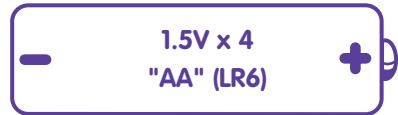

In exceptional circumstances, batteries may leak fluids that can cause a chemical burn injury or ruin your product. To avoid battery leakage:

- Do not mix old and new batteries or batteries of different types: alkaline, standard (carbon-zinc) or rechargeable (nickel-cadmium).
- Insert batteries as indicated inside the battery compartment.
- Remove batteries during long periods of non-use. Always remove exhausted batteries from the product. Dispose of batteries safely. Do not dispose of this product in a fire. The batteries inside may explode or leak.
- Never short-circuit the battery terminals.
- Use only batteries of the same or equivalent type, as recommended.
- Do not charge non-rechargeable batteries.
- Remove rechargeable batteries from the product before charging.
- If removable, rechargeable batteries are used, they are only to be charged under adult supervision.

## Lay & Play Setup

1

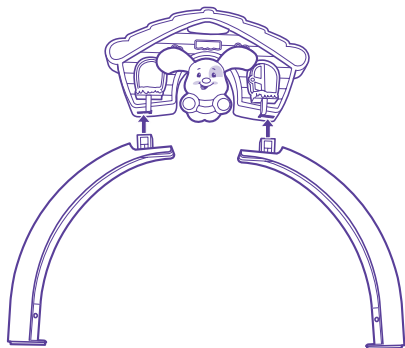

- **“Snap”** the arches to the underside of the puppy house.

2

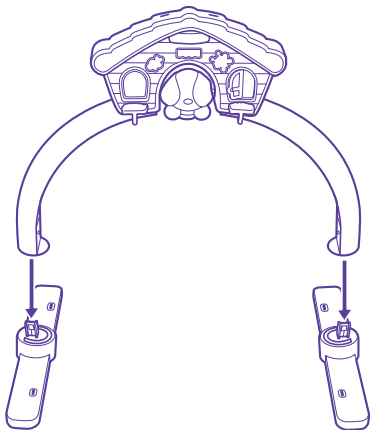

- **“Snap”** the arch assembly into the supports, as shown.

3

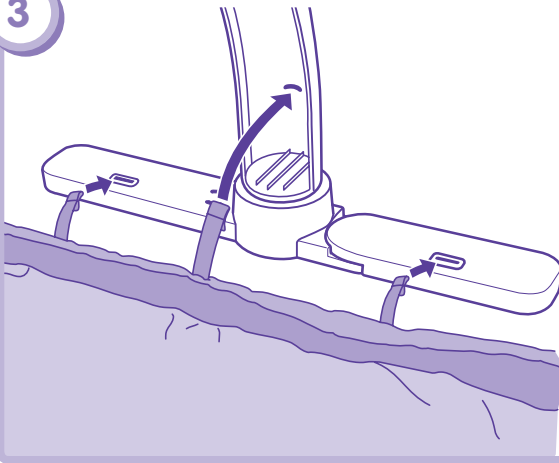

- Place the quilt, print side up, under the arch.
- Fit two straps on the side of the quilt through the slots in the support and one strap on the quilt through a slot in the arch. Make sure that the end of each strap forms a "T" on the outside of the slot.
- Repeat this procedure to attach the other side of the quilt to the support and arch.
- Pull up on the quilt to be sure it is secure to the supports and arches.

## Lay & Play Setup

4



- While pushing one end of a link, pull the other end of the link. Slide the toy loop onto the link.
- Push a link onto tab on the puppy house.



## Before Use

### ⚠ CAUTION

Please keep small parts such as the plastic tab out of children's reach.  
Throw the plastic tab away.

**Note:** A plastic tab was attached to the toy for in-store demonstration purposes. While the tab may have already been removed, check the back of the puppy house to be sure. If the plastic tab is still attached, pull and remove the tab. Throw the plastic tab away.

### ⚠ WARNING

To prevent entanglement injury,  
never place gym in a crib or playpen.  
Never add strings, ties or other  
products to the gym.

# Fun Music and Motion



## Power/Volume Switch

Slide the switch to on with low volume ◀▶ , on with high volume ◀▶▶ or off ○ .

## Mode Switch

### 🎵 Short Play

Baby can bat the hanging toys or puppy house for music, sound effects and a rocking puppy.

### 🎵 Long Play

Choose this mode for longer music and motions.

## Hints:

- For the youngest babies, we recommend assembling the links and animal toys as shown in the main photo on this page. This arrangement allows baby to reach the hanging toys while lying underneath the gym.
- For older babies, remove the overhead arch and attach the links and hanging toys to the soft quilt for Sit-At Play fun!
- If your child is not actively playing with this toy, it turns off automatically (sleep mode).

# Convert from Lay & Play to Sit-At Play

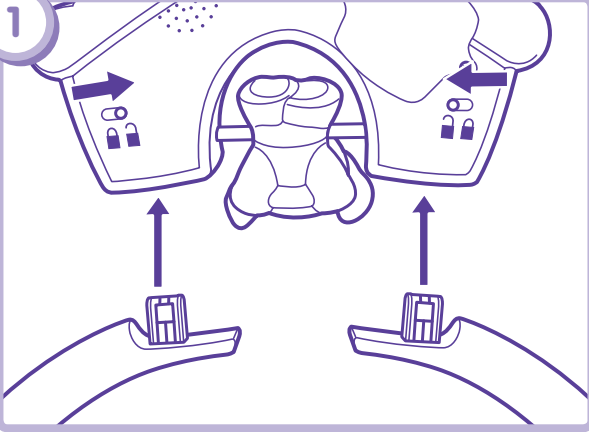

- While pushing the latches toward the unlock position , lift to remove the puppy house from the arches.

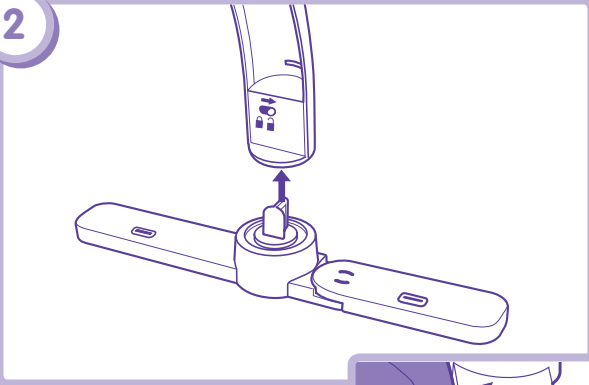

- Remove all six straps on the quilt from the slots in the supports and arches.
- While pushing the latch toward the unlock position , lift to remove the arch from the support.
- Repeat this procedure to remove the other arch.

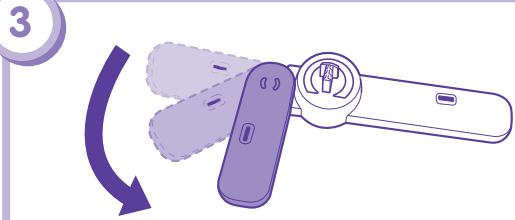
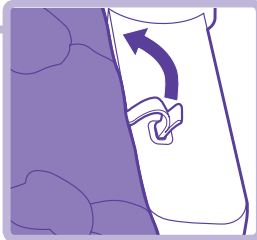

- Rotate the end of each support so that it forms a right angle.

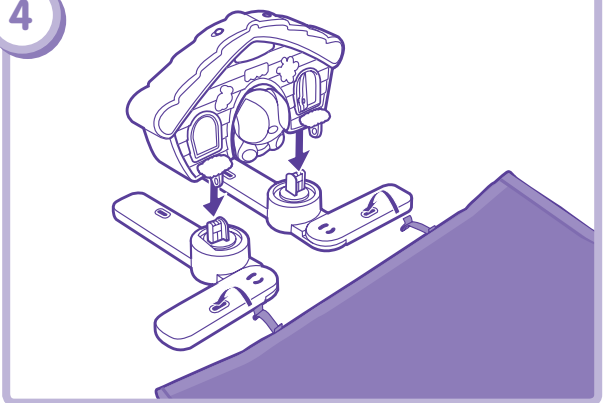

- Position both supports along one edge of the quilt, as shown.
- Fit the straps on the ends of the quilt through the slots in the supports. Make sure that the end of each strap forms a "T" under the support.
- Pull up on the quilt to be sure it is secure to the supports.
- **"Snap"** the puppy house onto the supports.
- To convert back to Lay & Play, first remove the puppy house from the supports. While pushing the latches toward the unlock position , lift to remove the puppy house from the supports. Remove the quilt from the supports and rotate the supports back to the straight position. Follow the Lay & Play setup instructions.

## Care

### Quilt

- Remove the quilt from the supports.
- Wash the quilt in cold water on a gentle cycle. Do not use bleach. Line dry the quilt.

### Arches, Supports, Links, Toys and Puppy House

- Wipe the surface with a clean cloth dampened with a mild soap and water solution.
- Do not immerse the puppy house.

## FCC Statement

### United States Only

This equipment has been tested and found to comply with the limits for a Class B digital device, pursuant to Part 15 of the FCC Rules. These limits are designed to provide reasonable protection against harmful interference in a residential installation. This equipment generates, uses and can radiate radio frequency energy and, if not installed and used in accordance with the instructions, may cause harmful interference to radio communications. However, there is no guarantee that interference will not occur in a particular installation. If this equipment does cause harmful interference to radio or television reception, which can be determined by turning the equipment off and on, the user is encouraged to try to correct the interference by one or more of the following measures:

- Reorient or relocate the receiving antenna.
- Increase the separation between the equipment and receiver.
- Consult the dealer or an experienced radio/TV technician for help.

Note: Changes or modifications not expressly approved by the manufacturer responsible for compliance could void the user's authority to operate the equipment.