

3+

Barbie

INSTRUCTIONS

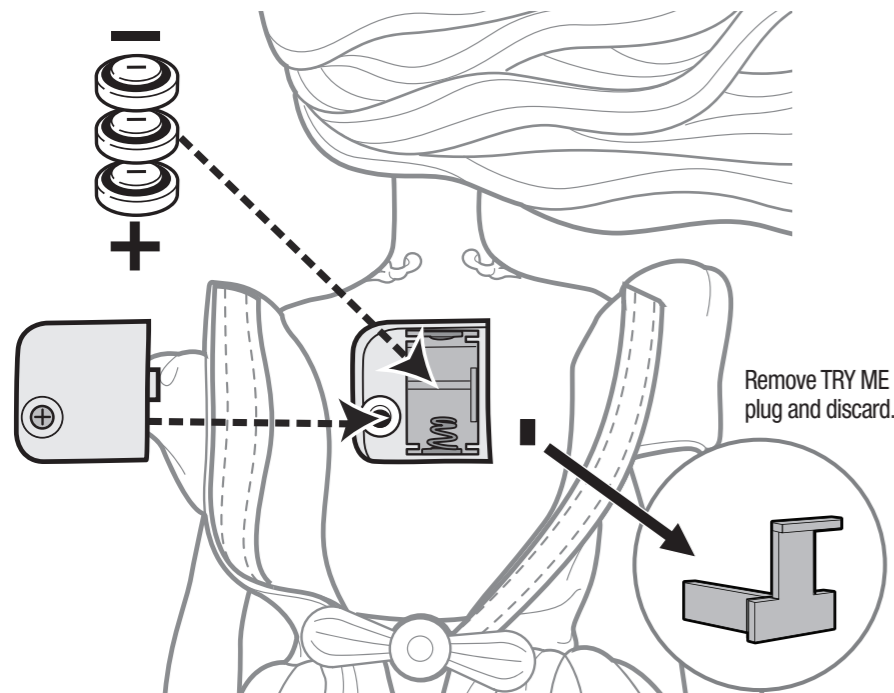

Remove TRY ME
plug and discard.

BATTERY REPLACEMENT: Use a Phillips head screwdriver (not included) to open battery door. Insert 3 AG-13 (LR44) button cell batteries as shown. Replace battery door and screw closed. For longer life use only alkaline batteries. Dispose of batteries safely. Replace batteries when sound becomes garbled or faint or light dims.

NOTE: Do NOT immerse battery operated "singing" dolls in water.

Battery contains Perchlorate Material – special handling may apply, See www.dtsc.ca.gov/hazardouswaste/perchlorate

Battery Safety Information

In exceptional circumstances batteries may leak fluids that can cause a chemical burn injury or ruin your product. To avoid battery leakage:

- Non-rechargeable batteries are not to be recharged.
- Rechargeable batteries are to be removed from the product before being charged (if designed to be removable).
- Rechargeable batteries are only to be charged under adult supervision (if designed to be removable).
- Do not mix alkaline, standard (carbon-zinc), or rechargeable (nickel-cadmium) batteries.
- Do not mix old and new batteries.
- Only batteries of the same or equivalent type as recommended are to be used.
- Batteries are to be inserted with the correct polarity.
- Exhausted batteries are to be removed from the product.
- The supply terminals are not to be short-circuited.
- Dispose of batteries safely.
- Do not dispose of this product in a fire. The batteries inside may explode or leak.



Protect the environment by not disposing of this product with household waste [2002/96/EC].
Check your local authority for recycling advice and facilities.

For product sold in USA

This device complies with Part 15 of the FCC Rules.

Operation is subject to the following two conditions:

(1) This device may not cause harmful interference, and (2) this device must accept any interference received, including interference that may cause undesired operation.

- This equipment has been tested and found to comply with the limits for a Class B digital device, pursuant to part 15 of the FCC rules. These limits are designed to provide reasonable protection against harmful interference in a residential installation. This equipment generates, uses and can radiate radio frequency energy and, if not installed and used in accordance with the instructions, may cause harmful interference to radio communications. However, there is no guarantee that interference will not occur in a particular installation. If this equipment does cause harmful interference to radio or television reception, which can be determined by turning the equipment off and on, the user is encouraged to try to correct the interference by one or more of the following measures:
- Reorient or relocate the receiving antenna.
- Increase the separation between the equipment and receiver.
- Connect the equipment into an outlet on a circuit different from that to which the receiver is connected.
- Consult the dealer or an experienced radio/TV technician for help.

NOTE: Changes or modifications not expressly approved by the manufacturer responsible for compliance could void the user's authority to operate the equipment.

RECYCLE INFORMATION (USA ONLY)

Please recycle button cell batteries contained in this product by:

—Visiting your nearest recycling center. For location of the nearest recycling center, visit us online at www.service.mattel.com.

—If a recycling center is not available in your area, contact us for a pre-paid mailing label. Visit us online at www.service.mattel.com or call toll-free at 1 (800) 524-8697.

Valid in the US only. • Solo válido en los EE.UU. • Valable aux États-Unis seulement.

For U.S.A. market only:

We want you to have fun playing with our products.

Please give us your feedback by filling out the short on-line survey. Go to :

service.mattel.com/surveys

Thanks for helping us make great toys even better!

English-only site

CONSUMER INFORMATION

Need Assistance? Visit service.mattel.com or call 1-800-524-8697 (US and Canada only), M-F 9AM - 7PM & SAT 11AM - 5PM, Eastern.

SERVICE.MATTEL.COM

Mattel Canada Inc., Mississauga, Ontario L5R 3W2. You may call us free at/ Composez sans frais le 1-800-524-8697.

Mattel U.K. Ltd., Vanwall Business Park, Maidenhead SL6 4UB. Helpline 01628 500303.

Mattel Australia Pty., Ltd., Richmond, Victoria. 3121. Consumer Advisory Service - 1300 135 312.

Mattel East Asia Ltd., Room 1106, South Tower, World Finance Centre, Harbour City, Tsimshatsui, HK, China.

Diimport & Diedarkan Oleh: Mattel SEA Ptd Ltd.(993532-P) Lot 13.5, 13th Floor, Menara Lien Hoe, Persiaran Tropicana Golf Country Resort, 47410 P.J. Tel:03-78803817, Fax:03-78803867.

Mattel, Inc., 333 Continental Blvd., El Segundo, CA 90245 U.S.A. Consumer Relations 1 (800) 524-8697.

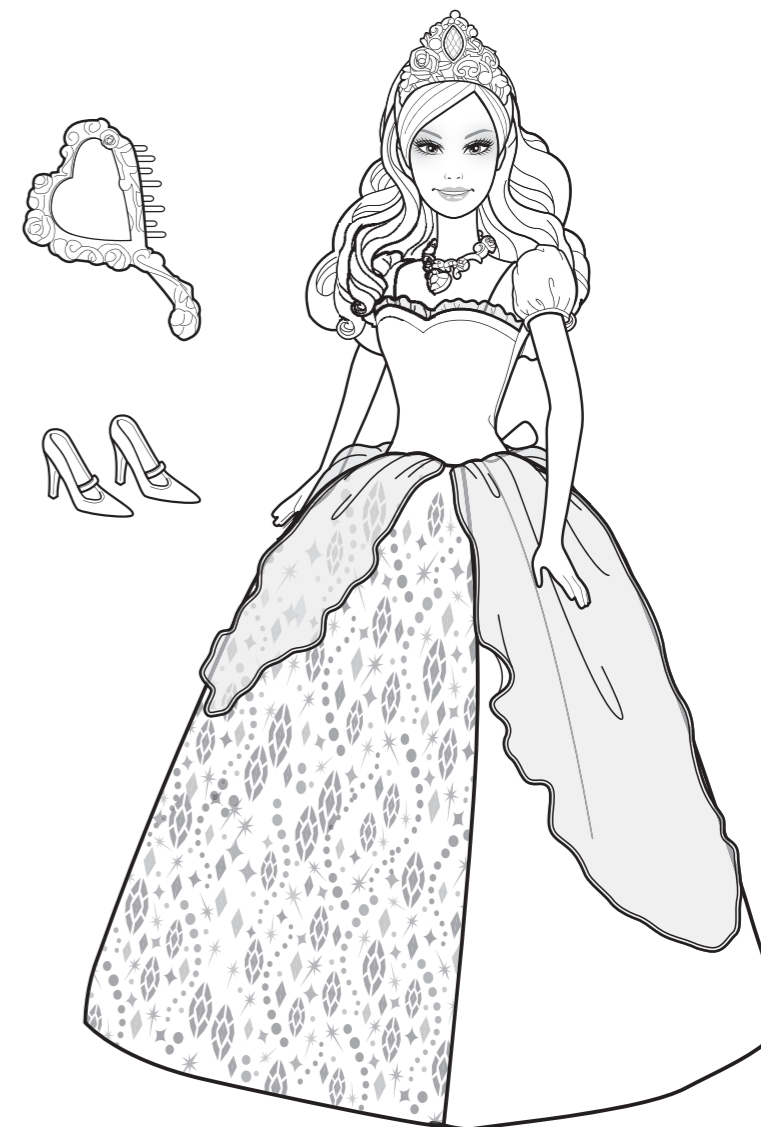

Doll cannot stand alone.

Includes 3 AG-13 (LR44) button cell batteries. Batteries are for demonstration purposes only.

Contents: Please remove everything from the package and compare to the contents shown here. If any items are missing, please contact your local Mattel office. Keep these instructions for future reference as they contain important information.

WARNING:
CHOKING HAZARD - Small parts.
Not for children under 3 years.

Let's play!

Dress "magically" transforms! First, raise the doll's arms UP as shown. Then rotate knob on the doll's back halfway around to make the 3 dress panels in front flip over. When the dress flips over in the FANCY DRESS MODE, the doll will make a "bringgg" sound and her pendant will light up and twinkle.

PLAIN DRESS MODE

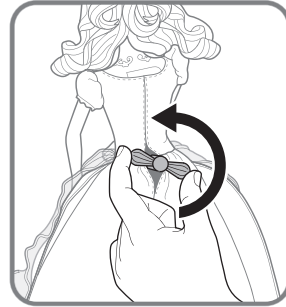

Rotate knob halfway around counterclockwise.

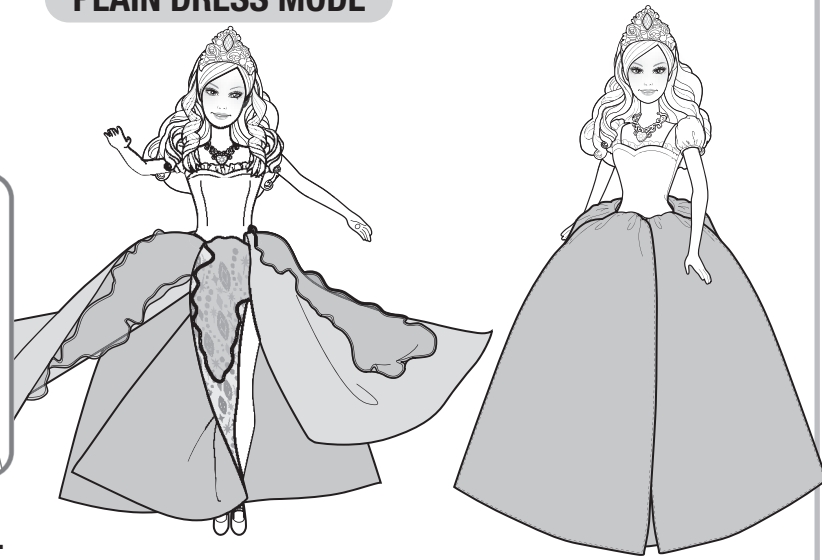

FANCY DRESS MODE

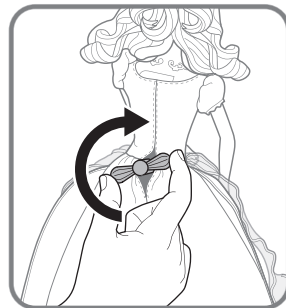

Rotate knob halfway around clockwise.

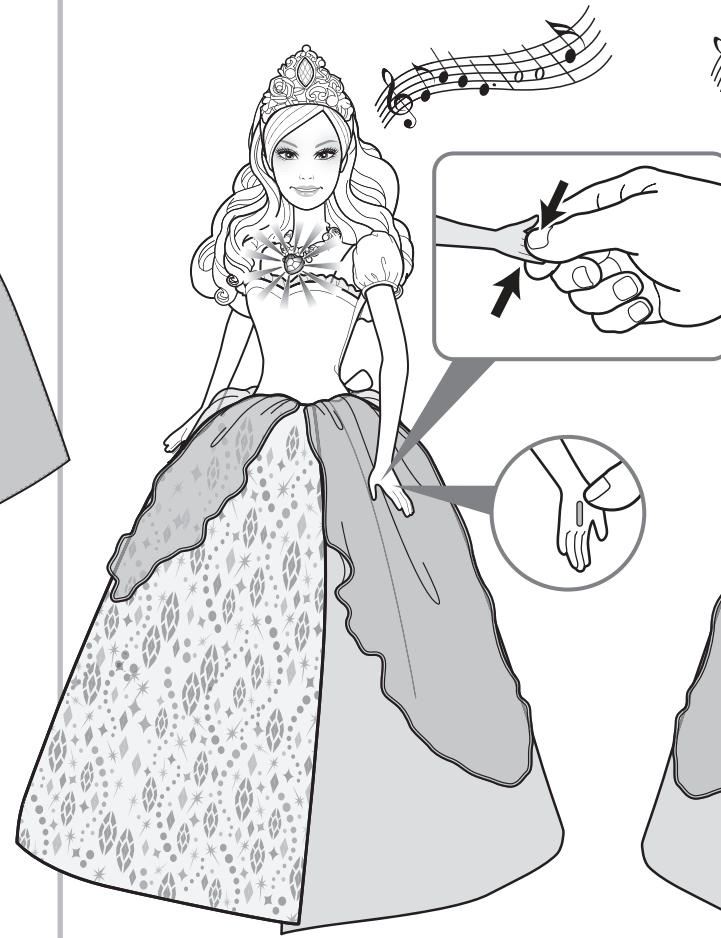
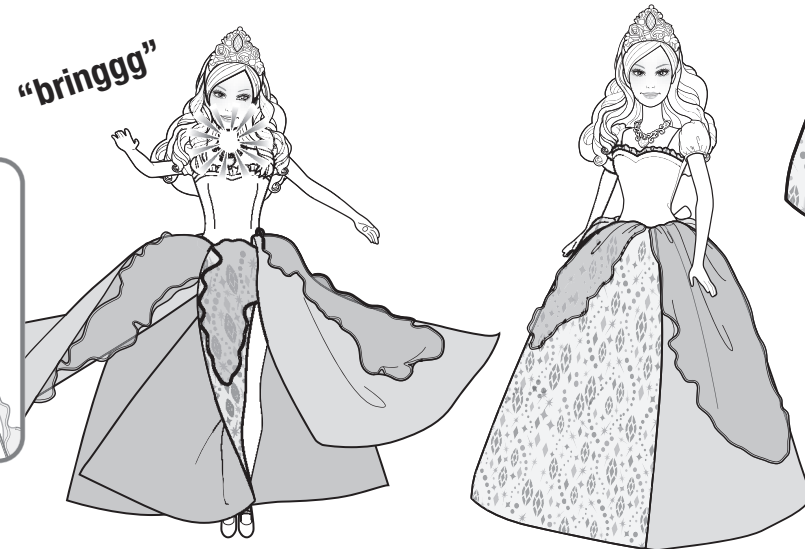

M0785

PLAYING WITH ONE DOLL

When M0785 doll's LEFT hand is squeezed, the doll will "sing" one of two songs and her pendant will light up and twinkle. Squeeze again for the other song.

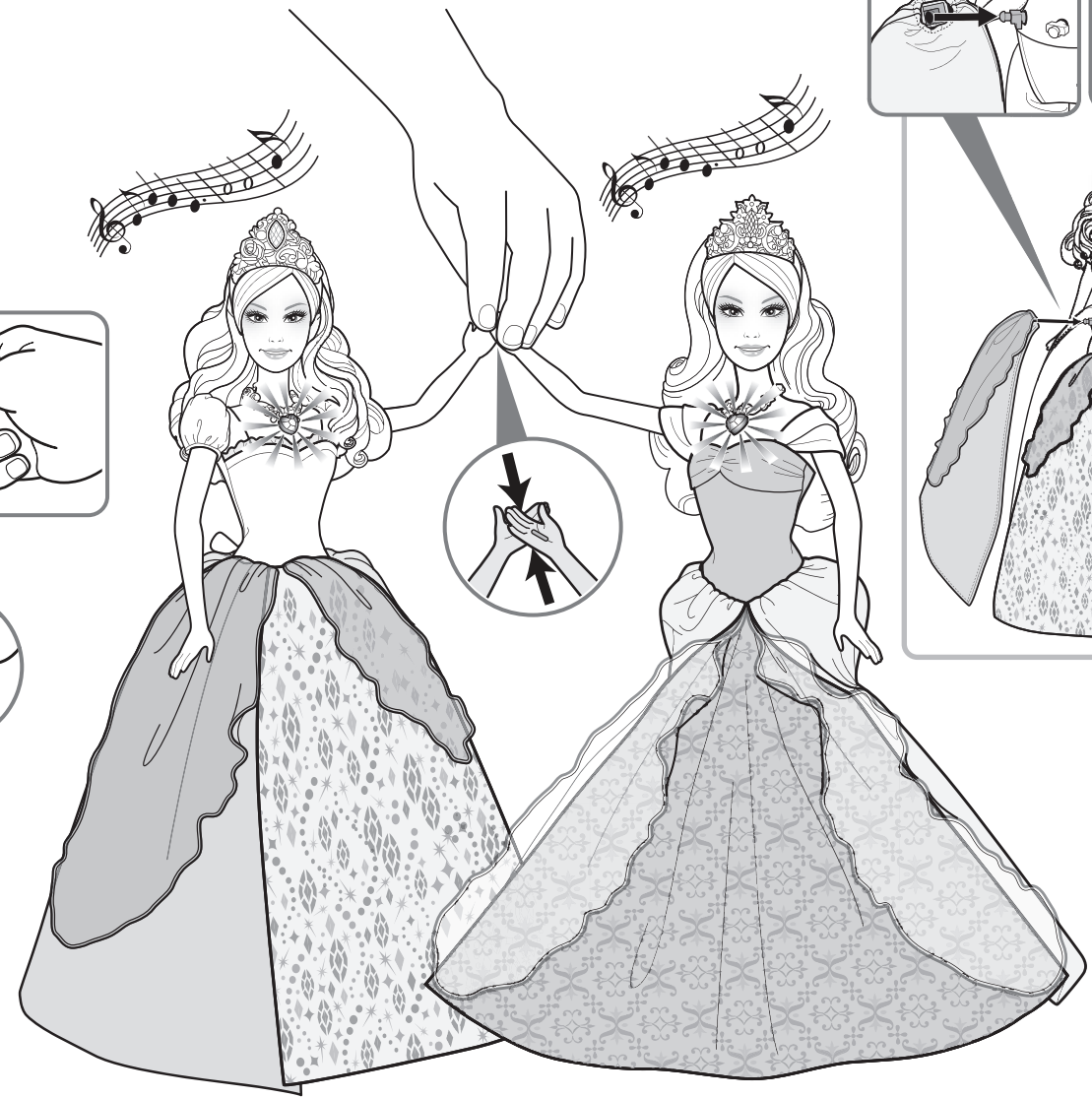

M0785

M0789

PLAYING WITH TWO DOLLS

Dolls sold separately, subject to availability. You must have a M0785 Princess Liana™ doll and a M0789 Princess Alexa® doll to "sing" their duet. Each doll has two matching songs. Make certain that the dolls will "sing" a duet by pressing the switch on doll's hand until the same song will be next for both dolls. Place Liana™ doll's LEFT hand and Alexa® doll's RIGHT hand together then squeeze. Dolls will "sing" together. Squeeze again for the other song.

Dolls cannot stand alone. Princess Alexa® doll and fashions not included.

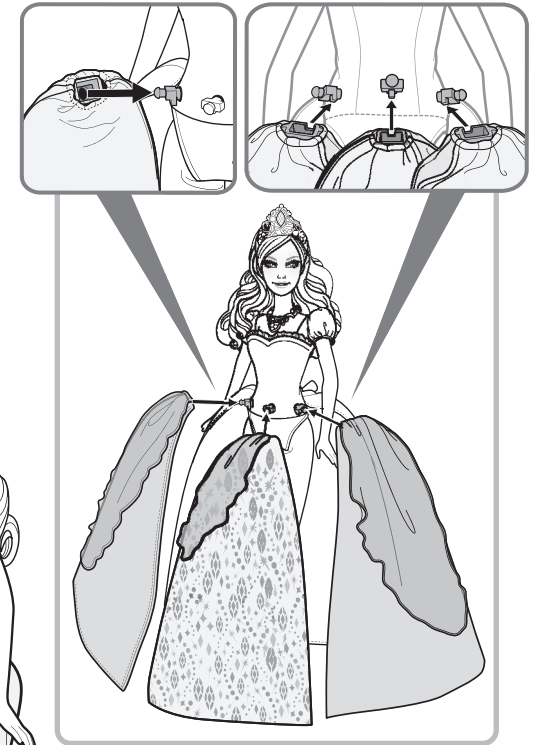

NOTE: Doll's dress is not intended to be removable, do not remove from doll.