

BATTERY INSTALLATION:
Unscrew and lift cover away from bottom of product.
Replace batteries as indicated inside the battery compartment.
Batteries included are for demonstration purposes only.
For longer life use only alkaline batteries.
Requires 3 “AA” (LR6) batteries.

Required tool: Phillips screwdriver (not included)

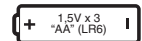

BATTERY SAFETY INFORMATION

In exceptional circumstances batteries may leak fluids that can cause a chemical burn injury or ruin your toy (product).

To avoid battery leakage:

- Non-rechargeable batteries are not to be recharged.
- Rechargeable batteries are to be removed from the toy before being charged (if designed to be removable).
- Rechargeable batteries are only to be charged under adult supervision (if designed to be removable).
- Do not mix alkaline, standard (carbon-zinc), or rechargeable (nickel-cadmium) batteries.

- Do not mix old and new batteries.
- Only batteries of the same or equivalent type as recommended are to be used.
- Batteries are to be inserted with the correct polarity.
- Exhausted batteries are to be removed from the toy.
- The supply terminals are not to be short-circuited.
- Dispose of battery(ies) safely.
- Do not dispose of this toy in a fire. The batteries inside may explode or leak.

ID: M1131-0020 02

“We Work Together”
Words and Music by Randy Miller and Richard Gitelson
© 2007 Wonderland Music Company, Inc. (BMI)
All Rights Reserved
© Disney
Visit the Disney Web site at www.disney.com
Fisher-Price, Inc., a subsidiary of Mattel, Inc., East Aurora, NY 14052 U.S.A.
PRINTED IN CHINA.
Manufactured for Fisher-Price. ©2008 Mattel, Inc. All Rights Reserved.
® and ™ designate U.S. trademarks of Mattel, Inc., unless otherwise indicated.
For countries outside the United States:
Canada: Mattel Canada Inc., 6155 Freemont Blvd., Mississauga, Ontario L5R 3W2; www.service.mattel.com.
Great Britain: Mattel U.K. Ltd., Vauxhall Business Park, Maidenhed SL6 4UB; Helpline: 01628 500393.
www.service.mattel.com/uk
Australia: Mattel Australia Pty. Ltd., 658 Church Street, Locked Bag #870, Richmond, Victoria, 3121 Australia.
Consumer Advisory Service – 1300 135 312
New Zealand: 16-18 William Pickering Drive, Albany 1331, Auckland.
Asia: Mattel East Asia Ltd., Room 1106, South Tower, World Finance Centre, Harbour City, Tsingtsui, HK, China.



M1131



2-in-1 Transforming Tool Truck

INSTRUCTIONS

Please keep these instructions for future reference as they contain important information.

BEFORE YOU BEGIN

- Remove and discard the “try me” pull tab, located on the bottom of the truck next to the battery compartment. See battery diagram for details.

- Remove and discard the two “try me” pieces, located on the engine, as shown.
- Once both pieces are removed, they can be discarded.

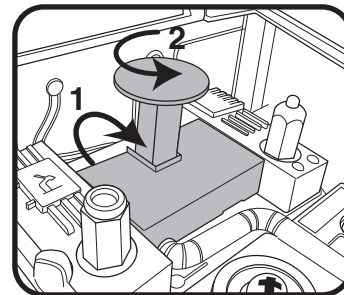

- Insert the air filter into the engine, as shown.

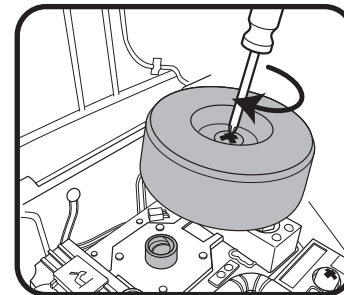

- Once the two “try me” pieces are removed and the air filter is inserted, the toy will perform its full play pattern as described below.
- Be sure the ON/OFF switch is in the ON position. The ON/OFF switch is also located on the bottom of the truck, next to the battery compartment. See battery diagram for details.

HOW TO ASSEMBLE

- Snap the roof onto the truck, as shown.
- Snap the toolbox onto the rear of the truck, as shown.

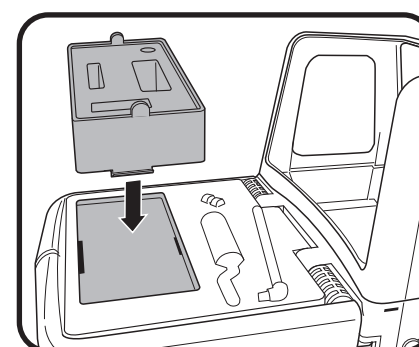
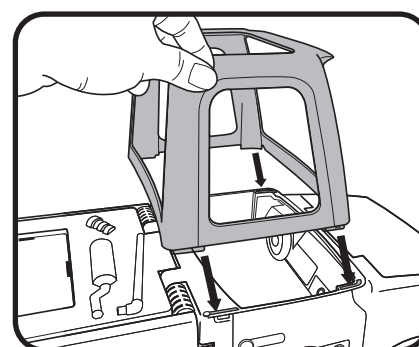

NOTE: Both of these pieces are a one-time assembly. Once these pieces are assembled, they cannot be taken apart.

Back

6/4/08 G2 Remark

- Revised line drawing on front panel

Front

HOW TO TRANSFORM TRUCK TO WORKSHOP

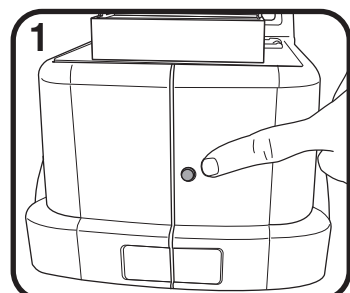

1. Push in the button found on the back of the truck and swing open. This becomes the two sides of the workbench.

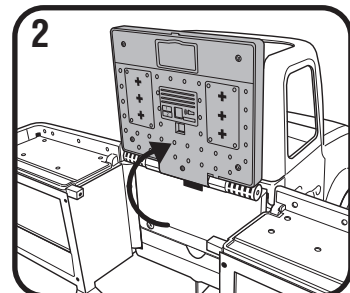

2. Hinge the flatbed of the truck upward – this becomes the pegboard of the workbench.

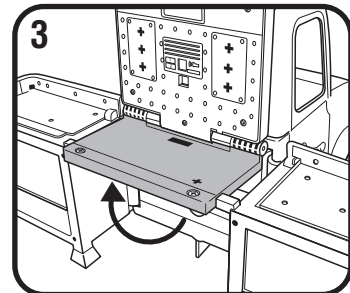

3. Hinge the center countertop upward, which is found hidden in the back of the truck.

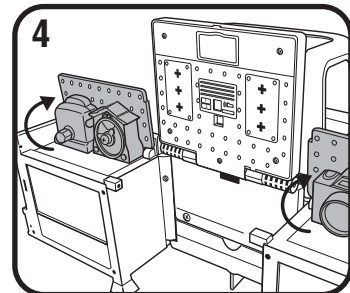

4. Hinge the two side countertops upward to reveal the two side pegboards.

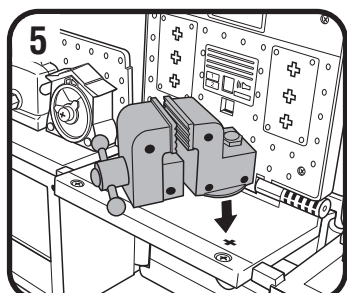

5. Insert the vise into main countertop.

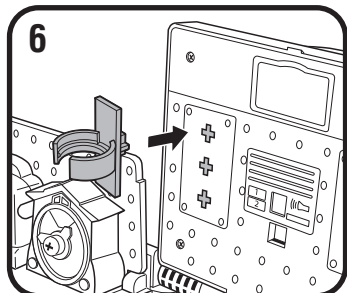

6. Insert the two tool clips into the main pegboard.

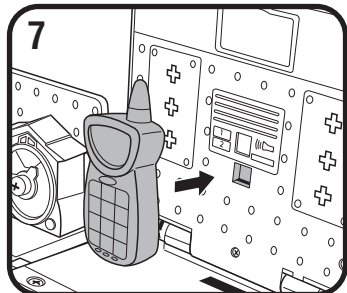

7. Clip the phone onto the hook found on the main pegboard.

WORKSHOP TO TRUCK

- To transform the workshop back into the truck, simply reverse the above steps. Be sure to perform the steps in the proper reverse sequence.

HOW TO PLAY

TRUCK

In truck mode, there are five different parts for you to fix in the engine:

- Radiator
- Engine
- Air Filter
- Spark Plugs
- Battery

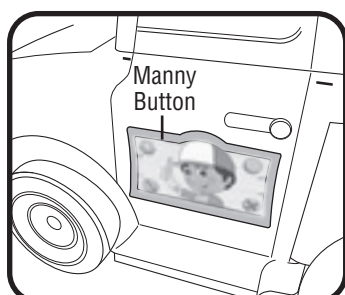

To begin play, press the Manny button found on the truck door.

Manny will tell you what needs to be fixed.
Refer to your blueprints for instructions on how to fix each part.

NOTE: At any time, you can press the Manny button to get extra help from Manny and the tools. After several presses you will hear the “Fix It Right” song.

WORKSHOP

In workshop mode there are 4 items for you to fix:

- Clock
- Toaster
- Camera

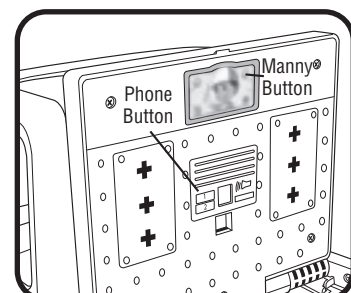

- Fan

- To begin play, press the Manny button found on the main peg board. One of the characters from the show will call needing your help. Pick up the phone to hear one of the following characters:

Mr. Lopart: “This is Mr. Lopart. My camera is broken! Can you please fix it?”
Remove the flash bulb with Squeeze or Rusty and Manny will tell you how you can pretend to fix it. Replace the bulb back into the camera and you fixed it!

Kelly: “Hi there! This is Kelly. The clock for my store is broken! Can you fix it?”
Remove the clock hands using Felipe and Manny will tell you how you can pretend to fix it. Replace the clock hands back onto the clock and you fixed it!

Abuelito: “Hola! This is Abuelito. Por favor, can you fix my fan? The fan blade is sticking.”
Remove the fan blade using Felipe and Manny will tell you how you can pretend to fix it. Replace the fan blade back into the fan and you fixed it!

Mrs. Portillo: “Hola! This is Mrs. Portillo. Can you fix my toaster?”
Remove the cover plate on the toaster with Squeeze or Rusty and Manny will tell you how you can pretend to fix it. Replace the cover back onto the toaster and you fixed it!

NOTE:

- If the phone is off the hook, you can also get phone calls by pressing the answering machine button found under the phone.
- You can press the Manny button at any time to get extra help. After several presses you will hear the “Fix It Right” song.
- Refer to the “blueprints” included with your 2-in-1 Transforming Tool Truck for further instructions on how to play.