

PLAY TIME!

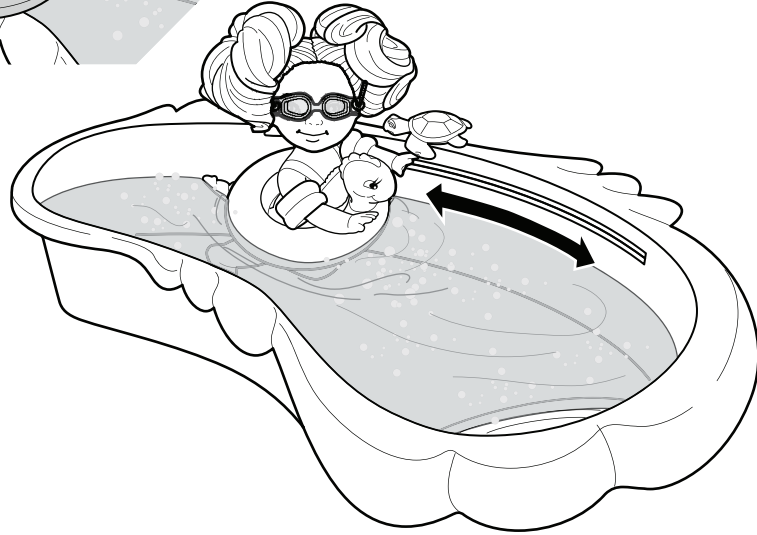

Barbie® INSTRUCTIONS M1463-0920 3+ MATTEL®

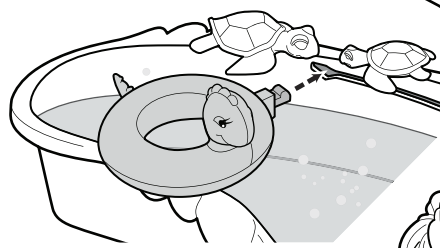
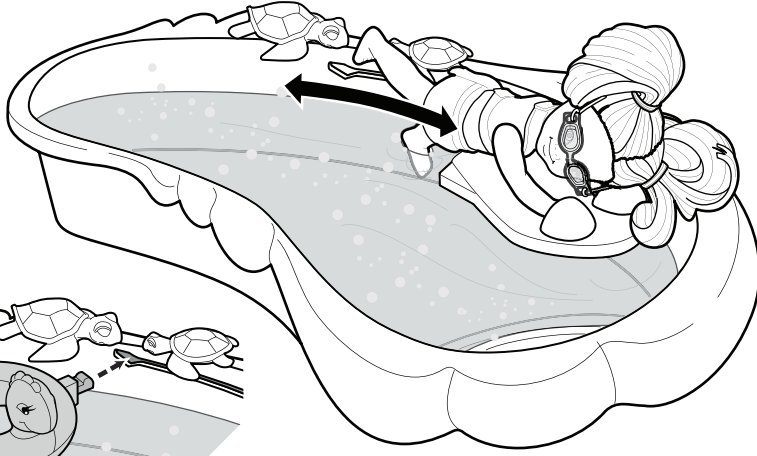
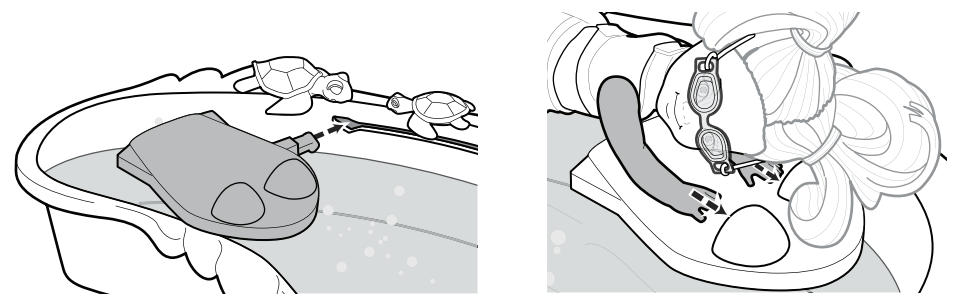
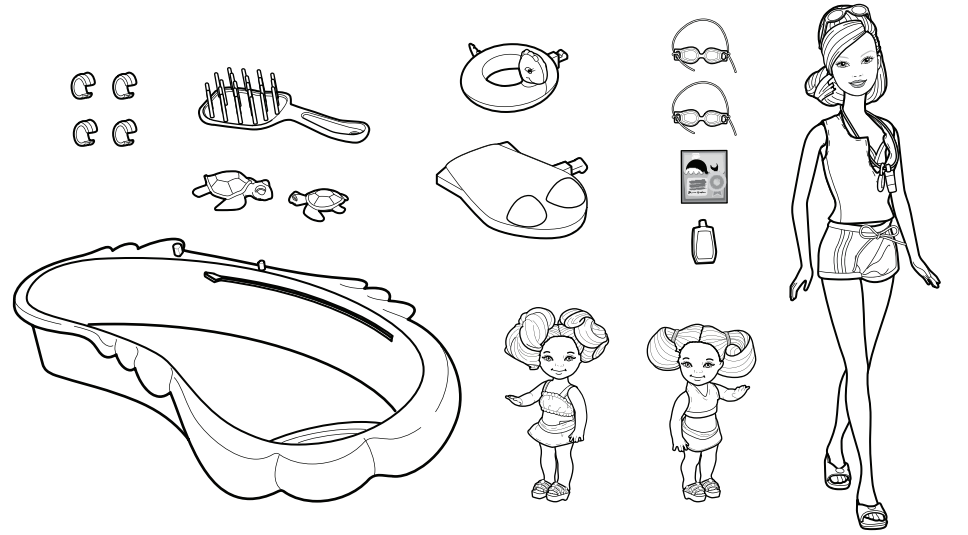

Contents: Please remove everything from the package and compare to the contents shown here. If any items are missing, please contact your local Mattel office. Keep these instructions for future reference as they contain important information.

WARNING:
CHOKING HAZARD - Small parts.
Not for children under 3 years.

INSTRUCTION SHEET SPECIFICATIONS

Toy: BARBIE® I CAN BE...™ Swim Instructor Playset

Toy No.:	M1463
Part No.:	0920
Trim Size:	5.5" W x 8.5" H
Folded Size:	5.5" W x 8.5" H
Type of Fold:	1 Panel
# colors:	One
Colors:	Black
Paper Stock:	White Offset
Paper Weight:	70 lb.
EDM No.:	

GETTING READY

Water toys sometimes get messy. Protect play surfaces before use. Do not use on surfaces that can be damaged by water. Drain, rinse, clean, and dry all items thoroughly before storing.

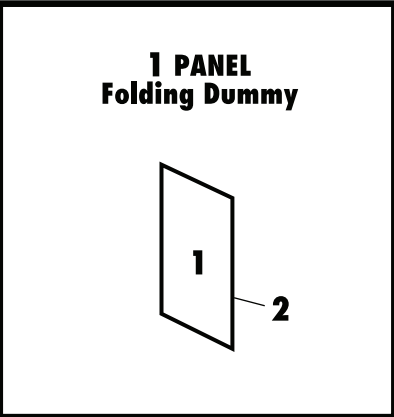
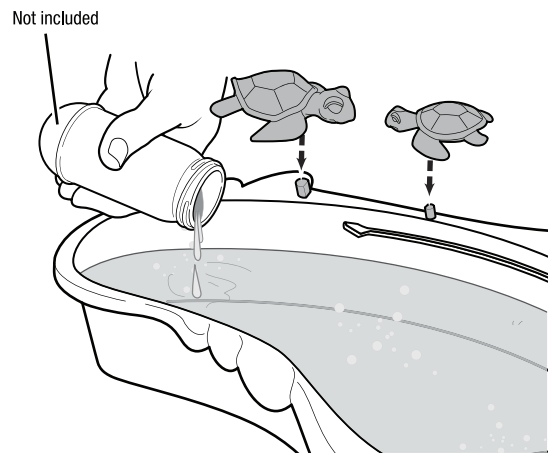

CONSUMER INFORMATION

Need Assistance? Visit service.mattel.com or call 1-800-524-8697 (US and Canada only), M-F 9AM - 7PM & SAT 11AM - 5PM, Eastern.

SERVICE.MATTEL.COM

Mattel Canada Inc., Mississauga, Ontario L5R 3W2. You may call us free at / Composez sans frais la 1-800-524-8697. Mattel.U.K.Ltd. Vanwall Business Park, Maidenhead SL6 4UB. Mattel.Australia Pty., Ltd., Richmond, Victoria, 3121. Consumer Advisory Service - 1300 135 312. Mattel.East Asia Ltd., Room 1106, South Tower, World Finance Centre, Harbour City, Tsimshatsui, HK, China. [Diimport & Diedarkan Oleh: Mattel SEA Ptd Ltd.\(993532-P\) Lot 13.5, 13th Floor, Menara Lien Hoe, Persiaran Tropicana Golf Country Resort, 47410 P.J.](http://Diimport & Diedarkan Oleh: Mattel SEA Ptd Ltd.(993532-P) Lot 13.5, 13th Floor, Menara Lien Hoe, Persiaran Tropicana Golf Country Resort, 47410 P.J.) Tel:03-78803817, Fax:03-78803867. Mattel, Inc., 333 Continental Blvd., El Segundo, CA 90245 U.S.A. Consumer Relations 1 (800) 524-8697.

Storage

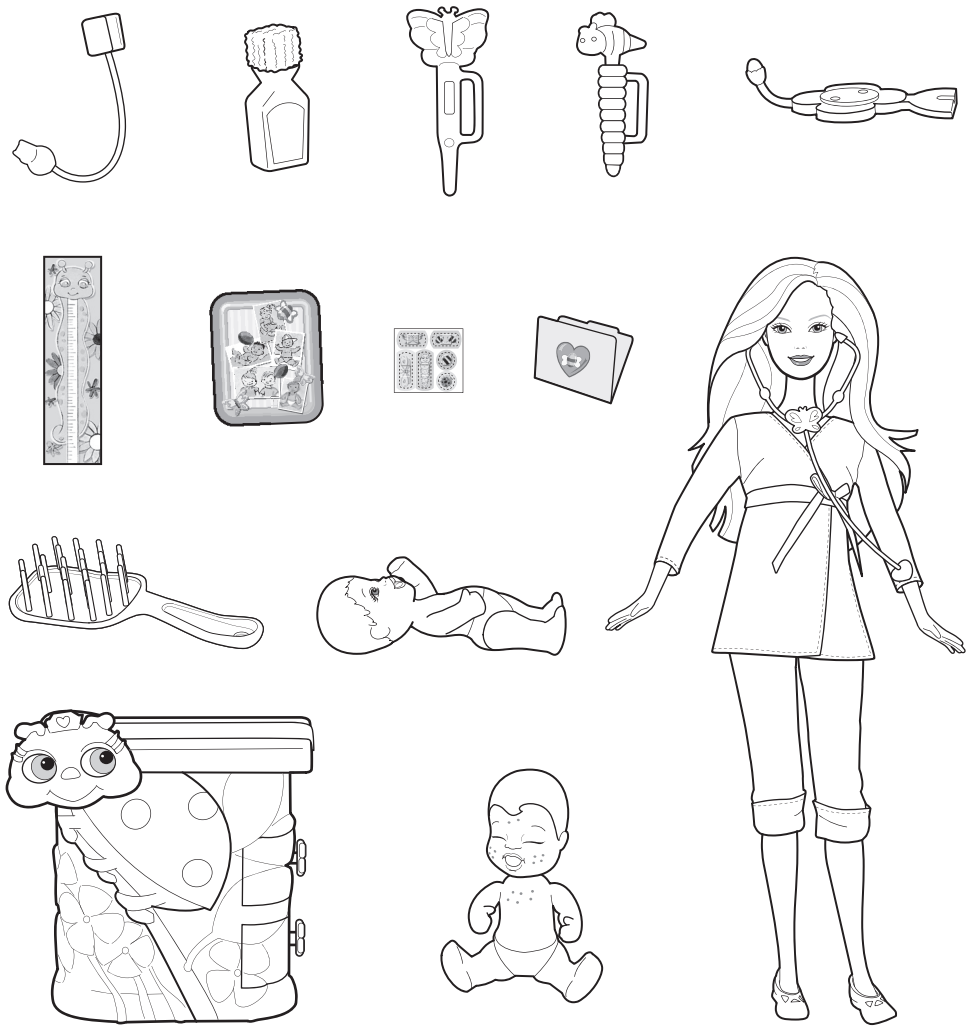
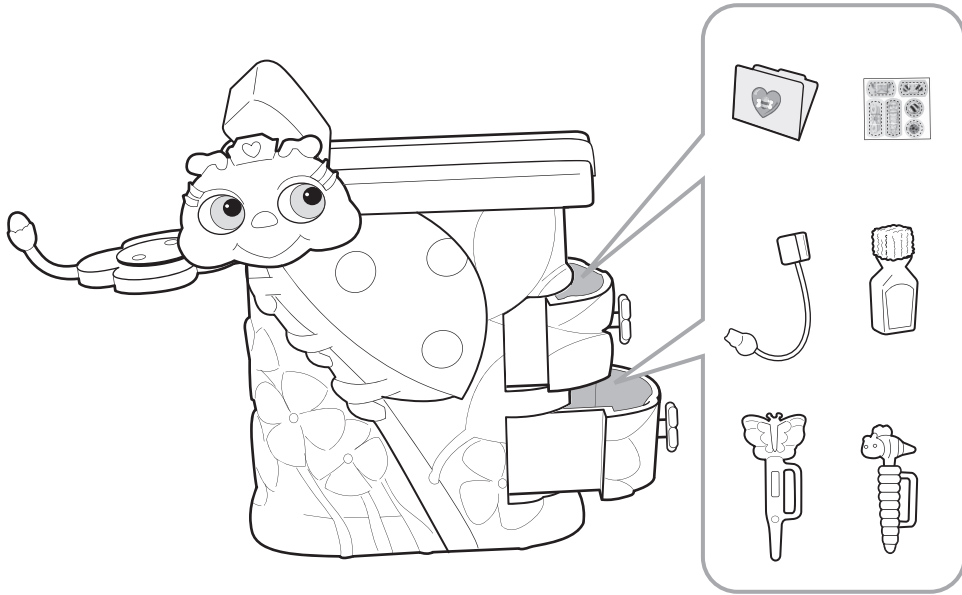

CONSUMER INFORMATION

Need Assistance? Visit service.mattel.com or call 1-800-524-8697 (US and Canada only), M-F 9AM - 7PM & SAT 11AM - 5PM, Eastern.

SERVICE.MATTEL.COM

Mattel Canada Inc., Mississauga, Ontario L5R 3W2. You may call us free at/ Composez sans frais le 1-800-524-8697.
 Mattel U.K. Ltd., Vanwall Business Park, Maidenhead SL6 4UB.
 Mattel Australia Pty., Ltd., Richmond, Victoria. 3121. Consumer Advisory Service - 1300 135 312.
 Mattel East Asia Ltd., Room 1106, South Tower, World Finance Centre, Harbour City, Tsimshatsui, HK, China.
 Diimport & Diedarkan Oleh: Mattel SEA Ptd Ltd.(993532-P) Lot 13.5, 13th Floor, Menara Lien Hoe, Persiaran Tropicana Golf Country Resort, 47410 PJ. Tel:03-78803817, Fax:03-78803867.
 Mattel, Inc., 333 Continental Blvd., El Segundo, CA 90245 U.S.A. Consumer Relations 1 (800) 524-8697.

Contents: Please remove everything from the package and compare to the contents shown here. If any items are missing, please contact your local Mattel office. Keep these instructions for future reference as they contain important information.

WARNING:
CHOKING HAZARD - Small parts.
 Not for children under 3 years.

Assembly

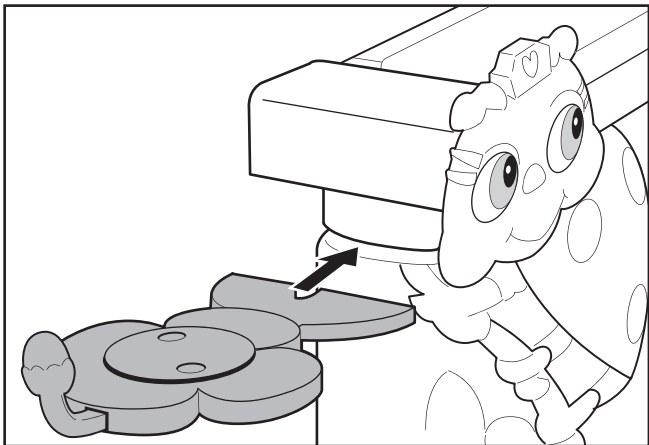

Play Time!

Water toys sometimes get messy. Protect play surfaces before use. Do not use on surfaces that can be damaged by water. Drain, rinse, clean, and dry all items thoroughly before storing.

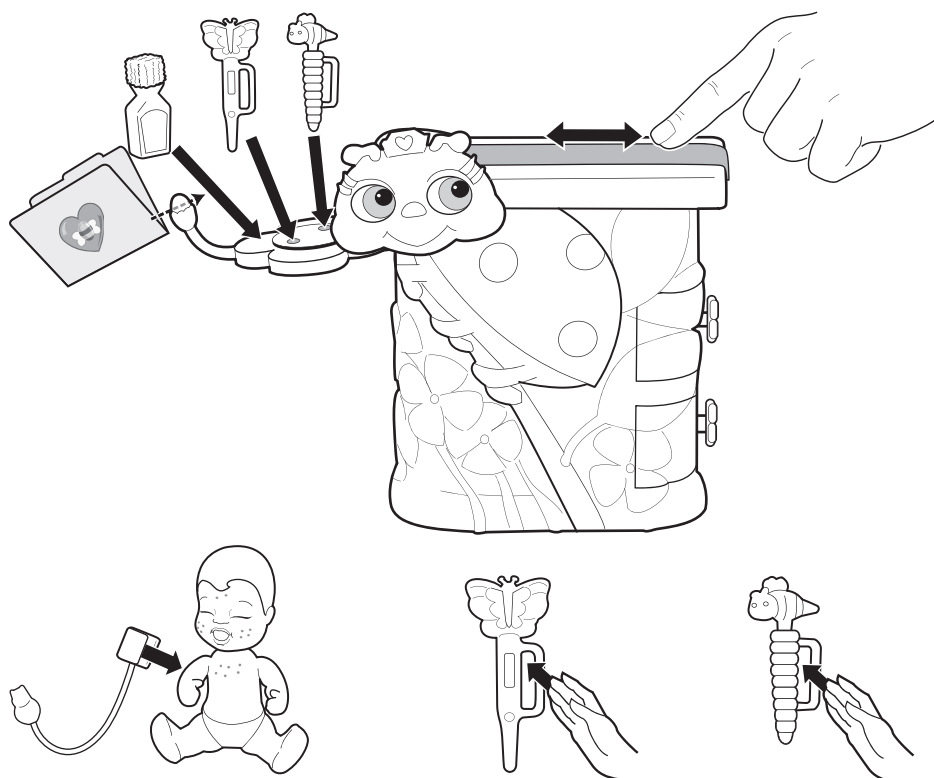

Color change by applying warm or cold water.

To color change: Dip applicator in warm water (30°C/ 86F) and apply to baby to make boo-boos disappear. Cup not included. DO NOT use water that is too hot (above 43°C/ 110°F) to avoid burns. When boo-boos reappear, repeat application of warm water. **Color** change will last longer if you do not expose this toy to intense heat or direct sunlight for prolonged periods of time.

Dolls cannot stand alone.

