

Fisher-Price®



**Please keep this instruction sheet for future reference,
as it contains important information.**

**Requires four "D" batteries
(included) for operation.**

Adult assembly is required for battery replacement.

**Tool required for battery replacement:
Phillips screwdriver (not included).**

www.fisher-price.com

Consumer Information

WARNING

Prevent falls and entanglement:

This product will not attach to all crib designs. Do not add additional strings or straps to attach to a crib or playpen.

Before Use

CAUTION

Please keep small parts such as plastic tabs out of children's reach.
Throw the plastic tab away.

Note: A plastic tab was attached to the toy for in-store demonstration purposes. While the tab may have already been removed, check the back of the toy to be sure. If the plastic tab is still attached, pull and remove the tab from the toy. Throw the plastic tab away.

Crib Attachment

IMPORTANT! Always attach all provided fasteners (strings, straps, clamps, etc.) tightly to a crib or playpen according to the instructions. Do not add additional strings or straps to attach to a crib. Check frequently.

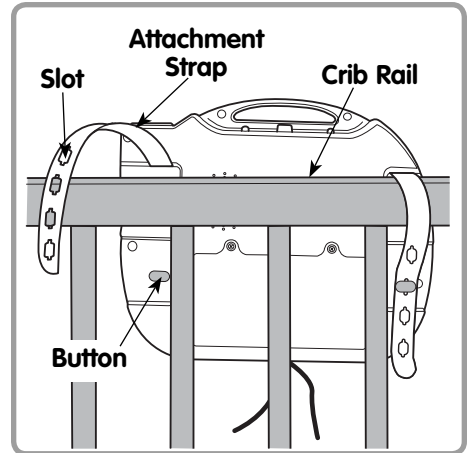

IMPORTANT! If you are attaching this toy to a crib side rail that can be lowered and raised, make sure the crib side rail is in the raised (locked) position whenever a child is in the crib.

- Position the toy inside the crib.
- Wrap one of the toy's attachment straps around the crib rail.
- Fasten the attachment strap slot to the button on the back of the toy.
- Repeat this procedure to secure the other attachment strap.

Note: This toy should be snug against the crib rail and spindles. Use the strap slot that provides the tightest fit.

Crib Attachment

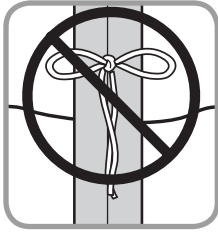
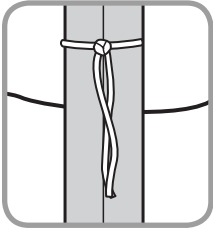

- Tie the toy's strings to a crib spindle.

Note: It is better to tie the strings in a knot than a bow, since a bow may be easily untied.

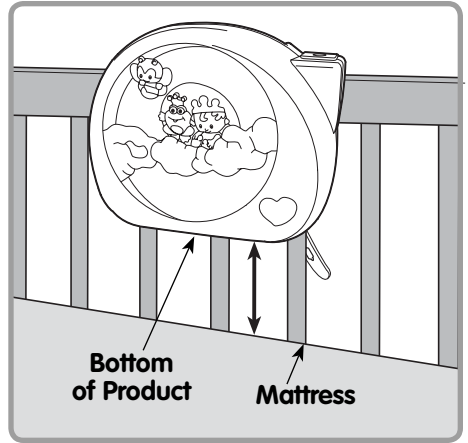

- Make sure the distance between the bottom of the product and the crib mattress is **at least 7 inches**.
- If the distance is less than 7 inches: readjust the attachment straps to lift the product; or lower the crib mattress.

Soothing Sights and Sounds

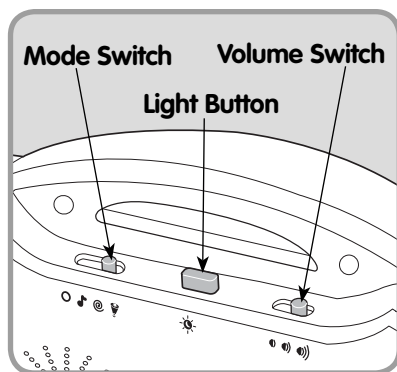

Start/Stop Button

Mode Switch

- 🎵 Listen to up to 22 minutes of music only.
- ⌚ Enjoy up to 15 minutes of music, soft lights and motion.
- 💡 Watch an enchanting ceiling light show along with soothing music, calming lights and gentle motion (up to 11 minutes).
- Slide the switch to the off position when the toy is not in use.

Light Control Button

- ☀️ Press to select a soothing night light; press again for twinkling lights only in ⌚ and 💡 modes.

Start/Stop Button

- ♥️ Press to stop or start music and lights.

Volume Switch

- 🔊 🔊 🔊 Slide to either low, medium or high volume.

Battery Replacement

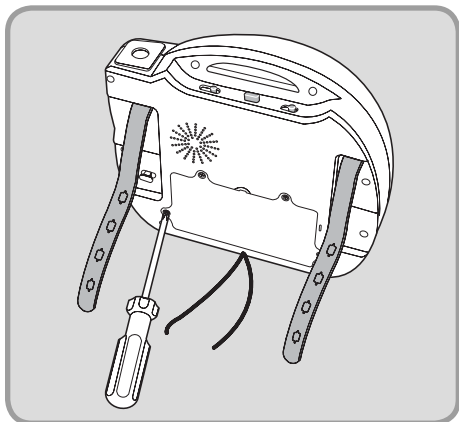

For best results, we recommend replacing the batteries that came with this toy with four, new "D" (LR20) alkaline batteries.

- Loosen the screws in the battery compartment door with a Phillips screwdriver. Remove the battery compartment door.
- Insert four "D" (LR20) **alkaline** batteries.

Hint: We recommend using **alkaline** batteries for longer battery life.

- Replace the battery compartment door and tighten the screws with a Phillips screwdriver. Do not over-tighten.
- If sounds, lights or motions from this toy become faint or stop, it's time for an adult to change the batteries.



- Protect the environment by not disposing of this product with household waste (2002/96/EC). Check your local authority for recycling advice and facilities (Europe only).

Battery Safety Information

In exceptional circumstances, batteries may leak fluids that can cause a chemical burn injury or ruin your product. To avoid battery leakage:

- Do not mix old and new batteries or batteries of different types: alkaline, standard (carbon-zinc) or rechargeable (nickel-cadmium).
- Insert batteries as indicated inside the battery compartment.
- Remove batteries during long periods of non-use. Always remove exhausted batteries from the product. Dispose of batteries safely. Do not dispose of product in a fire. The batteries inside may explode or leak.
- Never short-circuit the battery terminals.
- Use only batteries of the same or equivalent type, as recommended.
- Do not charge non-rechargeable batteries.
- Remove rechargeable batteries from the product before charging.
- If removable, rechargeable batteries are used, they are only to be charged under adult supervision.

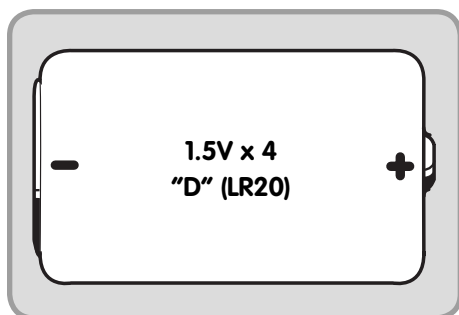

Consumer Information



CONSUMER ASSISTANCE
Call toll free: 1-800-432-5437 (US & Canada only)
M-F 9AM to 7PM / SAT 11AM to 5PM (EST)

service.fisher-price.com

Write to us at: Fisher-Price® Consumer Relations,
636 Girard Avenue, East Aurora, New York 14052.

Hearing-impaired consumers using TTY/TDD equipment,
please call 1-800-382-7470.

For countries outside the United States:

Canada: Mattel Canada Inc., 6155 Freemont Blvd.,
Mississauga, Ontario L5R 3W2; www.service.mattel.com.

Great Britain: Mattel UK Ltd, Vanwall Business Park,
Maidenhead SL6 4UB, Helpline: 01628 500303,
www.service.mattel.com/uk

Australia: Mattel Australia Pty. Ltd., 658 Church Street,
Locked Bag #870, Richmond, Victoria 3121 Australia.
Consumer Advisory Service 1300 135 312.

New Zealand: 16-18 William Pickering Drive,
Albany 1331, Auckland.

Asia: Mattel East Asia Ltd, Room 1106, South Tower,
World Finance Centre, Harbour City, Tsimshatsui, HK, China.

FCC Statement (United States Only)

This equipment has been tested and found to comply with the limits for a Class B digital device, pursuant to Part 15 of the FCC Rules. These limits are designed to provide reasonable protection against harmful interference in a residential installation. This equipment generates, uses and can radiate radio frequency energy and, if not installed and used in accordance with the instructions, may cause harmful interference to radio communications. However, there is no guarantee that interference will not occur in a particular installation. If this equipment does cause harmful interference to radio or television reception, which can be determined by turning the equipment off and on, the user is encouraged to try to correct the interference by one or more of the following measures:

Care

- To clean, wipe the surface of this toy with a damp cloth. Do not immerse this toy.
- Do not drop this toy on a hard surface.
- This toy has no consumer serviceable parts. Please do not take this toy apart.

- Reorient or relocate the receiving antenna.
- Increase the separation between the equipment and receiver.
- Consult the dealer or an experienced radio/TV technician for help.

Note: Changes or modifications not expressly approved by the manufacturer responsible for compliance could void the user's authority to operate the equipment.