

INSTRUCTION SHEET SPECIFICATIONS
 Toy: CARS MINIS RED FIRE PLAYSET TV
 Part No.: P0019
 Part No.: 0920
 Trim Size: 17.55"x8.26"
 Folded Size: 7.87"x5.45"
 Type of Fold:
 # colors: One
 Colors: Black
 Paper Stock: White Offset
 Paper Weight: 70 lb.
 EDM No.:

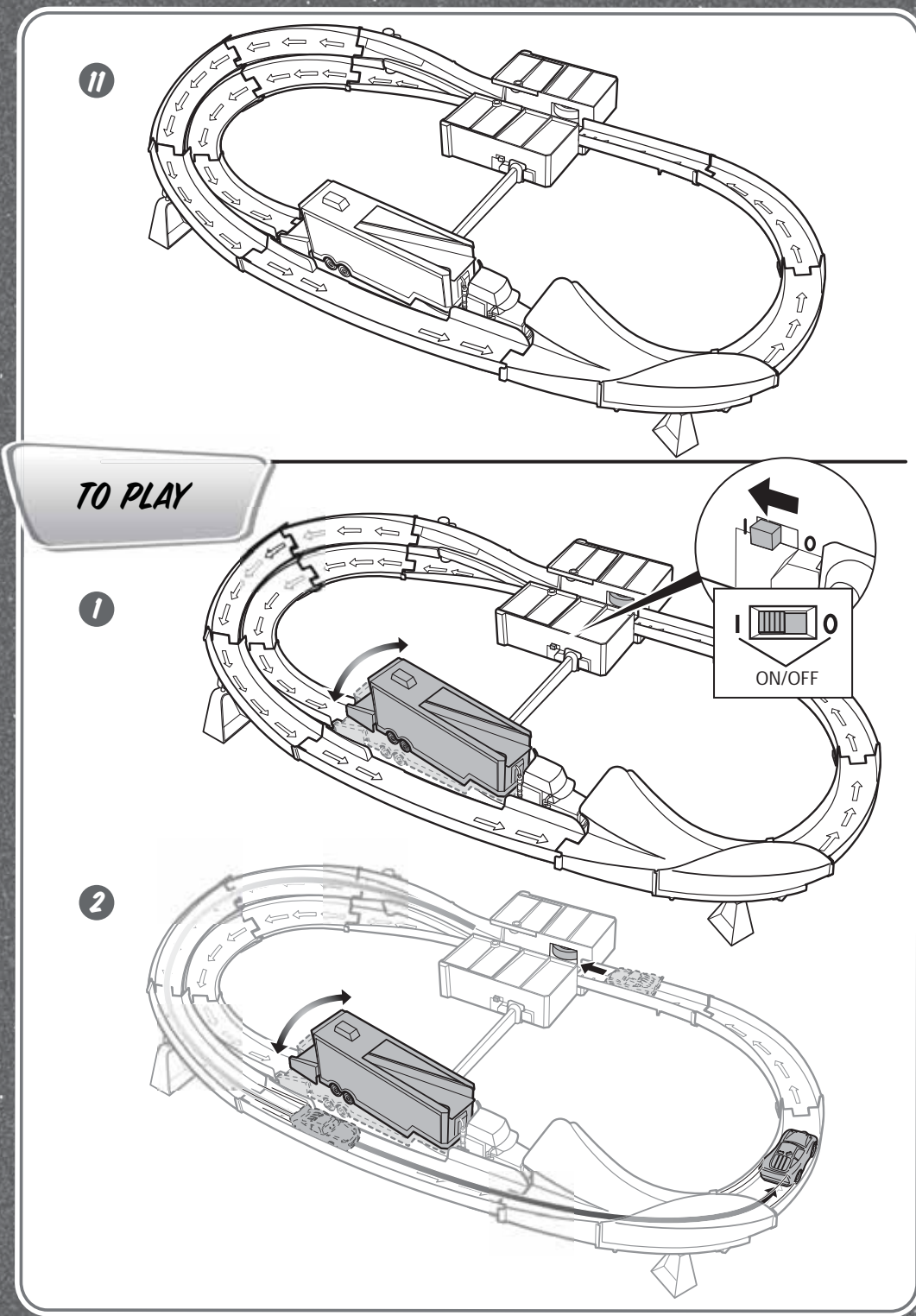

TO PLAY

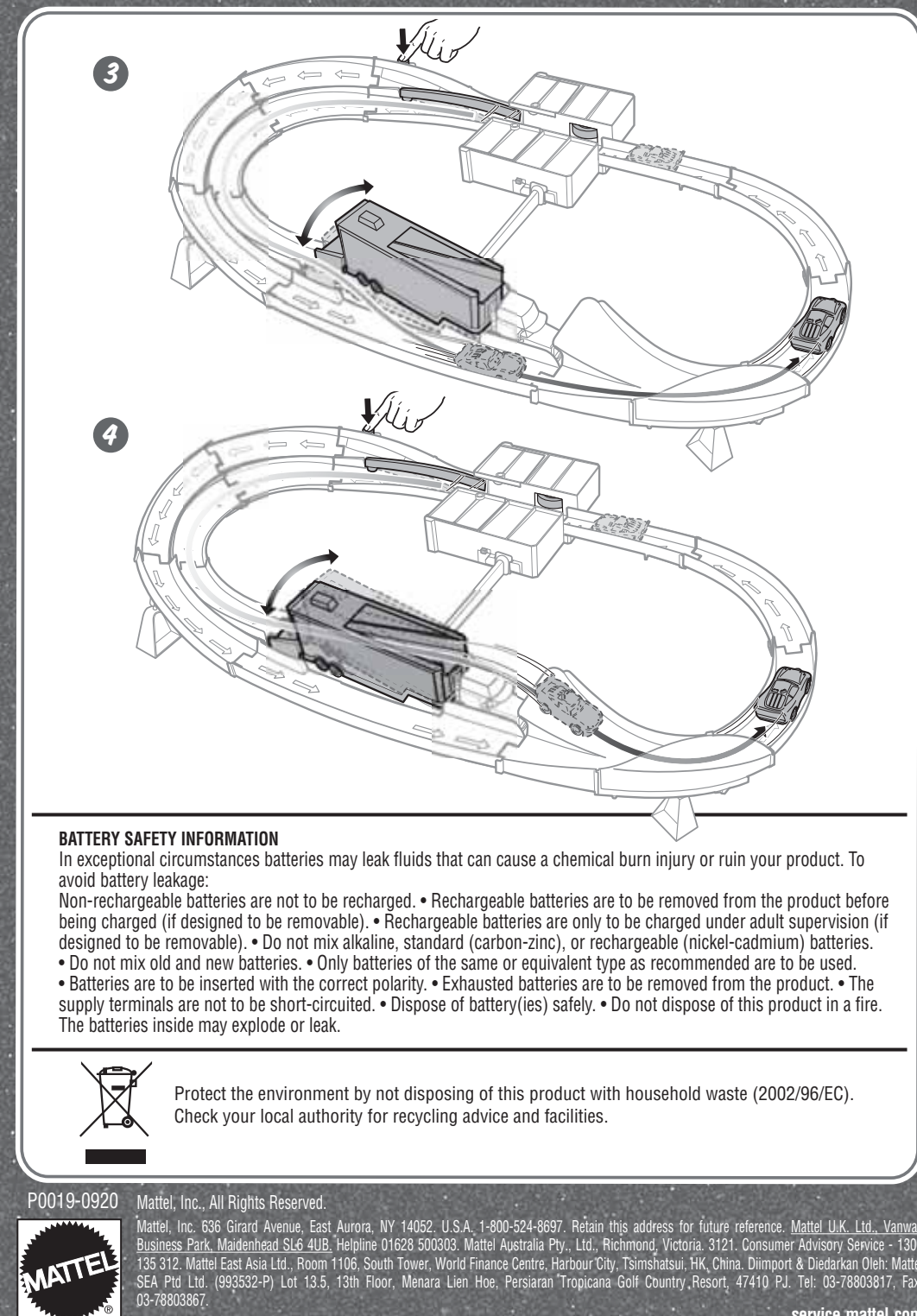

BATTERY SAFETY INFORMATION
 In exceptional circumstances batteries may leak fluids that can cause a chemical burn injury or ruin your product. To avoid battery leakage:
 • Non-rechargeable batteries are not to be recharged. • Rechargeable batteries are to be removed from the product before being charged (if designed to be removable). • Rechargeable batteries are only to be charged under adult supervision (if designed to be removable). • Do not mix alkaline, standard (carbon-zinc), or rechargeable (nickel-cadmium) batteries.
 • Do not mix old and new batteries. • Only batteries of the same or equivalent type as recommended are to be used.
 • Batteries are to be inserted with the correct polarity. • Exhausted batteries are to be removed from the product. • The supply terminals are not to be short-circuited. • Dispose of battery(ies) safely. • Do not dispose of this product in a fire. The batteries inside may explode or leak.

Protect the environment by not disposing of this product with household waste (2002/96/EC). Check your local authority for recycling advice and facilities.

P0019-0920 Mattel, Inc. All Rights Reserved.
 Mattel, Inc. 636 Girard Avenue, East Aurora, NY 14052, U.S.A. 1-800-524-8897. Retain this address for future reference. Mattel U.K. Ltd., Vauxhall Business Park, Mansfield Road, 4th Floor, South Tower, World Finance Centre, Harbour City, Tsimshatsui, HK, China. Dimpont & Diederiksen Oost: Mattel SEA Pte Ltd. (895332-P) Lot. 13.3, 13th Floor, Menara Lien Hoe, Persiaran Tropicana Golf Country, Resort, 47410 PJ, Tel: 03-78903817, Fax: 03-78903867.
 service.mattel.com

INSTRUCTIONS 5+

Please keep these instructions for future reference as they contain important information.

CONTENTS

© Disney/Pixar
 Mack is a registered trademark of Mack Trucks, Inc.

BATTERY INSTALLATION

- Unscrew the battery cover with a Phillips head screwdriver (not included).
- Remove batteries included for demonstration purposes and dispose of them safely.
- Install 4 'D' size batteries in the orientation (+/-) shown.
- Replace battery cover and tighten screw.
- For best performance, use only alkaline batteries.
- Replace batteries if lights dim or if sounds play slowly or distort.

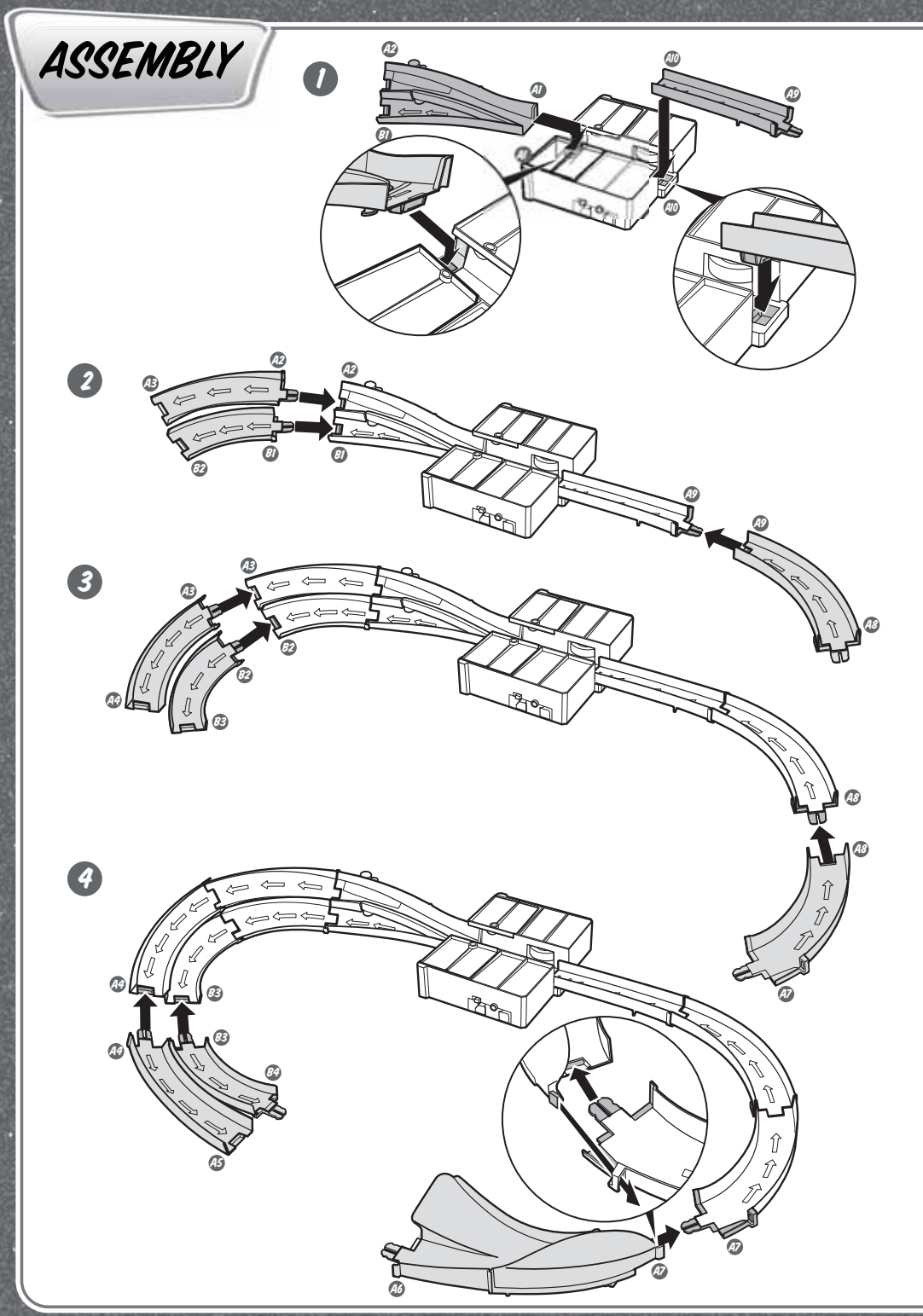

ASSEMBLY

