

Fisher-Price®

P4259



www.fisher-price.com

Consumer Information



WARNING

Prevent serious injury or death from falls or sliding out.

- The child should be secured in the high chair at all times by the restraint system, either in the reclining or upright position. The restraint belts must be adjusted to fit your child snugly. The tray is not designed to hold the child in the chair.
- It is recommended that only children capable of sitting upright unassisted use the high chair in the upright position.
- Always keep child in view while using the high chair.
- Never leave child unattended.



CAUTION

This package contains small parts
in its unassembled state.
Adult assembly is required.

IMPORTANT! Please keep these instructions for future reference.

- Please read these instructions before assembly and use of this product.
- Adult assembly is required. Tool needed for assembly: Allen wrench (included).
- Product features and decorations may vary from photographs.

Parts

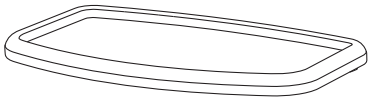

Food Tray

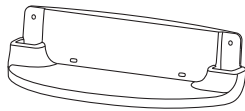

Footrest

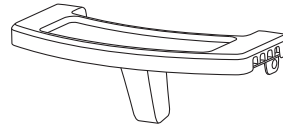

Snack Tray

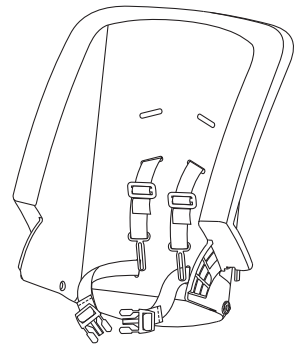

Seat Back with Shoulder and Waist Belts

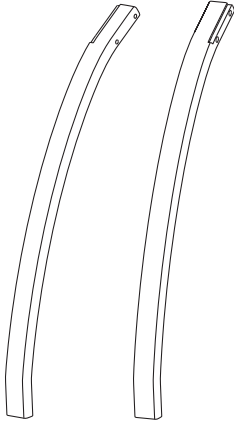

2 Front Legs

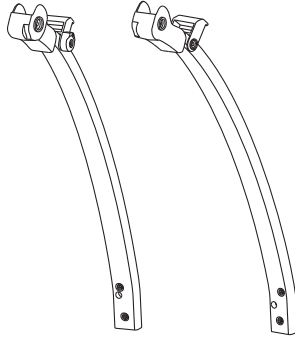

2 Back Legs

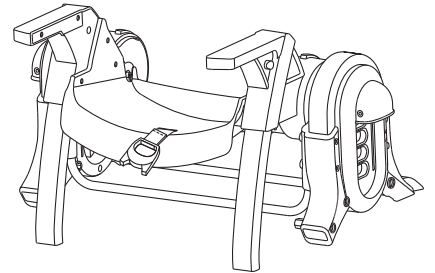

Seat Bottom with Crotch Belt



Back Base



Front Base

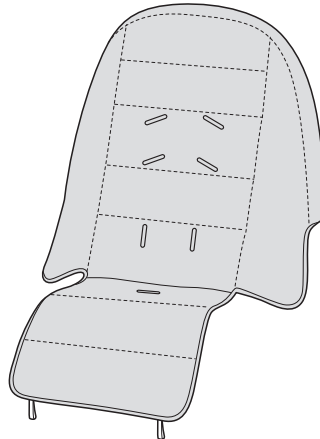

Seat Pad



2 Seat Brackets

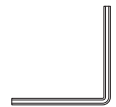

Allen Wrench



M4 x 17mm Screw – 6

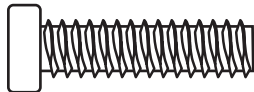

M6 x 28mm Screw – 8

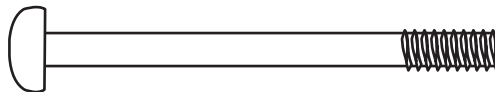

M5 x 60mm Screw – 6

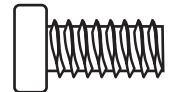

M6 x 15mm Screw – 2

All Fasteners Shown Actual Size

Tighten the screws with the enclosed Allen wrench.

Assembly

IMPORTANT! Before assembly and each use, inspect this product for damaged hardware, loose joints, missing parts or sharp edges. DO NOT use if any parts are missing or broken. Contact Fisher-Price® for replacement parts and instructions if needed. Never substitute parts.

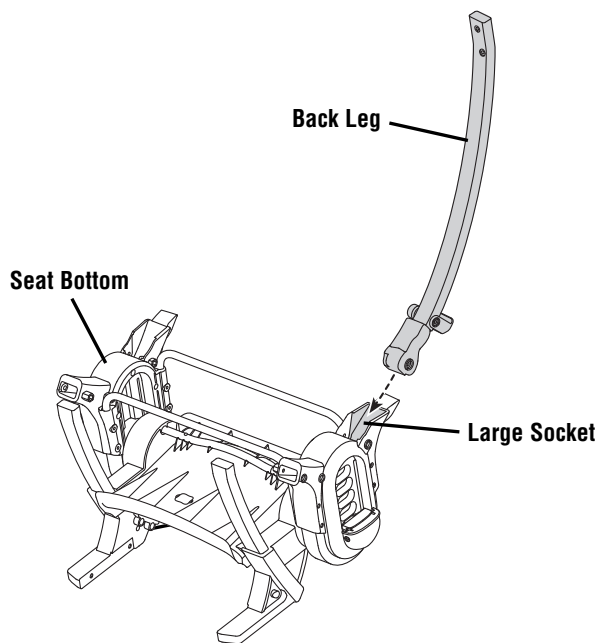

- Turn the seat bottom upside down on a flat surface.
- Position a back leg so that it curves up and fit it into a large socket in the seat bottom.

Hint: If the leg does not seem to fit into the seat bottom socket, try the other back leg.

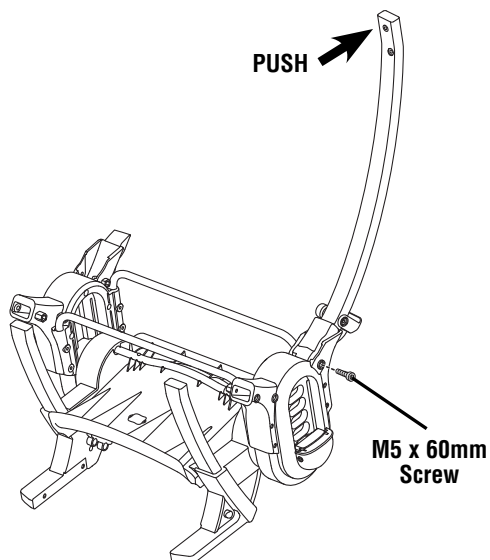

- Insert an M5 x 60mm screw into the side of the seat bottom and tighten.
- Push the back leg until it **"snaps"** in place.

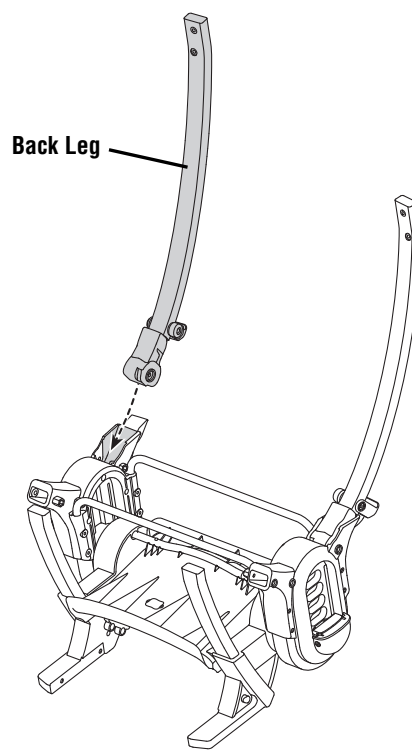

- Fit the other back leg into the large socket in the seat bottom.

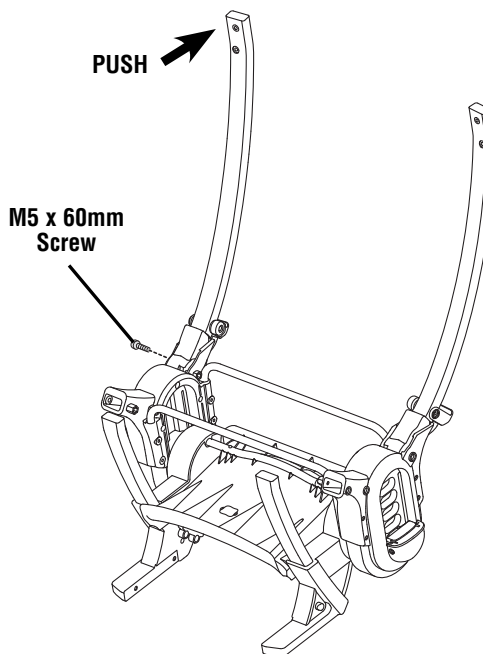

- Insert an M5 x 60mm screw into the side of the seat bottom and tighten.
- Push the back leg until it **"snaps"** in place.

Assembly

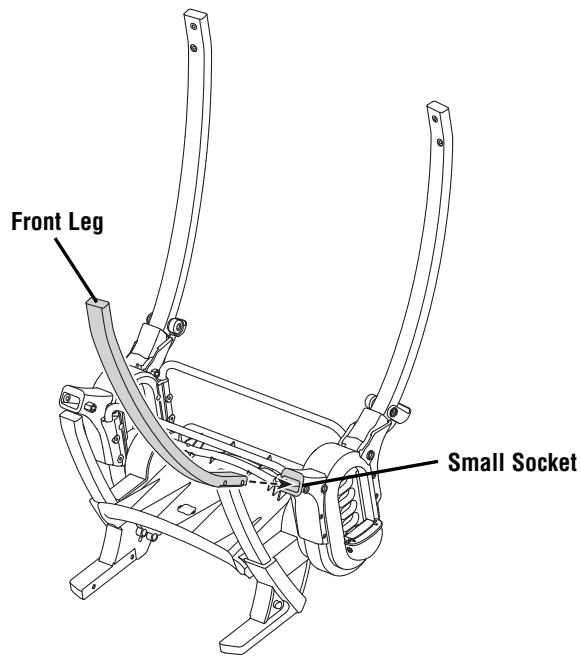

- Position a front leg so that it curves up and fit it into the small socket in the seat bottom.

Hint: If the leg does not seem to fit into the seat bottom, try the other front leg.

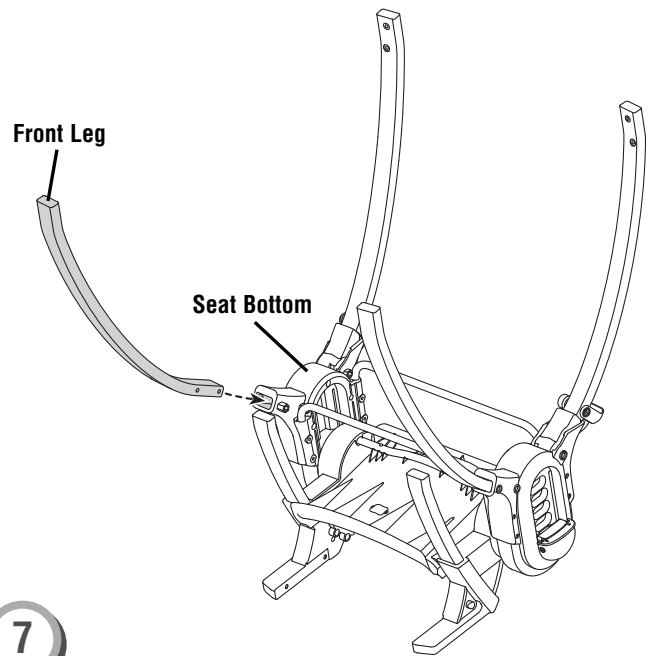

- Fit the other front leg into the small socket in the seat bottom.

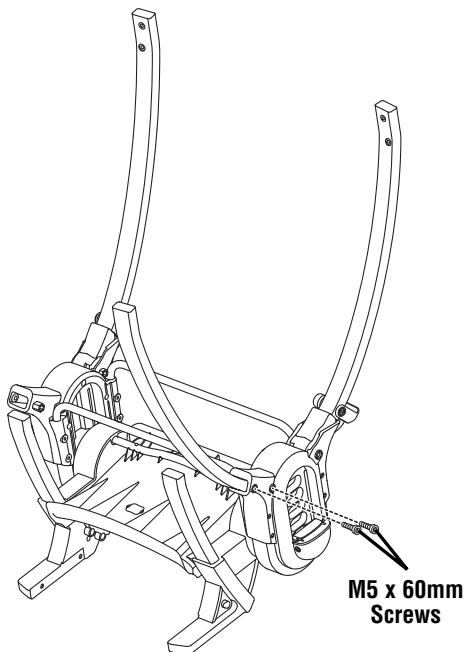

- Insert two M5 x 60mm screws into the other side of the seat bottom and tighten.

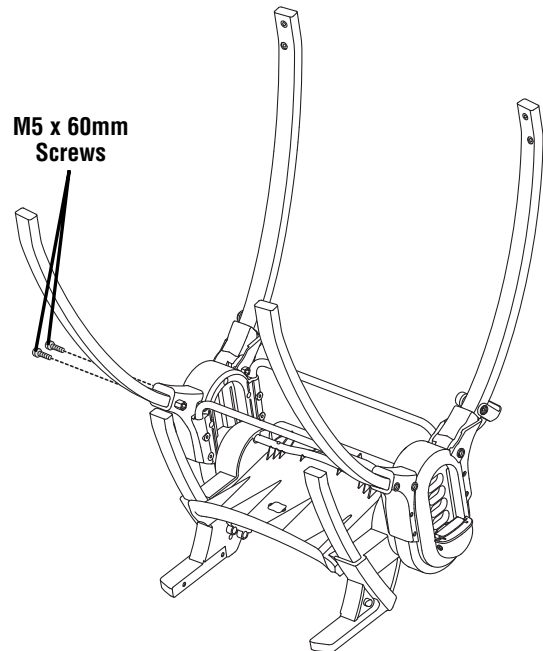

- Insert two M5 x 60mm screws into the side of the seat bottom and tighten.

Assembly

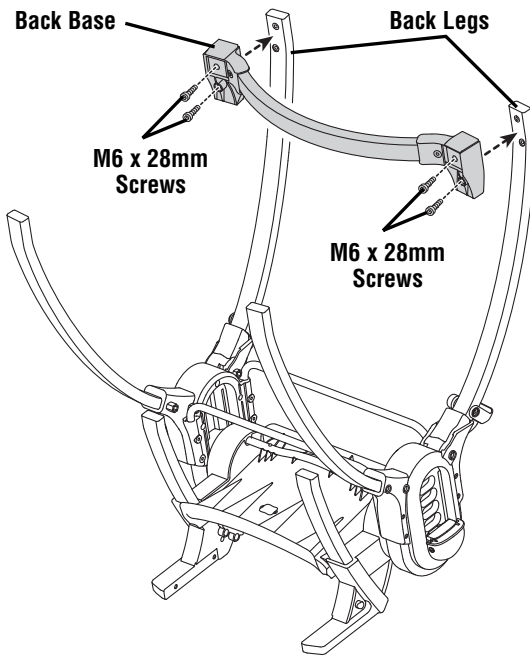

9

- Fit the back base onto the bottom of both back legs, as shown.
- Insert two M6 x 28mm screws into **each back leg** and tighten.

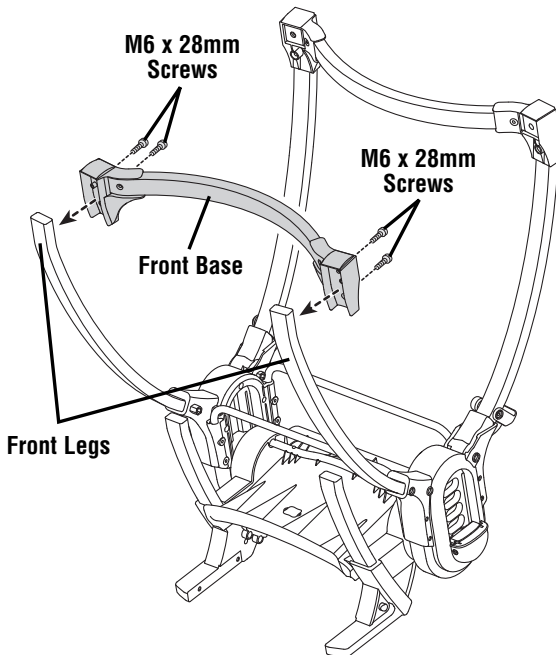

10

- Fit the front base onto the bottom of both front legs.
- Insert two M6 x 28mm screws into **each front leg** and tighten.
- Turn the assembly upright.

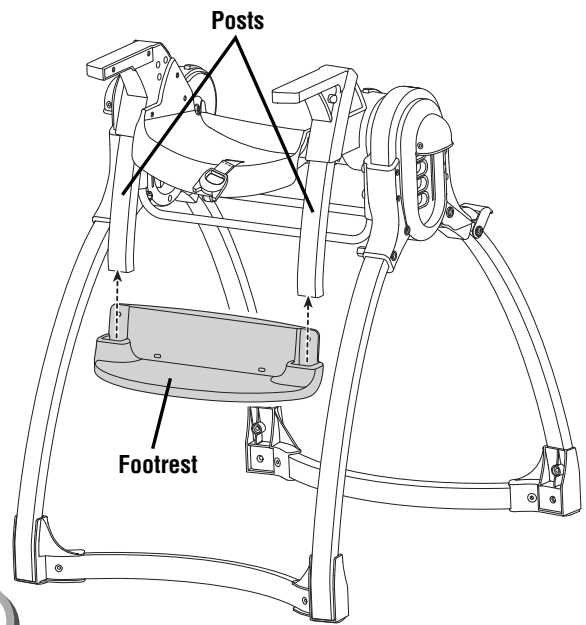

11

- Fit the sockets on the footrest onto the posts on the front of the assembly.
- Slide the footrest up onto the posts.

***Hint:** You may want to lower the seat to assemble the footrest. Refer to page 13 for instructions to lower the seat.*

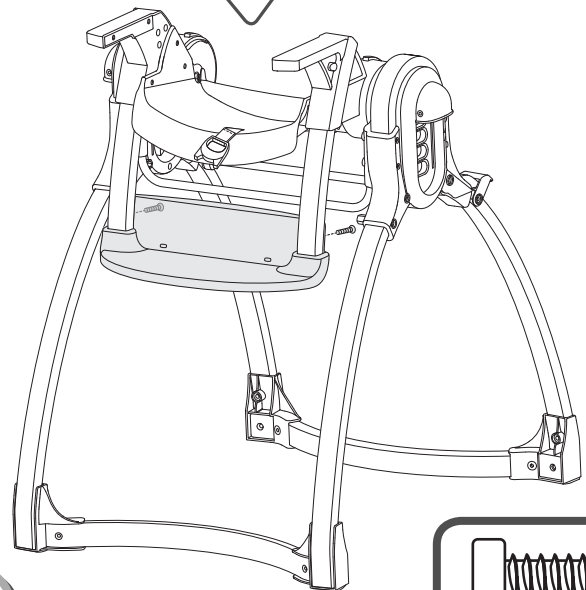
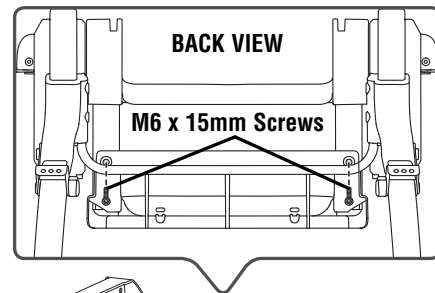

12

- While holding the footrest in place, insert two M6 x 15mm screws into the holes on the back of the footrest and tighten.

Assembly

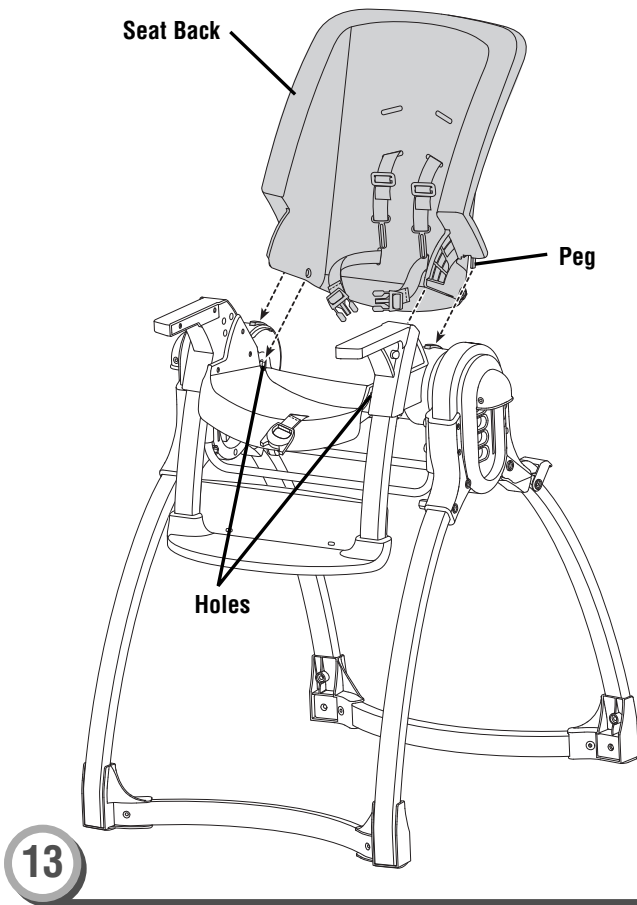

- At an angle, fit the pegs on each side of the seat back into the holes in the sides of the seat bottom.

Hint: You may need to flex the bottom edge of the seat back to fit the seat back pegs into the holes in the seat bottom.

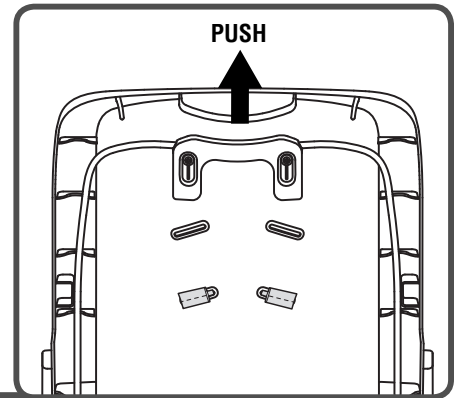
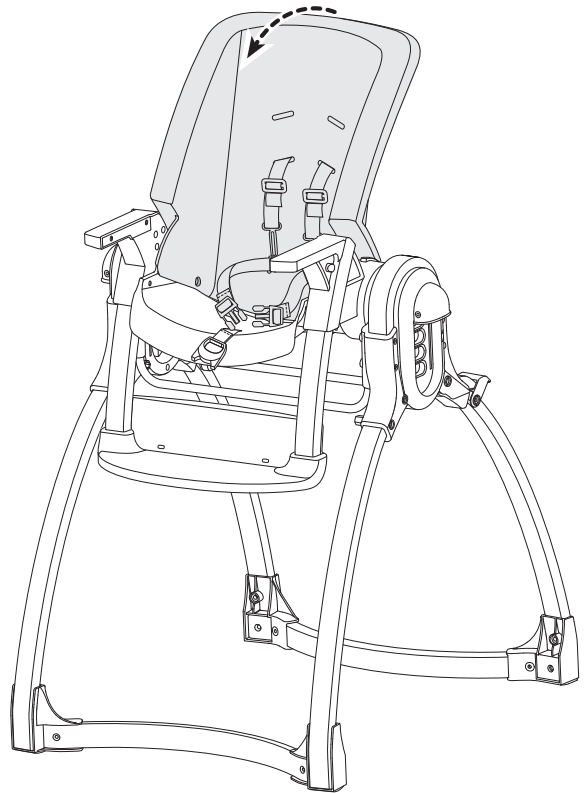

- Lift the seat back latch and push the seat back forward.

Assembly

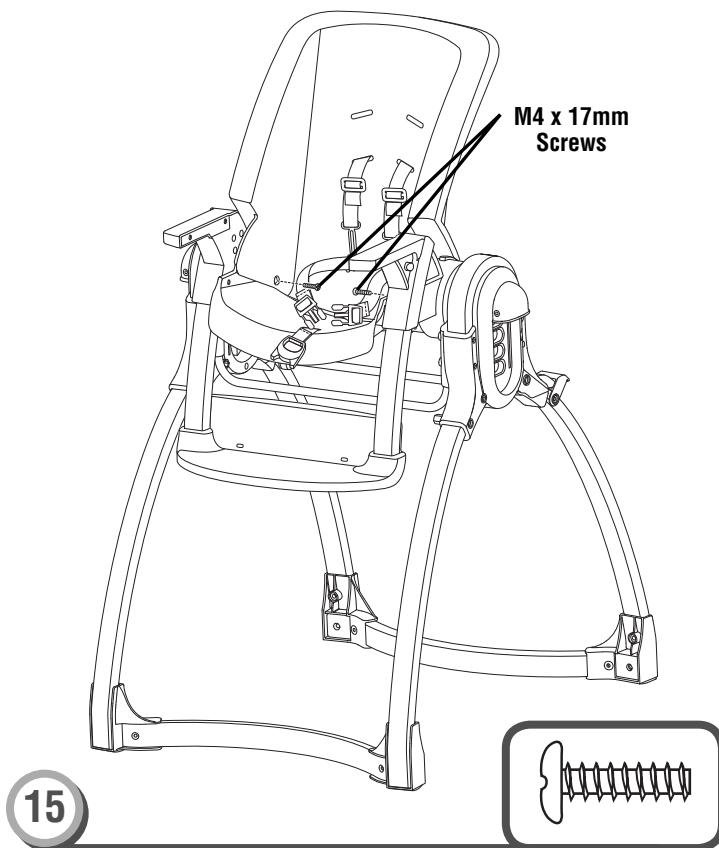

- Insert two M4 x 17mm screws into the seat back and tighten.

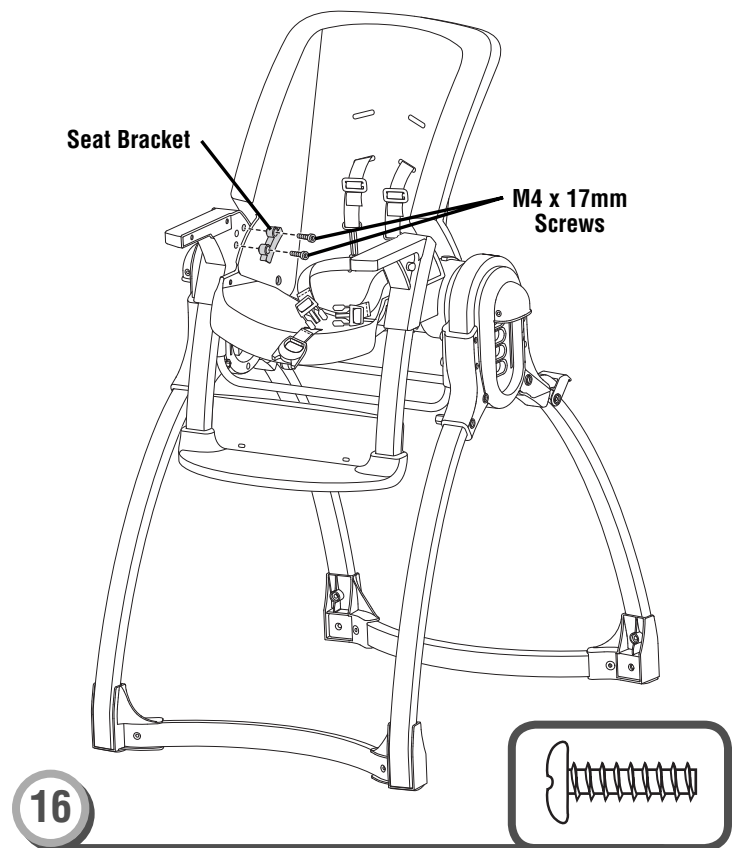

- Fit a seat bracket to the side of the seat bottom, as shown.
- Insert two M4 x 17 mm screws and tighten.

Assembly

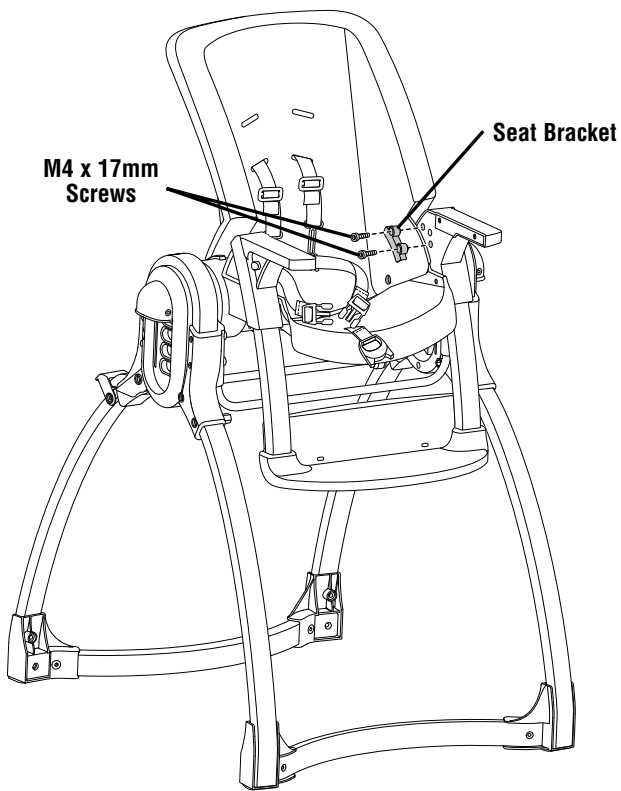

17

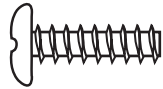

- Fit the other seat bracket to the other side of the seat bottom, as shown.
- Insert two M4 x 17 mm screws and tighten.

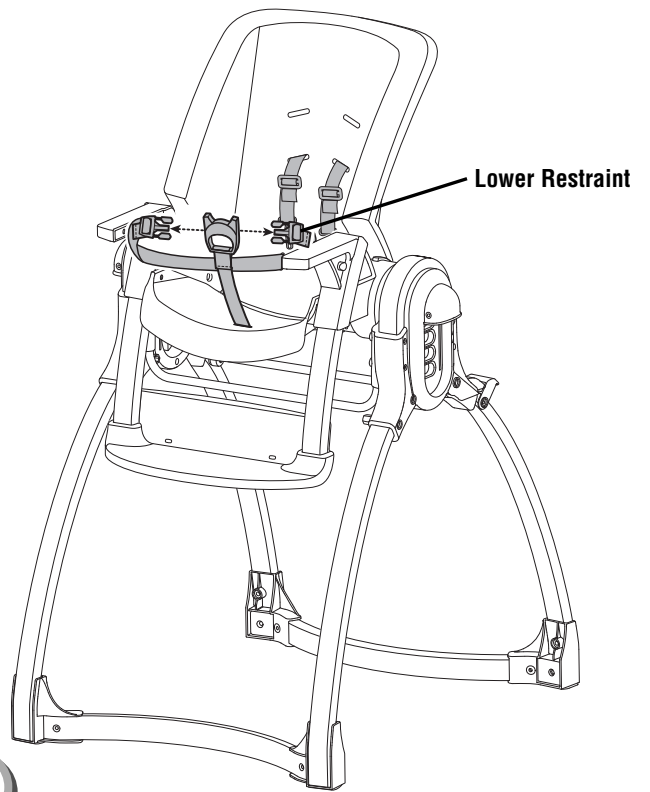

18

- Unbuckle the lower restraint.

Assembly

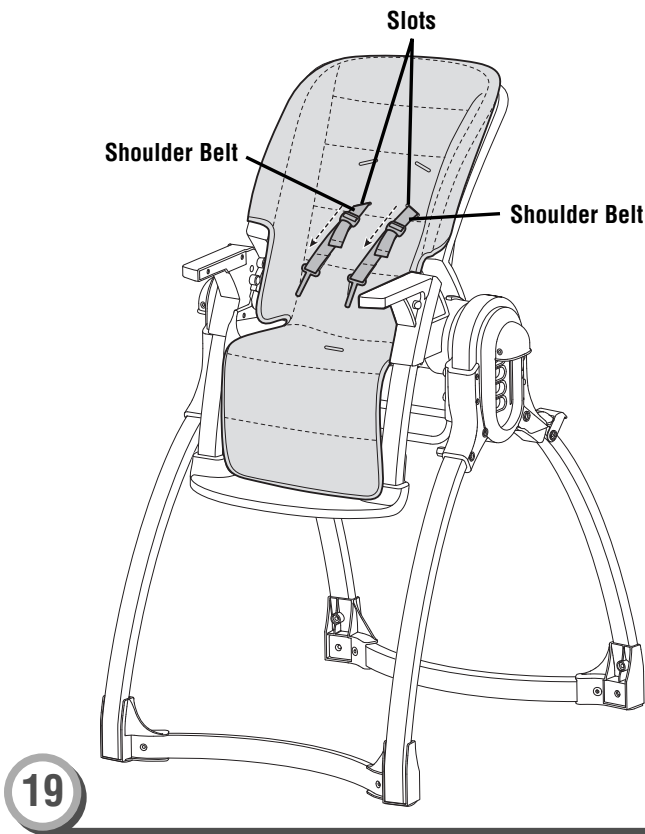

Hint: The shoulder belts come assembled to the seat back in the lower position for a smaller child. To change to the upper slots for a larger child, refer to page 12.

- Place the seat pad onto the seat.
- Pull the shoulder belts ends through the slots in the seat pad.

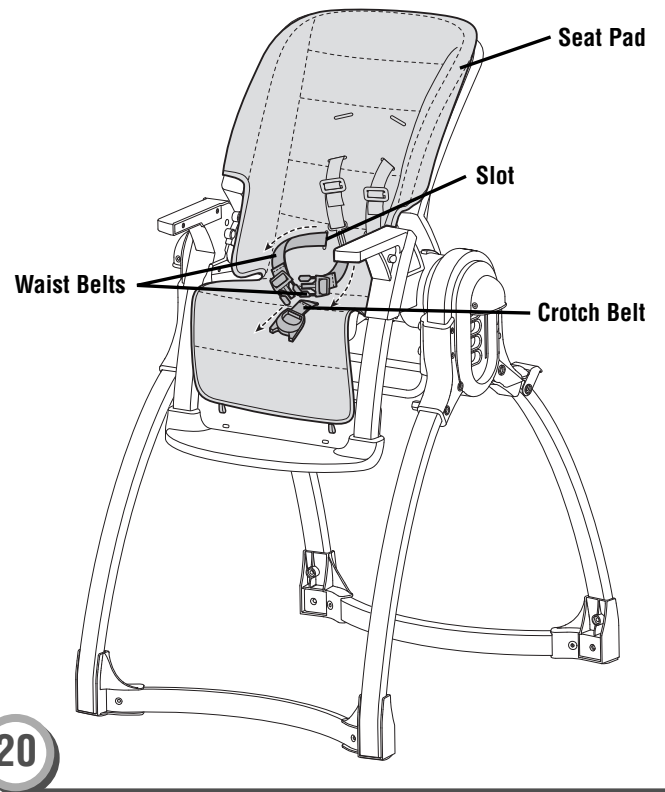

- Pull the waist belt ends through the slots in the seat pad.
- Pull the crotch belt through the slot in the seat pad.

Assembly

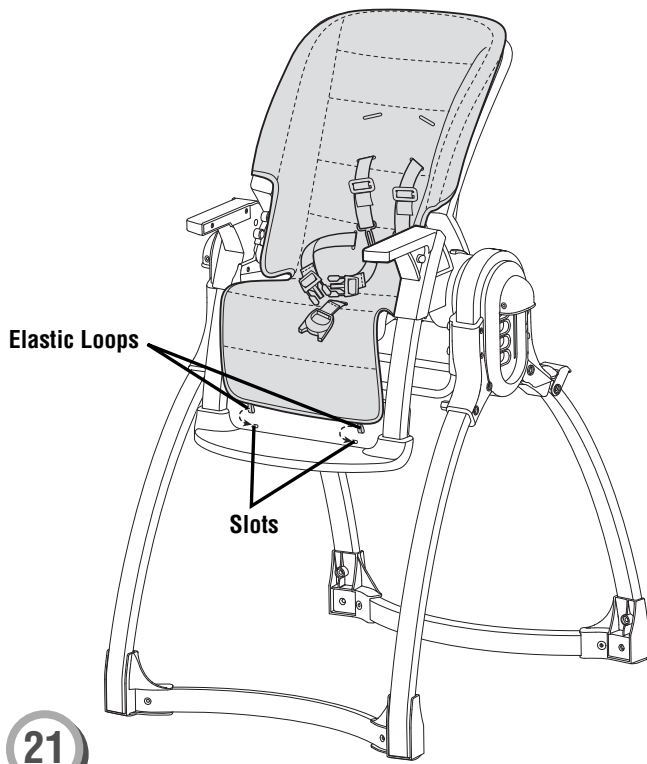

21

- Fit the elastic loops on the seat pad down through the slots in the footrest.

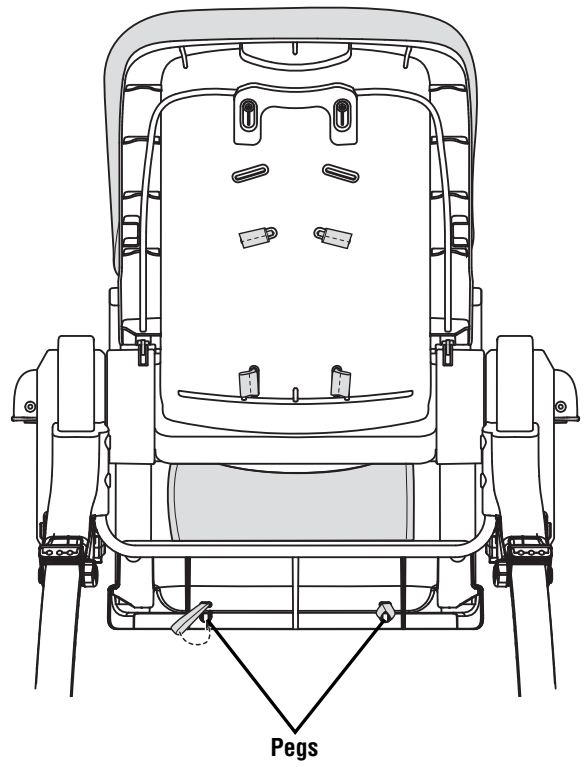

22

BACK VIEW

- Fit the elastic loops on the seat pad bottom onto the pegs on the footrest.

Assembly

Shoulder Belts

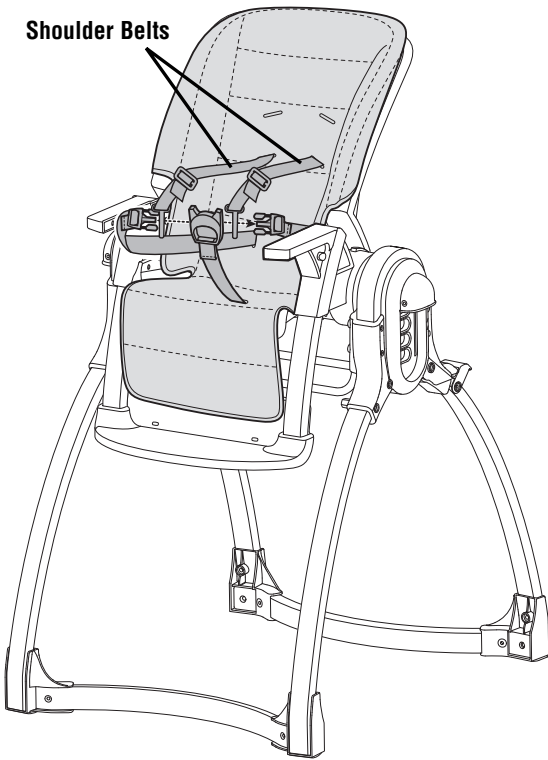

23

- Fit the ends of the waist belts through the clips on the shoulder belts.

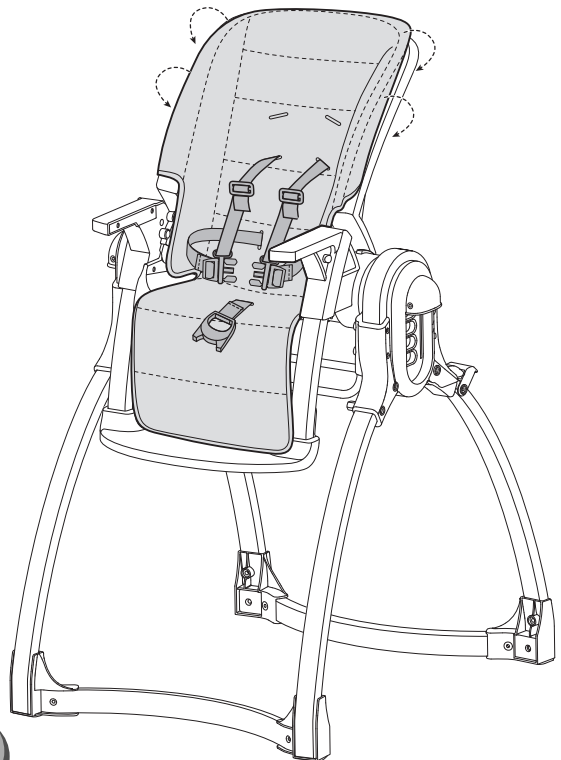

24

- Fit the upper pocket of the seat pad onto the seat back.

Securing Your Child

WARNING

Prevent serious injury or death from falls or sliding out.

- The child should be secured in the high chair at all times by the restraint system, either in the reclining or upright position. The restraint belts must be adjusted to fit your child snugly. The tray is not designed to hold the child in the chair.
- It is recommended that only children capable of sitting upright unassisted use the high chair in the upright position.
- Always keep child in view while using the high chair.
- Never leave child unattended.

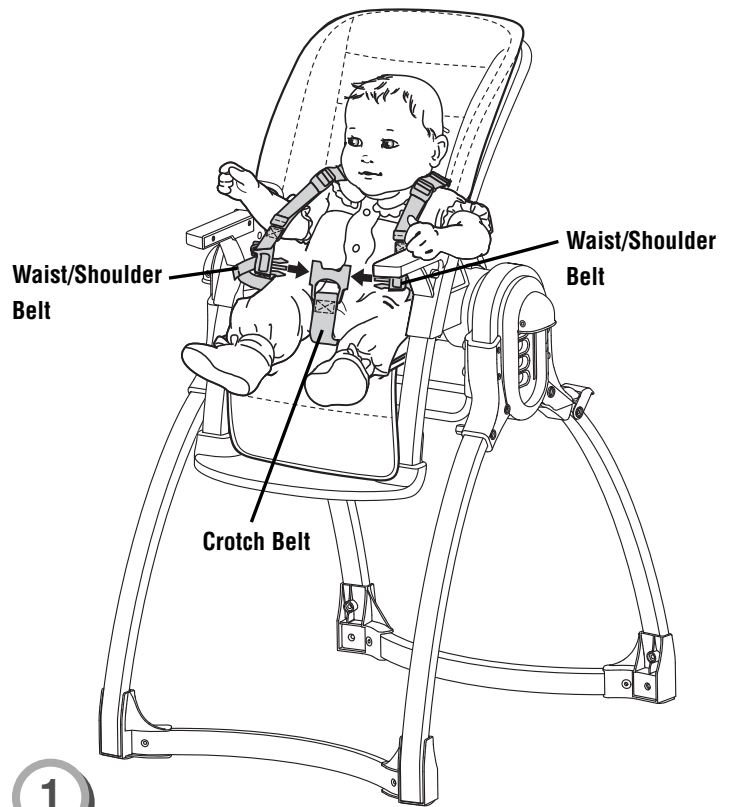

1. Place your child in the seat. Position the crotch belt between your child's legs.
- Fasten both waist/shoulder belts to each side of the crotch belt.
- Make sure you hear a **"click"** on both sides.
- Check to be sure the restraint system is securely attached by pulling it away from your child. The restraint system should remain attached.

Securing Your Child

2



- Tighten each waist belt/shoulder belt so that the restraint system is snug against your child. Please refer to the next section for instructions to tighten the waist belts/shoulder belts.

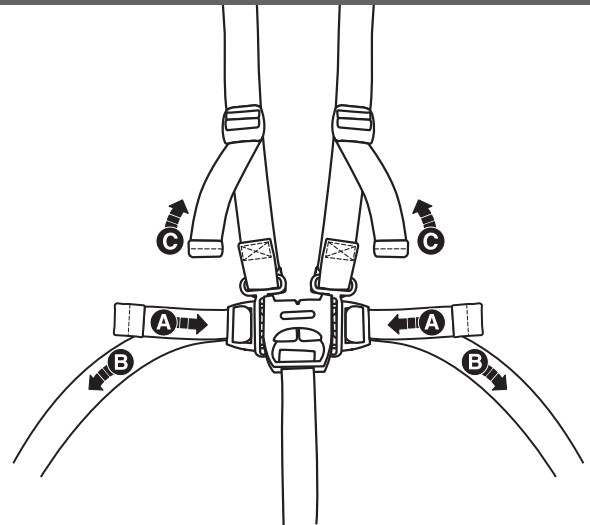
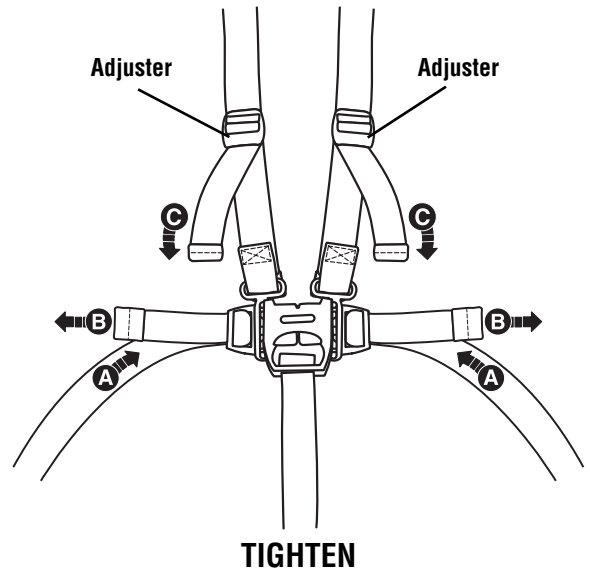

3

- **To tighten the waist belts:** Feed the anchored end of the waist belt up through the buckle to form a loop **A**. Pull the free end of the waist belt **B**.
- **To tighten the shoulder belts:** Hold the adjuster and pull the shoulder belt down **C**.
- **To loosen the waist belts:** Feed the free end of the waist belt up through the buckle to form a loop **A**. Enlarge the loop by pulling on the end of the loop toward the buckle.
- Pull the anchored end of the waist belt to shorten the free end of the waist belt **B**.
- **To loosen the shoulder belts:** Lift the adjuster **C**.

Note: After adjusting the restraint system to fit your child, make sure you pull on it to be sure it is securely fastened.

Securing Your Child

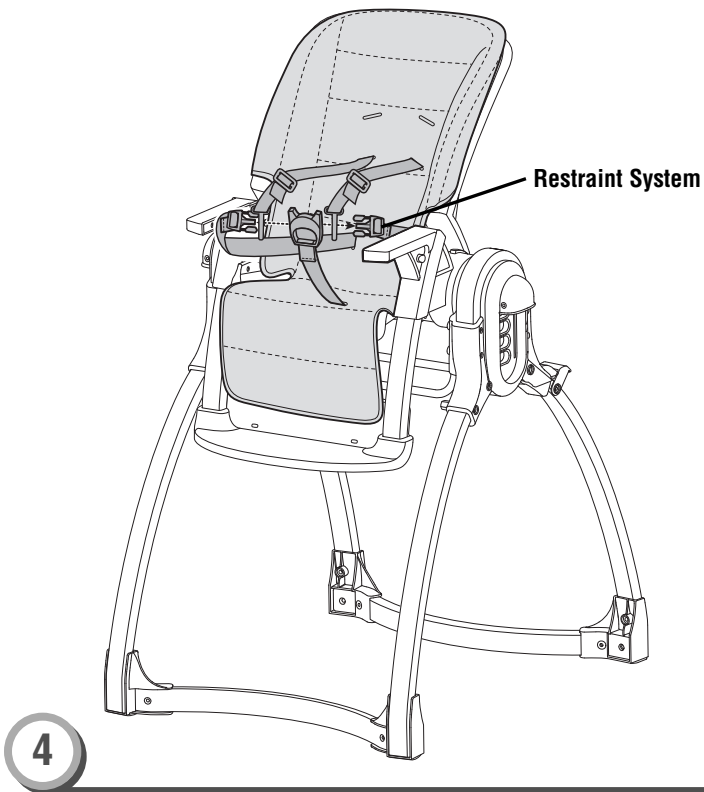

- Unbuckle the restraint system.

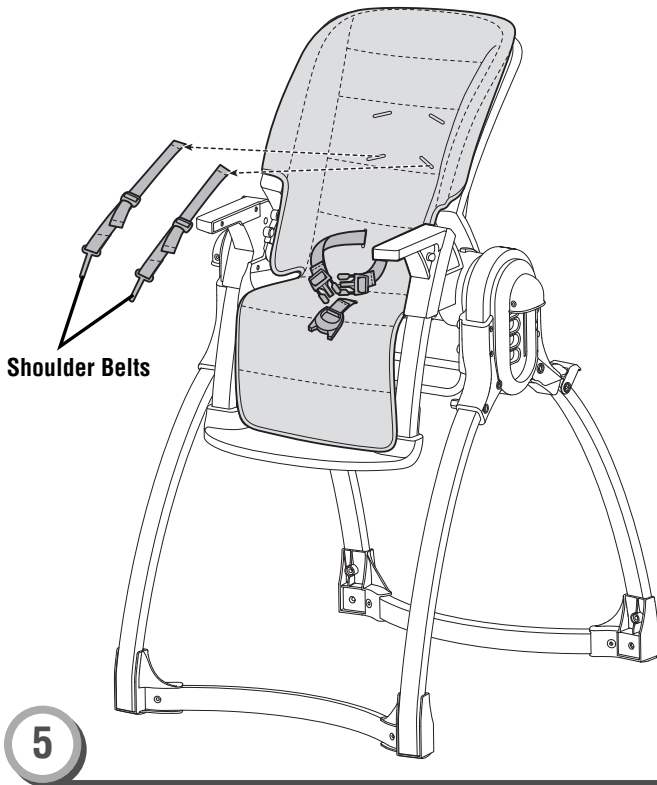

- To adjust the restraint height for baby, push to remove the shoulder belts from the seat back.

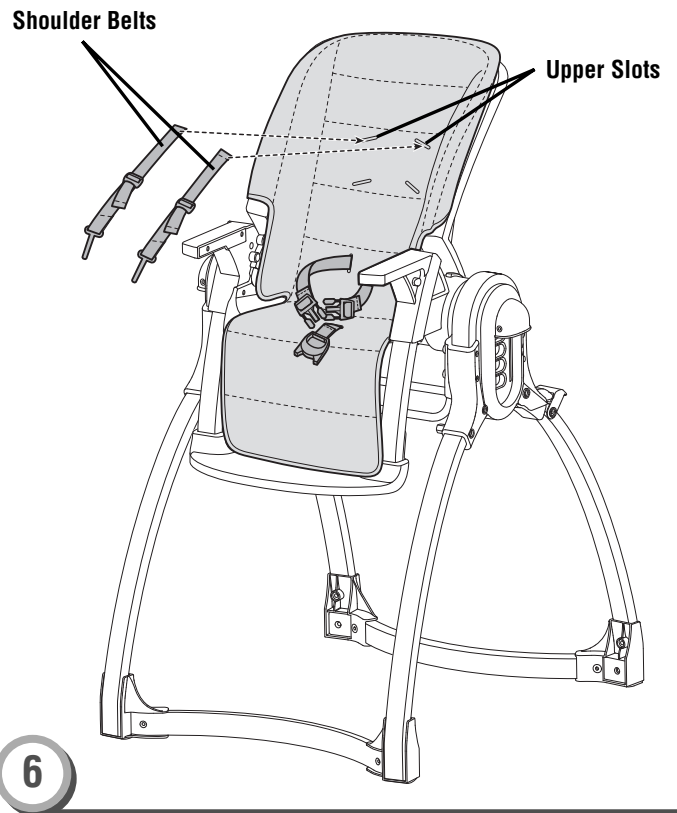

Larger Baby

- Insert the ends of the shoulder belts through the upper slots in the pad and seat back.

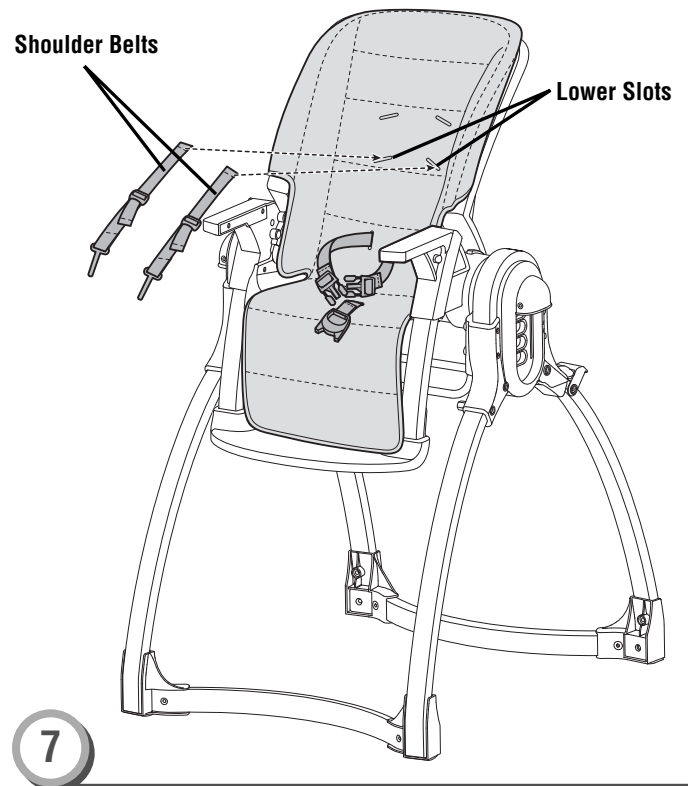

Smaller Baby

- Insert the ends of the shoulder belts through the lower slots in the pad and seat back.

Seat Adjustment

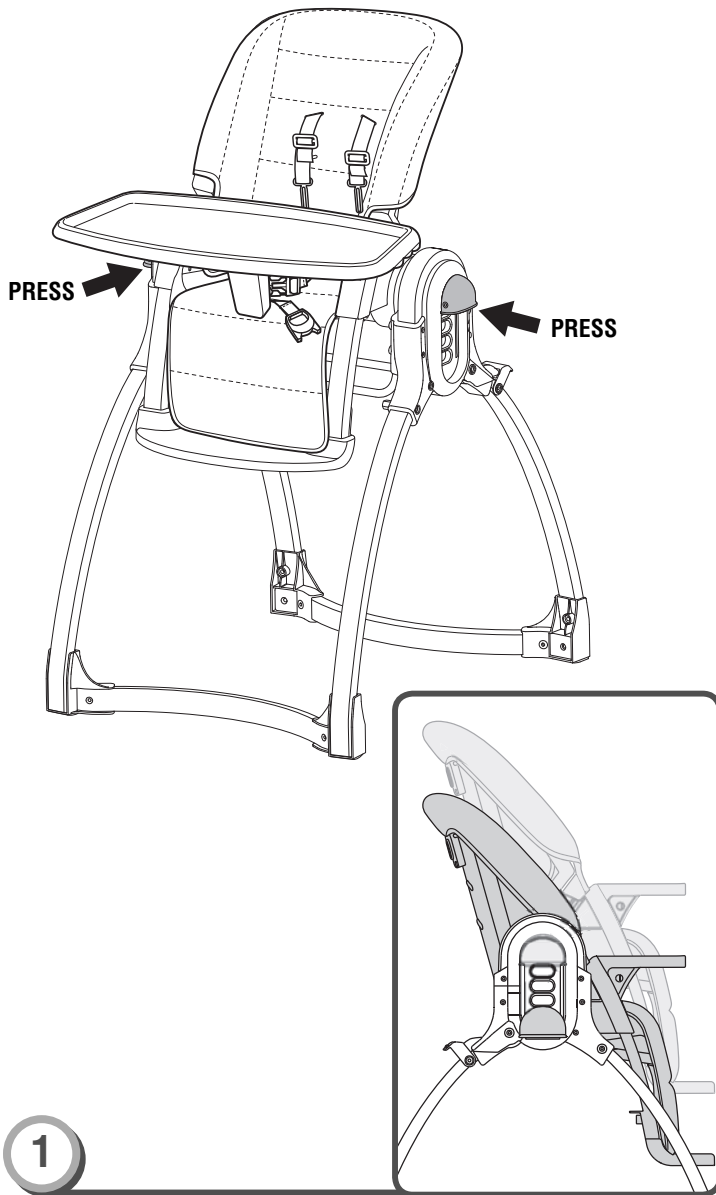

Adjusting Seat Height

- Press the levers on both seat height adjusters and lift or lower the seat to any of five different heights.
- Make sure both sides of the seat are adjusted to the same height.
- Push the seat bottom to be sure the seat is secure.

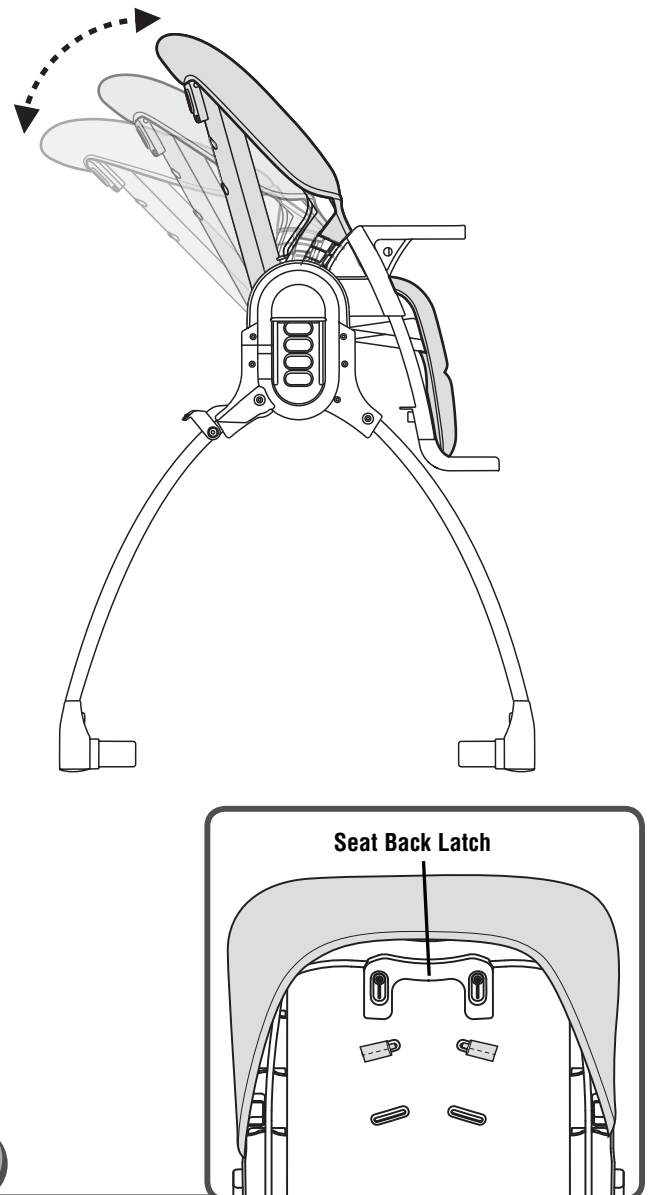

Adjusting Seat Recline

Hint: Adjust the seat angle to any of three positions: Upright, Semi-Recline or Recline.

- Lift the seat back latch and push the seat back forward or, pull it backwards to the desired position.
- Push the seat back to be sure it is latched in position.

Using the Trays

Hint: Before use, thoroughly wash all parts (the trays) that may contact food. The snack tray is not dishwasher safe. The snack and foot trays are not microwave safe.

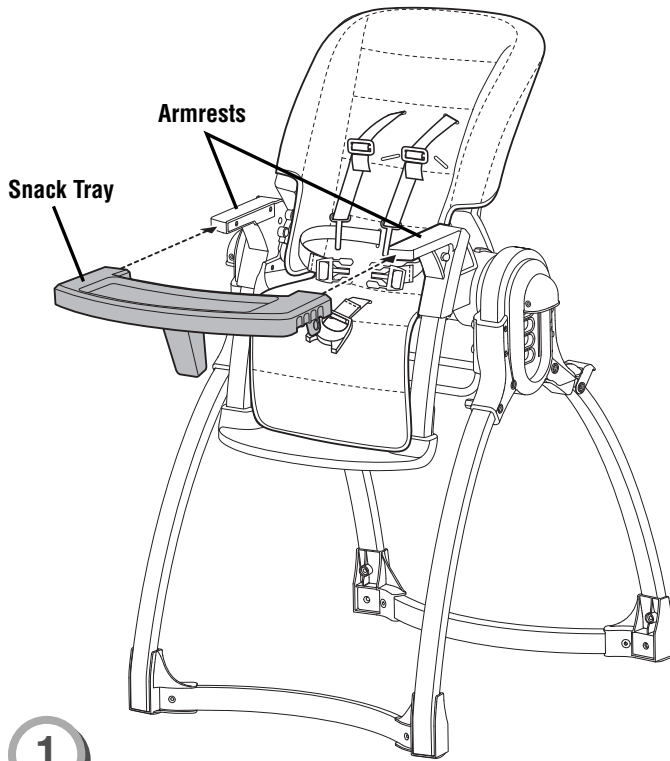

- Slide the snack tray onto the seat armrests. Push the snack tray until it **"snaps"** into place.

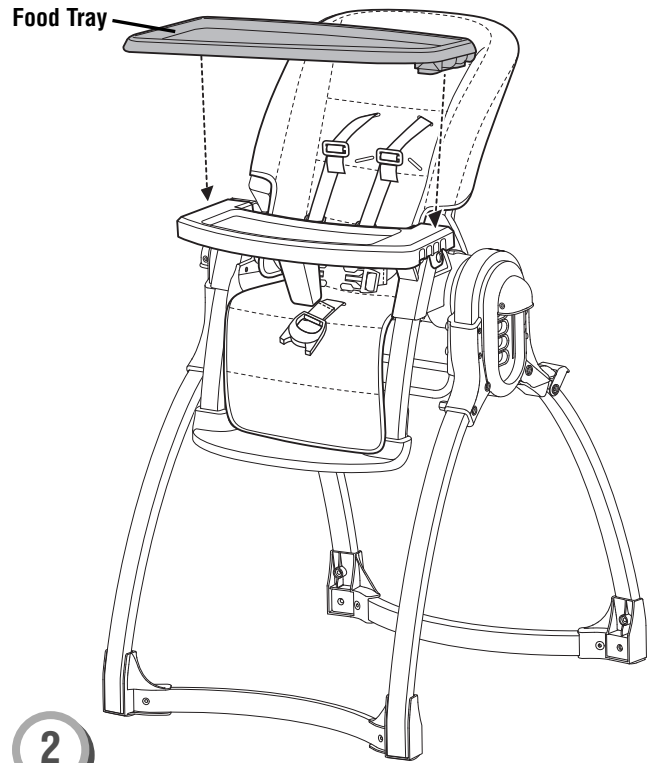

- Fit the food tray onto the seat armrests. Push down until the tray **"snaps"** into place.

Using the Trays

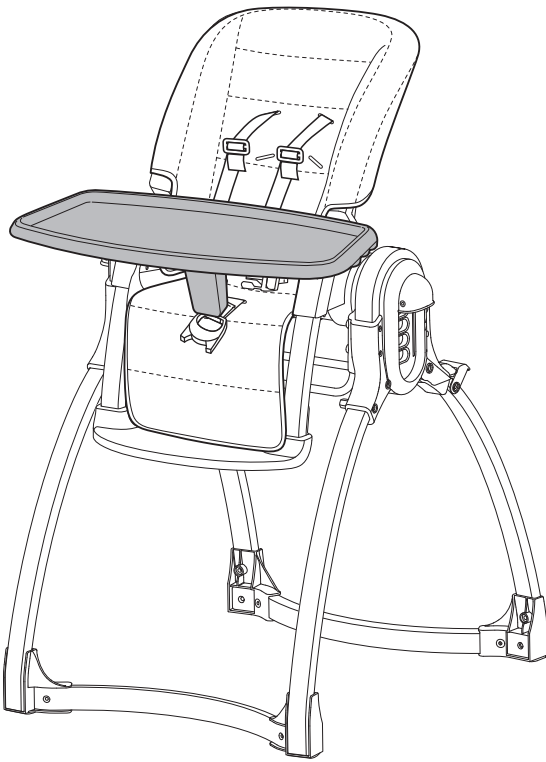

3

- While pulling the release tabs on the sides of the food tray, adjust the tray forward or backward.
- While pulling the release handles on the sides of the food tray, lift to remove it.

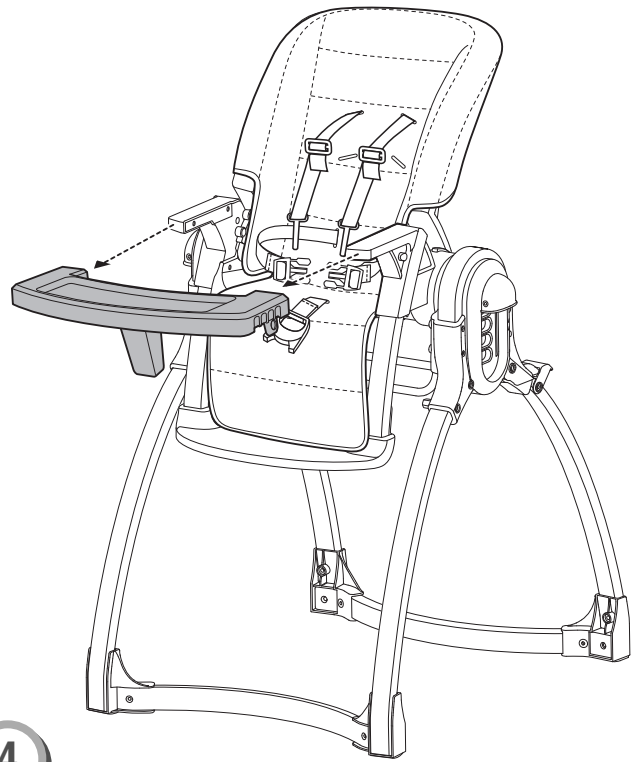

4

- To remove the snack tray, pull the tabs on the sides of the snack tray off the pegs.
- Slide the tray off of the armrests.

Storage

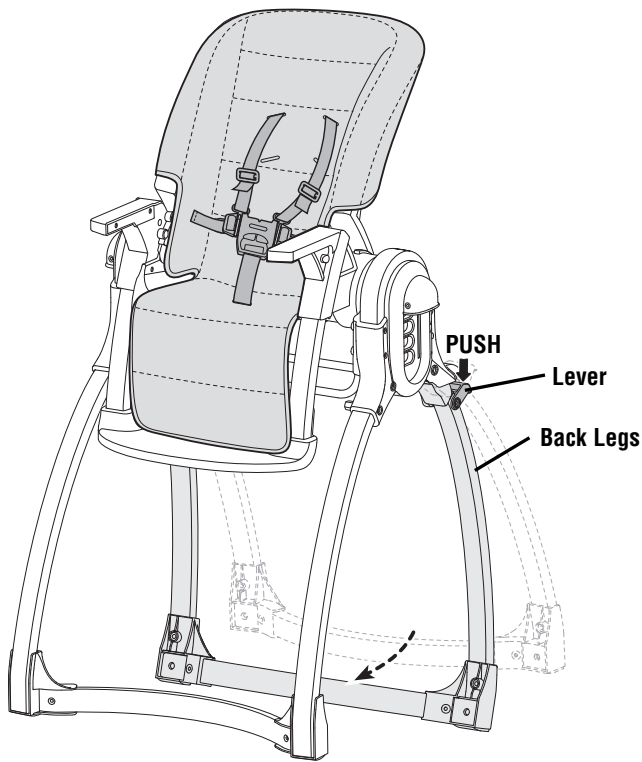

- Push down on the levers on the back legs.
- Then, push the back legs in towards the front legs.

Care

- The snack tray, seat and restraint straps may be wiped clean using a mild cleaning solution and damp cloth. Do not use bleach. Do not use harsh or abrasive cleansers. Rinse clean with water to remove residue.
- The food tray is dishwasher safe.
- Machine wash the seat pad in cold water with a mild detergent. Do not use bleach. Tumble dry on low heat and remove promptly.
- To remove the pad:
 - Push to remove the shoulder belts, waist belts and crotch belt from the seat and pads.
 - Unfasten the straps on the footrest.
- Remove the pad from the seat.
- To replace the pad and restraint straps, refer to the assembly instructions in this manual.

IMPORTANT! Be sure to replace the restraint system. Never use this product without the restraint system.



CONSUMER ASSISTANCE

Call toll free: 1-800-432-5437 (US & Canada only)
M-F 9AM to 7PM / SAT 11AM to 5PM (EST)



service.fisher-price.com

Write to us at: Fisher-Price® Consumer Relations,
636 Girard Avenue, East Aurora, New York 14052.

Hearing-impaired consumers using TTY/TDD equipment,
please call 1-800-382-7470.

In Mexico: 59-05-51-00 Ext. 5206 or 01-800-46359-89
In Brazil: 0800 550780

CANADA

Mattel Canada Inc., 6155 Freemont Blvd., Mississauga, Ontario L5R 3W2.

Fisher-Price, Inc., a subsidiary of Mattel, Inc., East Aurora, New York 14052, U.S.A.
©2009 Mattel, Inc. All Rights Reserved. ® and ™ designate U.S. trademarks of Mattel, Inc.