

EMPTY WATER

Lift up on the track over the splash pool. Carefully lift up on the splash pool, detaching it from the base. Slide under the track, and remove.

Carefully take the pool to a sink and pour out the water.

Empty the hot tub and pool too.

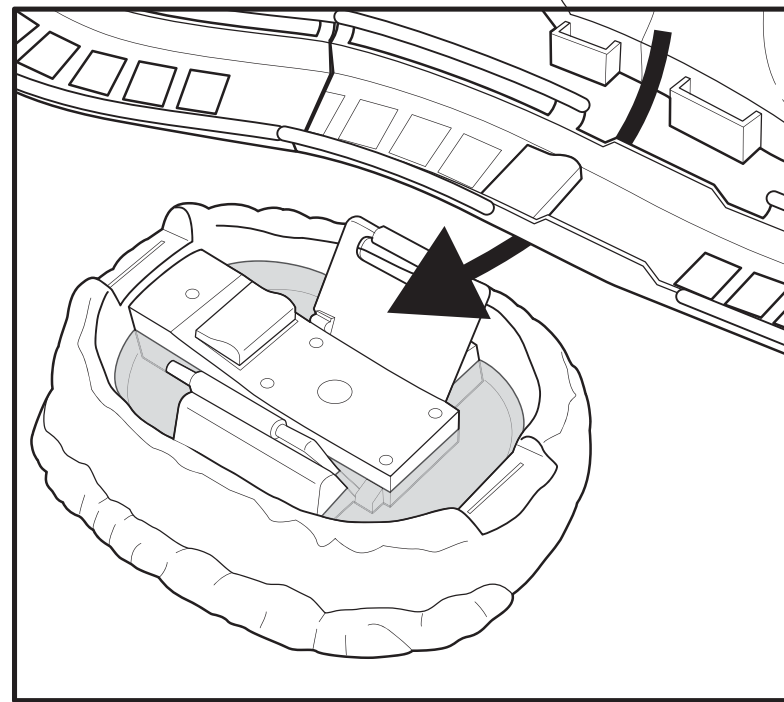

Roller Coaster Resort

Playset



INSTRUCTIONS

CONTENTS

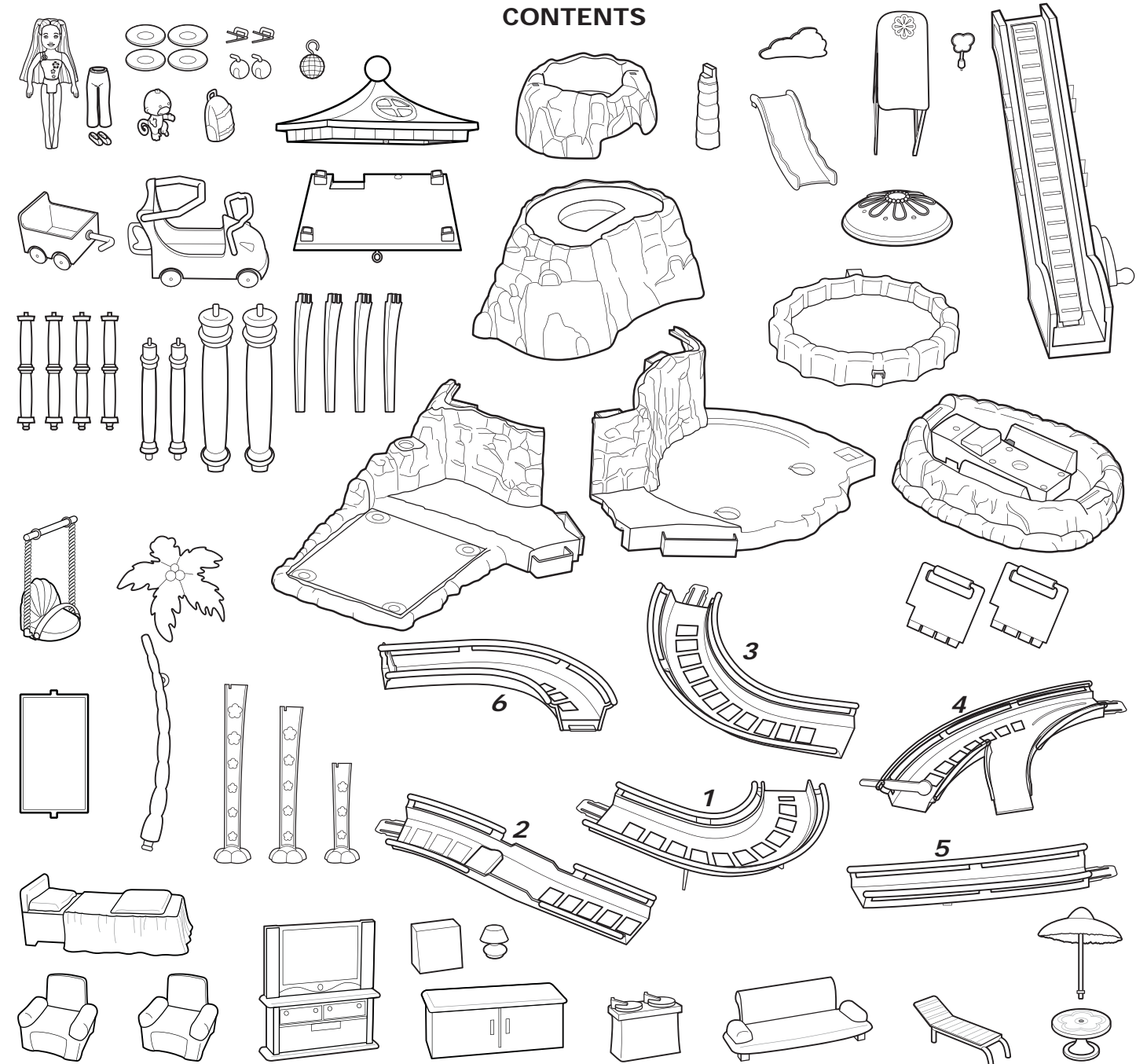

CONSUMER INFORMATION

Need Assistance? Visit service.mattel.com or call 1-800-524-8697 (US and Canada only), M-F 9AM - 7PM & SAT 11AM - 5PM, Eastern.

SERVICE.MATTEL.COM

Mattel Canada Inc., Mississauga, Ontario L5R 3W2. You may call us free at 1-800-524-8697.

Mattel U.K. Ltd., Vanwall Business Park, Maidenhead SL6 4UB. Helpline 01628 500303.

Mattel Australia Pty., Ltd., Richmond, Victoria. 3121. Consumer Advisory Service - 1300 135 312.

Mattel East Asia Ltd., Room 1106, South Tower, World Finance Centre, Harbour City, Tsimshatsui, HK, China

Diimport & Diedarkan Oleh: Mattel SEA Ptd Ltd.(993532-P) Lot 13.5, 13th Floor, Menara Lien Hoe, Persiaran Tropicana Golf Country Resort, 47410 P.J. Tel:03-78803817, Fax:03-78803867.

Mattel, Inc. 636 Girard Avenue, East Aurora NY 14052. U.S.A. Consumer Relations 1 (800) 524-8697.



Please remove everything from the package and compare to the contents shown here.

If any items are missing, please call 1-800-524-8697.

Keep these instructions for future reference as they contain important information.

TM + © 2009 Mattel, Inc. and/or Origin Product Ltd. All Rights Reserved.

ASSEMBLY

A-1

Assemble the 2 pieces of the base, as shown here.

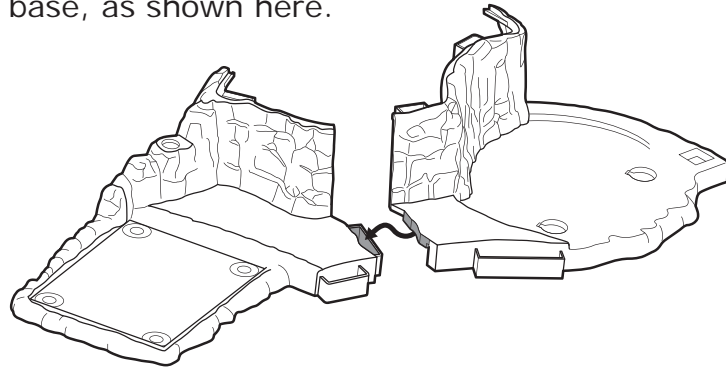

A-2

Build the center sections, as shown here. Add the support for the middle section.

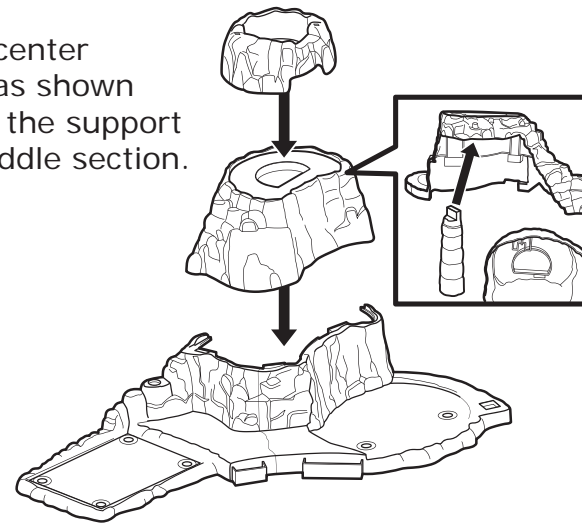

A-3

Follow the steps below to complete the center of the resort.

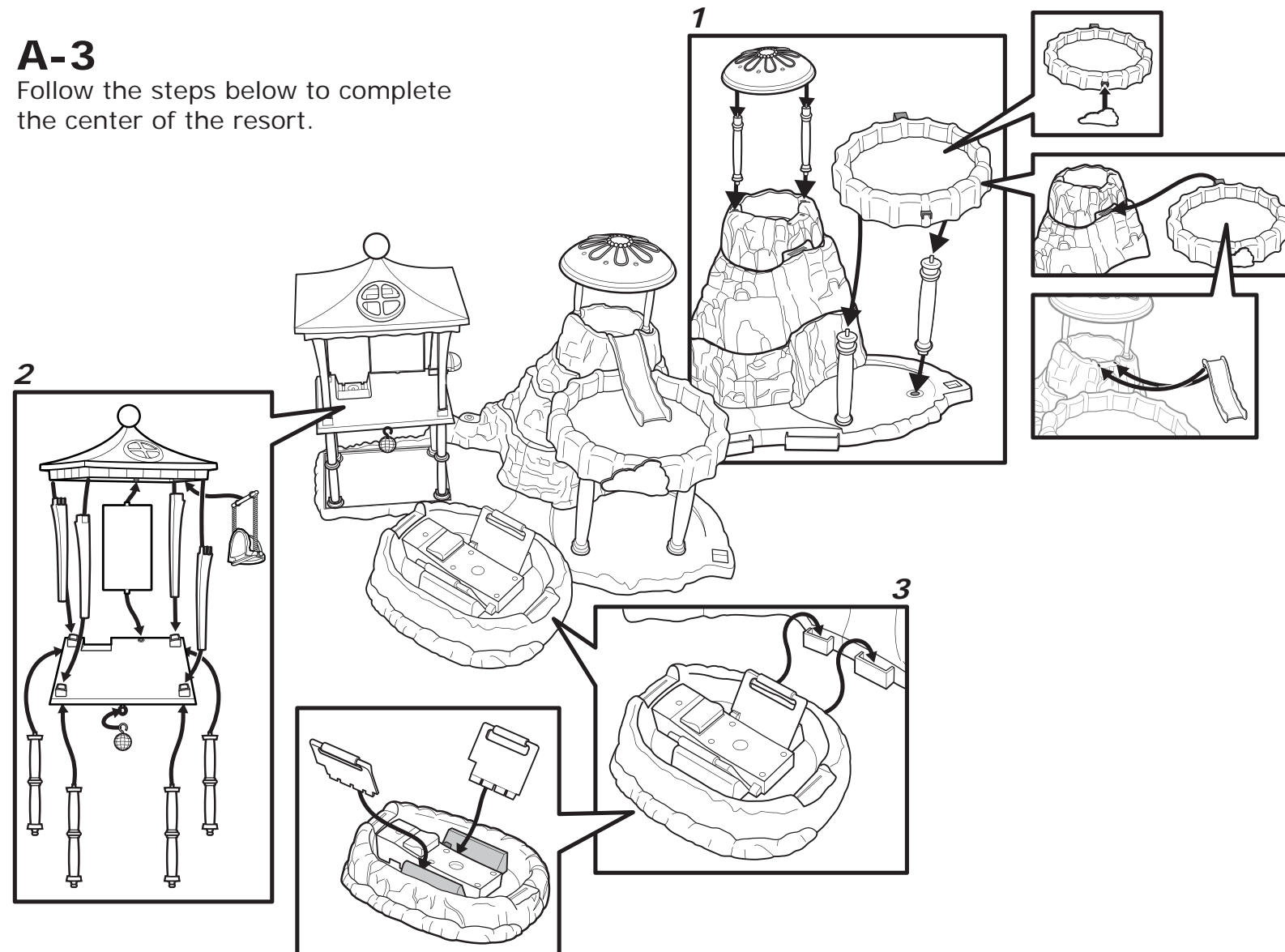

A-4

Assemble the escalator to the base. Add the tunnel to the escalator.

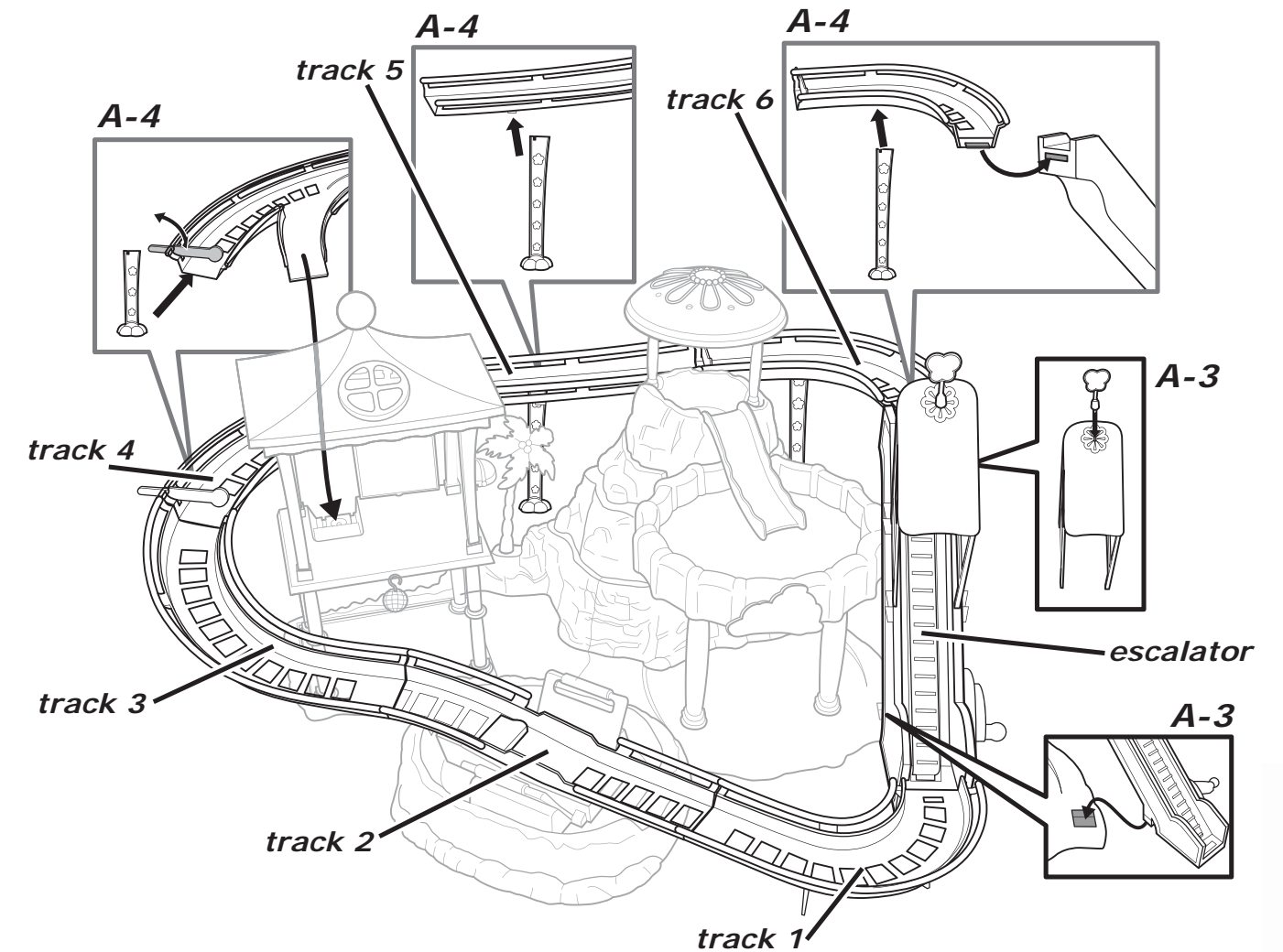

A-5

Assemble the 6 tracks in order as shown below. Tracks 4, 5, 6 each have a support leg.

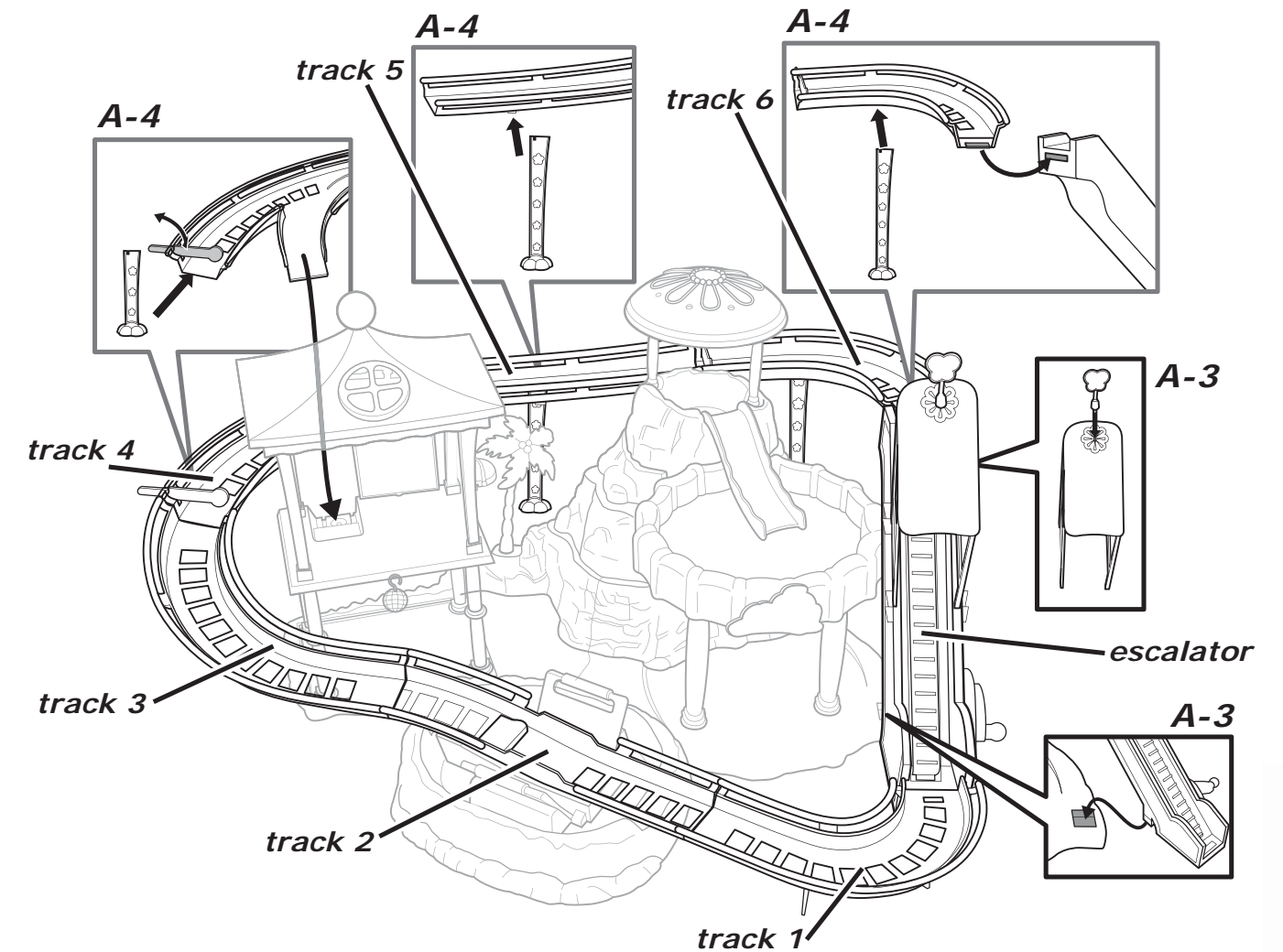

A-6

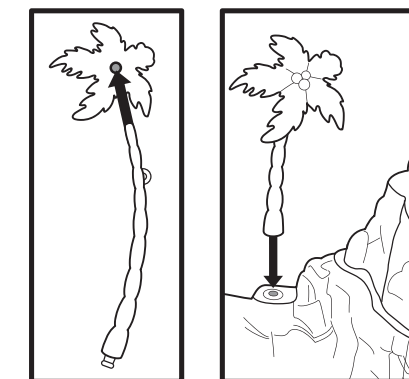

A-7

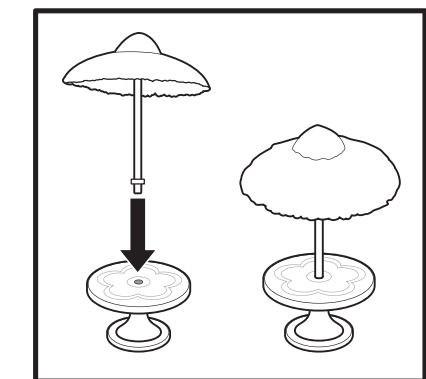

PLAY!

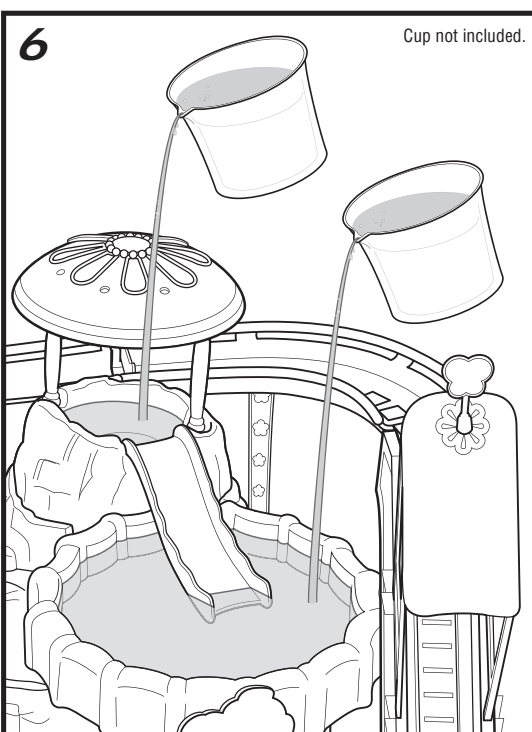
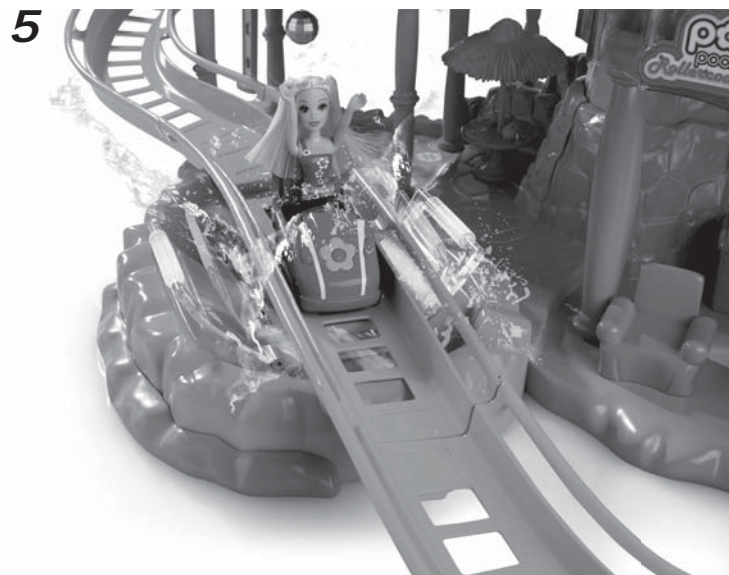
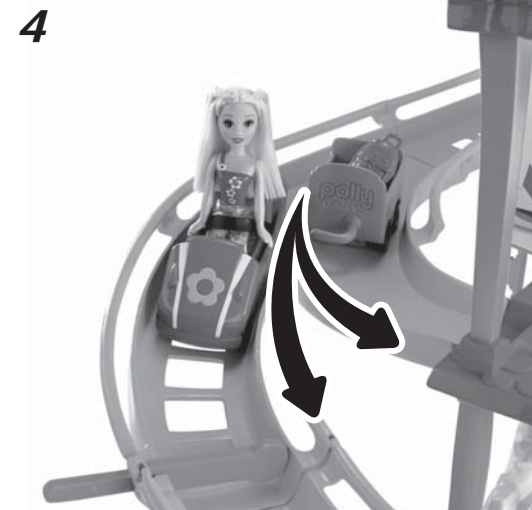
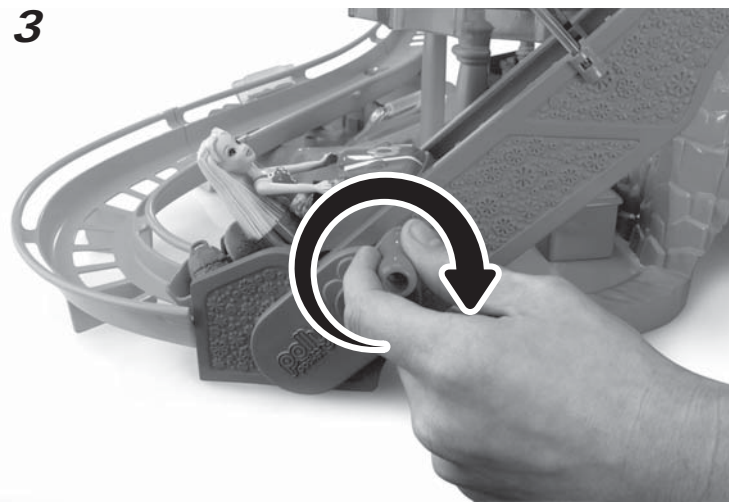
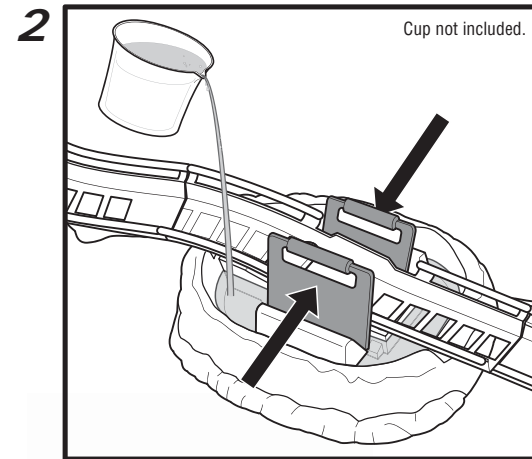
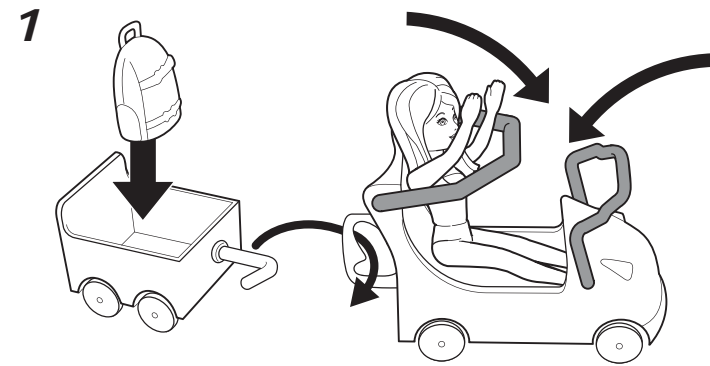

SET UP

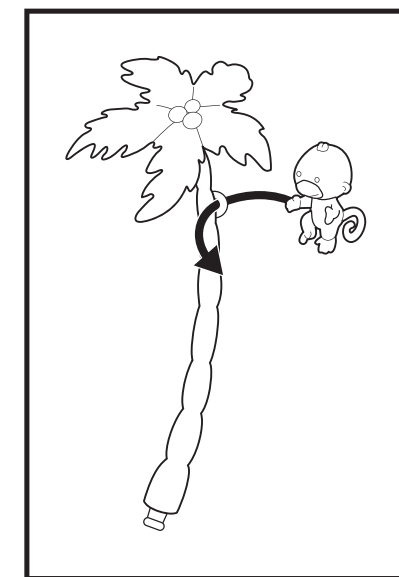
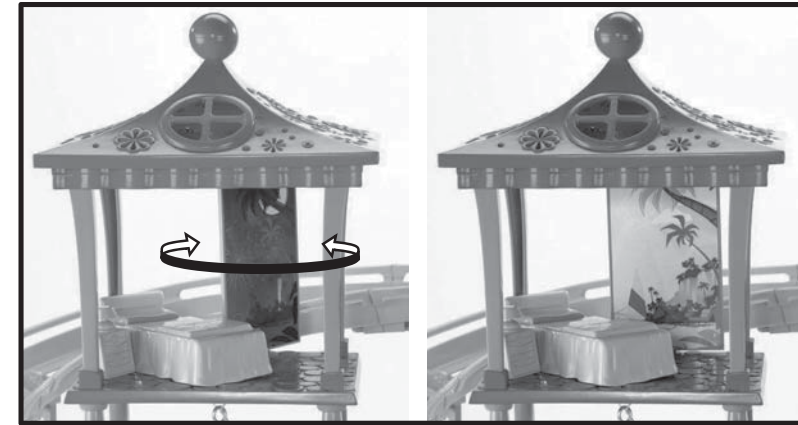

Water toys sometimes get messy, so please protect play surfaces before use. Drain/rinse/clean/dry all items thoroughly before storing. Overfilling of reservoir may cause leakage.