

MAKE HIM YOUR GUARD

When he's in Guard mode, Terrordactyl® will surprise unwanted visitors with a sticky strike!

Set-up: Push and hold his tail switch for 3 seconds. He will hiss to let you know he is ready.

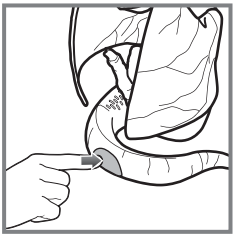

Actions: If he detects any movement in front of him, he will attack by snapping forward and shooting his gooey grub (if loaded). To reload his grub for another attack, pet his head to get him to open his mouth.

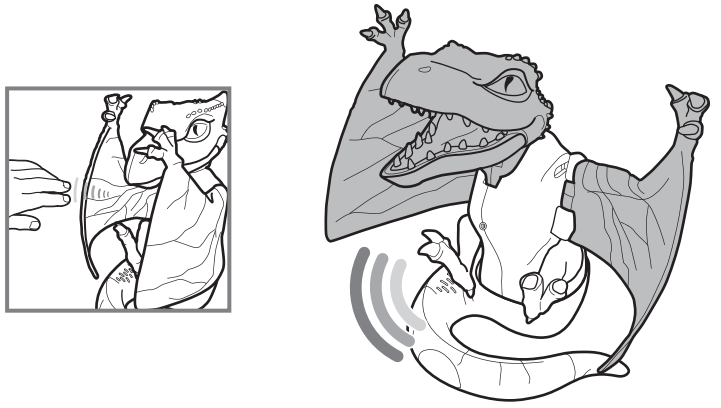

To Exit: Press the tail switch to take him out of Guard mode.

CARRY HIM ON YOUR ARM

Terrordactyl® will sit on your arm like a loyal pet so you can take him wherever you go!



BATTERY SAFETY INFORMATION

In exceptional circumstances batteries may leak fluids that can cause a chemical burn injury or ruin your product. To avoid battery leakage:

- Non-rechargeable batteries are not to be recharged.
- Rechargeable batteries are to be removed from the product before being charged (if designed to be removable).
- Rechargeable batteries are only to be charged under adult supervision (if designed to be removable).
- Do not mix alkaline, standard (carbon-zinc), or rechargeable (nickel-cadmium) batteries.
- Do not mix old and new batteries.
- Only batteries of the same or equivalent type as recommended are to be used.

- Batteries are to be inserted with the correct polarity.
- Exhausted batteries are to be removed from the product.
- The supply terminals are not to be short-circuited.
- Dispose of battery(ies) safely.
- Do not dispose of this product in a fire. The batteries inside may explode or leak.
- Do not connect to more than the recommended number of power supplies.

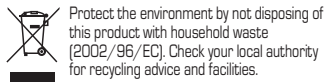

This device complies with Part 15 of the FCC Rules.

Operation is subject to the following two conditions: (1) This device may not cause harmful interference, and (2) this device must accept any interference received, including interference that may cause undesired operation.

- This equipment has been tested and found to comply with the limits for a Class B digital device, pursuant to part 15 of the FCC rules. These limits are designed to provide reasonable protection against harmful interference in a residential installation. This equipment generates, uses and can radiate radio frequency energy and, if not installed and used in accordance with the instructions, may cause harmful interference to radio communications. However, there is no guarantee that interference will not occur in a particular installation. If this equipment does cause harmful interference to radio or television reception, which can be determined by turning the equipment off and on, the user is encouraged to try to correct the interference by one or more of the following measures:
- Reorient or relocate the receiving antenna.
- Increase the separation between the equipment and receiver.
- Connect the equipment into an outlet on a circuit different from that to which the receiver is connected.
- Consult the dealer or an experienced radio/TV technician for help.

NOTE: Changes or modifications not expressly approved by the manufacturer responsible for compliance could void the user's authority to operate the equipment.

Mattel, Inc. All Rights Reserved.

Mattel, Inc. 636 Girard Avenue, East Aurora, NY 14052, U.S.A. Consumer Relations 1-800-524-8697. Mattel Canada Inc., Mississauga, Ontario L5R 3W2. You may call us free at 1-800-524-8697. Mattel U.K. Ltd., Vanwall Business Park, Maidenhead SL6 4UB. Helpline 01628 500303. Mattel Australia Pty., Ltd., Richmond, Victoria. 3121.Consumer Advisory Service - 1300 135 312 Mattel East Asia Ltd., Room 1106, South Tower, World Finance Centre, Harbour City, Tsimshatsui, HK, China. Diimport & Diedarkan Oleh: Mattel SEA Ptd Ltd.(993532-P) Lot 13.5, 13th Floor, Menara Lien Hoe, Persiaran Tropicana Golf Country Resort, 47410 PJ. Tel:03-78803817, Fax:03-78803867.

SERVICE.MATTEL.COM

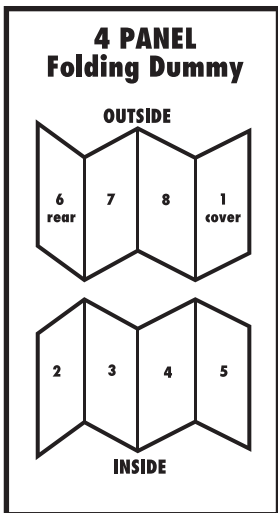
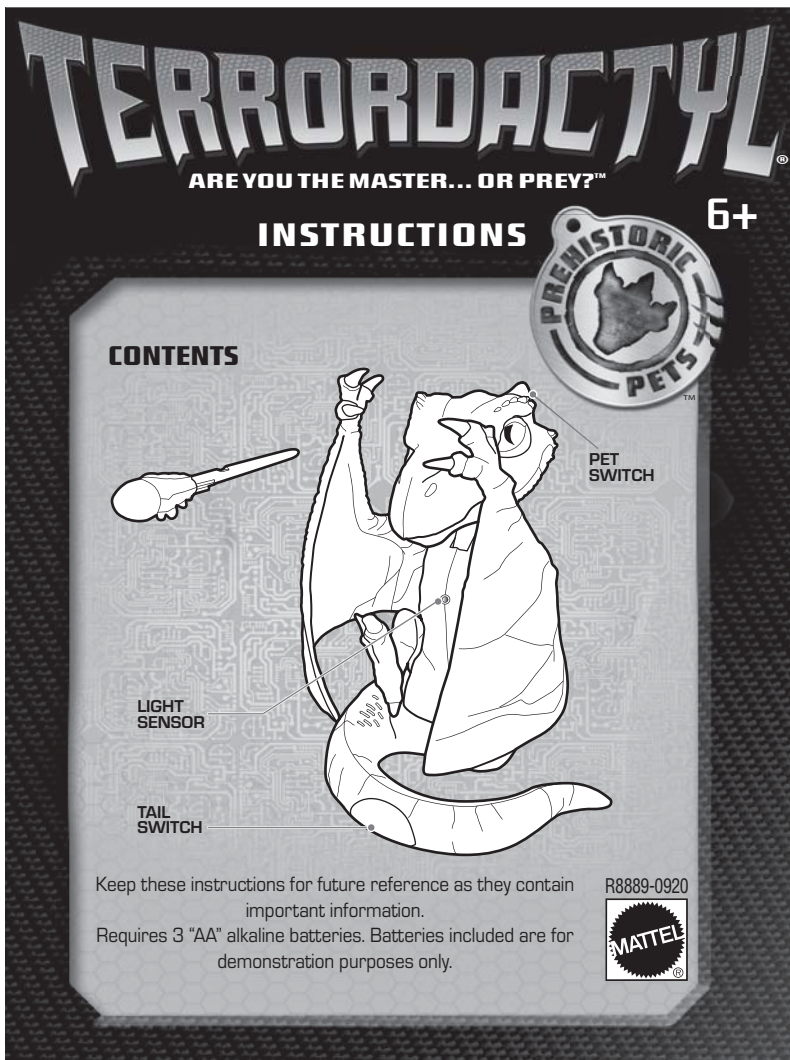

BATTERY INSTALLATION/REPLACEMENT

1. Open battery cover with a Phillips head screwdriver (not included). Remove batteries included for demonstration purposes and dispose of them safely.

2. Install 3 "AA" batteries in the orientation (+/-) shown. Replace battery cover and tighten screw.

Replace batteries when toy slows down, stalls, or sounds become distorted. For best performance, use only alkaline batteries.

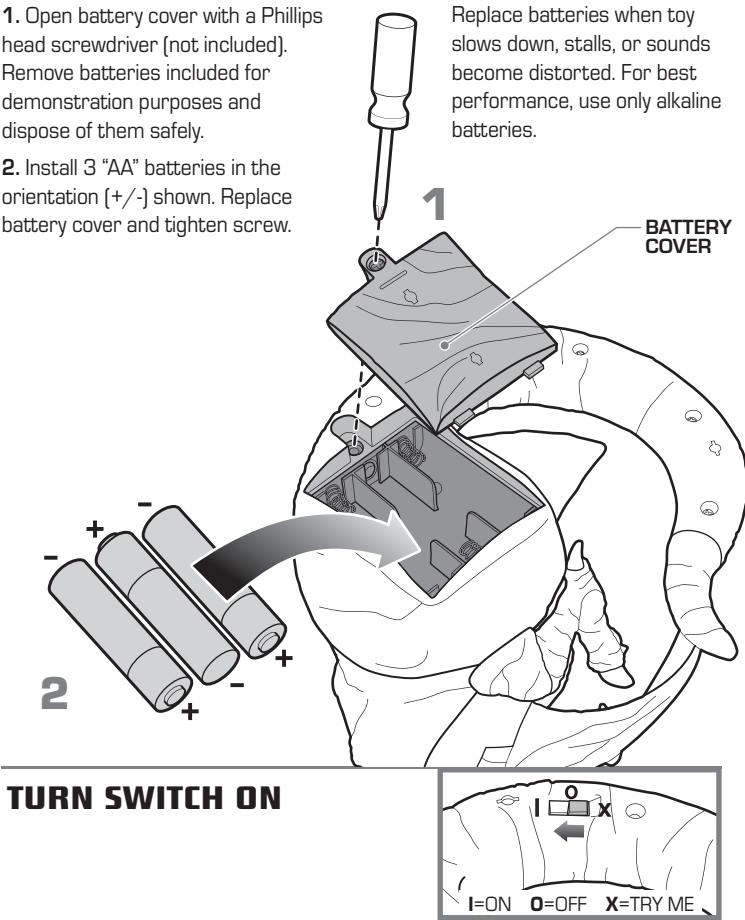

TO PLAY

PET HIM

Terrordactyl® loves being pet! If you press the back of his head or lift under his chin, he'll purr or chirp in appreciation. The more you pet him, the happier (and hungrier) he gets!



SURPRISE ATTACK

Press the switch on his tail one time and after growling, Terrordactyl® will sit back and wait to launch a surprise attack. The next person to pet him will become his prey!

GET SNAPPY

If you leave Terrordactyl on his own for a bit, he'll become one feisty predator! Once he takes a deep breath, he'll start snapping at anyone who approaches him from the front. And if he's eating when someone comes by, he'll growl.



FEED HIM

When Terrordactyl® is hungry, he'll open his mouth and beg for food. If you want a happy dino on your hands, hold onto his head, insert his grub, and press it in until it locks. He will then chomp and chew on his food.

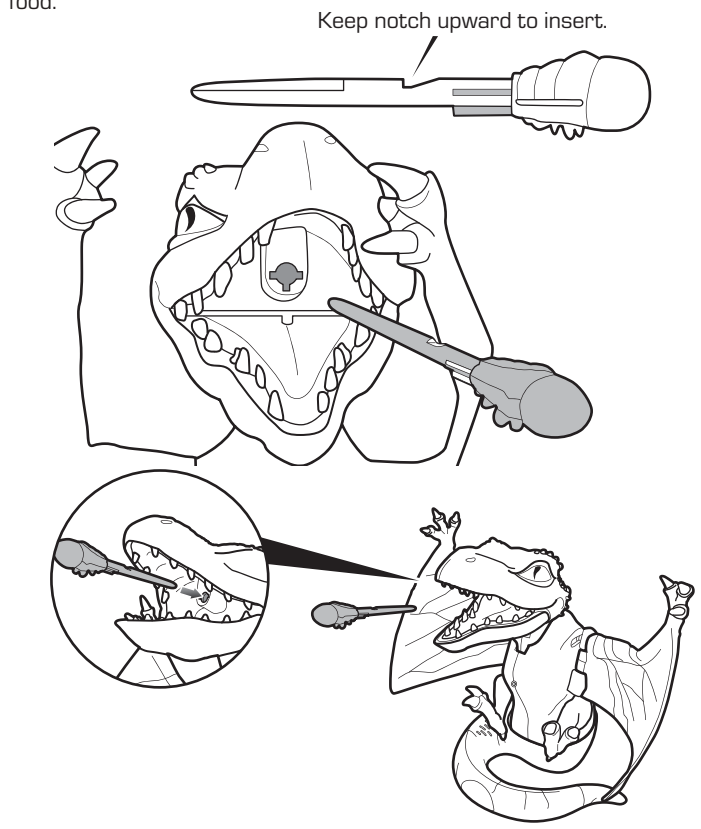

THROW A SPIT FIT

Terrordactyl® will spit his grub out if:

- you press his tail switch twice.
- you push his torso all the way forward.
- he senses someone while in Guard mode.
- he is petted while in Surprise Attack mode.

If Terrordactyl's facing you when he's ready to spit, you'd better split!



Do not aim at eyes or face. Only use projectiles supplied with this toy. Do not fire at point blank range.

CLEAN HIS GRUB

If his grub gets dirty, clean it with water to restore its sticking power.