

Battery replacement:

Batteries included are for demonstration purposes only. Toy requires 3 "AAA/LR03" alkaline batteries. Use a Phillips head screwdriver (not included) to open battery door. Remove and set aside. Insert 3 fresh "AAA/LR03" alkaline batteries. Replace battery cover and screw shut.

ATTENTION: Non-alkaline batteries may not power this toy. Replace with alkaline batteries for longest life and best performance. Replace batteries when sounds become garbled or the screen becomes faint.

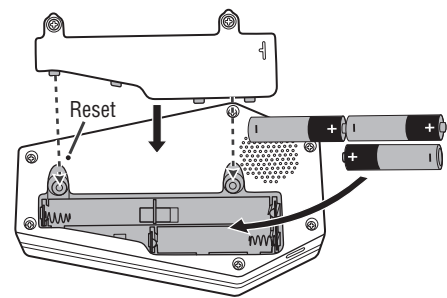

BATTERY SAFETY INFORMATION

In exceptional circumstances batteries may leak fluids that can cause a chemical burn injury or ruin your product. To avoid battery leakage:

- Non-rechargeable batteries are not to be recharged.
- Rechargeable batteries are to be removed from the product before being charged (if designed to be removable).
- Rechargeable batteries are only to be charged under adult supervision (if designed to be removable).
- Do not mix alkaline, standard (carbon-zinc), or rechargeable (nickel-cadmium) batteries.

- Do not mix old and new batteries.
- Only batteries of the same or equivalent type as recommended are to be used.
- Batteries are to be inserted with the correct polarity.
- Exhausted batteries are to be removed from the product.
- The supply terminals are not to be short-circuited.
- Dispose of battery(ies) safely.
- Do not dispose of this product in a fire. The batteries inside may explode or leak.

This device complies with Part 15 of the FCC Rules.

Operation is subject to the following two conditions:
(1) This device may not cause harmful interference, and (2) this device must accept any interference received, including interference that may cause undesired operation.

• This equipment has been tested and found to comply with the limits for a Class B digital device, pursuant to part 15 of the FCC rules. These limits are designed to provide reasonable protection against harmful interference in a residential installation. This equipment generates, uses and can radiate radio frequency energy and, if not installed and used in accordance with the instructions, may cause harmful interference to radio communications. However, there is no guarantee that interference will not occur in a particular installation. If this equipment does cause harmful interference to radio or television reception, which can be determined by turning the equipment off and on, the user is encouraged to try to correct the interference by one or more of the following measures:

- Reorient or relocate the receiving antenna.
 - Increase the separation between the equipment and receiver.
 - Connect the equipment into an outlet on a circuit different from that to which the receiver is connected.
 - Consult the dealer or an experienced radio/TV technician for help.
- NOTE: Changes or modifications not expressly approved by the manufacturer responsible for compliance could void the user's authority to operate the equipment.**



Protect the environment by not disposing of this product with household waste [2002/96/EC]. Check your local authority for recycling advice and facilities.

CONSUMER INFORMATION

Need Assistance? Visit service.mattel.com or call 1-800-524-8697 (US and Canada only).

SERVICE.MATTEL.COM

Mattel, Inc. 636 Girard Avenue, East Aurora, NY 14052, U.S.A.
Consumer Relations 1-800-524-8697.
Mattel U.K. Ltd., Vanwall Business Park, Maidenhead, SL6 4UB. Helpline 01628 500303.
Mattel Australia Pty. Ltd., Richmond, Victoria. 3121.Consumer Advisory Service - 1300 135 312.
Mattel East Asia Ltd., Room 1106, South Tower, World Finance Centre, Harbour City, Tsimshatsui, HK, China.
Diimport & Diedarkan Oleh: Mattel SEA Ptd Ltd.(993532-P) Lot 13.5, 13th Floor, Menara Lien Hoe, Persiaran Tropicana Golf Country Resort, 47410 PJ. Tel:03-78803817, Fax:03-78803867.



iCoffin™
INSTRUCTIONS

CONTENTS

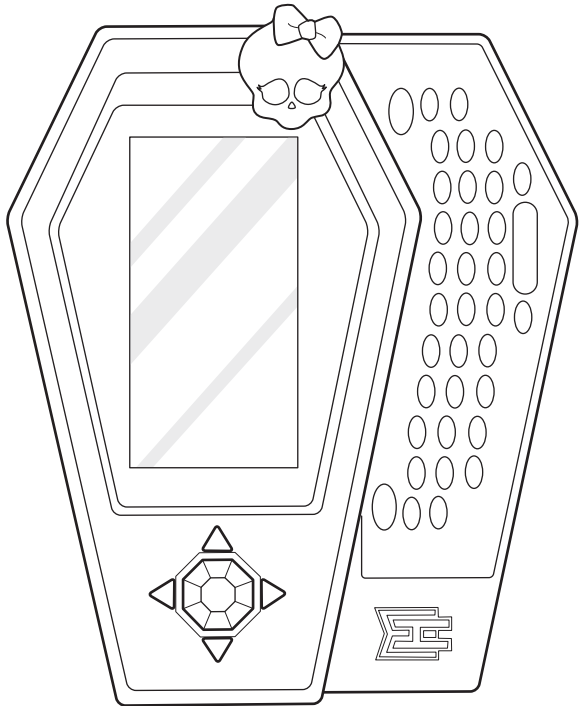

Batteries included are for demonstration purposes only. For longer life, replace with 3 fresh "AAA/LR03" alkaline batteries.

Please remove everything from the package and compare to the contents shown here. If any items are missing, please contact your local Mattel office.
Keep these instructions for future reference as they contain important information.



© 2010 Mattel, Inc., All Rights Reserved.

INSTRUCTIONS SHEET
SPECIFICATIONS

Toy:	B & B
Toy No.:	T1403
Part No.:	0920
Trim Size:	11 " W x 8.5 " H
Folded Size:	5.5 " W x 8.5 " H
Type of Fold:	2 panel
# colors:	One
Colors:	Black
Paper Stock:	White Offset
Paper Weight:	70 lb.
EDM No.:	

2 PANEL
Folding Dummy

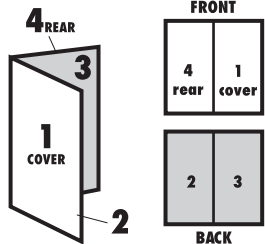

4 Rear

1 Cover

iCoffin™! The coolest new gadget at Monster High™!

Packed with games galore, hidden activities and secret webcodes, the iCoffin™ is simply the Monster High™ gadget to die for. Now you can join in the fun and pass each class as any one of your 6 favorite Monster High™ characters. So get ready to experience the horrors of high school – the frighteningly fashionable way!

How to exit TRY-ME mode

After removing the packaging, close the iCoffin™ for 3 seconds and it will exit TRY-ME mode. Slide open the iCoffin™ again to enter normal play mode.

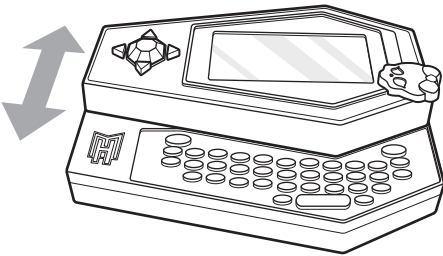

Create a freaky nickname and password

To start the game, the first thing you need to do is follow the screen prompts to set a user name and password – so no one alive can touch your iCoffin™! If the iCoffin™ is left idle for 2 minutes, it will switch off to save battery. Press the Center Button and use your password to continue playing.

What do all the buttons do?

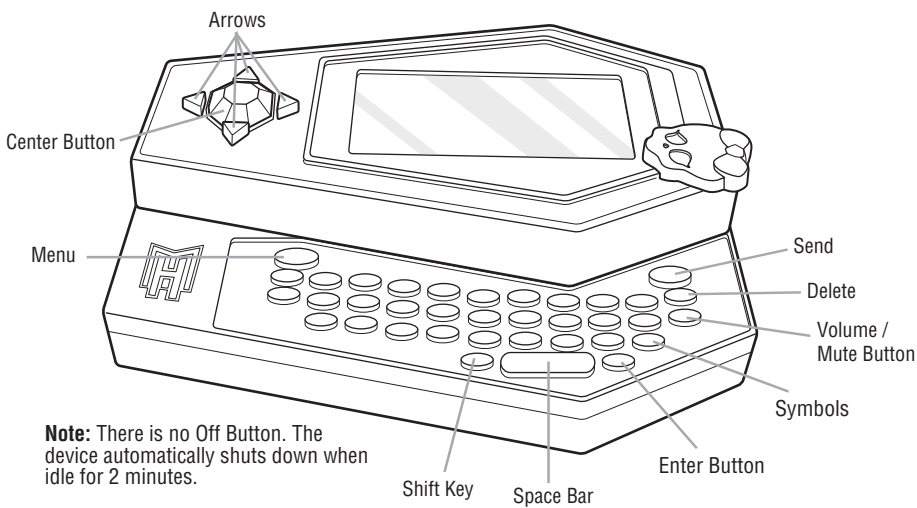

Arrows – Use them to move the character on the screen, scroll through menu items and make selections.

Center Button – Press to switch on the device, make the character perform actions and confirm your selection on the screen.

Menu – Press to return to the Main Menu at any time.

Send – Press to send message.

Shift Key – To type numbers and symbols on the right side of each key, press and hold this key before typing.

Symbols – Press to access emoticons and symbols in Text mode.

Select a character and check out the Main Menu



TEXT Got some screaming hot gossip or just something on your mind? Text the Monster High™ gang and you just might hear back.



WEB The last 4 webcodes unearthed while playing the game are stored here.



CLASS Science, Home Ick, History and more, just some of the classes you'll have to pass if you're going to avoid detention at Monster High™. But don't worry; it's all fun and games! What's more, you'll unlock new Apps with every class you pass and each character's class schedule is different. So remember to try them all!



MAP Wander the hallways of Monster High™ and explore if you dare. Remember to check out the Maul and the Arcade; you'll never know what you might find there.



APPS Have a fangtastic time with these monster applications and unlock more of them by making the grade in class.



SETUP Lets you change your password, choose ringtones, adjust contrast and return the device to factory settings.



BACK Select this icon to go to the previous screen.

Class & Other Games Include:

- Casketball/Fearleading/Swimming
- Food Fight/Picky Eater
- Potions 101/Genetics 101
- Brinecake Flipper/Stitching 101
- Letter Beat/Skeleton Choir
- Passing Notes/Graveyard Dig
- Pet Assembly Line/Claw Crane
- Locker Slam/Locker Luck 1 & 2
- Maul Maze Chase

Apps Include:

- Text Master
- Monster Future
- Create your own Ragdoll
- BFF Matcher
- Hangman
- Whack-a-skeleton
- Freaky Funny Stories
- Message Decoder
- Fortune Skull
- Coffin Cam

Dig up webcodes for more monster fun online!

Hidden throughout Monster High™ are special activities that unlock hidden webcodes. You never know where they'll be lurking, so be sure to play everything! Logon to monsterhigh.com and see what surprises await.

Troubleshooting

Can't get into class?

Look for the blinking classroom sign and press the **Center** button; or press the **Menu** button, select the CLASS icon, and find out which class is on your schedule.

Lost in the hallway, or anywhere else?

Press the **Menu** button at any time to go directly back to the main menu.

Want to select a new Monster High™ character?

Press the **Menu** button, scroll down to the BACK icon, and select it with the **Center** button.

Forgot your password?

If you forget your password, you can create a new one by resetting the device. Ask an adult to insert a metal tip, such as a bent paper clip, into the Reset button hole found on the back of the device. No game data will be lost upon reset. However if you change batteries, all data will be lost.

Malfunction

When exposed to an electrostatic source, the device may malfunction and suffer memory loss. Please remove the batteries and install them again to start a fresh game.