



Toddler



Preschooler

Please keep this instruction sheet for future reference, as it contains important information.

Requires two "AA" (LR6) **alkaline** batteries (not included) for operation.

Adult assembly is required.

Tool required for assembly:
Phillips screwdriver (not included).

Doll not included and sold separately.

Consumer Information



CONSUMER ASSISTANCE

1-800-432-5437 (US & Canada)
1300 135 312 (Australia)

 **service.fisher-price.com**

Fisher-Price, Inc., 636 Girard Avenue, East Aurora, NY 14052.
Hearing-impaired consumers: 1-800-382-7470.

Outside the United States:

Canada: Mattel Canada Inc., 6155 Freemont Blvd.,
Mississauga, Ontario L5R 3W2; www.service.mattel.com.

Great Britain: Mattel UK Ltd, Vanwall Business Park,
Maidenhead SL6 4UB. Helpline: 01628 500303.
www.service.mattel.com/uk

Mattel Europa, B.V., Gondel 1, 1186 MJ Amstelveen, Nederland.

Australia: Mattel Australia Pty. Ltd., 658 Church Street,
Locked Bag #870, Richmond, Victoria 3121 Australia.

New Zealand: 16-18 William Pickering Drive,
Albany 1331, Auckland.

Care

- Wipe this toy with a clean cloth dampened with a mild soap and water solution. Do not immerse this toy.
- This toy has no consumer serviceable parts. Do not take this toy apart.

FCC Statement (United States Only)

This equipment has been tested and found to comply with the limits for a Class B digital device, pursuant to Part 15 of the FCC Rules. These limits are designed to provide reasonable protection against harmful interference in a residential installation. This equipment generates, uses and can radiate radio frequency energy and, if not installed and used in accordance with the instructions, may cause harmful interference to radio communications. However, there is no guarantee that interference will not occur in a particular installation. If this equipment does cause harmful interference to radio or television reception, which can be determined by turning the equipment off and on, the user is encouraged to try to correct the interference by one or more of the following measures:

- Reorient or relocate the receiving antenna.
- Increase the separation between the equipment and receiver.
- Consult the dealer or an experienced radio/TV technician for help.

Note: Changes or modifications not expressly approved by the manufacturer responsible for compliance could void the user's authority to operate the equipment.

This device complies with Part 15 of the FCC Rules. Operation is subject to the following two conditions: (1) this device may not cause harmful interference and (2) this device must accept any interference received, including interference that may cause undesired operation.

ICES-003

This Class B digital apparatus complies with Canadian ICES-003. Operation is subject to the following two conditions: (1) this device may not cause harmful interference and (2) this device must accept any interference received, including interference that may cause undesired operation.

NMB-003

Cet appareil numérique de la classe B est conforme à la norme NMB-003 du Canada. L'utilisation de ce dispositif est autorisée seulement aux conditions suivantes: (1) il ne doit pas produire de brouillage et (2) l'utilisateur du dispositif doit être prêt à accepter tout brouillage radioélectrique reçu, même si ce brouillage est susceptible de compromettre le fonctionnement du dispositif.

Assembled Parts

⚠ CAUTION

This product contains small parts in its unassembled state. Adult assembly is required. Take extra care during unpacking and assembly.



Kitchen



Shelf



Faucet



Sink

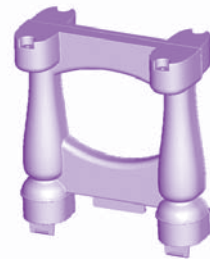

Shelf Support

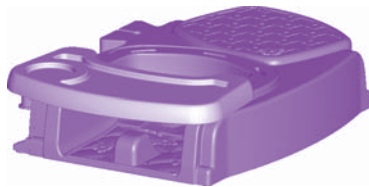

Doll Seat



Seat Back



#6 x 5/8" (1,6 cm) Screw - 9

Shown Actual Size

Note: Tighten and loosen all screws with a Phillips screwdriver. Do not over-tighten.

Assembly

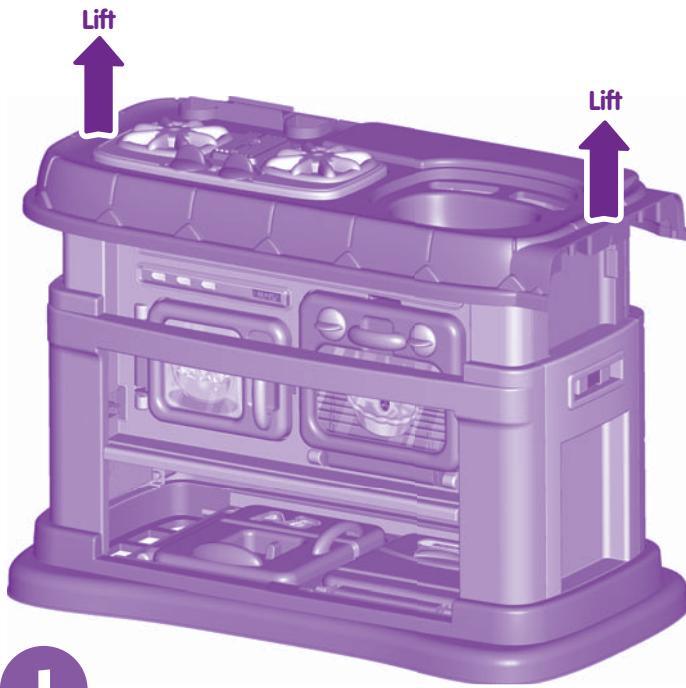

1

- Place your feet on the base of the kitchen and lift the counter top until it **"snaps"** in place.

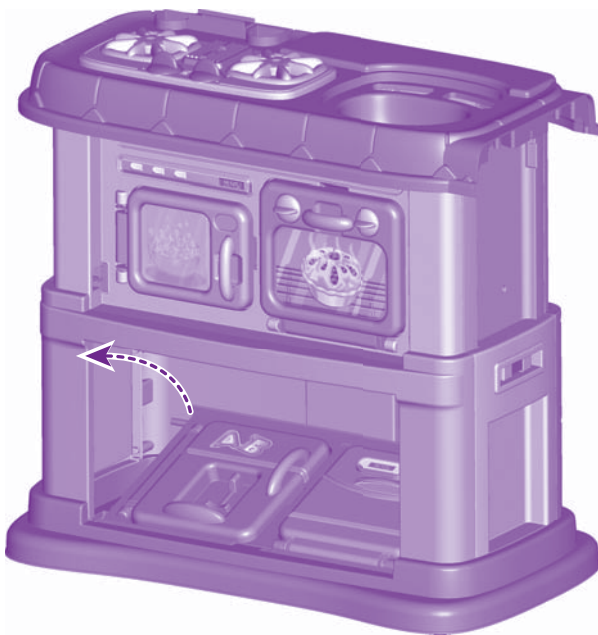

2

- Lift the refrigerator panel inside the lower part of the kitchen.
- Pull the refrigerator panel forward until it **"snaps"** in place.

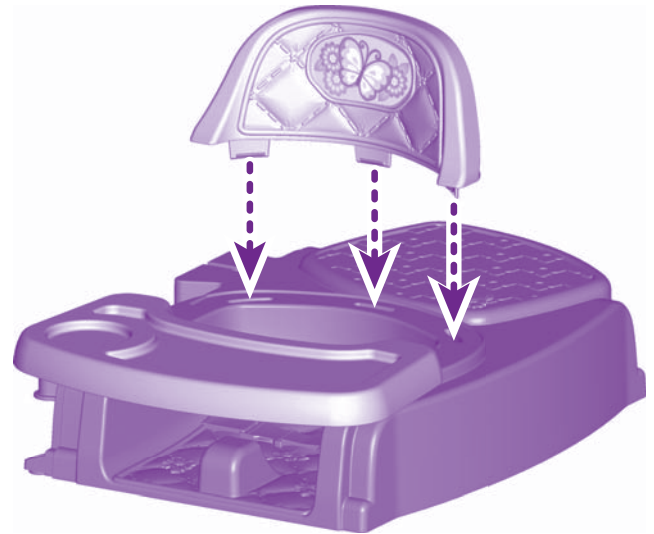

3

- Insert the tabs on the bottom of the seat back into the slots on the doll seat.
- Push to **"snap"** in place.



4

- Set the kitchen on its side. Fit the seat assembly to the underside of counter top.

Assembly

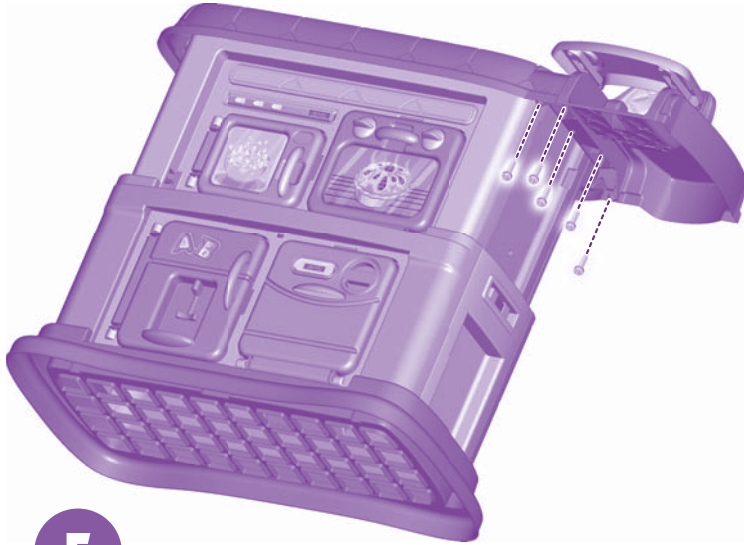

5

- Insert five screws into the seat assembly and tighten.
- Turn the kitchen upright.



7

- Fit the shelf onto the shelf support.
- Insert four screws into the shelf and tighten.

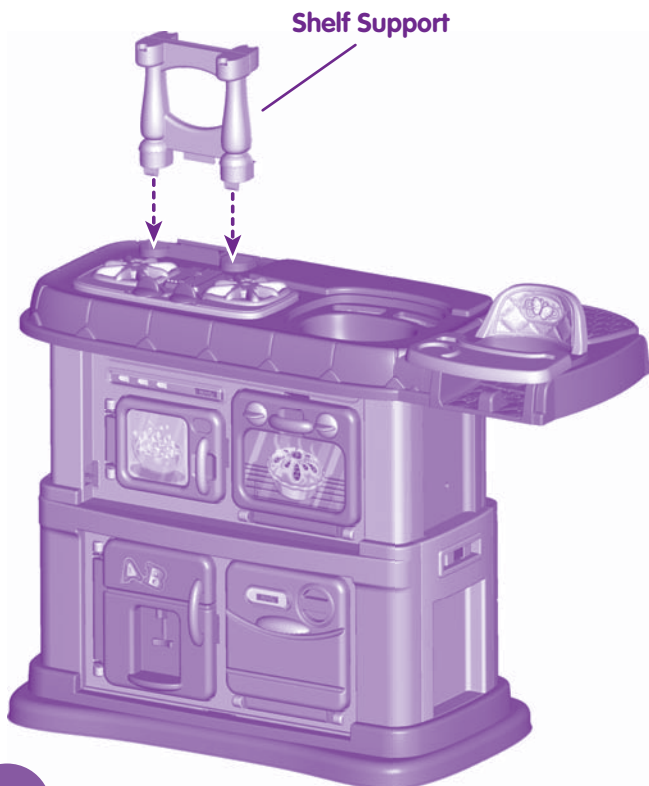

6

- **"Snap"** the shelf support into the counter top, as shown.
- Hint:** This may require some force.



8

- **"Snap"** the faucet into the sink.

Assembly

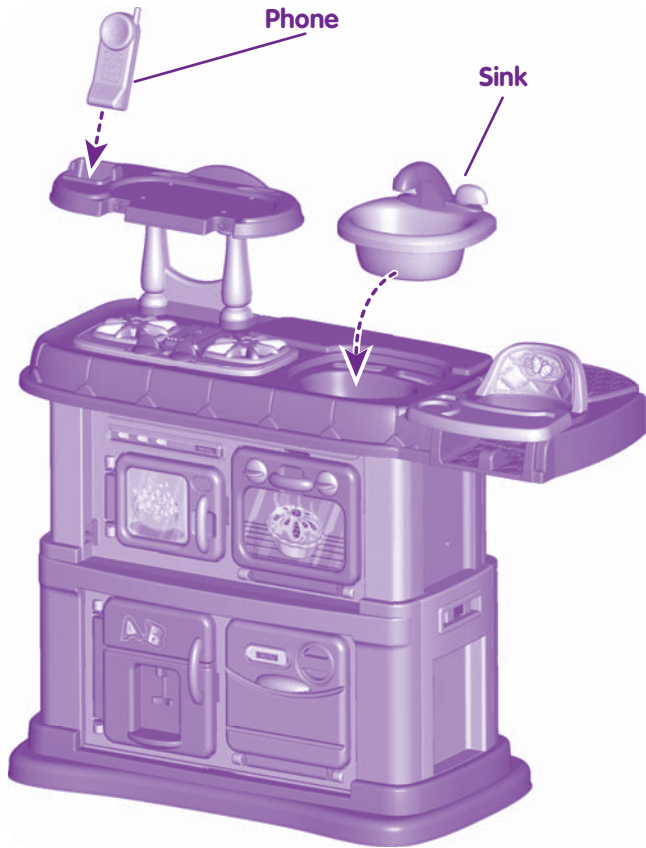

9

- Place the sink and phone into the kitchen, as shown.

Battery Installation

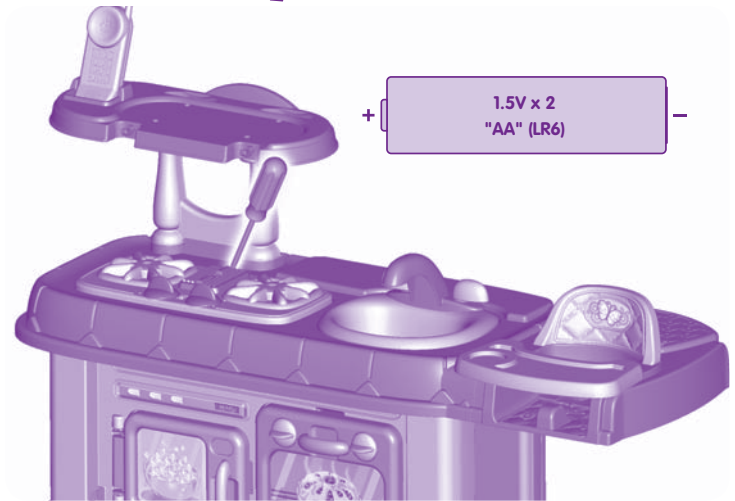

- Locate the battery compartment on the counter top.
- Loosen the screw in the battery compartment door with a Phillips screwdriver. Remove the battery compartment door.
- Insert two "AA" (LR6) **alkaline** batteries.

Hint: We recommend using **alkaline** batteries for longer battery life.

- Replace the battery compartment door and tighten the screw.
- If this product begins to operate erratically, you may need to reset the electronics. Slide the power/volume switch off and then back on.
- When sounds become faint or stop, it's time for an adult to change the batteries!



- Protect the environment by not disposing of this product with household waste (2002/96/EC). Check your local authority for recycling advice and facilities (Europe only).

Battery Safety Information

In exceptional circumstances, batteries may leak fluids that can cause a chemical burn injury or ruin your product. To avoid battery leakage:

- Do not mix old and new batteries or batteries of different types: alkaline, standard (carbon-zinc) or rechargeable (nickel-cadmium).
- Insert batteries as indicated inside the battery compartment.
- Remove batteries during long periods of non-use. Always remove exhausted batteries from the toy. Dispose of batteries safely. Do not dispose of this product in a fire. The batteries inside may explode or leak.
- Never short-circuit the battery terminals.
- Use only batteries of the same or equivalent type, as recommended.
- Do not charge non-rechargeable batteries.
- Remove rechargeable batteries from the product before charging.
- If removable, rechargeable batteries are used, they are only to be charged under adult supervision.

Convert from Toddler Height to Preschooler Height

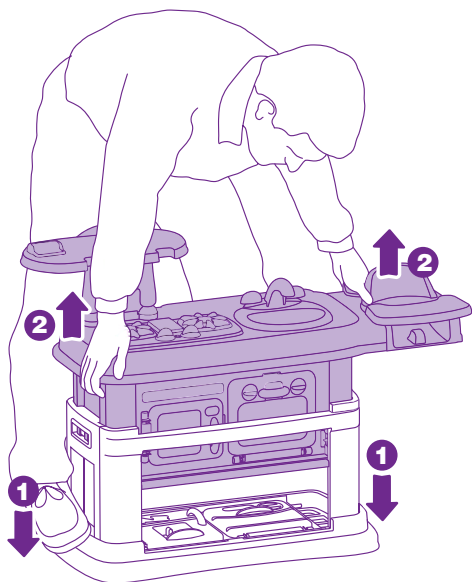

- Place your feet on the base of the kitchen **1** and lift the counter top until it “snaps” in place **2**.

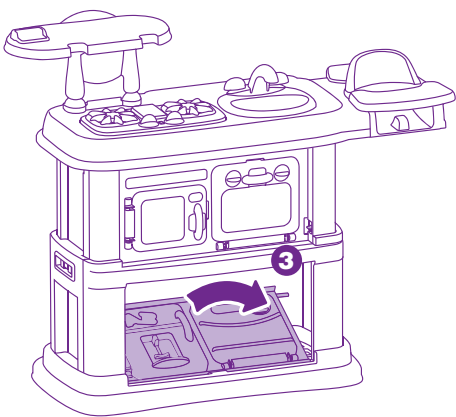

- Lift the refrigerator panel inside the lower part of the kitchen. Pull the refrigerator panel forward until it “snaps” in place **3**.

Convert from Preschooler Height to Toddler Height

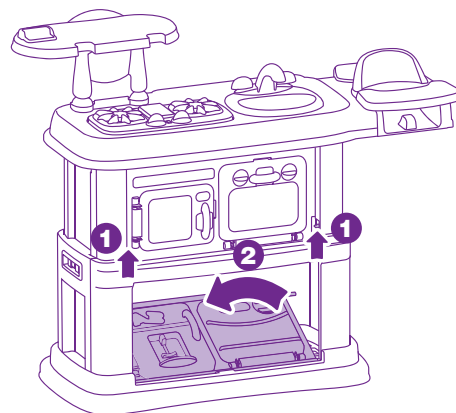

- Lift the two levers near the microwave and oven **1**.
- Push to lower the refrigerator panel **2**.

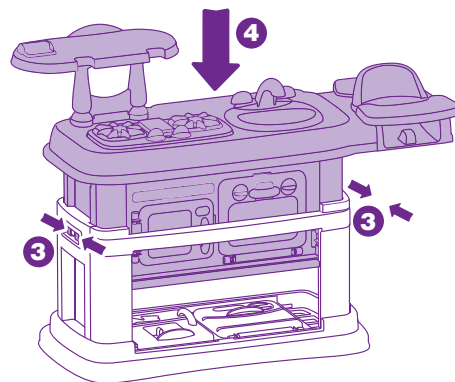



- Squeeze the levers on each side of the kitchen **3**.
- Push the counter top down **4**.

Lots of Fun Kitchen Activities

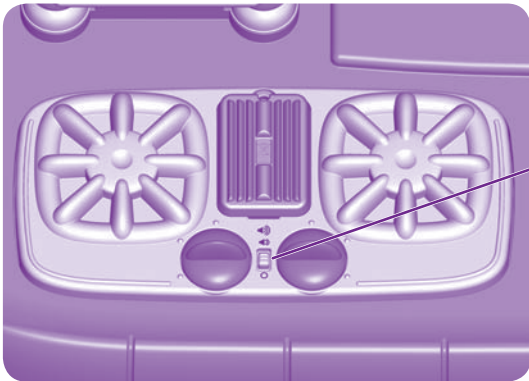
Before use, thoroughly wash all parts that may contact food.



Power/Volume Switch

Slide the power/volume switch to ON with low volume  or ON with high volume . When you are finished playing with this toy, slide the power/volume switch OFF O.



Turn the stove knobs for realistic cooking sounds.