

## RESET FIGURE

If figure detaches, please reattach as shown.

1.

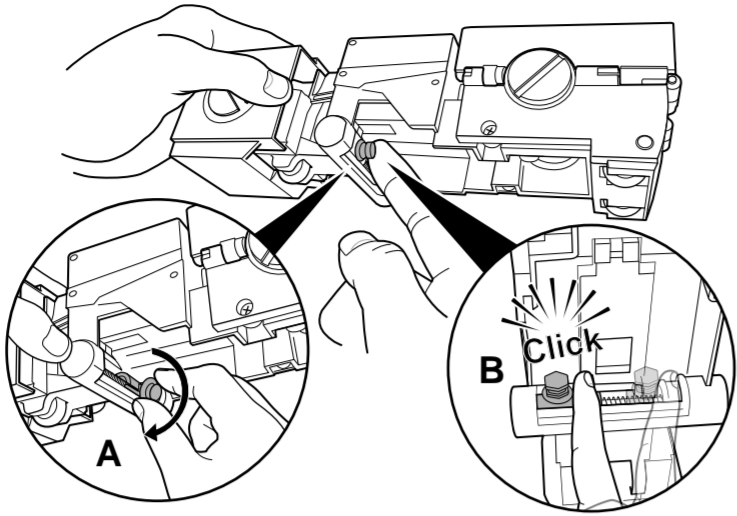

2.

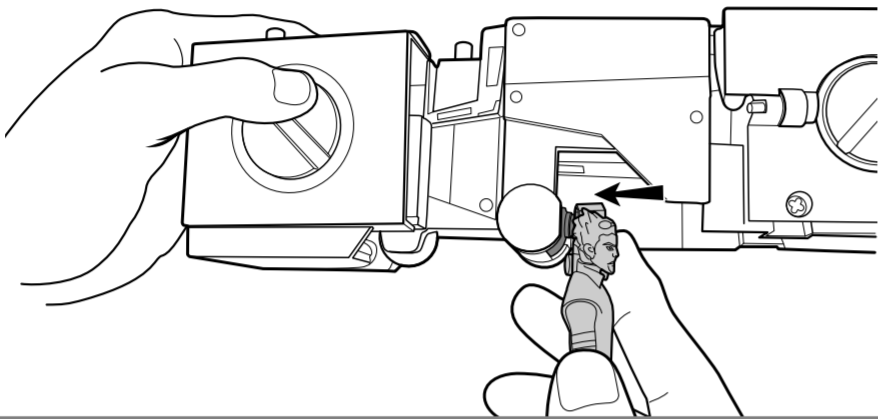

© 2010 Mattel, Inc. All Rights Reserved.

Mattel, Inc., 636 Girard Avenue, East Aurora, NY 14052, U.S.A. Consumer Relations 1-800-524-8697. Mattel U.K. Ltd., Vanwall Business Park, Maidenhead SL6 4UB. Helpline 01628 500303. Mattel Australia Pty., Ltd., Richmond, Victoria. 3121. Consumer Advisory Service - 1300 135 312. Mattel East Asia Ltd., Room 1106, South Tower, World Finance Centre, Harbour City, Tsimshatsui, HK, China. Diimport & Diedarkan Oleh: Mattel SEA Ptd Ltd. (993532-P) Lot 13.5, 13th Floor, Menara Lien Hoe, Persiaran Tropicana Golf Country Resort, 47410 PJ. Tel: 03-78803817, Fax: 03-78803867.



CARTOON NETWORK, GENERATOR REX, the logos and all characters and elements are trademarks of and © 2010 Cartoon Network.

SERVICE.MATTEL.COM

T6079-0920  
Asst. T6079



4+

## TRANSFORMING REX RIDE

### INSTRUCTIONS

Please keep these instructions for future reference as they contain important information.

### CONTENTS

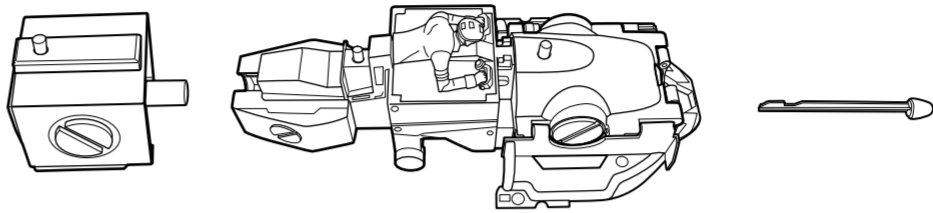

### TO PLAY AS SLAM CANNON

1.

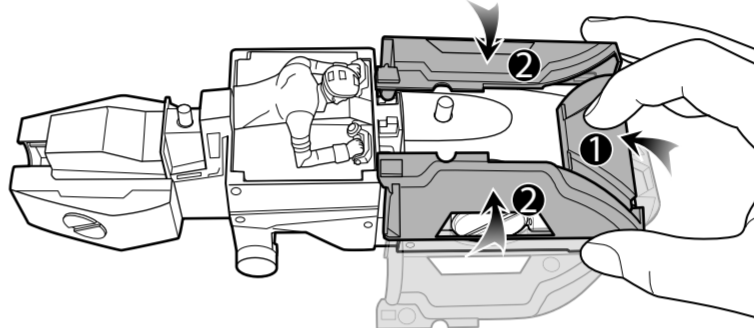

2.

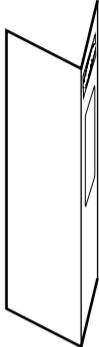
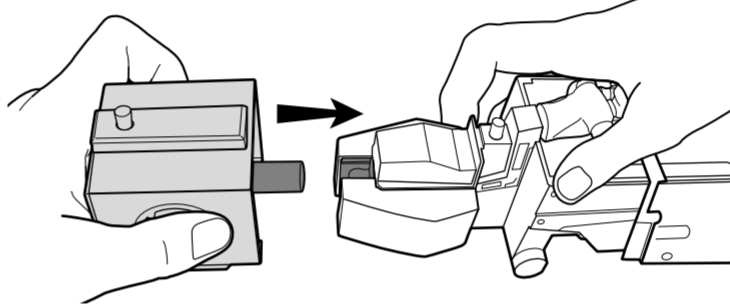

3.

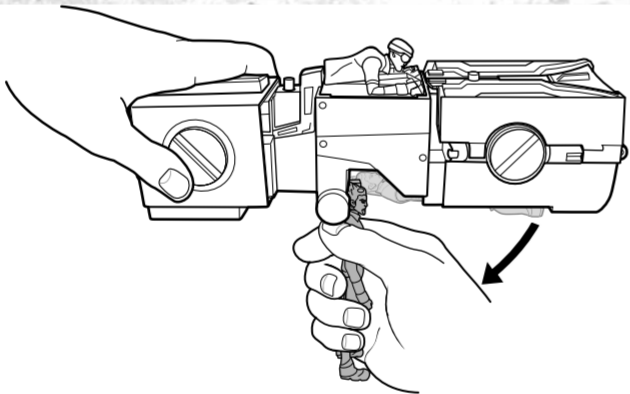

4.

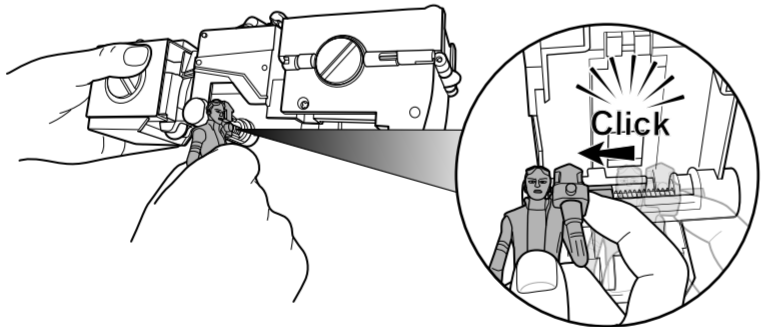

5.

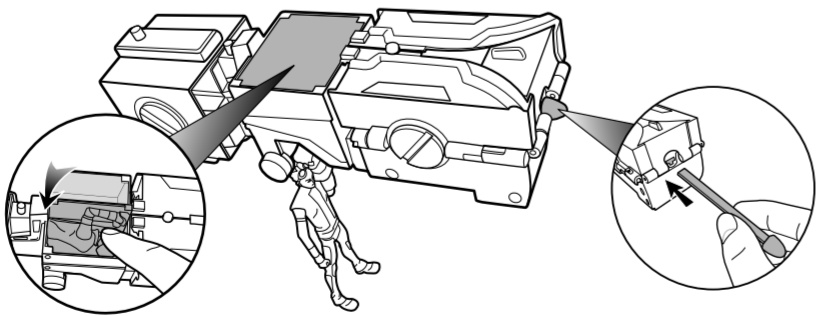

6.

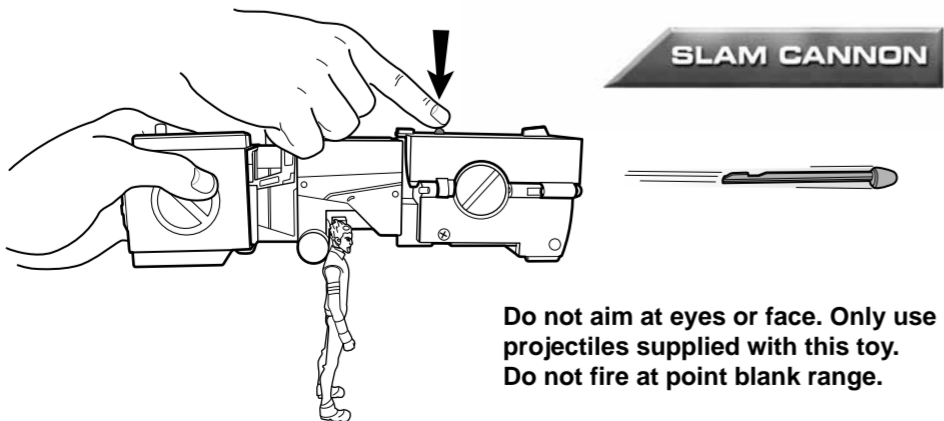

Do not aim at eyes or face. Only use projectiles supplied with this toy. Do not fire at point blank range.

### TO PLAY AS REX RIDE

1.

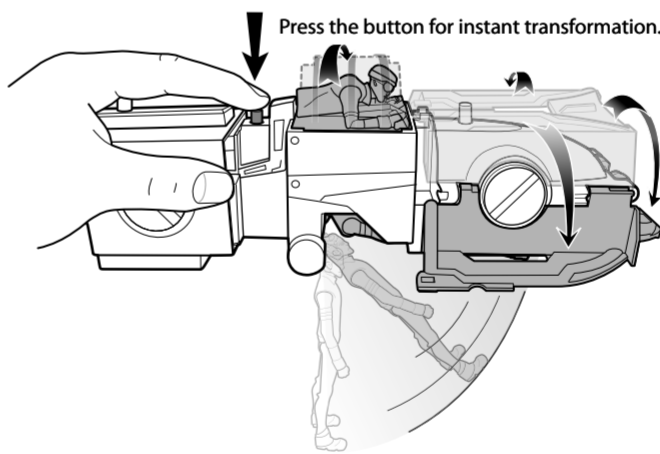

2.

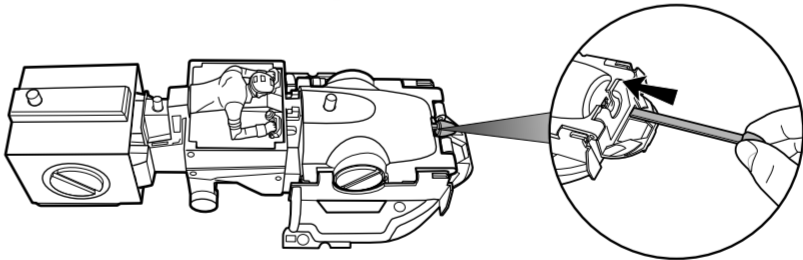

3.

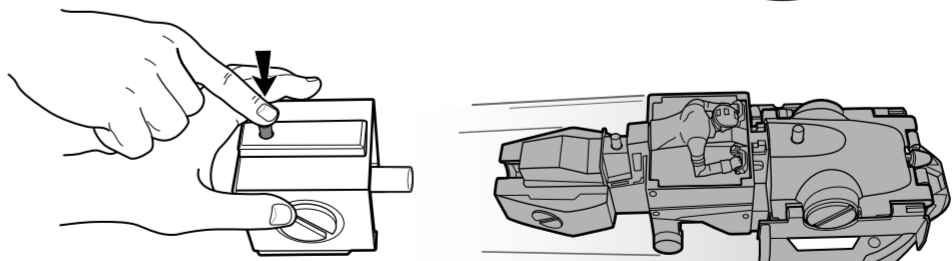

4.

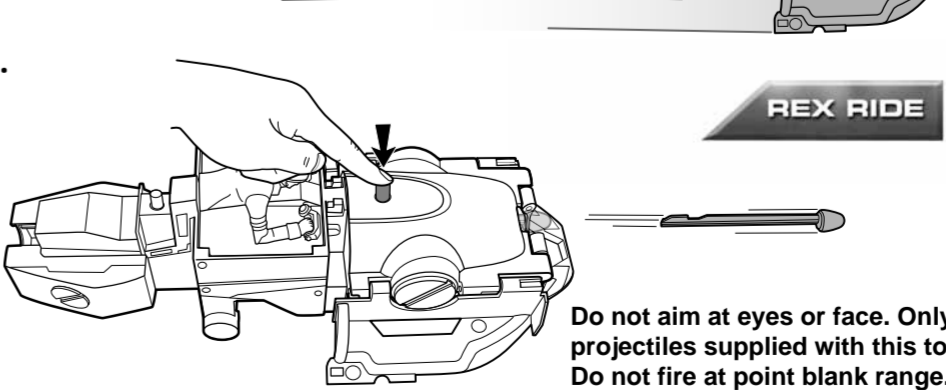

Do not aim at eyes or face. Only use projectiles supplied with this toy. Do not fire at point blank range.