



Please keep this instruction sheet for future reference, as it contains important information. Requires four "C" (LR14) **alkaline** batteries for mobile operation and two "AAA" (LR03) **alkaline** batteries for remote operation (batteries not included).

Adult assembly is required. Tool required: Phillips screwdriver (not included).

IMPORTANT! Always attach with all provided fasteners tightly to a crib or playpen according to the instructions. Do not add additional strings or straps to attach to a crib. Check frequently.

- The mobile portion of this product may be used from birth until 5 months.
- The base portion of this product may be used from birth until 24 months.
- A crib mobile is intended for visual stimulation and is not to be grasped by a child.

Parts

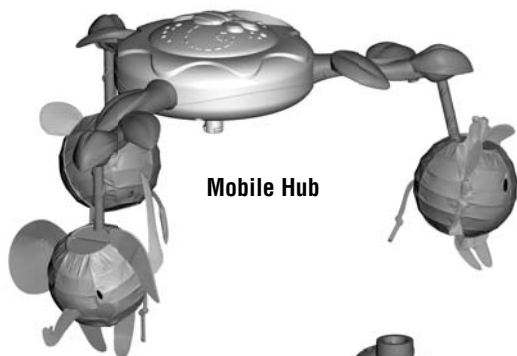

Mobile Hub

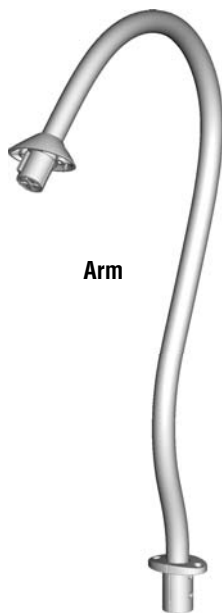

Arm



Spinner



Crib Connector



Remote



Base

Note: All of the screws used to assemble this toy are attached to the product. Follow these instructions carefully to fully secure the screws. Tighten and loosen all screws with a Phillips screwdriver. Do not over-tighten the screws.

Battery Installation

*Hint: We recommend using **alkaline** batteries for longer battery life.*

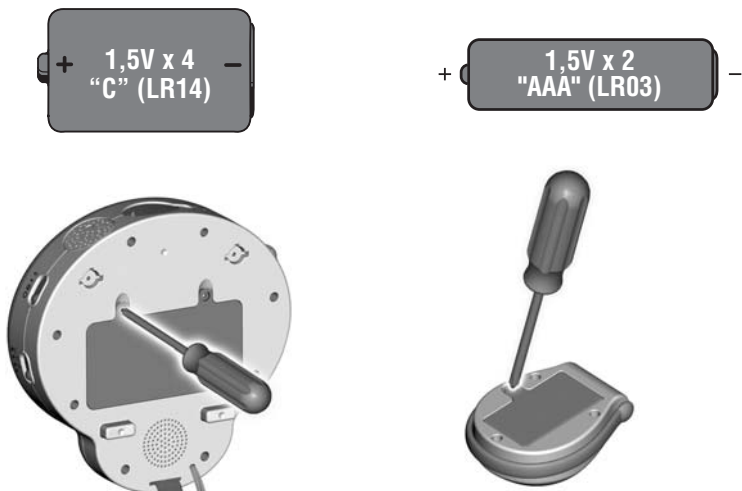

- Loosen the screws in the mobile base battery compartment door with a Phillips screwdriver and remove it.
- Insert four "C" (LR14) **alkaline** batteries.
- Replace the battery compartment door and tighten the screws.
- Loosen the screw in the remote battery compartment door with a Phillips screwdriver and remove it.
- Insert two "AAA" (LR03) **alkaline** batteries.
- Replace the battery compartment door and tighten the screw.

IMPORTANT! Under normal use conditions, the batteries in the mobile base will require replacement more often than the batteries in the remote. When sounds, lights, projection or movement become faint or stop, it's time for an adult to change the batteries.

- If this product begins to operate erratically, you may need to reset the electronics. Slide the power/volume switch on the base off and then back on. Remove the batteries from the remote and reinstall them.

Assembly

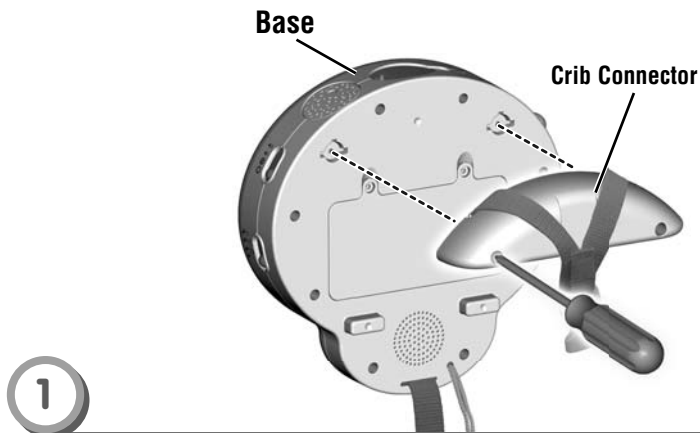

- Fit the crib connector to the base and tighten **both** screws.
- IMPORTANT!** Make sure the straps are over the **top** of the crib connector.

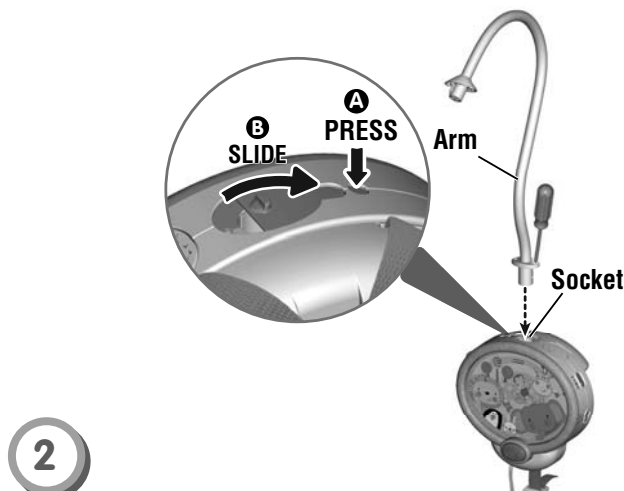

- First, press the button on the mobile base **A** and then slide the socket door open **B**.
- Fit the arm into the socket in the base and tighten **both** screws.

Assembly

3

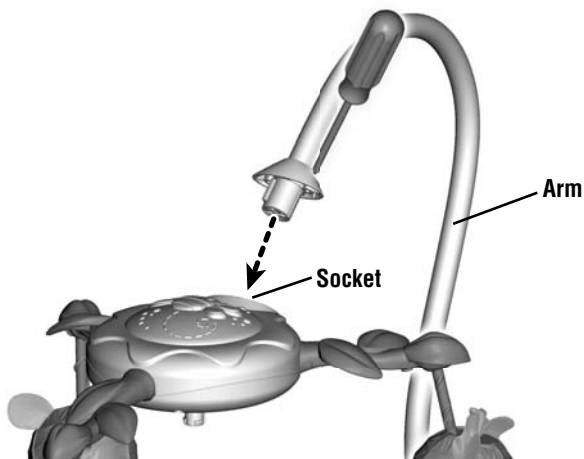

- Fit the end of the arm to the socket on the mobile hub.
- Tighten **both screws** in the arm to secure it to mobile hub.

4

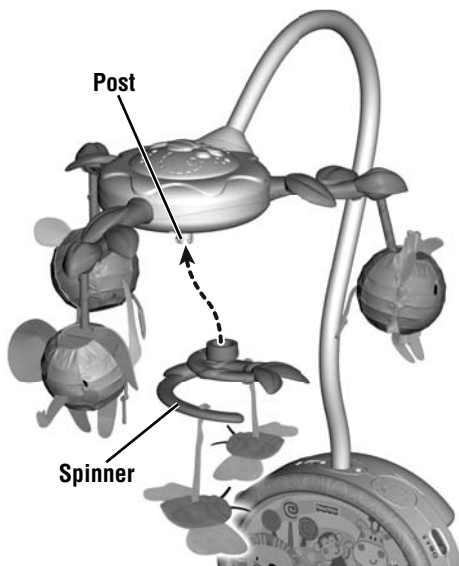

- Fit the spinner onto the post on the mobile hub. Push to "**snap**" in place.



CONSUMER ASSISTANCE

1-800-432-5437 (US & Canada)

1300 135 312 (Australia)



service.fisher-price.com

Fisher-Price, Inc., 636 Girard Avenue, East Aurora, NY 14052.

Hearing-impaired consumers: 1-800-382-7470.

Outside the United States:

Canada: Mattel Canada Inc., 6155 Freemont Blvd.,
Mississauga, Ontario L5R 3W2; www.service.mattel.com.

Great Britain: Mattel UK Ltd, Vanwall Business Park,
Maidenhead SL6 4UB. Helpline: 01628 500303.
www.service.mattel.com/uk

Mattel Europa, B.V., Gondel 1, 1186 MJ Amstelveen, Nederland.

Australia: Mattel Australia Pty. Ltd., 658 Church Street,
Locked Bag #870, Richmond, Victoria 3121 Australia.

New Zealand: 16-18 William Pickering Drive,
Albany 1331, Auckland.

Battery Safety Information

In exceptional circumstances, batteries may leak fluids that can cause a chemical burn injury or ruin your product. To avoid battery leakage:

- Do not mix old and new batteries or batteries of different types: alkaline, standard (carbon-zinc) or rechargeable (nickel-cadmium).
- Insert batteries as indicated inside the battery compartment.
- Remove batteries during long periods of non-use. Always remove exhausted batteries from the product. Dispose of batteries safely. Do not dispose of this product in a fire. The batteries inside may explode or leak.
- Never short-circuit the battery terminals.
- Use only batteries of the same or equivalent type, as recommended.
- Do not charge non-rechargeable batteries.
- Remove rechargeable batteries from the product before charging.
- If removable, rechargeable batteries are used, they are only to be charged under adult supervision.

Crib Attachment



WARNING

Prevent Entanglement Injury

- Keep mobile out of baby's reach.
- Remove mobile portion of product from crib or playpen when baby begins to push up on hands and knees.
- This product may not attach to all crib designs. Do not add additional strings or straps to attach to crib or playpen.
- Use ONLY attached to a crib or playpen.

IMPORTANT! Always attach with all provided fasteners tightly to a crib or playpen according to the instructions. Do not add additional strings or straps to attach to a crib. Check frequently.

- The mobile portion of this product may be used from birth until 5 months.
- The base portion of this product may be used from birth until 24 months.
- A crib mobile is intended for visual stimulation and is not to be grasped by a child.

Crib Attachment

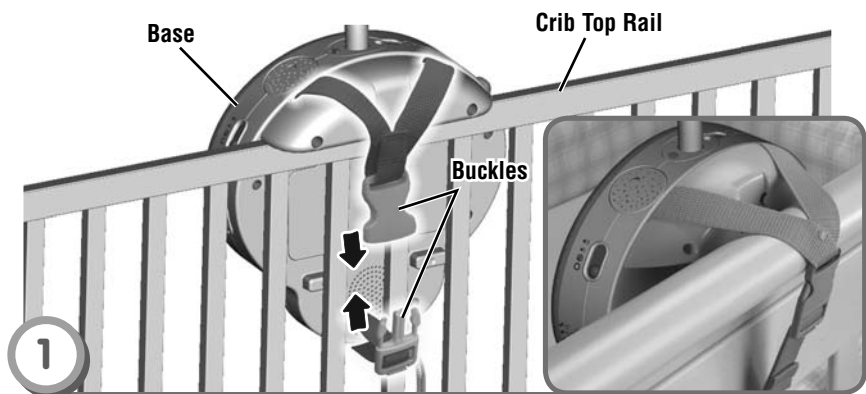

- Position the base so that the decorated side faces the inside of the crib. Fit the base onto or against the crib top rail.

Hint: The base is designed to fit most crib designs. Please refer to the main illustration and the inset photograph.

- Make sure the top strap is hanging over the crib top rail. Pull the bottom strap through the crib spindles.
- Buckle the straps. Make sure you hear a “click”.

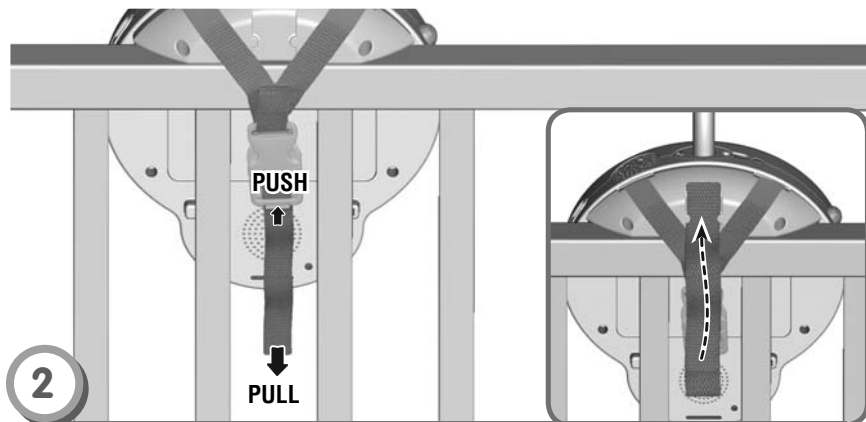

- Make sure the straps are tightened securely around the crib top rail.
- While pushing the tab at the bottom of the buckle, pull the free end of the strap to tighten on the crib top rail.

Note: You can secure the free end of the strap to the base.

Crib Attachment

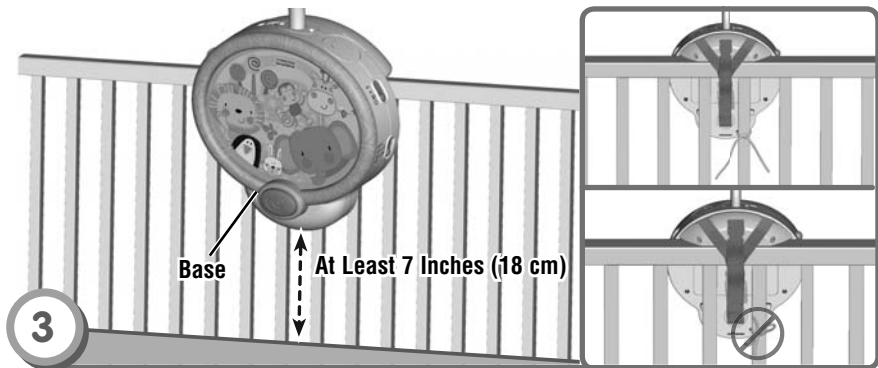

3

- Tie the base strings to a crib spindle.
- If the distance between the base and the mattress is less than 7 Inches (18 cm), lower the crib mattress.

Note: It is better to tie the strings in a knot than a bow, since a bow may be easily untied.

Remote Use

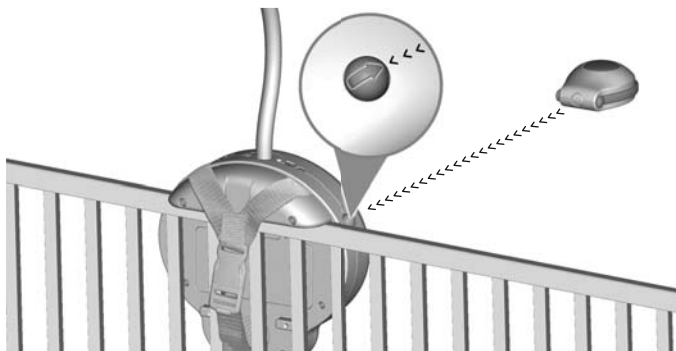

- In the unlikely event that use of the remote interferes with normal use of other remote controlled equipment, such as televisions or stereos, or use of other electronic or battery powered appliances interfere with operation of the mobile, do not use both at the same time.
- You may notice a loss of range between the remote and the mobile when using in bright light. For best performance, avoid using the remote in areas of bright light. Move the mobile, or reduce the amount of light to improve performance.
- Position the mobile so that the receiver arrow points towards the area that the remote will be used. Make sure there is a clear path between the remote and the mobile. Point the end of the remote toward the mobile receiver and press the button.

Twinkling Stars, Soothing Music and Animal Friends

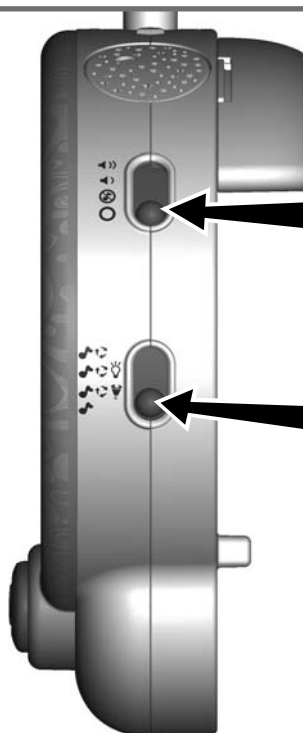

Power/Volume Switch

- Slide the switch to:

- ON with no sound
- ON with low volume
- ON with high volume
- OFF

Mode Switch

- Slide the switch to select a mode:

- Music Only
- Music/Motion/Projection
- Music/Motion/Lights
- Music/Motion



Music Button

- Press the button to play a song.
- Press the button again to change the song.

Convert to Soothing Projector

Remove the mobile and use as a soother with projection! When used as a soother, music and projection are the only modes that can be used.



- Loosen both screws in the arm near the mobile base. Lift and remove the arm.
- Close the socket door on top of the mobile base.
- Store the mobile in a safe place for future use.

Consumer Information

Care

- Wipe this toy with a clean cloth dampened with a mild soap and water solution. Do not immerse.
- This toy has no consumer serviceable parts. Do not take this toy apart.

FCC Statement (United States Only)

This equipment has been tested and found to comply with the limits for a Class B digital device, pursuant to Part 15 of the FCC Rules. These limits are designed to provide reasonable protection against harmful interference in a residential installation. This equipment generates, uses and can radiate radio frequency energy and, if not installed and used in accordance with the instructions, may cause harmful interference to radio communications. However, there is no guarantee that interference will not occur in a particular installation. If this equipment does cause harmful interference to radio or television reception, which can be determined by turning the equipment off and on, the user is encouraged to try to correct the interference by one or more of the following measures:

- Reorient or relocate the receiving antenna.
- Increase the separation between the equipment and receiver.
- Consult the dealer or an experienced radio/TV technician for help.

Note: Changes or modifications not expressly approved by the manufacturer responsible for compliance could void the user's authority to operate the equipment.

This device complies with Part 15 of the FCC Rules. Operation is subject to the following two conditions: (1) this device may not cause harmful interference and (2) this device must accept any interference received, including interference that may cause undesired operation.

ICES-003

This Class B digital apparatus complies with Canadian ICES-003. Operation is subject to the following two conditions: (1) this device may not cause harmful interference and (2) this device must accept any interference received, including interference that may cause undesired operation.

NMB-003

Cet appareil numérique de la classe B est conforme à la norme NMB-003 du Canada. L'utilisation de ce dispositif est autorisée seulement aux conditions suivantes: (1) il ne doit pas produire de brouillage et (2) l'utilisateur du dispositif doit être prêt à accepter tout brouillage radioélectrique reçu, même si ce brouillage est susceptible de compromettre le fonctionnement du dispositif.