

3.

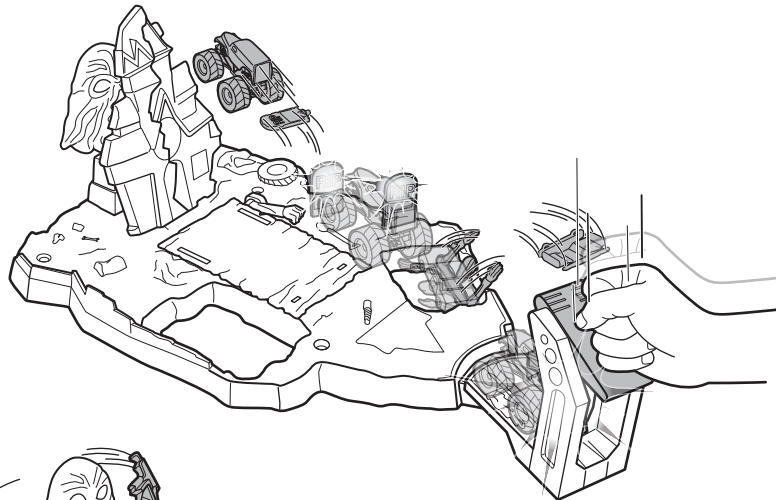

4.

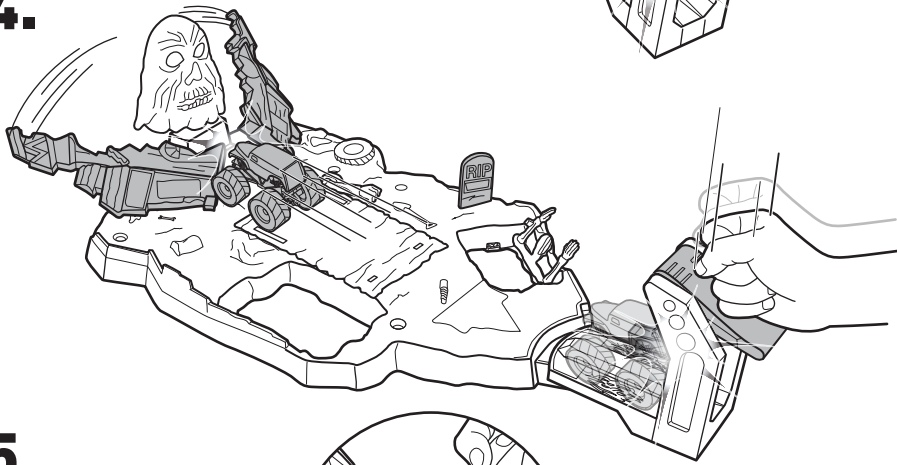

5.

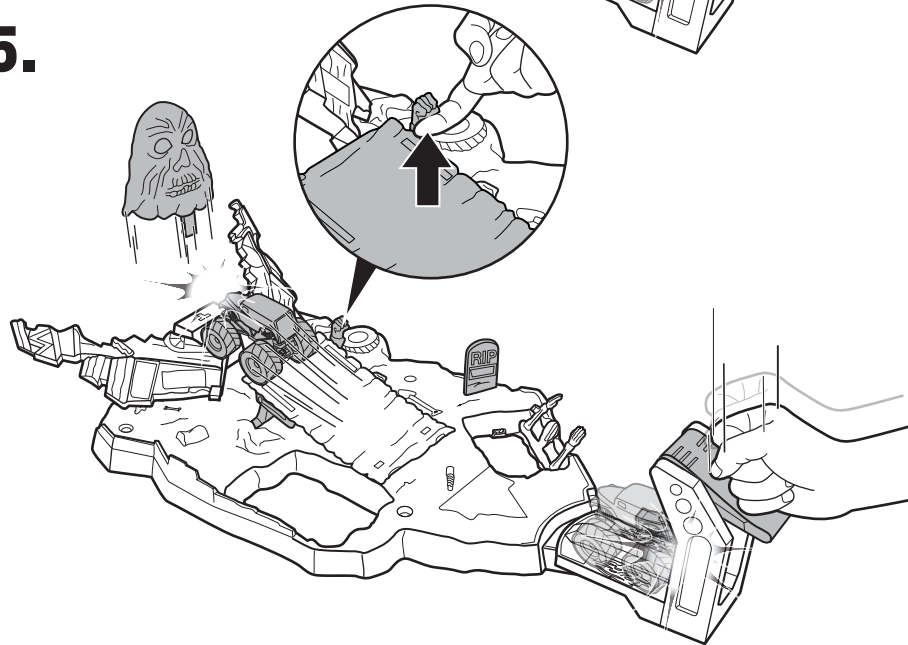

# GRAVE BONEYARD BASH™

## INSTRUCTIONS

Please keep these instructions for future reference as they contain important information.

### CONTENTS

4+

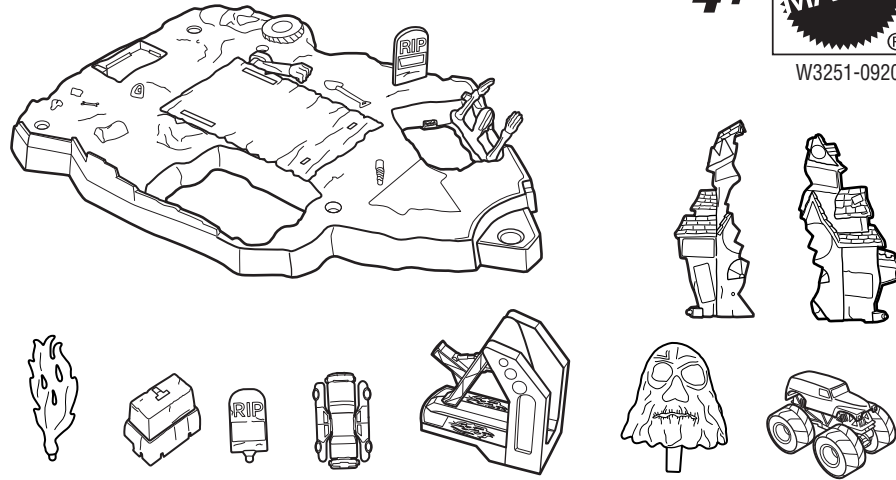

© 2012 Field Motor Sports, Inc.  
Monster Jam®, United States Hot Rod Association®, USHRA®, Afterburner™, Backwards Bob®, Blacksmith®, Blue Thunder®, Bulldozer®, Captain's Curse®, Dragon's Breath™, El Toro Loco®, Grave Digger®, Grave Digger The Legend™, Grinder™, Crusader™, Maximum Destruction®, Mohawk Warrior®, Monster Mutt®, and Son-u-va Digger™ are all trademarks of Field Motor Sports, Inc.  
SUPERMAN and all related characters and elements are trademarks of and © DC Comics.  
(s12)  
BATMAN and all related characters and elements are trademarks of and © DC Comics.  
(s12)  
LOONEY TUNES and all related characters and elements are trademarks of and © Warner Bros. Entertainment Inc.  
(s12)  
© 2012 Viacom International Inc. All Rights Reserved. TEENAGE MUTANT NINJA TURTLES and all related titles, logos and characters are trademarks of Viacom International Inc.  
TM & © 2012 Marvel & Subs.

©2011 Mattel, Inc. All Rights Reserved. Mattel, Inc., 636 Girard Avenue, East Aurora, NY 14052, U.S.A. Consumer Relations 1-800-524-8697. Mattel U.K. Ltd., Vanwall Business Park, Maidenhead SL6 4UB. Helpline 01628 500303. Mattel Australia Pty., Ltd., Richmond, Victoria, 3121. Consumer Advisory Service - 1300 135 312. Mattel East Asia Ltd., Room 1106, South Tower, World Finance Centre, Harbour City, Tsimshatsui, HK, China. Diimport & Diedarkan Oleh: Mattel SEA Ptd Ltd (993532-P) Lot 13.5, 13th Floor, Menara Lien Hoe, Persiaran Tropicana Golf Country Resort, 47410 PJ. Tel:03-78803817, Fax:03-78803867. service.mattel.com

### INSTRUCTION SHEET SPECIFICATIONS

Toy: Smash-Up Stadium play set  
Toy No.: W3251  
Part No.: 0920  
Trim Size: 11" W x 8.5" H  
Folded Size: 5.5" W x 8.5" H  
Type of Fold: Single  
# colors: One  
Colors: Black  
Paper Stock: White Offset  
Paper Weight: 70 lb.  
EDM No.:



### 2 PANEL Folding Dummy

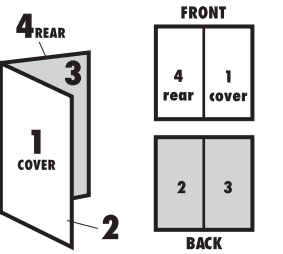

### ASSEMBLY

1.

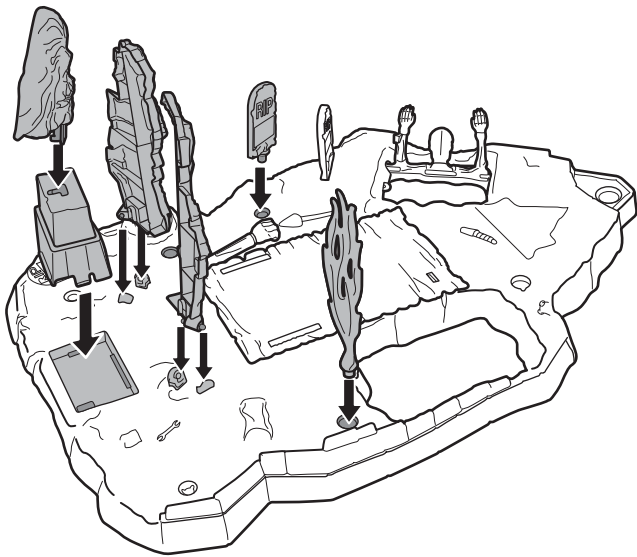

2.

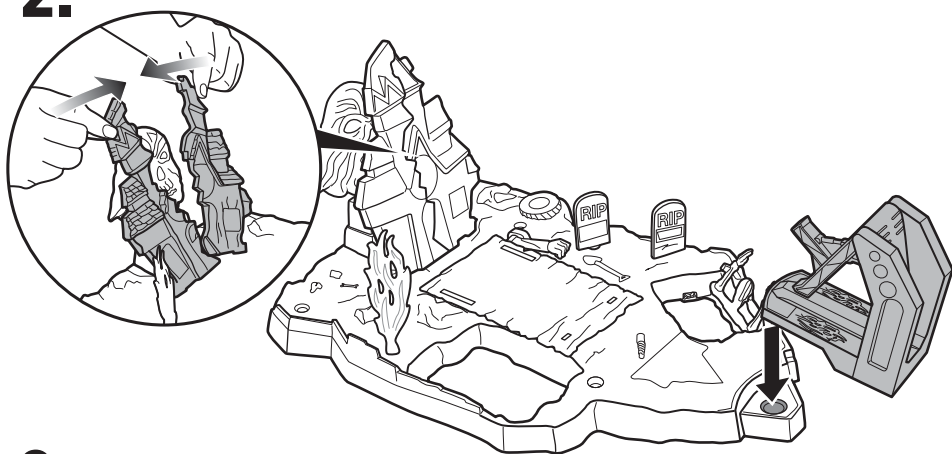

3.

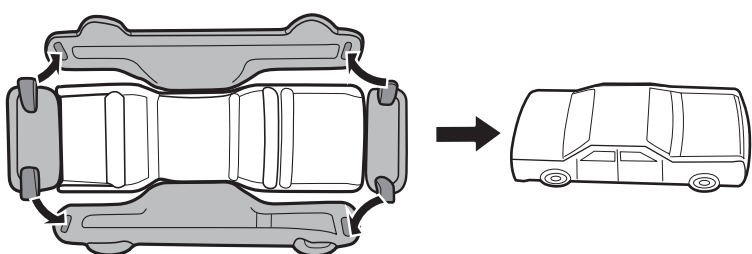

4.

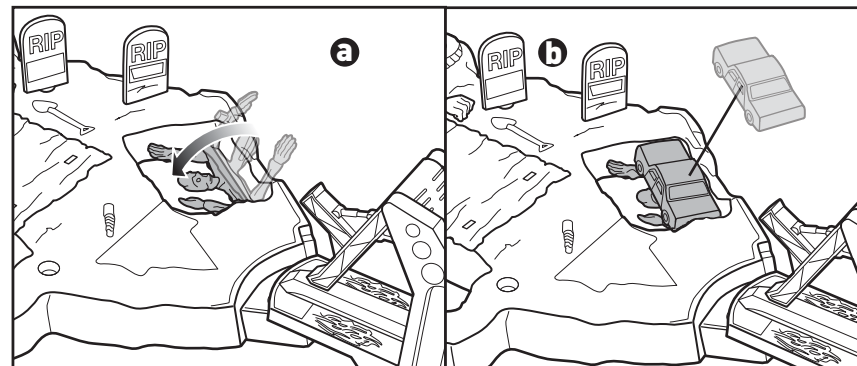

### TO PLAY

1.

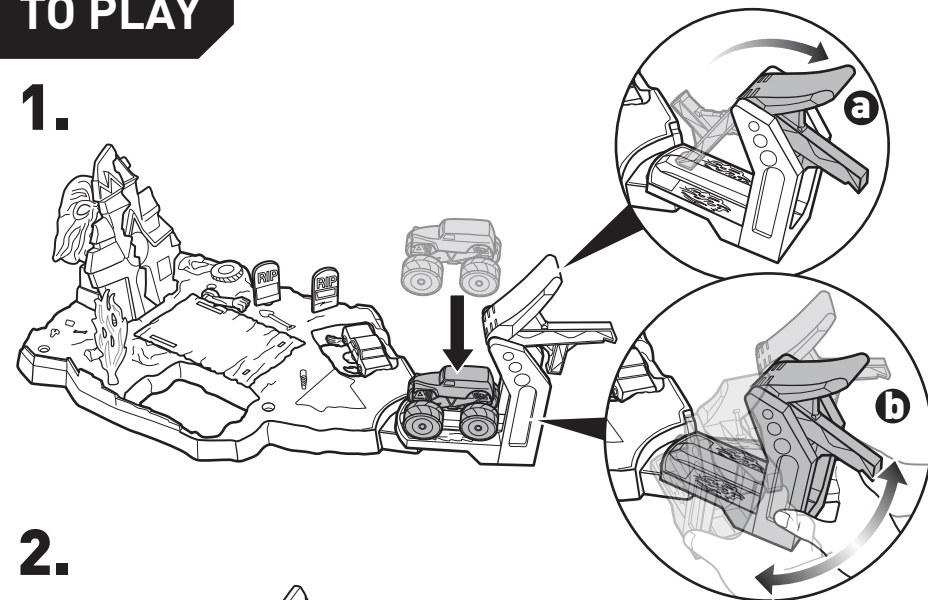

2.

