



WALL TRACKS

POWER TOWER™ TRACK SET

5+

INSTRUCTIONS

Hangs with



FOR INSTRUCTIONAL VIDEOS AND MORE GO TO www.HOTWHEELS.COM/WALL-TRACKS

Keep these instructions for future reference as they contain important information.

YOU WILL NEED:



Low-adhesive tape such as painter's tape or masking tape

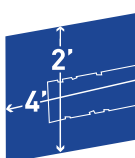

Approximately 4 feet by 2 feet of open wall space



20 minutes

CONTENTS:

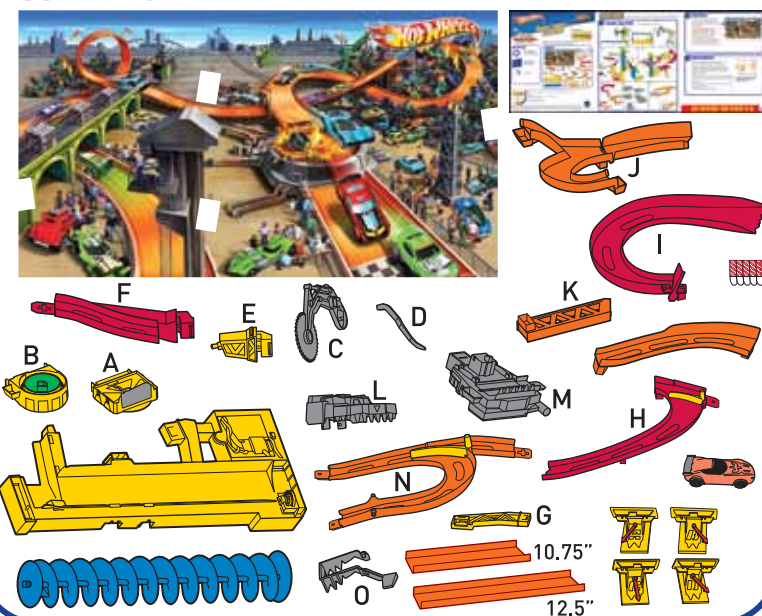

Command™ Strips are a product of 3M. For further information visit command.com

NOTE: Apply strips to surfaces above 50°F (10°C). Adhesive could lose adhesion above 105°F (40°C).

CAUTION: DO NOT use with wallpaper. May not adhere well to vinyl surfaces. DO NOT hang items over beds.

3M and Command are trademarks of 3M. © 3M 2011. All Rights Reserved.

©2011 Mattel. All Rights Reserved. Mattel, Inc., 636 Girard Avenue, East Aurora, NY 14052, U.S.A. Consumer Relations 1-800-524-8697, Mattel U.K. Ltd., Vanwall Business Park, Maidenhead SL6 4UB. Helpline 01628 500303. Mattel Australia Pty., Ltd., Richmond, Victoria, 3121. Consumer Advisory Service - 1300 135 312. Mattel East Asia Ltd., Room 1106, South Tower, World Finance Centre, Harbour City, Tsimshatsui, HK, China. Diimport & Diedarkan Oleh: Mattel SEA Ptd Ltd.(993532-P) Lot 13.5, 13th Floor, Menara Lien Hoe, Persiaran Tropicana Golf Country Resort, 47410 PJ. Tel:03-78803817, Fax:03-78803867.



W3423-0920G1

START HERE:

Please read all instructions before beginning assembly and set-up.

1 ASSEMBLE TRACK PIECES

Pre-assemble pieces as shown.

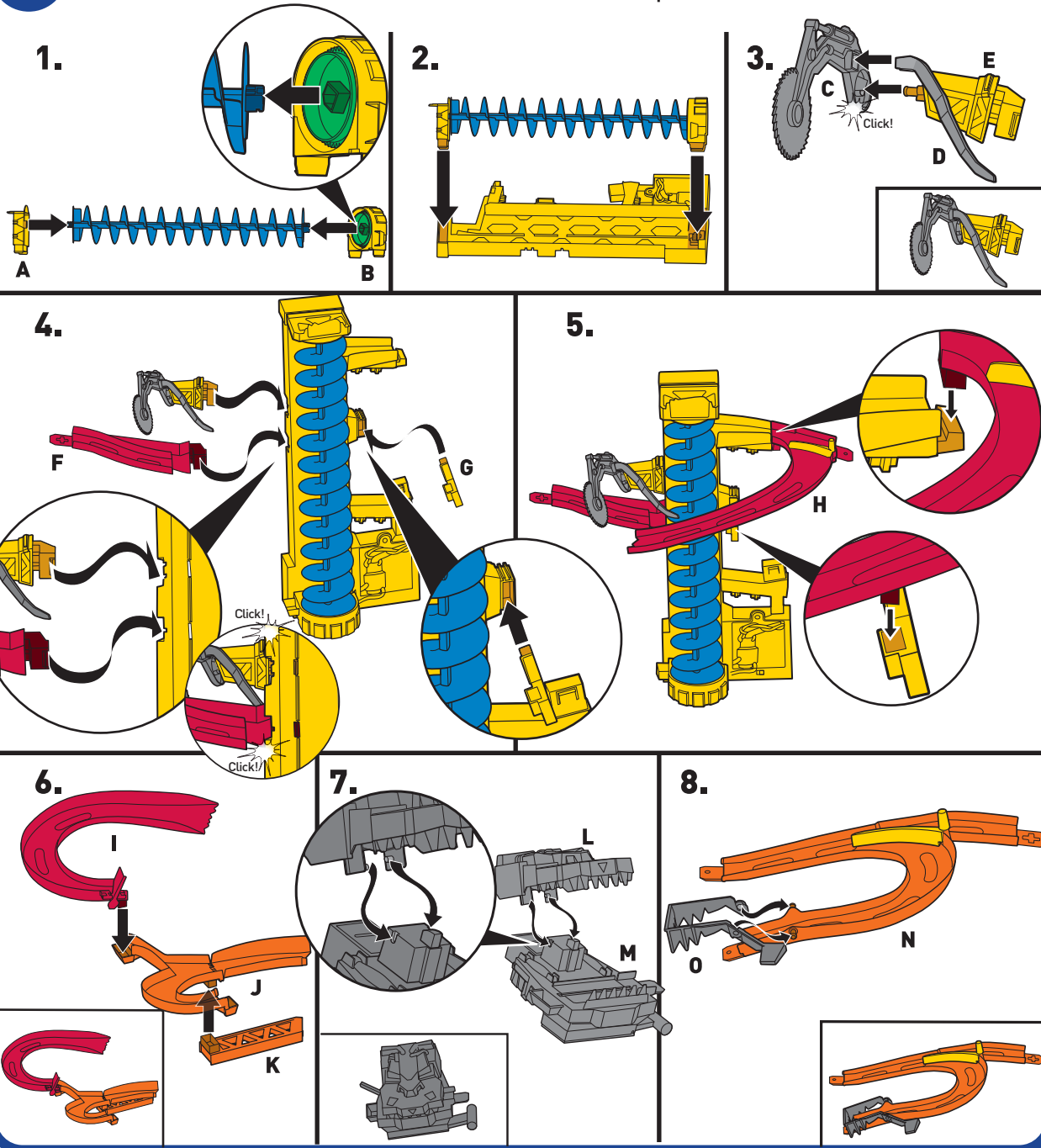

2 HANG POSTER

Lie poster flat and level against wall and tape as shown. Top of poster should align with the height of the child.

NOTE TO PARENTS: Before applying Command™ Strips make sure the wall surface is clean and dry. If cleaning is necessary 3M recommends using isopropyl rubbing alcohol. Do not use household cleaners.



3 PREPARE BRACKETS

There are 4 yellow brackets [Marked A – D] and 5 Command™ Strips (1 extra strip).

Separate strips. Remove red-printed liner from Command™ Strips and apply to back of brackets as shown. Make sure the strip tab is accessible for future removal.

NOTE: Apply strips to surfaces above 50°F (10°C). Adhesive could lose adhesion above 105°F (40°C).

CAUTION: DO NOT use with wallpaper. May not adhere well to vinyl surfaces. DO NOT hang items over beds.

Red Printing = On Bracket

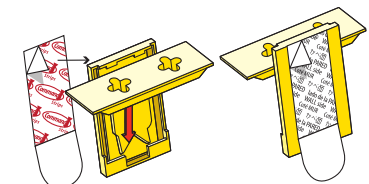

Black Printing = On Wall

NOTE: DO NOT PULL BRACKET OFF WALL without reading removal instructions in step 8.

SEE REVERSE FOR STEPS 4-8.

SEE BACK

SEE OTHER SIDE FOR STEPS 1-3

4 HANG BRACKETS

Remove black-printed liner from Command™ Strips and attach each bracket into the designated notch of the poster as shown.

Bracket should not overlap the poster.

Press bracket firmly onto wall and hold, pressing for 30 seconds.

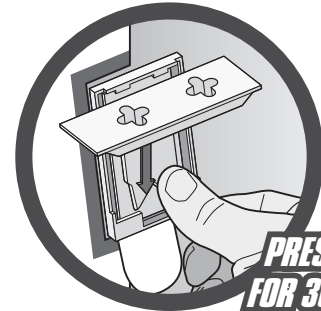

PRESS FIRMLY FOR 30 SECONDS

NOTE: For optimal adhesion performance 3M recommends waiting 1 hour before adding weight to Command™ Strips.



Red arrow should line up with arrow on bracket.

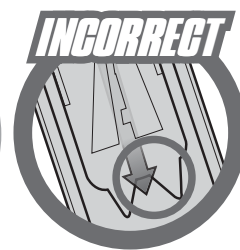
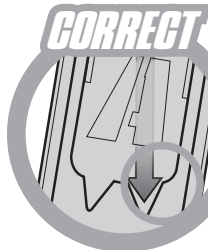

5 BATTERY INSTALLATION

- Unscrew the battery cover with a Phillips head screwdriver (not included).
- Install 2 "D" size (LR20) alkaline batteries (not included) in the orientation (+/-) shown.
- Replace battery cover and tighten screw.
- For longer life use alkaline batteries.
- Replace batteries when vehicles can no longer reach the top of the tower.
- When exposed to an electrostatic source, the product may malfunction. To resume normal operation, remove and re-install the batteries.

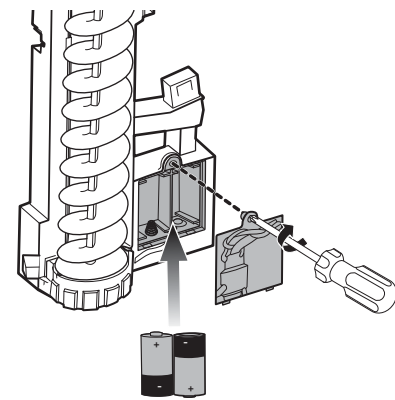

IMPORTANT NOTE: Elevator will not function if Part B is not properly connected as shown in ASSEMBLE TRACK PIECES steps 1 and 2.

6 HANG TRACK ON WALL

1. Once poster and brackets are mounted on wall, attach tower as shown.

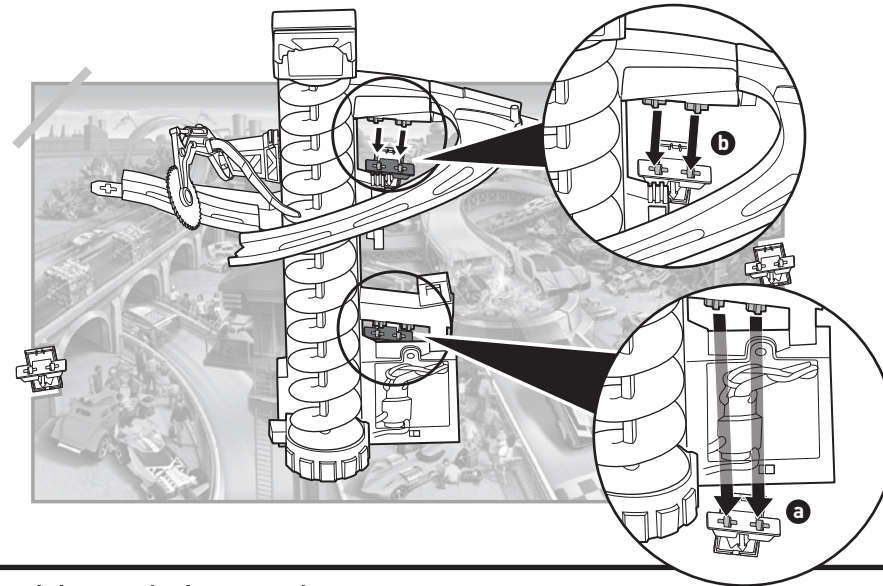

2. Attach remaining track pieces as shown.

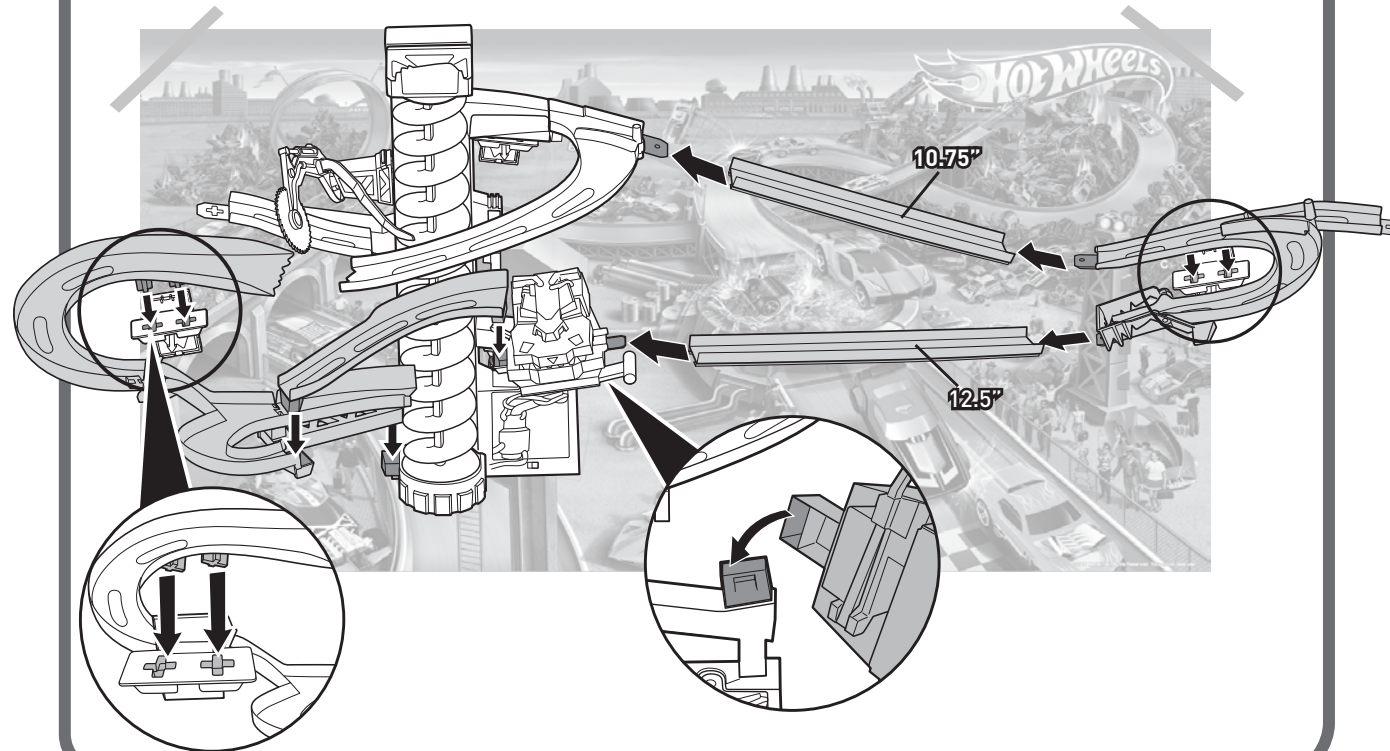

7 LET'S PLAY!

Load car and launch!

Send your cars in different directions!

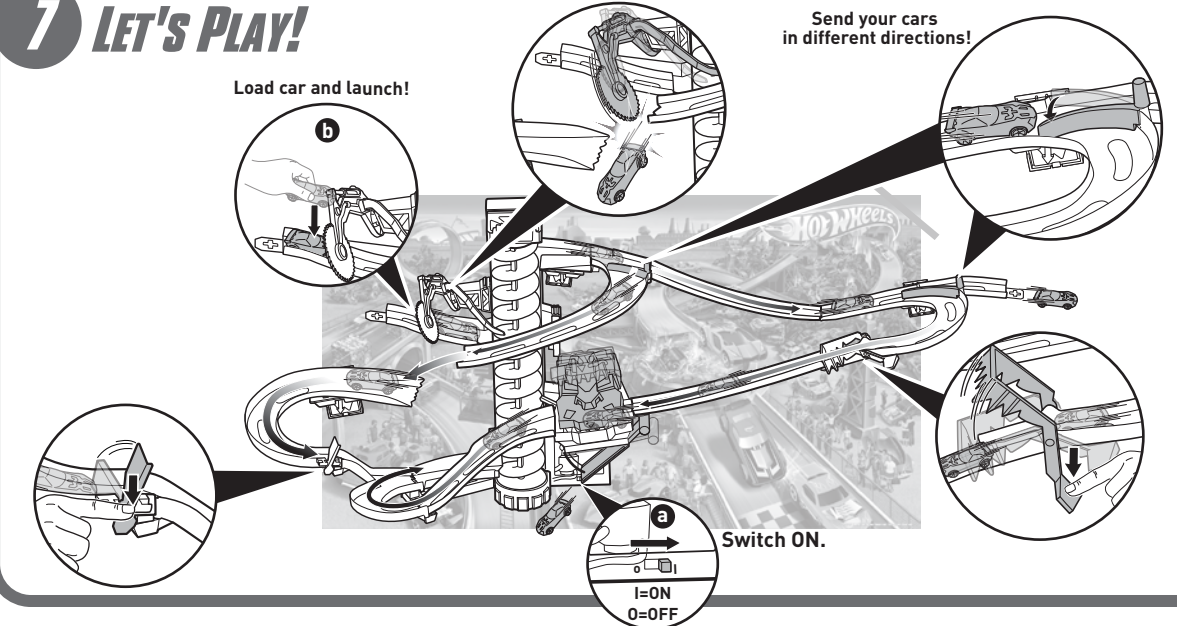

8 REATTACHING & REMOVAL

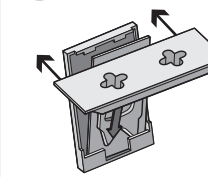

Mounting brackets are designed to break away from the set without causing surface damage. If mounting plate separates from bracket, snap bracket back into place.

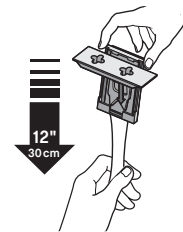

- To remove brackets from the wall entirely:
1. NEVER pull strip towards you.
 2. Hold bracket gently to prevent it from snapping fingers. DO NOT press against wall.
 3. Grab tab on Command™ Strip and **SLOWLY STRETCH STRAIGHT DOWN ALONG WALL AT LEAST 12 INCHES** until bracket and strip release.

Purchase medium Command™ Refill Strips to reapply to your wall.

CONNECT

Create your own set-ups with other Wall Tracks™ sets.

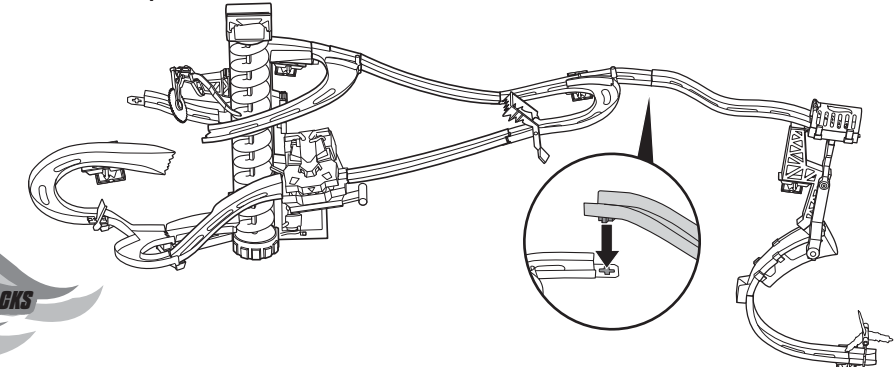

FOR INSTRUCTIONAL VIDEOS AND MORE GO TO WWW.HOTWHEELS.COM/WALL-TRACKS