

## TO PLAY

### 1. Set up.

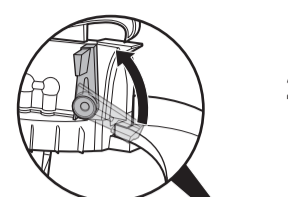

### 2. Launch vehicle into light chamber.

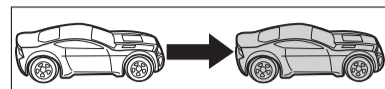

### 3. Release vehicle when lights stop flashing.

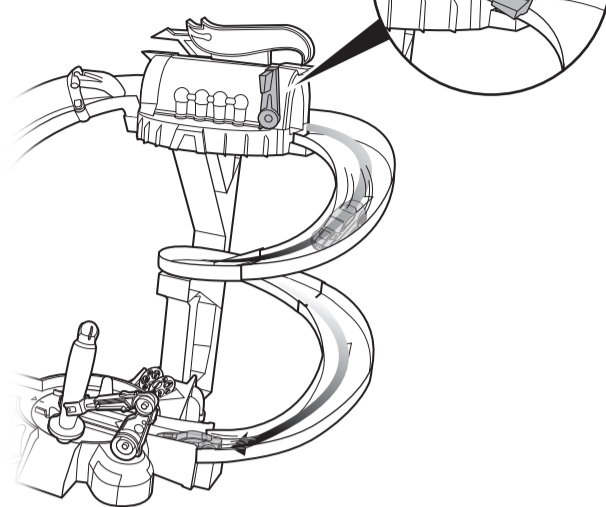

Align platform.

### 4. Clip vehicle to platform.

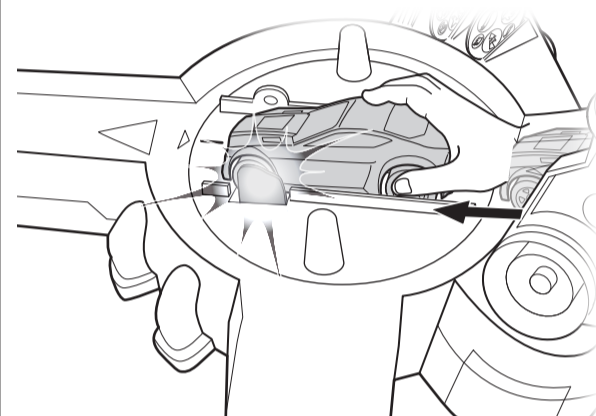

### 5. Rotate and tilt platform to customize vehicle.

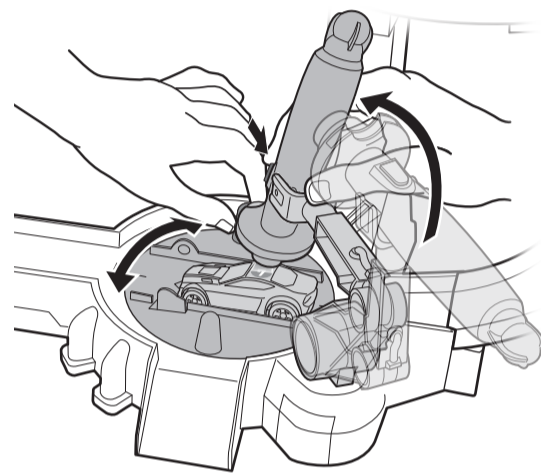

### 6. Push to release vehicle.

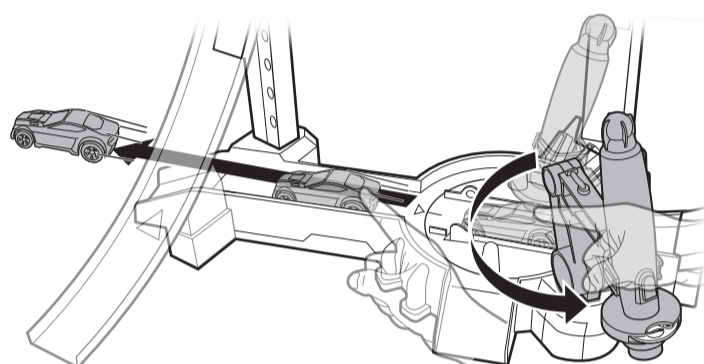

**Noted:** Do not expose this toy to intense heat or direct sunlight. These will damage the color-change feature.



# FLASH FACTORY™

## INSTRUCTIONS

Keep these instructions for future reference as they contain important information.

## CONTENTS

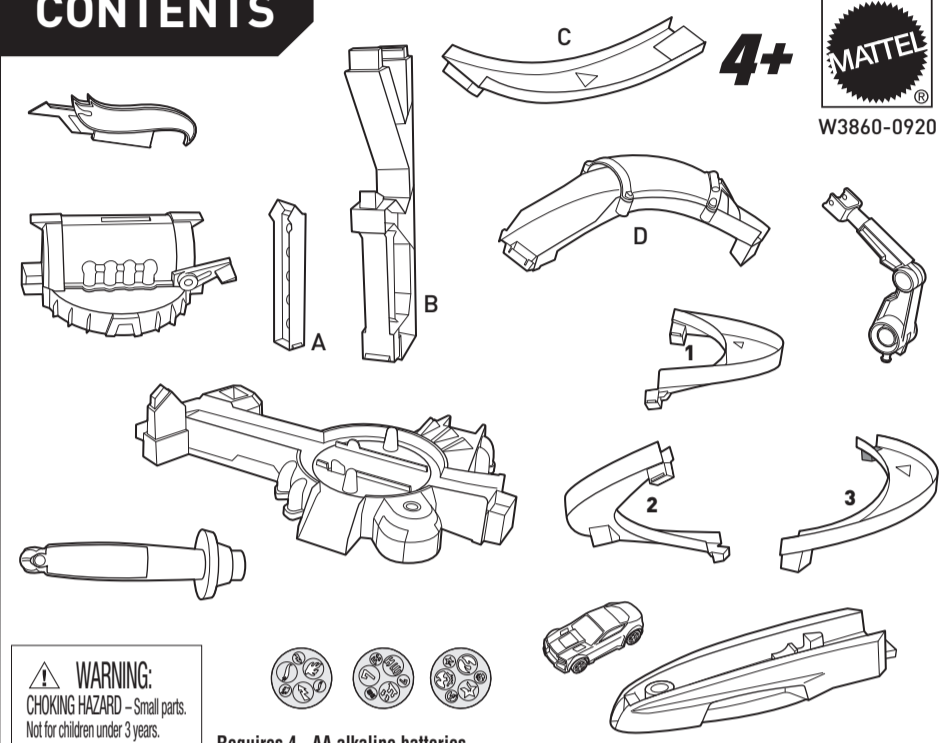

©2012 Mattel. All Rights Reserved. Mattel, Inc., 636 Girard Avenue, East Aurora, NY 14052, U.S.A. Consumer Relations 1-800-524-8697. Mattel U.K. Ltd., Vanwall Business Park, Maidenhead SL6 4UB. Helpline 01628 500303. Mattel Australia Pty., Ltd., Richmond, Victoria, 3121. Consumer Advisory Service - 1300 135 312. Mattel East Asia Ltd., Room 1106, South Tower, World Finance Centre, Harbour City, Tsimshatsui, HK, China. Diimport & Diedarkan Oleh: Mattel SEA Ptd Ltd. (993532-P) Lot 13.3, 13th Floor, Menara Lien Hoe, Persiaran Tropicana Golf Country Resort, 47410 PJ. Tel: 03-78803617, Fax: 03-78803667. service.mattel.com

### INSTRUCTION SHEET SPECIFICATIONS

Toy: HW TURBO GARAGE  
 Part No.: W3860  
 Part No.: 0920  
 Trim Size: 16.5"W x 8.5" H  
 Fokbed Size: 5.5" W x 8.5" H  
 Type of Fold: Single  
 # colors: One  
 Colors: Black  
 Paper Stock: White Offset  
 Paper Weight: 70 lb.  
 EDM No.:  
 Date: 09/05/2011



### 2 PANEL Folding Dummy

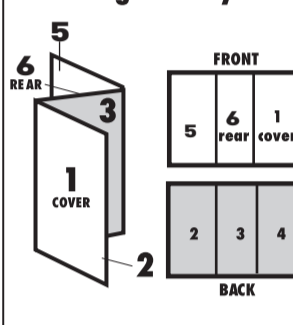

## BATTERY REPLACEMENT

- Unscrew the battery covers with a Phillips head screwdriver (not included).
- Light chamber requires 3 AA (LR6) alkaline batteries. Projector pen requires 1 AA (LR6) alkaline battery.
- Install batteries with polarity (+/-) as shown inside the battery compartment.
- Replace battery covers and tighten screws.
- For longer life use alkaline batteries.
- Replace batteries when lights dim.
- When exposed to an electrostatic source, the product may malfunction. To resume normal operation, remove and re-install the batteries.

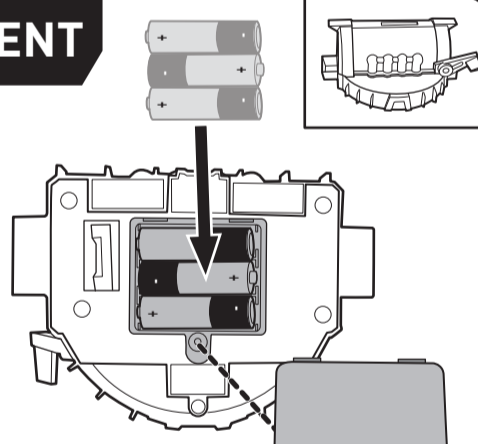

## BATTERY SAFETY INFORMATION

- In exceptional circumstances batteries may leak fluids that can cause a chemical burn injury or ruin your product. To avoid battery leakage:
- Non-rechargeable batteries are not to be recharged.
  - Rechargeable batteries are to be removed from the product before being charged.
  - Rechargeable batteries are only to be charged under adult supervision.
  - Do not mix alkaline, standard (carbon-zinc), or rechargeable (nickel-cadmium) batteries.
  - Do not mix old and new batteries.
  - Only batteries of the same or equivalent type as recommended are to be used.
  - Batteries are to be inserted with the correct polarity.
  - Exhausted batteries are to be removed from the product.
  - The supply terminals are not to be short-circuited.
  - Dispose of battery(ies) safely.
  - Do not dispose of this product in a fire. The batteries inside may explode or leak.

Protect the environment by not disposing of this product with household waste (2002/96/EC). Check your local authority for recycling advice and facilities.

### This device complies with Part 15 of the FCC Rules.

Operation is subject to the following two conditions: (1) This device may not cause harmful interference, and (2) this device must accept any interference received, including interference that may cause undesired operation.

This equipment has been tested and found to comply with the limits for a Class B digital device, pursuant to part 15 of the FCC rules. These limits are designed to provide reasonable protection against harmful interference in a residential installation. This equipment generates, uses and can radiate radio frequency energy and, if not installed and used in accordance with the instructions, may cause harmful interference to radio communications. However, there is no guarantee that interference will not occur in a particular installation. If this equipment does cause harmful interference to radio or television reception, which can be determined by turning the equipment off and on, the user is encouraged to try to correct the interference by one or more of the following measures:

- Reorient or relocate the receiving antenna.
- Increase the separation between the equipment and receiver.
- Connect the equipment into an outlet on a circuit different from that to which the receiver is connected.
- Consult the dealer or an experienced radio/TV technician for help.

**NOTE:** Changes or modifications not expressly approved by the manufacturer responsible for compliance could void the user's authority to operate the equipment.

## PROJECTOR PEN

1. Switch disc for more graphics!

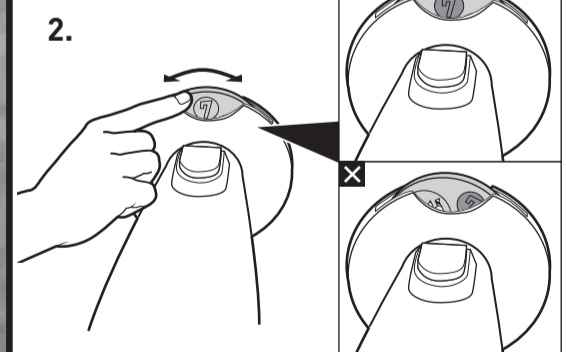
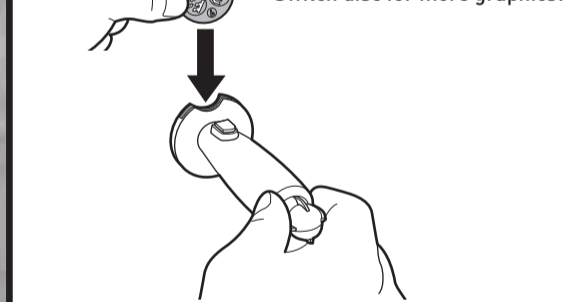

3. Hold pen around 1 inch from vehicle and press button. Hold still for 3 seconds or more to customize.

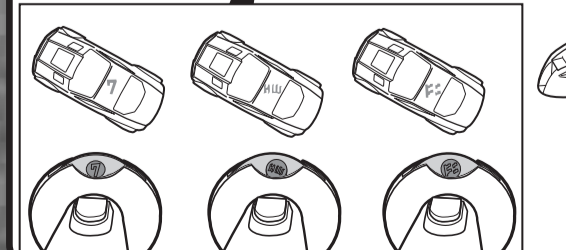
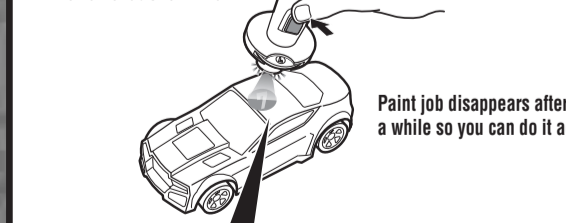

## ASSEMBLY

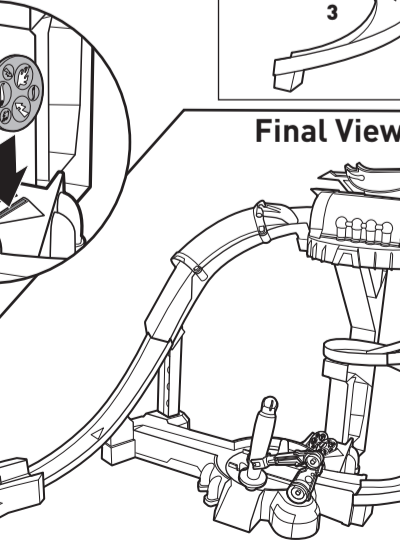
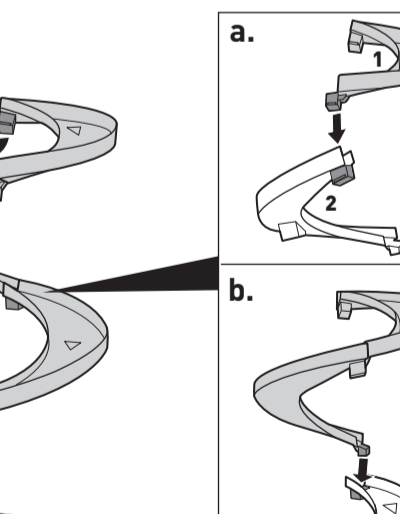
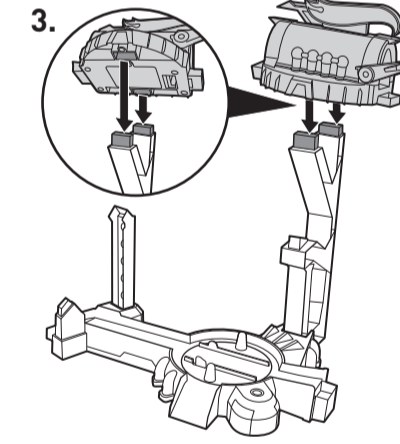
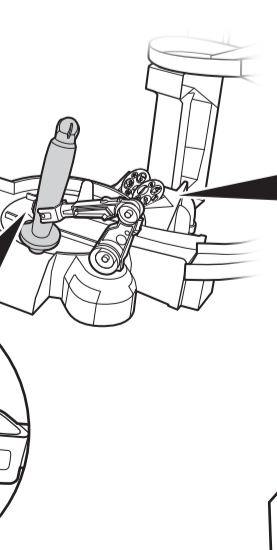
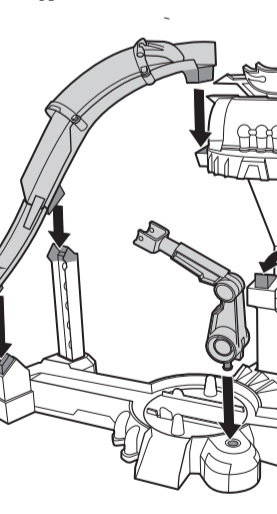
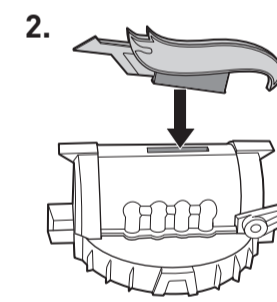
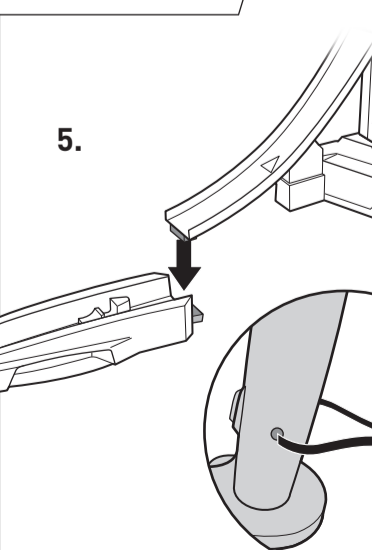
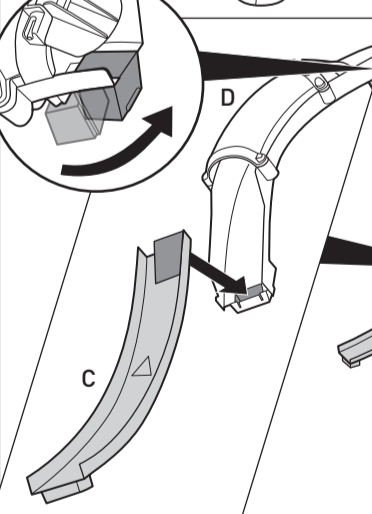
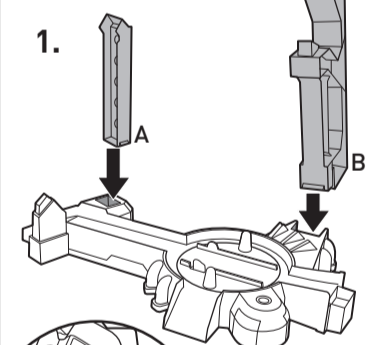

### Final View

