

Please keep this instruction sheet for future reference,
as it contains important information.

Adult assembly is required.

Requires two "AA" batteries (included).

Batteries included are for demonstration purposes only.

Tool required for assembly: Phillips screwdriver (not included).

fisher-price.com

Assembled Parts

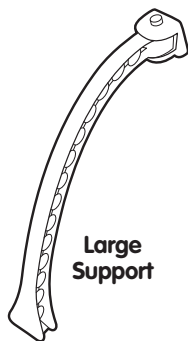

Large Support



Arch



2 Bases

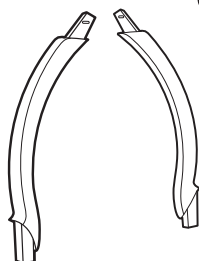

2 Small Supports



3 Hanging Toys

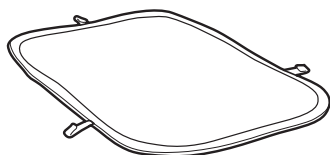

Mat



#6 x 3/4" (1,9 cm) Screw - 4

Screw shown actual size. Tighten all screws with a Phillips screwdriver. Do not over-tighten.

Assembly



CAUTION

This package contains small parts. For adult assembly only.

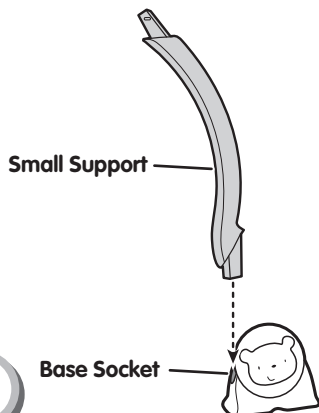

1

Base Socket

- Fit a small support into the socket in a base.

Hint: The small supports are designed to fit into the bases one way. If a support does not seem to fit, turn it around or try assembling it to the other base.

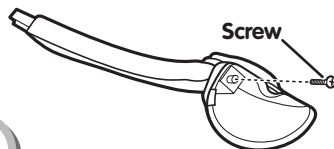

Screw

2

BOTTOM VIEW

- Insert a screw into the bottom of the base and tighten.
- Repeat this procedure to assemble the other small support and base.

Assembly

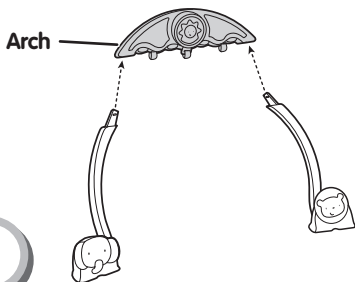

3

- Fit the ends of the small supports into the slots in the arch.

Hint: The small supports are designed to fit into the arch one way. If they do not seem to fit, turn the arch around and try again.

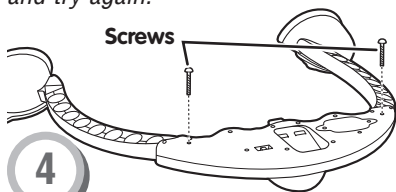

4

- Lay the assembly face down. Insert two screws into the arch and tighten.

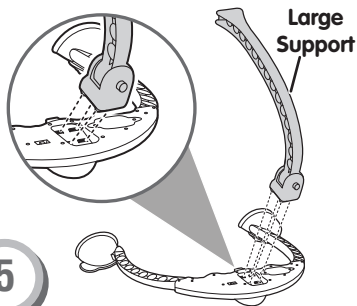

5

- Fit the tabs on the large support into the slots in the arch. Push to "snap" into place.

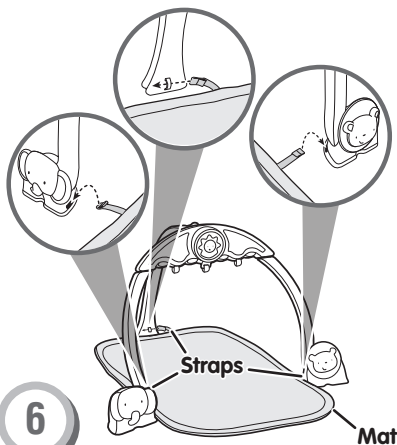

6

- Place the mat, decorated side up, between the bases and large support.
- Fit the straps on the mat through the slots in the support/bases. Make sure the tab on the end of each strap forms a "T" on the other side of each slot.
- Pull up on the mat to be sure all three straps are secured.

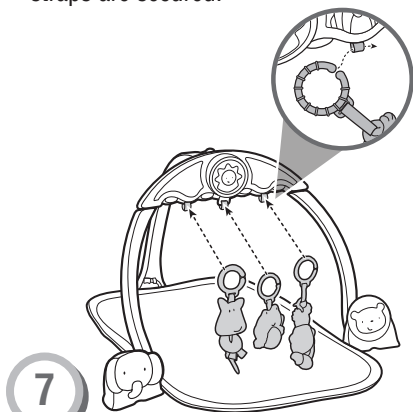

7

- 3
- Hook the toys to the loops on the arch.

Consumer Information

**CONSUMER ASSISTANCE**
1-800-432-5437 (US & Canada)
1300 135 312 (Australia)
service.fisher-price.com

Fisher-Price, Inc., 636 Girard Avenue, East Aurora, NY 14052.
Hearing-impaired consumers: 1-800-382-7470.

Outside the United States:
Canada: Mattel Canada Inc., 6155 Freemont Blvd.,
Mississauga, Ontario L5R 3W2; www.service.mattel.com.
Great Britain: Mattel UK Ltd, Vanwall Business Park,
Maidenhead SL6 4UB. Helpline: 01628 500303.
www.service.mattel.com/uk
Mattel Europa B.V., Gondel 1, 1186MJ Amstelveen, Nederland.
Australia: Mattel Australia Pty. Ltd., 658 Church Street,
Locked Bag #870, Richmond, Victoria 3121 Australia.
New Zealand: 16-18 William Pickering Drive,
Albany 1331, Auckland.

FCC Statement (United States Only)

This equipment has been tested and found to comply with the limits for a Class B digital device, pursuant to Part 15 of the FCC Rules. These limits are designed to provide reasonable protection against harmful interference in a residential installation. This equipment generates, uses and can radiate radio frequency energy and, if not installed and used in accordance with the instructions, may cause harmful interference to radio communications. However, there is no guarantee that interference will not occur in a particular installation. If this equipment does cause harmful interference to radio or television reception, which can be determined by turning the equipment off and on, the user is encouraged to try to correct the interference by one or more of the following measures:

- Reorient or relocate the receiving antenna.
- Increase the separation between the equipment and receiver.
- Consult the dealer or an experienced radio/TV technician for help.

Note: Changes or modifications not expressly approved by the manufacturer responsible for compliance could void the user's authority to operate the equipment. This device complies with Part 15 of the FCC Rules. Operation is subject to the following two conditions: (1) this device may not cause harmful interference and (2) this device must accept any interference received, including interference that may cause undesired operation.

ICES-003

- This Class B digital apparatus complies with Canadian ICES-003.
- Operation is subject to the following two conditions: (1) this device may not cause harmful interference and (2) this device must accept any interference received, including interference that may cause undesired operation.

NMB-003

- Cet appareil numérique de la classe B est conforme à la norme NMB-003 du Canada.
- L'utilisation de ce dispositif est autorisée seulement aux conditions suivantes : (1) il ne doit pas produire de brouillage et (2) l'utilisateur du dispositif doit être prêt à accepter tout brouillage radioélectrique reçu, même si ce brouillage est susceptible de compromettre le fonctionnement du dispositif.

Battery Replacement

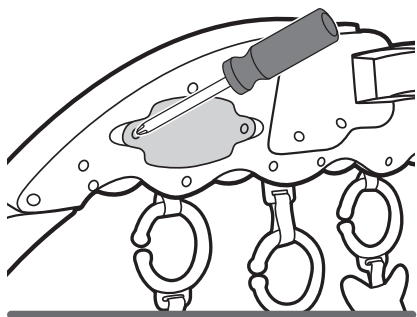

For best performance, we recommend replacing the batteries that came with this toy with two, new "AA" (LR6) alkaline batteries.

- Locate the battery compartment door on the back of the arch.
- Loosen the screws in the battery compartment door with a Phillips screwdriver and remove it.
- Remove the exhausted batteries and dispose of them properly. Insert two, new "AA" (LR6) **alkaline** batteries.
- Replace the battery compartment door and tighten the screws. Do not over-tighten.
- If this product begins to operate erratically, you may need to reset the electronics. Slide the power/volume switch off and then back on.
- When sounds or lights become faint or stop, it's time for an adult to change the batteries.



- Protect the environment by not disposing of this product with household waste (2002/96/EC). Check your local authority for recycling advice and facilities.

Battery Safety Information

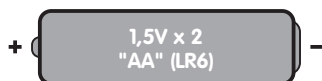

In exceptional circumstances, batteries may leak fluids that can cause a chemical burn injury or ruin your product. To avoid battery leakage:

- Do not mix old and new batteries or batteries of different types: alkaline, standard (carbon-zinc) or rechargeable (nickel-cadmium).
- Insert batteries as indicated inside the battery compartment.
- Remove batteries during long periods of non-use. Always remove exhausted batteries from the product. Dispose of batteries safely. Do not dispose of this product in a fire. The batteries inside may explode or leak.
- Never short-circuit the battery terminals.
- Use only batteries of the same or equivalent type, as recommended.
- Do not charge non-rechargeable batteries.
- Remove rechargeable batteries from the product before charging.
- If removable, rechargeable batteries are used, they are only to be charged under adult supervision.

Musical Fun!







WARNING

To prevent entanglement injury, never place the gym in a crib or playpen. Never add strings, ties or other products to the gym.

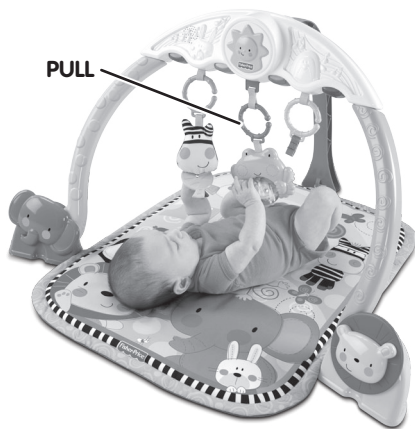

Power/Volume Switch



- Slide the power/volume switch on the arch to ON with low volume  or ON with high volume .
- Pull the center toy on the arch for music and lights!
- When you are finished playing with this toy, slide the power/volume switch OFF .

Storage

PRESS

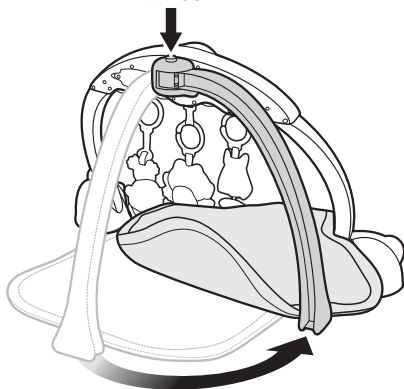

- Press the button on top of the large support and push toward the arch.

Care

- The mat is machine washable. Wash separately in cold water on the gentle cycle. Do not use bleach. Tumble dry on low.
- The frame and toys can be wiped with a clean, damp cloth. Do not immerse the frame.