

Fisher-Price®

X0057



Please keep this instruction sheet for future reference, as it contains important information.

Requires three "AA" (LR6) alkaline batteries (not included) for operation.

Adult assembly is required.

Tool required for assembly: Phillips screwdriver (not included).

Actual product may appear different from the photos.

fisher-price.com

Consumer Information



CONSUMER ASSISTANCE
1-800-432-5437 (US & Canada)
1300 135 312 (Australia)

service.fisher-price.com

Fisher-Price, Inc., 636 Girard Avenue, East Aurora, NY 14052.
Hearing-impaired consumers: 1-800-382-7470.

Outside the United States:

Canada: Mattel Canada Inc., 6155 Freemont Blvd.,
Mississauga, Ontario L5R 3W2; www.service.mattel.com.

Great Britain: Mattel UK Ltd, Vanwall Business Park,
Maidenhead SL6 4UB. Helpline: 01628 500303.
www.service.mattel.com/uk

Mattel Europa B.V., Gondel 1, 1186MJ Amstelveen, Nederland.

Australia: Mattel Australia Pty. Ltd., 658 Church Street,
Locked Bag #870, Richmond, Victoria 3121 Australia.

New Zealand: 16-18 William Pickering Drive,
Albany 1331, Auckland.

Care

- Wipe this toy with a clean cloth dampened with a mild soap and water solution. Do not immerse this toy.
- This toy has no consumer serviceable parts. Do not take this toy apart.

FCC Statement (United States Only)

This equipment has been tested and found to comply with the limits for a Class B digital device, pursuant to Part 15 of the FCC Rules. These limits are designed to provide reasonable protection against harmful interference in a residential installation. This equipment generates, uses and can radiate radio frequency energy and, if not installed and used in accordance with the instructions, may cause harmful interference to radio communications. However, there is no guarantee that interference will not occur in a particular installation. If this equipment does cause harmful interference to radio or television reception, which can be determined by turning the equipment off and on, the user is encouraged to try to correct the interference by one or more of the following measures:

- Reorient or relocate the receiving antenna.
- Increase the separation between the equipment and receiver.
- Consult the dealer or an experienced radio/TV technician for help.

Note: Changes or modifications not expressly approved by the manufacturer responsible for compliance could void the user's authority to operate the equipment.

This device complies with Part 15 of the FCC Rules. Operation is subject to the following two conditions: (1) this device may not cause harmful interference and (2) this device must accept any interference received, including interference that may cause undesired operation.

ICES-003

- This Class B digital apparatus complies with Canadian ICES-003. Operation is subject to the following two conditions: (1) this device may not cause harmful interference and (2) this device must accept any interference received, including interference that may cause undesired operation.

NMB-003

- Cet appareil numérique de la classe B est conforme à la norme NMB-003 du Canada. L'utilisation de ce dispositif est autorisée seulement aux conditions suivantes : (1) il ne doit pas produire de brouillage et (2) l'utilisateur du dispositif doit être prêt à accepter tout brouillage radioélectrique reçu, même si ce brouillage est susceptible de compromettre le fonctionnement du dispositif.

Assembled Parts

⚠ CAUTION

This package contains small parts.
For adult assembly only.

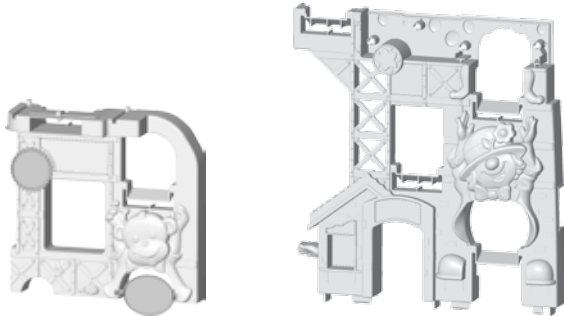

Upper Wall

Lower Wall



3 Ramps
(Labeled 1)

Ramp
(Labeled 2)

Ramp
(Labeled 3)

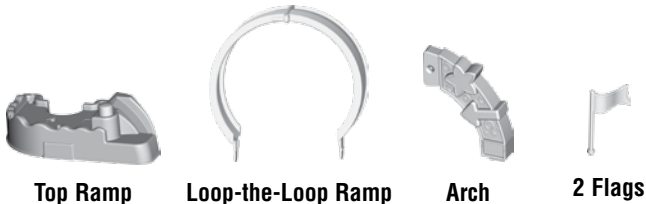

Top Ramp

Loop-the-Loop Ramp

Arch

2 Flags

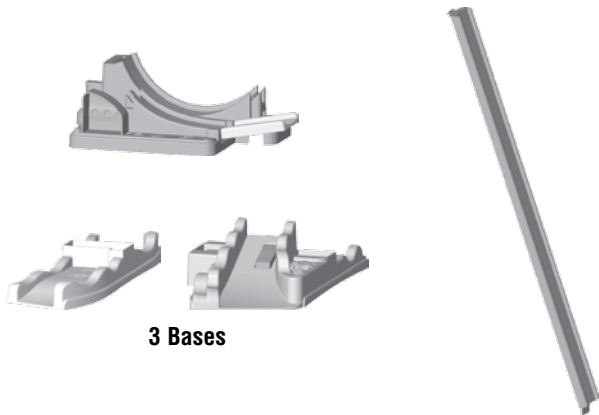

3 Bases

Long Ramp

Part not shown: Label Sheet





#8 x 5/8" (1,6 cm) Screw – 8

Shown Actual Size

Screw shown actual size. Tighten or loosen all screws with a Phillips screwdriver. Do not over-tighten the screws.

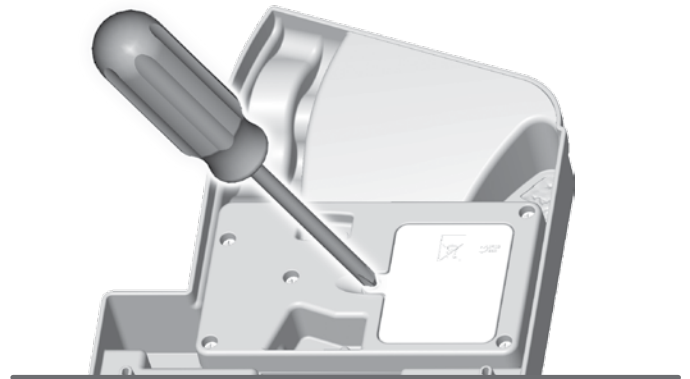
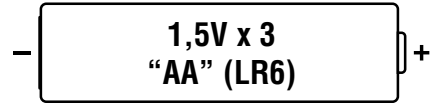
Battery Installation



- Locate the battery compartment on the bottom of the toy.
 - Loosen the screw in the battery compartment door and remove the door.
 - Insert three, new "AA" (LR6) **alkaline** batteries.
 - *Hint: We recommend **alkaline** batteries for longer battery life.*
 - Replace the battery compartment door and tighten the screw.
 - If this product begins to operate erratically, you may need to reset the electronics. Slide the power switch off and back on.
 - When sounds from this toy become faint or stop, it's time for an adult to change the batteries.
-  • Protect the environment by not disposing of this product with household waste (2002/96/EC). Check your local authority for recycling advice and facilities.

Battery Safety Information

In exceptional circumstances, batteries may leak fluids that can cause a chemical burn injury or ruin your product. To avoid battery leakage:

- Do not mix old and new batteries or batteries of different types: alkaline, standard (carbon-zinc) or rechargeable (nickel-cadmium).
- Insert batteries as indicated inside the battery compartment.
- Remove batteries during long periods of non-use. Always remove exhausted batteries from the product. Dispose of batteries safely. Do not dispose of this product in a fire. The batteries inside may explode or leak.
- Never short-circuit the battery terminals.
- Use only batteries of the same or equivalent type, as recommended.
- Do not charge non-rechargeable batteries.
- Remove rechargeable batteries from the product before charging.
- If removable, rechargeable batteries are used, they are only to be charged under adult supervision.

Assembly

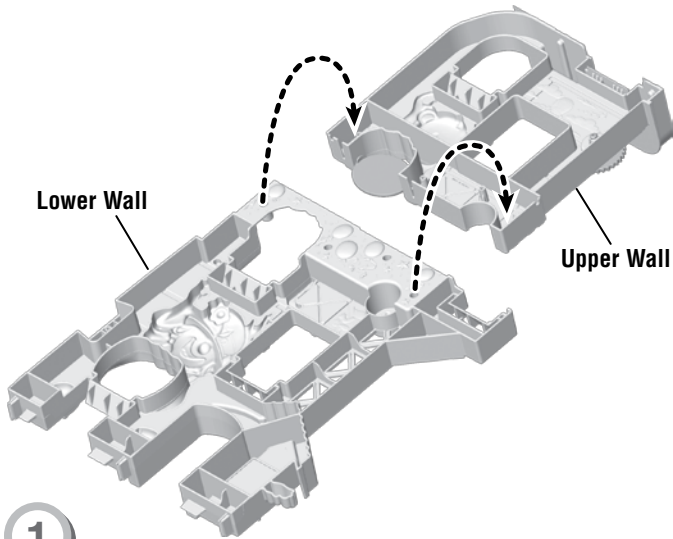

1

- Fit the upper and lower walls together, as shown.

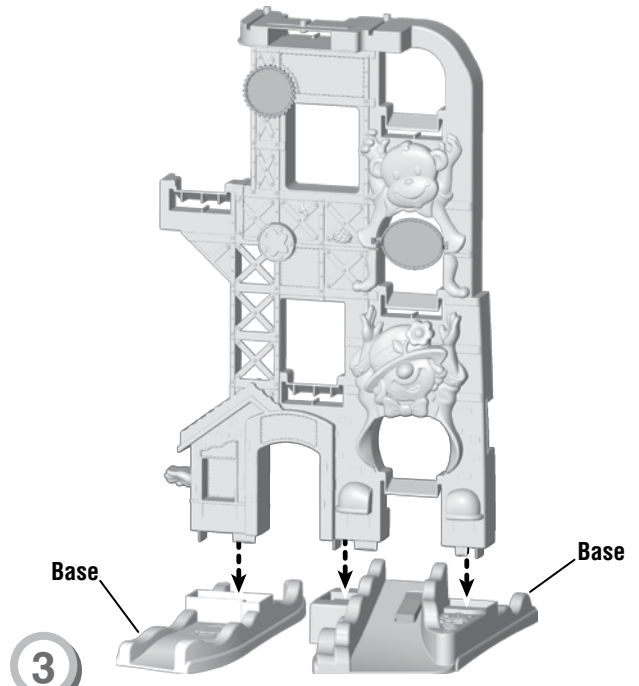

3

- Place two of the bases on a flat surface, as shown.
 - Fit the wall assembly into each base and push to “snap” in place.
- Hint: The wall is designed to fit the bases one way. If it does not seem to fit, turn or switch one or both bases around and try again!*

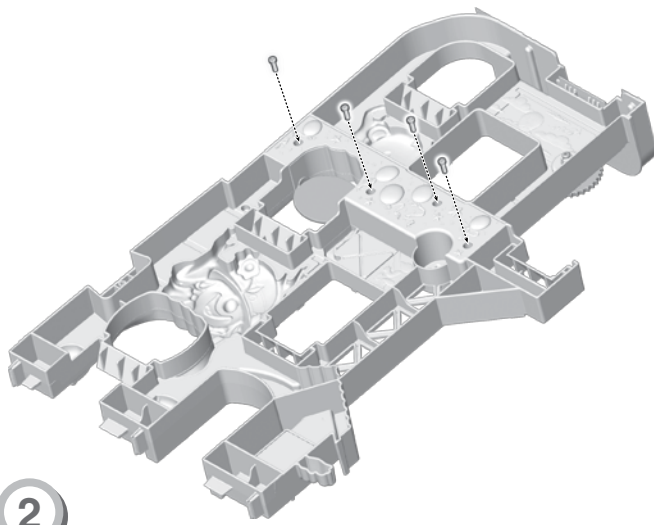

2

- Insert four screws into the holes in the wall assembly and tighten.

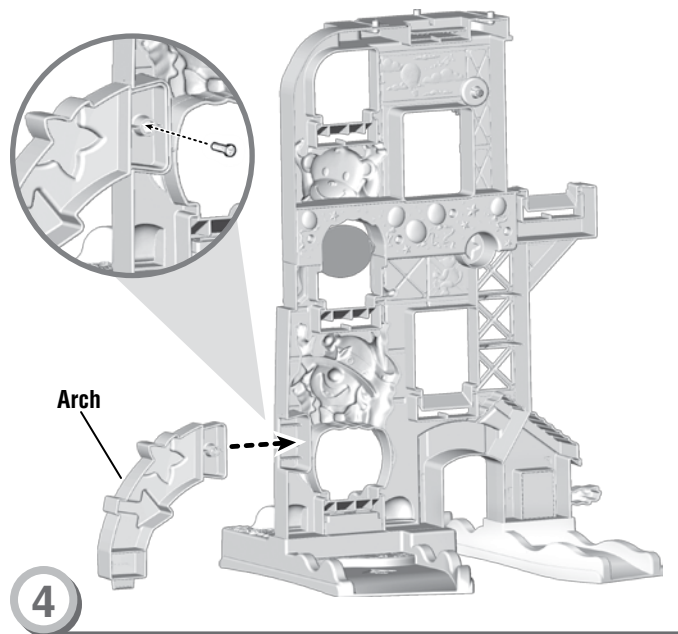

4

- Fit the arch onto the wall, as shown. Insert a screw into the arch and tighten.

Assembly

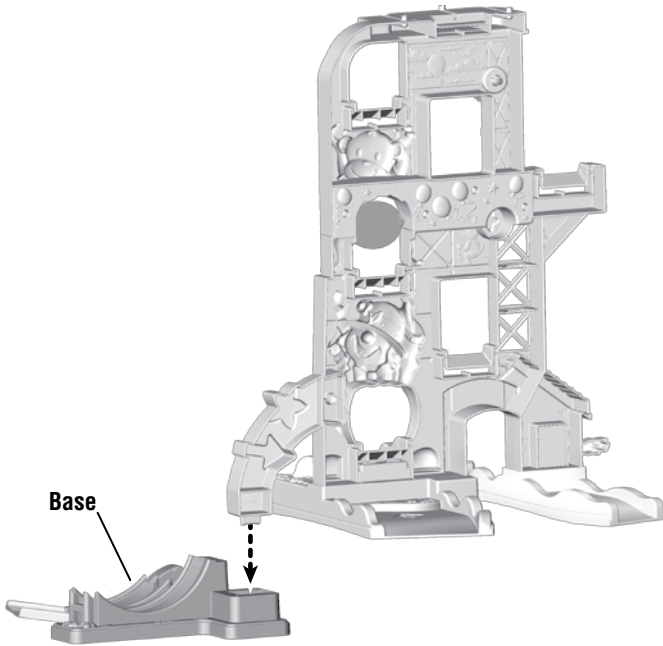

5

- Fit the bottom of the arch into the remaining base. Push to "snap" in place.

Hint: The arch is designed to fit into the base one way. If it does not seem to fit, turn the base around and try again.

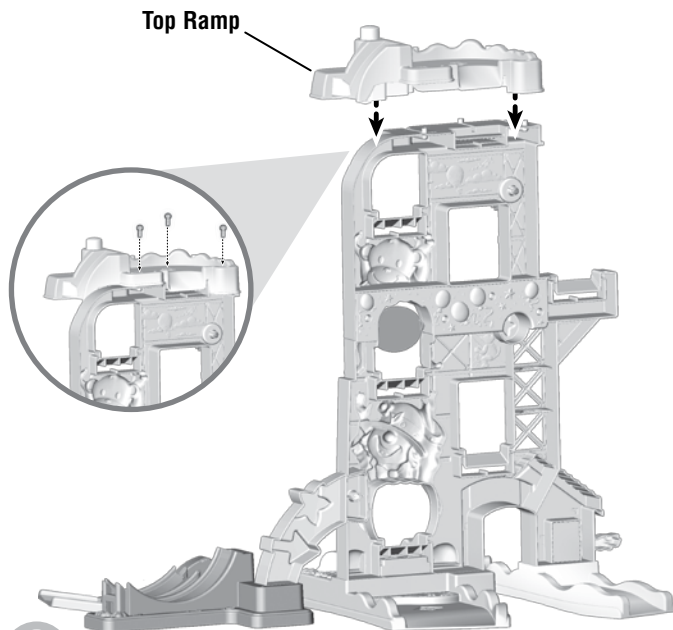

6

- Fit the top ramp onto the top of the assembly.
- Insert three screws into the top ramp and tighten.

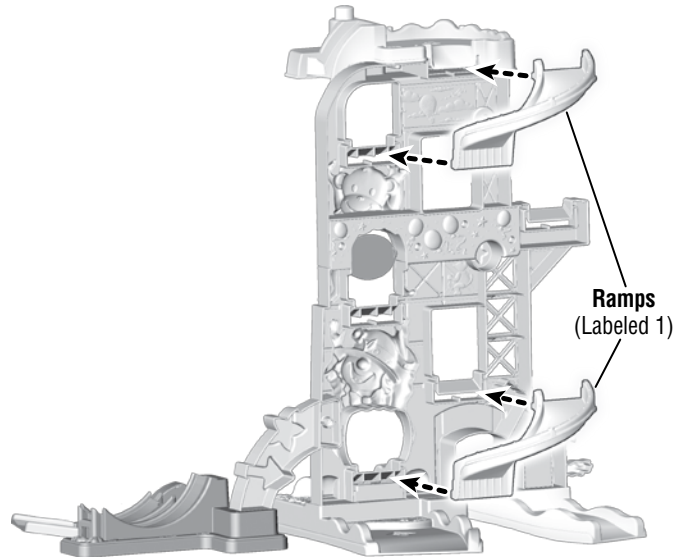

7

- Locate two of the ramps labeled 1.
- Fit the ends of the ramps into the slots in the wall.

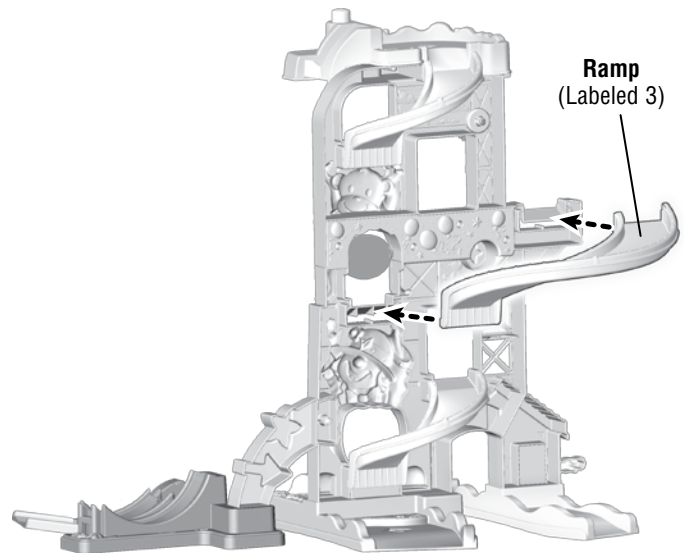

8

- Locate the ramp labeled 3.
- Fit the ends of the ramp into the slots in the wall.

Assembly

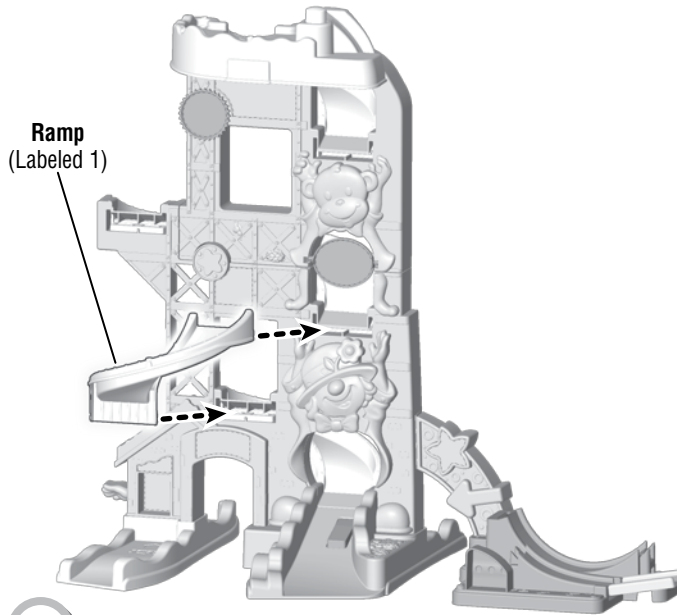

9

- Carefully turn the assembly around.
- Fit the ends of the remaining ramp labeled 1 into the slots in the wall.

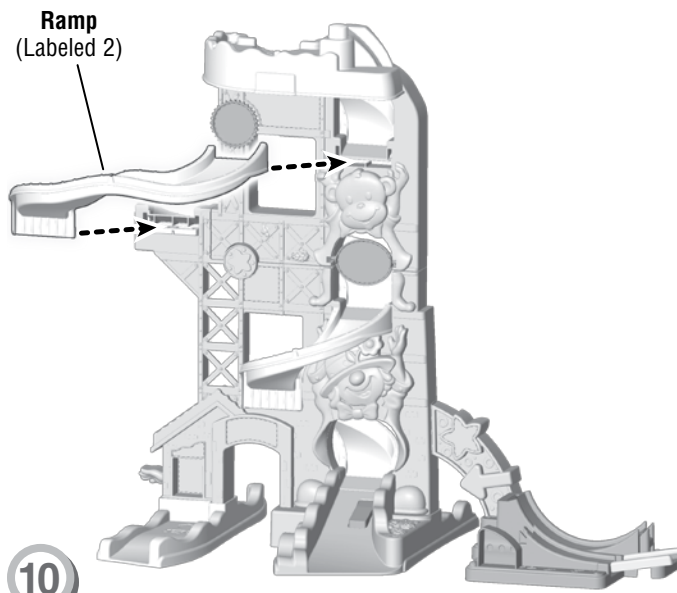

10

- Locate the ramp labeled 2.
- Fit the ends of the ramp into the remaining slots in the wall.

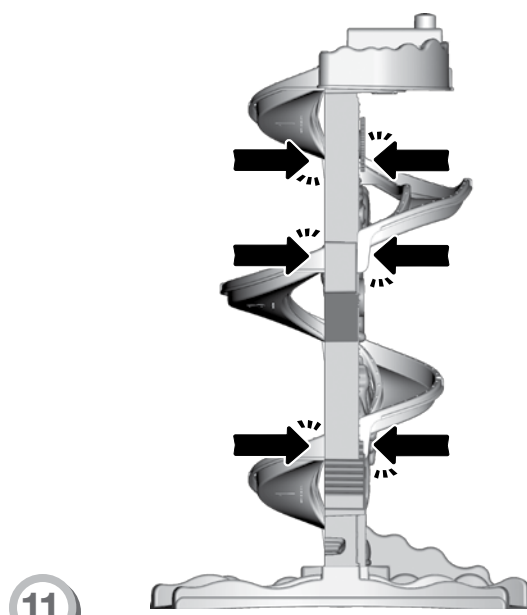

11

- While holding each ramp in place, push the ramps on both sides of the wall to "snap" in place.

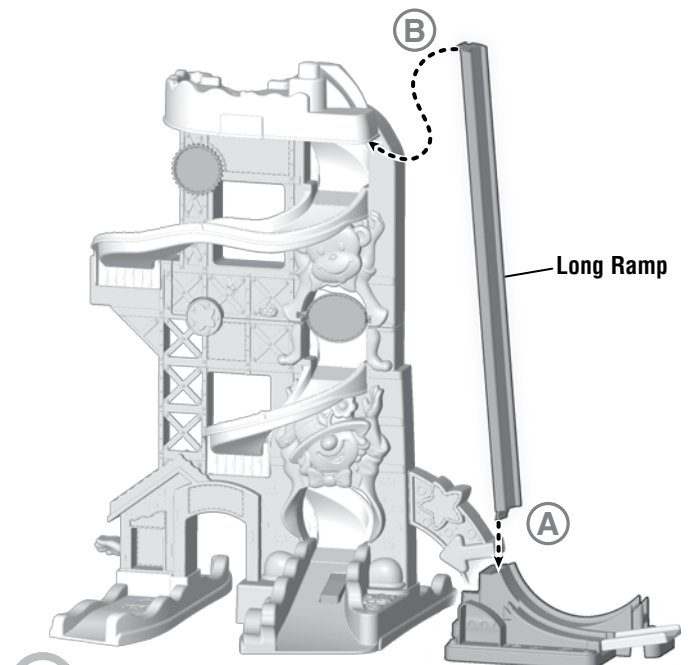

12

- First fit the tab on the long ramp into the slot in the base ①. Push to "snap" the long ramp in place.
- Then fit the tab on the other end of the long ramp into the slot under the top ramp ②. Push to "snap" in place.

Assembly

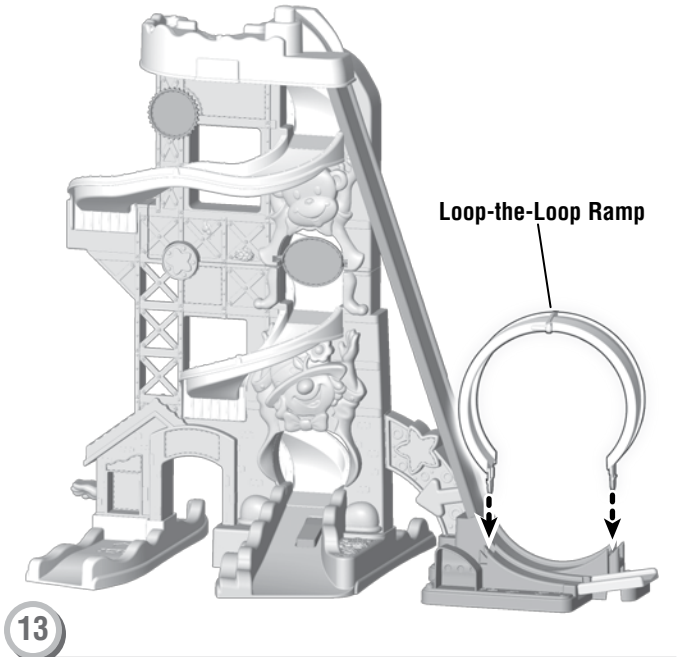

- Fit the tabs on the ends of the loop-the-loop ramp into the slots in the base.
- Push to **"snap"** the loop-the-loop ramp in place.

Decoration

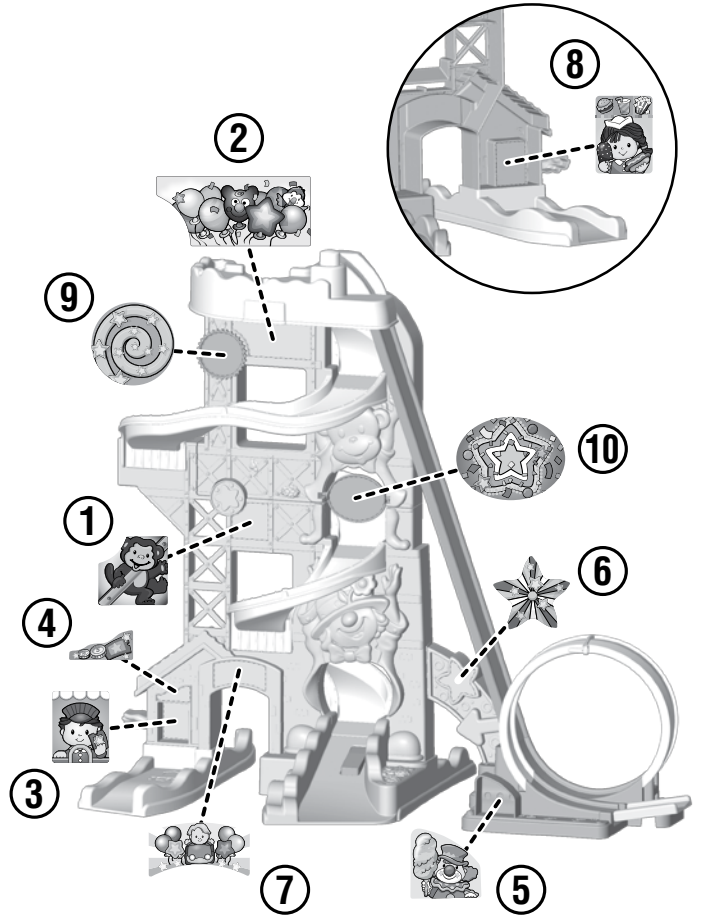

- Place the labels exactly as shown in the illustrations.
- For best results, avoid repositioning a label once it has been applied.

Fun Songs and Sounds!

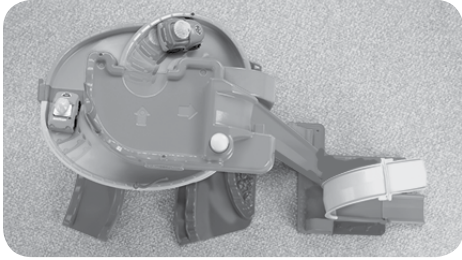

- Slide the vehicles down the ramps for double roller coaster action!



- Press the button to send a vehicle down the side ramp!



- Watch the vehicle drive through the loop-the-loop.

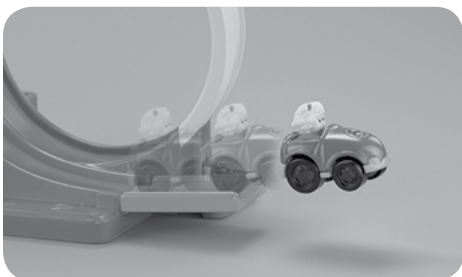

- Lift the jump at the end of the loop to send the vehicle flying!

Fit the flags into any of the sockets on the toy!



- Slide the power switch on the bottom of the toy ON ●. When you are finished playing with this toy, slide the power switch OFF ○.

