

**⚠ WARNING**

To prevent entanglement injury,
never place gym in a crib or
playpen. Never add strings, ties or
other products to the gym.

Please keep this instruction sheet for future reference,
as it contains important information.

Requires three “AA” batteries (included) for operation.
Batteries included are for demonstration purposes only.

Adult assembly is required.

Tool required: Phillips screwdriver (not included).

Assembled Parts

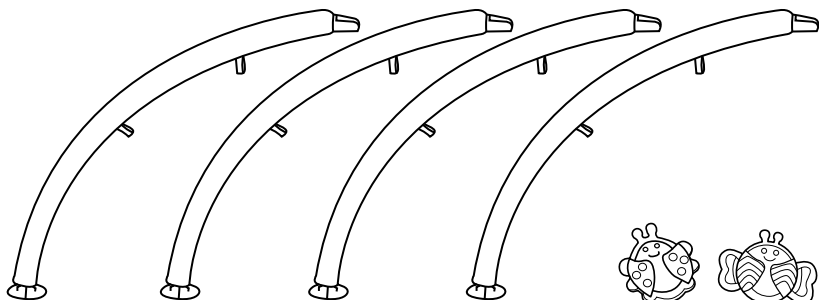

4 Arches

2 Butterfly Toys



Simba Toy



Nala Toy



Zazu Toy

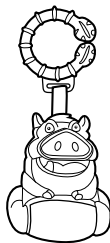

Pumbaa Toy



Take-Along Mirror

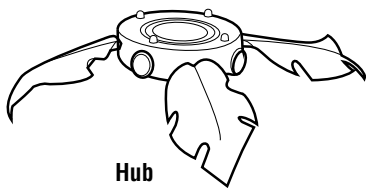

Hub



Timon Teether



Mirror Base

Note: the screws used to assemble part are attached to the product. Follow these instructions carefully to fully secure the screws. Tighten and loosen all screws with a Phillips screwdriver. Do not over-tighten the screws.

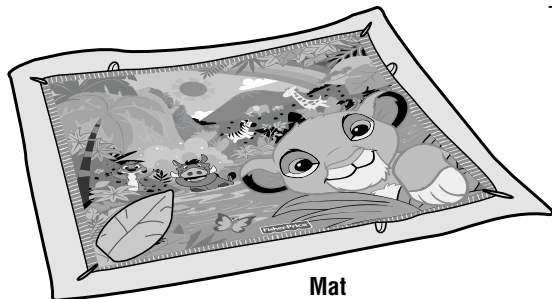

Mat

Battery Replacement

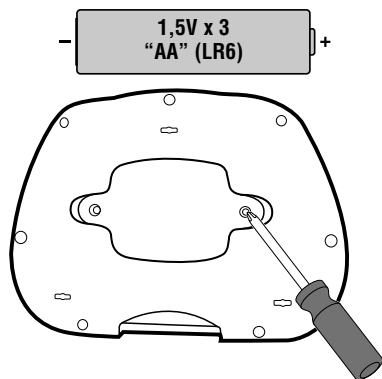

For best performance, we recommend replacing the batteries that came with this toy with three, new "AA" (LR6) alkaline batteries.

- Locate the battery compartment door on the take-along mirror.
- Loosen the screws in the battery compartment door and remove the door.
- Insert three "AA" (LR6) **alkaline** batteries.
- Replace the battery compartment door and tighten the screws. Do not over-tighten.
- If this toy begins to operate erratically, you may need to reset the electronics. Slide the power/volume switch off and then back on.
- When sounds or lights from this toy become faint or stop, it's time for an adult to change the batteries.



- Protect the environment by not disposing of this product with household waste (2002/96/EC). Check your local authority for recycling advice and facilities.

Battery Safety Information

In exceptional circumstances, batteries may leak fluids that can cause a chemical burn injury or ruin your product. To avoid battery leakage:

- Do not mix old and new batteries or batteries of different types: alkaline, standard (carbon-zinc) or rechargeable (nickel-cadmium).
- Insert batteries as indicated inside the battery compartment.
- Remove batteries during long periods of non-use. Always remove exhausted batteries from the product. Dispose of batteries safely. Do not dispose of this product in a fire. The batteries inside may explode or leak.
- Never short-circuit the battery terminals.
- Use only batteries of the same or equivalent type, as recommended.
- Do not charge non-rechargeable batteries.
- Remove rechargeable batteries from the product before charging.
- If removable, rechargeable batteries are used, they are only to be charged under adult supervision.

Care

Mat

- Wash in cold water on the gentle cycle. Do not use bleach. Tumble dry low.

Arches, Hub and Toys

- Wipe the surface with a clean cloth dampened with a mild soap and water solution. Do not use bleach.
- Do not immerse take-along mirror.

Consumer Information

**CONSUMER ASSISTANCE**
1-800-432-5437 (US & Canada)
1300 135 312 (Australia)
service.fisher-price.com

Fisher-Price, Inc., 636 Girard Avenue, East Aurora, NY 14052.
Hearing-impaired consumers: 1-800-382-7470.

Outside the United States:
Canada: Mattel Canada Inc., 6155 Freemont Blvd.,
Mississauga, Ontario L5R 3W2; www.service.mattel.com.
Great Britain: Mattel UK Ltd, Vanwall Business Park,
Maidenhead SL6 4UB. Helpline: 01628 500303.
www.service.mattel.com/uk
Mattel Europa B.V., Gondel 1, 1186MJ Amstelveen, Nederland.
Australia: Mattel Australia Pty. Ltd., 658 Church Street,
Locked Bag #870, Richmond, Victoria 3121 Australia.
New Zealand: 16-18 William Pickering Drive,
Auburn 1331, Auckland.

FCC Statement (United States Only)

This equipment has been tested and found to comply with the limits for a Class B digital device, pursuant to Part 15 of the FCC Rules. These limits are designed to provide reasonable protection against harmful interference in a residential installation. This equipment generates, uses and can radiate radio frequency energy and, if not installed and used in accordance with the instructions, may cause harmful interference to radio communications. However, there is no guarantee that interference will not occur in a particular installation. If this equipment does cause harmful interference to radio or television reception, which can be determined by turning the equipment off and on, the user is encouraged to try to correct the interference by one or more of the following measures:

- Reorient or relocate the receiving antenna.
- Increase the separation between the equipment and receiver.
- Consult the dealer or an experienced radio/TV technician for help.

Note: Changes or modifications not expressly approved by the manufacturer responsible for compliance could void the user's authority to operate the equipment. This device complies with Part 15 of the FCC Rules. Operation is subject to the following two conditions: (1) this device may not cause harmful interference and (2) this device must accept any interference received, including interference that may cause undesired operation.

ICES-003

- This Class B digital apparatus complies with Canadian ICES-003.
- Operation is subject to the following two conditions: (1) this device may not cause harmful interference and (2) this device must accept any interference received, including interference that may cause undesired operation.

NMB-003

- Cet appareil numérique de la classe B est conforme à la norme NMB-003 du Canada.
- L'utilisation de ce dispositif est autorisée seulement aux conditions suivantes : (1) il ne doit pas produire de brouillage et (2) l'utilisateur du dispositif doit être prêt à accepter tout brouillage radioélectrique reçu, même si ce brouillage est susceptible de compromettre le fonctionnement du dispositif.

© Disney

©2012 Mattel. All Rights Reserved. ® and ™ designate U.S. trademarks of Mattel, except as noted.

Assembly and Setup

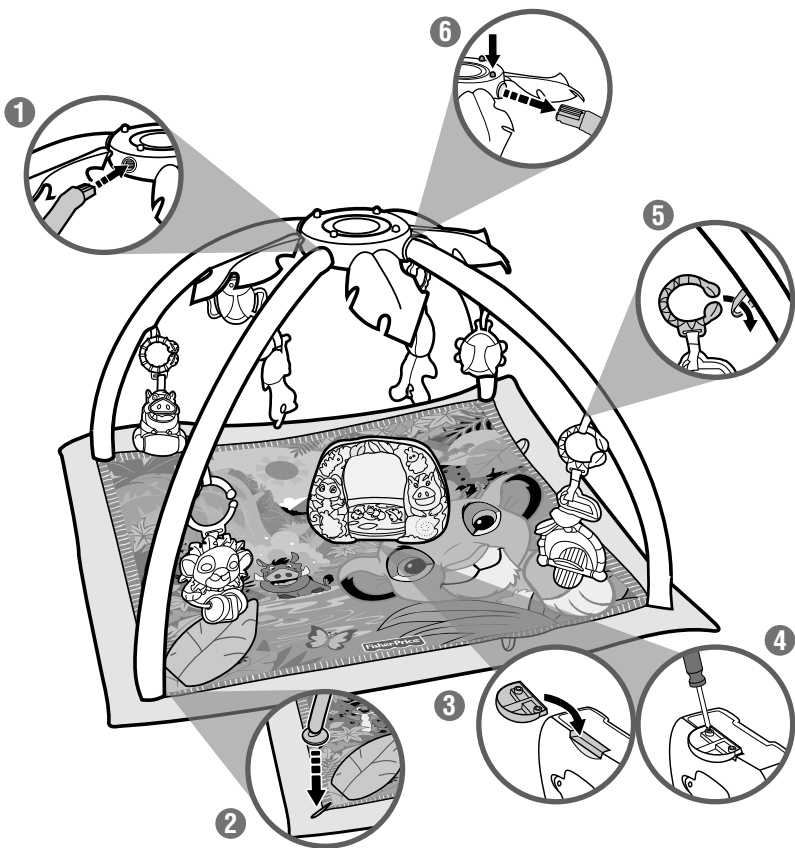

- 1 Insert and **"snap"** each arch into the sockets in the hub.
- 2 Lay the mat on a flat surface with the decorated side up. Insert the end of each arch through the slots in each corner of the mat.
- 3 Fit the mirror base onto the bottom of the take-along mirror.
- 4 Tighten the screws in the mirror base.
- 5 Hang the toys from loops on the arches or the mat or from the bottom other toys.
- 6 To remove the arches from the hub, simply press the button on the hub near each arch socket.

Music, Lights & Nature Sounds!



Power/Volume Switch



Mode Switch

- Slide the **power/volume switch** on the take-along mirror to ON with low volume ◀), or ON with high volume ◀)).
- Slide the **mode switch** to short play 🎵 or long play 🎵🎵.
- **Short Play** - Spin the roller to play a tune and build a song!
- **Long Play** - Spin the roller for approximately 20 minutes of music and lights!
- When you are finished playing with this toy, slide the power/volume switch OFF ○.