

#### This device complies with Part 15 of the FCC Rules.

Operation is subject to the following two conditions:

(1) This device may not cause harmful interference, and (2) this device must accept any interference received, including interference that may cause undesired operation.

- This equipment has been tested and found to comply with the limits for a Class B digital device, pursuant to Part 15 of the FCC rules. These limits are designed to provide reasonable protection against harmful interference in a residential installation. This equipment generates uses and can radiate radio frequency energy and, if not installed and used in accordance with the instructions, may cause harmful interference to radio communications. However, there is no guarantee that interference will not occur in a particular installation. If this equipment does cause harmful interference to radio or television reception, which can be determined by turning the equipment off and on, the user is encouraged to try to correct the interference by one or more of the following measures:
- Reorient or relocate the receiving antenna.
- Increase the separation between the equipment and receiver.
- Connect the equipment into an outlet on a circuit different from that to which the receiver is connected.
- Consult the dealer or an experienced radio/TV technician for help.

**NOTE: Changes or modifications not expressly approved by the manufacturer responsible for compliance could void the user's authority to operate the equipment.**



Protect the environment by not disposing of this product with household waste (2002/96/EC). Check your local authority for recycling advice and facilities.

**Note: Do not use the pen to draw or write on skin. Wash ink off skin after use.**

Dying to know more? Visit us at:

**MONSTERHIGH.COM**

Y2329-0920



**RADICA**

**girl  
TECH**

**CONFORMS TO THE SAFETY REQUIREMENTS OF ASTM F963.  
PEN CONFORMS TO THE SAFETY REQUIREMENTS OF ASTM D4236**

©2012 Mattel. All Rights Reserved.

RADICA USA Ltd. Helpline 1-800-524-8697 or service.mattel.com.

Mattel, Inc. 636 Girard Avenue, East Aurora, NY 14052, U.S.A. Consumer Relations 1-800-524-8697.

Mattel Europa, B.V., Gondel 1, 1186 MJ Amstelveen, Nederland.

Mattel U.K. Ltd., Vanwall Business Park, Maidenhead SL6 4UB. Helpline 01628 500303.

Mattel Australia Pty., Ltd., Richmond, Victoria. 3121. Consumer Advisory Service - 1300 135 312

Mattel East Asia Ltd., Room 1106, South Tower, World Finance Centre, Harbour City, Tsimshatsui, HK, China.

Diimport & Diedarkan Oleh: Mattel SEA Ptd Ltd.(993532-P) Lot 13.5, 13th Floor, Menara Lien Hoe, Persiaran Tropicana Golf Country Resort, 47410 PJ. Tel:03-78803817, Fax:03-78803867

#### CONSUMER INFORMATION

Need Assistance? Visit [service.mattel.com](http://service.mattel.com) or call 1-800-524-8697 (US and Canada only).

[SERVICE.MATTEL.COM](http://SERVICE.MATTEL.COM)



**Ages  
6+**

# Password Journal®

**Y2329**

## INSTRUCTION MANUAL

Keep these instructions for future reference as they contain important information.

**Your secrets are now twice as safe! Write and protect your innermost thoughts in your password-protected journal, while at the same time storing your favorite things in a hidden compartment—which opens only with a second personal password! YOUR voice is the only key!**

**Plus, you can write in your journal with the Invisible Ink Pen, and then watch your words magically appear by activating your Show / Glow Light. And you can do it all while listening to your favorite music on your MP3 player!**

### CONTENTS

- 1 Password Journal® Case
- 1 Notebook
- 1 Invisible Ink Pen

Please remove all components from the container and compare them to the contents list. If any items are missing, please call 1-800-524-8697. Outside the U.S., please consult the listing of your local Mattel offices at the end of these instructions.

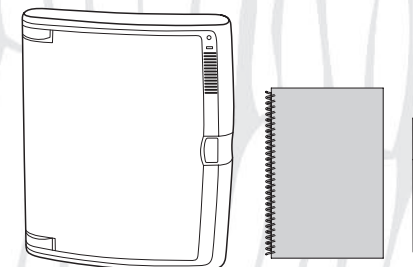

### BATTERY INFORMATION

- Requires 3 "AA" Alkaline batteries (not included).
- For longer life use only alkaline batteries.
- If game malfunctions, check the battery installation.
- BATTERIES SHOULD BE CHANGED WHEN SOUND DISTORTS OR LOCKING MECHANISM MALFUNCTIONS.

**IMPORTANT NOTE:** You will have 20 seconds to replace the old batteries before your password and set-up information is lost. Should you lose your password or set-up information, you will need to re-enter them.

**ADULT SUPERVISION RECOMMENDED WHEN CHANGING BATTERIES.**

### BATTERY SAFETY INFORMATION

In exceptional circumstances batteries may leak fluids that can cause a chemical burn injury or ruin your product. To avoid battery leakage:

- Non-rechargeable batteries are not to be recharged.
- Rechargeable batteries are to be removed from the product before being charged.
- Rechargeable batteries are only to be charged under adult supervision.
- Do not mix alkaline, standard (carbon-zinc), or rechargeable (nickel-cadmium) batteries.
- Do not mix old and new batteries.
- Only batteries of the same or equivalent type as recommended are to be used.
- Batteries are to be inserted with the correct polarity.
- Exhausted batteries are to be removed from the product.
- The supply terminals are not to be short-circuited.
- Dispose of batteries safely.
- Do not dispose of this product in a fire. The batteries inside may explode or leak.

**- AA + x3**  
Not Included

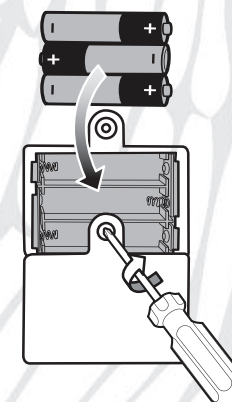

#### INSTRUCTION SHEET SPECIFICATIONS

Toy: Password Journal 7 MH  
Toy No.: Y2329  
Part No.: -0920  
Trim Size: 11" W x 8.5" H  
Folded Size: 5.5" W x 4.25" H  
Type of Fold: Fold into half (W & H)  
# colors: One  
Colors: Black  
Paper Stock: White Offset  
Paper Weight: 70 lb.  
EDM No.: 001

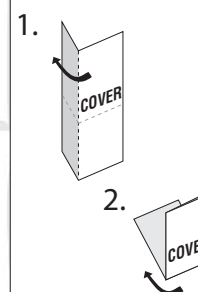



## BUTTON FUNCTIONS

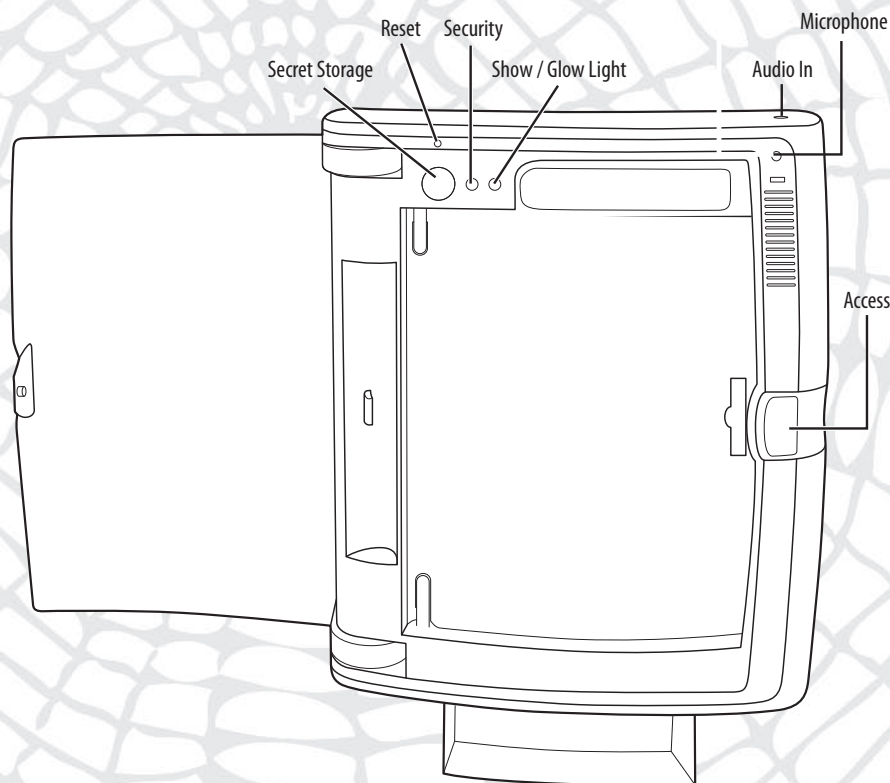

**Audio In** – Plug the cord of your MP3 Player into the Audio In plug to listen to your favorite tunes.

**NOTE:** Use your MP3 Player to adjust the volume of your music.

**Access** – Press to open journal.

**NOTE:** The Access Button is disabled when the audio cable is plugged into your Password Journal®. Please remove cable when entering your password.

**Microphone:** Speak clearly into the Microphone when recording your passwords.

**Show / Glow Light:** Press ONCE to use the Glow Light. Press TWICE for the Show Light, and then again to turn the light off.

**NOTE:** The UV light will automatically shut off after 1 minute.

**Secret Storage** – Press to open Secret Storage Compartment.

**Security** – The Security Button adds even more protection to Password Journal®. The button has HIGH, LOW and OFF settings. On HIGH, you will have to speak your secret password precisely and clearly to release the lock. On LOW, you may say your password softer and not as clear. When you switch to the OFF setting, the journal will open automatically.

**NOTE:** After you first record your passwords, the security setting will be on LOW. If you want to change it to HIGH or OFF, you must use the button.

## SETUP

### RECORDING YOUR PASSWORDS

**1) Access Button** – after installing the batteries, press the Access Button. The door will automatically open. Press and hold the Access Button again and you will hear the prompt instruct you to record your password. Say your chosen password into the microphone (be careful not to speak until the LED light turns on or else the Password Journal® will not hear you).

Password Journal® will then ask you to repeat your new password. If you speak it correctly, it will be accepted and you will be informed that your password has been recorded.

**2) Secret Storage Button** – First, the cover of your Password Journal® must be open. Next, press the Secret Storage Button and the drawer will automatically open. Then press the Secret Storage Button again—and hold it—and you will hear the prompt to record your secret storage password. You will record your Secret Storage password by following the same steps as when you recorded your Access Button password.

**HINT:** Be sure to speak clearly and say your passwords the EXACT same way each time! When recording your passwords, make sure you are in a quiet place. If the Password Journal® does not accept your password after speaking it clearly, try whispering the password.

You may want to write down your passwords in case you forget them – but be sure to write them in a safe place or they won't be secret anymore!

If you do not want to set a password, ignore the voice instructions and switch the Security Button to OFF. The Access Button will then automatically open the journal, and the Secret Storage Button will automatically open the Secret Storage Compartment.

## USING YOUR PASSWORD JOURNAL®

### 1. USING THE GLOW LIGHT AND PEN

Use the special Glow Light pen included in your Password Journal® to write your personal secrets then reveal them with the Glow Light. To activate the Glow Light, first pull up the Glow / Show Light from inside your Password Journal®, position it over the writing pad, and then press the Glow / Show Light Button until the Glow Light appears.

You may also write in your Password Journal® with a regular pen or pencil.

### 2. USING THE SECRET STORAGE COMPARTMENT

When you want to store something in your Secret Storage Compartment, press the Secret Storage Button. The Password Journal® will ask you for your password. Once you have successfully spoken your password, the compartment will open. After placing your secret stuff in the compartment, push it closed for safekeeping.

### 3. CHANGING YOUR PASSWORDS

From time to time, you may want to change your passwords (especially if you think some else knows it!). Open Password Journal® using your old password. To change your password, press and hold the Access Button. The Password Journal® will then prompt you to record your new password. Say your chosen new password in the microphone. Password Journal® will then prompt you to repeat your new password. If spoken correctly, the new password will be accepted.

To change your Secret Storage password, press and hold the Secret Storage Button, then repeat the same process described above.

#### NOTE:

- Sometimes, a build-up of static electricity (from carpets, etc.) may cause the product to stop working. Just press the Reset Button and it will work again.

- In an environment with radio frequency interference, the product may malfunction and require user to reset the product.