

©2012 Mattel. All Rights Reserved. Mattel, Inc., 636 Girard Avenue, East Aurora, NY 14052, U.S.A. Consumer Relations 1-800-524-8697. Mattel U.K. Ltd., Vanwall Business Park, Maidenhead SL6 4UB. Helpline 01628500303. Mattel Australia Pty Ltd., Richmond, Victoria. 3121. Consumer Advisory Service - 1300 135 312. Mattel East Asia Ltd., Room 1106, South Tower, World Finance Centre, Harbour City, Tsimshatsui, HK, China. Diimport & Diedarkan Oleh: Mattel SEA Ptd Ltd. (993532-P) Lot 13.5, 13th Floor, Menara Lien Hoe, Persiaran Tropicana Golf Country Resort, 47410 PJ. Tel: 03-78803817, Fax: 03-78803867. Mattel Europa B.V., Gondel 1, 1186MJ Amstelveen, Nederland.

iPad is a trademark of Apple Inc., registered in the U.S. and other countries. App Store is a service mark of Apple Inc.

We reserve the right to terminate digital Appitivity™ applications after September 1, 2014.

Y2409-0920G1



service.mattel.com

Y2409, X3150, X3152, X3153, X3155



LANG: DOM

### INSTRUCTION SHEET SPECIFICATIONS

Toy: Y2409  
 Toy No.: Y2409  
 Part No.: 0920G1  
 Trim Size: 2.5"W x5" H  
 Folded Size: 2.5" W x2.5" H  
 Type of Fold: Single  
 # colors: One  
 Colors: Black  
 Paper Stock: White Offset  
 Paper Weight: 70 lb.  
 EDM No.:

### G1 change Details:

- 1) Fresh IS with new standard style.
- 2) Y2409, X3149 DOM will common use one manual (Y2409-0920).
- 3) Add disclaimer "We reserve the right to terminate digital Appitivity™ applications after September 1, 2014."
- 4) Add a new diagram that shows how to hold the car, along with copy: "Hold with two fingers as shown or vehicle may not function properly."

## VEHICLE POSITION

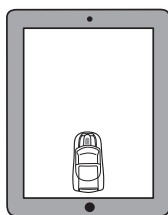

For best results, hold vehicle lightly in the center and near the bottom of the screen of your iPad.

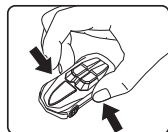

Hold with two fingers as shown or vehicle may not function properly.

## VEHICLE OPERATION



### Retractable Touch Points:

1. Press center button to extend touch points for play on iPad® screen.
2. Press center button again to retract touch points for non-iPad play.



### Action Button:

Press to select features in the app during game play.

### IMPORTANT:

- If iPad screen does not respond, **make sure the touch points are in the extended position.**
- Consumer should periodically check the vehicle for damage that could scratch the screen. If damaged, discontinue use.

## 2 PANEL Folding Dummy

