



INSTRUCTIONS

Please keep these instructions for future reference as they contain important information.

ASSEMBLY

1. Unfold the playset by separating the 2 sides, allowing the circular track to fall into place.

a

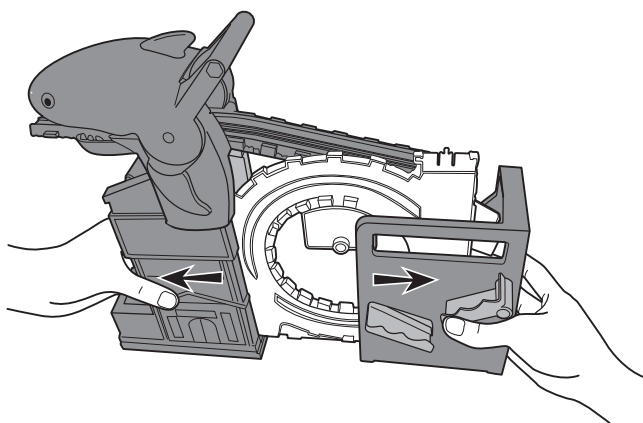

b

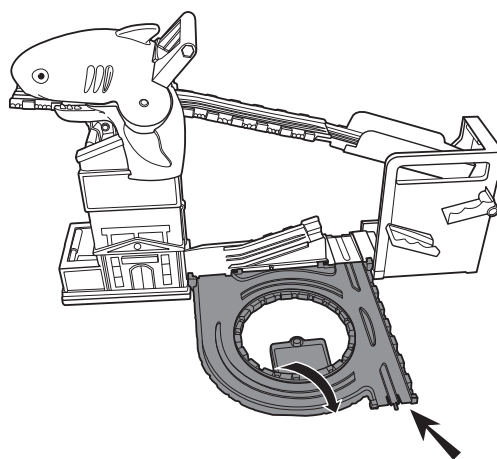

Attach here to other Take-n-Play track and playsets (sold separately).

HOW TO PLAY

1. Place the shark cargo in the tank and place the cargo car beneath the shark tank.

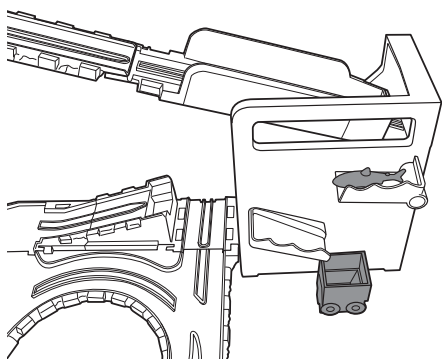

2. Press the handle to open the shark's mouth.

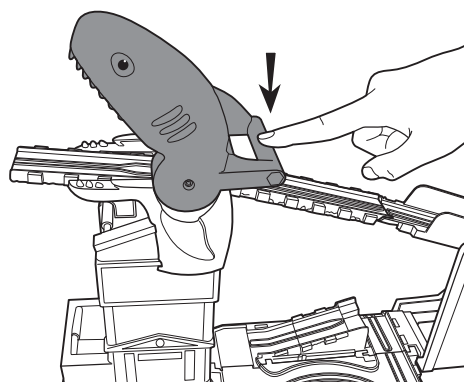

3. Set Thomas at the top of the track to enter the shark exhibit.

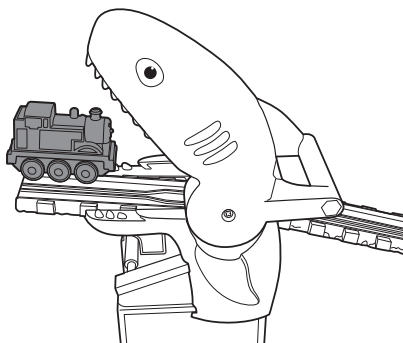

4. Tap the bottom of the handle to release the shark's mouth.

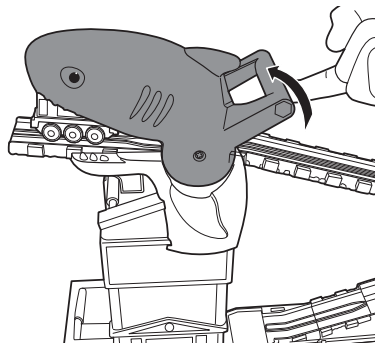

5. As the shark's mouth closes it will release Thomas down the track, past the tank, where it will trigger the release of the shark cargo into the cargo car.

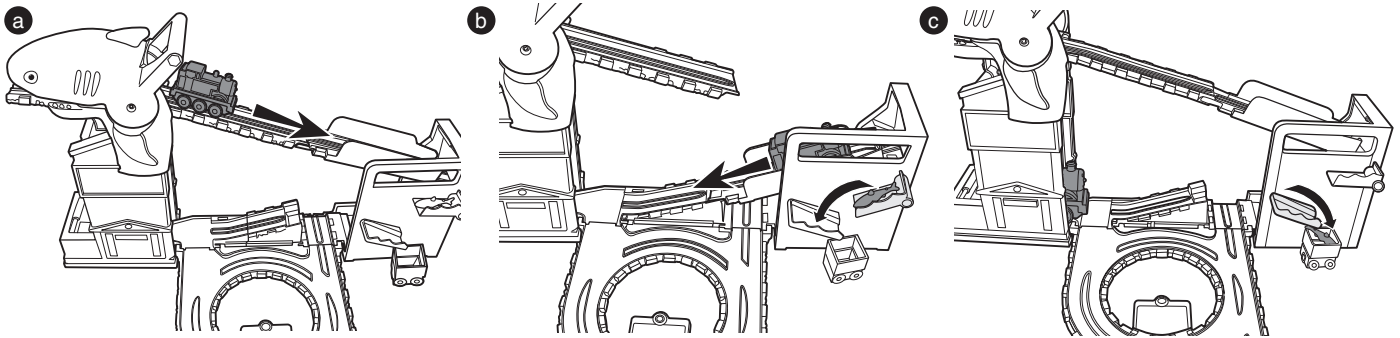

6. Once the engine reaches the bottom of the track, Thomas can attach to the cargo car and transport the shark cargo to the exhibit display.

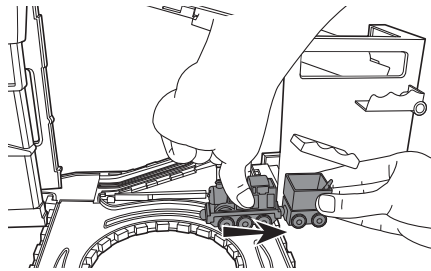

NOTE: May not work with all engines.

STORAGE

1. Fold the playset by folding the circular track upward and pushing the 2 sides back together.

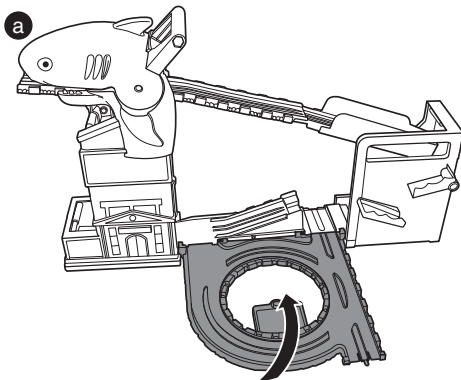

2. Store Thomas, his cargo car and the shark cargo beneath the playset.

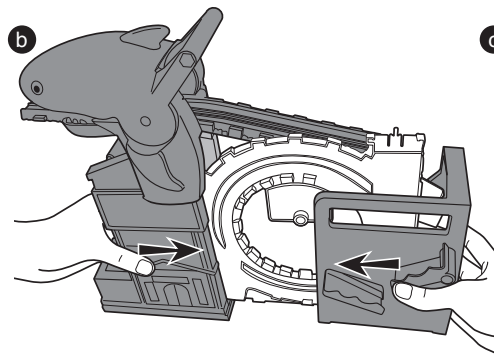
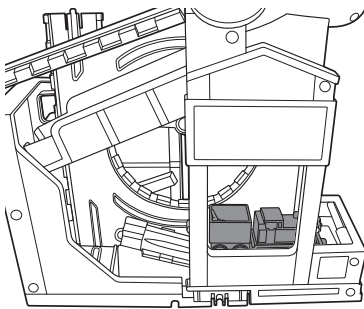

3. Carry by the handle for Take-N-Play™ portability!

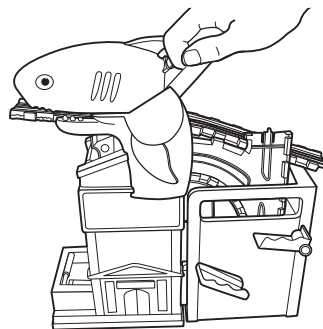

WARNING:
CHOKING HAZARD – Small parts.
Not for children under 3 years.

Thomas the Tank Engine & Friends™



CREATED BY BRIT ALLCROFT

Based on the Railway Series by The Reverend W Awdry.
©2012 Gullane (Thomas) Limited. Thomas the Tank Engine & Friends and Thomas & Friends are trademarks of Gullane (Thomas) Limited.
© HIT Entertainment Limited. HIT and the HIT logo are trademarks of HIT Entertainment Limited.

©2012 Mattel. All Rights Reserved.

* and ™ designate U.S. trademarks of Mattel, except as noted. **PRINTED IN CHINA.**

Mattel East Asia Ltd., Room 1106, South Tower, World Finance Centre, Harbour City, Tsimshatsui, HK, China.



Y3019

Fisher-Price®

CONSUMER ASSISTANCE
1-800-432-5437 (US & Canada)
1300 135 312 (Australia)
service.fisher-price.com

Fisher-Price, Inc., 636 Girard Avenue, East Aurora, NY 14052.
Hearing-impaired consumers: 1-800-382-7470.

Outside the United States:

Canada: Mattel Canada Inc., 6155 Freemont Blvd., Mississauga, Ontario L5R 3W2; www.service.mattel.com.

Great Britain: Mattel UK Ltd, Vanwall Business Park, Maidenhead SL6 4UB. Helpline: 01628 500303.
www.service.mattel.com/uk

Mattel Europa B.V., Gondel 1, 1186MJ Amstelveen, Nederland.

Australia: Mattel Australia Pty. Ltd., 658 Church Street, Locked Bag #870, Richmond, Victoria 3121 Australia.

New Zealand: 16-18 William Pickering Drive, Albany 1331, Auckland.